

J.C. Broderick & Associates, Inc.

Environmental / Construction Consulting & Testing



January 31, 2023

Mr. Severino Fasulo
Syosset Central School District
99 Pell Lane
Syosset, New York 11791

**Re: Indoor Radon Sampling / Methane Monitoring
South Grove Annex
60 Colony Lane
Syosset, New York 11791
Sampling Dates: January 9-12, 2023**

JCB#: 22-52916

Dear Mr. Fasulo:

J.C. Broderick and Associates, Inc. (JCB) was retained to perform indoor radon sampling and methane monitoring within the above referenced school building. The existing active sub-slab depressurization system (SSDS) for radon mitigation was turned off 48-hours prior to the start and throughout the duration of the sampling.

The radon sampling was performed by experienced JCB representatives following the EPA Radon Measurement in Schools (EPA 402-R-92-014) guidance document. Sampling was performed utilizing Short-Term test devices which were placed in frequently occupied rooms in contact with the ground.

Radon Laboratory Analytical Summary

The short-term Radon in Air sampling was performed utilizing laboratory supplied test kits, assigned individual identification numbers and were secured. Chain of Custody documents were prepared, and the samples were then delivered to an independent New York State Department of Health (NYSDOH) Environmental Laboratory Approval Program (ELAP) certified laboratory for analysis of Radon in Air.

EMSL Analytical Inc. (EMSL) of Cinnaminson, New Jersey provided laboratory analytical services. Copies of EMSL's NYSDOH certifications are available upon request.

The laboratory analytical results for the Radon in Air samples were reviewed and compared to the United States Environmental Protection Agency (EPA) recommended action level of 4.0 pCi/L as reported in Radon Measurement in Schools Revised Edition (EPA 402-R-92-014), dated July 1993.

The monitoring for methane gas was also performed during this period utilizing a Landtec GEM 5000 methane detecting real-time monitor. The monitor recorded the percentage of methane along with carbon dioxide and oxygen every 15-minutes.

The results of the sampling performed revealed the following:

- All results were reported below the EPA action level.
- No methane was recorded by the detector.

January 31, 2023
Mr. Severino Fasulo of Syosset CSD
Indoor Radon Sampling / Methane Monitoring
South Grove Annex
60 Colony Ln., Syosset, NY 11791
JCB#: 22-52916

Please see the attached laboratory reports to be included in the District's Radon Measurement Plan. If there are any questions or if more information is needed, please feel free to contact our office.

Sincerely,
J. C. Broderick & Associates, Inc.

A handwritten signature in black ink, appearing to read "Steven Muller", with a long horizontal flourish extending to the right.

Steven Muller, P.G.
Director, Subsurface Division

Appendix A

Figures

NEW

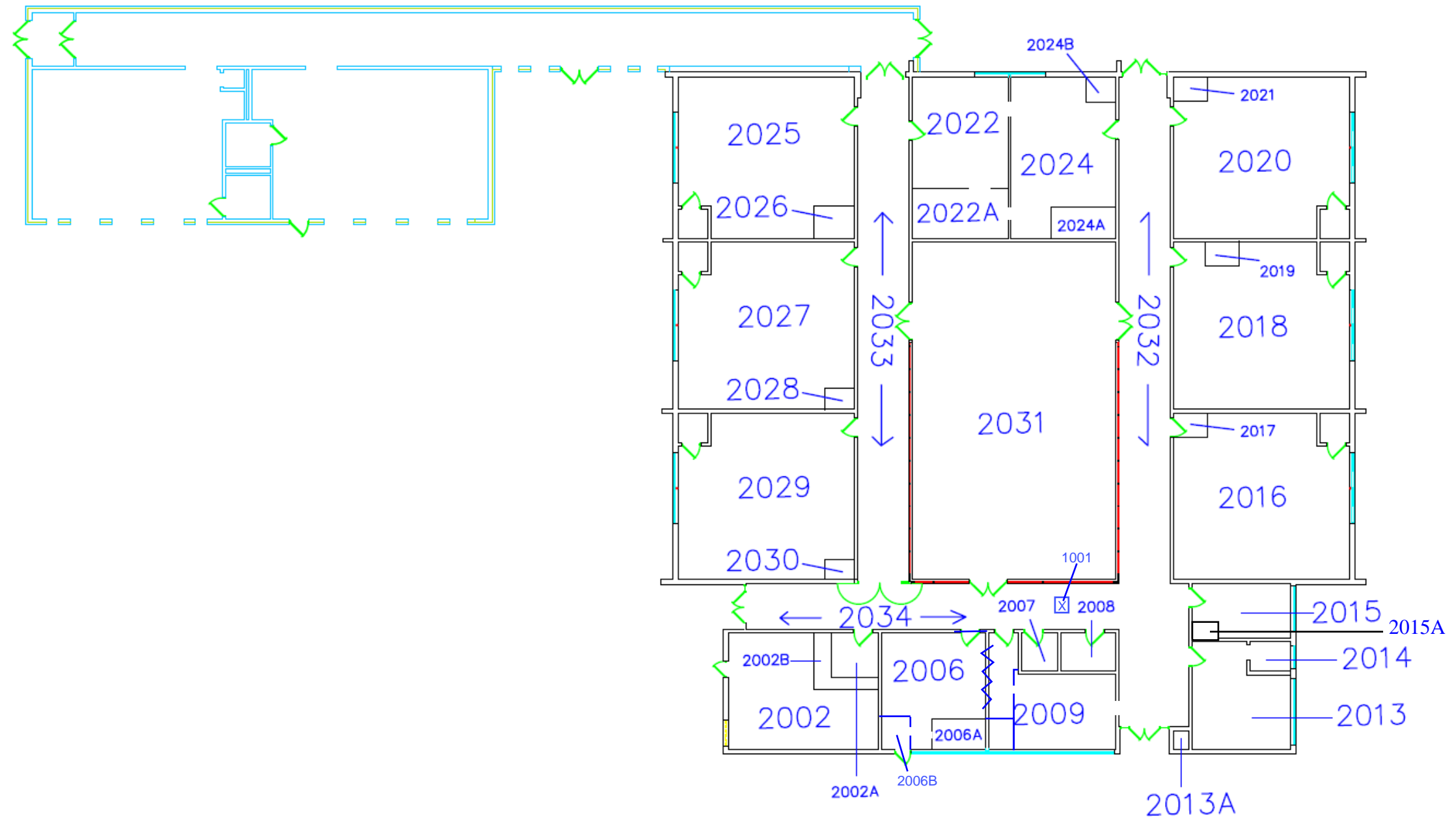

ANNEX

Pipe tunnel 1001



J.C. Broderick & Associates
Environmental Consulting & Testing
1775 Expressway Dr. North
Hauppauge, New York 11788
Phone: 631.584.5492 Fax: 631.584.5913

JCB #: 12-22347
SYOSSET CENTRAL SCHOOL DISTRICT
South Grove Annex
60 Colony Lane, Syosset, NY 11791

Appendix B

Laboratory Analysis Reports



EMSL Analytical, Inc.

200 Route 130 North, Cinnaminson, NJ 08077
Phone/Fax: (800) 220-3675 / (856) 786-0327
<http://www.EMSL.com> cinnaminsonradonlab@emsl.com

EMSL Order: 382300225
CustomerID: JCBR50
CustomerPO:
ProjectID:

Attn: **Steven Muller**
J.C. Broderick & Associates
1775 Expressway Drive North, Suite 1
Hauppauge, NY 11788

Phone: (631) 584-5492
Fax:
Received: 1/13/2023 08:16 PM
Analysis Date: 1/17/2023
Collected: 1/9/2023

Project: **South Grove Annex Project / 60 Colony Lane #22-52916**

Test **South Grove Annex**
Site: **60 Colony Lane**
Syosset, NY 11791

Test Report: Radon in Air Test Results

Liquid Scintillation ID	Location	Radon Activity (pCi/L)	Start	Stop	Temperature F	Humidity %	Sample Type
524626 382300225-0001	2006A Shelf	0.3	1/9/2023 7:20:00 AM	1/12/2023 6:23:00 PM	71	39	Customer
Sample Notes:							
524657 382300225-0002	2009 Shelf	0.6	1/9/2023 7:22:00 AM	1/12/2023 6:25:00 PM	72	45	Customer
Sample Notes:							
524542 382300225-0003	2009 Shelf	0.5	1/9/2023 7:22:00 AM	1/12/2023 6:25:00 PM	72	45	Duplicate
Sample Notes: Duplicate's Customer Sample:382300225-0002					Duplicate RPD = 18.2%		
524672 382300225-0004	2013 Cabinet	0.4	1/9/2023 7:24:00 AM	1/12/2023 6:26:00 PM	72	38	Customer
Sample Notes:							
524589 382300225-0005	2015 Cabinet	0.2	1/9/2023 7:25:00 AM	1/12/2023 6:28:00 PM	72	39	Customer
Sample Notes:							
524698 382300225-0006	2015 Cabinet	0.3	1/9/2023 7:25:00 AM	1/12/2023 6:28:00 PM	72	39	Blank
Sample Notes:							
524689 382300225-0007	2016 Cabinet	0.4	1/9/2023 7:27:00 AM	1/12/2023 6:32:00 PM	72	35	Customer
Sample Notes:							
524693 382300225-0008	2018 Cabinet	0.4	1/9/2023 7:29:00 AM	1/12/2023 6:34:00 PM	70	38	Customer
Sample Notes:							
524697 382300225-0009	2020 Shelf	0.4	1/9/2023 7:30:00 AM	1/12/2023 6:35:00 PM	70	41	Customer
Sample Notes:							
524629 382300225-0010	2022 Desk	0.4	1/9/2023 7:30:00 AM	1/12/2023 6:18:00 PM	73	39	Customer
Sample Notes:							



EMSL Analytical, Inc.

200 Route 130 North, Cinnaminson, NJ 08077

Phone/Fax: (800) 220-3675 / (856) 786-0327

<http://www.EMSL.com>

cinnaminsonradonlab@emsl.com

EMSL Order:	382300225
CustomerID:	JCBR50
CustomerPO:	
ProjectID:	

Test Report: Radon in Air Test Results

Liquid Scintillation ID	Location	Radon Activity (pCi/L)	Start	Stop	Temperature F	Humidity %	Sample Type
524526 382300225-0011	2022P Shelf	0.5	1/9/2023 7:31:00 AM	1/12/2023 6:37:00 PM	73	35	Customer
Sample Notes:							
524646 382300225-0012	2024 Cabinet	0.2	1/9/2023 7:32:00 AM	1/12/2023 6:36:00 PM	72	38	Customer
Sample Notes:							
524617 382300225-0013	2025 Shelf	0.3	1/9/2023 7:32:00 AM	1/12/2023 6:20:00 PM	69	43	Customer
Sample Notes:							
524681 382300225-0014	2027 Shelf	0.4	1/9/2023 7:33:00 AM	1/12/2023 6:21:00 PM	70	40	Customer
Sample Notes:							
524613 382300225-0015	2027 Shelf	0.3	1/9/2023 7:33:00 AM	1/12/2023 6:21:00 PM	70	40	Duplicate
Sample Notes: Duplicate's Customer Sample:382300225-0014					Duplicate RPD = 28.6%		
524537 382300225-0016	2029 Shelf	0.4	1/9/2023 7:34:00 AM	1/12/2023 6:22:00 PM	71	39	Customer
Sample Notes:							
524637 382300225-0017	2029 Shelf	0.2	1/9/2023 7:34:00 AM	1/12/2023 6:22:00 PM	71	39	Blank
Sample Notes:							

Report Notes



EMSL Analytical, Inc.

200 Route 130 North, Cinnaminson, NJ 08077

Phone/Fax: (800) 220-3675 / (856) 786-0327

<http://www.EMSL.com>

cinnaminsonradonlab@emsl.com

EMSL Order: 382300225

CustomerID: JCBR50

CustomerPO:

ProjectID:

Test Report: Radon in Air Test Results

Liquid Scintillation ID	Location	Radon Activity (pCi/L)	Start	Stop	Temperature F	Humidity %	Sample Type
-------------------------	----------	------------------------	-------	------	---------------	------------	-------------

The United States Environmental Protection Agency (EPA) has established a radon action level of 4.0pCi/L. EPA recommends mitigation of a structure if the confirmed radon level is equal to or greater than 4.0pCi/L.

The radon tests were performed using liquid scintillation radon detectors and counted on a liquid scintillation counter following EPA Method # 402-R-92-004 testing protocol for Radon in Air testing. EPA recommends retesting every two years.

Please contact EMSL Analytical, Inc. or your State Health Department for further information.

All procedures used for generating this report are in complete accordance with the current EPA protocols for the analysis of Radon in Air.

Analyst(s)

Julian Washington (17)

Dominic Gehret, Radiochemistry Laboratory Manager, 10872

In no event shall EMSL be liable for indirect, special, consequential, or incidental damages, including, but not limited to, damages for loss of profit or goodwill regardless of the negligence (either sole or concurrent) of EMSL and whether EMSL has been informed of the possibility of such damages, arising out of or in connection with EMSL's services thereunder or the delivery, use, reliance upon or interpretation of test results by client or any third party. We accept no legal responsibility for the purposes for which the client uses the test results. In no event shall EMSL be liable to a client or any third party, whether based upon theories of tort, contract or any other legal or equitable theory, in excess of the amount paid to EMSL by client thereunder. The test results meets all NELAC requirements unless otherwise specified.

Samples analyzed by EMSL Analytical, Inc. Cinnaminson, NJ FL RB2034/R2687,IL RNL2008202,IN RTL00935,IA RNLAB10005,KS KS-LB-0005/KS-MS-0482,ME SPC202,MN RL-0005,NE 474/RMB-1083,NJ 03036/MEB92525/MES13910,NY 10872,OH RL39,OK D9952,PA 2573/3393/68-00367,RI RMB-108/RI00179,WV RL000220,NRSB-ARL6006,NRPP

Initial report from 01/26/2023 10:31:27



**CHAIN OF CUSTODY
RADON LABORATORY SERVICES**
(COMMERCIAL USE)

EMSL ANALYTICAL, INC.
200 ROUTE 130 NORTH
CINNAMINSON, NJ 08077
PHONE: 800-220-3675
www.emsl.com

EMSL ANALYTICAL, INC.

EMSL Job #:

Company Information: EMSL Acct #: JCB R50

Company Name: JCB RODENRICK ASSOC. INC.

Contact: STEVEN MULLER

Address: 1775 EXPRESSWAY DR. N

City: HAUPPESQUE

State: NY Zip: 11788

Phone: 631-584-5792 Fax: 631-584-3795

Email:

Technician Certification #:

Tech Name: Steven Muller

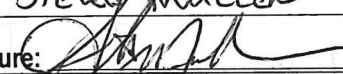
Tech Signature: 

Project/Site Information: *Required

Project Name: SOUTH GROVE ANNEX

Project # / PO: 22-52916

*Address: 60 COLONY LANE

*City: SYOSSET *State: NY *Zip: 11791

*Building type? Residential Non-Residential
 School Other:

*Building foundation type? Basement Crawlspace
 Slab on Grade Other:

Special Notes / Instructions:

***Turnaround Time (TAT) Options**

1 Day
 2 Day
 3 Day
 4 Day

Disclaimer: In no event shall EMSL be liable for indirect, special, consequential, or incidental damages for loss of profit or goodwill regardless of the negligence (either sole or concurrent) of EMSL and whether EMSL has been informed of the possibility of such damages arising out of or in connection with EMSL's services there under or the delivery, use, reliance upon or interpretation of test results by client or third party. We accept no legal responsibility for the purposes for which the client uses the test results. In no event shall EMSL be liable to a client or any third party, whether based upon theories of tort, contract or any other legal or equitable theory, in excess of the amount paid to EMSL by client thereafter.

(S) Sample (B) Blank (D) Duplicate	Device Number	Location	Room #	Exposure Period Beginning Date		Exposure Period Ending Date		Temp, °F	Humidity, %
				Date	Time	Date	Time		
(S) Sample	<u>524626</u>	<u>SHELF</u>	<u>2006A</u>	<u>1/9/23</u>	<u>720</u>	<u>1/12/23</u>	<u>1823</u>	<u>70.8</u>	<u>39.0</u>
<u>S</u>	<u>524657</u>	<u>SHELF</u>	<u>2009</u>	<u>1/9/23</u>	<u>722</u>	<u>1/12/23</u>	<u>1825</u>	<u>71.7</u>	<u>45.3</u>
<u>D</u>	<u>524542</u>	<u> </u>	<u> </u>	<u> </u>	<u> </u>	<u> </u>	<u> </u>	<u> </u>	<u> </u>
<u>S</u>	<u>524672</u>	<u>CABINET</u>	<u>2013</u>	<u>1/9/23</u>	<u>724</u>	<u>1/12/23</u>	<u>1826</u>	<u>71.6</u>	<u>37.9</u>
<u>S</u>	<u>524589</u>	<u>CABINET</u>	<u>2015</u>	<u>1/9/23</u>	<u>725</u>	<u>1/12/23</u>	<u>1828</u>	<u>71.6</u>	<u>39.2</u>
<u>B</u>	<u>524698</u>	<u> </u>	<u> </u>	<u> </u>	<u> </u>	<u> </u>	<u> </u>	<u> </u>	<u> </u>
<u>S</u>	<u>524689</u>	<u>CABINET</u>	<u>2016</u>	<u>1/9/23</u>	<u>727</u>	<u>1/12/23</u>	<u>1832</u>	<u>72.3</u>	<u>34.6</u>
<u>S</u>	<u>524693</u>	<u>CABINET</u>	<u>2018</u>	<u>1/9/23</u>	<u>729</u>	<u>1/12/23</u>	<u>1834</u>	<u>70.3</u>	<u>38.3</u>
<u>S</u>	<u>524697</u>	<u>SHELF</u>	<u>2020</u>	<u>1/9/23</u>	<u>730</u>	<u>1/12/23</u>	<u>1835</u>	<u>70.3</u>	<u>40.6</u>

Relinquished by (Sign): _____ Date: _____ Time: _____

Received by EMSL (Sign): _____ Date: _____ Time: _____



**CHAIN OF CUSTODY
RADON LABORATORY SERVICES
(COMMERCIAL USE)**

EMSL ANALYTICAL, INC.
200 ROUTE 130 NORTH
CINNAMINSON, NJ 08077
PHONE: 800-220-3675
www.emsl.com

EMSL Job #: _____

EMSL ANALYTICAL, INC.

(S) Sample (B) Blank (D) Duplicate	Device Number	Location	Room #	Exposure Period Beginning Date		Exposure Period Ending Date		Temp, °F	Humidity, %
				Date	Time	Date	Time		
S	524629	DESK	2022	1/9/23	730	1/12/23	1818	72.5	38.4
S	524526	SHOLF	2022A	1/9/23	731	1/12/23	1837	73.0	34.8
S	524646	CABINET	2024	1/9/23	732	1/12/23	1836	72.3	37.9
S	524617	SHOLF	2025	1/9/23	732	1/12/23	1820	69.7	43.1
S	524681	SHOLF	2027	1/9/23	733	1/12/23	1821	69.6	39.5
D	524613	SHOLF	2027	1/9/23	733	1/12/23	1821	69.6	39.5
S	524537	SHOLF	2029	1/9/23	734	1/12/23	1822	70.5	38.5
B	524637	SHOLF	2029	1/9/23	734	1/12/23	1822	70.5	38.5
/									

Relinquished by (Sign): _____

Date: 1/13/23 Time: _____

Received by EMSL (Sign): _____

Date: _____ Time: _____