

# J.C. Broderick & Associates, Inc.

Environmental / Construction Consulting & Testing



March 6, 2024

Mr. Severino Fasulo  
Syosset Central School District  
99 Pell Lane  
Syosset, New York 11791

**Re: Perform Professional Consulting and Environmental Sampling and testing for Radon in Air at:**

**Site: Baylis Elementary School  
580 Woodbury Road  
Plainview, New York 11803  
Site Visits: February 6 & 9, 2024**

**JCB#: 23-55371**

Dear Mr. Fasulo:

J.C. Broderick and Associates, Inc. (JCB) was retained by the Syosset Central School District (SCSD) to perform environmental sampling for indoor radon gas within the above referenced school building. The radon sampling was performed by experienced JCB representatives on the above referenced dates following the American National Standards Institute (ANSI)/American Association of Radon Scientists and Technologists (AARST) *Protocol for Conducting Measurements of Radon and Radon Decay Products in Multifamily, School, Commercial and Mixed-Use Buildings* MA-MFLB-2023, effective date December 1, 2023, guidance document. The site visits consisted of the following:

- Collection of radon in air samples from 41 locations within occupied rooms in contact with the ground at the above referenced school building.
- Submission of designated samples to an independent New York State Department of Health (NYSDOH) Environmental Laboratory Approval Program (ELAP) certified laboratory for radon in air analysis.
- Review and compare the laboratory results to the ANSI/AARST *Protocol for Conducting Measurements of Radon and Radon Decay Products in Multifamily, School, Commercial and Mixed-Use Buildings* MA-MFLB-2023, effective date December 1, 2023.

## **Summary of Sample Collection, Field Screening and Sample Submission**

The following section summarizes the environmental sampling performed. Please refer to attachments located at the end of this report for additional details.

- On February 6, 2024, a total of 50 short-term radon test kits were deployed in 42 strategic occupied spaces located throughout the above referenced school building. The test kits remained within the given space for a period of three (3) days. A select number of samples served as a duplicate or remained closed as a field blank for QA/QC compliance.

March 6, 2024

Mr. Severino Fasulo of Syosset CSD

Perform Professional Consulting and Environmental Sampling and testing for

Radon in Air at:

Baylis Elementary School

580 Woodbury Rd., Plainview, NY 11803

JCB#: 23-55371

- The area around each test kit location was field screened for the presence of total volatile organic compounds utilizing a MiniRAE 3000 Portable photo-ionization detector (PID). Technical data pertaining to the MiniRAE 3000 Portable PID is available upon request.
- On February 9, 2024, a total of 48 short-term radon test kits were retrieve, sealed, and assigned unique identification numbers, logged into a chain of custody document, and delivered to an independent New York State Department of Health (NYSDOH) Environmental Laboratory Approval Program (ELAP) accredited radon laboratory for analysis. Prior to sample retrieval, temperature and humidity were recorded utilizing a OXV Thermo-Hygrometer meter. It should be noted that the two (2) short-term radon test kits placed in space 2008 was not retrieved from this classroom for analysis.

### Quality Assurance and Quality Control (QA/QC) Procedures

To ensure that measurement results are reliable, JCB performed duplicate and laboratory blank sampling in eight (8) selected spaces. JCB representatives maintained a radon sampling chain of custody used to track samples from sampling point to analysis which summarized the following:

- Sample identification;
- Test Kit ID number;
- Device ID number;
- Sampling beginning date and time;
- Sampling ending date and time;
- Temperature, °F;
- Humidity, %.

### Summary of Laboratory Analysis

Please refer to the tables located in Attachment #1 for a summary of submitted samples and laboratory analysis results.

- The laboratory analytical results for the radon in air samples were reviewed and compared to the ANSI/AARST *Protocol for Conducting Measurements of Radon and Radon Decay Products in Multifamily, School, Commercial and Mixed-Use Buildings* MA-MFLB-2023, effective date December 1, 2023, which establishes a radon in air action concentration level of 4.0 pCi/L.
  - The laboratory analysis results from the Radon in Air samples submitted did **not** reveal any elevated concentrations of radon exceeding 4.0 pCi/L, the referenced action level. The highest recorded radon concentration was in space C10 at a concentration of 1.1 pCi/L, well below the 4.0 pCi/L action level.
- EMSL Analytical Inc. (EMSL) of Cinnaminson, New Jersey provided laboratory analytical services. Copies of EMSL's NYSDOH certifications are available upon request.

March 6, 2024  
Mr. Severino Fasulo of Syosset CSD  
Perform Professional Consulting and Environmental Sampling and testing for  
Radon in Air at:  
Baylis Elementary School  
580 Woodbury Rd., Plainview, NY 11803  
JCB#: 23-55371

### Conclusions and Recommendations

Based upon the results of the laboratory analysis, the USEPA decision matrix does not recommend any additional investigation pertaining to radon in air associated with the above referenced school building.

The ANSI/AARST guidance document recommends that responsible care requires repeating initial testing procedures for all building(s) at least every 5 years and in conjunction with any sale of a building.

Radon testing should also be conducted when any of the following circumstances occur:

- a new addition is constructed or alterations for building reconfiguration or rehabilitation occur;
- a ground contact area not previously tested is occupied, or a building is newly occupied;
- heating or cooling systems are significantly altered, resulting in changes to air pressures or pressure relationships;
- ventilation is significantly altered by extensive weatherization, changes to mechanical systems or comparable procedures;
- significant openings to soil occur due to:
  - groundwater or slab surface water control systems that are altered or added (e.g., sumps, perimeter drain tile, shower/tub retrofits, etc.) or,
  - natural settlement causing major cracks to develop;
- earthquakes or construction blasting, fracking or formation of sink holes nearby; or
- a mitigation system is altered, modified, or repaired.

Should testing indicate concentrations that meet or exceed the action level, conduct evaluations, corrections and further testing until radon concentrations have been mitigated to below the action level.

However, to monitor for possible changes in indoor quality, JCB does recommend that the current annual testing schedule for radon in air within the school building continue.

Please refer to the attached laboratory reports to be included in the District's Radon Measurement Plan.

- Attachment #1 Tables
- Attachment #2 Figures
- Attachment #3 Field Photograph Logs
- Attachment #4 Laboratory Analysis Reports

If there are any questions or if more information is needed, please feel free to contact our office.

Sincerely,  
**J. C. Broderick & Associates, Inc.**

  
Steven Muller, P.G.  
Director, Subsurface Division

---

# **Attachment #1 Tables**

**Table 1. Summary of Radon Samples Submitted for Laboratory Analysis**

Sample ID#	AHERA Space ID	Sample Start Date	Sample End Date	Description of Sample	Analysis Method
524683	2005	2/6/2024	2/9/2024	File Cabinet	Radon in Air
524418 (Dup)		2/6/2024	2/9/2024		Radon in Air
524434	2007	2/6/2024	2/9/2024	File Cabinet	Radon in Air
524554	2006	2/6/2024	2/9/2024	Cabinet	Radon in Air
524685	2008	2/6/2024	Not Retrieved	Cabinet	Not Tested
524644 (B)		2/6/2024	Not Retrieved		Not Tested
524584	2009	2/6/2024	2/9/2024	Cabinet	Radon in Air
524600	2011	2/6/2024	2/9/2024	File Cabinet	Radon in Air
524489	2010	2/6/2024	2/9/2024	Cabinet	Radon in Air
524604	2012	2/6/2024	2/9/2024	Bookshelf	Radon in Air
524401	2013	2/6/2024	2/9/2024	Speaker	Radon in Air
524473	2015	2/6/2024	2/9/2024	Bookshelf	Radon in Air
524492	2020	2/6/2024	2/9/2024	Cabinet	Radon in Air
524512	2021	2/6/2024	2/9/2024	Shelf	Radon in Air
524379	2022	2/6/2024	2/9/2024	Electrical Box	Radon in Air
524431	2026	2/6/2024	2/9/2024	Speaker	Radon in Air
524487 (Dup)		2/6/2024	2/9/2024		Radon in Air
524490	2029	2/6/2024	2/9/2024	Speaker	Radon in Air
524553 (B)		2/6/2024	2/9/2024		Radon in Air
524400	2032	2/6/2024	2/9/2024	Speaker	Radon in Air
524469	2035	2/6/2024	2/9/2024	Bookshelf	Radon in Air
524522	B6	2/6/2024	2/9/2024	Cabinet	Radon in Air
524328 (B)		2/6/2024	2/9/2024		Radon in Air
524560	B9	2/6/2024	2/9/2024	Bookshelf	Radon in Air
524394	2038	2/6/2024	2/9/2024	Bookshelf	Radon in Air
524486	2041	2/6/2024	2/9/2024	Vending Machine	Radon in Air
524625	2044	2/6/2024	2/9/2024	Bookshelf	Radon in Air
521392	1055	2/6/2024	2/9/2024	Cabinet	Radon in Air
524466 (B)		2/6/2024	2/9/2024		Radon in Air
521385	2050	2/6/2024	2/9/2024	Cabinet	Radon in Air
524022	2053	2/6/2024	2/9/2024	Cabinet	Radon in Air
521379	2046	2/6/2024	2/9/2024	Bookshelf	Radon in Air
524450	2047	2/6/2024	2/9/2024	TV Stand	Radon in Air
521618	2048	2/6/2024	2/9/2024	Bookshelf	Radon in Air
524414	2049	2/6/2024	2/9/2024	Bookshelf	Radon in Air
521631	2049A	2/6/2024	2/9/2024	Bookshelf	Radon in Air
524317 (Dup)		2/6/2024	2/9/2024		Radon in Air
524583	2077	2/6/2024	2/9/2024	Shelf	Radon in Air
521075 (Dup)		2/6/2024	2/9/2024		Radon in Air
524314	2061	2/6/2024	2/9/2024	Speaker	Radon in Air
524424	2063	2/6/2024	2/9/2024	Speaker	Radon in Air
524377	2065	2/6/2024	2/9/2024	Cabinet	Radon in Air
524322	2068	2/6/2024	2/9/2024	Speaker	Radon in Air
521952	C7	2/6/2024	2/9/2024	File Cabinet	Radon in Air
524432	C9	2/6/2024	2/9/2024	File Cabinet	Radon in Air
521630	C10	2/6/2024	2/9/2024	Cabinet	Radon in Air
523230	C12	2/6/2024	2/9/2024	Cabinet	Radon in Air
524506	2070	2/6/2024	2/9/2024	Cabinet	Radon in Air
524310	2071	2/6/2024	2/9/2024	Cabinet	Radon in Air
521953	2073	2/6/2024	2/9/2024	Speaker	Radon in Air

**Notes:**  
 B = Blank  
 Dup = Duplicate

**Table 2. Summary of Radon Laboratory Results**

AHERA Space ID	2/6/24-2/9/24 (pCi/L)	1/10/23 - 1/13/23 (pCi/L)
2005	0.80	0.70
2005 (Dup)	0.50	0.90
2007	0.80	0.60
2008	Not Retrived	0.70
2008 (B)	Not Retrived	-0.10
2006	0.70	0.90
2009	0.60	0.20
2011	0.50	0.70
2010	0.30	0.40
2012	0.60	0.70
2013	0.70	0.60
2015	0.40	0.60
2020	0.60	0.80
2021	0.50	0.70
2022	0.60	0.70
2026	0.60	0.70
2026 (Dup)	0.50	1.50
2029	0.70	1.00
2029 (B)	-0.10	0.00
2032	0.30	1.10
2035	0.40	1.10
B6	0.60	1.00
B6 (B)	-0.10	Not Sampled
B9	0.20	0.50
2038	0.80	0.70
2041	0.50	0.80
2044	0.40	0.90
1055	0.70	0.30
1055 (B)	0.10	0.20
2050	1.00	0.90
2053	0.80	0.40
2046	0.50	0.90
2047	0.60	0.80
2048	0.50	0.60
2049	0.10	1.00
2049A	0.90	0.60
2049A (Dup)	0.40	0.40
2077	0.80	0.50
2077 (Dup)	0.40	0.60
2061	0.60	0.70
2063	0.50	0.70
2065	0.80	0.50
2068	0.50	1.00
C7	1.00	1.50
C9	0.60	1.10
C10	1.10	1.60
C12	0.50	0.80
2070	0.80	0.50
2071	0.40	0.60
2073	0.70	0.50

**Notes:**

B = Blank

Dup = Duplicate

---

# **Attachment #2**

## **Figures**

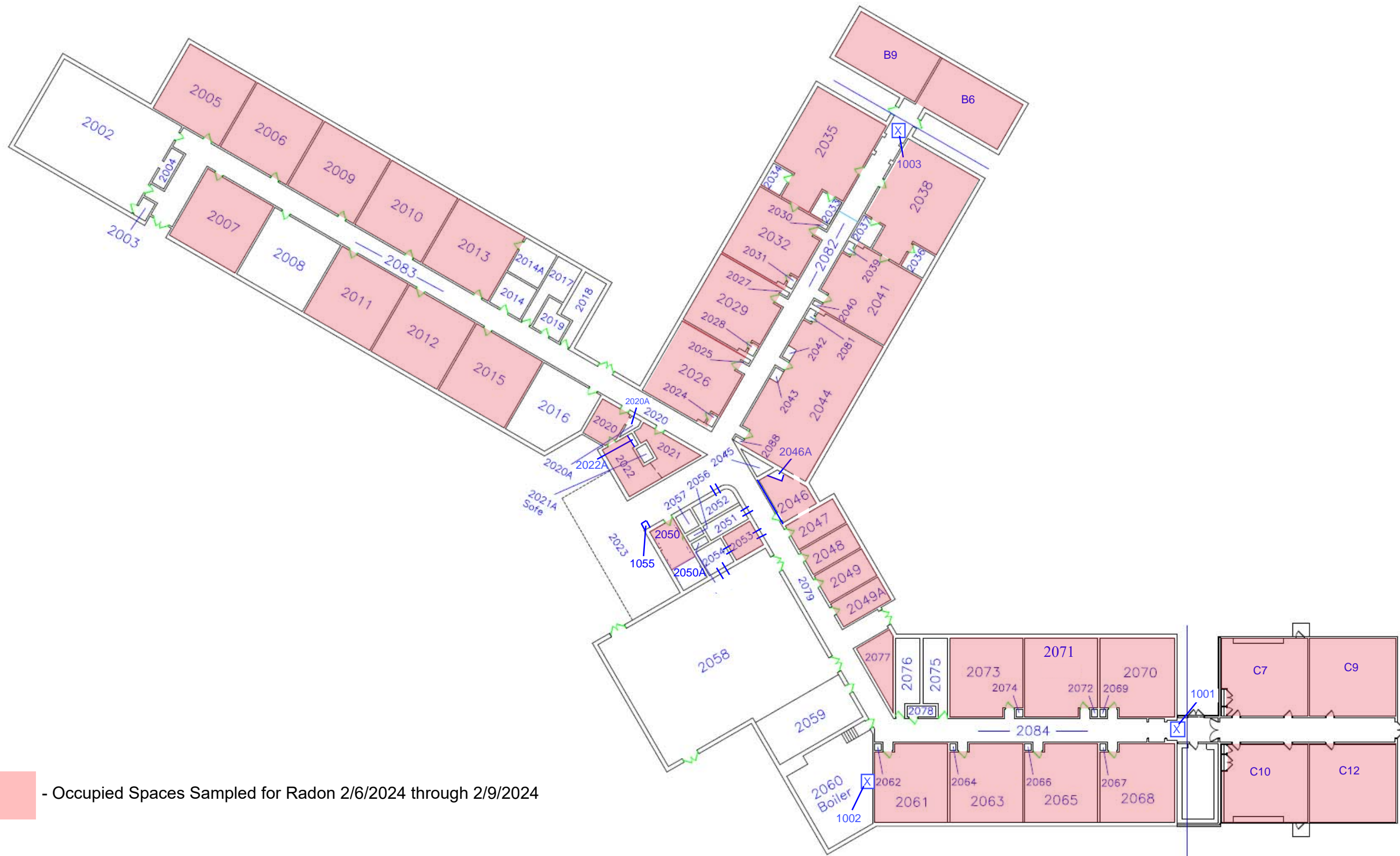

- Occupied Spaces Sampled for Radon 2/6/2024 through 2/9/2024



**J.C. Broderick & Associates**  
 Environmental Consulting & Testing  
 1775 Expressway Dr. North  
 Hauppauge, New York 11788  
 Phone: 631.584.5492 Fax: 631.584.5913

**JCB #: 23-55371**  
**SYOSSET CENTRAL SCHOOL DISTRICT**  
 Baylis Elementary School  
 580 Woodbury Road, Plainview, NY 11803



---

**Attachment #3**  
**Field Photograph Logs**

**Typical Radon Sample**

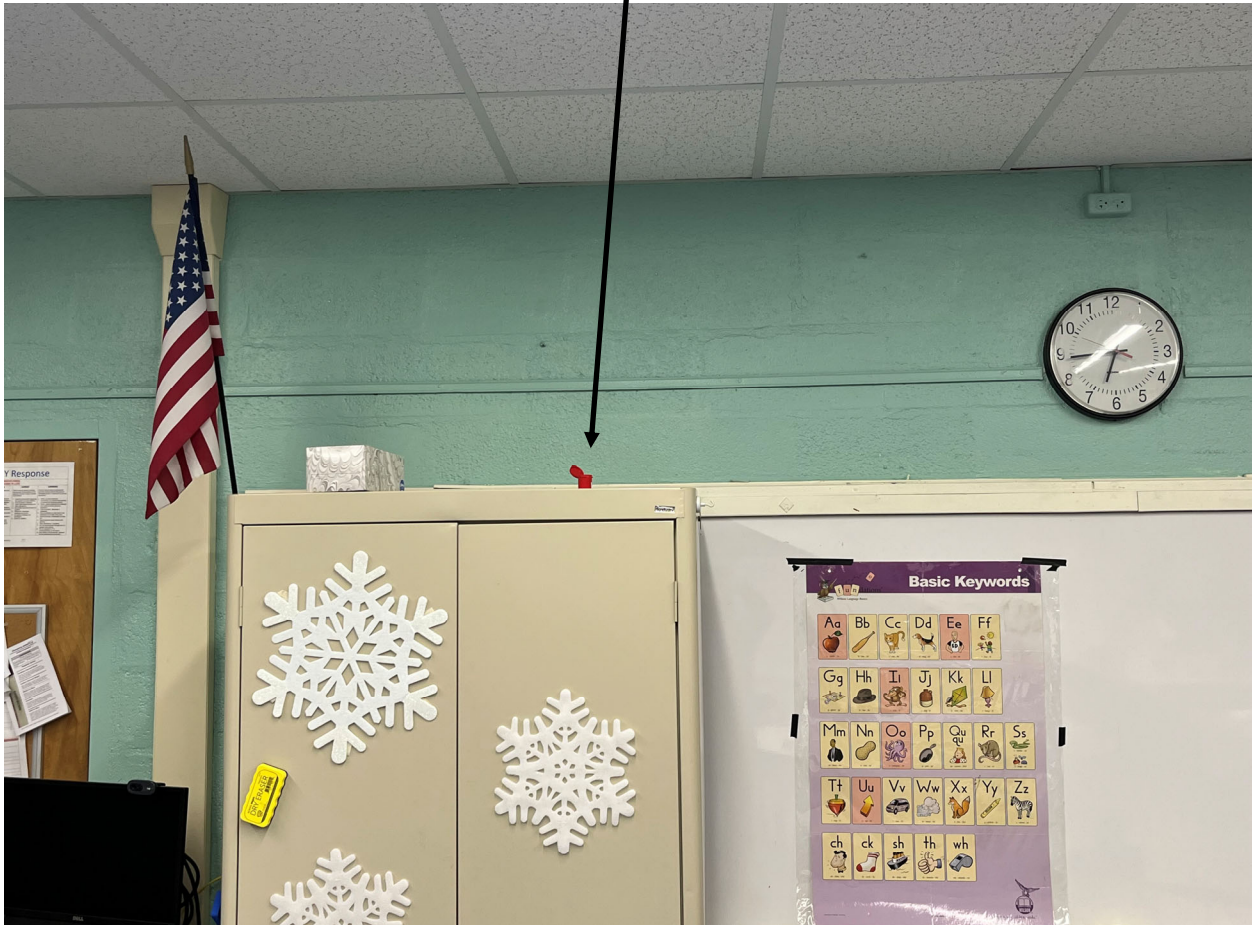

## **Field Photograph Log**

**Indoor Radon Investigation at:**

**Baylis Elementary School  
580 Woodbury Road  
Plainview, New York 11803**

**Photo No. 01**

**JCB#: 23-55371**

**Typical Radon Sample with Blank**

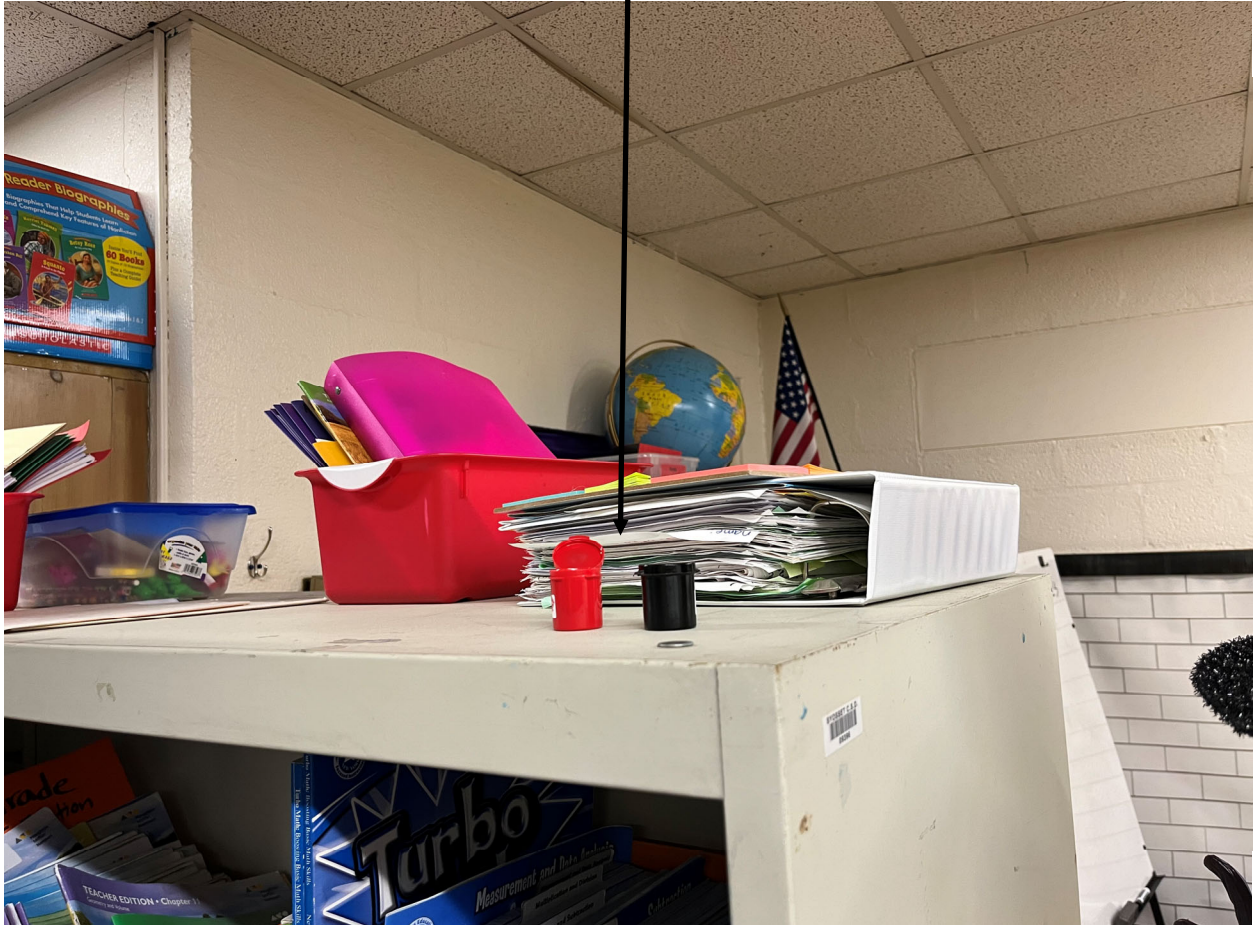

**Field Photograph Log**

**Indoor Radon Investigation at:**

**Baylis Elementary School  
580 Woodbury Road  
Plainview, New York 11803**

**Photo No. 02**

**JCB#: 23-55371**

**Typical Radon Sample with Duplicate**



**Field Photograph Log**

**Indoor Radon Investigation at:**

**Baylis Elementary School  
580 Woodbury Road  
Plainview, New York 11803**

**Photo No. 03**

**JCB#: 23-55371**

---

**Attachment #4**  
**Laboratory Analysis Reports**



# EMSL Analytical, Inc.

200 Route 130 North, Cinnaminson, NJ 08077  
Phone/Fax: (800) 220-3675 / (856) 786-0327  
<http://www.EMSL.com> [cinnaminsonradonlab@emsl.com](mailto:cinnaminsonradonlab@emsl.com)

EMSL Order: 382400759  
CustomerID: JCBR50  
CustomerPO:  
ProjectID:

Attn: **Steven Muller**  
**J.C. Broderick & Associates**  
**1775 Expressway Drive North, Suite 1**  
**Hauppauge, NY 11788**

Phone: (631) 584-5492  
Fax:  
Received: 2/13/2024 11:24 AM  
Analysis Date: 2/15/2024  
Collected: 2/6/2024

Project: **Baylis ES / 23-55371**

Test **Baylis ES**  
Site: **580 Woodbury Rd**  
**Plainview, NY 11803**

## Test Report: Radon in Air Test Results

Liquid Scintillation ID	Location	Radon Activity (pCi/L)	Start	Stop	Temperature F	Humidity %	Sample Type
524683 382400759-0001	2005 - File Cabinet	0.8	2/6/2024 6:34:00 AM	2/9/2024 6:35:00 AM	67	27	Customer
<b>Sample Notes:</b>							
524418 382400759-0002	2005 - File Cabinet	0.5	2/6/2024 6:34:00 AM	2/9/2024 6:35:00 AM	67	27	Duplicate
<b>Sample Notes:</b> Duplicate's Customer Sample:382400759-0001 <span style="float: right;"><b>Duplicate RPD = 46.2%</b></span>							
524434 382400759-0003	2007 - File Cabinet	0.8	2/6/2024 6:35:00 AM	2/9/2024 6:36:00 AM	67	27	Customer
<b>Sample Notes:</b>							
524554 382400759-0004	2006 - Cabinet	0.7	2/6/2024 6:36:00 AM	2/9/2024 6:37:00 AM	67	27	Customer
<b>Sample Notes:</b>							
524584 382400759-0007	2009 - Cabinet	0.6	2/6/2024 6:39:00 AM	2/9/2024 6:40:00 AM	68	26	Customer
<b>Sample Notes:</b>							
524600 382400759-0008	2011 - File Cabinet	0.5	2/6/2024 6:39:00 AM	2/9/2024 6:41:00 AM	68	26	Customer
<b>Sample Notes:</b>							
524489 382400759-0009	2010 - Cabinet	0.3	2/6/2024 6:40:00 AM	2/9/2024 6:42:00 AM	68	26	Customer
<b>Sample Notes:</b>							
524604 382400759-0010	2012 - Bookshelf	0.6	2/6/2024 6:40:00 AM	2/9/2024 6:42:00 AM	68	27	Customer
<b>Sample Notes:</b>							
524401 382400759-0011	2013 - Speaker	0.7	2/6/2024 6:41:00 AM	2/9/2024 6:43:00 AM	68	26	Customer
<b>Sample Notes:</b>							
524473 382400759-0012	2015 - Bookshelf	0.4	2/6/2024 6:42:00 AM	2/9/2024 6:43:00 AM	68	26	Customer
<b>Sample Notes:</b>							



# EMSL Analytical, Inc.

200 Route 130 North, Cinnaminson, NJ 08077

Phone/Fax: (800) 220-3675 / (856) 786-0327

<http://www.EMSL.com>

[cinnaminsonradonlab@emsl.com](mailto:cinnaminsonradonlab@emsl.com)

EMSL Order: 382400759

CustomerID: JCBR50

CustomerPO:

ProjectID:

## Test Report: Radon in Air Test Results

Liquid Scintillation ID	Location	Radon Activity (pCi/L)	Start	Stop	Temperature F	Humidity %	Sample Type
524492 382400759-0013	2020 - Cabinet	0.6	2/6/2024 6:56:00 AM	2/9/2024 6:57:00 AM	74	23	Customer
<b>Sample Notes:</b>							
524512 382400759-0014	2021 - Shelf	0.5	2/6/2024 6:57:00 AM	2/9/2024 6:57:00 AM	75	25	Customer
<b>Sample Notes:</b>							
524379 382400759-0015	2022 - Electrical Box	0.6	2/6/2024 6:57:00 AM	2/9/2024 6:57:00 AM	74	26	Customer
<b>Sample Notes:</b>							
524431 382400759-0016	2026 - Speaker	0.6	2/6/2024 6:47:00 AM	2/9/2024 6:48:00 AM	71	26	Customer
<b>Sample Notes:</b>							
524487 382400759-0017	2026 - Speaker	0.5	2/6/2024 6:47:00 AM	2/9/2024 6:48:00 AM	71	26	Duplicate
<b>Sample Notes:</b> Duplicate's Customer Sample:382400759-0016		<b>Duplicate RPD = 18.2%</b>					
524490 382400759-0018	2029 - Speaker	0.7	2/6/2024 6:48:00 AM	2/9/2024 6:49:00 AM	71	26	Customer
<b>Sample Notes:</b>							
524553 382400759-0019	2029 - Speaker	-0.1	2/6/2024 6:48:00 AM	2/9/2024 6:49:00 AM	71	26	Blank
<b>Sample Notes:</b>							
524400 382400759-0020	2032 - Speaker	0.3	2/6/2024 6:48:00 AM	2/9/2024 6:49:00 AM	72	26	Customer
<b>Sample Notes:</b>							
524469 382400759-0021	2035 - Bookshelf	0.4	2/6/2024 6:49:00 AM	2/9/2024 6:50:00 AM	73	25	Customer
<b>Sample Notes:</b>							
524522 382400759-0022	B6 - Cabinet	0.6	2/6/2024 6:51:00 AM	2/9/2024 6:52:00 AM	68	26	Customer
<b>Sample Notes:</b>							
524328 382400759-0023	B6 - Cabinet	-0.1	2/6/2024 6:51:00 AM	2/9/2024 6:52:00 AM	68	26	Blank
<b>Sample Notes:</b>							
524560 382400759-0024	B9 - Bookshelf	0.2	2/6/2024 6:51:00 AM	2/9/2024 6:53:00 AM	70	27	Customer
<b>Sample Notes:</b>							
524394 382400759-0025	2038 - Bookshelf	0.8	2/6/2024 6:52:00 AM	2/9/2024 6:53:00 AM	72	26	Customer
<b>Sample Notes:</b>							

Please visit [www.radontestinglab.com](http://www.radontestinglab.com)



# EMSL Analytical, Inc.

200 Route 130 North, Cinnaminson, NJ 08077

Phone/Fax: (800) 220-3675 / (856) 786-0327

<http://www.EMSL.com>

[cinnaminsonradonlab@emsl.com](mailto:cinnaminsonradonlab@emsl.com)

EMSL Order: 382400759

CustomerID: JCBR50

CustomerPO:

ProjectID:

## Test Report: Radon in Air Test Results

Liquid Scintillation ID	Location	Radon Activity (pCi/L)	Start	Stop	Temperature F	Humidity %	Sample Type
524486 382400759-0026	2041 - Vending Machine	0.5	2/6/2024 6:53:00 AM	2/9/2024 6:54:00 AM	74	25	Customer
<b>Sample Notes:</b>							
524625 382400759-0027	2044 - Bookshelf	0.4	2/6/2024 6:54:00 AM	2/9/2024 6:55:00 AM	74	22	Customer
<b>Sample Notes:</b>							
521392 382400759-0028	1055 - Cabinet	0.7	2/6/2024 7:05:00 AM	2/9/2024 7:05:00 AM	74	23	Customer
<b>Sample Notes:</b>							
524466 382400759-0029	1055 - Cabinet	0.1	2/6/2024 7:05:00 AM	2/9/2024 7:05:00 AM	74	23	Blank
<b>Sample Notes:</b>							
521385 382400759-0030	2050 - Cabinet	1	2/6/2024 7:06:00 AM	2/9/2024 7:06:00 AM	73	25	Customer
<b>Sample Notes:</b>							
524022 382400759-0031	2053 - Cabinet	0.8	2/6/2024 7:07:00 AM	2/9/2024 7:07:00 AM	74	24	Customer
<b>Sample Notes:</b>							
521379 382400759-0032	2046 - Bookshelf	0.5	2/6/2024 7:08:00 AM	2/9/2024 7:08:00 AM	72	25	Customer
<b>Sample Notes:</b>							
524450 382400759-0033	2047 - TV Stand	0.6	2/6/2024 7:09:00 AM	2/9/2024 7:09:00 AM	72	26	Customer
<b>Sample Notes:</b>							
521618 382400759-0034	2048 - Bookshelf	0.5	2/6/2024 7:09:00 AM	2/9/2024 7:10:00 AM	73	26	Customer
<b>Sample Notes:</b>							
524414 382400759-0035	2049 - Bookshelf	0.1	2/6/2024 7:09:00 AM	2/9/2024 7:10:00 AM	74	25	Customer
<b>Sample Notes:</b>							
521631 382400759-0036	2049A - Bookshelf	0.9	2/6/2024 7:14:00 AM	2/9/2024 7:15:00 AM	74	24	Customer
<b>Sample Notes:</b>							
524317 382400759-0037	2049A - Bookshelf	0.4	2/6/2024 7:14:00 AM	2/9/2024 7:15:00 AM	74	24	Duplicate
<b>Sample Notes:</b> Duplicate's Customer Sample:382400759-0036 Duplicate RPD >67%							
<b>Duplicate RPD = 76.9%</b>							
524583 382400759-0038	2077 - Shelf	0.8	2/6/2024 7:15:00 AM	2/9/2024 7:16:00 AM	74	26	Customer
<b>Sample Notes:</b>							

Please visit [www.radontestinglab.com](http://www.radontestinglab.com)





# EMSL Analytical, Inc.

200 Route 130 North, Cinnaminson, NJ 08077

Phone/Fax: (800) 220-3675 / (856) 786-0327

<http://www.EMSL.com>

[cinnaminsonradonlab@emsl.com](mailto:cinnaminsonradonlab@emsl.com)

EMSL Order: 382400759

CustomerID: JCBR50

CustomerPO:

ProjectID:

## Test Report: Radon in Air Test Results

Liquid Scintillation ID	Location	Radon Activity (pCi/L)	Start	Stop	Temperature F	Humidity %	Sample Type
521075 382400759-0039	2077 - Shelf	0.4	2/6/2024 7:15:00 AM	2/9/2024 7:16:00 AM	74	26	Duplicate
<b>Sample Notes:</b> Duplicate's Customer Sample:382400759-0038							<b>Duplicate RPD = 66.7%</b>
524314 382400759-0040	2061 - Speaker	0.6	2/6/2024 7:15:00 AM	2/9/2024 7:17:00 AM	74	25	Customer
<b>Sample Notes:</b>							
524424 382400759-0041	2063 - Speaker	0.5	2/6/2024 7:16:00 AM	2/9/2024 7:17:00 AM	73	26	Customer
<b>Sample Notes:</b>							
524377 382400759-0042	2065 - Cabinet	0.8	2/6/2024 7:17:00 AM	2/9/2024 7:18:00 AM	74	26	Customer
<b>Sample Notes:</b>							
524322 382400759-0043	2068 - Speaker	0.5	2/6/2024 7:17:00 AM	2/9/2024 7:18:00 AM	74	26	Customer
<b>Sample Notes:</b>							
521952 382400759-0044	C7 - File Cabinet	1	2/6/2024 7:20:00 AM	2/9/2024 7:21:00 AM	71	24	Customer
<b>Sample Notes:</b>							
524432 382400759-0045	C9 - File Cabinet	0.6	2/6/2024 7:20:00 AM	2/9/2024 7:21:00 AM	69	26	Customer
<b>Sample Notes:</b>							
521630 382400759-0046	C10 - Cabinet	1.1	2/6/2024 7:21:00 AM	2/9/2024 7:22:00 AM	74	23	Customer
<b>Sample Notes:</b>							
523230 382400759-0047	C12 - Cabinet	0.5	2/6/2024 7:21:00 AM	2/9/2024 7:23:00 AM	72	23	Customer
<b>Sample Notes:</b>							
524506 382400759-0048	2070 - Cabinet	0.8	2/6/2024 7:24:00 AM	2/9/2024 7:25:00 AM	71	27	Customer
<b>Sample Notes:</b>							
524310 382400759-0049	2071 - Cabinet	0.4	2/6/2024 7:25:00 AM	2/9/2024 7:26:00 AM	72	28	Customer
<b>Sample Notes:</b>							
521953 382400759-0050	2073 - Speaker	0.7	2/6/2024 7:25:00 AM	2/9/2024 7:27:00 AM	73	26	Customer
<b>Sample Notes:</b>							

### Report Notes

Please visit [www.radontestinglab.com](http://www.radontestinglab.com)



# EMSL Analytical, Inc.

200 Route 130 North, Cinnaminson, NJ 08077

Phone/Fax: (800) 220-3675 / (856) 786-0327

<http://www.EMSL.com>

[cinnaminsonradonlab@emsl.com](mailto:cinnaminsonradonlab@emsl.com)

EMSL Order:	382400759
CustomerID:	JCBR50
CustomerPO:	
ProjectID:	

## Test Report: Radon in Air Test Results

Liquid Scintillation ID	Location	Radon Activity (pCi/L)	Start	Stop	Temperature F	Humidity %	Sample Type
-------------------------	----------	------------------------	-------	------	---------------	------------	-------------

The United States Environmental Protection Agency (EPA) has established a radon action level of 4.0pCi/L. EPA recommends mitigation of a structure if the confirmed radon level is equal to or greater than 4.0pCi/L.

The radon tests were performed using liquid scintillation radon detectors and counted on a liquid scintillation counter following EPA Method # 402-R-92-004 testing protocol for Radon in Air testing. EPA recommends retesting every two years.

Please contact EMSL Analytical, Inc. or your State Health Department for further information.

All procedures used for generating this report are in complete accordance with the current EPA protocols for the analysis of Radon in Air.

Analyst(s)

*Jeanel Zoll (48)*

Dominic Gehret, Radiochemistry Laboratory Manager, 10872

In no event shall EMSL be liable for indirect, special, consequential, or incidental damages, including, but not limited to, damages for loss of profit or goodwill regardless of the negligence (either sole or concurrent) of EMSL and whether EMSL has been informed of the possibility of such damages, arising out of or in connection with EMSL's services thereunder or the delivery, use, reliance upon or interpretation of test results by client or any third party. We accept no legal responsibility for the purposes for which the client uses the test results. In no event shall EMSL be liable to a client or any third party, whether based upon theories of tort, contract or any other legal or equitable theory, in excess of the amount paid to EMSL by client thereunder. The test results meets all NELAC requirements unless otherwise specified.

Samples analyzed by EMSL Analytical, Inc. Cinnaminson, NJ FL RB2034/R2687,IL RNL2008202,IN RTL00935,IA RNLAB10005,KS KS-LB-0005/KS-MS-0482,ME SPC202,MN RL-0005,NE 474/RMB-1083,NJ 03036/MEB92525/MES13910,NY 10872,OH RL39,OK D9952,PA 2573/3393/68-00367,RI RMB-108/RI00179,WV RL000220,NRSB-ARL6006,NRPP

Initial report from 02/15/2024 15:25:22



**CHAIN OF CUSTODY  
RADON LABORATORY SERVICES**  
(COMMERCIAL USE)

EMSL ANALYTICAL, INC.  
200 ROUTE 130 NORTH  
CINNAMINSON, NJ 08077  
PHONE: 800-220-3675  
www.emsl.com

EMSL Job #: 382400759

EMSL ANALYTICAL, INC.

**Company Information:**

EMSL Acct #: JCB250

Company Name: JC Broderick & Assoc. Inc.

Contact: Steven Muller

Address: 1775 Express Dr. N.

City: Hempstead

State: NY Zip: 11788

Phone: (631) 584-5492 Fax: (631) 584-3395

Email: smuller@jcbroderick.com

Technician Certification #:

Tech Name: Steven Muller

Tech Signature: [Signature]

**Project/Site Information:** \*Required

Project Name: Baylis ES

Project # / PO: 23-55371

\*Address: 580 Woodbury Road

\*City: Plainview \*State: NY \*Zip: 11803

\*Building type?  Residential  Non-Residential  
 School  Other: \_\_\_\_\_

\*Building foundation type?  Basement  Crawlspace  
 Slab on Grade  Other: \_\_\_\_\_

Special Notes / Instructions:  
48 samples

\*Turnaround Time (TAT) Options

1 Day  2 Day  3 Day  4 Day

Disclaimer: In no event shall EMSL be liable for indirect, special, consequential, or incidental damages for loss of profit or goodwill regardless of the negligence (either sole or concurrent) of EMSL and whether EMSL has been informed of the possibility of such damages arising out of or in connection with EMSL's services there under or the delivery, use, reliance upon or interpretation of test results by client or third party. We accept no legal responsibility for the purposes for which the client uses the test results. In no event shall EMSL be liable to a client or any third party, whether based upon theories of tort, contract or any other legal or equitable theory, in excess of the amount paid to EMSL by client thereafter.

(S) Sample (B) Blank (D) Duplicate	Device Number	Location	Room #	Exposure Period Beginning Date		Exposure Period Ending Date		Temp. of	Humidity, %
				Date	Time	Date	Time		
(S) Sample	524683	File cabinet	2005	2/6/24	6:34 A	2/9/24	6:35 A	67.1	27.2
D	524418	File cabinet	2007	2/6/24	6:35 A	2/9/24	6:36 A	66.9	27.2
S	524434	File cabinet	2007	2/6/24	6:35 A	2/9/24	6:36 A	66.9	27.2
S	524554	cabinet	2006	2/6/24	6:36 A	2/9/24	6:37 A	67.2	27.2
S	524685	cabinet	2008	2/6/24	6:37 A	2/9/24	NOT RETRIEVED		
B	524644	cabinet	2009	2/6/24	6:39 A	2/9/24	6:40 A	67.6	26.2
S	524584	cabinet	2009	2/6/24	6:39 A	2/9/24	6:40 A	67.6	26.2
S	524600	File cabinet	2011	2/6/24	6:39 A	2/9/24	6:41 A	68.0	26.3
S	524489	cabinet	2010	2/6/24	6:40 A	2/9/24	6:42 A	67.8	26.3

Relinquished by (Sign): [Signature] Date: 2/9/24 Time: 4:06 PM

Received by EMSL (Sign): [Signature] Date: 2/13/24 Time: 11:24 AM

Page 1 of 8



**CHAIN OF CUSTODY  
RADON LABORATORY SERVICES  
(COMMERCIAL USE)**

EMSL ANALYTICAL, INC.  
200 ROUTE 130 NORTH  
CINNAMINSON, NJ 08077  
PHONE: 800-220-3675  
www.emsl.com

EMSL Job #: \_\_\_\_\_

EMSL ANALYTICAL, INC.

(S) Sample (B) Blank (D) Duplicate	Device Number	Location	Room #	Exposure Period Beginning Date		Exposure Period Ending Date		Temp, °F	Humidity, %
				Date	Time	Date	Time		
				S	524604	Bookshelf	2012		
S	524401	Speaker	2013	2/6/24	6:41 A	2/9/24	6:43 A	68.1	26.3
S	524473	Bookshelf	2015	2/6/24	6:42 A	2/9/24	6:43 A	68.3	26.3
S	524492	Cabinet	2020	2/6/24	6:56 A	2/9/24	6:57 A	73.7	22.6
S	524512	Shelf	2021	2/6/24	6:57 A	2/9/24	6:57 A	75.2	25.0
S	524379	Electrical Box	2022	2/6/24	6:57 A	2/9/24	6:57 A	73.9	25.6
S	524431	Speaker	2026	2/6/24	6:47 A	2/9/24	6:48 A	71.2	25.5
D	524487	Speaker	2026	2/6/24	6:47 A	2/9/24	6:48 A	71.2	25.5
S	524490	Speaker	2029	2/6/24	6:48 A	2/9/24	6:49 A	71.1	25.5
B	524553	Speaker	2029	2/6/24	6:48 A	2/9/24	6:49 A	71.1	25.5
S	524400	Speaker	2032	2/6/24	6:48 A	2/9/24	6:49 A	72.3	25.5
S	524469	Bookshelf	2035	2/6/24	6:49 A	2/9/24	6:50 A	73.0	24.6
S	524522	Cabinet	B6	2/6/24	6:51 A	2/9/24	6:52 A	68.3	26.3
B	524 <del>469</del> 328	Cabinet	B6	2/6/24	6:51 A	2/9/24	6:52 A	68.3	26.3
S	524560	Bookshelf	B9	2/6/24	6:51 A	2/9/24	6:53 A	69.8	27.0
S	524394	Bookshelf	2038	2/6/24	6:52 A	2/9/24	6:53 A	71.7	25.5
S	524486	Vending Machine	2041	2/6/24	6:53 A	2/9/24	6:54 A	73.9	24.6
S	524625	Bookshelf	2044	2/6/24	6:54 A	2/9/24	6:55 A	73.9	21.6
S	521392	Cabinet	1055	2/6/24	7:05 A	2/9/24	7:05 A	74.1	22.7
B	524466	Cabinet	1055	2/6/24	7:05 A	2/9/24	7:05 A	74.1	22.7

Relinquished by (Sign): \_\_\_\_\_ Date: \_\_\_\_\_ Time: \_\_\_\_\_  
 Received by EMSL (Sign): Ernie Salato Date: 2/9/24 Time: 4:06 PM Page of 7



**CHAIN OF CUSTODY  
RADON LABORATORY SERVICES**  
(COMMERCIAL USE)

EMSL ANALYTICAL, INC.  
200 ROUTE 130 NORTH  
CINNAMINSON, NJ 08077  
PHONE: 800-220-3675  
www.emsl.com

EMSL Job #: 382400759

EMSL ANALYTICAL, INC.

(S) Sample (B) Blank (D) Duplicate	Device Number	2024 Location	Room #	Exposure Period Beginning Date		Exposure Period Ending Date		Temp, °F	Humidity, %
				Date	Time	Date	Time		
S	521385	Cabinet	2050	2/6/24	7:06 <sub>A</sub>	2/9/24	7:06 <sub>A</sub>	73.4	24.6
S	524022	Cabinet	2053	2/6/24	7:07 <sub>A</sub>	2/9/24	7:07 <sub>A</sub>	74.3	24.0
S	521379	Bookshelf	2046	2/6/24	7:08 <sub>A</sub>	2/9/24	7:08 <sub>A</sub>	71.9	24.8
S	52450	TU stand	2047	2/6/24	7:09 <sub>A</sub>	2/9/24	7:09 <sub>A</sub>	71.9	25.5
S	521618	Bookshelf	2048	2/6/24	7:09 <sub>A</sub>	2/9/24	7:10 <sub>A</sub>	73.4	25.9
S	524414	Bookshelf	2049	2/6/24	7:09 <sub>A</sub>	2/9/24	7:10 <sub>A</sub>	73.9	25.4
S	521631	Bookshelf	2049A	2/6/24	7:14 <sub>A</sub>	2/9/24	7:15 <sub>A</sub>	73.9	23.6
D	524312								
S	524583	Shelf	2077	2/6/24	7:15 <sub>A</sub>	2/9/24	7:16 <sub>A</sub>	74.1	25.7
D	521075								
S	524314	Speaker	2061	2/6/24	7:15 <sub>A</sub>	2/9/24	7:17 <sub>A</sub>	73.9	24.6
S	524424	Speaker	2063	2/6/24	7:16 <sub>A</sub>	2/9/24	7:17 <sub>A</sub>	73.9	25.6
S	524377	Cabinet	2065	2/6/24	7:17 <sub>A</sub>	2/9/24	7:18 <sub>A</sub>	73.9	25.6
S	524322	Speaker	2068	2/6/24	7:17 <sub>A</sub>	2/9/24	7:18 <sub>A</sub>	73.9	25.6
S	521952	File Cabinet	C7	2/6/24	7:20 <sub>A</sub>	2/9/24	7:21 <sub>A</sub>	71.2	23.5
S	524432	File Cabinet	C9	2/6/24	7:20 <sub>A</sub>	2/9/24	7:21 <sub>A</sub>	69.2	26.3
S	521630	Cabinet	C10	2/6/24	7:21 <sub>A</sub>	2/9/24	7:22 <sub>A</sub>	74.1	22.6
S	523230	Cabinet	C12	2/6/24	7:21 <sub>A</sub>	2/9/24	7:23 <sub>A</sub>	71.9	22.5

RECEIVED  
EMSL ANALYTICAL, INC.  
CINNAMINSON, NJ  
2024 FEB - 9 12 PM

Relinquished by (Sign):

Date:

Time:

Received by EMSL (Sign): Core Gulek

Date: 2/9/24

Time: 4:06 PM

Page of 4



**CHAIN OF CUSTODY  
RADON LABORATORY SERVICES**  
(COMMERCIAL USE)

EMSL ANALYTICAL, INC.  
200 ROUTE 130 NORTH  
CINNAMINSON, NJ 08077  
PHONE: 800-220-3675  
www.emsl.com

EMSL Job #: 382400759

EMSL ANALYTICAL, INC.

(S) Sample (B) Blank (D) Duplicate	Device Number	Location	Room #	Exposure Period Beginning Date		Exposure Period Ending Date		Temp, °F	Humidity, %
				Date	Time	Date	Time		
S	524506	Cabinet	2070	2/6/24	7:24 <sub>A</sub>	2/9/24	7:25 <sub>A</sub>	71.2	26.5
S	524310	Cabinet	2071	2/6/24	7:25 <sub>A</sub>	2/9/24	7:26 <sub>A</sub>	72.3	27.6
S	521953	Speaker	2073	2/6/24	7:25 <sub>A</sub>	2/9/24	7:27 <sub>A</sub>	73.0	25.6

RECEIVED  
EMSL  
CINNAMINSON, N.J.  
2024 FEB 13 AM 11:24

RECEIVED  
EMSL ANALYTICAL, INC.  
CARLE PLACE, NY  
2024 FEB - 9 P 4: 06

Relinquished by (Sign): [Signature] Date: 2/9/24 Time: \_\_\_\_\_  
 Received by EMSL (Sign): [Signature] Date: 2/9/24 Time: 4:06 PM