



**DANVILLE AREA SCHOOL DISTRICT**

# **FEASIBILITY STUDY**

**CONSTRUCTION OPTIONS**

COMMITTEE OF THE WHOLE MEETING • DECEMBER 4TH, 2024

**ALLOY5**

# INTRODUCTION

# 01



Randy Galiotto | **AIA**  
ALLOY5, PRINCIPAL



Jamie Bortz  
ALLOY5, SENIOR PROJECT MANAGER



Nick Rubino  
ALLOY5, ARCHITECTURAL DESIGNER

# FEASIBILITY STUDY

## 02

1

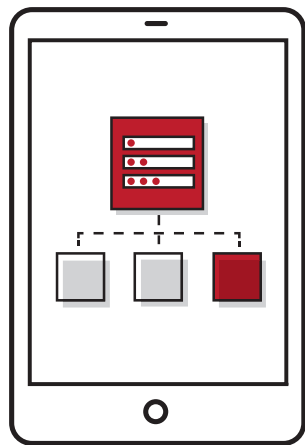

**DATA COLLECTION,  
ANALYSIS, & EVALUATION**

2

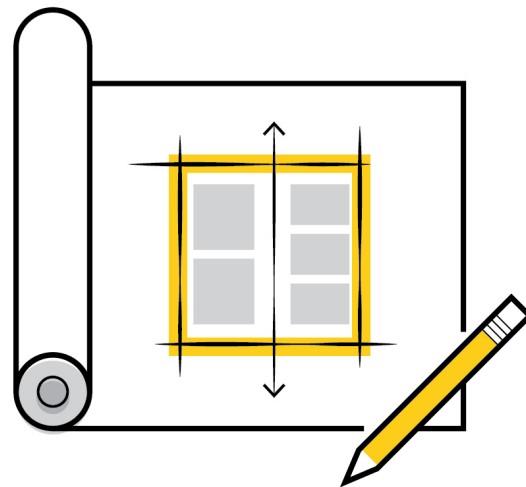

**BUILDING EVALUATIONS**

3

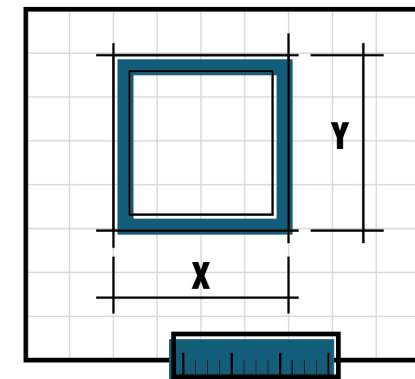

**CONCEPT DESIGN PHASE**

# WORK PLAN TIMELINE

## 03

PROJECT TIMELINE: 5 MONTHS FROM START (JULY 18 2024 - DECEMBER 18 2024)

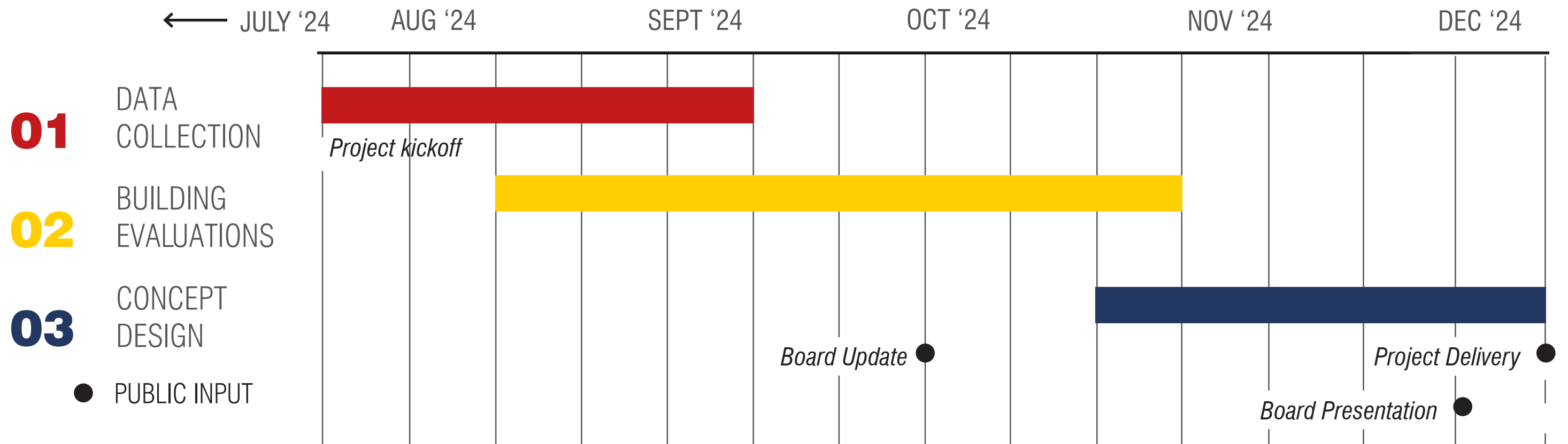

# 18,136

POPULATION

# \$72,626

MEDIAN HOUSEHOLD INCOME

# 58.3%

LABOR PARTICIPATION  
RATE

# 8,083

TOTAL HOUSING UNITS

# 7,633

TOTAL HOUSEHOLDS

# COMMUNITY MONTGOMERY COUNTY



# 2,105

STUDENT ENROLLMENT

# 184

FULL-TIME FACULTY  
AND STAFF

# 13:1

STUDENT TEACHER  
RATIO

# 93.4%

TEACHERS WITH 3 OR MORE  
YEARS EXPERIENCE

# 43

STUDENTS ENROLLED IN  
CYBER SCHOOLS

# 388

STUDENTS ENROLLED IN  
NON-PUBLIC SCHOOLS OR  
HOMESCHOOL

# 97%

GRADUATION RATE

# DANVILLE AREA SCHOOL DISTRICT



# 26,000

EMPLOYEES IN PA

# 17,000

PHYSICIANS IN PA

# 200

NEW JOBS IN 2024  
IN DANVILLE AREA

# 57%

PERCENTAGE OF ADULTS  
AGED 18-64

# 45.2%

PERCENT OF PEOPLE  
EMPLOYED IN HEALTHCARE  
SECTOR

# GEISINGER HEALTH



# DISTRICT ENROLLMENT PROJECTIONS

## 2025-2033

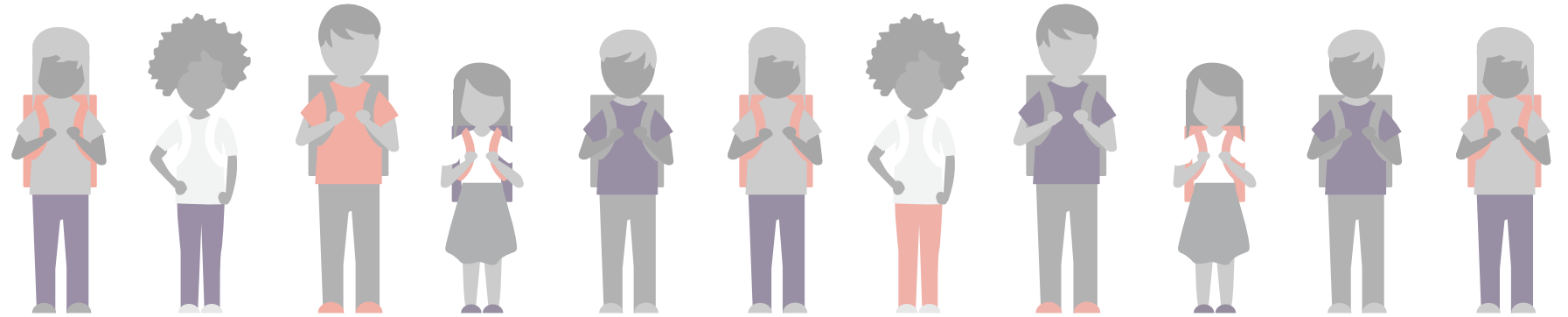

### DISTRICT WIDE

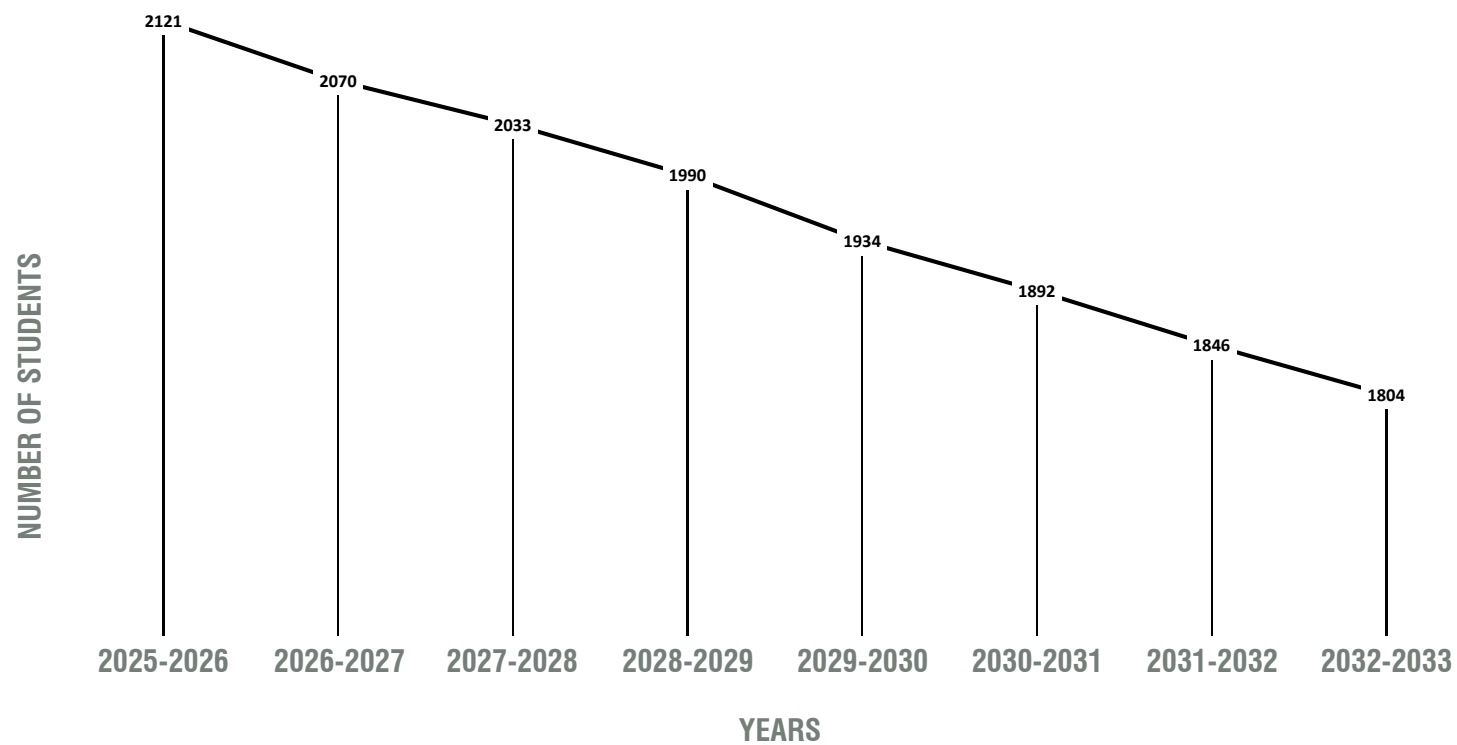

### PER BUILDING

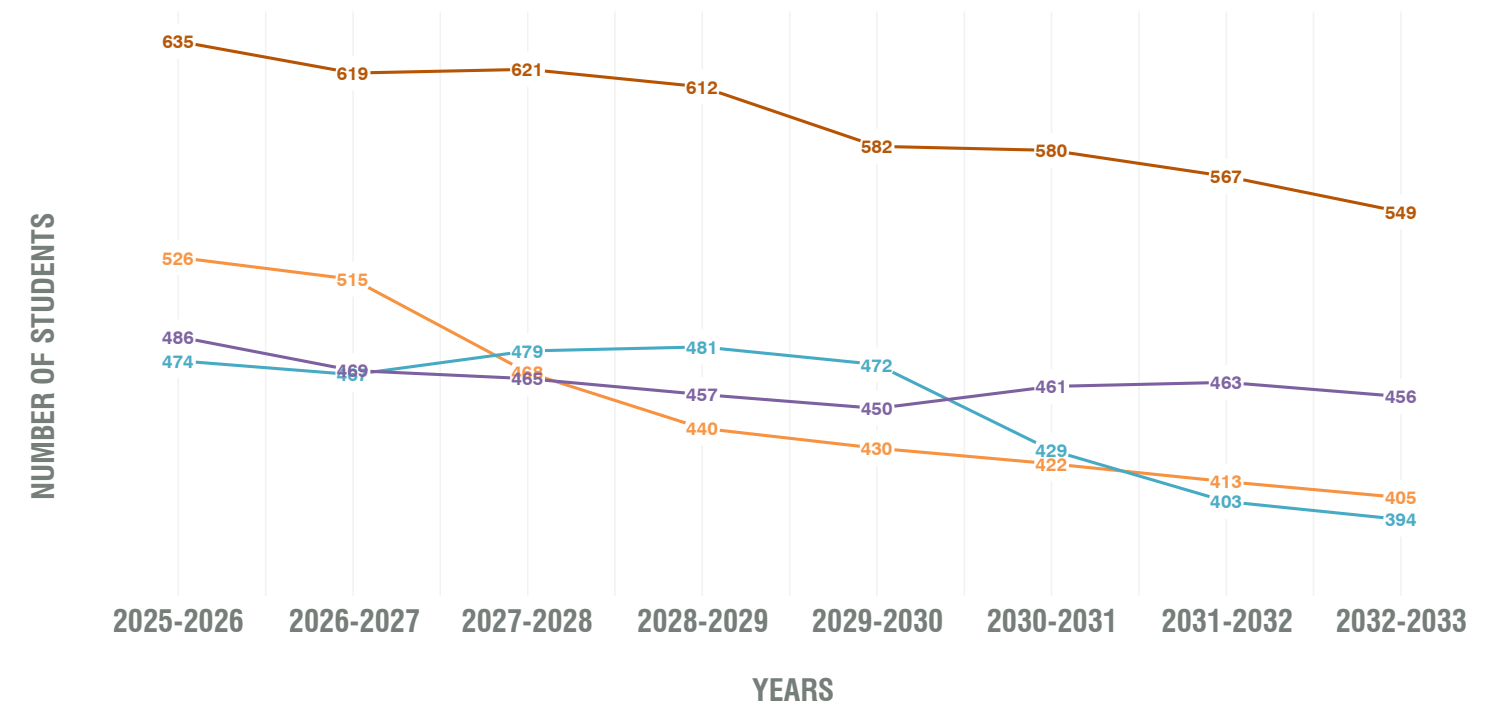

\*ENROLLMENT PROJECTIONS FROM PENNSYLVANIA DEPARTMENT OF EDUCATION

High School Middle School Intermediate School Primary School



**CLASSROOM CAPACITY: 25 STUDENTS**

## RECOMMENDED SCHOOL CAPACITY

# 85%

**TARGET CAPACITY:** 85% of functional capacity (25 students per classroom)

- ✓ Leaves room for growth and unexpected bubble years
- ✓ Provides flexibility

# DISTRICT MASTER PLAN

## PHASES

1

STEP 1

**NEW OUTDOOR  
FIELDS COMPLEX**

2

STEP 2

**DISTRICT BUILDING  
PROJECT OPTIONS**

STEP 1

1

# NEW OUTDOOR FIELDS COMPLEX

- ☒ PROVIDES NEW DRY SPORTS FIELDS
- ☒ ALLOWS FOR GROWTH OF PROGRAMS
- ☒ PROVIDES OPEN SPACE FOR DISTRICT BUILDING EXPANSION OPTIONS

# 1 EXISTING CAMPUS

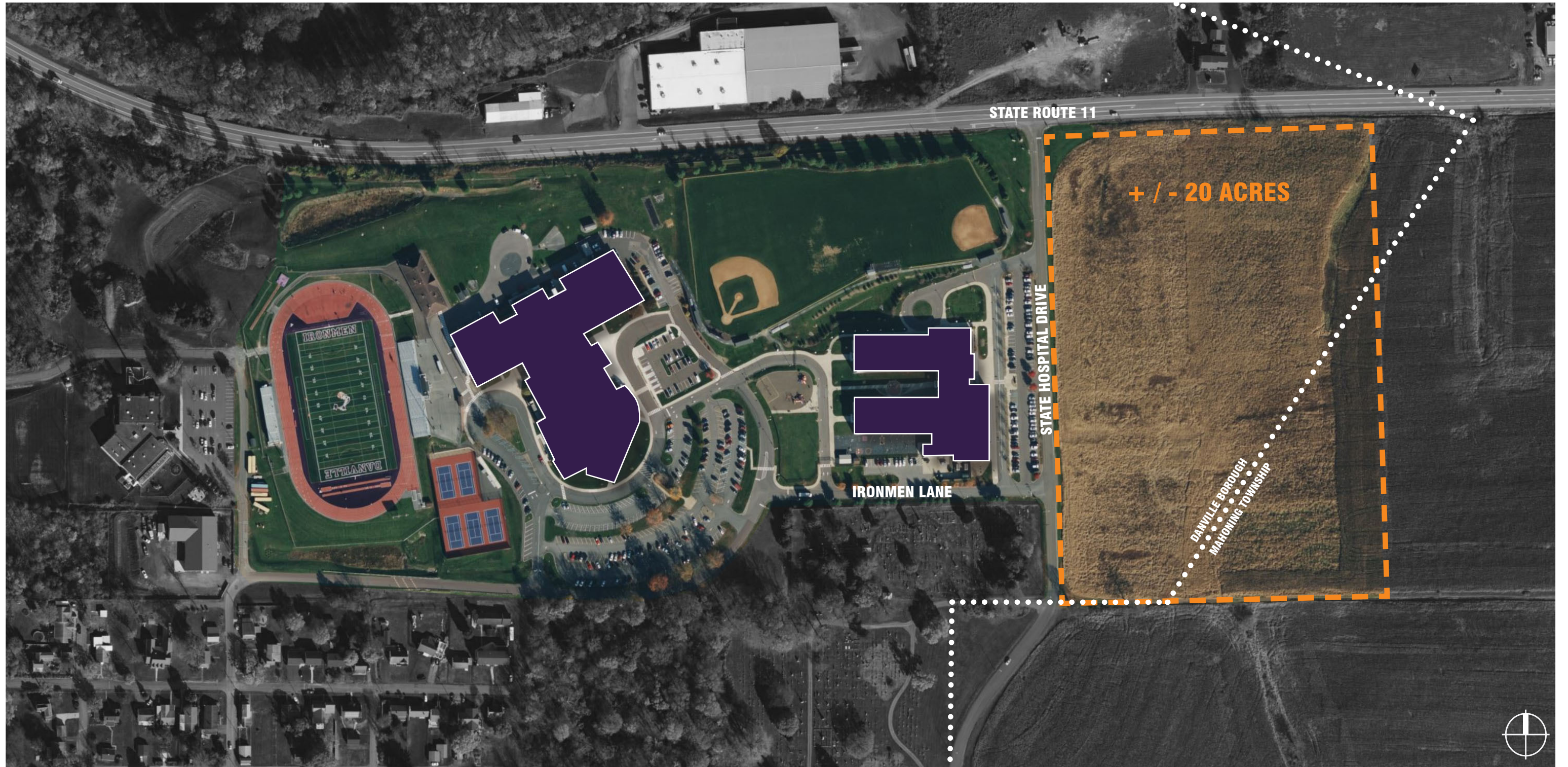

# 1 NEW OUTDOOR MULTIPURPOSE FIELDS COMPLEX

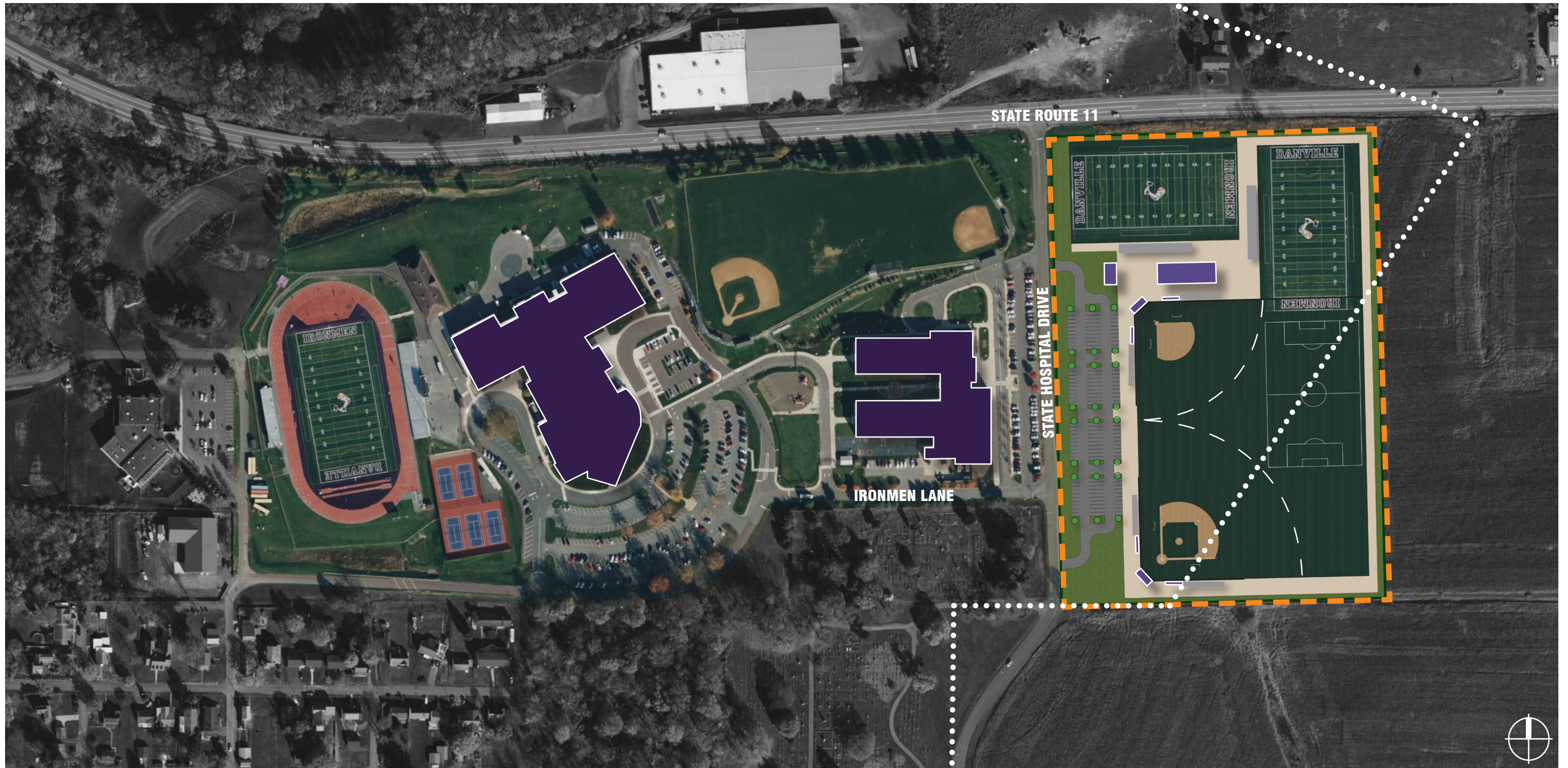

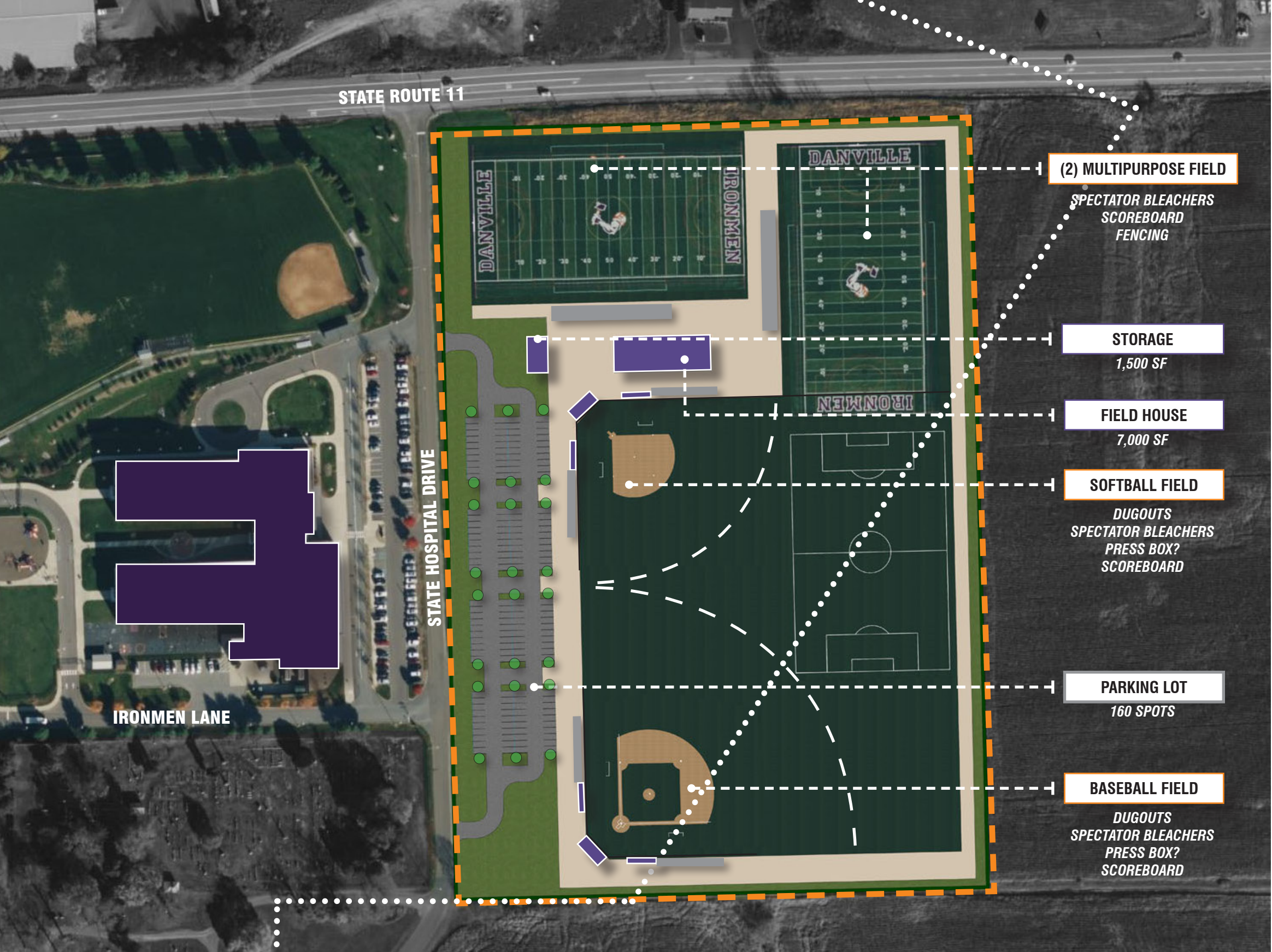

1

NEW OUTDOOR MULTIPURPOSE FIELDS COMPLEX

TURF PRACTICE FIELDS	\$10.1m - \$10.7m probable cost
FIELD HOUSE	\$2m - \$2.6m probable cost
SITE WORK	\$2.9m - \$3.4m probable cost
<b>TOTAL ESTIMATED CONSTRUCTION COST</b>	<b>\$15.1m - \$16.7m probable cost</b>
SOFT COSTS (15%)	\$2.2m - \$2.5m probable cost
<b>TOTAL ESTIMATED PROJECT COST</b>	<b>\$17.3m - \$19.2m probable</b>
*ADD - STADIUM TURF REPLACEMENT	\$3.6m - \$4m probable cost

# DISTRICT MASTER PLAN

## PROJECT OPTIONS

**A**

**INFASTRUCTURE IMPROVEMENTS - BASIC UPGRADES**

**B**

**INFASTRUCTURE IMPROVEMENTS +  
DANVILLE MIDDLE SCHOOL RENOVATION**

**C**

**DANVILLE HIGH SCHOOL - 7-8 HIGH SCHOOL ADDITION**

**D**

**PRIMARY CAMPUS + SECONDARY CAMPUS**

**E**

**DANVILLE AREA SCHOOL DISTRICT COMMON CAMPUS**

# A DANVILLE PRIMARY SCHOOL

## SCOPE OF WORK - FULL



- Upgrade Controls
- Upgrade Central Plant



**\$1.1M - \$1.2M TOTAL**

**SOFT COSTS 25% - \$333,000 - \$382,500 TOTAL**

**COST OF FULL SCOPE OF WORK - \$1.6 - \$1.9M TOTAL**

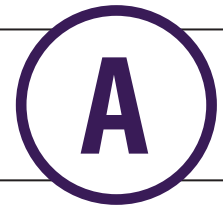

# LIBERTY VALLEY INTERMEDIATE SCHOOL

## SCOPE OF WORK - INFRASTRUCTURE UPGRADES



- Replace Casework
- Replace Doors
- Replace Control Joints / Window Sealants
- Replace Hot Water Heaters
- Upgrade Water Distribution System
- Replace Folding Partition in Multipurpose Room
- Replace PA/clock system
- Replace TPO roofs
- ADA / Code Compliance upgrades for Bathrooms

**\$2.9M - \$3.4M TOTAL**

**SOFT COSTS 25% - \$725,000 - \$850,000 TOTAL**

**COST OF FULL SCOPE OF WORK - \$3.6M - \$4.2M TOTAL**

# A DANVILLE MIDDLE SCHOOL

## SCOPE OF WORK - INFRASTRUCTURE UPGRADES

- Replace Ceilings
- Paint Refresh for Entire Building
- Central Plant Replacement
- Upgrade Voice Notification Fire Alarm System
- Replace Hot Water Heaters
- Replace Control Joints / Window Sealants
- Repair Exterior Masonry and EFIS
- Replace TPO Roofs
- Upgrade Lighting to LED
- Upgrade HVAC Controls
- Upgrade Water Distribution System
- Central Plant Replacement
- Building Renovation for Secure Vestibule at Main Entrance
- ADA / Code Compliance Building Wide
- Replace Exterior Doors

**\$8.4M - \$10.3M TOTAL**

**SOFT COSTS 25% - \$2.1M - \$2.5 TOTAL**

**COST OF FULL SCOPE OF WORK - \$10.5M - \$12.8M TOTAL**

# A DANVILLE HIGH SCHOOL

## SCOPE OF WORK - INFRASTRUCTURE UPGRADES

- 
- Replace Casework
  - Replace Interior and Exterior Doors
  - Upgrade Kitchen Equipment
  - Replace Control Joints / Window Sealants
  - Repair Exterior Masonry and EFIS
  - Replace Hot Water Heaters
  - Upgrade Voice Notification Fire Alarm System
  - Replace Switch Gear
  - Replace TPO Roofs
  - Upgrade all Lighting to LED

**\$8.3 - \$9.9 M TOTAL**

- ADA / Code Compliance upgrades for Bathrooms
- ADA / Code Compliance upgrades for Railings

**SOFT COSTS 25% - \$2M - \$2.4 TOTAL**

**COST OF FULL SCOPE OF WORK - \$10.3M - \$12.3M TOTAL**

A

INFASTRUCTURE IMPROVEMENTS - BASIC

DANVILLE PRIMARY SCHOOL	\$1.6m - \$1.9m probable cost
LIBERTY VALLEY INTERMEDIATE SCHOOL	\$3.6m - \$4.2m probable cost
DANVILLE MIDDLE SCHOOL	\$10.5m - \$12.8m probable cost
DANVILLE HIGH SCHOOL	\$10.3m - \$12.3m probable cost
TOTAL	\$26m - \$31.2m probable cost
2+ YEARS INFLATION 4% PER YEAR	\$2m - \$1.2m added cost

# B DANVILLE MIDDLE SCHOOL - RENOVATIONS

## SCOPE OF WORK - INFRASTRUCTURE UPGRADES + SCOPE OF WORK - BUILDING RENOVATIONS

- Replace Ceilings
- Paint Refresh for Entire Building
- Central Plant Replacement
- Upgrade Voice Notification Fire Alarm System
- Replace Hot Water Heaters

- Replace Control Joints / Window Sealants
- Repair Exterior Masonry and EFIS
- Replace TPO Roofs
- Upgrade Lighting to LED
- Upgrade HVAC Controls
- Upgrade Water Distribution System
- Central Plant Replacement

- Building Renovation for Secure Vestibule at Main Entrance
- ADA / Code Compliance Building Wide
- Replace Exterior Doors

**\$4.7M - \$5.5M TOTAL**

### COMPLETE BUILDING RENOVATION

- New Secure Vestibule at Main Entrance
- New Finishes Building Wide
- Right - Size Classrooms
- Fix Door Clearances
- Upgrade Tech Lab and Science Lab Spaces
- Upgrade Auditorium
- Building Wide Sprinkler System
- Revise and Repave Parking Lots
- Turf Practice Field
- Repair Tennis Courts

**\$28.5M - \$32.6M TOTAL**

**SOFT COSTS 25% - \$8.3M - \$9.5M TOTAL**

**COST OF FULL SCOPE OF WORK - \$41.6M - \$47.7M TOTAL**

# B DANVILLE MIDDLE SCHOOL

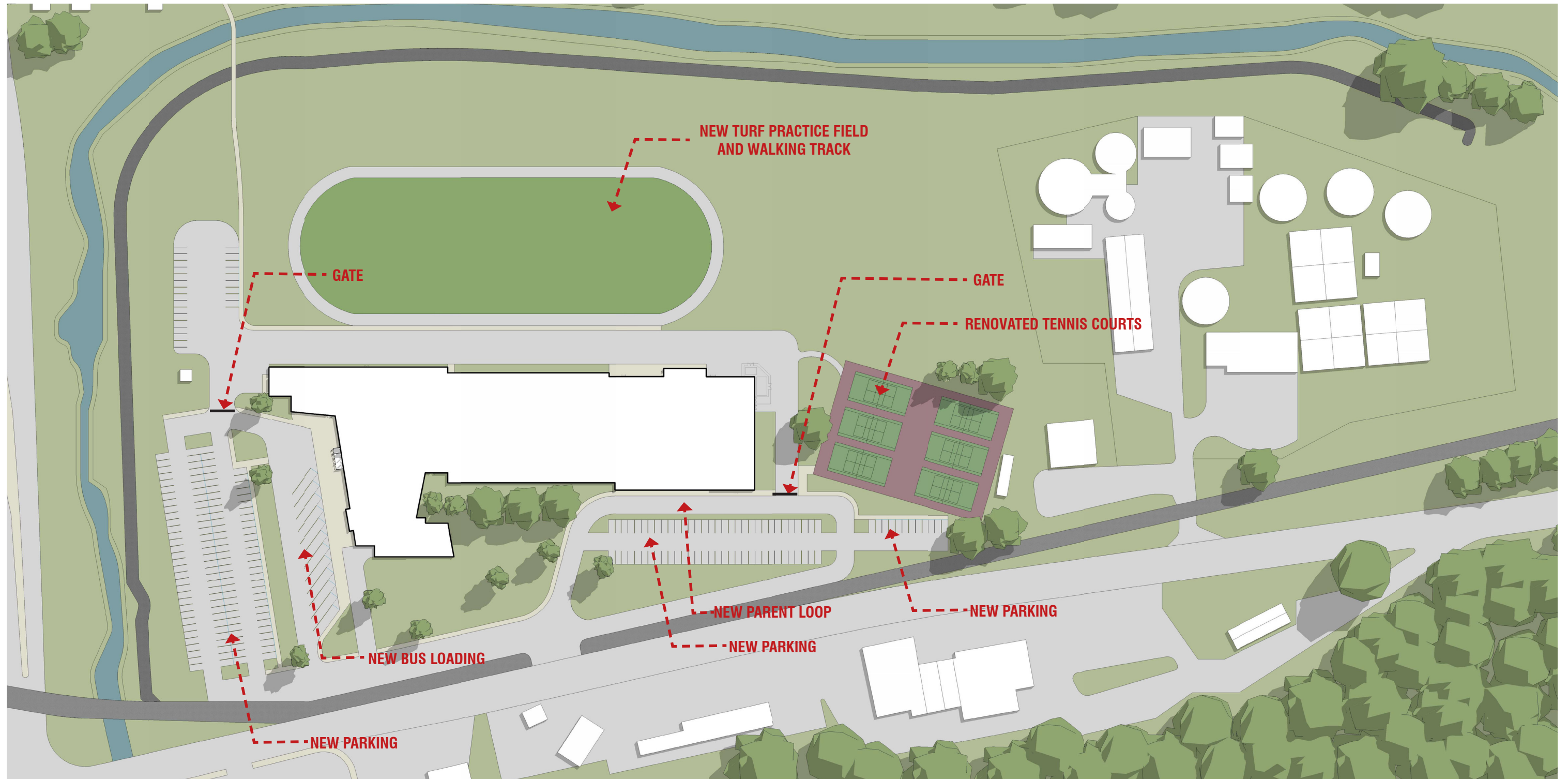

B

INFASTRUCTURE IMPROVEMENTS + MIDDLE SCHOOL RENOVATION

DANVILLE PRIMARY SCHOOL	\$1.6m - \$1.9m probable cost
LIBERTY VALLEY INTERMEDIATE SCHOOL	\$3.6m - \$4.2m probable cost
<b>DANVILLE MIDDLE SCHOOL RENOVATION</b>	<b>\$41.6m - \$47.7m probable cost</b>
DANVILLE HIGH SCHOOL	\$10.3m - \$12.3m probable cost
<b>TOTAL</b>	<b>\$57.1m - \$66.1m probable cost</b>
2+ YEARS INFLATION 4% PER YEAR	\$4.4m - \$5.2m added cost

# C CURRENT GRADE ALIGNMENT

District  
Office

## HS-2

*487 students  
850 capacity*

**PRIMARY SCHOOL**

**58% CAPACITY**

*\*enrollment does not include Head Start*

## 3-5

*495 students  
600 capacity*

**LIBERTY VALLEY**

**83% CAPACITY**

## 6-8

*513 students  
600 capacity*

**MIDDLE SCHOOL**

**86% CAPACITY**

## 9-12

*610 students  
850 capacity*

**HIGH SCHOOL**

**71% CAPACITY**

# C GRADE REALIGNMENT - 7-8 HIGH SCHOOL ADDITION

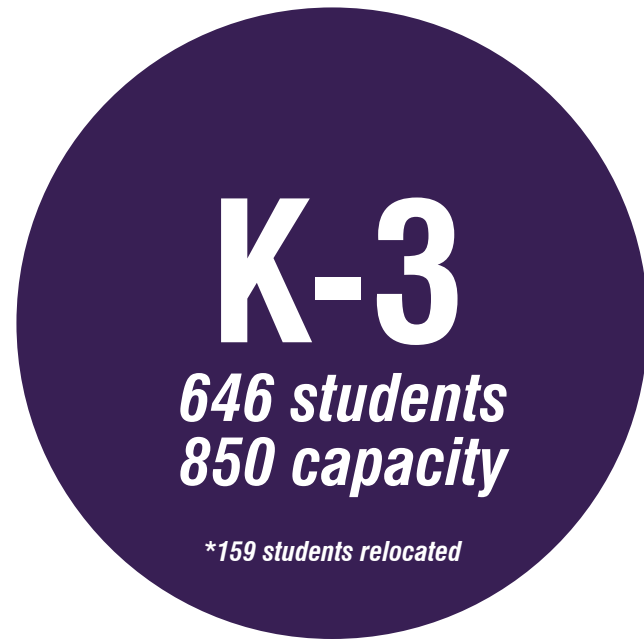

## PRIMARY SCHOOL

**77% CAPACITY**

*\*Head Start program relocated*

**REALIGNED**



## LIBERTY VALLEY

**83% CAPACITY**

**REALIGNED**

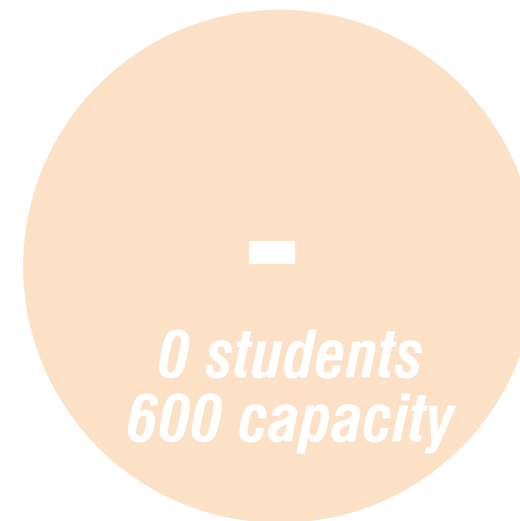

## MIDDLE SCHOOL

**0% CAPACITY**



## HIGH SCHOOL

**76% CAPACITY**

**REALIGNED**

**ADDITION**

# C DANVILLE HIGH SCHOOL : 7-8 ADDITION + RENOVATION

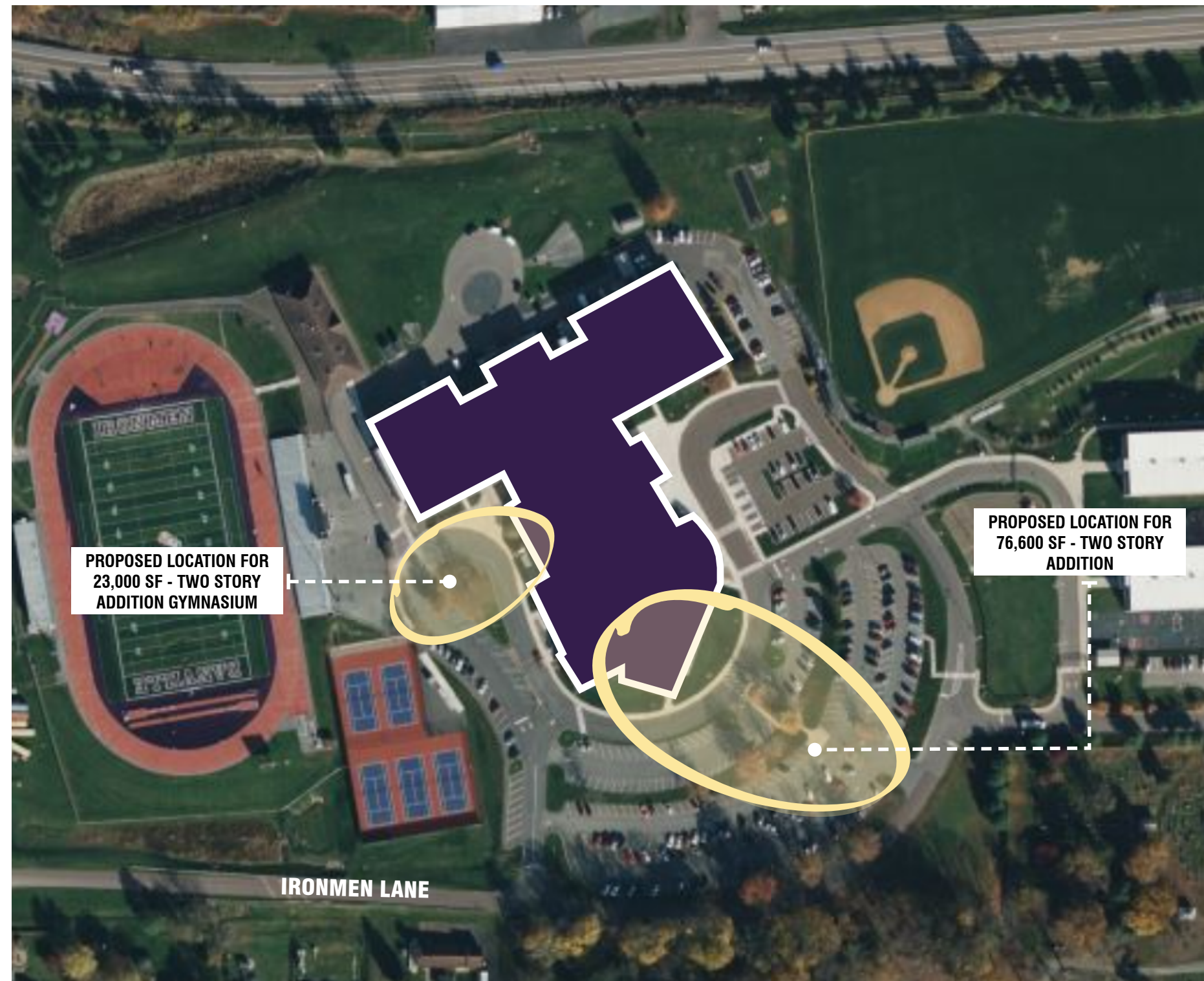

# C DANVILLE HIGH SCHOOL : 7-8 ADDITION + RENOVATION

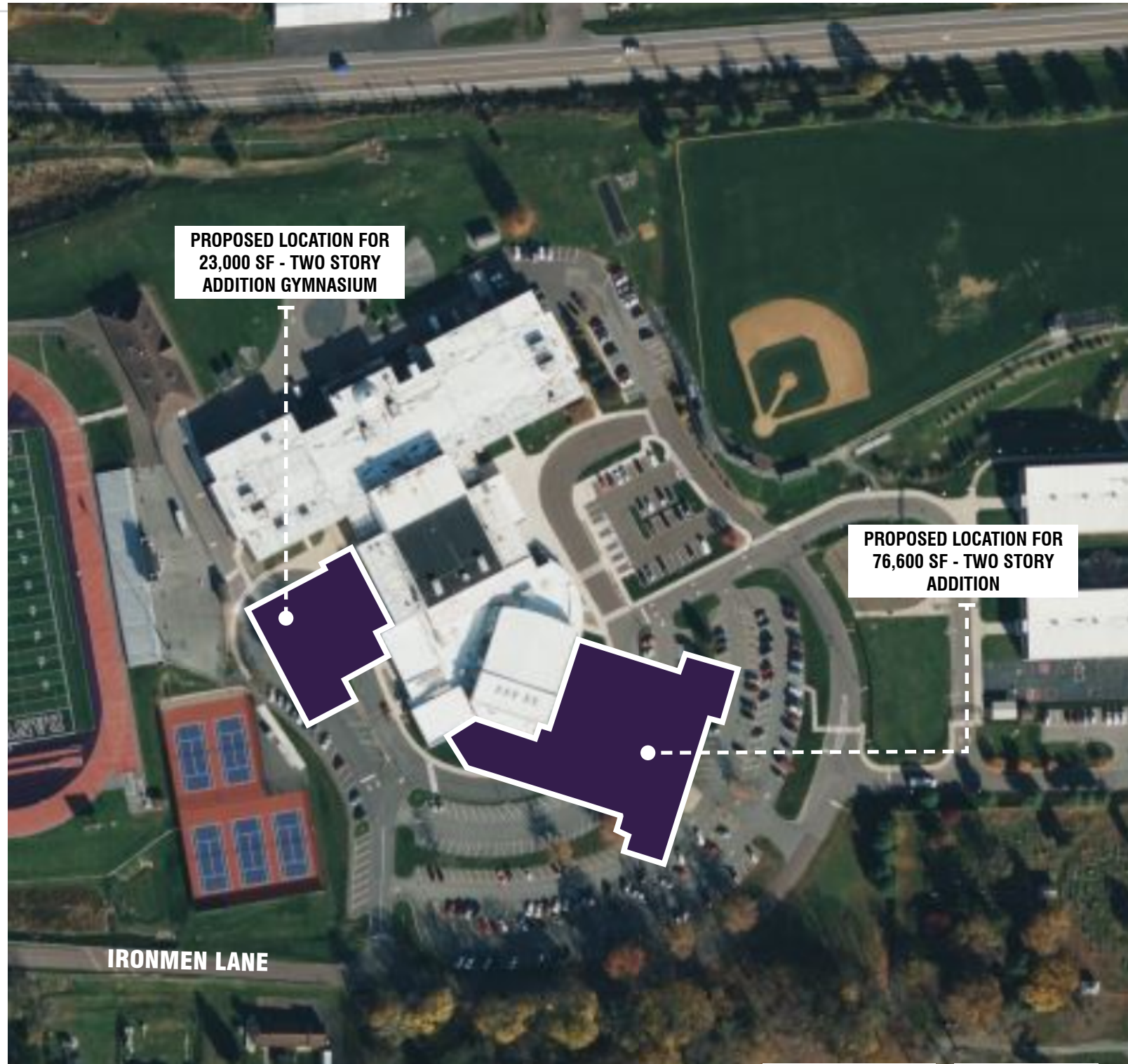

**172,160 SF**

EXISTING BUILDING SQUARE FOOTAGE

**850 STUDENTS**

CURRENT CAPACITY

+

+

**99,600 SF**

7/8 SCHOOL BUILDING  
ADDITION +  
GYMNASIUM ADDITION

**400 STUDENTS**

7TH - 8TH GRADE

**271,760 SF**

**1,250 STUDENTS**  
ACADEMIC CAPACITY

PROPOSED DANVILLE HIGH SCHOOL | LEVEL 01



Existing High School

7/8 Addition

- FLOOR PLAN KEY**
- LEARNING SUPPORT
  - KINDERGARTEN
  - GRADES 1-2
  - COMMON SPACES
  - GRADES 3-6
  - GRADES 7-8
  - GRADES 9-12
  - ADMIN/TEACHERS
  - SCIENCE/LABS
  - ART/DESIGN/TECH
  - MUSIC/THEATER
  - GYMNASIUM
  - CIRCULATION
  - BUILDING SUPPORT
  - SCHOOL ENTRANCE

# PROPOSED DANVILLE HIGH SCHOOL | LEVEL 02



Existing High School

7/8 Addition

## FLOOR PLAN KEY

- LEARNING SUPPORT
- KINDERGARTEN
- GRADES 1-2
- COMMON SPACES
- GRADES 3-6
- GRADES 7-8
- GRADES 9-12
- ADMIN/TEACHERS
- SCIENCE/LABS
- ART/DESIGN/TECH
- MUSIC/THEATER
- GYMNASIUM
- CIRCULATION
- BUILDING SUPPORT
- SCHOOL ENTRANCE

C

DANVILLE HIGH SCHOOL: 7-8 HIGH SCHOOL ADDITION

99,600 SF NEW ADDITION CONSTRUCTION	\$40.8m - \$42.8 probable cost
EXISTING BUILDING RENOVATIONS	\$9.4m - \$11.2m probable cost
SITE WORK (20%)	\$10m - \$10.8m probable cost
<b>TOTAL ESTIMATED CONSTRUCTION COST</b>	<b>\$60.3m - \$64.8m probable cost</b>
SOFT COSTS (25%)	\$15m - \$16.2m probable cost
<b>TOTAL ESTIMATED PROJECT COST</b>	<b>\$75.3m - \$81.1m probable</b>
* INCLUDES INFRASTRUCTURE UPGRADES TO EXISTING BUILDING	
2+ YEARS INFLATION 4% PER YEAR	\$6m - \$6.2m added cost

# D CURRENT GRADE ALIGNMENT

## HS-2

*487 students  
850 capacity*

**PRIMARY SCHOOL**

**58% CAPACITY**

*\*enrollment does not include Head Start*

## 3-5

*495 students  
600 capacity*

**LIBERTY VALLEY**

**83% CAPACITY**

## 6-8

*513 students  
600 capacity*

**MIDDLE SCHOOL**

**86% CAPACITY**

## 9-12

*610 students  
850 capacity*

**HIGH SCHOOL**

**71% CAPACITY**

**District  
Office**

# D PRIMARY CAMPUS + SECONDARY CAMPUS



**MIDDLE SCHOOL  
(PRIMARY SCHOOL)**

**REALIGNED**

**ADDITION**

**82% CAPACITY**

*\*Head Start program relocated*



**LIBERTY VALLEY  
ELEMENTARY SCHOOL**

**REALIGNED**

**ADDITION**

**82% CAPACITY**

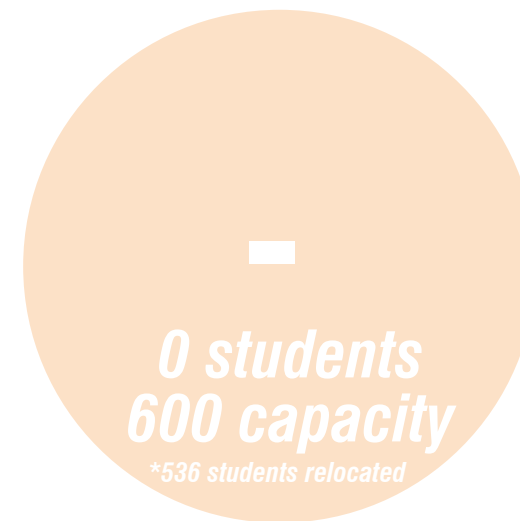

**MIDDLE SCHOOL**  
**0% CAPACITY**



**HIGH SCHOOL**  
**69% CAPACITY**

# D1 LIBERTY VALLEY PRIMARY SCHOOL : ADDITION + RENOVATION

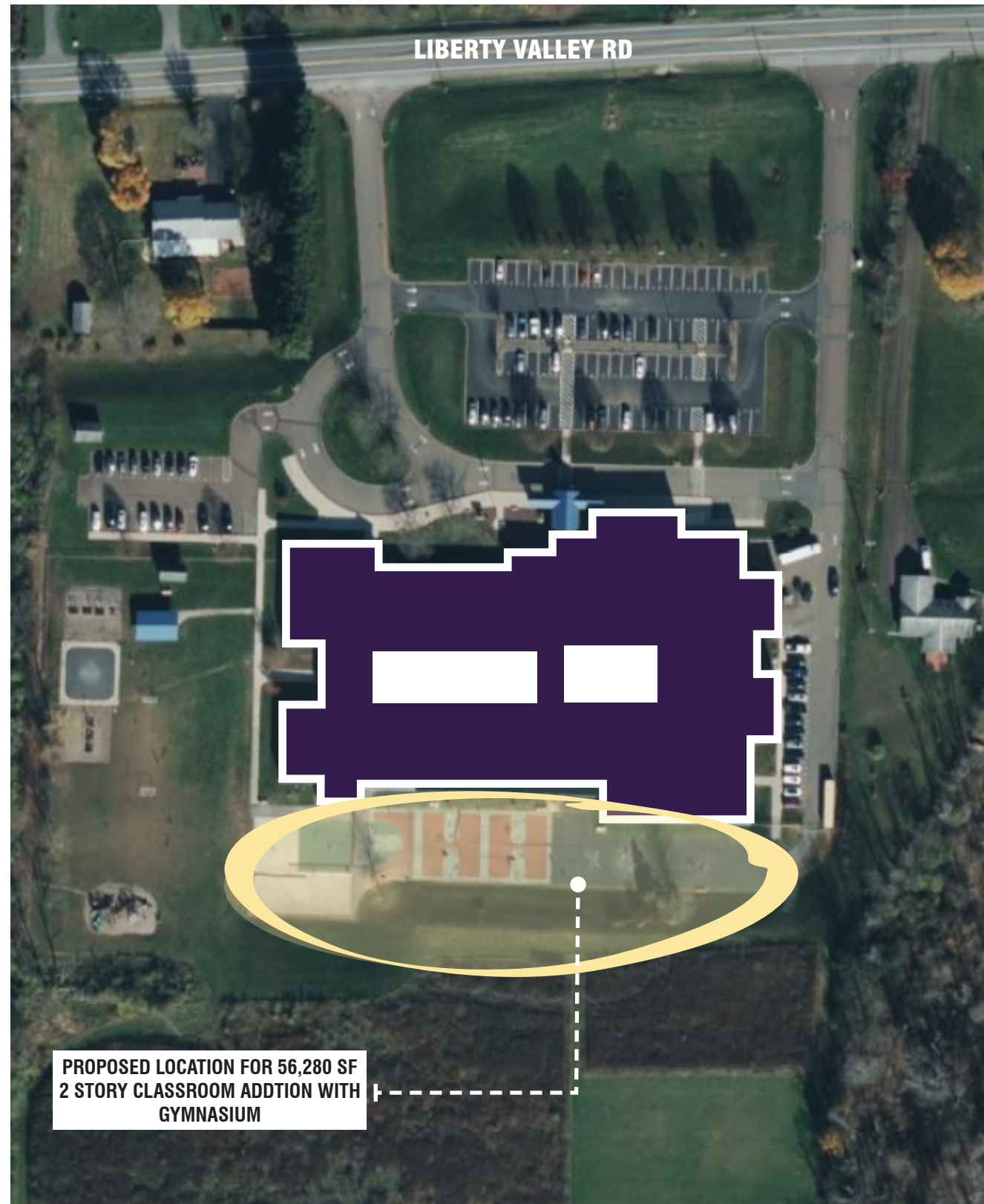

# D1 LIBERTY VALLEY PRIMARY SCHOOL : ADDITION + RENOVATION

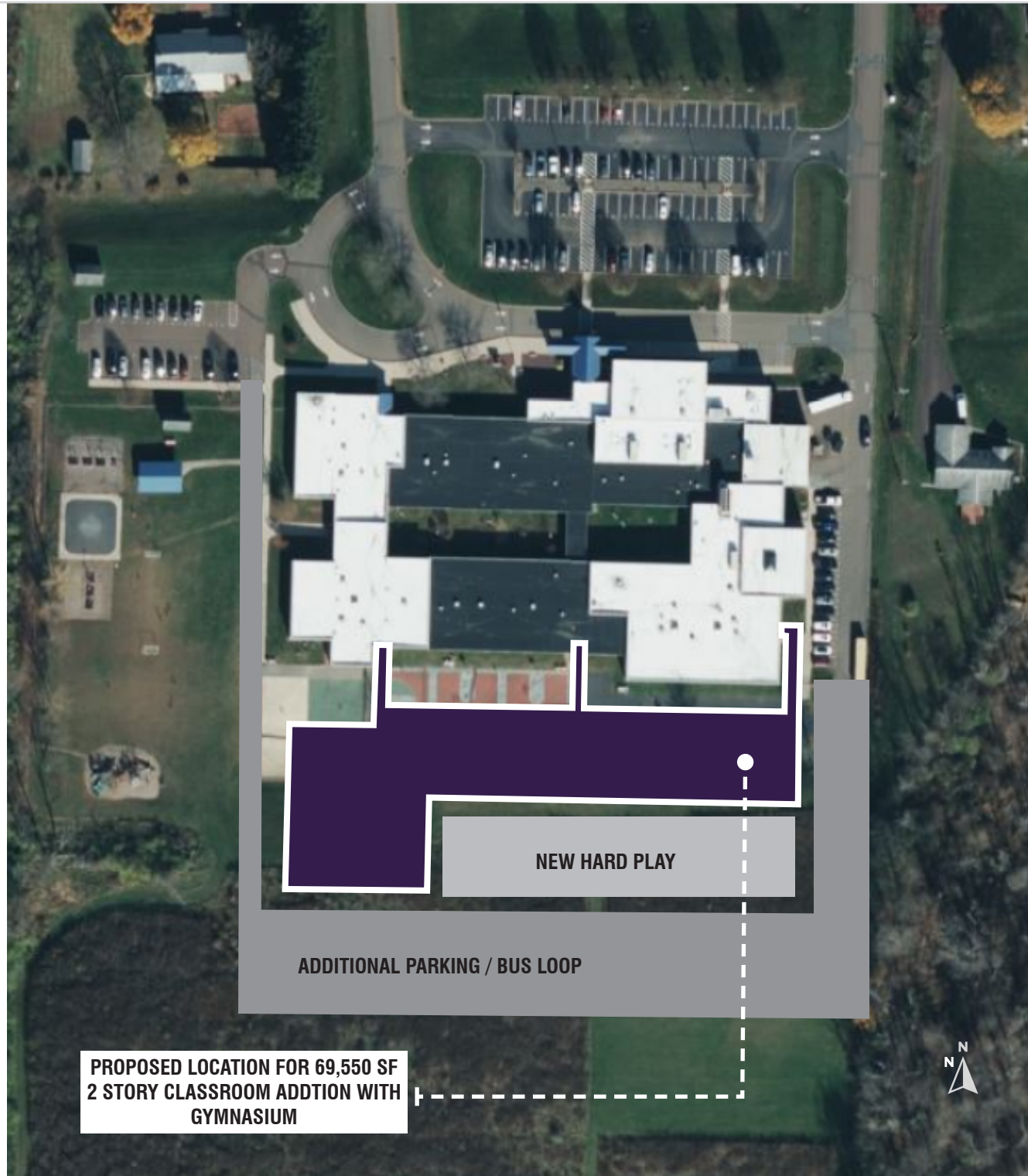

**72,440 SF**

EXISTING BUILDING SQUARE FOOTAGE

**600 STUDENTS**

CURRENT CAPACITY

+

+

**69,550 SF**

24 CLASSROOM ADDITION +  
2 MUSIC + GYMNASIUM / STAGE

**600 STUDENTS**

K - 2ND GRADE

**141,990 SF**

**1,200 STUDENTS**  
ACADEMIC CAPACITY

# D1 LIBERTY VALLEY PRIMARY SCHOOL : ADDITION + RENOVATION

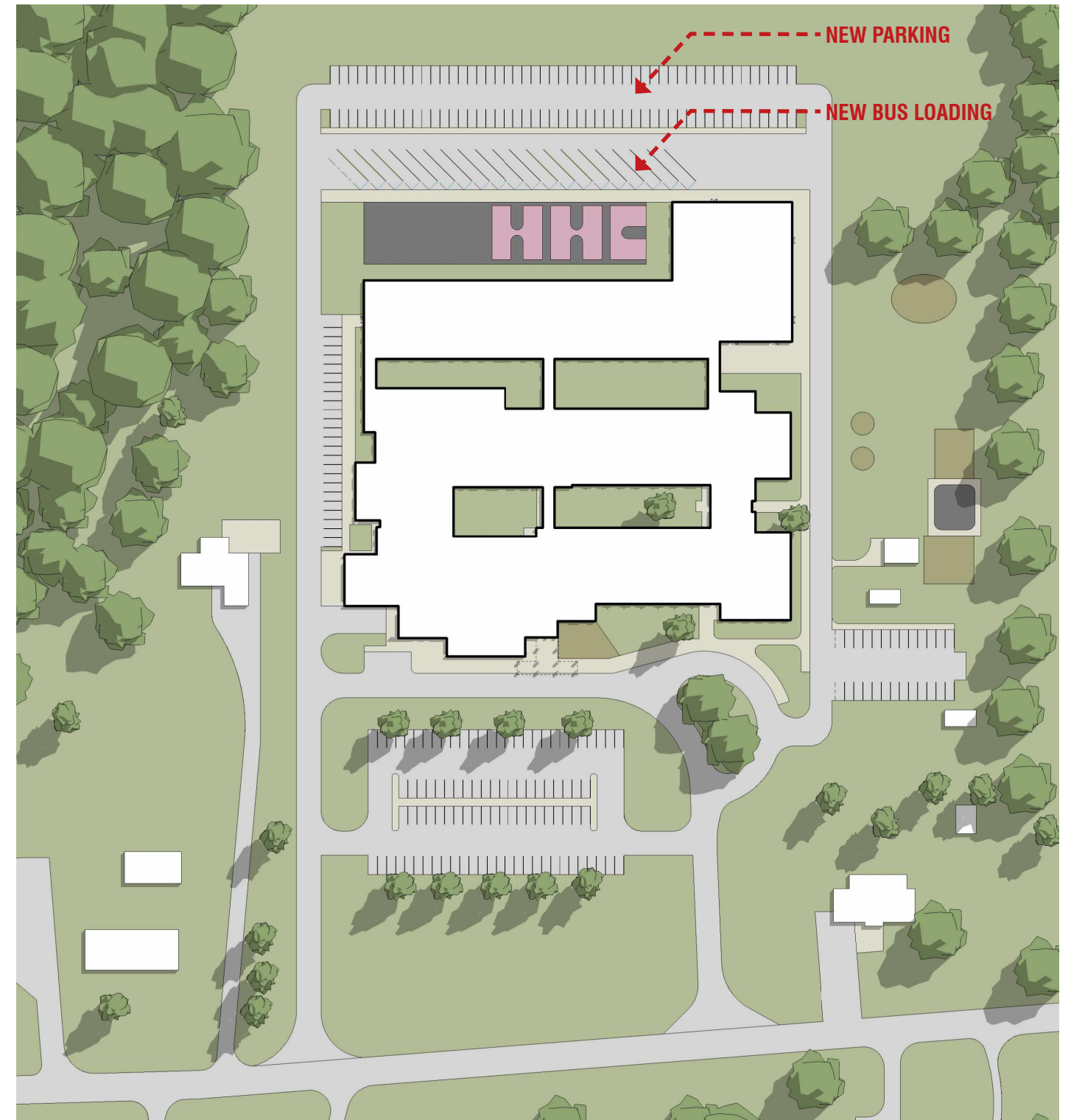
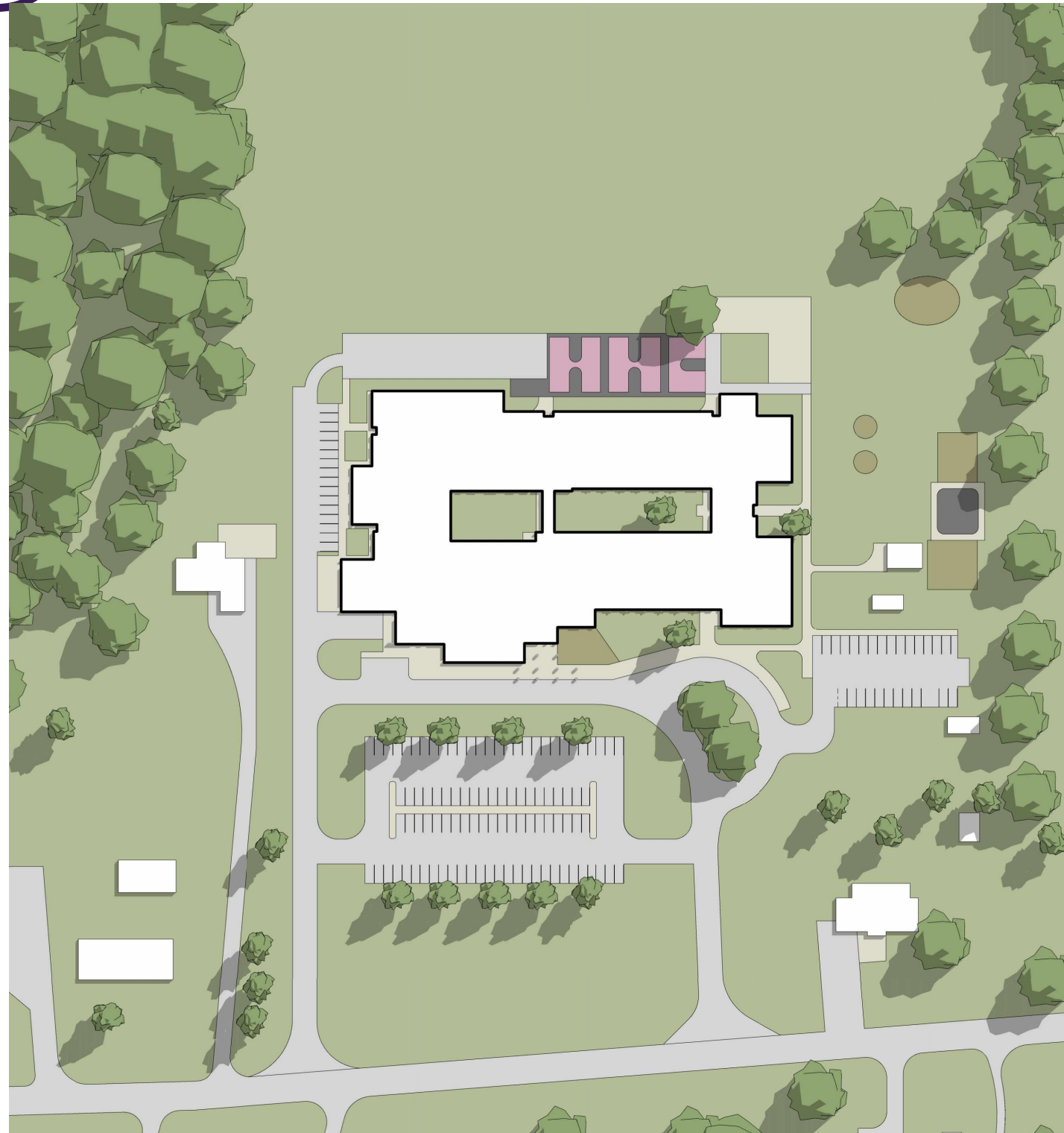

# PROPOSED LIBERTY VALLEY PRIMARY SCHOOL | LEVEL 01

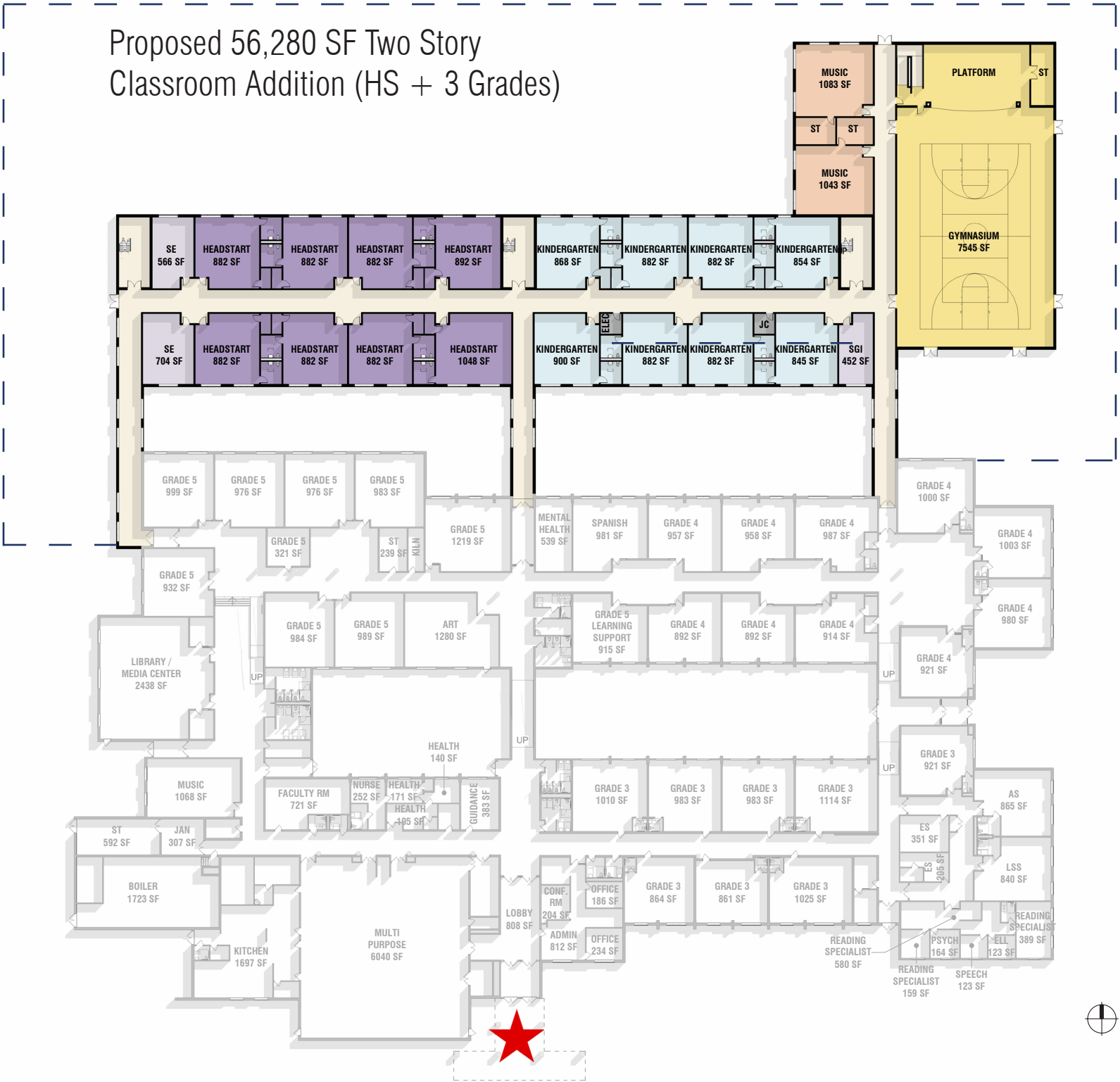

Existing Intermediate School - HS - 2nd Grade moves into existing building - Existing Multipurpose Becomes only Cafeteria

PROPOSED LIBERTY VALLEY PRIMARY SCHOOL | LEVEL 01

Proposed 56,280 SF Two Story Classroom Addition (HS + 3 Grades)

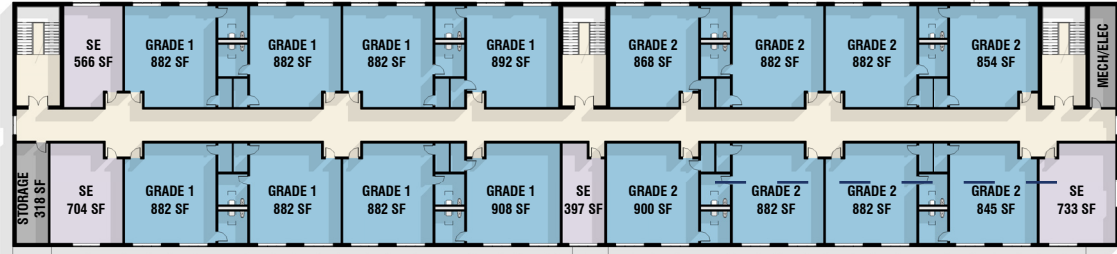

- FLOOR PLAN KEY
- LEARNING SUPPORT
  - KINDERGARTEN
  - GRADES 1-2
  - COMMON SPACES
  - GRADES 3-6
  - GRADES 7-8
  - GRADES 9-12
  - ADMIN/TEACHERS
  - SCIENCE/LABS
  - ART/DESIGN/TECH
  - MUSIC/THEATER
  - GYMNASIUM
  - CIRCULATION
  - BUILDING SUPPORT
  - SCHOOL ENTRANCE

Existing Intermediate School - HS - 2nd Grade moves into existing building - Existing Multipurpose Becomes only Cafeteria

# **D1** LIBERTY VALLEY PRIMARY SCHOOL: RENOVATION + ADDITION

69,550 SF NEW ADDITION CONSTRUCTION	\$28.5m - \$29.9 probable cost
EXISTING BUILDING RENOVATIONS	\$3.6m - \$4.3m probable cost
SITE WORK (20%)	\$6.4m - \$6.8m probable cost
<b>TOTAL ESTIMATED CONSTRUCTION COST</b>	<b>\$38.5m - \$41.1m probable cost</b>
SOFT COSTS (25%)	\$9.6m - \$10.2m probable cost
<b>TOTAL ESTIMATED PROJECT COST</b>	<b>\$48.1m - \$51.4m probable cost</b>

\* INCLUDES INFRASTRUCTURE UPGRADES TO EXISTING BUILDING

# D2 DANVILLE MIDDLE SCHOOL : ADDITION + RENOVATION

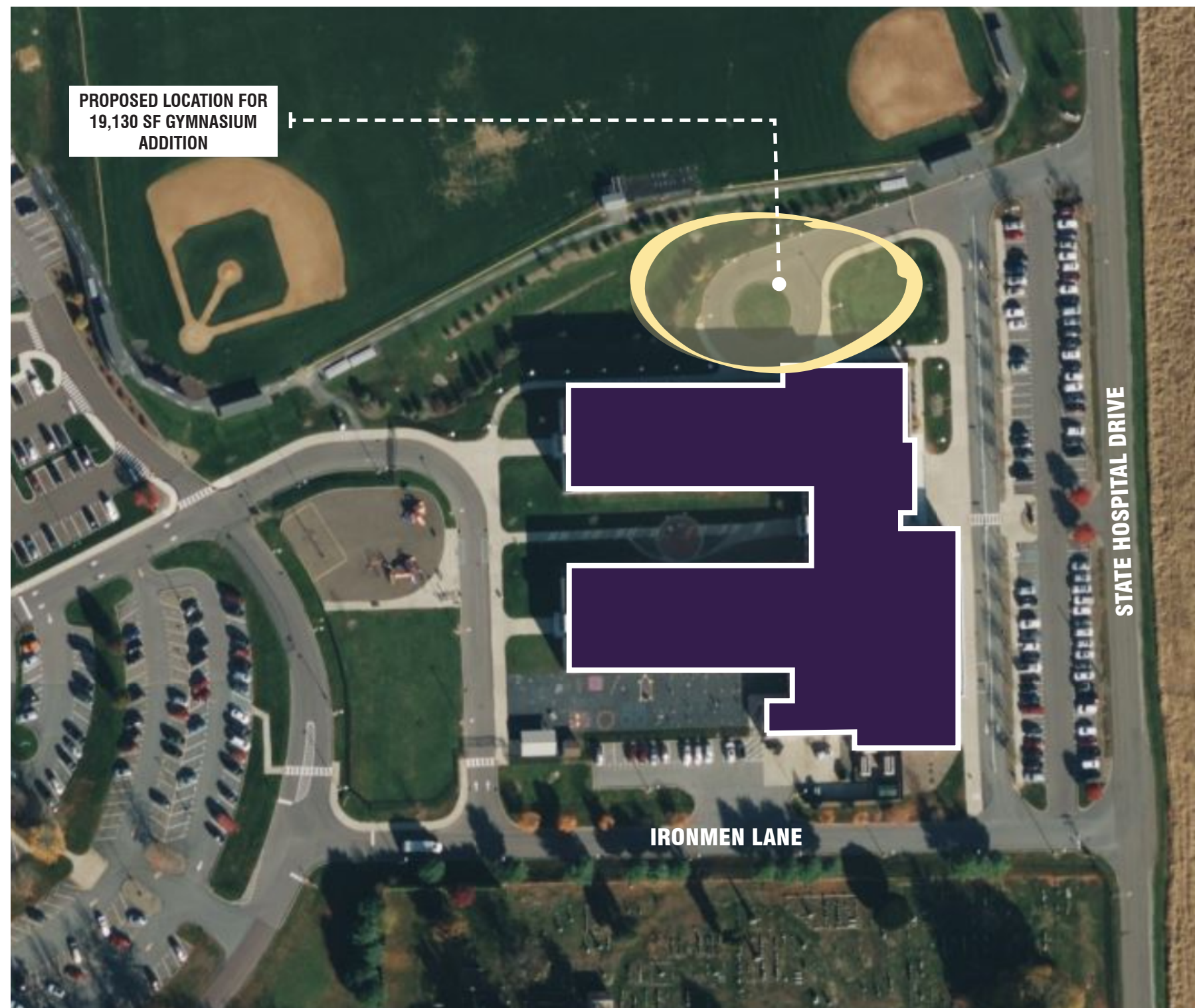

# D2 DANVILLE MIDDLE SCHOOL : ADDITION + RENOVATION



**110,200 SF**

EXISTING BUILDING SQUARE FOOTAGE

**850 STUDENTS**

CURRENT CAPACITY

+

**19,130 SF**

GYMNASIUM ADDITION

**600 STUDENTS**

(RENOVATE CLASSROOMS FOR  
6TH - 8TH GRADE)

**129,330 SF**

**600 STUDENTS**

ACADEMIC CAPACITY

## PROPOSED DANVILLE MIDDLE SCHOOL | LEVEL 01



## FLOOR PLAN KEY

- LEARNING SUPPORT
- KINDERGARTEN
- GRADES 1-2
- COMMON SPACES
- GRADES 3-6
- GRADES 7-8
- GRADES 9-12
- ADMIN/TEACHERS
- SCIENCE/LABS
- ART/DESIGN/TECH
- MUSIC/THEATER
- GYMNASIUM
- CIRCULATION
- BUILDING SUPPORT
- SCHOOL ENTRANCE

Existing Primary School - all grades move out to Liberty Valley - existing 1st floor classrooms renovated for Science Labs, Speciality Labs, Music, and bathrooms

PROPOSED DANVILLE MIDDLE SCHOOL | LEVEL 02



- FLOOR PLAN KEY
- LEARNING SUPPORT
  - HEADSTART
  - KINDERGARTEN
  - GRADES 1-2
  - COMMON SPACES
  - GRADES 3-6
  - GRADES 7-8
  - GRADES 9-12
  - ADMIN/TEACHERS
  - SCIENCE/LABS
  - ART/DESIGN/TECH
  - MUSIC/THEATER
  - GYMNASIUM
  - CIRCULATION
  - BUILDING SUPPORT
  - SCHOOL ENTRANCE



Existing Primary School - all grades move out to Liberty Valley - existing 1st floor classrooms renovated for Science Labs, Speciality Labs, Music, and bathrooms

## **D2** DANVILLE MIDDLE SCHOOL: RENOVATION + ADDITION

19,130 SF NEW ADDITION CONSTRUCTION	\$7.8m - \$8.2 probable cost
EXISTING BUILDING RENOVATIONS	\$6.6m - \$7.5m probable cost
SITE WORK (20%)	\$2.8m - \$3.1m probable cost
<b>TOTAL ESTIMATED CONSTRUCTION COST</b>	<b>\$17.3m - \$18.9m probable cost</b>
SOFT COSTS (25%)	\$4.3m - \$4.7m probable cost
<b>TOTAL ESTIMATED PROJECT COST</b>	<b>\$21.7m - \$23.6m probable</b>

\* INCLUDES INFRASTRUCTURE UPGRADES TO EXISTING BUILDING

D

PRIMARY CAMPUS + SECONDARY CAMPUS

LIBERTY VALLEY PRIMARY SCHOOL	\$48.1m - \$51.4 probable cost
DANVILLE MIDDLE SCHOOL (FORMERLY DPS)	\$21.7m - \$23.6m probable cost
<b>TOTAL ESTIMATED PROJECT COST</b>	<b>\$69.8m - \$75m probable cost</b>
2+ YEARS INFLATION 4% PER YEAR	\$5.5m - \$6m added cost

# E CURRENT GRADE ALIGNMENT

## HS-2

*487 students  
850 capacity*

### PRIMARY SCHOOL

*58% CAPACITY*

*\*enrollment does not include Head Start*

## 3-5

*495 students  
600 capacity*

### LIBERTY VALLEY

*83% CAPACITY*

## 6-8

*513 students  
600 capacity*

### MIDDLE SCHOOL

*86% CAPACITY*

## 9-12

*610 students  
850 capacity*

### HIGH SCHOOL

*71% CAPACITY*

District  
Office

# E DANVILLE AREA SCHOOL DISTRICT COMMON CAMPUS

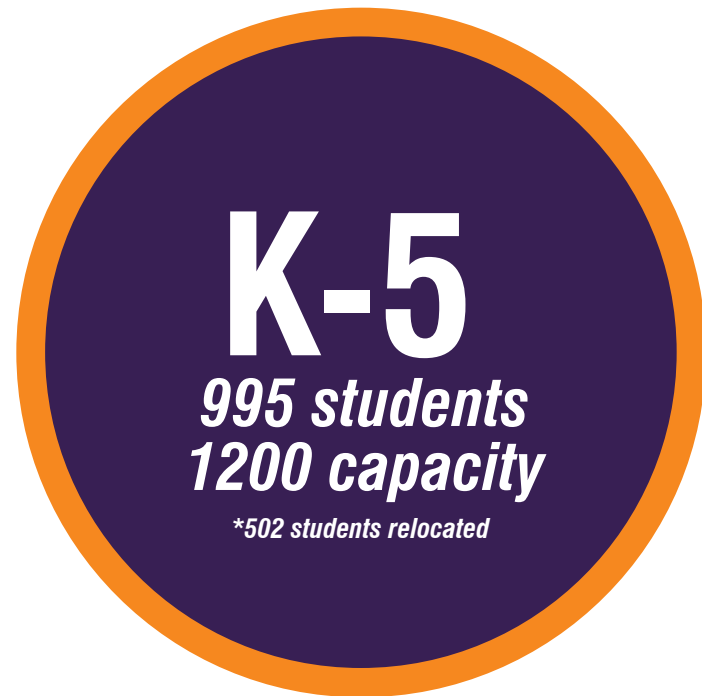

## PRIMARY SCHOOL

**REALIGNED**

**ADDITION**

**82% CAPACITY**

*\*Head Start program relocated*

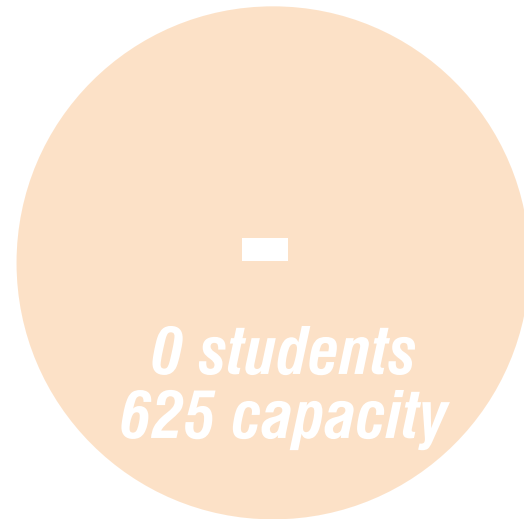

## LIBERTY VALLEY

**0% CAPACITY**

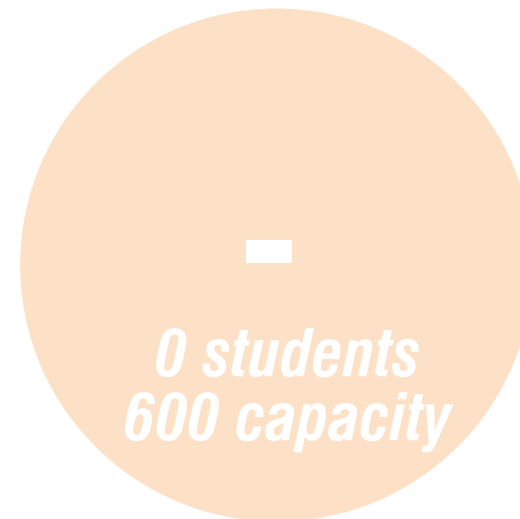

## MIDDLE SCHOOL

**0% CAPACITY**



## DANVILLE SECONDARY SCHOOL

**REALIGNED**

**ADDITION**

**77% CAPACITY**

# E1 DANVILLE PRIMARY SCHOOL : ADDITION + RENOVATION

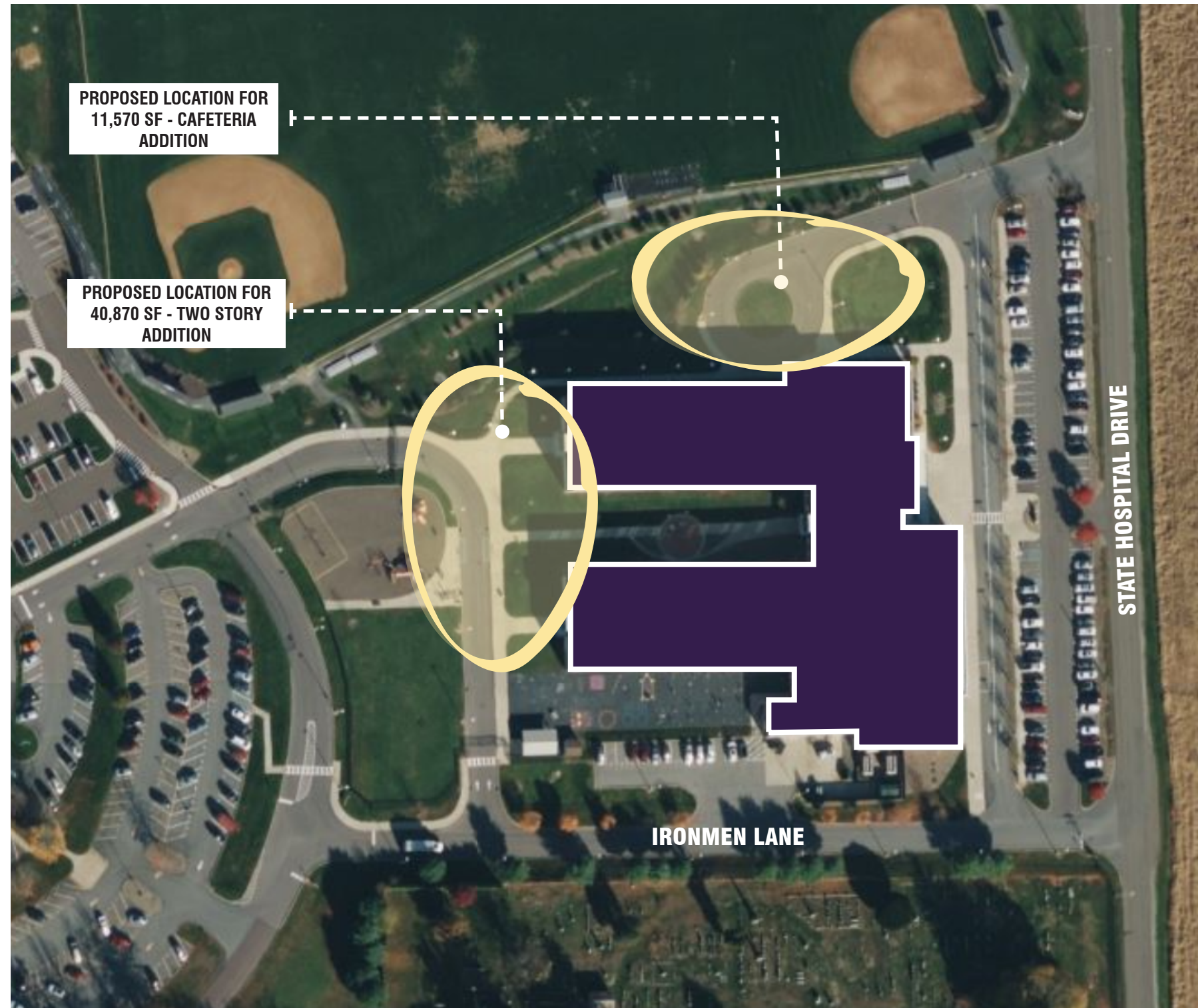

# E1 DANVILLE PRIMARY SCHOOL : ADDITION + RENOVATION

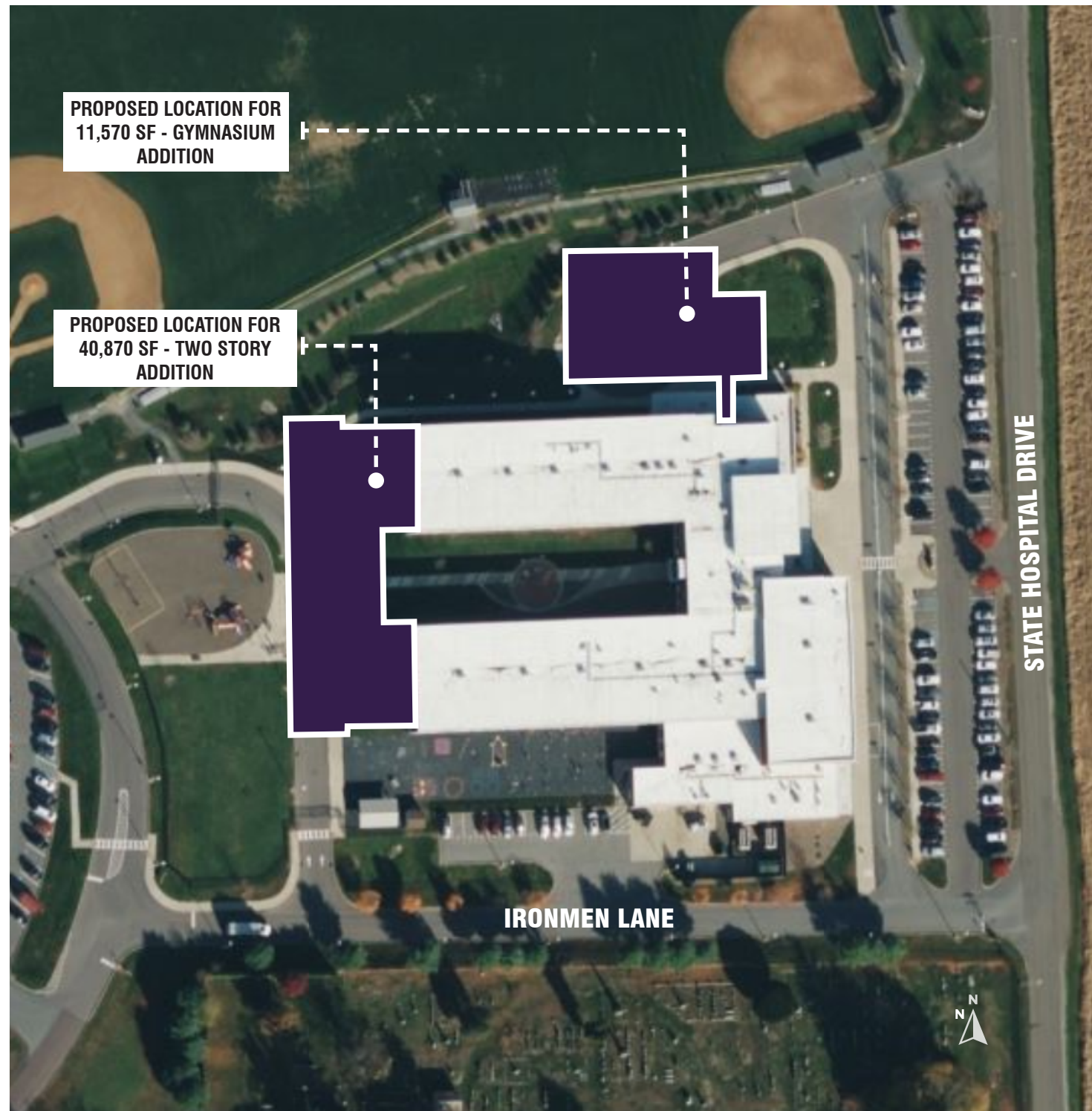

**110,200 SF**

EXISTING BUILDING SQUARE FOOTAGE

+

**52,440 SF**

24 CLASSROOM ADDITION +  
GYMNSA

**162,640 SF**

**850 STUDENTS**

CURRENT CAPACITY

(MOVE OUT HEAD START  
MOVE IN 3RD GRADE)

+

**350 STUDENTS**

4TH - 5TH GRADE

**1,200 STUDENTS**  
ACADEMIC CAPACITY

PROPOSED DANVILLE PRIMARY SCHOOL | LEVEL 01



- FLOOR PLAN KEY
- LEARNING SUPPORT
  - KINDERGARTEN
  - GRADES 1-2
  - COMMON SPACES
  - GRADES 3-6
  - GRADES 7-8
  - GRADES 9-12
  - ADMIN/TEACHERS
  - SCIENCE/LABS
  - ART/DESIGN/TECH
  - MUSIC/THEATER
  - GYMNASIUM
  - CIRCULATION
  - BUILDING SUPPORT
  - SCHOOL ENTRANCE

Existing Primary School - Head Start moves out - 3rd Grade moves into existing building - Existing Head Start Offices become Music Rooms

## PROPOSED DANVILLE PRIMARY SCHOOL | LEVEL 02

Proposed 40,870 SF  
Two Story Classroom  
Addition (2 Grades)



### FLOOR PLAN KEY

- LEARNING SUPPORT
- KINDERGARTEN
- GRADES 1-2
- COMMON SPACES
- GRADES 3-6
- GRADES 7-8
- GRADES 9-12
- ADMIN/TEACHERS
- SCIENCE/LABS
- ART/DESIGN/TECH
- MUSIC/THEATER
- GYMNASIUM
- CIRCULATION
- BUILDING SUPPORT
- ★ SCHOOL ENTRANCE

Existing Primary School - Head Start moves out - 3rd Grade moves into existing building - Existing Kitchen becomes Music Rooms

## **E1** DANVILLE PRIMARY SCHOOL: ADDITION + RENOVATION

52,440 SF NEW ADDITION CONSTRUCTION	\$21.4m - \$22.5 probable cost
EXISTING BUILDING RENOVATIONS	\$2.7m - \$3m probable cost
SITE WORK (20%)	\$4.8m - \$5.1m probable cost
<b>TOTAL ESTIMATED CONSTRUCTION COST</b>	<b>\$29m - \$30.7m probable cost</b>
SOFT COSTS (25%)	\$7.2m - \$7.6m probable cost
<b>TOTAL ESTIMATED PROJECT COST</b>	<b>\$36.2m - \$38.4m probable cost</b>

\* INCLUDES INFRASTRUCTURE UPGRADES TO EXISTING BUILDING

# E2 DANVILLE SECONDARY SCHOOL : ADDITION + RENOVATION

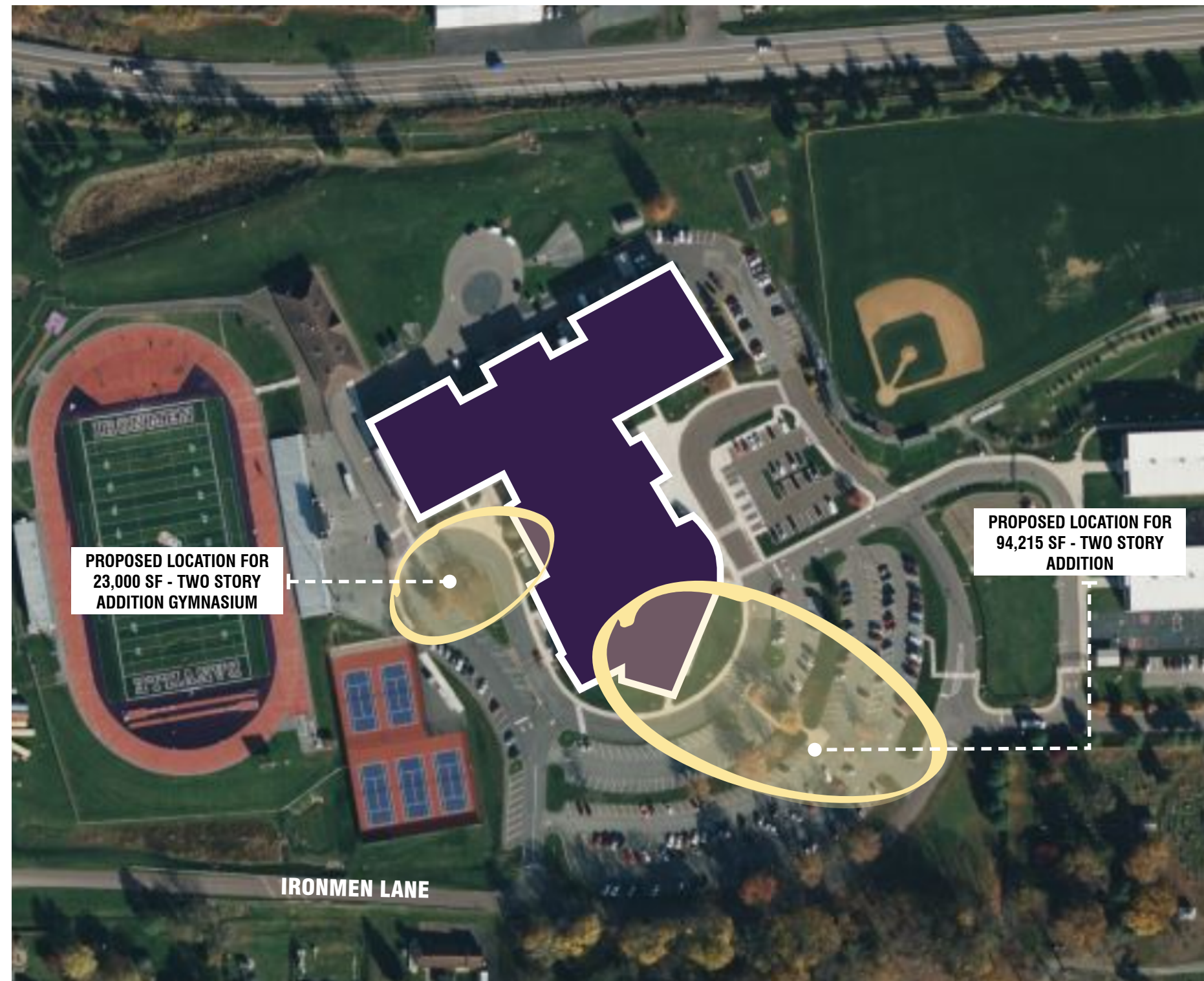

# E2 DANVILLE SECONDARY SCHOOL : ADDITION + RENOVATION



**172,160 SF**

EXISTING BUILDING SQUARE FOOTAGE

**850 STUDENTS**

CURRENT CAPACITY

+

+

**117,215 SF**

NEW MIDDLE SCHOOL  
BUILDING ADDITION +  
GYMNASIUM ADDITION

**600 STUDENTS**

6TH - 8TH GRADE

**289,375 SF**

**1,450 STUDENTS**  
ACADEMIC CAPACITY





E2

DANVILLE HIGH SCHOOL: 6-8 HIGH SCHOOL ADDITION

118,365 SF NEW ADDITION CONSTRUCTION	\$48m - \$50 probable cost
EXISTING BUILDING RENOVATIONS	\$9.8m - \$11.7m probable cost
SITE WORK (20%)	\$11.6m - \$12.5m probable cost
<b>TOTAL ESTIMATED CONSTRUCTION COST</b>	<b>\$70m - \$75.1m probable cost</b>
SOFT COSTS (25%)	\$17.5m - \$18.7m probable cost
<b>TOTAL ESTIMATED PROJECT COST</b>	<b>\$87.5m - \$93.9m probable</b>

\* INCLUDES INFRASTRUCTURE UPGRADES TO EXISTING BUILDING

## EXISTING CAMPUS SITE PLAN



# NEW CAMPUS SITE PLAN

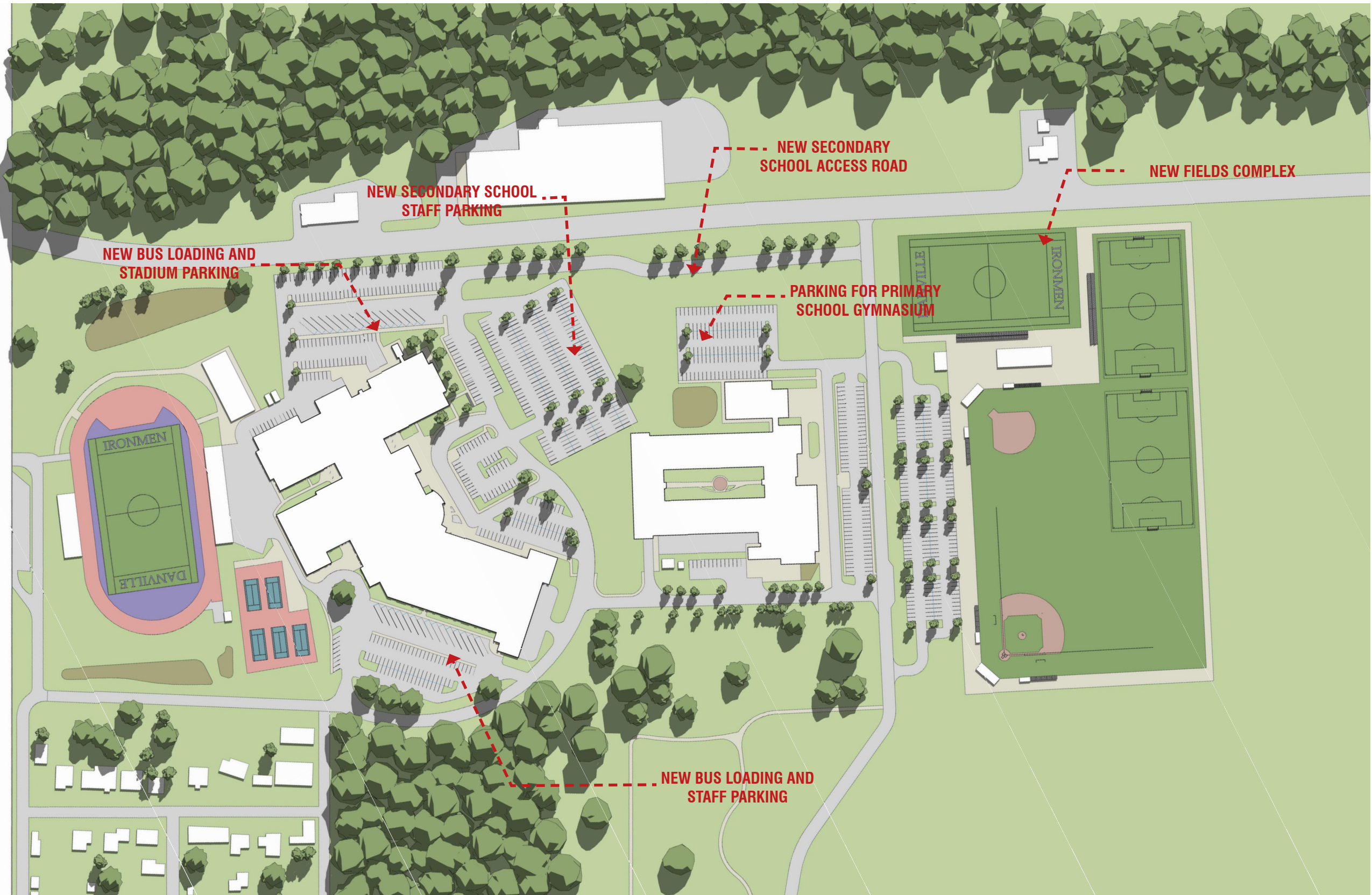

E

DANVILLE AREA SCHOOL DISTRICT COMMON CAMPUS

DANVILLE PRIMARY SCHOOL ADDITION	\$36.2m - \$38.4 probable cost
DANVILLE HIGH SCHOOL SECONDARY ADDITION	\$87.5m - \$93.9m probable cost
TOTAL ESTIMATED PROJECT COST	\$123.7m - \$132.3m probable cost
2+ YEARS INFLATION 4% PER YEAR	\$9.8m - \$10.5m added cost

# DISTRICT MASTER PLAN

## PROJECT OPTIONS - SUMMARY

**A**

**INFASTRUCTURE IMPROVEMENTS - BASIC UPGRADES**

**\$26m - \$31.2m probable cost**

**B**

**INFASTRUCTURE IMPROVEMENTS + DANVILLE MIDDLE SCHOOL RENOVATION**

**\$57.1m - \$66.1m probable cost**

**C**

**DANVILLE HIGH SCHOOL - 7-8 HIGH SCHOOL ADDITION**

**\$75.3m - \$81.1m probable cost**

**D**

**PRIMARY CAMPUS + SECONDARY CAMPUS**

**\$69.8m - \$75m probable cost**

**E**

**DANVILLE AREA SCHOOL DISTRICT COMMON CAMPUS**

**\$123.7m - \$132.3m probable cost**