

An aerial photograph of the Fairport Harbor Exempted Village School District. The image shows a large, multi-story school building with a flat roof and several wings, situated in the center. In front of the building is a large, open grassy field, likely a sports field, with some markings visible. The school is surrounded by a dense residential neighborhood with many houses and trees. In the background, there are hills and a body of water, possibly a harbor or lake. The sky is overcast.

# **Fairport Harbor** Exempted Village School District

Capital Improvements Presentation  
November 18<sup>th</sup> 2024

# Agenda

## **Project Design Update**

Program Overview

Phasing Plans

Opinion of Cost and  
Schedule

Renderings

Q&A



# Program Overview

## Program

- New ADA compliant Bleachers and Pressbox.
- ADA compliant sidewalks and access to all areas within the stadium.
- New Restroom and Concessions Building (at field level).
- New Locker Room Building with or without Board Office component.
- Field improvements (natural grass or synthetic turf).
- North side spectator improvements.



# Site Plan Phase 1

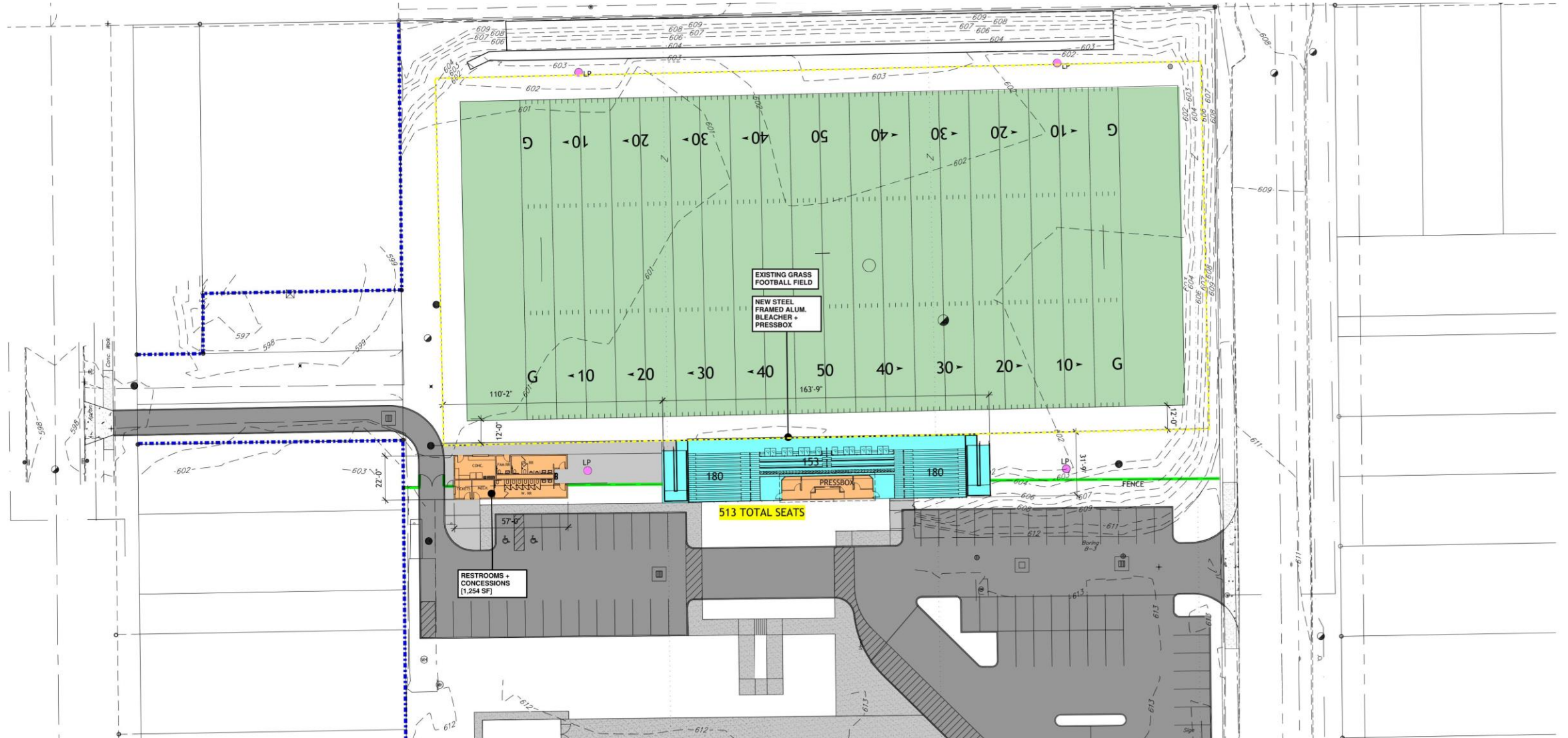

# Site Plan Phase 2A

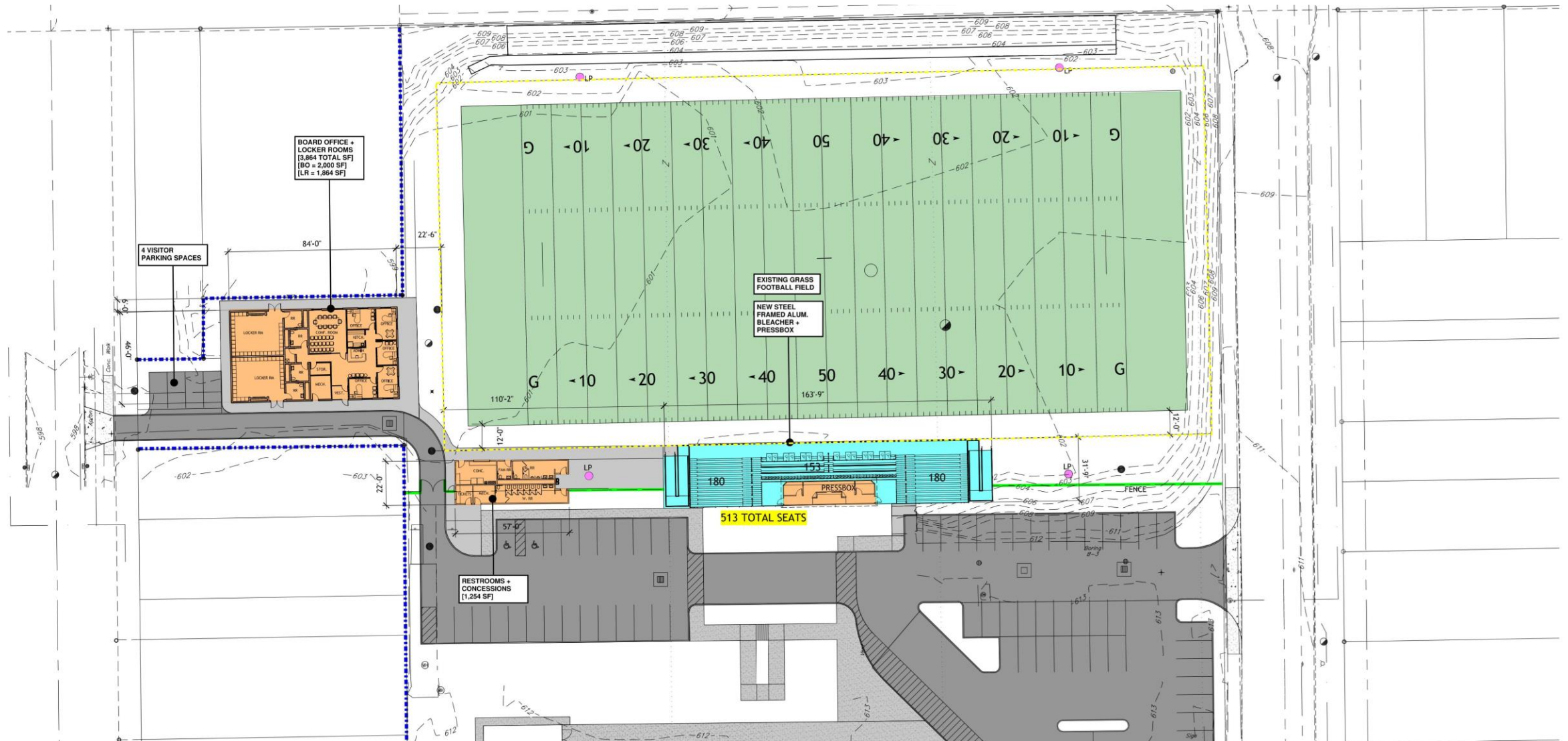



# Site Plan Phase 2A

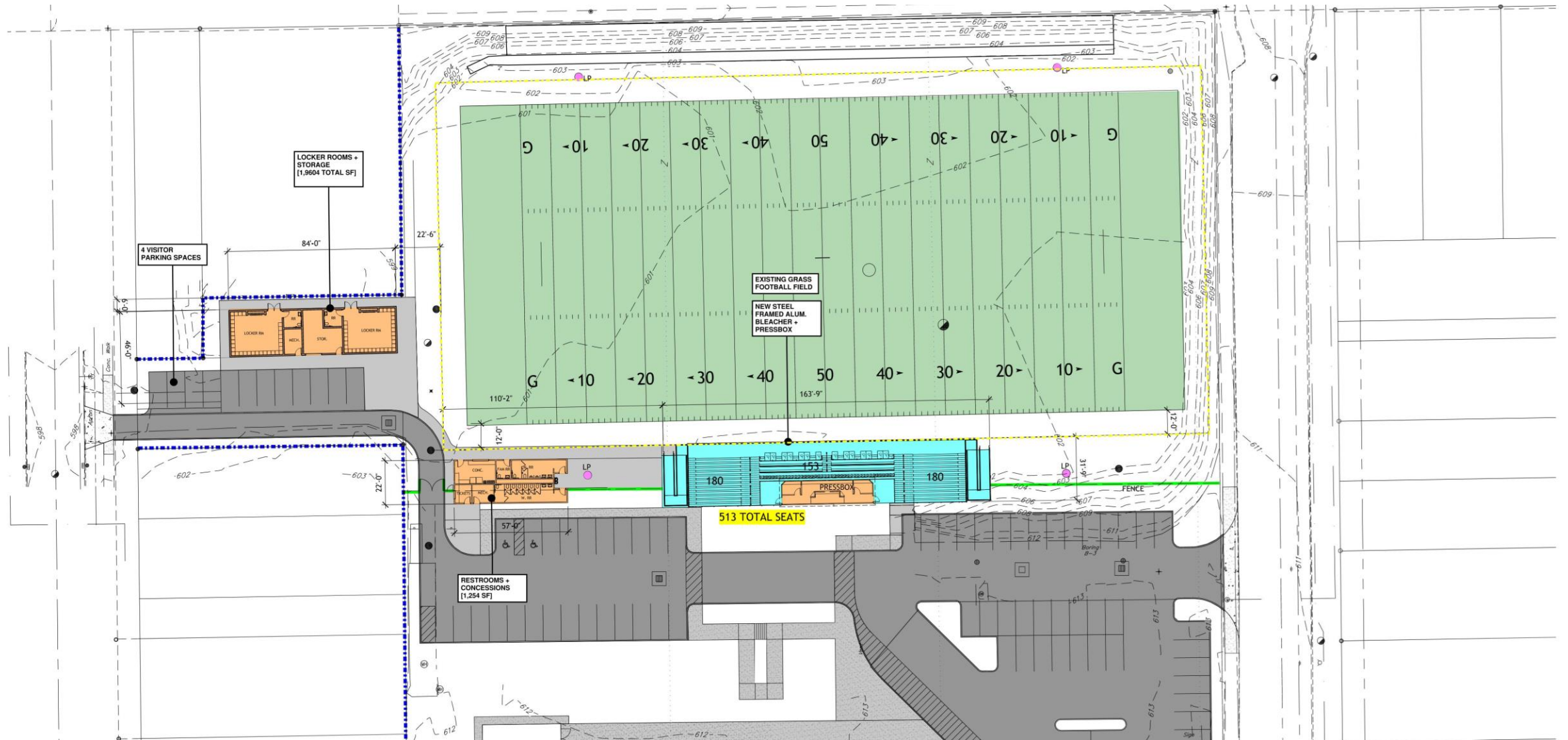

# Site Plan Phase 3A

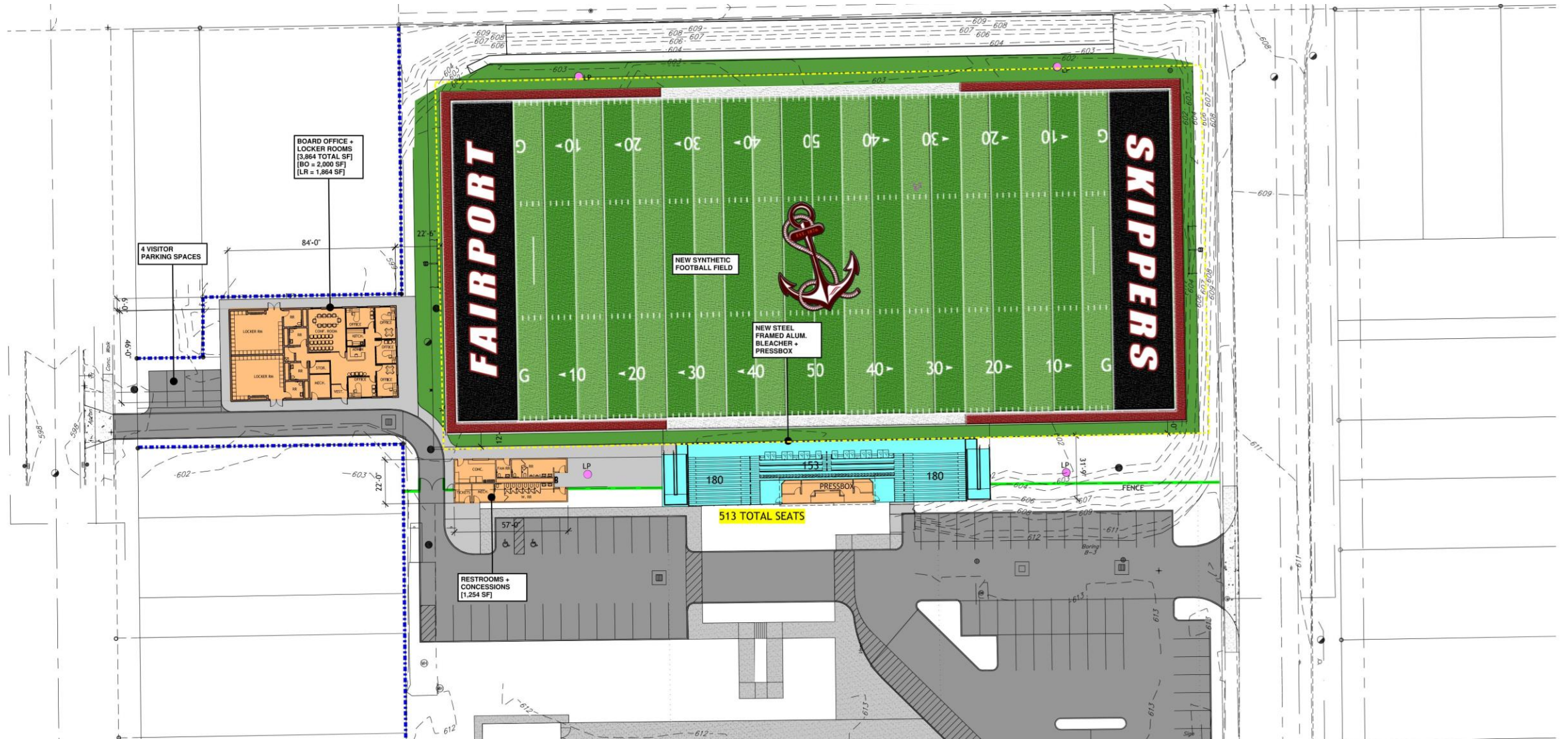



The site plan shows a large green rectangular area representing the football field, with yard lines and numbers (10, 20, 30, 40, 50) marked. To the left of the field is a building labeled "BOARD OFFICE + LOCKER ROOMS (3,864 TOTAL SF) (BO = 2,000 SF) (LR = 1,864 SF)". Below this building are "4 VISITOR PARKING SPACES". To the right of the field is a building labeled "RESTROOMS + CONCESSIONS (1,254 SF)". In front of the field is a large seating area labeled "513 TOTAL SEATS" and "PRESSBOX". The field is labeled "NEW NATURAL GRASS FOOTBALL FIELD" and "NEW STEEL FRAMED ALUM. BLEACHER + PRESSBOX". The plan also shows various dimensions, property lines, and surrounding streets.



# Site Plan Phase 3C



# Site Plan Phase 3D [at upper level]

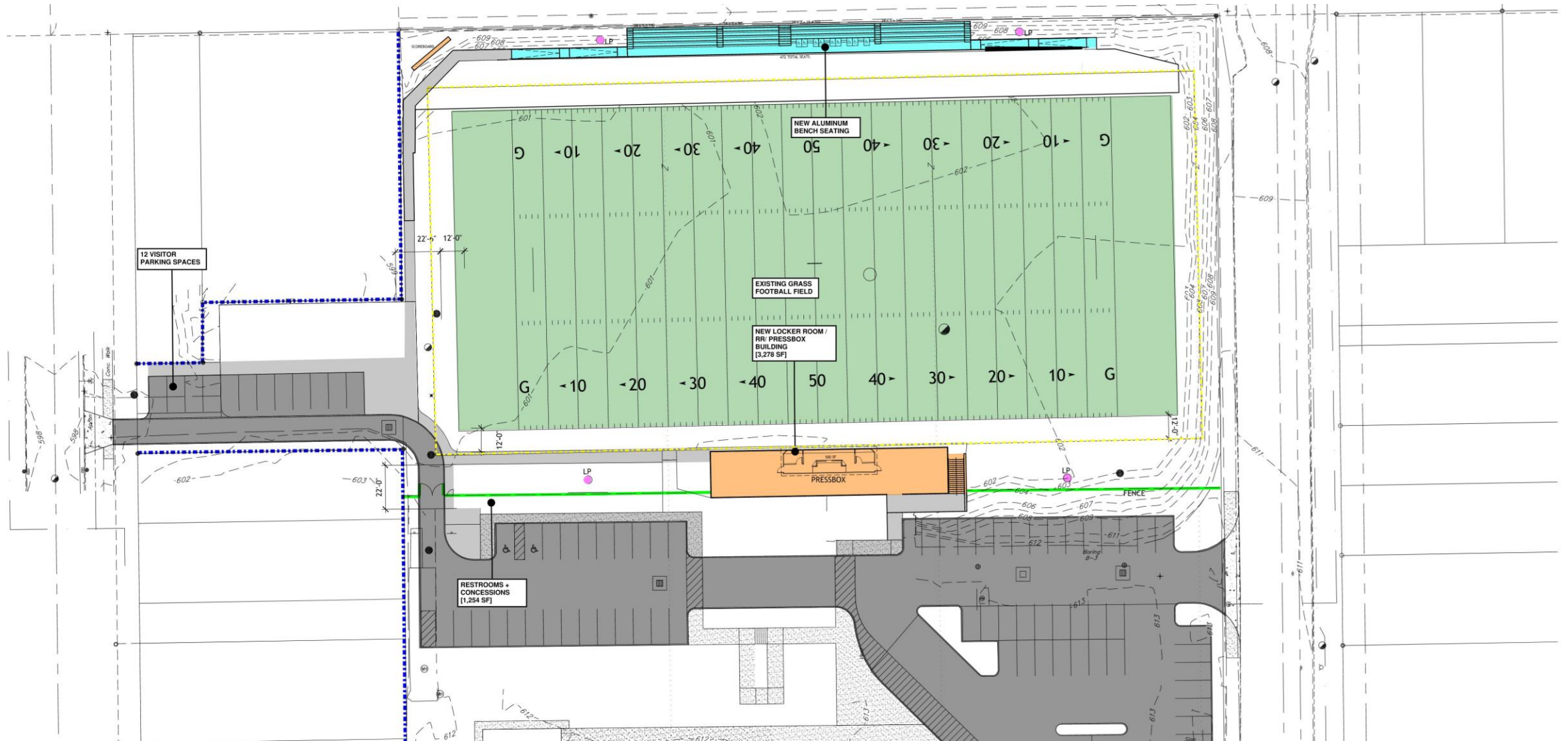



# Site Plan Phase 3D [at field level]

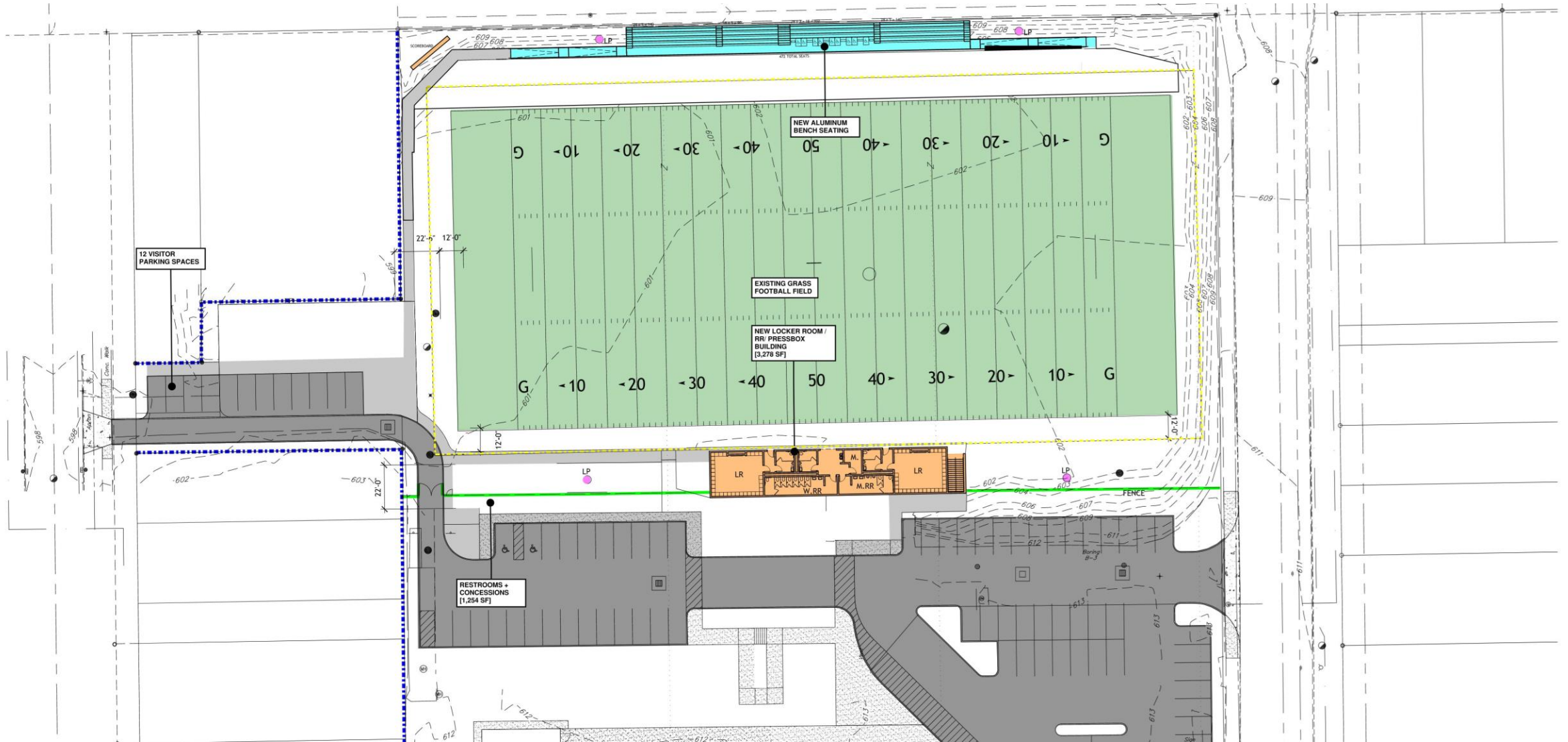

# Site Plan Phase 4

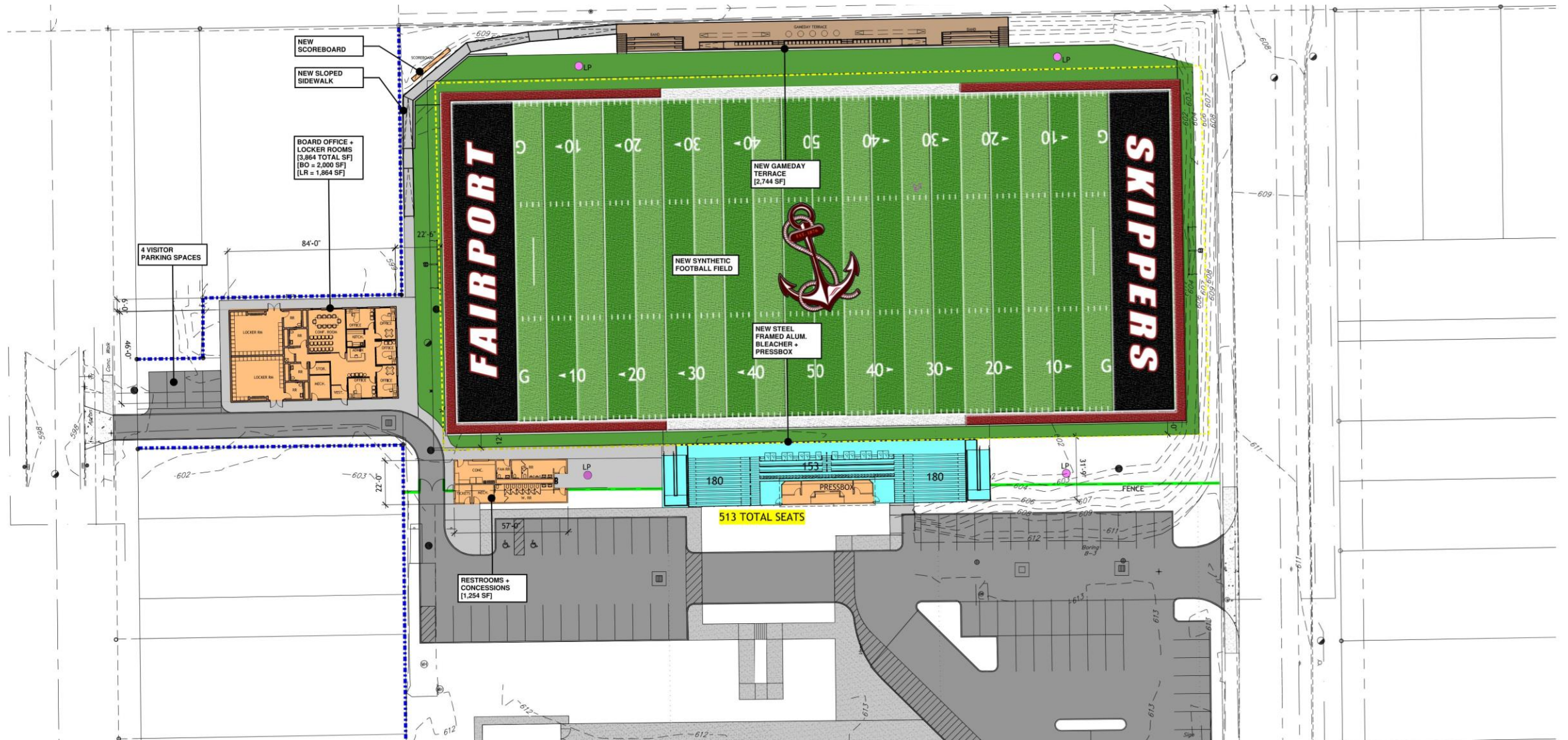



# Opinion of Cost

Fairport Harbor Pre K - 12 - Capital Improvement Projects			
Phase	Description	Range	
Phase 1	Bleacher, Pressbox, Restroom/Concession Bldg.	\$900,000.00	\$1,000,000.00
Phase 2A	Board Office + Locker Room Bldg.	\$1,400,000.00	\$1,500,000.00
Phase 3A	Synthetic Turf Field	\$1,150,000.00	\$1,250,000.00
Phase 4	Gameday Terrace	\$550,000.00	\$650,000.00
Total		\$4,000,000.00	\$4,400,000.00

Fairport Harbor Pre K - 12 - Capital Improvement Projects			
Phase	Description	Range	
Phase 1	Bleacher, Pressbox, Restroom/Concession Bldg.	\$900,000.00	\$1,000,000.00
Phase 2B	Locker Room Bldg.	\$750,000.00	\$850,000.00
Phase 3B	*Natural Grass Field	\$625,000.00	\$725,000.00
Phase 4	Gameday Terrace	\$550,000.00	\$650,000.00
Total		\$2,825,000.00	\$3,225,000.00

# Schedule

## **Phase 1: [6–8] months.**

- March 2025 – Nov. 2025
- Field usable Fall 2026

## **Phase 1 + 2: [9–12] months.**

- March 2025 – Feb. 2026
- Field usable Fall 2026

## **Phase 1 + 2 + 3: [9–12] months.**

- March 2025 – Feb. 2026
- Option 3A Field usable Fall 2026
- Option 3B Field usable Spring 2027

\* Option 3B (natural grass field) will require (3) growing seasons(fall/spring/fall) before usable.

## **Phase 1 + 2 + 3 + 4: [10–14] months.**

- March 2025 – April 2026
- Option 3A Field usable Fall 2026
- Option 3B Field usable Spring 2027





Aerial 1 [grass field]





Aerial 1 [syn. turf field]





Aerial 2 [grass field]





Aerial 2 [syn. turf field]





View 1 [grass field]





View 1 [syn. turf field]





View 2 [grass field]





View 2 [syn. turf field]





View 3 [grass field]



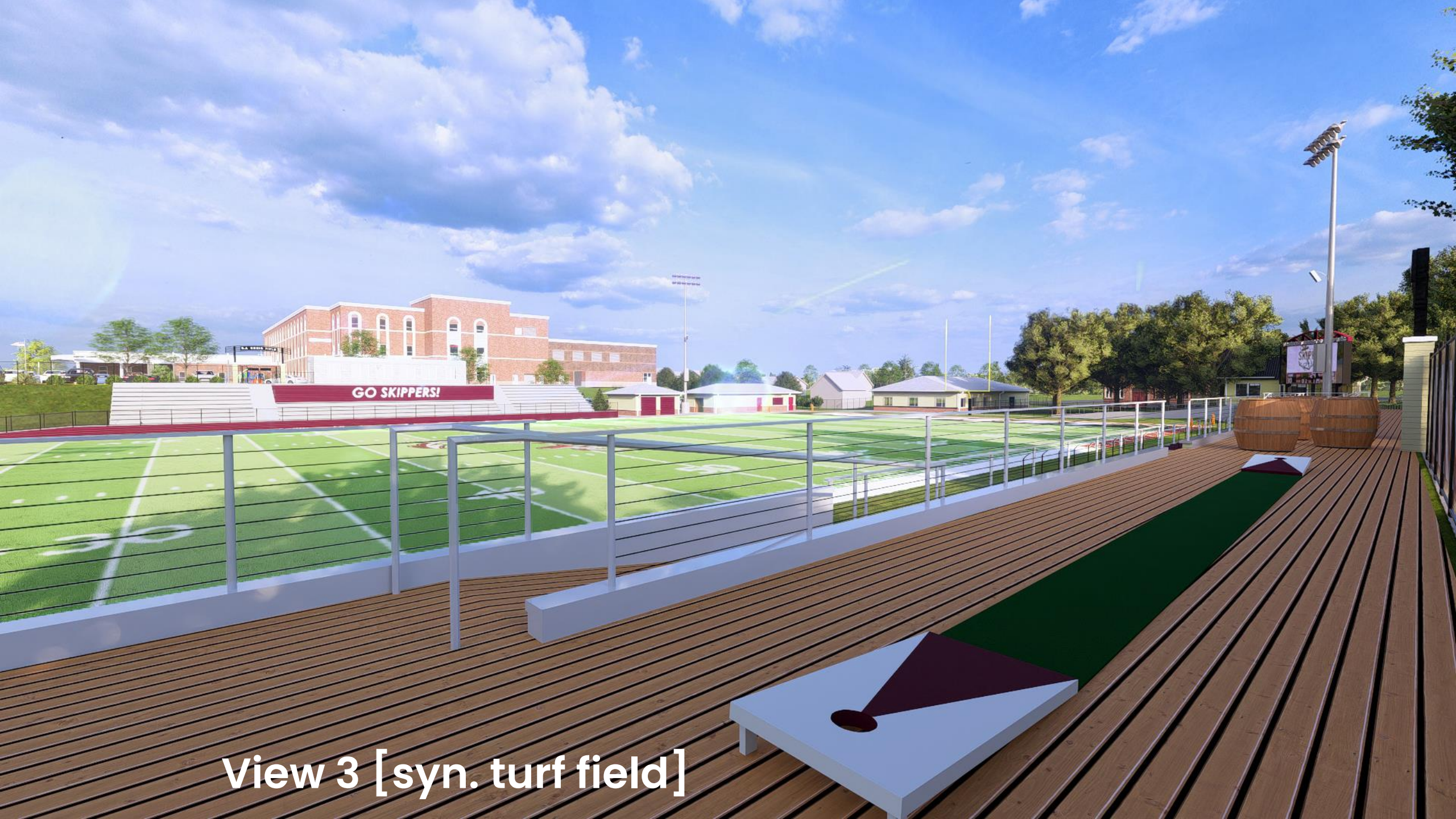

View 3 [syn. turf field]



# Questions?

