



Purchasing Services Department  
1900 W Olive Ave  
Burbank, CA 91506  
[www.burbankusd.org](http://www.burbankusd.org)

**CONTRACTOR'S REQUEST FOR INFORMATION**

**BID 2425-003 AQUATIC CENTER MODERNIZATION  
AT BURBANK HIGH SCHOOL**

**From:**

\_\_\_\_\_  
Company

\_\_\_\_\_  
Contact

\_\_\_\_\_  
Phone

\_\_\_\_\_  
Date

\_\_\_\_\_  
Urgency

Question:

Proposed Solution:

Response from Owner:

By: \_\_\_\_\_

Date: \_\_\_\_\_

**Questions must be emailed to Dennis Maxwell,  
[dennismaxwell@burbankusd.org](mailto:dennismaxwell@burbankusd.org) by 12:00 pm, Friday, October 18, 2024**

## ANCHORS AND ACCESSORIES MODEL - CUP ANCHOR

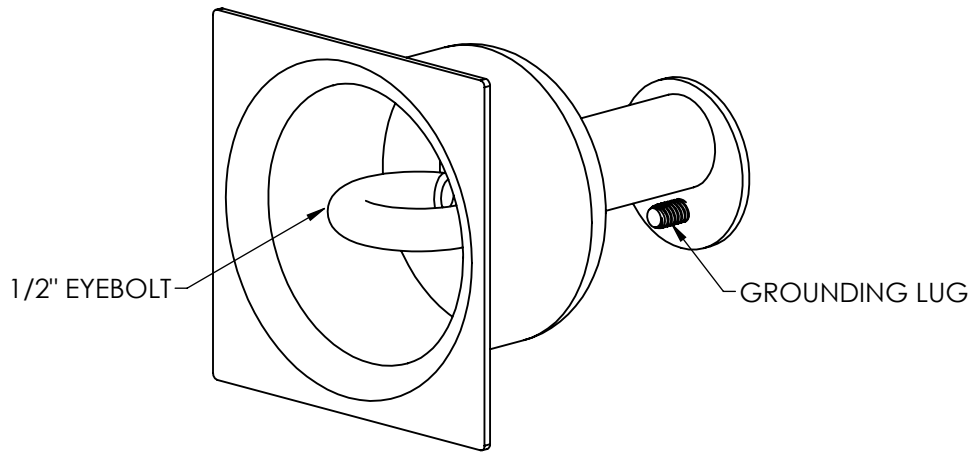
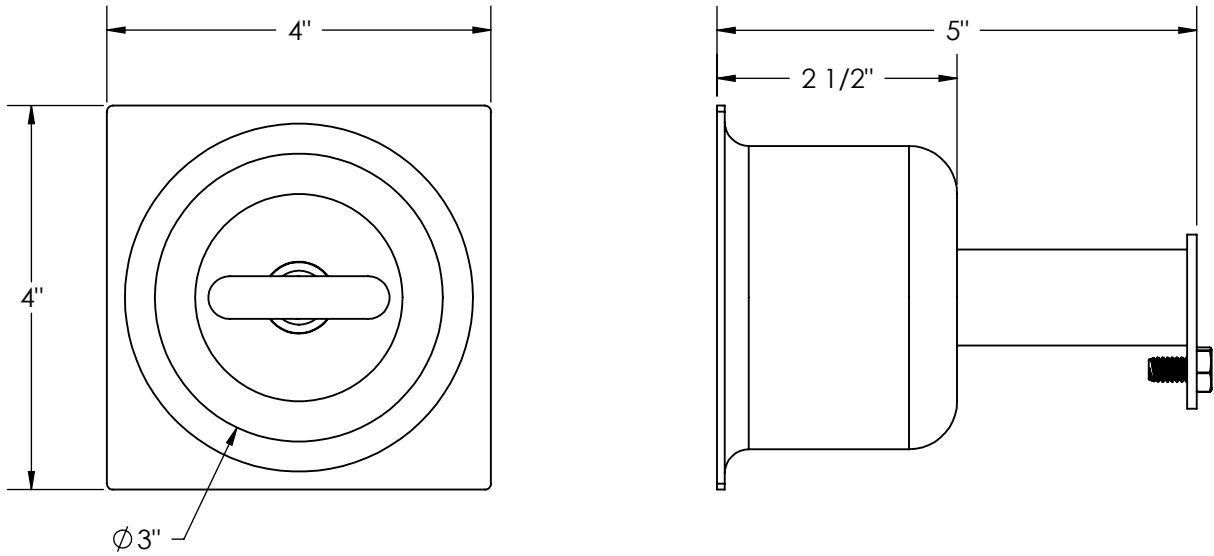

**NOTE:**

**1** DIMENSIONS VARY WITH SPECIFIC APPLICATIONS.  
 SPECIFICATIONS ARE NOMINAL AND ARE SUBJECT TO CHANGE.  
 PLEASE CONTACT SPECTRUM PRODUCTS FOR CUSTOM APPLICATIONS.



7100 Spectrum Lane  
 Missoula, Montana 59808  
 406.542.9781 \* 800.791.8056  
 Fax: 406.542.1158  
 www.spectrumproducts.com

### ENGINEERING DATA

PRODUCT:	CUP ANCHOR
PRODUCT #:	58316
REVISION:	A
MATERIAL:	304 SERIES STAINLESS STEEL

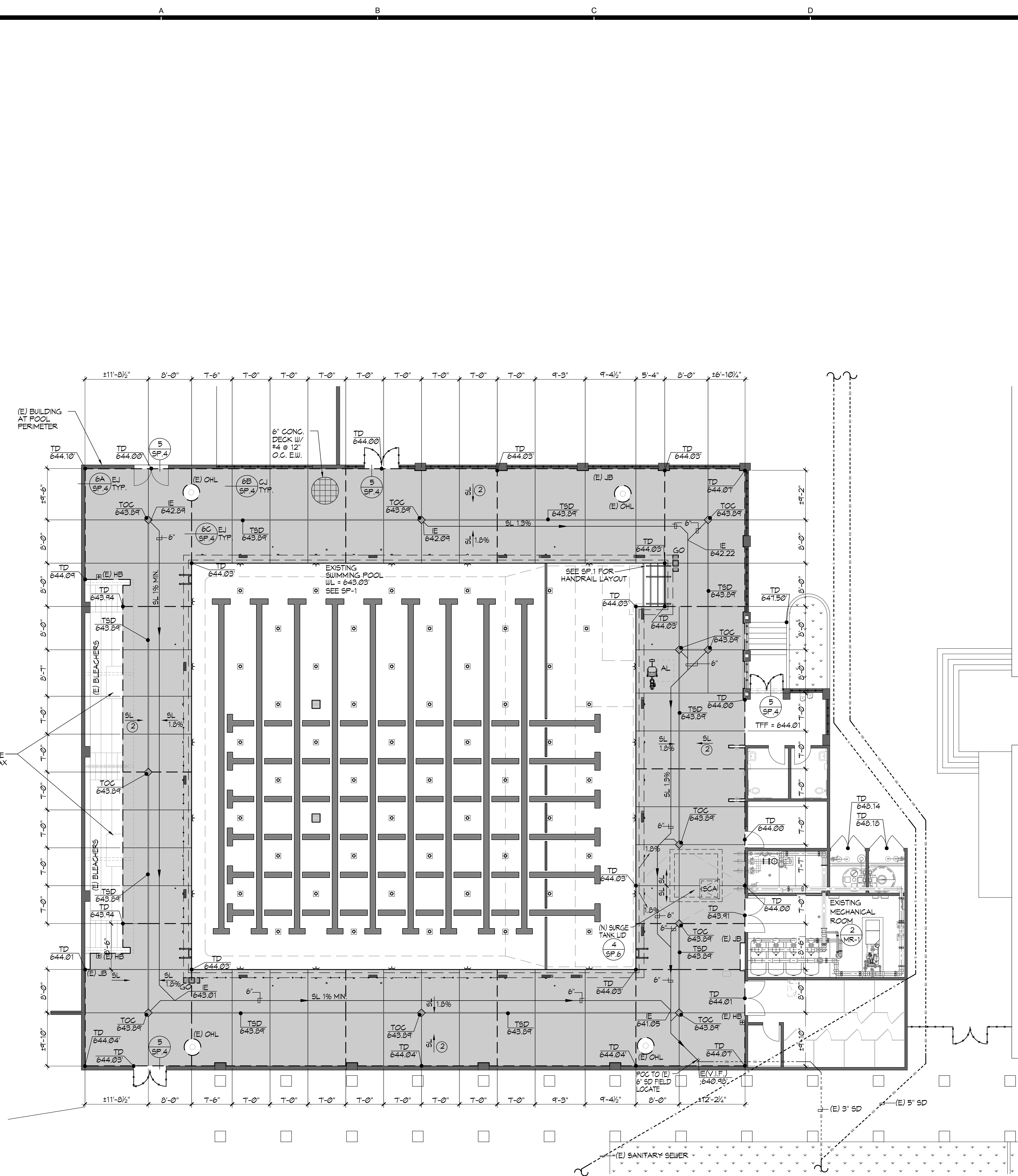

**(E) SWIMMING POOL DATA**

SURFACE AREA	=	6,204 SQ. FT.
PERIMETER	=	325 FT.
DEPTH	=	3'-0" TO 7'-3"
VOLUME	=	302,000 GAL.
6 HR TURNOVER	=	840 GPM

**LEGEND**

- EJ— = EXPANSION JOINT
- CJ— = CONTROL JOINT
- TSD = TOP OF SLOT DRAIN
- TOC = TOP OF CLEAN-OUT
- AL = ACCESSIBLE LIFT
- GO = GUTTER OUTLET
- (E) HB = HOSE BIBB
- (E) JB = JUNCTION BOX
- OHL = OVERHEAD LIGHT
- SL = SLOPE DIRECTION
- WL = WATERLEVEL
- TD = TOP OF DECK
- TFF = TOP OF FINISHED FLOOR
- I.E. = INVERT ELEVATION
- P.O.C. = POINT OF CONNECTION
- (E) = EXISTING
- V.I.F. = VERIFY IN FIELD

**GENERAL NOTES**

1. VERIFY EXISTING SIGNAGE PLACEMENT WITH HEALTH DEPT.
2. DECKS SHALL HAVE 1.5% MIN. SLOPE AND 1.0% MAX. SLOPE TO DRAINS.
3. ALL POOL DECKING SHALL BE NON-SLIP AND NON-ABRASIVE MEDIUM BROOM FINISH WITH MIN. 4 FOOT WIDTH TYP. NATURAL GRAY CONCRETE UNLESS OTHERWISE NOTED.
4. FIRE SAFETY DURING CONSTRUCTION AND DEMOLITION SHALL BE IN CONFORMANCE WITH CFC CHAPTER 33
5. SURGE CHAMBER LOCATION IS APPROXIMATE, PLEASE VERIFY EXACT LOCATION IN FIELD.

**CODE COMPLIANCE**

- 2022 CBC CHAPTER 31 B - PUBLIC POOLS
- 2021 INTERNATIONAL SWIMMING POOL AND SPA CODE (CBC 3104)

AGENCY  
PTN\_64337-110 APPL\_03-122682



**FLEWELLING & MOODY**  
architecture planning interiors

HEADQUARTERS OFFICE:  
815 Colorado Blvd, Suite 200  
Los Angeles, CA 90041  
323.543.8300  
E-Mail: fm-passaden@flewelling-moody.com

ANTELOPE VALLEY OFFICE:  
1035 West Lancaster Boulevard  
Lancaster, California 93534  
951.949.0771  
E-Mail: fm-lancaster@flewelling-moody.com

An Employee Owned Corporation

ARCHITECT  
CONSULTANT

**AQUATIC**  
DESIGN GROUP  
2226 Faraday Ave. Carlsbad, CA 92008  
AquaticDesignGroup.com  
760.438.8400

Drawn by	NMV	
Checked by	GSF	
Revisions		
No.	Date	Description

All dimensions must be checked at the job by the contractor who accepts full responsibility for their accuracy under the contract. These plans & the specifications in connection therewith have been prepared for a specific site. Any and all responsibility for their use in whole or in part on any other site is hereby disclaimed by Flewelling & Moody.

BURBANK UNIFIED SCHOOL DISTRICT  
BURBANK HIGH SCHOOL  
AQUATIC CENTER MODERNIZATION  
902 NORTH 3RD STREET  
BURBANK, CA 91502

SWIMMING POOL DECK PLAN

Job No. 2986.0000  
Date 11-18-2022  
**DP.2**

**SWIMMING POOL DECK PLAN** 1/8" = 1'-0"





**(E) SWIMMING POOL DATA**

SURFACE AREA	=	6,209 SQ. FT.
PERIMETER	=	325 FT.
DEPTH	=	3'-0" TO 7'-3"
VOLUME	=	302,000 GAL.
6 HR TURNOVER	=	840 GPM

**LEGEND**

UL	=	UNDERWATER LIGHT
X MD	=	MAIN DRAIN
GR	=	GRABRAIL
DM	=	DEPTH MARKER
NR	=	'NO RUNNING'
ND	=	'NO DIVING'
RA	=	ROPE ANCHOR
RP	=	RACING PLATFORM
BS	=	BACKSTROKE STANCHION
HR	=	HANDRAIL
AL	=	ACCESSIBLE LIFT
GO	=	GUTTER OUTLET
WP	=	WATER POLO GOAL
(E)	=	EXISTING
(N)	=	NEW

**GENERAL NOTES**

- COORDINATE SIGNAGE PLACEMENT WITH HEALTH DEPT PRIOR TO INSTALLATION.
- DECKS SHALL HAVE 1.5% MIN. SLOPE AND 1.0% MAX. SLOPE TO DRAINS.
- ALL POOL DECKING SHALL BE NON-SLIP AND NON-ABRASIVE MEDIUM BROOM FINISH WITH MIN. 4 FOOT WIDTH TYP. NATURAL GRAY CONCRETE UNLESS OTHERWISE NOTED.
- FIRE SAFETY DURING CONSTRUCTION AND DEMOLITION SHALL BE IN CONFORMANCE WITH CFC CHAPTER 93

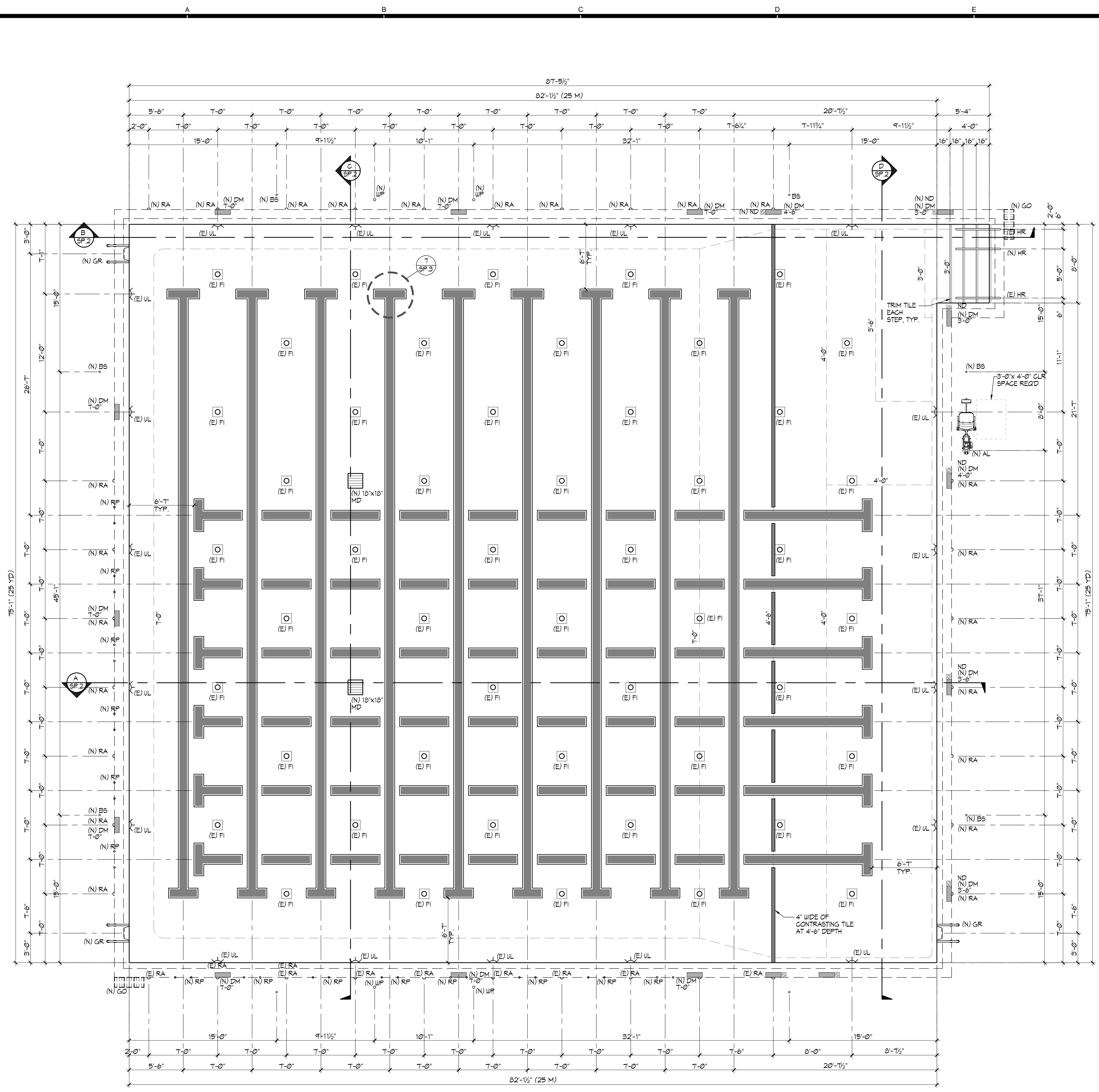

**SWIMMING POOL LAYOUT PLAN**

1/4" = 1'-0"

AGENCY  
PTN\_64337-110 APPL\_03-122682

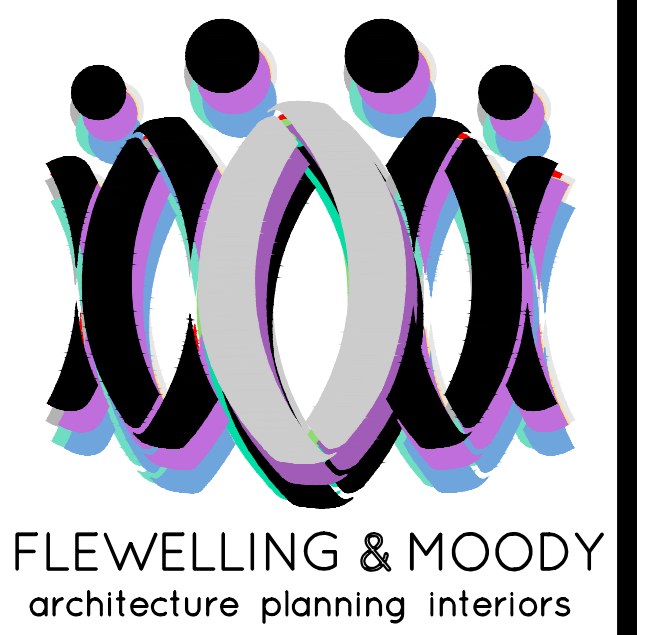

HEADQUARTERS OFFICE:  
815 Colorado Blvd, Suite 200  
Los Angeles, CA 90041  
323.543.8300  
E-Mail: fm-pasadena@flewelling-moody.com

ANTELOPE VALLEY OFFICE:  
1035 West Lancaster Boulevard  
Lancaster, California 93534  
661.949.0771  
E-Mail: fm-lancaster@flewelling-moody.com

An Employee Owned Corporation

ARCHITECT  
CONSULTANT



Drawn by: NMV  
Checked by: GSF

No.	Date	Description

All dimensions must be checked at the job by the contractor who accepts full responsibility for their accuracy under the contract. These plans & the specifications in connection therewith have been prepared for a specific site. Any and all responsibility for their use in whole or in part on any other site is hereby disclaimed by Flewelling & Moody.

BURBANK UNIFIED SCHOOL DISTRICT  
BURBANK HIGH SCHOOL AQUATIC CENTER MODERNIZATION  
902 NORTH 3RD STREET  
BURBANK, CA 91502

SWIMMING POOL LAYOUT PLAN

Job No: 2986.0000  
Date: 11-18-2022  
SP.1



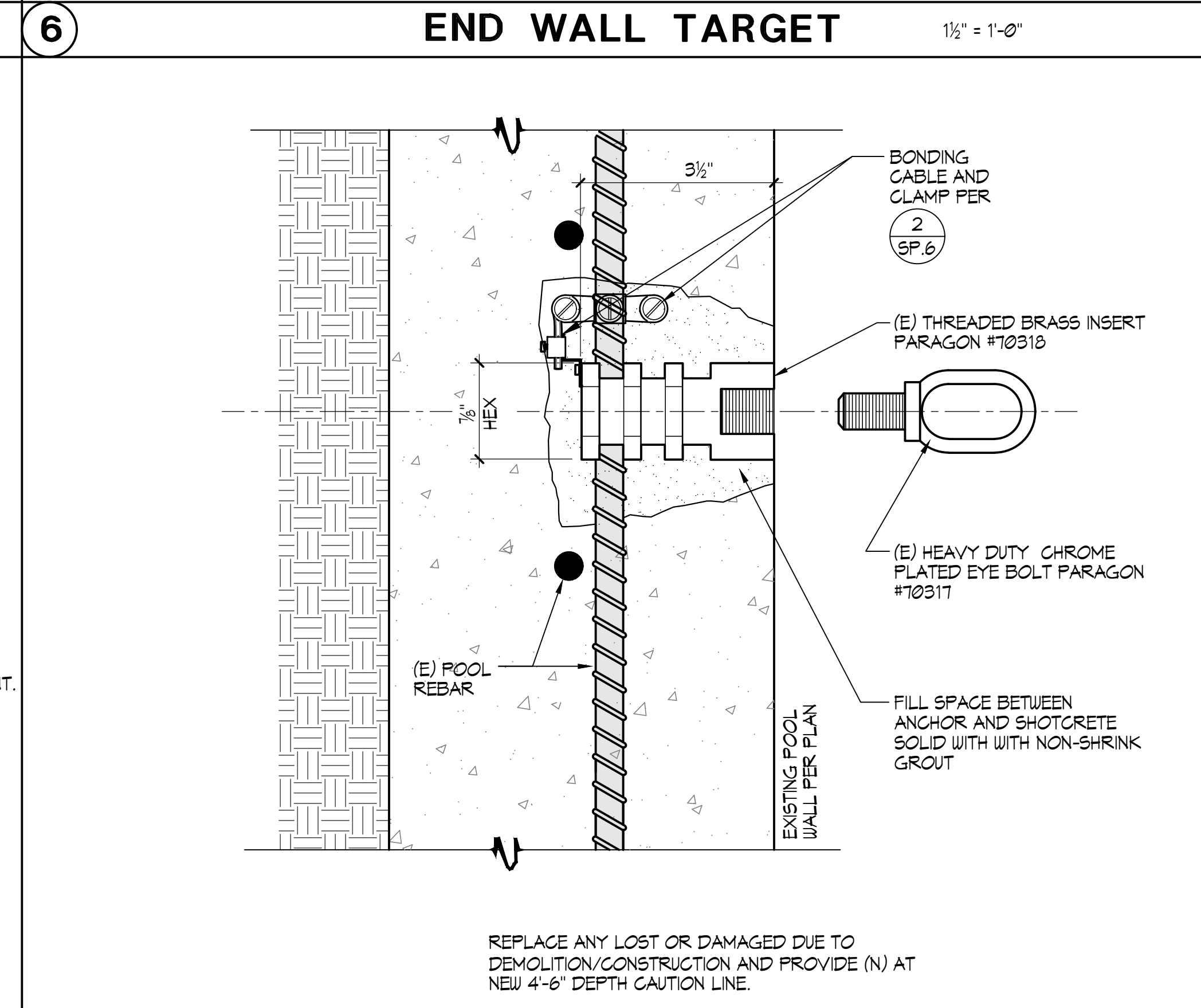
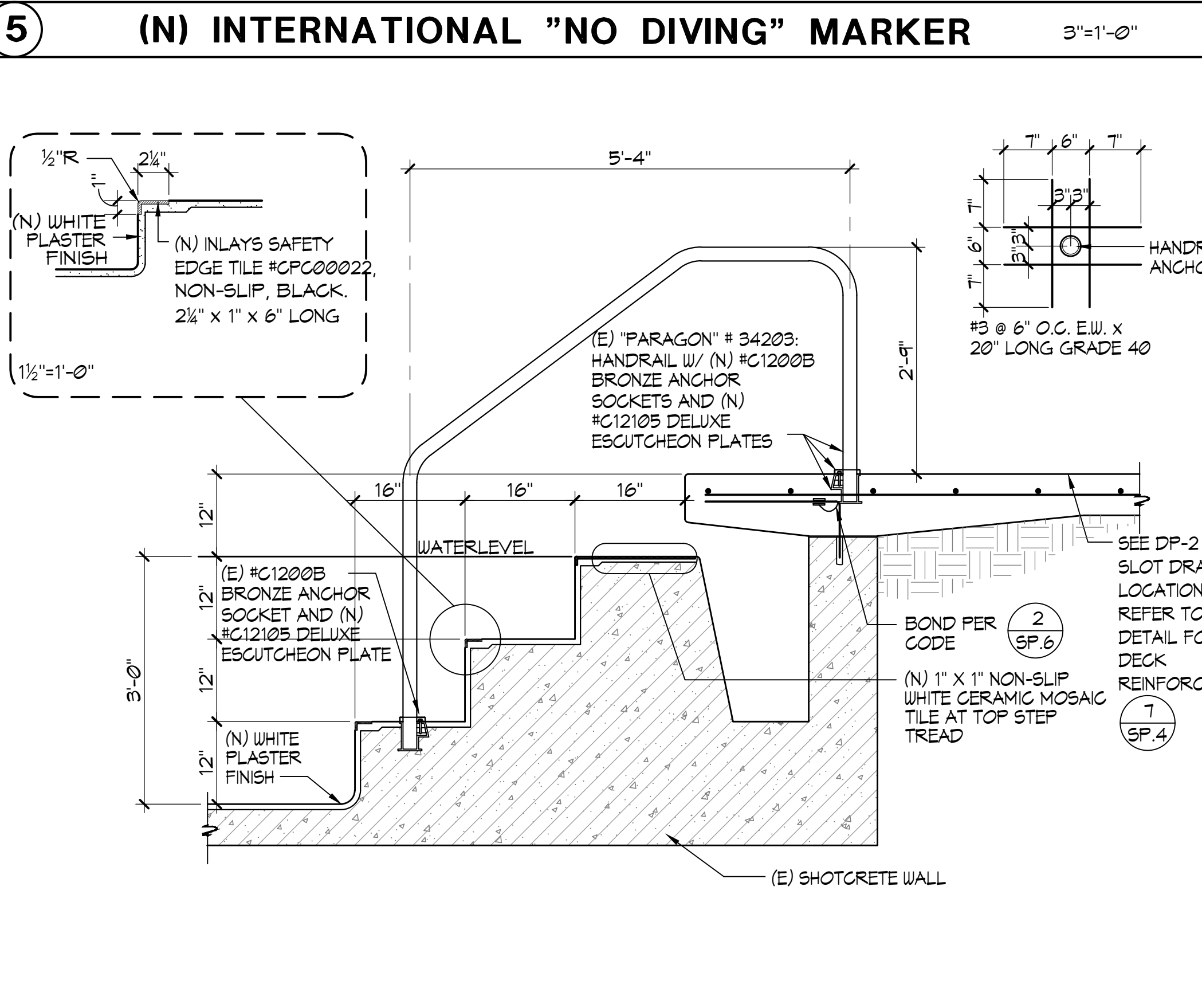
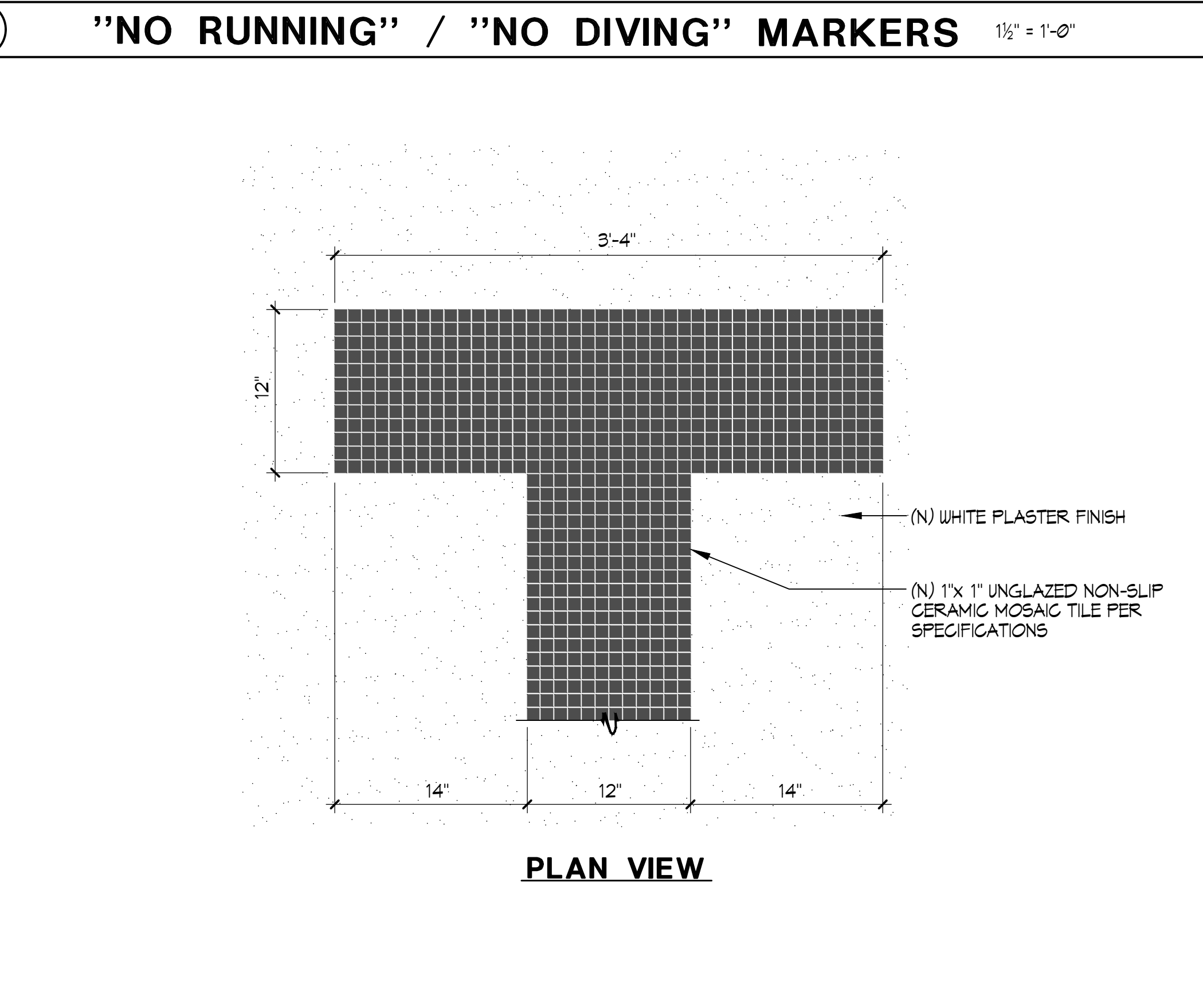
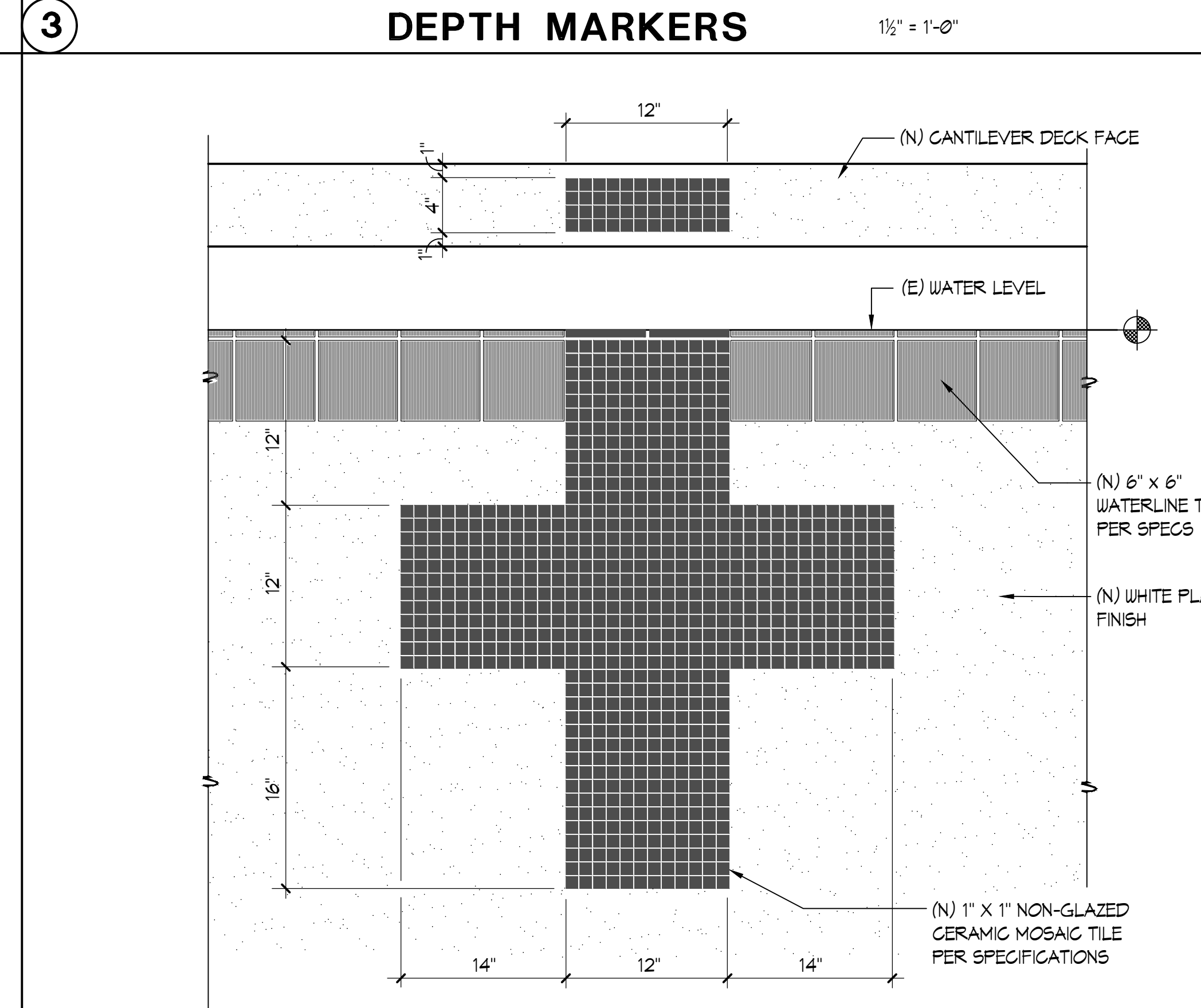
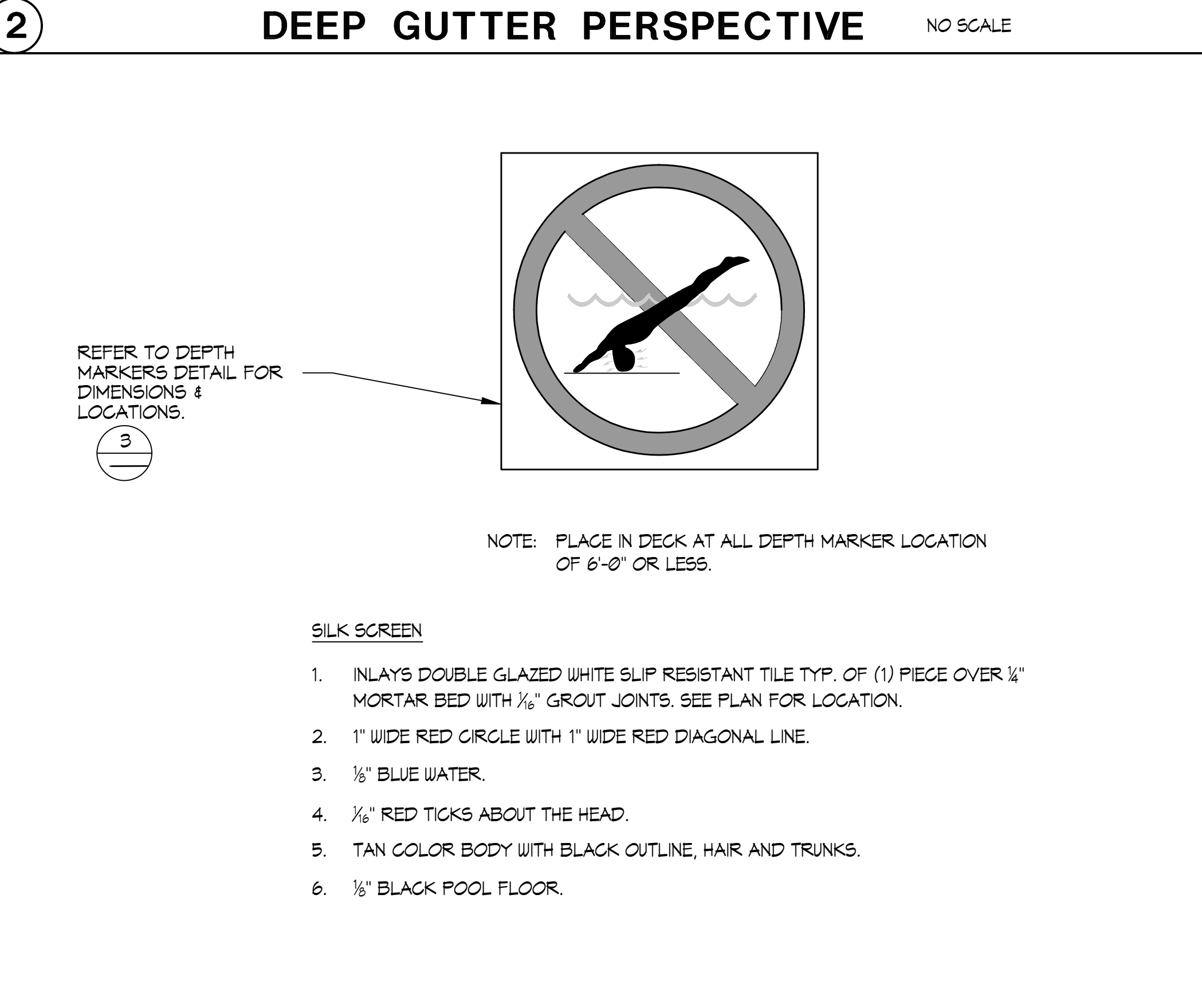
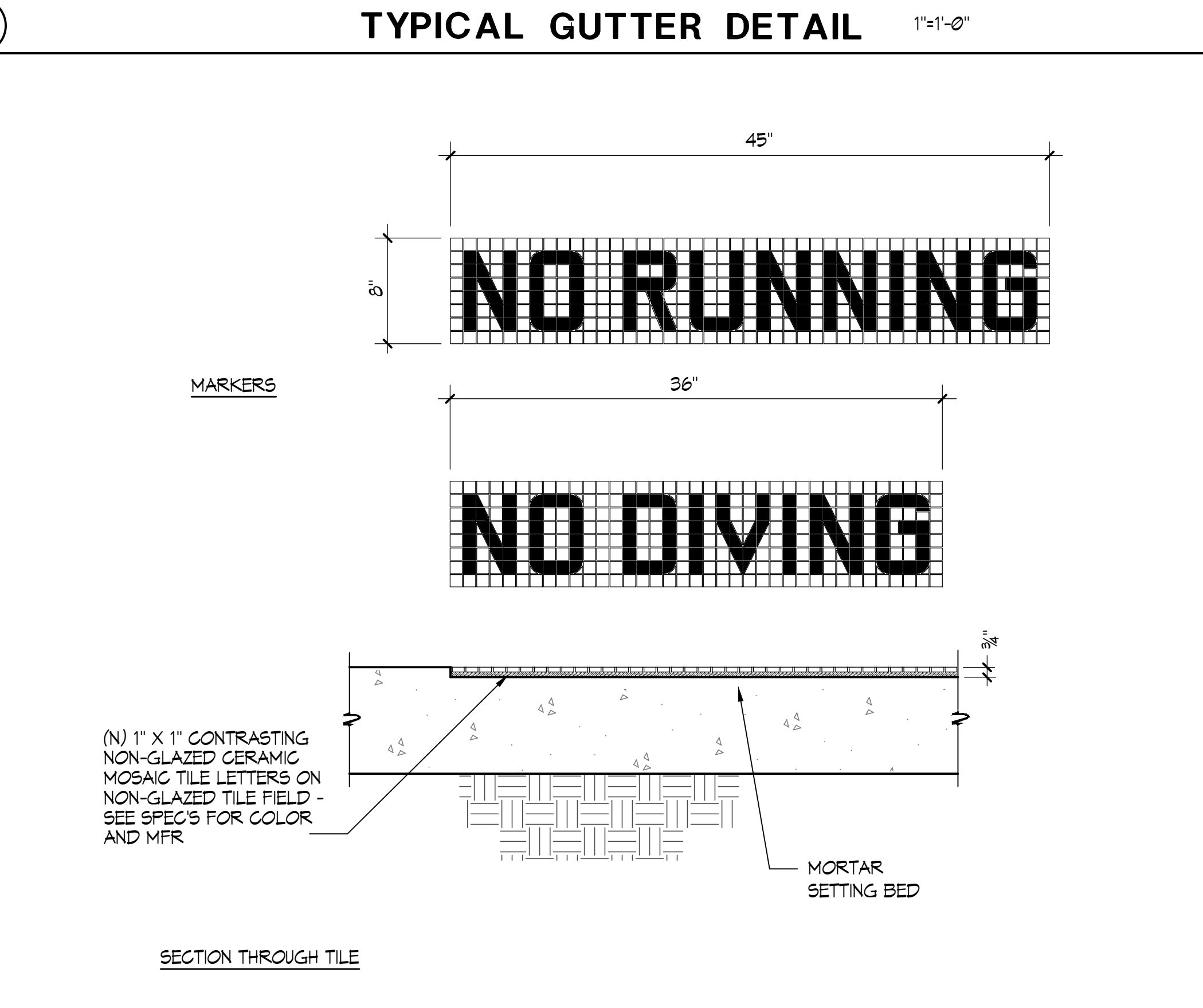
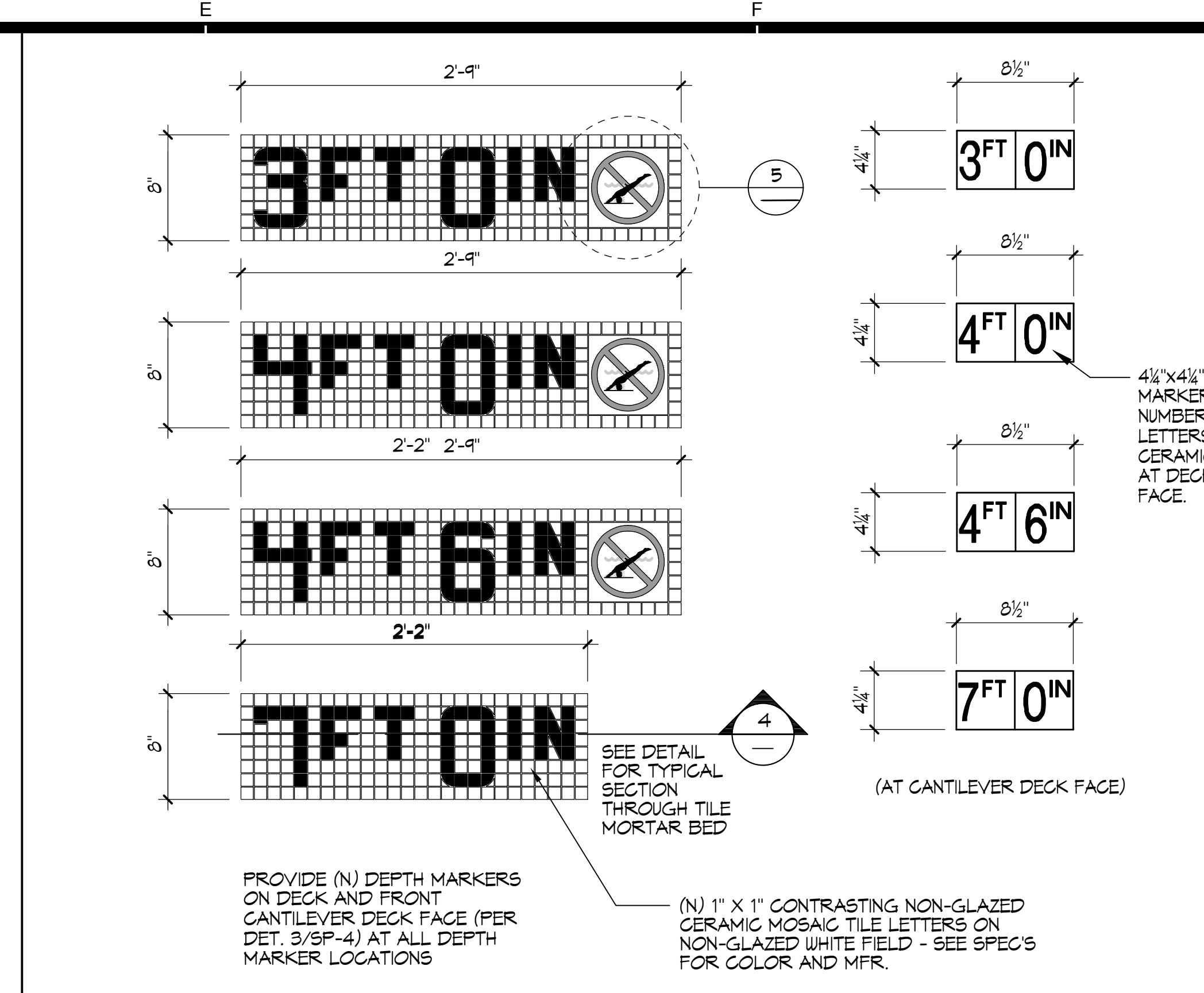
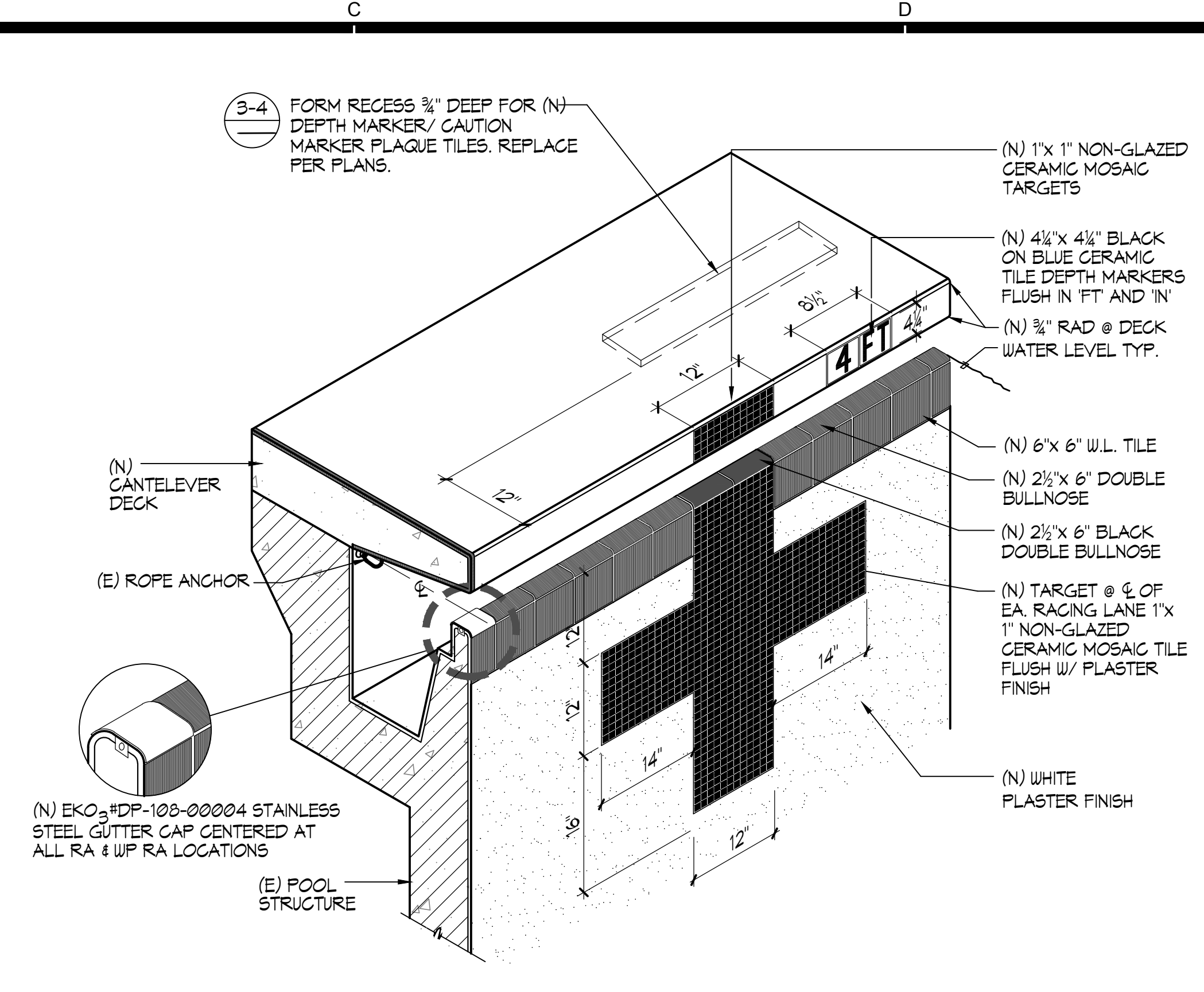
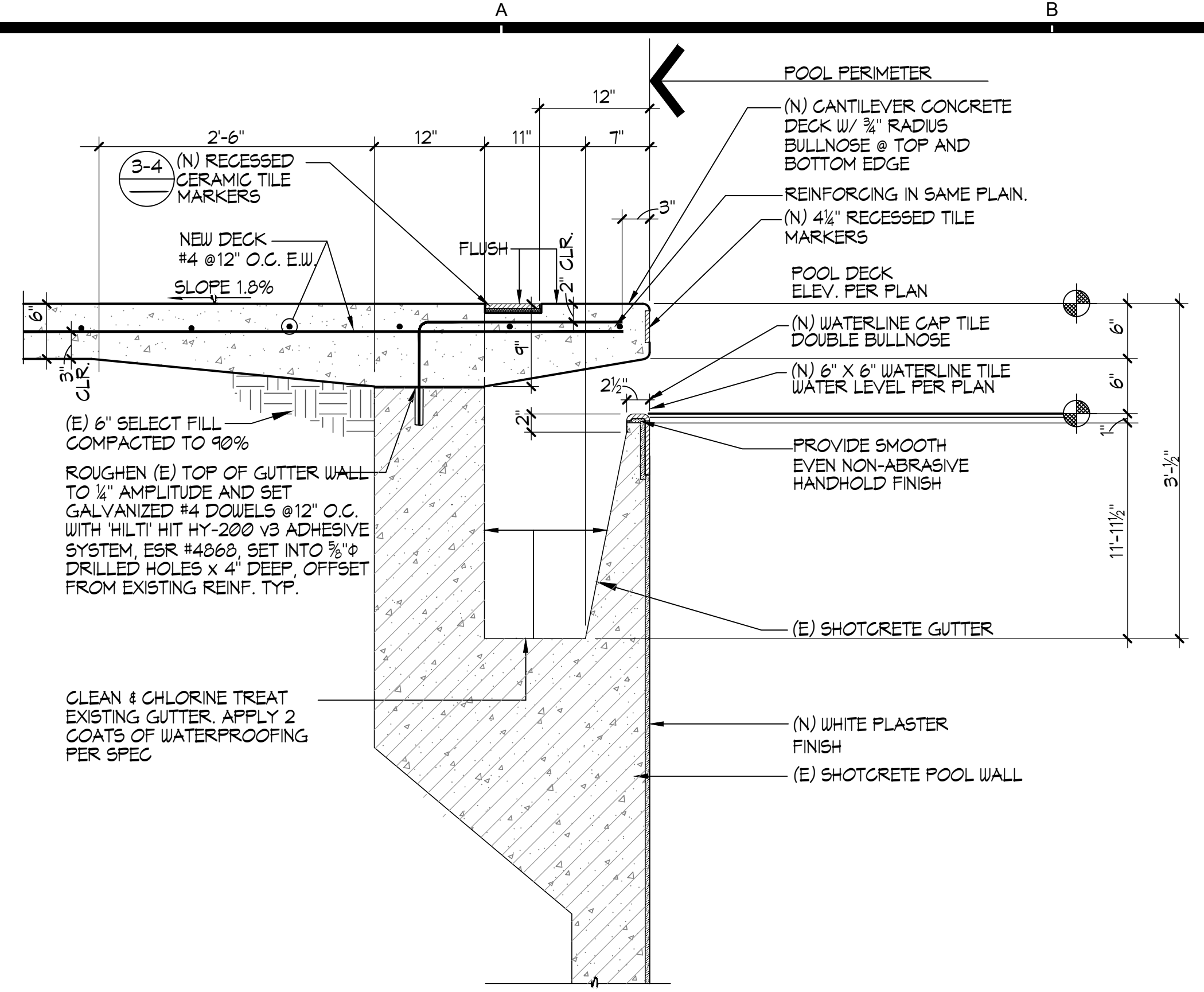

AGENCY

PTN\_64337-110 APPL\_03-122682

**FLEWELLING & MOODY**  
architecture planning interiors

HEADQUARTERS OFFICE:  
815 Colorado Blvd, Suite 200  
Los Angeles, CA 90041  
323.543.8300  
E-Mail: fm-pasadena@flewelling-moody.com

ANTELOPE VALLEY OFFICE:  
1035 West Lancaster Boulevard  
Lancaster, California 93534  
951.949.0771  
E-Mail: fm-lancaster@flewelling-moody.com

An Employee Owned Corporation

ARCHITECT

**AQUATIC DESIGN GROUP**  
2226 Faraday Ave. Carlsbad, CA 92008  
AquaticDesignGroup.com  
760.438.8400

CONSULTANT

DESIGNED BY: NMV

CHECKED BY: GSF

NO. \_\_\_\_\_

DATE \_\_\_\_\_

DESCRIPTION \_\_\_\_\_

All dimensions must be checked at the job by the contractor who accepts full responsibility for their accuracy under the contract. These plans & the specifications in connection therewith have been prepared for a specific site. Any and all responsibility for their use in whole or in part on any other site is hereby disclaimed by Flewelling & Moody.

BURBANK UNIFIED SCHOOL DISTRICT  
BURBANK HIGH SCHOOL AQUATIC CENTER MODERNIZATION  
902 NORTH 3RD STREET BURBANK, CA 91502

DETAILS

JOB NO. 2986.0000

DATE 11-18-2022

SP.3