

nSide | Lockdown™

What it is

nSide|Lockdown™ is a mobile app that gives your school faculty the ability to manage emergencies with the push of a button.

How you can use it

Users will have the ability to initiate a lockdown sequence for their campus and send notification to local emergency management agencies simply by tapping a few buttons.

How to register

You can **register** for an account with nSide at nside.io/register

Download the app

Once you have registered, you will need to **Download the App** to your device.



Log in

When you open the **nSide|Lockdown** app, you will need to login with your nSide credentials. This can be done by clicking **Log In** at the top of the screen and then **Continue** when prompted.



Once logged into the app, you will see four types of emergency alerts to choose from:

- 1 LOCKDOWN
- 2 POLICE
- 3 MEDICAL
- 4 FIRE

nSide | Lockdown™

Test Alerts

To send a **test notification alert** in the app, the user can press and hold the alert notification for at least 1 second, but **not more than 5 seconds**. The test notification alert will only be sent to the user who sent it. The user will receive a push notification and an email.

Real Alerts

To send a **REAL ALERT** in the app, the user can press and hold the alert notification for at least **5 seconds**.

THE APP WILL SEND A **LIVE EMERGENCY NOTIFICATION ALERT** TO THE USERS WHO HAVE BEEN DESIGNATED TO RECEIVE ALERTS FOR THE DISTRICT OR BUILDING DISPLAYED AT THE TOP OF THE APPLICATION SCREEN.

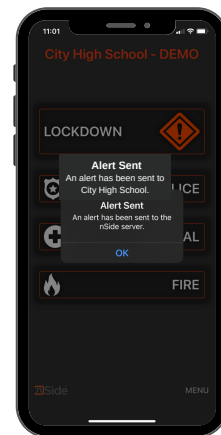

NOTE:
WHEN A REAL ALERT IS SENT, 911 IS AUTOMATICALLY NOTIFIED

Admin Messages*

Within the **menu** of the Lockdown app, there is also an option to send a **general admin message**. Once in the menu, simply tap **ADMIN MESSAGE**. Here you can type a general (non-emergency) message to your district or school's designated users.

**for authorized users only*

