

A. C. Corcoran Elementary School

QUESTIONS AND RESPONSES from Northwoods Civic Club Meeting

May 14, 2024

The following document is a consolidation of recent questions and comments from our stakeholders and community members regarding the construction of the new addition to A. C. Corcoran Elementary School. Capital Programs has responded to the received questions and concerns. We will continue to accept public comments and review concerns. Please email Capital@Charleston.k12.sc.us.

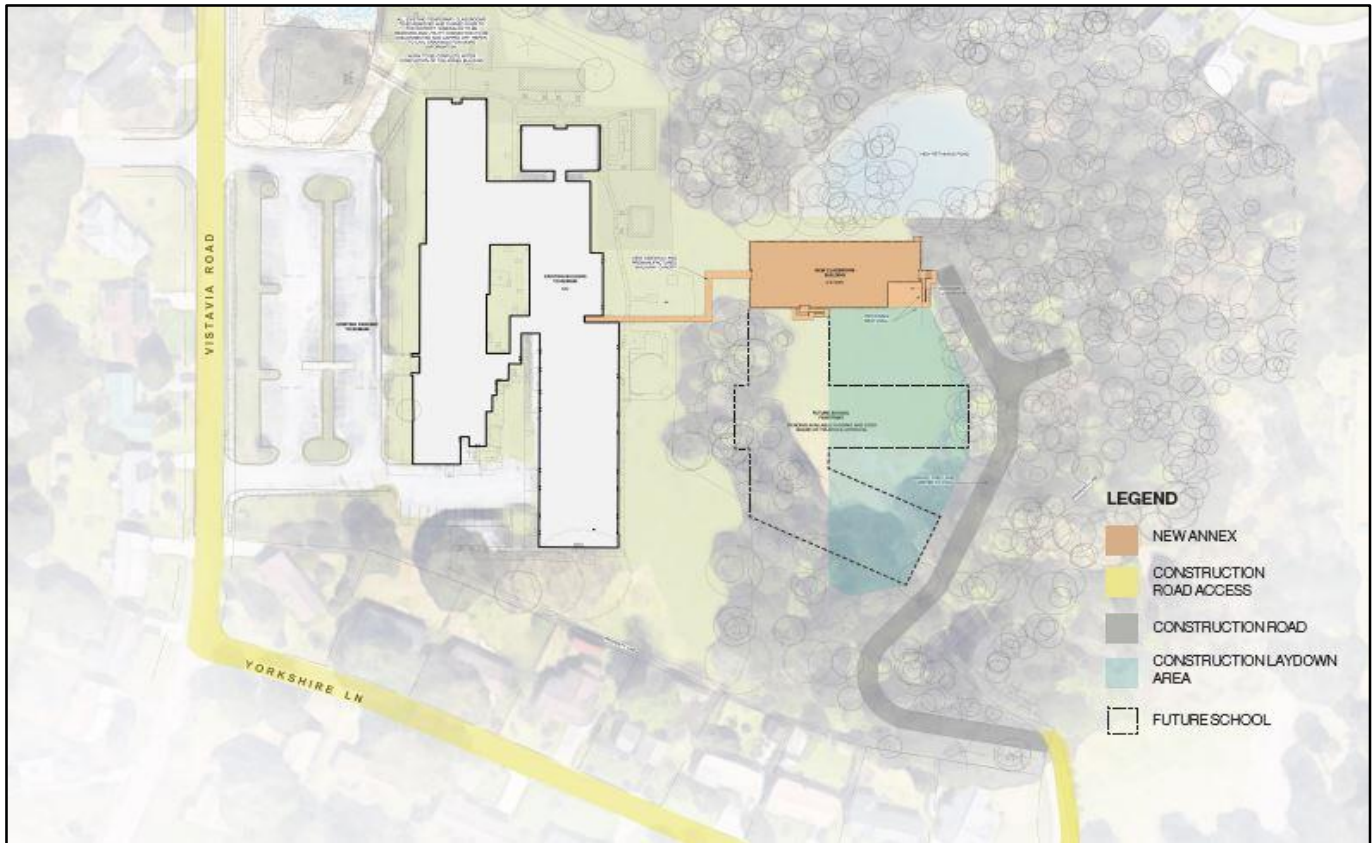

QUESTIONS/COMMENTS AND RESPONSES

1. *What is the construction activity behind AC Corcoran Elementary School on Vistavia Road all about?*

Response:

The Charleston County School District has embarked on an exciting journey to provide the A.C. Corcoran students with a future 2 story annex building (Phase 1). Once complete, the existing mobiles will be demolished as a part of this project. For more information, please visit our website where we provide monthly updates on school capital improvements. <https://www.ccsdschools.com/Page/7373>

2. The school sits adjacent to Northwood City Park. There is a construction crew tearing up a soccer field and removing trees. They informed me they are building a parking lot and new school building on the site. It was my understanding this was city park property not school property. Our adult community uses this soccer field every day. I train my dogs there, as do many others.

Response:

During the design and permitting phase, we found no MOU or park designation with the City of North Charleston. The area behind the school is owned by the Charleston County School District and the school agreed to use the land for the new annex. If you are interested in using CCSD property for events/activities, please contact our Planning and Real Estate Department where Angela Barnett is the Director. <https://www.ccsdschools.com/Page/215>

QUESTIONS/COMMENTS AND RESPONSES

3. The current school building was built in the 60s. One would think it would be more efficient to replace the existing single-story structure with a larger 2 story building and remove the trailers and use the current space the school sits on. The old building is an eye sore and tremendously out of date. The park green space and soccer field should be removed.

Response:

The Phase V (2023-2028) One Penny Sales Tax program includes a funded AC Corcoran project (Phase I – current construction for an annex building) and an unfunded AC Corcoran project (Phase II) for a new school. Phase II has not been approved for construction. If Phase II is funded and approved by the CCSD Board of Trustees (BOT) in the future, the new school will complement the new annex. The mobiles currently on site will be removed as a part of the Phase I new annex building project.

4. *What will be the capacity of the future school?*

Response:

The capacity of a future new AC Corcoran ES will be determined later if the project becomes funded, BOT approved, and a 5-year projection model is conducted to evaluate growth in the area.

5. *What is the capacity of the new annex?*

Response:

The capacity of the new annex is 280 students to consist of five 4th grades and five 5th grades. The other designated rooms that will serve children are the Reading Interventionist, ESOL Teacher, G/T class, Speech/OT, and Parenting Center (Parent Advocate and Parent Liaison).

QUESTIONS/COMMENTS AND RESPONSES

6. How does the district calculate future growth of students, based on the growth in the community?

Response:

Enrollment Projections are the building blocks of effective school district planning. They are used to determine allocations, establish budgeting, predict growth which impacts building capacity, and aid in the determination of potential attendance zone changes. Both Enrollment Projections and Enrollment Forecasting represent future enrollment but take into account past and current trend data.

CCSD currently utilizes the following enrollment methodology:

- **Survival Cohort Methodology or Grade Progression Ratio Model**
- **Live Birth Data**
- **Planned Growth and Development (permitted only) – Student Yield Count**
- **Live/Attend Analysis**
- **45 Day Certified Memberships**
- **School Programming and Rezoning**
- **Empirical Understanding of each Constituent District and Geographic area**

The following table shows the past 7 years of enrollment and the 5 year projection for A.C. Corcoran ES:

Charleston County School District
A. C. Corcoran (Data Generated in March 2024)

Yellow=Actual Numbers Blue=Current Year Actual Enrollment Green= Future Projections

FY2017	FY2018	FY2019	FY2020	FY2021	FY2022	FY2023	FY2024	FY2025	FY2026	FY2027	FY2028	FY2029	FY2030
710	662	767	772	665	636	748	708	728	736	747	732	731	720

*Future projections are subject to change yearly.

QUESTIONS/COMMENTS AND RESPONSES

7. *Where will construction vehicular enter and exit?*

Response:

Construction traffic will travel on Vistavia Road, turn left onto Yorkshire Lane, turn left onto Greenridge Road, and turn left onto the construction road. Please see map on page 1.

8. *With construction dump trucks coming down the narrow road, who will repair the road if damaged?*

Response:

CCSD's Capital Programs Division will be taking weekly/biweekly photos of Yorkshire Rd., Vistavia Rd. and Greenridge Rd. to monitor any damage caused by construction vehicles. Photos will be taken of current road conditions to establish a baseline of road conditions. Any damage caused by our construction project will be addressed.

9. *The current school is built for 450 students, but you mentioned the project will be built for future growth, how will this project accommodate the 800 to 900 students in the overcrowded building?*

Response:

A.C. Corcoran Elementary School is built for 600 students with additional mobile classrooms and support services rooms/offices bringing the capacity up to 850 students.

The new annex will accommodate 280 students comprised of 4th and 5th grades. The current number of 4th and 5th graders are 203 students. The difference is 77 students as represents opportunity for growth.

(Response continued on next page.)

QUESTIONS/COMMENTS AND RESPONSES

The current plan is to relocated all classrooms and support services into the new addition so that all mobiles can be removed from the school campus. This will provide the necessary area for future growth.

10. *Will kids have access to the open field shown on the plans?*

Response:

During construction, the open field area behind A.C. Corcoran ES will be used as a construction laydown area and no access to the school or public will be allowed. After construction and once the project is completed, the school will have access to the field area and all areas inside of the new annex fence perimeter.

11. *Where will the construction laydown area be located?*

Response:

The location of the construction laydown area will be confirmed by General Contractor, Samet Construction. Please see map on page 1.

Links:

[Phase 5 \(2023-2028\) Final Project List](#) (dated February 26, 2024)

[Capital Projects by Constituent District](#) (monthly updates)