



**BID 2024-25 02 - KITCHEN REPAIRS**

**ANDERSON ELEMENTARY**

**8902 Hewitt Pl.**

**Garden Grove, CA 92844**

# SITE: ANDERSON #3

- 1) **3 COMPARTMENT SINK:**
  - a) DEMO- Remove/ discard existing 2 compartment sink
  - b) PLUMBING- Move existing hot and cold water line
  - c) PLUMBING- Add Floor Sink
  - d) PLUMBING- Install Split Sink Valves for Ecolab Chemical Dispensers on hot and cold water supply with  $\frac{1}{2}$  in Compression x  $\frac{3}{8}$  OD Compression Brass Quarter Turn Dual Shut-Off valve
  - e) **INSTALL- 1 new custom 3- compartment sink (OFCI)**
  - f) **INSTALL- 2 upper cabinets above 3- compartment sink (OFCI)**
- 2) **PREP SINK:**
  - a) DEMO- Remove/ discard existing prep sink
  - b) PLUMBING- Add hot and cold water lines from existing water supply from old 2 comp sink to the left for new prep sink
  - c) PLUMBING- Add Floor Sink
  - d) PLUMBING- Install Split Sink Valves for Ecolab Chemical Dispensers on cold water supply only with  $\frac{1}{2}$  in Compression x  $\frac{3}{8}$  OD Compression Brass Quarter Turn Dual Shut-Off valve
  - e) **INSTALL- 1 new custom prep sink based (OFCI)**
- 3) **HAND SINK:**
  - a) PLUMBING- Add hot and cold water lines from existing water supply to right side for hand sink
  - b) **INSTALL- 1 new hand sink (OFCI)**
- 4) **RATIONAL COMBI OVEN:**
  - a) PLUMBING- Add Floor Sink
  - b) ELECTRICAL- Add 2 new 15AMP, 208/230 V electrical outlets
  - c) PLUMBING- Add new cold water supply, need  $\frac{1}{2}$  Water line for Rational Oven with  $\frac{3}{4}$  Brass Full Port Ball Valve
  - d) PLUMBING- 6+6g Rational- Install 2 ea  $\frac{3}{4}$  Gas Lines with  $\frac{3}{4}$  Brass FIP x FIP Full Port Threaded Ball Valve
  - e) \*HOOD- Extend existing Hood to 60" from wall (OFOI)
  - f) **INSTALL- 1 new 6+6g Rational Combi Oven (OFOI)**
- 5) **AIR CURTAINS: Kitchen Doors and Hall or MPR doors if needed**
  - a) DEMO- Remove Existing Units and any necessary repair work
  - b) ELECTRICAL- Remove any existing outlet timer switches
  - c) **INSTALL- 2 new 42" air curtains with Door Limit Switches (OFCI)**
- 6) **A/C SPLIT UNIT:**
  - a) ELECTRICAL- Add new power supply for AC Unit
  - b) **INSTALL- 1 new A/C Split Unit (CFCI)- include concrete pads needed for compressor unit, sub pump, etc**
- 7) **FRP: New FRP on all walls except oven wall**
  - a) DEMO- Remove existing Stainless Steel on all walls
  - b) WALL COVERINGS- Install FRP on ALL walls in the kitchen (include removing surface mounted conduit, existing FRP and glue, dead switches/ unused panels)
  - c) ELECTRICAL/ PLUMBING- Reinstall all surface mounted conduit
- 8) **STAINLESS STEEL:**
  - a) WALL COVERINGS- Install Stainless Steel on oven wall (include caulking around hood and any gaps)
  - b) WALL COVERINGS- Add Stainless Steel Corner Guards to all walls
- 9) **PAINT:**
  - a) Paint remaining kitchen walls with no FRP or Stainless (including doorways, doors, etc)
- 10) **FLOORING: New Epoxy Flooring in all Kitchen/Storage Areas**
  - a) DEMO- Demo/remove existing flooring
  - b) FLOORING- Install new Epoxy Flooring in all of kitchen (including store rooms)
- 11) **CEILING:**
  - a) CEILING- Fill any existing holes in ceiling
  - b) CEILING- Paint ceiling
- 12) **ALARM KEYPAD:**
  - a) OFOI Alarm Keypad
- 13) **FRIDGE MONITORING:**
  - a) ELECTRICAL- Install 1 new electrical outlet
- 14) **DIGITAL DISPLAYS:**
  - a) ELECTRICAL- Install 1 new electrical outlet above the ceiling
- 15) **OUTLETS:**
  - a) ELECTRICAL- Install 2 new ceiling electrical Locking Outlets above serving line
  - b) ELECTRICAL- Install new wall electrical outlets above 89"
  - c) ELECTRICAL- Install new GFCI outlet
  - d) ELECTRICAL- Replace existing with GFCI outlet
  - e) ELECTRICAL- Label all new/existing outlets with Panel Breaker
  - f) ELECTRICAL- Label all new/existing Switches
- 16) **NEW KITCHEN EQUIPMENT**
  - a) \*INSTALL- 1 new 49" single sided milk cooler (OFOI)
  - b) \*INSTALL- 1 new 58" double sided milk cooler (OFOI)
  - c) \*INSTALL- 1 new reach-in single door freezer (OFOI)
  - d) \*INSTALL- 2 new reach-in 2 door refrigerator (OFOI)
  - e) \*INSTALL- 5 new 48"x24" storage racks (OFOI)
  - f) \*INSTALL- 1 new dunnage rack 21x60 (OFOI)
  - g) \*INSTALL- 1 new custom desk (OFOI)
  - h) \*INSTALL- 1 new prep table with lower shelf (OFOI)
- 17) **REPAIRS/ MISC WORK**
  - a) ELECTRICAL- Remove/reinstall lighting in front of oven hood
  - b) WALL COVERINGS- Frame in passthru window near oven
  - c) ELECTRICAL- Replace existing exhaust fan (CFCI)

All work needs to meet Orange County Health Department Codes

\*exclude from bid



# ANDERSON - NEW

Updated 11.6.24

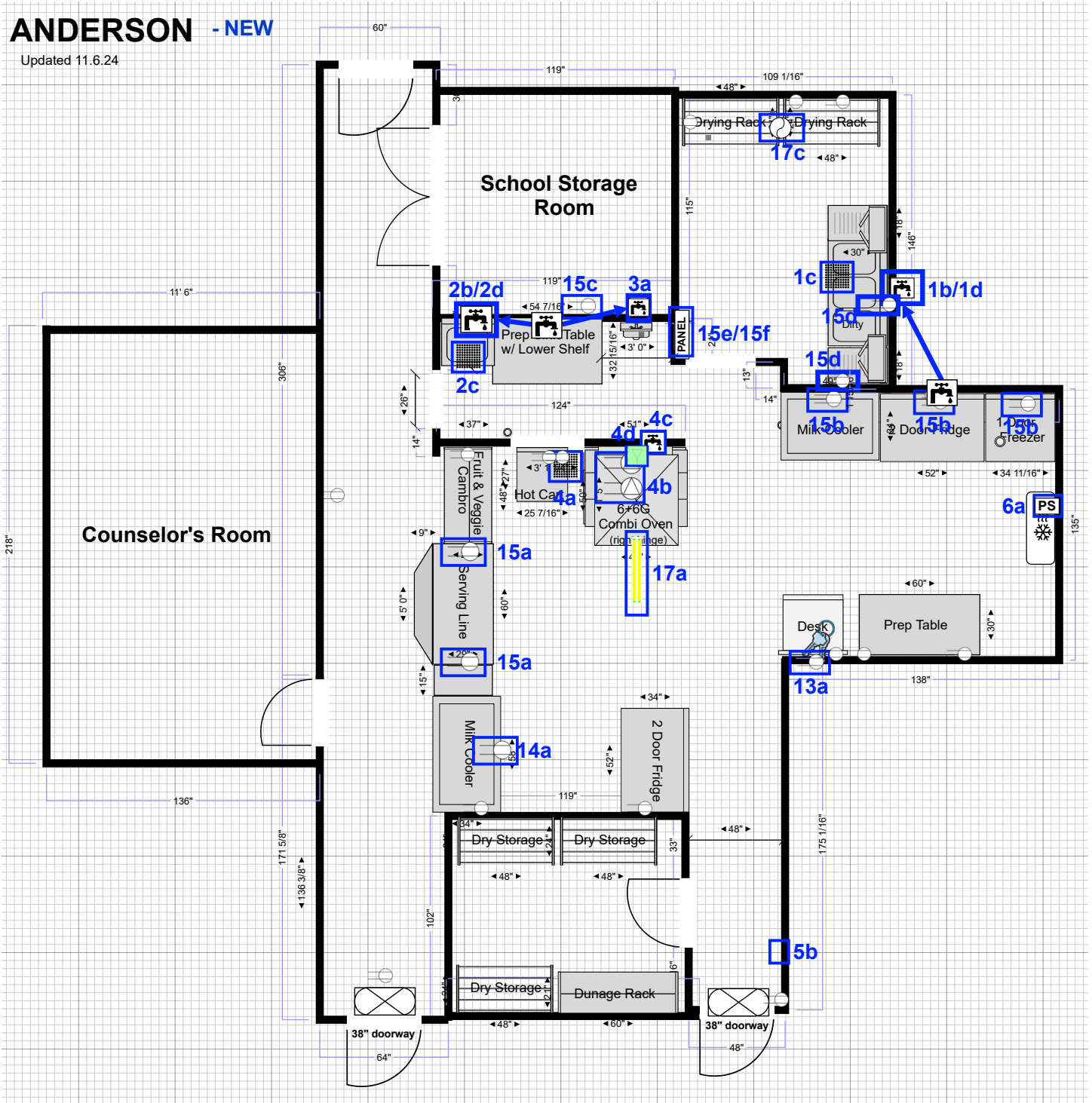

# ANDERSON - WALLS/CEILING

Updated 11.6.24

- PAINT
- FRP
- STAINLESS

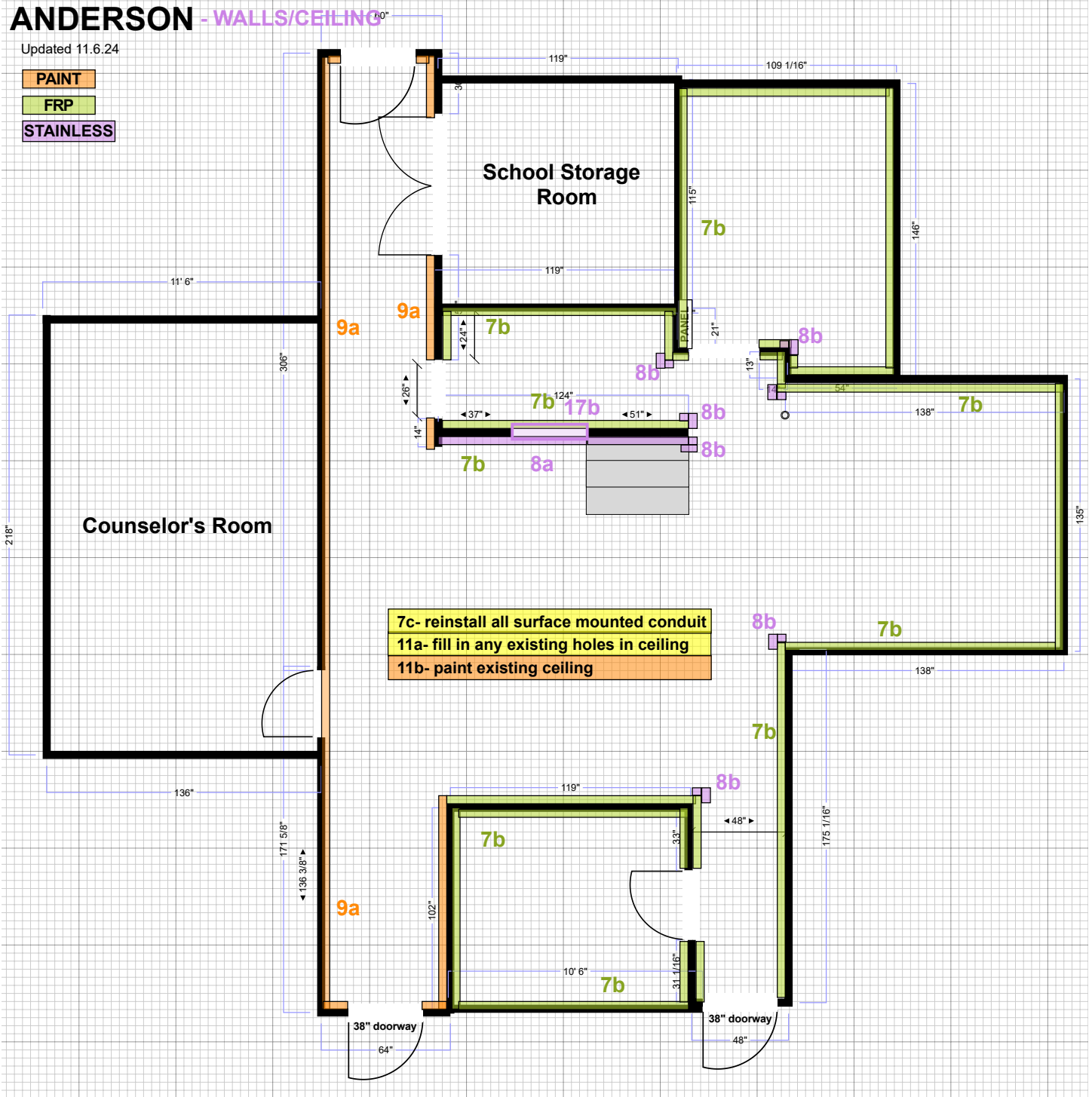

7c- reinstall all surface mounted conduit  
 11a- fill in any existing holes in ceiling  
 11b- paint existing ceiling



# ANDERSON - NEW EQUIPMENT

Updated 11.6.24

