



EFS
Smart Choice!

IT IS THE SOLE RESPONSIBILITY OF THE END-USER TO VERIFY ACCURACY OF FINAL SPECIFICATIONS, QUANTITIES, AND FINISHES. FIELD MEASUREMENTS SHOULD BE CONFIRMED AS NOTED.

FIELD VERIFICATION
This Plan incorporates building information compiled from various sources associated with this project and deemed as reliable. Conditions directly affecting the product or its installation must be field verified.
It is the Owner/ Architect/ Contractor's responsibility to notify Corbett Inc. if site conditions have changed or are not depicted on our drawing that would impact the furniture layout after completed field verified dimensions have been obtained.

CODE REQUIREMENTS
Corbett Inc. typically creates Plans based upon Corbett Inc.'s interpretation of applicable sections of the 2018 International Building Code (IBC). However, due to matters beyond Corbett Inc.'s control (such as contrary information and/or incomplete information from Owner/ Architect/ Contractor), this Plan may not be IBC compliant. As a result and notwithstanding anything to the contrary now or hereafter stated in any contract to which Corbett Inc. is a party, Corbett Inc. disclaims any responsibility or liability to insure that this Plan complies with federal, state or local statute, regulation or code section (including, but not limited to, the IBC). Corbett Inc. recommends that these Plans and the resulting layouts be reviewed with a local fire inspector to verify compliance with all local building codes. Corbett Inc. disclaims responsibility for any such review and any claim or liability that may result from non-compliance with local building codes.

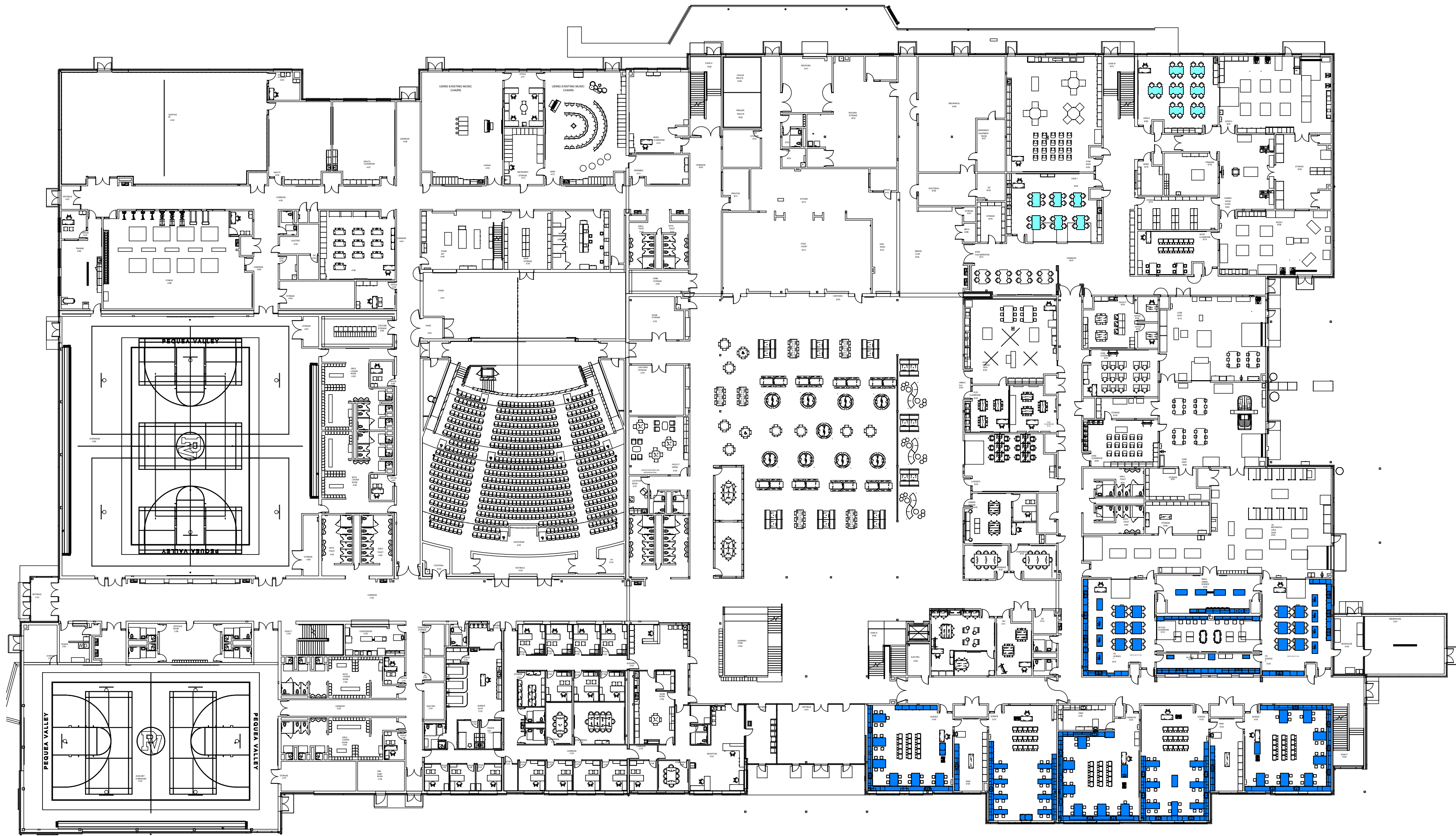

1st FLOOR

PEQUEA VALLEY SCHOOL DISTRICT

Quote:

DRAWN BY:

- REVISIONS:
- R2 - 05/24/2024
 - R3 - 9.11.2024
 - R5 - 10.25.2024

DATE: 11/7/2024

SHEET: 1/1

Scale 1/32" = 1'

** FURNITURE PLAN ONLY - NOT FOR CONSTRUCTION USE. **