



TOPICS

Purpose

- What is an Educational Specification
- What is the Process

Goals

- District Services Core Values
- Educational Specification Goals

Staff Survey

Focus Groups

- Space List and Definitions
- Site Test Fit

Hamilton Unified School District

Educational Specifications School Board Meeting

June 23, 2021

PURPOSE

Definition:

Educational Specifications

School Facilities Planning California Department of Education

- Linking Design of School Facilities to the Educational Program
- Form follows function
- The school facility does more than house the program; it is part of the program
- Educational Specifications are the vehicle the architect uses to translate the curriculum and the instructional program into a beautiful, economical, functional, educational environment

What the Educational Specification will Define

- Space definitions
- Size, Quantity, Utilities, Furnishing and Finishes
- Functional relationships between programs and uses
- Identification of space use efficiencies

THE PROCESS

Inclusive
Collaborative
Comprehensive
Visionary
Creative
Efficient

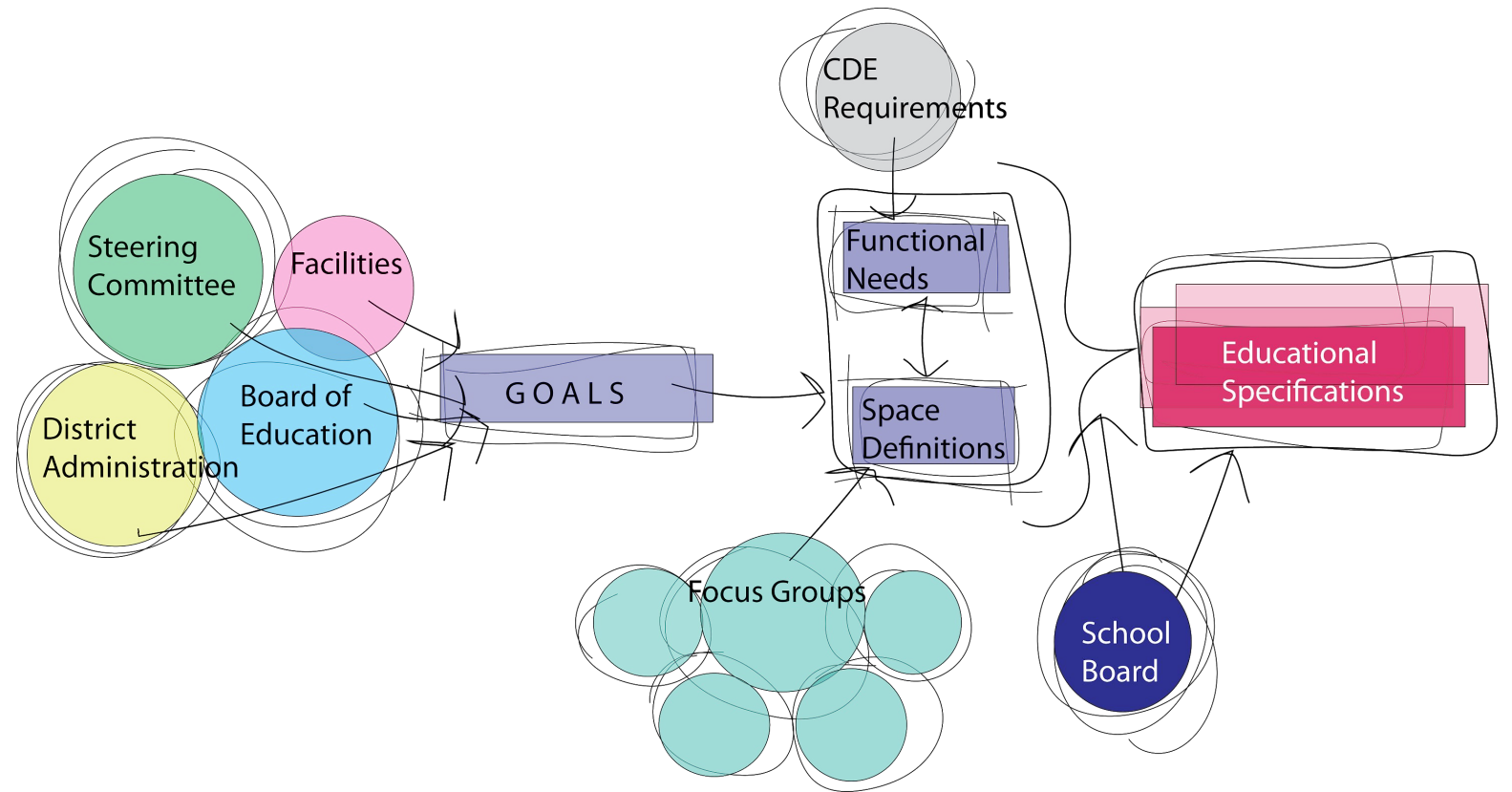

All our **DREAMS** can come true if we
have the courage to pursue them.

— WALT DISNEY

GOALS

Incorporating
the

District
Services Core
Values

- Student Focused
- Genuine
- Committed
- Teamtastic-Team/Enthusiastic
- Pro-Pos-Professional and Positive

GOALS

Educational Specifications Goals

How will your schools follow through on your goals and philosophies?

What will the schools that accomplish these things look like?

Hamilton Unified School District is committed to providing physical environments that support teachers, staff and students.

To this end, facilities need to provide:

- equal access to all
- comfortable, compassionate, welcoming environments and aesthetics
- spaces that enhance collaboration and embrace the Hamilton Community through transparency
- support for both college and career opportunities
- flexibility for a variety of innovative, educational deliveries
- overall low-maintenance, environmentally sound and socially conscious through sustainable design

STAFF SURVEY

In terms of Articulation, which of the following do you think generally represents Hamilton Unified School District?

11 responses

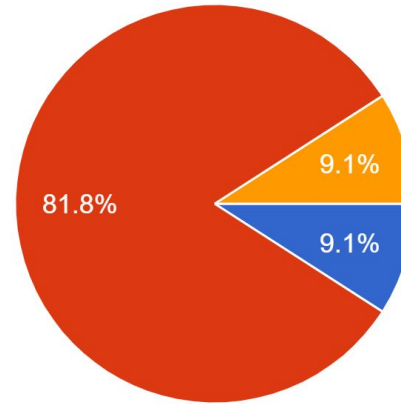

- K-12 education delivery not articulated
- Occasional curriculum connections to sending/receiving school
- K-12 educational delivery is highly articulated

In terms of Community Connections, which of the following do you think generally represents Hamilton School District?

11 responses

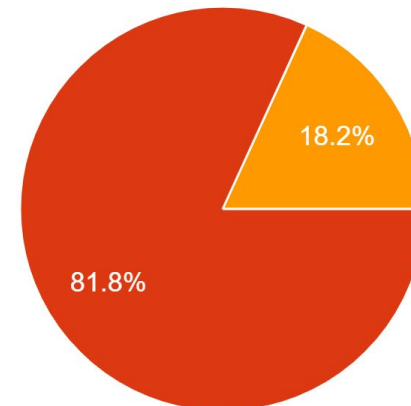

- Community uses for school seen as detrimental to student safety
- Evening/weekend community use of limited space
- Community users during school day embraced as learning opportunity for students

STAFF SURVEY

In terms of Furniture, which of the following do you think generally represents Hamilton Unified School District?

11 responses

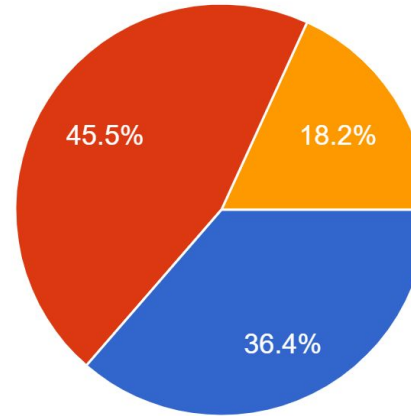

- Furniture is inappropriate for current educational methods: wrong sizes, wrong type, etc.
- Furniture is adaptable to several current educational deliveries with difficulty
- Furniture is flexible to anticipate future educational trends

In terms of Current Educational Delivery, what is your students' percentage of time in lecture mode versus collaborative groups?

11 responses

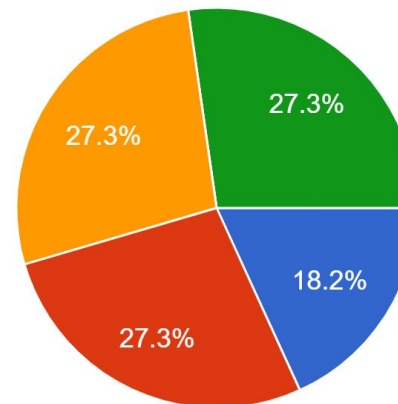

- 10% or less
- Greater than 10% but less than 25%
- Greater than 25% but less than 75%
- Greater than 75%

STAFF SURVEY

Current High School

In terms of School Learning Themes, which of the following do you think generally represents the Current Hamilton High School?

11 responses

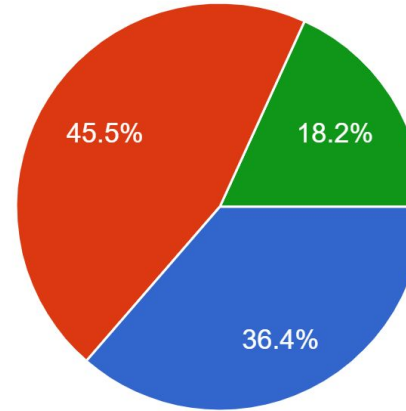

- Computers seen as sophisticated writing and math tools
- Computers used for power points and other presentations
- Computers occasionally used for learning programs and web research
- Adaptive learning programs, gaming, web, virtual access is ubiquitous

Future High School

In terms of Social Setting, which of the following do you think generally represents the Future Hamilton High School?

11 responses

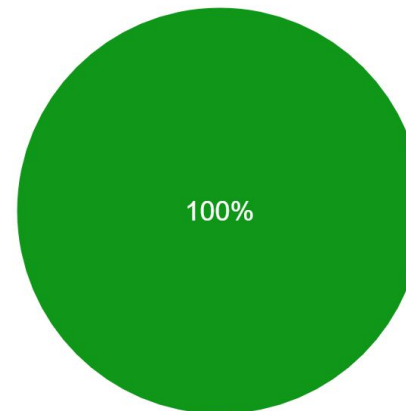

- Circulation in minimal terms of moving people: corridors and lobbies only
- Functional circulation with notable public expression at lobbies
- Central gathering spaces and "hangout" spaces
- Central social gathering spaces, "hangout" space and student centric social/workspaces

STAFF SURVEY

Future High School

In terms of flexibility, which of the following do you think generally represents the future Hamilton High School?

11 responses

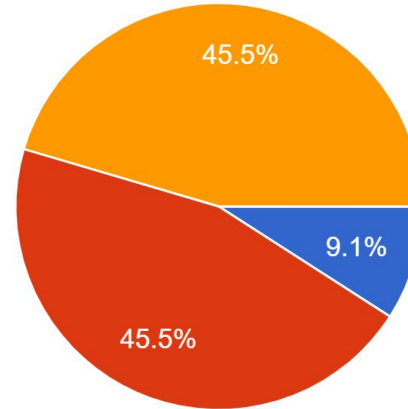

- Not all spaces need flexibility
- Many of the spaces need to be flexible for multiple uses and teaching methods
- All spaces need to be flexible with minimal effort

In terms of student exhibitions, which of the following do you think generally represents future Hamilton High School?

11 responses

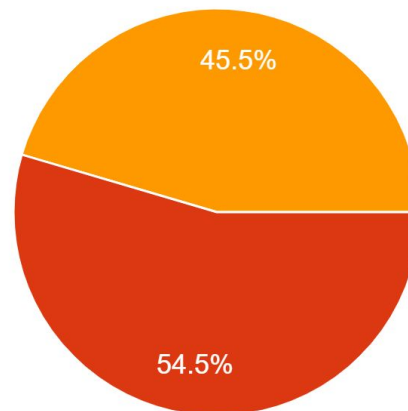

- Student work is rarely expressed outside of the classroom
- Student work is occasionally expressed in corridors or other areas of the school
- Students present work in exhibitions

STAFF SURVEY

Future High School

In terms of teaching teams, which of the following generally represents future Hamilton High School?

11 responses

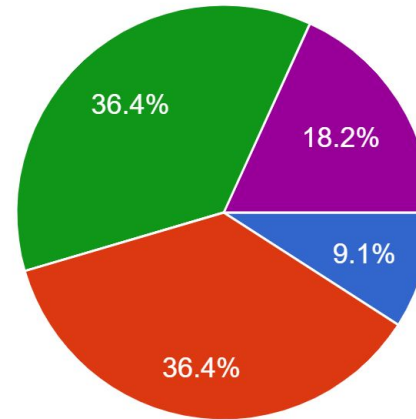

- Self-contained classroom teaching exclusively
- Common planning to coordinate curriculum
- Teachers swap classes for sharing instruction but do not teach together
- Teachers occasionally integrate curriculum by teaching together in sa...
- Teachers regularly teach synchronously in coordinated teams

In terms of transparency, which of the following do you think generally represents the future Hamilton High School?

11 responses

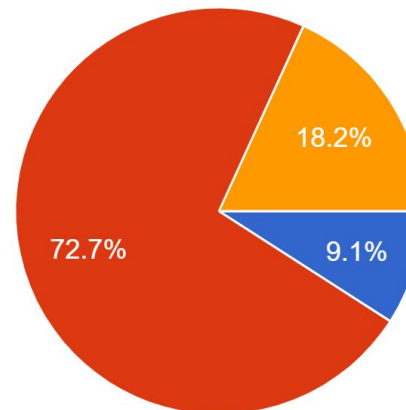

- No windows to corridors
- Unobstructed windows to common spaces, allowing teachers to observe students working separately or independently
- Abundant unobstructed windows connecting all spaces including teachers and administration

FOCUS GROUPS

Spaces Definitions

Relationships Identified

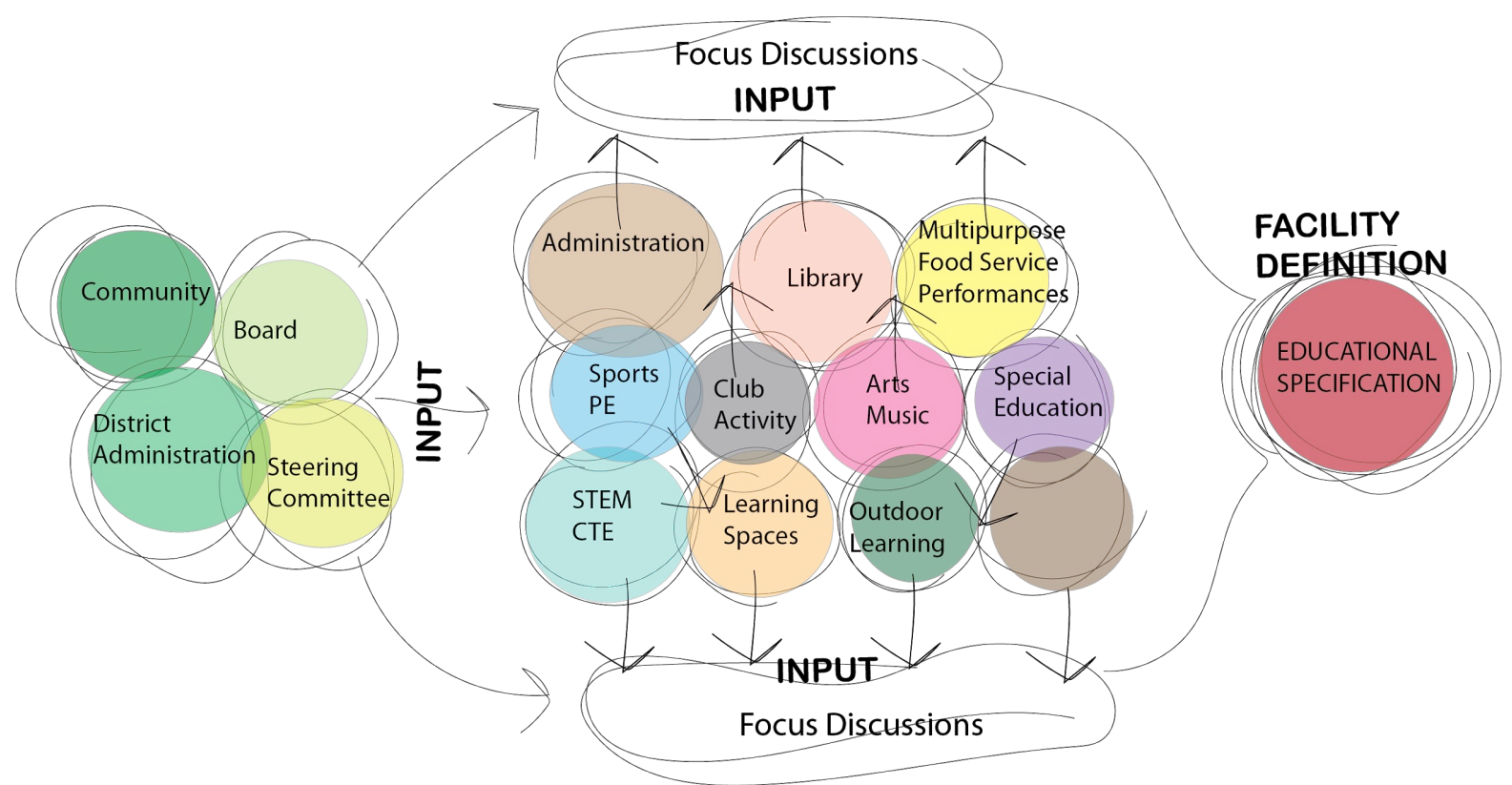

- STEM
- CTE
 - Science
 - Agriculture
 - Medical
 - Power Equipment
- Learning Spaces - 21st Century Learning
 - Student -Led
 - Open Layout-Moveable Walls
 - Innovative
 - Active Learning
- Outdoor Learning areas

- Administration
- Library
- Multipurpose/Food Service/Performances
- Sports/PE
- Club Activity
- Arts/Music
- Special Education

FOCUS GROUPS

Space Discussion Samples

Learning Spaces

There are many Components of a High School Program. However, building the basic **Learning Environment** in a manner that promotes both student and teacher collaboration, student participation, cross-curricular sharing and an exciting place to be is the most important part of the puzzle.

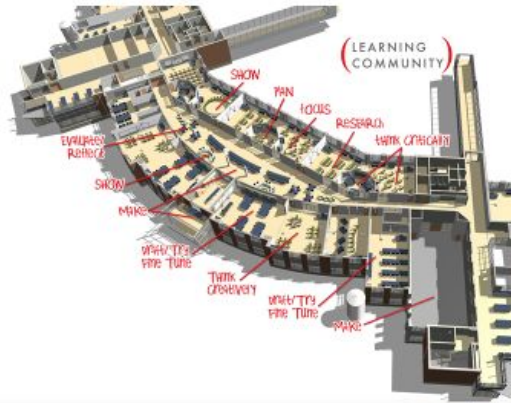

Learning Studio

- Create flexible, adaptable learning environments that resists a pure lecture format

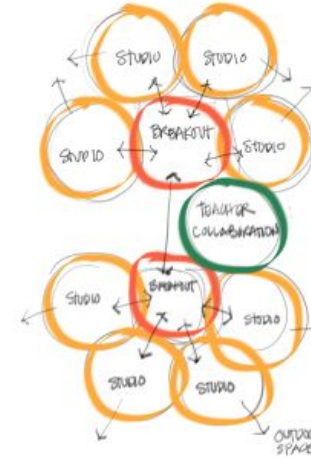

CTE Programs

	Teaching Station	Ed Spec		
		Qty	Size	Total
Technology Lab	3	3	1,200	3,600
Academy Lab & Professional Practice	1	1	2,400	2,400
Storage Room		4	200	800
Teacher Workstations / Collaboration Spaces	1	Design Based		280
Total	2			3,480

	Teaching Station	Ed Spec - Exterior		
		Qty	Size	Total
Outdoor Scene Building Area		1	900	900
Total				900

Focus Group 3 – Food Service

1. Multipurpose Food Service
 - a. Full-service kitchen
 - i. Type of Breakfast and #
 - ii. Type of Lunch #, how many shifts. Time?
 - iii. Equipment List
 - b. Service area
 - i. Conventional
 - ii. Themes – College Style
 - c. Staff
 - i. # of Staff
 - ii. Lockers/Dressing
 - iii. Restrooms
 - d. Free and reduced lunch
 - i. Percentage
 - e. Special wants

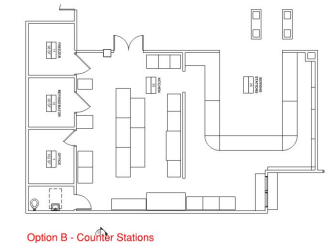
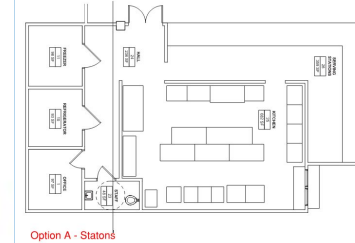
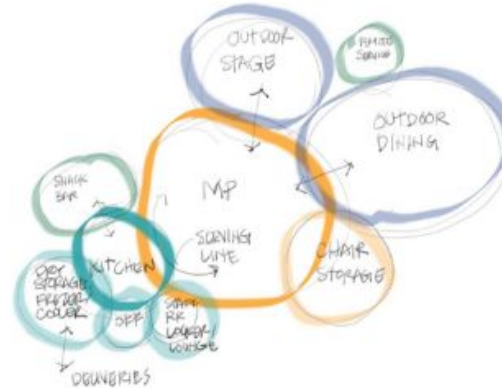

Example Food Service Delivery



SITE TEST FIT

Site oriented
“big picture” layouts
on site to make
sure the spaces fit
and to identify
adjacencies on site

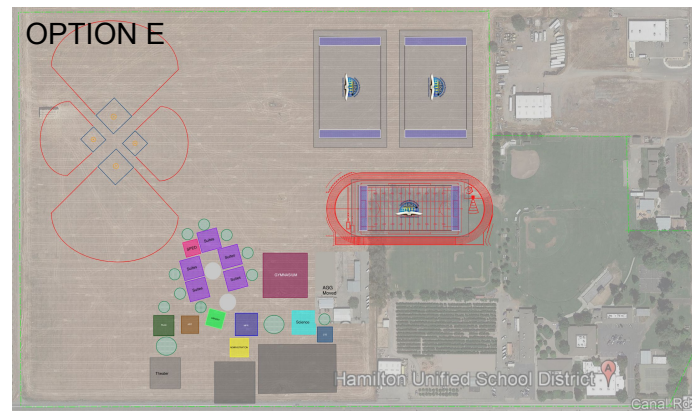
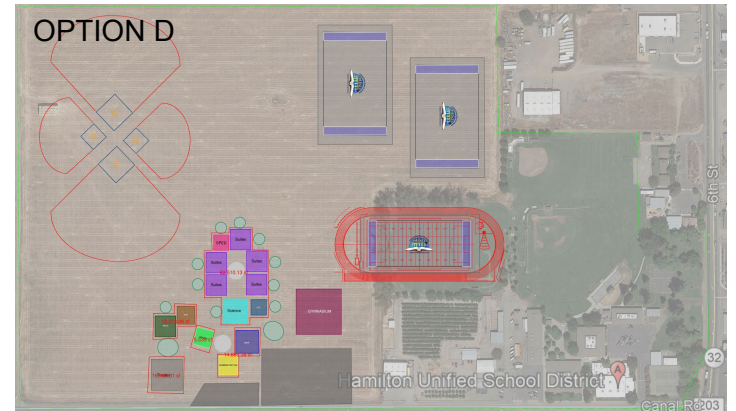
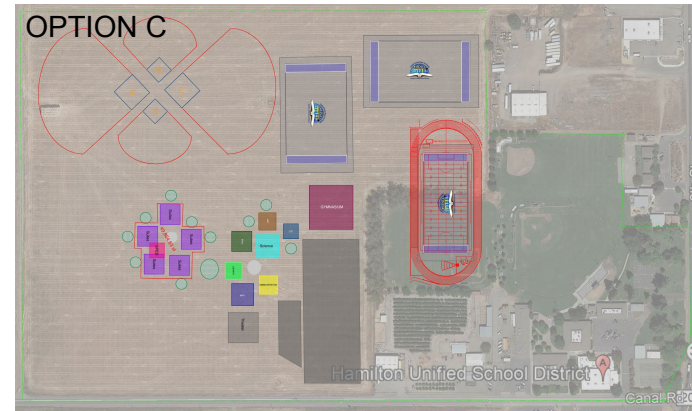
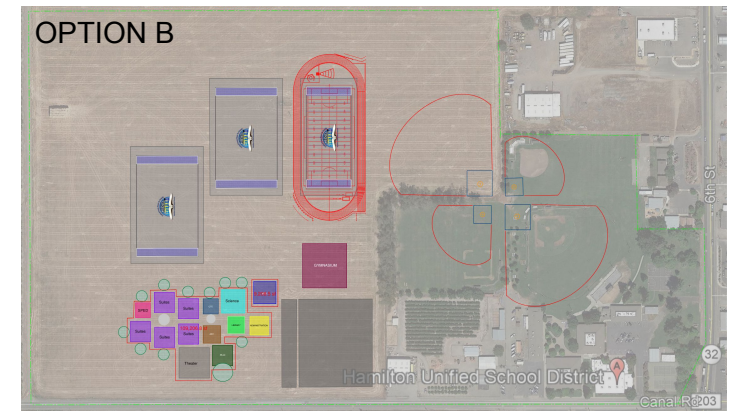
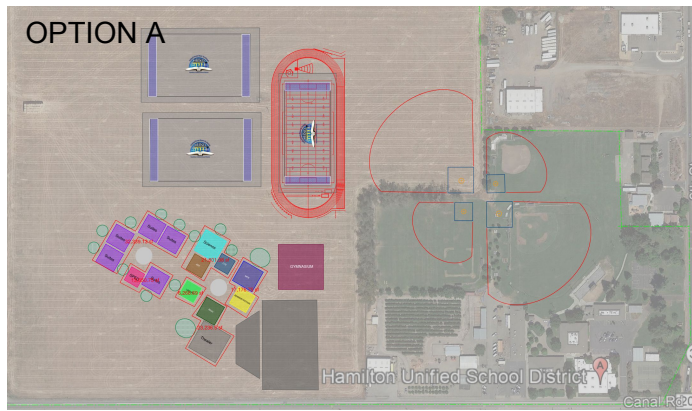

SITE TEST FIT

Site oriented
“big picture” layouts
on site to make
sure the spaces fit
and to identify
adjacencies on site

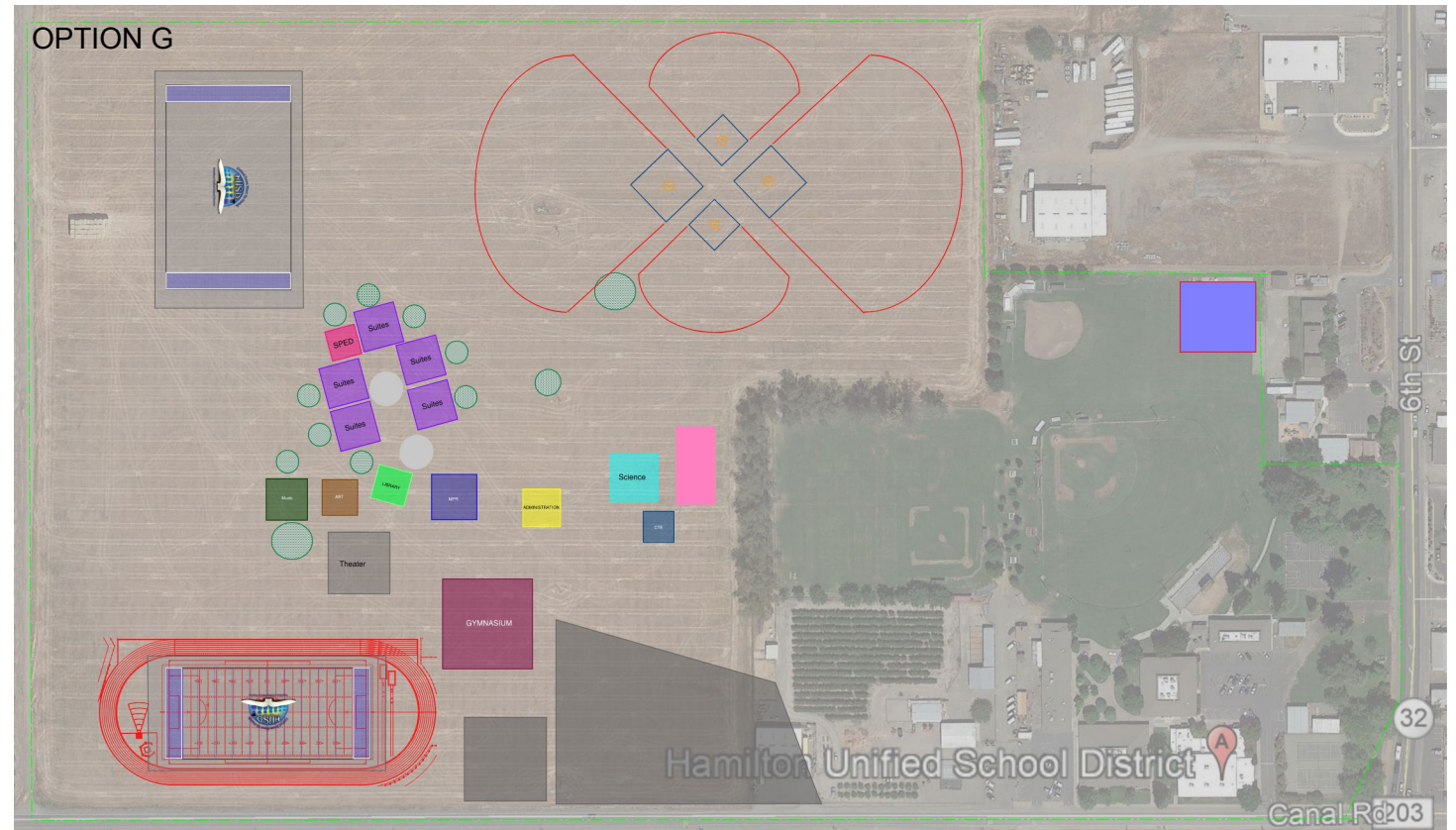
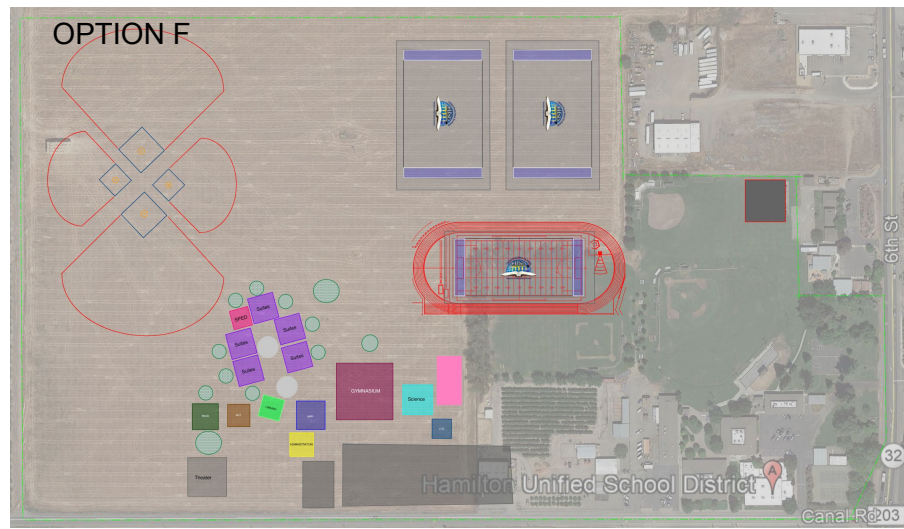

Thank you!