

TOPOGRAPHIC SURVEY

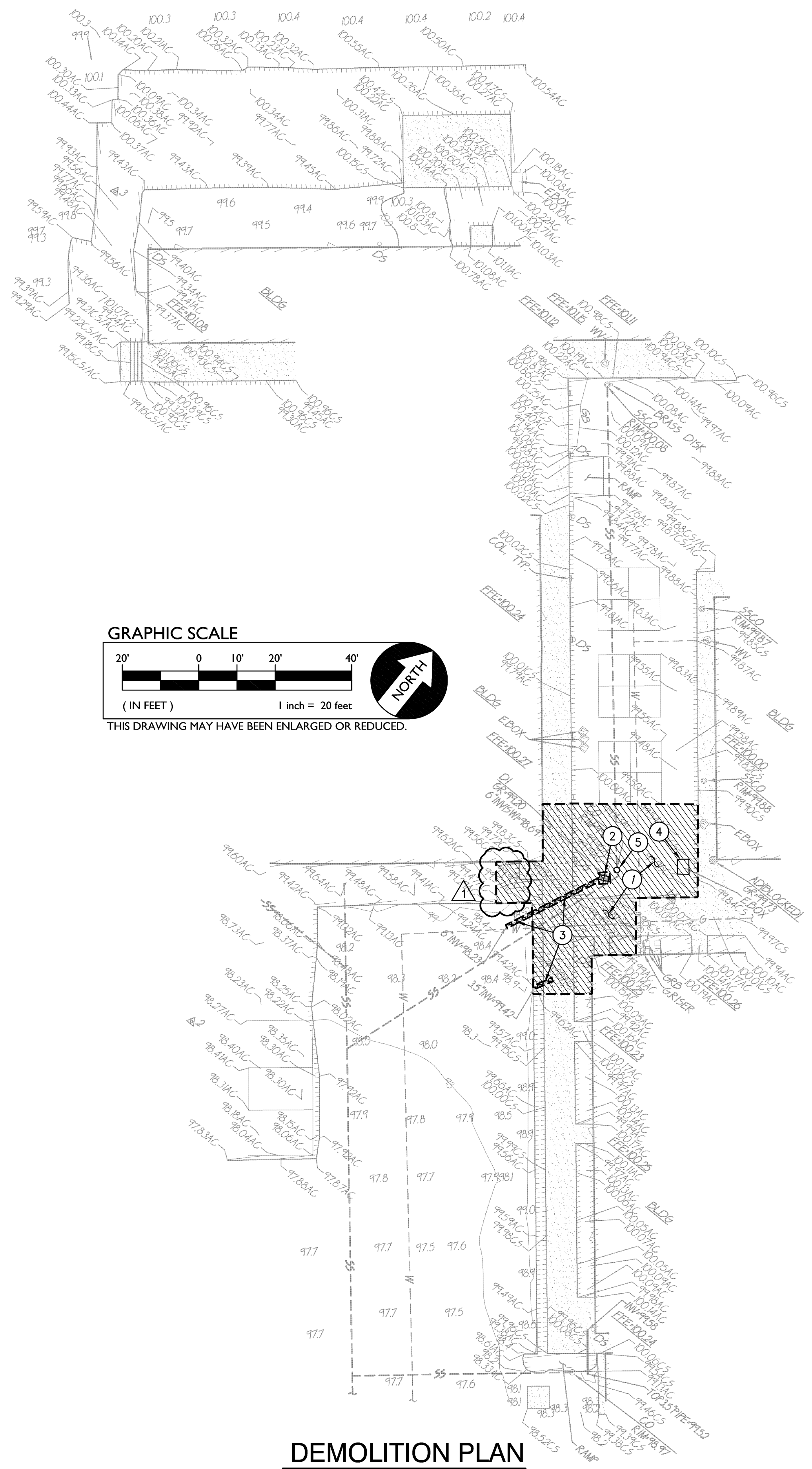

DEMOLITION PLAN

- DEMOLITION NOTES** *NOTES APPLY TO THIS SHEET ONLY
1. REMOVE EXISTING ASPHALT AND CONCRETE PAVING WITHIN AREA SHOWN.
 2. REMOVE EXISTING STORM DRAIN INLET.
 3. REMOVE EXISTING STORM DRAIN PIPE.
 4. PROTECT EXISTING ELECTRICAL BOX.
 5. PROTECT EXISTING CLEANOUT BOX.

- GENERAL NOTES:**
1. THE TYPES, LOCATIONS, SIZES, AND/OR DEPTHS OF EXISTING UNDERGROUND UTILITIES AS SHOWN ON THESE PLANS WERE OBTAINED FROM SOURCES OF VARYING RELIABILITY. THE CONTRACTOR IS CAUTIONED THAT ONLY ACTUAL EXCAVATION WILL REVEAL THE TYPES, EXTENT, SIZES, LOCATIONS AND DEPTHS OF SUCH UNDERGROUND UTILITIES. A REASONABLE EFFORT HAS BEEN MADE TO LOCATE AND DELINEATE ALL KNOWN UNDERGROUND UTILITIES. HOWEVER, WARREN CONSULTING ENGINEERS CAN ASSUME NO RESPONSIBILITY FOR THE COMPLETENESS OR ACCURACY OF ITS DELINEATION OF SUCH UNDERGROUND UTILITIES, NOR FOR THE EXISTENCE OF OTHER BURIED OBJECTS OR UTILITIES WHICH MAY BE ENCOUNTERED BUT WHICH ARE NOT SHOWN ON THESE PLANS. THE CONTRACTOR OR ANY SUBCONTRACTOR FOR THIS CONTRACT SHALL NOTIFY MEMBERS OF USA TWO(2) WORKING DAYS IN ADVANCE OF PERFORMING ANY EXCAVATION WORK BY CALLING TOLL FREE 1-800-227-2600.
 2. CONTRACTOR TO FIELD LOCATE EXISTING UTILITIES PRIOR TO START OF EXCAVATION.



DESIGNED: GW	DRAWN: ML	CHECKED: GW	DATE: 2/24/2015	NO. DESCRIPTION	ENG. COUNTY APPROVAL	HORIZONTAL SCALE: A.P.N.	BENCHMARK NO. ---	ELEV. ---	
				AS NOTED	DATE	AS NOTED	AS NOTED	JOB NO.: 15-019C	
				ADDENDUM #1					
				TOPOGRAPHIC SURVEY AND DEMOLITION PLAN FOR HAMILTON ELEMENTARY SCHOOL 277 Capay Street Hamilton City, CA 95951 HAMILTON UNIFIED SCHOOL DISTRICT GLENN CO., CALIFORNIA					
				C1.1					