

ADDENDUM No. 2

CSP#207707

**Org 162 Mockingbird Elementary School - Renovation
Org 232 Buckner Terrace Montessori - Renovation
Org 270 Eduardo Mata Montessori - Renovation**

DALLAS INDEPENDENT SCHOOL DISTRICT

11/01/2024



Any addendum issued will be listed or posted at the District website <http://www.dallasisd.org/>. Click on "Departments" Click On "Construction Services/Bond Office" Click On "Bond Vendor Opportunities" then click on bid Package number. Any and all addenda that are too large in size for the website will not be posted on the District website. However, all such addenda will be listed on the website with the of issuance of each addendum, and instructions to proposers for procuring such addenda from the Printing Company.

**Thomas Printworks
Attention: Jon Sauve
Address: 3610 Oak Lawn Ave
Dallas, Texas 75219
Phone: 214-880-0022
Email: jon.sauve@thomasprintworks.com**

Addenda will be available from the Printing Company for purchase. Purchase price must be obtained directly from the Printing Company.

The Bidder or proposer is responsible for obtaining all Addenda prior to submitting a bid or proposal to the district.

The following items modify the plans and specifications and shall become a part of the contract documents.:

ORG 162 MOCKINGBIRD ELEMENTARY SCHOOL – RENOVATION

DRAWINGS

ITEM 01: AD0.1 & A0.1

Add existing fire hydrants and existing building information to the Site plans.

ORG 232 BUCKNER TERRACE MONTESSORI – RENOVATION

DRAWINGS

ITEM 02: AD0.1 & A0.1

Add existing fire hydrants and existing building information to the Site plans.

ITEM 02: E4.01

Replace Sheet E4.01 with the one attached.

ORG 270 EDUARDO MATA MONTESSORI – RENOVATION

DRAWINGS

ITEM 04: AD0.1 & A0.1

Add existing fire hydrants and existing building information to the Site plans.

END OF ADDENDUM



Eduardo Mata
 LICENSED PROFESSIONAL ENGINEER



EDUARDO MATA
ELEMENTARY
(ORG #470)

| | |
|-----------|----------------|
| JOB NO. | 23027 |
| DATE | 10/1/20 |
| ISSUED TO | ADREN QUINONES |
| ISSUED BY | EDUARDO MATA |
| SCALE | AS SHOWN |
| DATE | 10/1/20 |
| BY | EDUARDO MATA |

OVERALL DEMO SITE PLAN

| | |
|-----------|----------------|
| DATE | 10/1/20 |
| ISSUED TO | ADREN QUINONES |
| ISSUED BY | EDUARDO MATA |
| SCALE | AS SHOWN |
| DATE | 10/1/20 |
| BY | EDUARDO MATA |

AD0.1

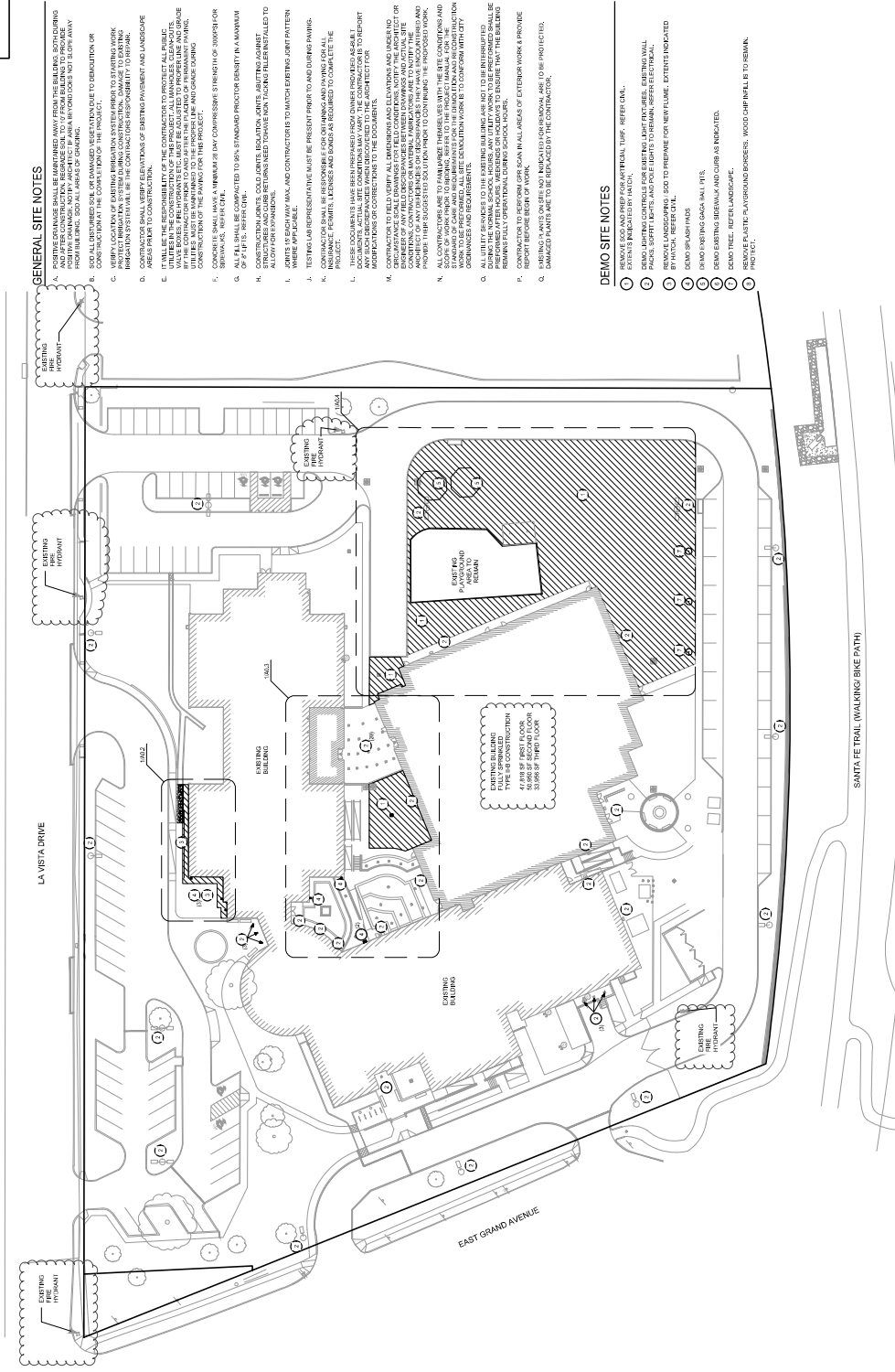

GENERAL SITE NOTES

1. ALL DEMOLITION WORK SHALL BE ACCORDING TO THE CITY OF HOUSTON DEMOLITION ORDINANCE AND ALL APPLICABLE REGULATIONS. DEMOLITION SHALL BE ACCORDING TO THE CITY OF HOUSTON DEMOLITION ORDINANCE AND ALL APPLICABLE REGULATIONS.
2. DEMOLITION SHALL BE ACCORDING TO THE CITY OF HOUSTON DEMOLITION ORDINANCE AND ALL APPLICABLE REGULATIONS.
3. DEMOLITION SHALL BE ACCORDING TO THE CITY OF HOUSTON DEMOLITION ORDINANCE AND ALL APPLICABLE REGULATIONS.
4. DEMOLITION SHALL BE ACCORDING TO THE CITY OF HOUSTON DEMOLITION ORDINANCE AND ALL APPLICABLE REGULATIONS.
5. DEMOLITION SHALL BE ACCORDING TO THE CITY OF HOUSTON DEMOLITION ORDINANCE AND ALL APPLICABLE REGULATIONS.
6. DEMOLITION SHALL BE ACCORDING TO THE CITY OF HOUSTON DEMOLITION ORDINANCE AND ALL APPLICABLE REGULATIONS.
7. DEMOLITION SHALL BE ACCORDING TO THE CITY OF HOUSTON DEMOLITION ORDINANCE AND ALL APPLICABLE REGULATIONS.
8. DEMOLITION SHALL BE ACCORDING TO THE CITY OF HOUSTON DEMOLITION ORDINANCE AND ALL APPLICABLE REGULATIONS.
9. DEMOLITION SHALL BE ACCORDING TO THE CITY OF HOUSTON DEMOLITION ORDINANCE AND ALL APPLICABLE REGULATIONS.
10. DEMOLITION SHALL BE ACCORDING TO THE CITY OF HOUSTON DEMOLITION ORDINANCE AND ALL APPLICABLE REGULATIONS.
11. DEMOLITION SHALL BE ACCORDING TO THE CITY OF HOUSTON DEMOLITION ORDINANCE AND ALL APPLICABLE REGULATIONS.
12. DEMOLITION SHALL BE ACCORDING TO THE CITY OF HOUSTON DEMOLITION ORDINANCE AND ALL APPLICABLE REGULATIONS.
13. DEMOLITION SHALL BE ACCORDING TO THE CITY OF HOUSTON DEMOLITION ORDINANCE AND ALL APPLICABLE REGULATIONS.
14. DEMOLITION SHALL BE ACCORDING TO THE CITY OF HOUSTON DEMOLITION ORDINANCE AND ALL APPLICABLE REGULATIONS.
15. DEMOLITION SHALL BE ACCORDING TO THE CITY OF HOUSTON DEMOLITION ORDINANCE AND ALL APPLICABLE REGULATIONS.
16. DEMOLITION SHALL BE ACCORDING TO THE CITY OF HOUSTON DEMOLITION ORDINANCE AND ALL APPLICABLE REGULATIONS.
17. DEMOLITION SHALL BE ACCORDING TO THE CITY OF HOUSTON DEMOLITION ORDINANCE AND ALL APPLICABLE REGULATIONS.
18. DEMOLITION SHALL BE ACCORDING TO THE CITY OF HOUSTON DEMOLITION ORDINANCE AND ALL APPLICABLE REGULATIONS.
19. DEMOLITION SHALL BE ACCORDING TO THE CITY OF HOUSTON DEMOLITION ORDINANCE AND ALL APPLICABLE REGULATIONS.
20. DEMOLITION SHALL BE ACCORDING TO THE CITY OF HOUSTON DEMOLITION ORDINANCE AND ALL APPLICABLE REGULATIONS.

DEMO SITE NOTES

1. DEMOLITION SHALL BE ACCORDING TO THE CITY OF HOUSTON DEMOLITION ORDINANCE AND ALL APPLICABLE REGULATIONS.
2. DEMOLITION SHALL BE ACCORDING TO THE CITY OF HOUSTON DEMOLITION ORDINANCE AND ALL APPLICABLE REGULATIONS.
3. DEMOLITION SHALL BE ACCORDING TO THE CITY OF HOUSTON DEMOLITION ORDINANCE AND ALL APPLICABLE REGULATIONS.
4. DEMOLITION SHALL BE ACCORDING TO THE CITY OF HOUSTON DEMOLITION ORDINANCE AND ALL APPLICABLE REGULATIONS.
5. DEMOLITION SHALL BE ACCORDING TO THE CITY OF HOUSTON DEMOLITION ORDINANCE AND ALL APPLICABLE REGULATIONS.
6. DEMOLITION SHALL BE ACCORDING TO THE CITY OF HOUSTON DEMOLITION ORDINANCE AND ALL APPLICABLE REGULATIONS.
7. DEMOLITION SHALL BE ACCORDING TO THE CITY OF HOUSTON DEMOLITION ORDINANCE AND ALL APPLICABLE REGULATIONS.
8. DEMOLITION SHALL BE ACCORDING TO THE CITY OF HOUSTON DEMOLITION ORDINANCE AND ALL APPLICABLE REGULATIONS.
9. DEMOLITION SHALL BE ACCORDING TO THE CITY OF HOUSTON DEMOLITION ORDINANCE AND ALL APPLICABLE REGULATIONS.
10. DEMOLITION SHALL BE ACCORDING TO THE CITY OF HOUSTON DEMOLITION ORDINANCE AND ALL APPLICABLE REGULATIONS.
11. DEMOLITION SHALL BE ACCORDING TO THE CITY OF HOUSTON DEMOLITION ORDINANCE AND ALL APPLICABLE REGULATIONS.
12. DEMOLITION SHALL BE ACCORDING TO THE CITY OF HOUSTON DEMOLITION ORDINANCE AND ALL APPLICABLE REGULATIONS.
13. DEMOLITION SHALL BE ACCORDING TO THE CITY OF HOUSTON DEMOLITION ORDINANCE AND ALL APPLICABLE REGULATIONS.
14. DEMOLITION SHALL BE ACCORDING TO THE CITY OF HOUSTON DEMOLITION ORDINANCE AND ALL APPLICABLE REGULATIONS.
15. DEMOLITION SHALL BE ACCORDING TO THE CITY OF HOUSTON DEMOLITION ORDINANCE AND ALL APPLICABLE REGULATIONS.
16. DEMOLITION SHALL BE ACCORDING TO THE CITY OF HOUSTON DEMOLITION ORDINANCE AND ALL APPLICABLE REGULATIONS.
17. DEMOLITION SHALL BE ACCORDING TO THE CITY OF HOUSTON DEMOLITION ORDINANCE AND ALL APPLICABLE REGULATIONS.
18. DEMOLITION SHALL BE ACCORDING TO THE CITY OF HOUSTON DEMOLITION ORDINANCE AND ALL APPLICABLE REGULATIONS.
19. DEMOLITION SHALL BE ACCORDING TO THE CITY OF HOUSTON DEMOLITION ORDINANCE AND ALL APPLICABLE REGULATIONS.
20. DEMOLITION SHALL BE ACCORDING TO THE CITY OF HOUSTON DEMOLITION ORDINANCE AND ALL APPLICABLE REGULATIONS.

1 OVERALL DEMO SITE PLAN

SCALE: 1/8" = 1'-0"



