

An aerial photograph of the Fairport Harbor Exempted Village School District. The image shows a large, multi-story school building with a flat roof and several wings, situated in the center. In front of the building is a large, open grassy field, likely a sports field, with some markings visible. The school is surrounded by a dense residential neighborhood with many houses and trees. In the background, there are hills and a body of water, possibly a harbor or lake. The sky is overcast.

Fairport Harbor Exempted Village School District

Capital Improvements Presentation
October 22nd, 2024

Agenda

Project Design Update

Program Overview

Phasing Plans

Opinion of Cost and
Schedule

Renderings

Q&A



Program Overview

Program

- New ADA compliant Bleachers and Pressbox.
- ADA compliant sidewalks and access to all areas within the stadium.
- New Restroom and Concessions Building (at field level).
- New Locker Room Building with or without Board Office component.
- Field improvements (natural grass or synthetic turf).
- North side spectator improvements.

Site Plan Phase 1

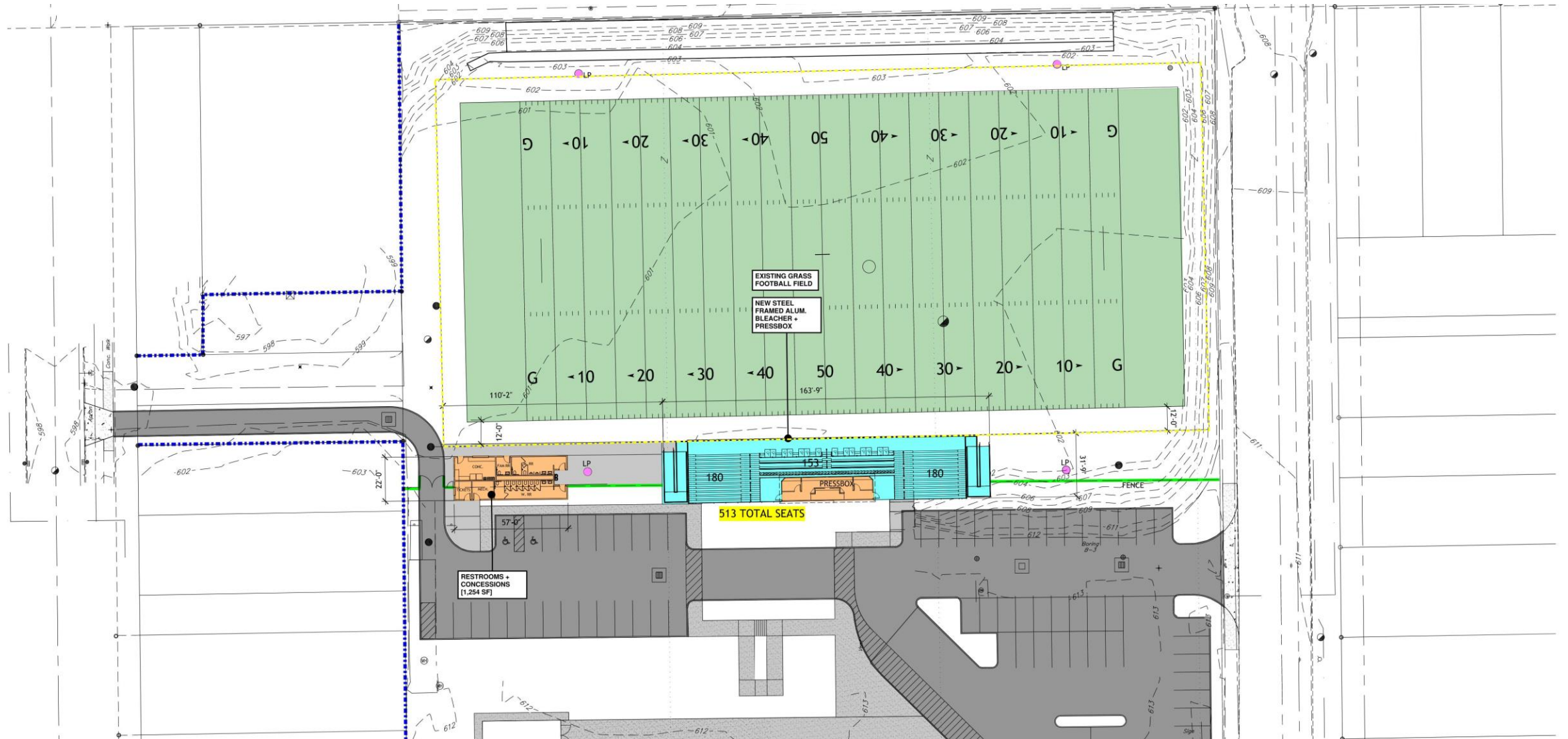

Site Plan Phase 2A

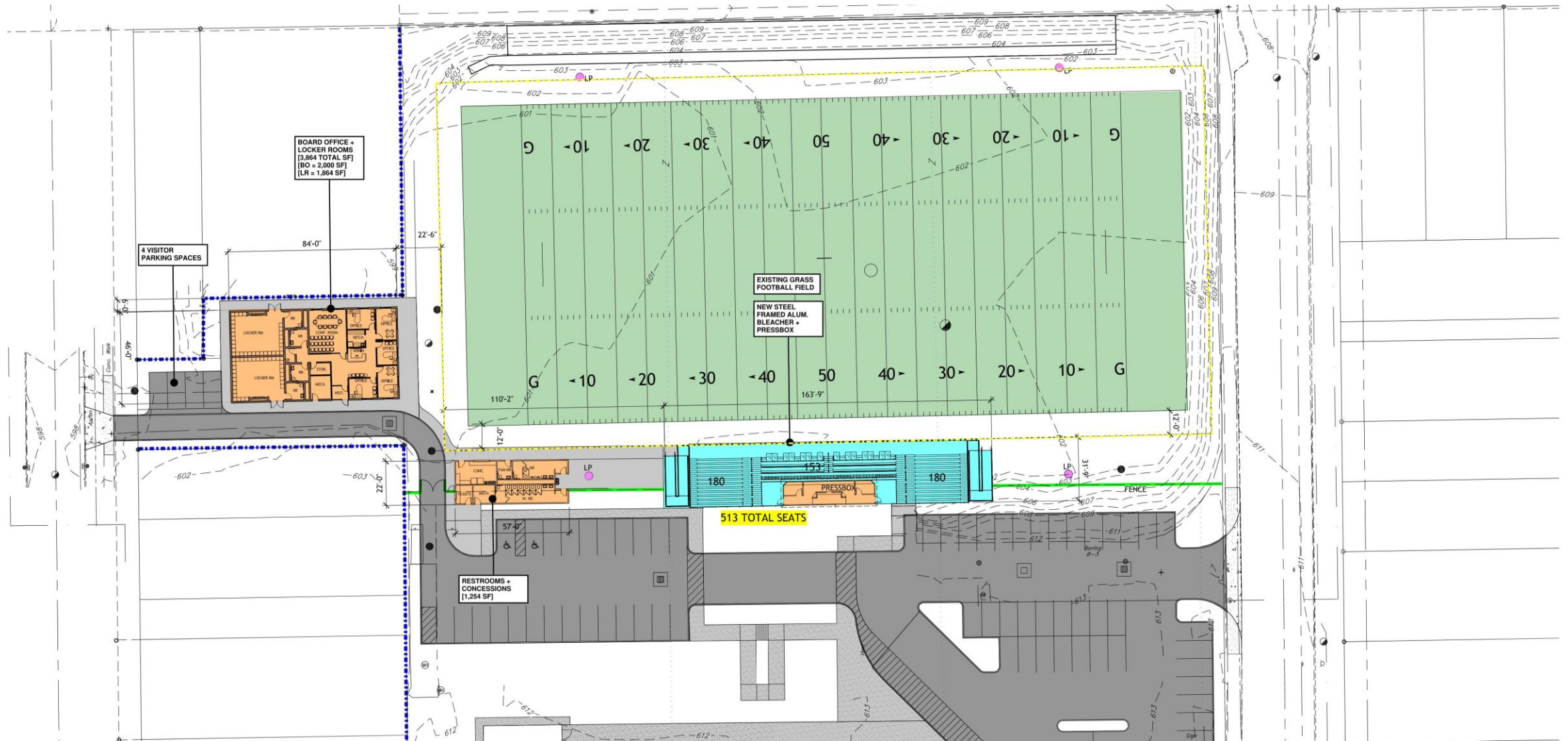

Site Plan Phase 2A

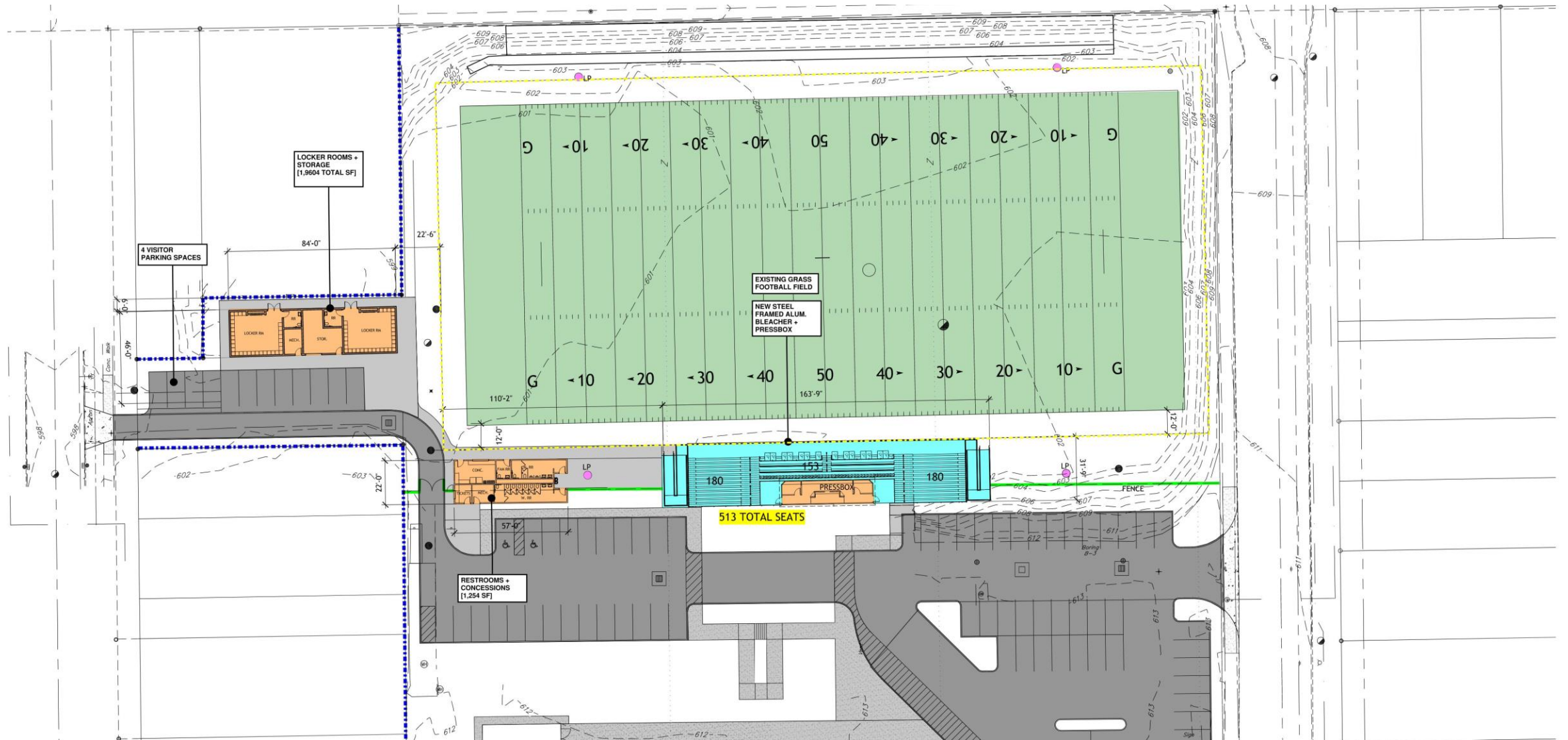

Site Plan Phase 3A

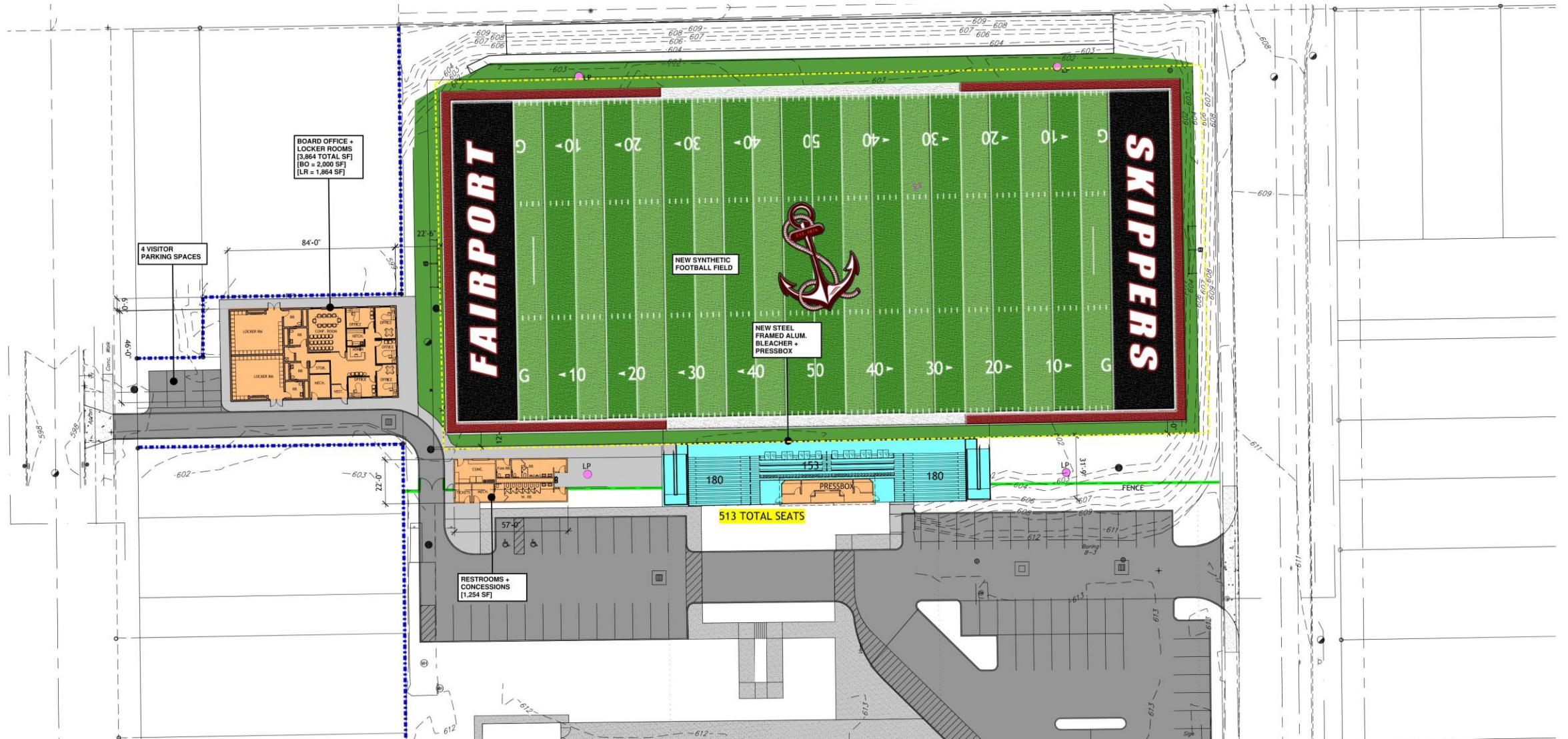

Site Plan Phase 3B



Site Plan Phase 4

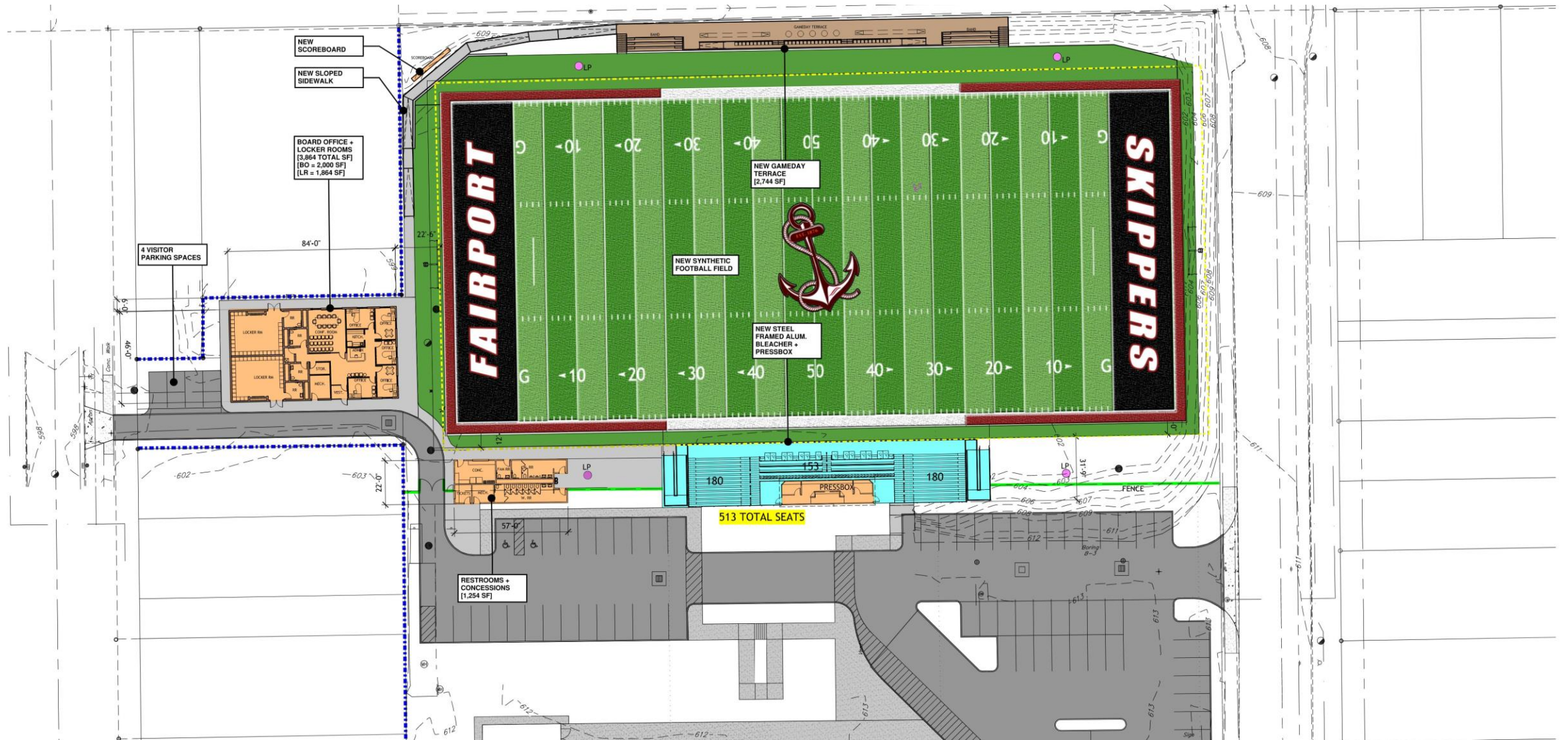

Opinion of Cost

Fairport Harbor Pre K - 12 - Capital Improvement Projects			
Phase	Description	Range	
Phase 1	Bleacher, Pressbox, Restroom/Concession Bldg.	\$900,000.00	\$1,000,000.00
Phase 2A	Board Office + Locker Room Bldg.	\$1,400,000.00	\$1,500,000.00
Phase 3A	Synthetic Turf Field	\$1,150,000.00	\$1,250,000.00
Phase 4	Gameday Terrace	\$550,000.00	\$650,000.00
Total		\$4,000,000.00	\$4,400,000.00

Fairport Harbor Pre K - 12 - Capital Improvement Projects			
Phase	Description	Range	
Phase 1	Bleacher, Pressbox, Restroom/Concession Bldg.	\$900,000.00	\$1,000,000.00
Phase 2B	Locker Room Bldg.	\$750,000.00	\$850,000.00
Phase 3B	*Natural Grass Field	\$625,000.00	\$725,000.00
Phase 4	Gameday Terrace	\$550,000.00	\$650,000.00
Total		\$2,825,000.00	\$3,225,000.00

Schedule

Phase 1: [6–8] months.

- March 2025 – Nov. 2025
- Field usable Fall 2026

Phase 1 + 2: [9–12] months.

- March 2025 – Feb. 2026
- Field usable Fall 2026

Phase 1 + 2 + 3: [9–12] months.

- March 2025 – Feb. 2026
- Option 3A Field usable Fall 2026
- Option 3B Field usable Spring 2027

* Option 3B (natural grass field) will require (3) growing seasons (fall/spring/fall) before usable.

Phase 1 + 2 + 3 + 4: [10–14] months.

- March 2025 – April 2026
- Option 3A Field usable Fall 2026
- Option 3B Field usable Spring 2027



Aerial 1 [grass field]



Aerial 1 [syn. turf field]



Aerial 2 [grass field]



Aerial 2 [syn. turf field]



View 1 [grass field]



View 1 [syn. turf field]



View 2 [grass field]



View 2 [syn. turf field]



View 3 [grass field]

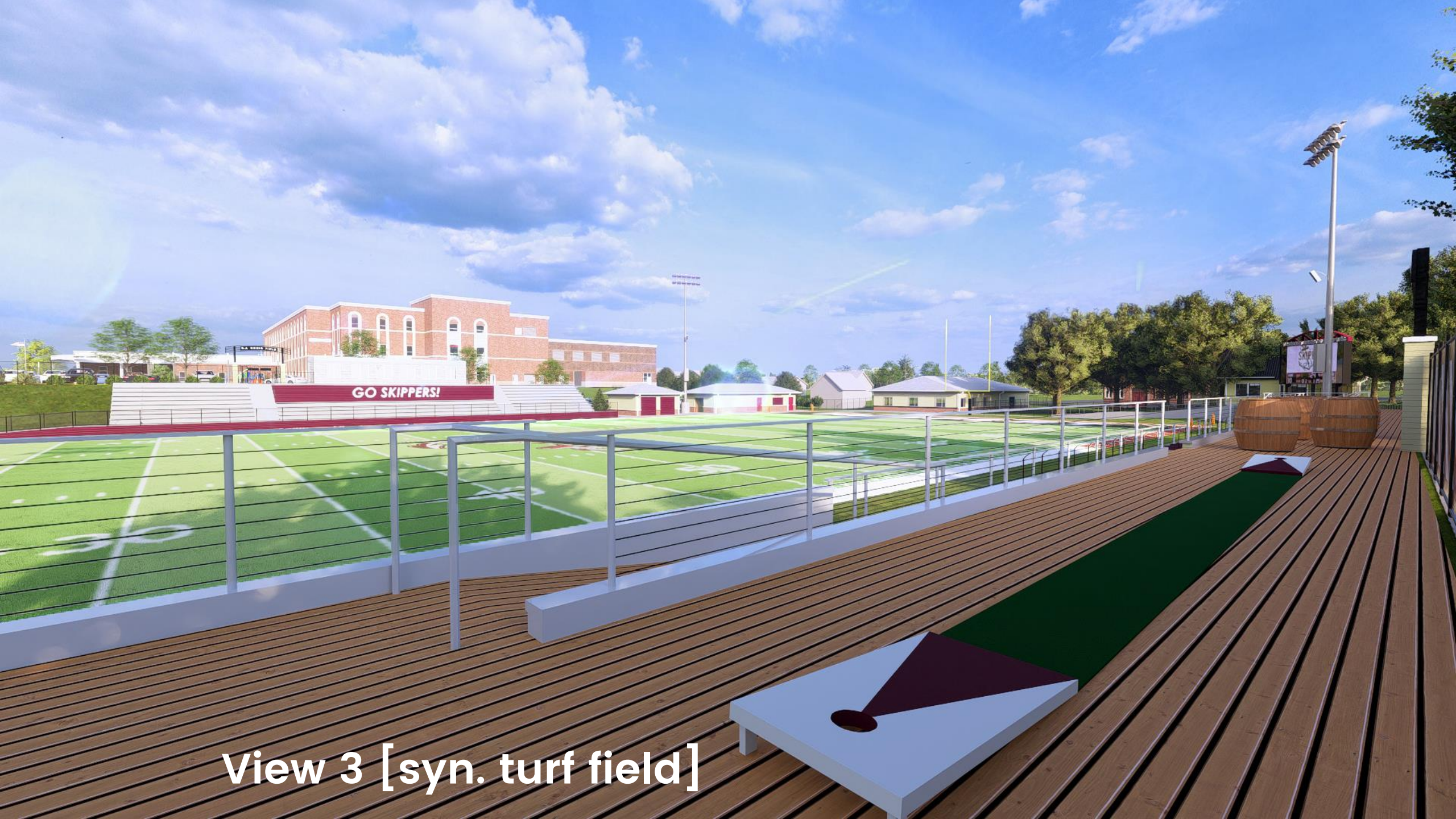

View 3 [syn. turf field]

Questions?

