

# **Update on FCPS Construction / Renovation Projects**

October 28, 2024

# Mary E. Britton Middle School



# Mary E. Britton Middle School



➤ Architect:

JRA Architects

➤ General Contractor:

Rising Sun Developing Co.

➤ GC Contract Sum:

\$69,964,000.00

➤ Total Project Cost:

\$82,680,000.00

➤ Change Orders to Date (7):

\$81,440.06

# Mary E. Britton Middle School



## ➤ **Completed Work:**

- Continue metal panels on Area E and batten seam panels on Areas C and A. (Trim/finish on entire areas and West elevations).
- Exterior furring and dense glass complete except outside Area D elevation.
- Completed pouring of terrazzo in Area C upstairs.
- Completed tile in Area B bathroom walls. Floors prepped and started.
- Continued – duct work in Area E, installation of lighting and electrical in Kitchen, Mezzanine Storm Shelter, Media Center, and Area E.
- Exterior weather/air barrier complete.
- Stair seats and Areas B and D formed and ready to pour.

## ➤ **Upcoming Work/Look Ahead:**

- Finish handrail and other related items to stairs.
- Another load of metal panels to deliver the week of 10-28-24.
- Rough grading at entrance slopes.
- Permeable pavers scheduled to be completed in October.
- Hydroseed and sod in areas that are ready, starting mid-October.
- Finish unistrut install in Vo Ag Lab.
- Install glass in frames as it arrives on site.
- Sprinkler rough-in continued in locker room areas and storm shelter.
- Pour seating under stair.

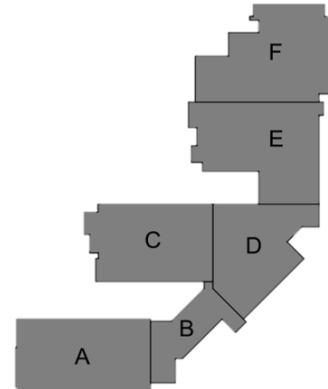

# Mary E. Britton Middle School



## Area A – Ceiling Grid in Classrooms



# Mary E. Britton Middle School



## Area A – Ceiling Grid in Corridors



# Mary E. Britton Middle School



## Area B – Platform under Stair





# Mary E. Britton Middle School



## Area D – Interior Soffit Framing in Media Center





# Mary E. Britton Middle School



## Area D – Media Center Window Framing



Week Ending October 11, 2024

# Mary E. Britton Middle School



## Area F – Gym Structure Painted



# Mary E. Britton Middle School



## Site – Asphalt Paving



# Mary E. Britton Middle School



## Site – Prepping Bus Area for Paving



Week Ending October 11, 2024



# The Hub for Innovative Learning & Leadership (The HILL)



# The Hub for Innovative Learning & Leadership (The HILL)



- Architect:  
EOP Architects
- General Contractor:  
D.W. Wilburn Inc.
- GC Contract Sum:  
\$50,700,288.00
- Total Project Cost:  
\$64,712,240.00
- Change Orders to Date (9):  
\$1,073,142.52

# The Hub for Innovative Learning & Leadership (The HILL)



## ➤ Completed Work:

- Getting Levels 3 and 4 ready for punch list/walk through.

## ➤ Upcoming Work/Look Ahead:

- Continue site work.
- Finish to continue on Levels 2 and 1.
- Metal stud and drywall work continue finishing on Levels 2 and 1.
- HVAC trim outs to continue.
- Electrical devices continue on Levels 3, 2, and 1 - pull wire on Level 1.
- Plumbing above ceiling continued on all floors.
- There may be partial shutdowns, and at times a complete shutdown, of Indiana for roofing and road work, and there will also be a lane closure on Midland.



# The Hub for Innovative Learning & Leadership (The HILL)



View of Composite Metal Panel at Main Entry



# The Hub for Innovative Learning & Leadership (The HILL)



View of Composite Metal Panel at Main Entry



# The Hub for Innovative Learning & Leadership (The HILL)



## West Parking Lot Gravel Base for Asphalt



# The Hub for Innovative Learning & Leadership (The HILL)



## West Parking Lot Asphalt Base Course



# The Hub for Innovative Learning & Leadership (The HILL)



## Concrete Bases and Framing for New Metal Panel





# The Hub for Innovative Learning & Leadership (The HILL)



## Railings at Level 3 Multi-purpose



# The Hub for Innovative Learning & Leadership (The HILL)



## Accent Lighting in Main Vestibule





# The Hub for Innovative Learning & Leadership (The HILL)



Overhead Door at Autotech Lab



# Harrison Elem - Preschool Classrooms Addition & HVAC Upgrades



# Harrison Elem - Preschool Classrooms Addition & HVAC Upgrades



- Architect:  
Ross Tarrant Architects
- General Contractor:  
Momentum Construction
- GC Contract Sum:  
\$3,998,400.00
- Total Project Cost:  
\$4,886,547.24
- Change Orders to Date (1):  
\$77,717.63

# Harrison Elem - Preschool Classrooms Addition & HVAC Upgrades



## ➤ **Completed Work:**

- Forming and pouring the deep portion of the building foundation.
- Backfill of building pad completed.
- Demolition of the old communication line.
- Finishing grading and pavement demolition at Jefferson Street.
- Poured cooling tower pad.
- Began construction of egress path trench drainage.

## ➤ **Upcoming Work/Look Ahead:**

- Finishing the foundation wall.
- Backfill with DGA.
- Under-slab plumbing work.
- Install sub-drainage system for permeable pavers.

# Harrison Elem - Preschool Classrooms Addition & HVAC Upgrades



Poured Cooling Tower Pad



# Harrison Elem - Preschool Classrooms Addition & HVAC Upgrades



## Forming and Pouring Foundations





# Harrison Elem - Preschool Classrooms Addition & HVAC Upgrades



## Forming and Pouring Foundations





# Harrison Elem - Preschool Classrooms Addition & HVAC Upgrades



Backfill of Building Pad



# Harrison Elem - Preschool Classrooms Addition & HVAC Upgrades



Backfill of Building Pad



# Harrison Elem - Preschool Classrooms Addition & HVAC Upgrades



Grading and Pavement Demo at Jefferson St.



Week Ending October 11, 2024

# Harrison Elem - Preschool Classrooms Addition & HVAC Upgrades



Grading and Pavement Demo at Jefferson St.



Week Ending October 11, 2024

# Harrison Elem - Preschool Classrooms Addition & HVAC Upgrades



## Egress Path Trench Drainage





# Rise STEM Academy for Girls



# Rise STEM Academy for Girls



- Architect:  
Ross Tarrant Architects
- General Contractor:  
D.W. Wilburn, Inc.
- GC Contract Sum:  
\$48,800,100.00
- Total Project Cost:  
\$58,460,689.35
- Change Orders to Date (0):  
\$0



# Rise STEM Academy for Girls



## ➤ **Completed Work:**

- Construction sign is installed.
- Road graded to the necessary elevation for heavy-duty asphalt application.
- Ongoing cut and fill operations for the building pad.
- Basement footers completed.
- Underground layout initiated, with excavation to commence soon.
- Parking lot and geothermal field cut to subgrade.
- First-course Insulated Concrete Forms (ICF) materials delivered and securely stored.

## ➤ **Upcoming Work/Look Ahead:**

- Complete road subgrade and begin the dense graded aggregate installation.
- Finalize subgrade for parking lot and geothermal field; prep lay-down areas.
- Pour concrete for the basement's south wall.
- Continued work on footers, steps, and piers.
- Proceed with rebar, pier mat installations, and exterior footers.
- Begin installation of ICF (Insulated Concrete Forms) base course.
- Start underground mechanical, electrical, and plumbing work on the main level.

# Rise STEM Academy for Girls



## Construction Signage



# Rise STEM Academy for Girls



## Entrance Widening



# Rise STEM Academy for Girls



## Road Cut in Progress





# Rise STEM Academy for Girls



## Basement Footers



Week Ending October 11, 2024

# Rise STEM Academy for Girls



## Trenches for Footings





# Rise STEM Academy for Girls



Grading in Progress



Week Ending October 11, 2024

# Rise STEM Academy for Girls



ICF Materials Stored on Site



Week Ending October 11, 2024

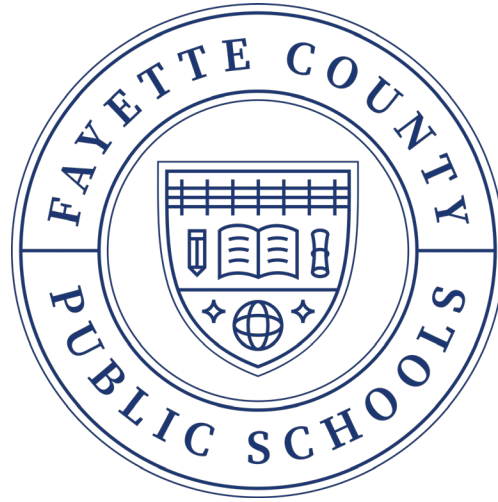

**Thank you!**