



ENVIRONMENTAL • GEOTECHNICAL  
BUILDING SCIENCES • MATERIALS TESTING

171 Commerce Street  
Williston, VT 05495  
Telephone 802-862-1980  
Fax 737-207-8272  
[www.atcgroupservices.com](http://www.atcgroupservices.com)

May 10, 2019

Mr. Kurt Proulx  
5420 Shelburne Road  
Shelburne, VT 05482

RE: Lead in Drinking Water Sampling  
**Champlain Valley Union High School**  
Champlain Valley School District  
Hinesburg, VT 05495  
ATC Project #280EM00349

Dear Kurt:

This report details the lead in drinking water sampling conducted at the Champlain Valley Union High School, located in Hinesburg, Vermont. ATC understands that the Champlain Valley Union High School receives its water from Hinesburg Water Works.

On April 23, 2019, ATC Group Services (ATC) conducted sampling at 15 locations as directed by CVSD facilities personnel. Each sampling location consisted of two (2) samples (A & B), a first draw (A) collected from a system left unused for a minimum of 6 hours and a flush sample (B) collected after location had been flushed with moving water for a minimum of 30 seconds. One (1) Blank sample per day and two (2) duplicate samples per facility were also collected for quality control purposes.

Lead in drinking water samples were submitted for analysis via EPA method SM 200.8 to Endyne Environmental Laboratories in Williston, Vermont.

Five (5) of the samples collected were found to have detectable concentrations of lead. None of the detectable results exceeded the Vermont Department of Health (VDH) Vermont Health Advisory (VHA) Drinking Water Guidance level of 15 ug/L for Lead. All other samples collected were found to be below the laboratory detection limit of 1.0 ug/L.

The following table illustrates samples that contained a detectable concentration of lead.

**List of samples with lead concentrations exceeding VHA Drinking Water Guidance level and laboratory detection limits:**

<b>Sample Number</b>	<b>Sample Location</b>	<b>Lead Detected* (ug/L) VHA Standard 15 ug/L</b>
CVU-07A	2 <sup>nd</sup> Floor Hall @ 228 First Draw	2.9
CVU-07B	2 <sup>nd</sup> Floor Hall @ 228 Flush	1.5
CVU-11A	Cafeteria First Draw	1.3
CVU-12A	1 <sup>st</sup> Floor Hall @ 161 First Draw	2.2
CVU-12B	1 <sup>st</sup> Floor Hall @ 161 Flush	1.1

Laboratory analytical results are included in **Appendix A** and a sample location diagram can be found in **Appendix B**. Applicable certifications are included as **Appendix C**.

Thank you for selecting ATC for your environmental management needs. If you have any questions concerning this correspondence, please feel free to contact us at 862-1980.

Sincerely,

ATC Group Services, LLC



For: Harland Miller  
 Senior Environmental Technician  
 Direct Line +1 802-862-1980  
 Email: [harland.miller@atcgs.com](mailto:harland.miller@atcgs.com)



Robert Montgomery  
 Senior Project Manager  
 Direct Line +1 802-862-1980  
 Email: [rob.montgomery@atcgs.com](mailto:rob.montgomery@atcgs.com)

## **APPENDIX A**

### **Lead in Drinking Water Laboratory Results**



ATC Group Services  
PO Box 1486 100043  
Williston, VT 05495  
Atten: Harland Miller

PROJECT: CVU  
WORK ORDER: **1904-08880**  
DATE RECEIVED: April 23, 2019  
DATE REPORTED: April 29, 2019  
SAMPLER: Harland Miller

### Laboratory Report

Enclosed please find the results of the analyses performed for the samples referenced on the attached chain of custody. All required method quality control elements including instrument calibration were performed in accordance with method requirements and determined to be acceptable unless otherwise noted.

The column labeled Lab/Tech in the accompanying report denotes the laboratory facility where the testing was performed and the technician who conducted the assay. A "W" designates the Williston, VT lab under NELAC certification ELAP 11263; "R" designates the Lebanon, NH facility under certification NH 2037 and "N" the Plattsburgh, NY lab under certification ELAP 11892. "Sub" indicates the testing was performed by a subcontracted laboratory. The accreditation status of the subcontracted lab is referenced in the corresponding NELAC and Qual fields.

The NELAC column also denotes the accreditation status of each laboratory for each reported parameter. "A" indicates the referenced laboratory is NELAC accredited for the parameter reported. "N" indicates the laboratory is not accredited. "U" indicates that NELAC does not offer accreditation for that parameter in that specific matrix. Test results denoted with an "A" meet all National Environmental Laboratory Accreditation Program requirements except where denoted by pertinent data qualifiers. Test results are representative of the samples as they were received at the laboratory

Endyne, Inc. warrants, to the best of its knowledge and belief, the accuracy of the analytical test results contained in this report, but makes no other warranty, expressed or implied, especially no warranties of merchantability or fitness for a particular purpose.

Reviewed by:

Harry B. Locker, Ph.D.  
Laboratory Director

**Laboratory Report**

DATE REPORTED: 04/29/2019

CLIENT: ATC Group Services  
PROJECT: CVUWORK ORDER: 1904-08880  
DATE RECEIVED: 04/23/2019

001	Site: CVU-01A			Date Sampled: 4/23/19	Time: 12:28			
Parameter	Result	Units	Method	Analysis Date/Time	Lab/Tech	NELAC	Qual.	
Lead, Total	< 0.0010	mg/L	EPA 200.8	4/26/19 11:03	W SJM	A		
002	Site: CVU-01B			Date Sampled: 4/23/19	Time: 12:30			
Parameter	Result	Units	Method	Analysis Date/Time	Lab/Tech	NELAC	Qual.	
Lead, Total	< 0.0010	mg/L	EPA 200.8	4/26/19 11:05	W SJM	A		
003	Site: CVU-02A			Date Sampled: 4/23/19	Time: 12:33			
Parameter	Result	Units	Method	Analysis Date/Time	Lab/Tech	NELAC	Qual.	
Lead, Total	< 0.0010	mg/L	EPA 200.8	4/26/19 11:08	W SJM	A		
004	Site: CVU-02B			Date Sampled: 4/23/19	Time: 12:35			
Parameter	Result	Units	Method	Analysis Date/Time	Lab/Tech	NELAC	Qual.	
Lead, Total	< 0.0010	mg/L	EPA 200.8	4/26/19 11:10	W SJM	A		
005	Site: CVU-03A			Date Sampled: 4/23/19	Time: 12:41			
Parameter	Result	Units	Method	Analysis Date/Time	Lab/Tech	NELAC	Qual.	
Lead, Total	< 0.0010	mg/L	EPA 200.8	4/26/19 11:18	W SJM	A		
006	Site: CVU-03B			Date Sampled: 4/23/19	Time: 12:43			
Parameter	Result	Units	Method	Analysis Date/Time	Lab/Tech	NELAC	Qual.	
Lead, Total	< 0.0010	mg/L	EPA 200.8	4/26/19 11:26	W SJM	A		
007	Site: CVU-04A			Date Sampled: 4/23/19	Time: 12:47			
Parameter	Result	Units	Method	Analysis Date/Time	Lab/Tech	NELAC	Qual.	
Lead, Total	< 0.0010	mg/L	EPA 200.8	4/26/19 11:28	W SJM	A		
008	Site: CVU-04B			Date Sampled: 4/23/19	Time: 12:49			
Parameter	Result	Units	Method	Analysis Date/Time	Lab/Tech	NELAC	Qual.	
Lead, Total	< 0.0010	mg/L	EPA 200.8	4/26/19 11:31	W SJM	A		
009	Site: CVU-05A			Date Sampled: 4/23/19	Time: 12:52			
Parameter	Result	Units	Method	Analysis Date/Time	Lab/Tech	NELAC	Qual.	
Lead, Total	< 0.0010	mg/L	EPA 200.8	4/26/19 11:33	W SJM	A		
010	Site: CVU-05B			Date Sampled: 4/23/19	Time: 12:54			
Parameter	Result	Units	Method	Analysis Date/Time	Lab/Tech	NELAC	Qual.	
Lead, Total	< 0.0010	mg/L	EPA 200.8	4/26/19 11:36	W SJM	A		
011	Site: CVU-06A			Date Sampled: 4/23/19	Time: 12:56			

**Laboratory Report**

DATE REPORTED: 04/29/2019

CLIENT: ATC Group Services  
PROJECT: CVUWORK ORDER: 1904-08880  
DATE RECEIVED: 04/23/2019

011	Site: CVU-06A			Date Sampled: 4/23/19	Time: 12:56			
Parameter	Result	Units	Method	Analysis Date/Time	Lab/Tech	NELAC	Qual.	
Lead, Total	< 0.0010	mg/L	EPA 200.8	4/26/19 11:38	W SJM	A		
012	Site: CVU-06B			Date Sampled: 4/23/19	Time: 12:59			
Parameter	Result	Units	Method	Analysis Date/Time	Lab/Tech	NELAC	Qual.	
Lead, Total	< 0.0010	mg/L	EPA 200.8	4/26/19 11:41	W SJM	A		
013	Site: CVU-07A			Date Sampled: 4/23/19	Time: 13:01			
Parameter	Result	Units	Method	Analysis Date/Time	Lab/Tech	NELAC	Qual.	
Lead, Total	0.0029	mg/L	EPA 200.8	4/26/19 11:44	W SJM	A		
014	Site: CVU-07B			Date Sampled: 4/23/19	Time: 13:04			
Parameter	Result	Units	Method	Analysis Date/Time	Lab/Tech	NELAC	Qual.	
Lead, Total	0.0015	mg/L	EPA 200.8	4/26/19 11:46	W SJM	A		
015	Site: CVU-08A			Date Sampled: 4/23/19	Time: 13:05			
Parameter	Result	Units	Method	Analysis Date/Time	Lab/Tech	NELAC	Qual.	
Lead, Total	< 0.0010	mg/L	EPA 200.8	4/26/19 11:56	W SJM	A		
016	Site: CVU-08B			Date Sampled: 4/23/19	Time: 13:07			
Parameter	Result	Units	Method	Analysis Date/Time	Lab/Tech	NELAC	Qual.	
Lead, Total	< 0.0010	mg/L	EPA 200.8	4/26/19 12:04	W SJM	A		
017	Site: CVU-09A			Date Sampled: 4/23/19	Time: 13:11			
Parameter	Result	Units	Method	Analysis Date/Time	Lab/Tech	NELAC	Qual.	
Lead, Total	< 0.0010	mg/L	EPA 200.8	4/26/19 12:06	W SJM	A		
018	Site: CVU-09B			Date Sampled: 4/23/19	Time: 13:12			
Parameter	Result	Units	Method	Analysis Date/Time	Lab/Tech	NELAC	Qual.	
Lead, Total	< 0.0010	mg/L	EPA 200.8	4/26/19 12:09	W SJM	A		
019	Site: CVU-10A			Date Sampled: 4/23/19	Time: 13:15			
Parameter	Result	Units	Method	Analysis Date/Time	Lab/Tech	NELAC	Qual.	
Lead, Total	< 0.0010	mg/L	EPA 200.8	4/26/19 12:11	W SJM	A		
020	Site: CVU-10B			Date Sampled: 4/23/19	Time: 13:17			
Parameter	Result	Units	Method	Analysis Date/Time	Lab/Tech	NELAC	Qual.	
Lead, Total	< 0.0010	mg/L	EPA 200.8	4/26/19 12:14	W SJM	A		
021	Site: CVU-11A			Date Sampled: 4/23/19	Time: 13:18			

**Laboratory Report**

DATE REPORTED: 04/29/2019

CLIENT: ATC Group Services  
PROJECT: CVUWORK ORDER: 1904-08880  
DATE RECEIVED: 04/23/2019

021	Site: CVU-11A			Date Sampled: 4/23/19	Time: 13:18			
Parameter	Result	Units	Method	Analysis Date/Time	Lab/Tech	NELAC	Qual.	
Lead, Total	0.0013	mg/L	EPA 200.8	4/26/19 12:17	W SJM	A		
022	Site: CVU-11B			Date Sampled: 4/23/19	Time: 13:20			
Parameter	Result	Units	Method	Analysis Date/Time	Lab/Tech	NELAC	Qual.	
Lead, Total	< 0.0010	mg/L	EPA 200.8	4/26/19 12:19	W SJM	A		
023	Site: CVU-12A			Date Sampled: 4/23/19	Time: 13:22			
Parameter	Result	Units	Method	Analysis Date/Time	Lab/Tech	NELAC	Qual.	
Lead, Total	0.0022	mg/L	EPA 200.8	4/26/19 12:22	W SJM	A		
024	Site: CVU-12B			Date Sampled: 4/23/19	Time: 13:24			
Parameter	Result	Units	Method	Analysis Date/Time	Lab/Tech	NELAC	Qual.	
Lead, Total	0.0011	mg/L	EPA 200.8	4/26/19 12:24	W SJM	A		
025	Site: CVU-13A			Date Sampled: 4/23/19	Time: 13:25			
Parameter	Result	Units	Method	Analysis Date/Time	Lab/Tech	NELAC	Qual.	
Lead, Total	< 0.0010	mg/L	EPA 200.8	4/26/19 12:32	W SJM	A		
026	Site: CVU-13B			Date Sampled: 4/23/19	Time: 13:27			
Parameter	Result	Units	Method	Analysis Date/Time	Lab/Tech	NELAC	Qual.	
Lead, Total	< 0.0010	mg/L	EPA 200.8	4/26/19 12:40	W SJM	A		
027	Site: CVU-14A			Date Sampled: 4/23/19	Time: 13:27			
Parameter	Result	Units	Method	Analysis Date/Time	Lab/Tech	NELAC	Qual.	
Lead, Total	< 0.0010	mg/L	EPA 200.8	4/26/19 12:42	W SJM	A		
028	Site: CVU-14B			Date Sampled: 4/23/19	Time: 13:29			
Parameter	Result	Units	Method	Analysis Date/Time	Lab/Tech	NELAC	Qual.	
Lead, Total	< 0.0010	mg/L	EPA 200.8	4/26/19 12:45	W SJM	A		
029	Site: CVU-15A			Date Sampled: 4/23/19	Time: 13:30			
Parameter	Result	Units	Method	Analysis Date/Time	Lab/Tech	NELAC	Qual.	
Lead, Total	< 0.0010	mg/L	EPA 200.8	4/26/19 12:47	W SJM	A		
030	Site: CVU-15B			Date Sampled: 4/23/19	Time: 13:32			
Parameter	Result	Units	Method	Analysis Date/Time	Lab/Tech	NELAC	Qual.	
Lead, Total	< 0.0010	mg/L	EPA 200.8	4/26/19 12:50	W SJM	A		
031	Site: CVU-16A			Date Sampled: 4/23/19	Time: 13:30			

**Laboratory Report**

DATE REPORTED: 04/29/2019

CLIENT: ATC Group Services  
PROJECT: CVUWORK ORDER: **1904-08880**  
DATE RECEIVED: 04/23/2019

031	Site: CVU-16A			Date Sampled: 4/23/19	Time: 13:30			
<u>Parameter</u>	<u>Result</u>	<u>Units</u>	<u>Method</u>	<u>Analysis Date/Time</u>	<u>Lab/Tech</u>	<u>NELAC</u>	<u>Qual.</u>	
Lead, Total	< 0.0010	mg/L	EPA 200.8	4/26/19 12:52	W SJM	A		

032	Site: CVU-16B			Date Sampled: 4/23/19	Time: 13:32			
<u>Parameter</u>	<u>Result</u>	<u>Units</u>	<u>Method</u>	<u>Analysis Date/Time</u>	<u>Lab/Tech</u>	<u>NELAC</u>	<u>Qual.</u>	
Lead, Total	< 0.0010	mg/L	EPA 200.8	4/26/19 12:55	W SJM	A		

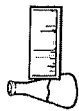

**ENDYNE, INC.**  
 160 James Brown Drive  
 Williston, Vermont 05495  
 (802) 879-4333

**CHAIN-OF-CUSTODY-RECORD**

Special Reporting Instructions/PO#: **280FEM 00 349**

Project Name: **CVU** Client/Contact Name: **ATC VT** Sampler Name: **Harold Miller**  
 State of Origin: VT NY NH Other Phone #: **802 862 1980** Phone #: **802 238 6167**  
 Endyne WO # \_\_\_\_\_ Mailing Address: \_\_\_\_\_ Billing Address: \_\_\_\_\_

Sample Location	Matrix	C R A B	O M P	Date/Time Sampled	Sample Containers		Sample Preservation	Analysis Required	Field Results/Remarks	Due Date
					No.	Type/Size				
CVU-01A	W	X		1228	1	1lb		Pb		
CVU-01B				1230						
CVU-02A				1233						
CVU-02B				1235						
CVU-03A				1241						
CVU-03B				1243						
CVU-04A				1247						
CVU-04B				1249						
CVU-05A				1252						
CVU-05B				1254						



Relinquished by: **[Signature]** Date/Time: **4/23 1710** Received by: **Storney** Date/Time: **4/23/19 @ 1411**

LAB USE ONLY					
Delivery:	<b>Client</b>				
Temp:	<b>23.4</b>				
Comment:					
1 pH	6 TKN	11 Total Solids	16 Sulfate	21 1664 TPH/FOG	26 8270 PAH Only
2 Chloride	7 Total P	12 TSS	17 Coliform (Specify)	22 8015 GRO	27 8081 Pest
3 Ammonia N	8 Total Diss. P	13 TDS	18 COD	23 8015 DRO	28 8082 PCB
4 Nitrite N	9 BOD	14 Turbidity	19 VT PCF	24 8260B	29 PP13 Metals
5 Nitrate N	10 Alkalinity	15 Conductivity	20 VOC Halocarbons	25 8270 B/N or Acid	30 Total RCRA8
31 Metals (Total, Diss.) Ag, Al, As, B, Ba, Be, Ca, Cd, Co, Cr, Cu, Fe, Hg, K, Mg, Mn, Mo, Na, Ni, Pb, Sb, Se, Sn, Ti, U, V, Zn					
32 TCLP (volatiles, semi-volatiles, metals, pesticides, herbicides)					
34 Corrosivity	35 Ignitability	36 Reactivity	37 Other		
38 Other					

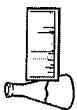

# ENDYNE, INC.

160 James Brown Drive  
Williston, Vermont 05495  
(802) 879-4333

# CHAIN-OF-CUSTODY-RECORD

Special Reporting Instructions/PO#:

Project Name: <b>CVU</b>	Client/Contact Name:	Sampler Name:
State of Origin: VT <u>NY</u> NH <u>Other</u>	Phone #:	Phone #:
Endyne WO #	Mailing Address:	Billing Address:

Sample Location	Matrix	C R A B	O M P	Date/Time Sampled	Sample Containers		Sample Preservation	Analysis Required	Field Results/Remarks	Due Date
					No.	Type/Size				
CVU-06A				4/23/19						
CVU-06B				1256						
CVU-07A				1259						
CVU-07B				1301						
CVU-08A				1304						
CVU-08B				1305						
CVU-09A				1307						
CVU-09B				1311						
CVU-10A				1312						
CVU-10B				1315						
CVU-10B				1317						

Relinquished by: <b>HWN</b>	Date/Time <b>4/23 1710</b>	Received by: <b>STDM</b>	Date/Time <b>4/23/19 @ 1411</b>
--------------------------------	-------------------------------	-----------------------------	------------------------------------

No.	Parameter	Date/Time	Received by:	Date/Time	Sample No.	Sample Type/Size	Sample Preservation	Analysis Required	Field Results/Remarks	Due Date	
											1
2	Chloride	7	Total P	12	TSS	17	Coliform (Specify)	22	8015 GRO	27	8081 Pest
3	Ammonia N	8	Total Diss. P	13	TDS	18	COD	23	8015 DRO	28	8082 PCB
4	Nitrite N	9	BOD	14	Turbidity	19	VT PCF	24	8260B	29	PP13 Metals
5	Nitrate N	10	Alkalinity	15	Conductivity	20	VOC Halocarbons	25	8270 B/N or Acid	30	Total RCRA8
31	Metals (Total, Diss.) Ag, Al, As, B, Ba, Be, Ca, Cd, Co, Cr, Cu, Fe, Hg, K, Mg, Mn, Mo, Na, Ni, Pb, Sb, Se, Sn, Ti, U, V, Zn										
32	TCCLP (volatiles, semi-volatiles, metals, pesticides, herbicides)										
34	Corrosivity	35	Ignitability	36	Reactivity	37	Other	33	Other		
38	Other										

LAB USE ONLY  
 Delivery: Client  
 Temp: 23.4  
 Comment:

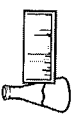

**ENDYNE, INC.**  
 160 James Brown Drive  
 Williston, Vermont 05495  
 (802) 879-4333

**CHAIN-OF-CUSTODY-RECORD**

Special Reporting Instructions/PO#:

Project Name: <b>CVU</b>	Client/Contact Name:	Sampler Name:
State of Origin: VT <u>NY</u> NH <u>Other</u>	Phone #:	Phone #:
Endyne WO #	Mailing Address:	Billing Address:

Sample Location	Matrix	G R A B	C O M P	Date/Time Sampled	Sample Containers		Sample Preservation	Analysis Required	Field Results/Remarks	Due Date
					No.	Type/Size				
CVU-11A				4/23/15						
CVU-11B				1318						
CVU-12A				1320						
CVU-12B				1322						
CVU-13A				1327						
CVU-13B				1325						
CVU-14A				1327						
CVU-14B				1327						
CVU-15A				1329						
CVU-15B				1330						
CVU-15C				1332						

Relinquished by: <i>[Signature]</i>	Date/Time 4/23 17:0	Received by: <i>[Signature]</i>	Date/Time 4/23/15 @ 1411
--	------------------------	------------------------------------	-----------------------------

1	pH	6	TKN	11	Total Solids	16	Sulfate	21	1664 TPH/FOG	26	8270 PAH Only	LAB USE ONLY
3	Ammonia N	8	Total Diss. P	13	TDS	18	COD	23	8015 DRO	28	8082 PCB	Temp: 23.4
4	Nitrite N	9	BOD	14	Turbidity	19	VT PCF	24	8260B	29	PP13 Metals	Comment:
5	Nitrate N	10	Alkalinity	15	Conductivity	20	VOC Halocarbons	25	8270 B/N or Acid	30	Total RCRA8	
31	Metals (Total, Diss.) Ag, Al, As, B, Ba, Be, Ca, Cd, Co, Cr, Cu, Fe, Hg, K, Mg, Mn, Mo, Na, Ni, Pb, Sb, Se, Sn, Tl, U, V, Zn											
32	TCLP (volatiles, semi-volatiles, metals, pesticides, herbicides)											
34	Corrosivity	35	Ignitability	36	Reactivity	37	Other	33	Other			
38	Other											



**APPENDIX B**  
**Sample Location Diagram**

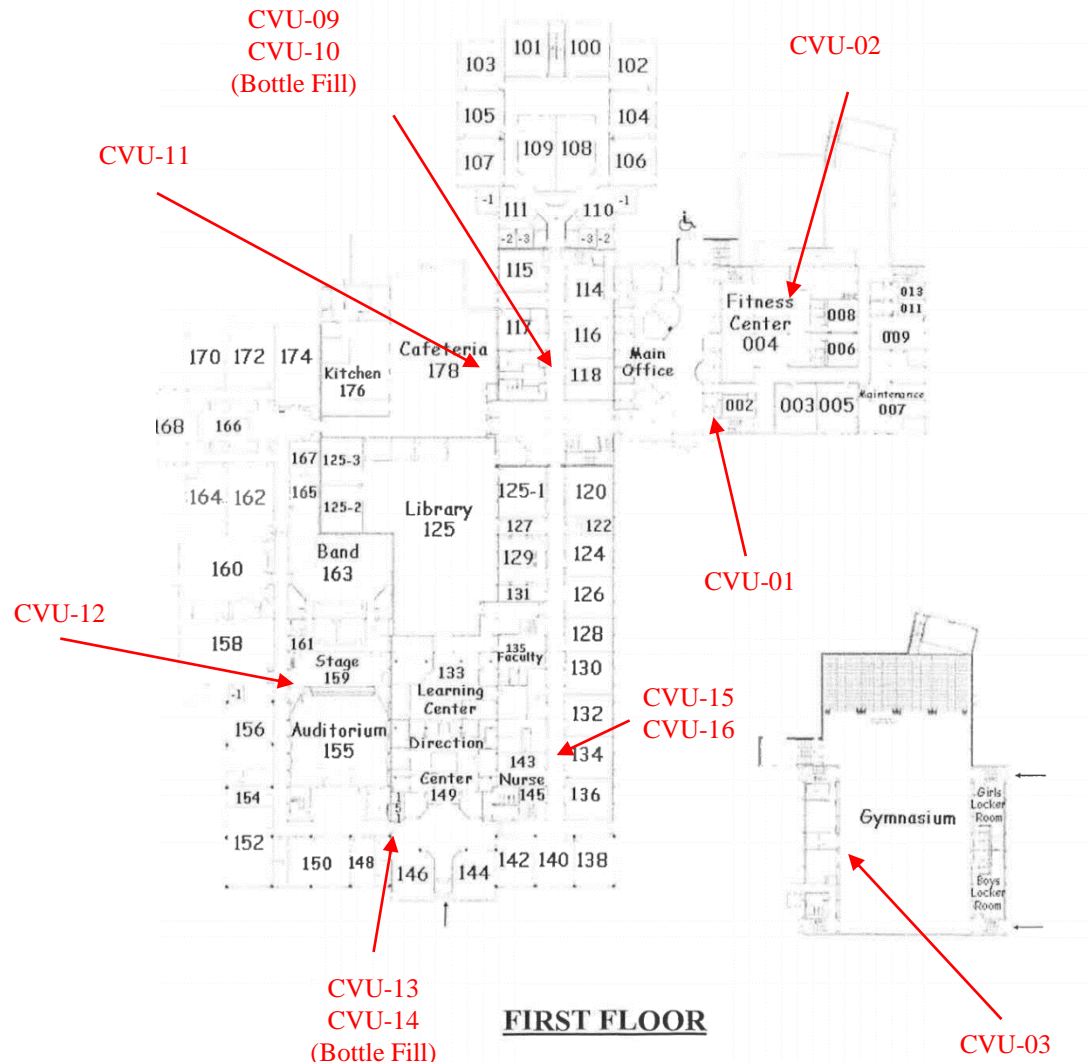

CVU-00 – Water Sample Location

## Water Sample Location Diagram – 4/23/19

Address: Champlain Valley Union High School  
Hinesburg, Vermont

Project Number: 280EM00349



171 Commerce St. Williston, Vermont 05495  
Phone: (802) 862-1980 Fax: (802) 862-1405

CVU-05  
CVU-06  
(Bottle Fill)

CVU-07

CVU-08

CVU-04

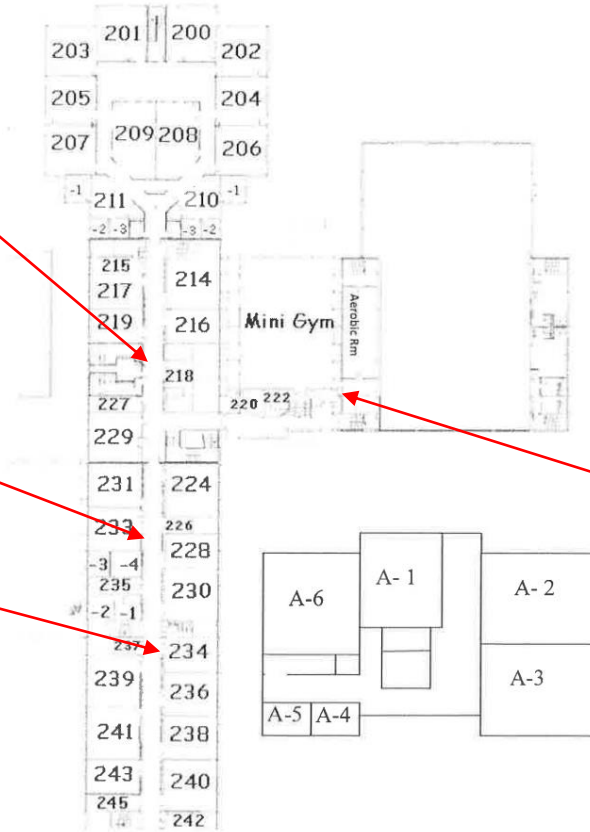

**SECOND FLOOR**

CVU-00 – Water Sample Location

**Water Sample Location Diagram – 4/23/19**

**Address: Hinesburg Community School  
Hinesburg, Vermont**

**Project Number: 280EM00349**



**171 Commerce St. Williston, Vermont 05495  
Phone:(802) 862-1980 Fax: (802) 862-1405**

**APPENDIX C**  
**ATC and Laboratory Certifications**

**Vermont Drinking Water Certification**  
**Analytical Methods**  
 Issued December 29, 2018 as provided for in 18 VSA 501b  
 Expiration Date December 31, 2019  
 This listing is not valid without accompanying Vermont Certificate  
**Endyne, Inc.**  
**Williston, VT**

**DRINKING WATER MICROBIOLOGY**

Total coliform and *E. coli* (SM 9223 B):

Colilert, P/A      Colisure, P/A      Colilert, QuantiTray

Uranium:

EPA 200.8

Vanadium:

EPA 200.8

Zinc:

EPA 200.7      EPA 200.8

**DRINKING WATER METALS**

Aluminum:      EPA 200.7      EPA 200.8  
 Antimony:      EPA 200.8  
 Arsenic:      EPA 200.8  
 Barium:      EPA 200.7      EPA 200.8  
 Beryllium:      EPA 200.7      EPA 200.8  
 Cadmium:      EPA 200.7      EPA 200.8  
 Calcium:      EPA 200.7  
 Chromium:      EPA 200.7      EPA 200.8  
 Copper:      EPA 200.7      EPA 200.8  
 Iron:      EPA 200.7  
 Lead:      EPA 200.8  
 Magnesium:      EPA 200.7  
 Manganese:      EPA 200.7      EPA 200.8  
 Mercury:      EPA 200.8      EPA 245.1  
 Molybdenum:      EPA 200.8  
 Nickel:      EPA 200.7      EPA 200.8  
 Selenium:      EPA 200.8  
 Silver:      EPA 200.7      EPA 200.8  
 Sodium:      EPA 200.7  
 Thallium:      EPA 200.8

**DRINKING WATER INORGANIC CONTAMINANTS**

Chloride:      EPA 300.0  
 Color:      SM 2120 B  
 Conductivity (Specific Conductance):      EPA 120.1  
 Corrosivity (Langlier Index):      SM 2330 B  
 Fluoride:      EPA 300.0  
 Hardness (Calc.):      EPA 200.7  
 Nitrate-N:      EPA 300.0  
 Nitrite-N:      EPA 300.0  
 Odor:      SM 2150 B  
 Orthophosphate:      EPA 300.0  
 Residue, Total Filterable (TDS):      SM 2540 C  
 Sulfate:      EPA 300.0  
 Turbidity:      EPA 180.1  
 UV 254:      SM 5910 B

**DRINKING WATER ACIDS, BASE/NEUTRALS**

Benzo(a)pyrene:      EPA 525.2  
 Di(2-ethylhexyl)adipate:      EPA 525.2  
 Di(2-ethylhexyl)phthalate:      EPA 525.2

**DRINKING WATER METALS**

**DRINKING WATER HERBICIDES**

2,4-D: EPA 515.4  
Dalapon: EPA 515.4  
Dicamba: EPA 515.4  
Dinoseb: EPA 515.4  
Pentachlorophenol: EPA 515.4  
Picloram: EPA 515.4  
2,4-TP (Silvex): EPA 515.4

**DRINKING WATER INSECTICIDES (PESTICIDES)**

Alachlor: EPA 525.2  
Aldrin: EPA 505  
Atrazine: EPA 525.2  
Butachlor: EPA 525.2  
Chlordane: EPA 505  
Dieldrin: EPA 505  
Endrin: EPA 505  
Heptachlor: EPA 505  
Heptachlor Epoxide: EPA 505  
Lindane: EPA 505  
Methoxychlor: EPA 505  
Metolachlor: EPA 525.2  
Metribuzin: EPA 525.2  
Propachlor: EPA 525.2  
Simazine: EPA 525.2  
Toxaphene: EPA 505

**INDIVIDUAL DRINKING WATER ORGANIC CONTAMINANTS**

DBCP: EPA 504.1  
EDB: EPA 504.1  
1,2,3 Trichloropropane: EPA 524.2

**DRINKING WATER TRIHALOMETHANES**

Bromodichloromethane: EPA 524.2

Bromoform: EPA 524.2  
Chlorodibromomethane: EPA 524.2  
Chloroform: EPA 524.2  
Total Trihalomethanes: EPA 524.2

**DRINKING WATER VOLATILE ORGANICS**

Benzene: EPA 524.2  
Bromobenzene: EPA 524.2  
Bromochloromethane: EPA 524.2  
Bromodichloromethane: EPA 524.2  
Bromoform: EPA 524.2  
Bromomethane: EPA 524.2  
n-Butylbenzene: EPA 524.2  
sec-Butylbenzene: EPA 524.2  
tert-Butylbenzene: EPA 524.2  
Carbon Tetrachloride: EPA 524.2  
Chlorobenzene: EPA 524.2  
Chloroethane: EPA 524.2  
Chloroform: EPA 524.2  
Chloromethane: EPA 524.2  
2-Chlorotoluene: EPA 524.2  
4-Chlorotoluene: EPA 524.2  
Dibromochloromethane: EPA 524.2  
Dibromomethane: EPA 524.2  
1,2-Dichlorobenzene: EPA 524.2  
1,3-Dichlorobenzene: EPA 524.2  
1,4-Dichlorobenzene: EPA 524.2  
Dichlorodifluoromethane: EPA 524.2  
1,1-Dichloroethane: EPA 524.2  
1,2-Dichloroethane: EPA 524.2  
c-1,2-Dichloroethene: EPA 524.2  
t 1,2-Dichloroethylene: EPA 524.2

**DRINKING WATER VOLATILE ORGANICS (cont.)**

1,1-Dichloroethylene: EPA 524.2

Dichloromethane:  
EPA 524.2  
1,2-Dichloropropane:  
EPA 524.2  
1,3-Dichloropropane:  
EPA 524.2  
2,2-Dichloropropane:  
EPA 524.2  
1,1-Dichloropropene:  
EPA 524.2  
c 1,3-Dichloropropene:  
EPA 524.2  
t 1,3-Dichloropropene:  
EPA 524.2  
Ethylbenzene:  
EPA 524.2  
Hexachlorbutadiene:  
EPA 524.2  
Isopropylbenzene:  
EPA 524.2  
4-Isopropyltoluene:  
EPA 524.2  
Methyl t-Butyl Ether (MTBE):  
EPA 524.2  
Naphthalene:  
EPA 524.2  
n-Propylbenzene:  
EPA 524.2  
Styrene:  
EPA 524.2  
1,1,1,2-Tetrachloroethane:  
EPA 524.2  
1,1,2,2-Tetrachloroethane:  
EPA 524.2  
Tetrachloroethylene:  
EPA 524.2  
Toluene:

1,2,3-Trichlorobenzene:  
EPA 524.2  
1,2,4-Trichlorobenzene:  
EPA 524.2  
1,1,1-Trichloroethane:  
EPA 524.2  
1,1,2-Trichloroethane:  
EPA 524.2  
Trichloroethylene:  
EPA 524.2  
Trichlorofluoromethane:  
EPA 524.2  
1,2,3 Trichloropropane:  
EPA 524.2  
1,2,4-Trimethylbenzene:  
EPA 524.2  
1,3,5-Trimethylbenzene:  
EPA 524.2  
Total Xylenes:  
EPA 524.2  
Vinyl Chloride:  
EPA 524.2

**DRINKING WATER ORGANIC DISINFECTION BY-  
PRODUCTS HALOACETIC ACIDS**

Bromoacetic Acid:  
EPA 552.2  
Chloroacetic Acid:  
EPA 552.2  
Dibromoacetic Acid:  
EPA 552.2  
Dichloroacetic Acid:  
EPA 552.2  
Trichloroacetic Acid:  
EPA 552.2  
Total Haloacetic Acids:  
EPA 552.2

**DRINKING WATER VOLATILE ORGANICS (cont.)**  
EPA 524.2

By:



William G. Mills  
Certification Officer  
Date signed and effective December 29, 2018

As of December 29, 2018, this listing supersedes all previous lists for this certificate number.  
Vermont Certification is based in part upon current New York Accreditation Certificate of Approval NY lab ID 11263-58567, April 1, 2018 – April 1, 2019 (Revised August 27, 2018). Laboratories are certified in Vermont based, in part, upon its Primary Accrediting Body(ies) drinking water accreditation(s). Also, loss of drinking water primary accreditation (in part or whole) constitutes loss of certification in Vermont for the same drinking water tests.



DEPARTMENT OF HEALTH

*State of Vermont Department of Health  
Drinking Water Laboratory Certification*

*Endyne, Inc.  
Williston, Vermont*

*Is certified to perform microbiological, inorganic and organic analyses on drinking water pursuant to the certification letter dated December 29, 2018.*

  
\_\_\_\_\_  
Commissioner of Health

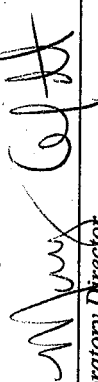
  
\_\_\_\_\_  
Laboratory Director

  
\_\_\_\_\_  
Laboratory Certification Officer

January 1, 2019  
Date certified

VT - 2021  
Laboratory Number

December 31, 2019  
Certificate expiration date