



ENVIRONMENTAL • GEOTECHNICAL
BUILDING SCIENCES • MATERIALS TESTING

171 Commerce Street
Williston, VT 05495
Telephone 802-862-1980
Fax 737-207-8272
www.atcgroupservices.com

May 9, 2019

Mr. Kurt Proulx
5420 Shelburne Road
Shelburne, VT 05482

RE: Lead in Drinking Water Sampling
Allen Brook School
Champlain Valley School District
Williston, VT 05495
ATC Project #280EM00349

Dear Kurt:

This report details the lead in drinking water sampling conducted at the Allen Brook School, located in Williston, Vermont. ATC understands that the Allen Brook School receives their water from the Champlain Water District.

On April 22, 2019, ATC Group Services (ATC) conducted sampling at 25 locations as directed by CVSD facilities personnel. Each sampling location consisted of two (2) samples (A & B), a first draw (A) collected from a system left unused for a minimum of 6 hours and a flush sample (B) collected after location had been flushed with moving water for a minimum of 30 seconds. One (1) Blank sample per day and two (2) duplicate samples per facility were also collected for quality control purposes.

Lead in drinking water samples were submitted for analysis via EPA method SM 200.8 to Endyne Environmental Laboratories in Williston, Vermont.

NONE of the samples collected exceeded the Vermont Department of Health (VDH) Vermont Health Advisory (VHA) Drinking Water Guidance level of 15 ug/L for Lead. All samples were found to be below the laboratory detection limit of 1.0 ug/L.

Laboratory analytical results are included in **Appendix A** and a sample location diagram can be found in **Appendix B**. Applicable certifications are included as **Appendix C**.



Thank you for selecting ATC for your environmental management needs. If you have any questions concerning this correspondence, please feel free to contact us at 862-1980.

Sincerely,
ATC Group Services, LLC

A handwritten signature in black ink that reads "Harland Miller". The signature is written in a cursive style with a long horizontal stroke extending to the right.

For: Harland Miller
Senior Environmental Technician
Direct Line +1 802-862-1980
Email: harland.miller@atcgs.com

A handwritten signature in black ink that reads "Robert Montgomery". The signature is written in a cursive style with a long horizontal stroke extending to the right.

Robert Montgomery
Senior Project Manager
Direct Line +1 802-862-1980
Email: rob.montgomery@atcgs.com

APPENDIX A

Lead in Drinking Water Laboratory Results



ATC Group Services
PO Box 1486 100043
Williston, VT 05495

Atten: Harland Miller

PROJECT: Allen Brook School
WORK ORDER: **1904-08727**
DATE RECEIVED: April 22, 2019
DATE REPORTED: April 26, 2019
SAMPLER: Harland Miller

Laboratory Report

Enclosed please find the results of the analyses performed for the samples referenced on the attached chain of custody. All required method quality control elements including instrument calibration were performed in accordance with method requirements and determined to be acceptable unless otherwise noted.

The column labeled Lab/Tech in the accompanying report denotes the laboratory facility where the testing was performed and the technician who conducted the assay. A "W" designates the Williston, VT lab under NELAC certification ELAP 11263; "R" designates the Lebanon, NH facility under certification NH 2037 and "N" the Plattsburgh, NY lab under certification ELAP 11892. "Sub" indicates the testing was performed by a subcontracted laboratory. The accreditation status of the subcontracted lab is referenced in the corresponding NELAC and Qual fields.

The NELAC column also denotes the accreditation status of each laboratory for each reported parameter. "A" indicates the referenced laboratory is NELAC accredited for the parameter reported. "N" indicates the laboratory is not accredited. "U" indicates that NELAC does not offer accreditation for that parameter in that specific matrix. Test results denoted with an "A" meet all National Environmental Laboratory Accreditation Program requirements except where denoted by pertinent data qualifiers. Test results are representative of the samples as they were received at the laboratory

Endyne, Inc. warrants, to the best of its knowledge and belief, the accuracy of the analytical test results contained in this report, but makes no other warranty, expressed or implied, especially no warranties of merchantability or fitness for a particular purpose.

Reviewed by:

Harry B. Locker, Ph.D.
Laboratory Director

Laboratory Report

DATE REPORTED: 04/26/2019

CLIENT: ATC Group Services
PROJECT: Allen Brook SchoolWORK ORDER: 1904-08727
DATE RECEIVED: 04/22/2019

001	Site: ABS - 01A			Date Sampled: 4/22/19	Time: 10:57		
Parameter	Result	Units	Method	Analysis Date/Time	Lab/Tech	NELAC	Qual.
Lead, Total	< 0.0010	mg/L	EPA 200.8	4/25/19 12:13	W SJM	A	
002	Site: ABS - 01B			Date Sampled: 4/22/19	Time: 10:59		
Parameter	Result	Units	Method	Analysis Date/Time	Lab/Tech	NELAC	Qual.
Lead, Total	< 0.0010	mg/L	EPA 200.8	4/25/19 12:21	W SJM	A	
003	Site: ABS - 02A			Date Sampled: 4/22/19	Time: 11:00		
Parameter	Result	Units	Method	Analysis Date/Time	Lab/Tech	NELAC	Qual.
Lead, Total	< 0.0010	mg/L	EPA 200.8	4/25/19 12:23	W SJM	A	
004	Site: ABS - 02B			Date Sampled: 4/22/19	Time: 11:02		
Parameter	Result	Units	Method	Analysis Date/Time	Lab/Tech	NELAC	Qual.
Lead, Total	< 0.0010	mg/L	EPA 200.8	4/25/19 12:26	W SJM	A	
005	Site: ABS - 03A			Date Sampled: 4/22/19	Time: 11:08		
Parameter	Result	Units	Method	Analysis Date/Time	Lab/Tech	NELAC	Qual.
Lead, Total	< 0.0010	mg/L	EPA 200.8	4/25/19 12:28	W SJM	A	
006	Site: ABS - 03B			Date Sampled: 4/22/19	Time: 11:10		
Parameter	Result	Units	Method	Analysis Date/Time	Lab/Tech	NELAC	Qual.
Lead, Total	< 0.0010	mg/L	EPA 200.8	4/25/19 12:31	W SJM	A	
007	Site: ABS - 04A			Date Sampled: 4/22/19	Time: 11:12		
Parameter	Result	Units	Method	Analysis Date/Time	Lab/Tech	NELAC	Qual.
Lead, Total	< 0.0010	mg/L	EPA 200.8	4/25/19 12:33	W SJM	A	
008	Site: ABS - 04B			Date Sampled: 4/22/19	Time: 11:14		
Parameter	Result	Units	Method	Analysis Date/Time	Lab/Tech	NELAC	Qual.
Lead, Total	< 0.0010	mg/L	EPA 200.8	4/25/19 12:36	W SJM	A	
009	Site: ABS - 05A			Date Sampled: 4/22/19	Time: 11:17		
Parameter	Result	Units	Method	Analysis Date/Time	Lab/Tech	NELAC	Qual.
Lead, Total	< 0.0010	mg/L	EPA 200.8	4/25/19 12:39	W SJM	A	
010	Site: ABS - 05B			Date Sampled: 4/22/19	Time: 11:18		
Parameter	Result	Units	Method	Analysis Date/Time	Lab/Tech	NELAC	Qual.
Lead, Total	< 0.0010	mg/L	EPA 200.8	4/25/19 12:41	W SJM	A	
011	Site: ABS - 06A			Date Sampled: 4/22/19	Time: 11:20		

Laboratory Report

DATE REPORTED: 04/26/2019

CLIENT: ATC Group Services
PROJECT: Allen Brook SchoolWORK ORDER: 1904-08727
DATE RECEIVED: 04/22/2019

011	Site: ABS - 06A			Date Sampled: 4/22/19	Time: 11:20		
Parameter	Result	Units	Method	Analysis Date/Time	Lab/Tech	NELAC	Qual.
Lead, Total	< 0.0010	mg/L	EPA 200.8	4/25/19 12:49	W SJM	A	
012	Site: ABS - 06B			Date Sampled: 4/22/19	Time: 11:22		
Parameter	Result	Units	Method	Analysis Date/Time	Lab/Tech	NELAC	Qual.
Lead, Total	< 0.0010	mg/L	EPA 200.8	4/25/19 12:56	W SJM	A	
013	Site: ABS - 07A			Date Sampled: 4/22/19	Time: 11:27		
Parameter	Result	Units	Method	Analysis Date/Time	Lab/Tech	NELAC	Qual.
Lead, Total	< 0.0010	mg/L	EPA 200.8	4/25/19 12:59	W SJM	A	
014	Site: ABS - 07B			Date Sampled: 4/22/19	Time: 11:29		
Parameter	Result	Units	Method	Analysis Date/Time	Lab/Tech	NELAC	Qual.
Lead, Total	< 0.0010	mg/L	EPA 200.8	4/25/19 13:01	W SJM	A	
015	Site: ABS - 08A			Date Sampled: 4/22/19	Time: 11:30		
Parameter	Result	Units	Method	Analysis Date/Time	Lab/Tech	NELAC	Qual.
Lead, Total	< 0.0010	mg/L	EPA 200.8	4/25/19 13:04	W SJM	A	
016	Site: ABS - 08B			Date Sampled: 4/22/19	Time: 11:32		
Parameter	Result	Units	Method	Analysis Date/Time	Lab/Tech	NELAC	Qual.
Lead, Total	< 0.0010	mg/L	EPA 200.8	4/25/19 13:07	W SJM	A	
017	Site: ABS - 09A			Date Sampled: 4/22/19	Time: 11:36		
Parameter	Result	Units	Method	Analysis Date/Time	Lab/Tech	NELAC	Qual.
Lead, Total	< 0.0010	mg/L	EPA 200.8	4/25/19 13:09	W SJM	A	
018	Site: ABS - 09B			Date Sampled: 4/22/19	Time: 11:37		
Parameter	Result	Units	Method	Analysis Date/Time	Lab/Tech	NELAC	Qual.
Lead, Total	< 0.0010	mg/L	EPA 200.8	4/25/19 13:12	W SJM	A	
019	Site: ABS - 10A			Date Sampled: 4/22/19	Time: 11:39		
Parameter	Result	Units	Method	Analysis Date/Time	Lab/Tech	NELAC	Qual.
Lead, Total	< 0.0010	mg/L	EPA 200.8	4/25/19 13:14	W SJM	A	
020	Site: ABS - 10B			Date Sampled: 4/22/19	Time: 11:40		
Parameter	Result	Units	Method	Analysis Date/Time	Lab/Tech	NELAC	Qual.
Lead, Total	< 0.0010	mg/L	EPA 200.8	4/25/19 13:17	W SJM	A	
021	Site: ABS - 11A			Date Sampled: 4/22/19	Time: 11:42		

Laboratory Report

DATE REPORTED: 04/26/2019

CLIENT: ATC Group Services
PROJECT: Allen Brook SchoolWORK ORDER: 1904-08727
DATE RECEIVED: 04/22/2019

021	Site: ABS - 11A			Date Sampled: 4/22/19	Time: 11:42			
Parameter	Result	Units	Method	Analysis Date/Time	Lab/Tech	NELAC	Qual.	
Lead, Total	< 0.0010	mg/L	EPA 200.8	4/25/19 13:27	W SJM	A		
022	Site: ABS - 11B			Date Sampled: 4/22/19	Time: 11:43			
Parameter	Result	Units	Method	Analysis Date/Time	Lab/Tech	NELAC	Qual.	
Lead, Total	< 0.0010	mg/L	EPA 200.8	4/25/19 13:35	W SJM	A		
023	Site: ABS - 12A			Date Sampled: 4/22/19	Time: 11:45			
Parameter	Result	Units	Method	Analysis Date/Time	Lab/Tech	NELAC	Qual.	
Lead, Total	< 0.0010	mg/L	EPA 200.8	4/25/19 13:37	W SJM	A		
024	Site: ABS - 12B			Date Sampled: 4/22/19	Time: 11:47			
Parameter	Result	Units	Method	Analysis Date/Time	Lab/Tech	NELAC	Qual.	
Lead, Total	< 0.0010	mg/L	EPA 200.8	4/25/19 13:40	W SJM	A		
025	Site: ABS - 13A			Date Sampled: 4/22/19	Time: 11:49			
Parameter	Result	Units	Method	Analysis Date/Time	Lab/Tech	NELAC	Qual.	
Lead, Total	< 0.0010	mg/L	EPA 200.8	4/25/19 13:42	W SJM	A		
026	Site: ABS - 13B			Date Sampled: 4/22/19	Time: 11:50			
Parameter	Result	Units	Method	Analysis Date/Time	Lab/Tech	NELAC	Qual.	
Lead, Total	< 0.0010	mg/L	EPA 200.8	4/25/19 13:45	W SJM	A		
027	Site: ABS - 14A			Date Sampled: 4/22/19	Time: 11:51			
Parameter	Result	Units	Method	Analysis Date/Time	Lab/Tech	NELAC	Qual.	
Lead, Total	< 0.0010	mg/L	EPA 200.8	4/25/19 13:47	W SJM	A		
028	Site: ABS - 14B			Date Sampled: 4/22/19	Time: 10:52			
Parameter	Result	Units	Method	Analysis Date/Time	Lab/Tech	NELAC	Qual.	
Lead, Total	< 0.0010	mg/L	EPA 200.8	4/25/19 13:50	W SJM	A		
029	Site: ABS - 15A			Date Sampled: 4/22/19	Time: 11:54			
Parameter	Result	Units	Method	Analysis Date/Time	Lab/Tech	NELAC	Qual.	
Lead, Total	< 0.0010	mg/L	EPA 200.8	4/25/19 13:53	W SJM	A		
030	Site: ABS - 15B			Date Sampled: 4/22/19	Time: 11:55			
Parameter	Result	Units	Method	Analysis Date/Time	Lab/Tech	NELAC	Qual.	
Lead, Total	< 0.0010	mg/L	EPA 200.8	4/25/19 13:55	W SJM	A		
031	Site: ABS - 16A			Date Sampled: 4/22/19	Time: 11:56			

Laboratory Report

DATE REPORTED: 04/26/2019

CLIENT: ATC Group Services
PROJECT: Allen Brook SchoolWORK ORDER: 1904-08727
DATE RECEIVED: 04/22/2019

031	Site: ABS - 16A			Date Sampled: 4/22/19	Time: 11:56			
Parameter	Result	Units	Method	Analysis Date/Time	Lab/Tech	NELAC	Qual.	
Lead, Total	< 0.0010	mg/L	EPA 200.8	4/25/19 14:03	W SJM	A		
032	Site: ABS - 16B			Date Sampled: 4/22/19	Time: 11:57			
Parameter	Result	Units	Method	Analysis Date/Time	Lab/Tech	NELAC	Qual.	
Lead, Total	< 0.0010	mg/L	EPA 200.8	4/25/19 14:11	W SJM	A		
033	Site: ABS - 17A			Date Sampled: 4/22/19	Time: 11:59			
Parameter	Result	Units	Method	Analysis Date/Time	Lab/Tech	NELAC	Qual.	
Lead, Total	< 0.0010	mg/L	EPA 200.8	4/25/19 14:13	W SJM	A		
034	Site: ABS - 17B			Date Sampled: 4/22/19	Time: 12:01			
Parameter	Result	Units	Method	Analysis Date/Time	Lab/Tech	NELAC	Qual.	
Lead, Total	< 0.0010	mg/L	EPA 200.8	4/25/19 14:16	W SJM	A		
035	Site: ABS - 18A			Date Sampled: 4/22/19	Time: 12:03			
Parameter	Result	Units	Method	Analysis Date/Time	Lab/Tech	NELAC	Qual.	
Lead, Total	< 0.0010	mg/L	EPA 200.8	4/25/19 14:18	W SJM	A		
036	Site: ABS - 18B			Date Sampled: 4/22/19	Time: 12:05			
Parameter	Result	Units	Method	Analysis Date/Time	Lab/Tech	NELAC	Qual.	
Lead, Total	< 0.0010	mg/L	EPA 200.8	4/25/19 14:21	W SJM	A		
037	Site: ABS - 19A			Date Sampled: 4/22/19	Time: 12:17			
Parameter	Result	Units	Method	Analysis Date/Time	Lab/Tech	NELAC	Qual.	
Lead, Total	< 0.0010	mg/L	EPA 200.8	4/25/19 14:24	W SJM	A		
038	Site: ABS - 19B			Date Sampled: 4/22/19	Time: 12:04			
Parameter	Result	Units	Method	Analysis Date/Time	Lab/Tech	NELAC	Qual.	
Lead, Total	< 0.0010	mg/L	EPA 200.8	4/25/19 14:26	W SJM	A		
039	Site: ABS - 20A			Date Sampled: 4/22/19	Time: 12:11			
Parameter	Result	Units	Method	Analysis Date/Time	Lab/Tech	NELAC	Qual.	
Lead, Total	< 0.0010	mg/L	EPA 200.8	4/25/19 14:29	W SJM	A		
040	Site: ABS - 20B			Date Sampled: 4/22/19	Time: 12:13			
Parameter	Result	Units	Method	Analysis Date/Time	Lab/Tech	NELAC	Qual.	
Lead, Total	< 0.0010	mg/L	EPA 200.8	4/25/19 14:31	W SJM	A		
041	Site: ABS - 21A			Date Sampled: 4/22/19	Time: 12:14			

Laboratory Report

DATE REPORTED: 04/26/2019

CLIENT: ATC Group Services
PROJECT: Allen Brook SchoolWORK ORDER: 1904-08727
DATE RECEIVED: 04/22/2019

041	Site: ABS - 21A			Date Sampled: 4/22/19	Time: 12:14			
Parameter	Result	Units	Method	Analysis Date/Time	Lab/Tech	NELAC	Qual.	
Lead, Total	< 0.0010	mg/L	EPA 200.8	4/25/19 14:41	W SJM	A		
042	Site: ABS - 21B			Date Sampled: 4/22/19	Time: 12:16			
Parameter	Result	Units	Method	Analysis Date/Time	Lab/Tech	NELAC	Qual.	
Lead, Total	< 0.0010	mg/L	EPA 200.8	4/25/19 14:49	W SJM	A		
043	Site: ABS - 22A			Date Sampled: 4/22/19	Time: 12:17			
Parameter	Result	Units	Method	Analysis Date/Time	Lab/Tech	NELAC	Qual.	
Lead, Total	< 0.0010	mg/L	EPA 200.8	4/25/19 14:52	W SJM	A		
044	Site: ABS - 22B			Date Sampled: 4/22/19	Time: 12:19			
Parameter	Result	Units	Method	Analysis Date/Time	Lab/Tech	NELAC	Qual.	
Lead, Total	< 0.0010	mg/L	EPA 200.8	4/25/19 14:54	W SJM	A		
045	Site: ABS - 23A			Date Sampled: 4/22/19	Time: 12:19			
Parameter	Result	Units	Method	Analysis Date/Time	Lab/Tech	NELAC	Qual.	
Lead, Total	< 0.0010	mg/L	EPA 200.8	4/25/19 14:57	W SJM	A		
046	Site: ABS - 23B			Date Sampled: 4/22/19	Time: 12:21			
Parameter	Result	Units	Method	Analysis Date/Time	Lab/Tech	NELAC	Qual.	
Lead, Total	< 0.0010	mg/L	EPA 200.8	4/25/19 15:00	W SJM	A		
047	Site: ABS - 24A			Date Sampled: 4/22/19	Time: 12:23			
Parameter	Result	Units	Method	Analysis Date/Time	Lab/Tech	NELAC	Qual.	
Lead, Total	< 0.0010	mg/L	EPA 200.8	4/25/19 15:02	W SJM	A		
048	Site: ABS - 24B			Date Sampled: 4/22/19	Time: 12:25			
Parameter	Result	Units	Method	Analysis Date/Time	Lab/Tech	NELAC	Qual.	
Lead, Total	< 0.0010	mg/L	EPA 200.8	4/25/19 15:05	W SJM	A		
049	Site: ABS - 25A			Date Sampled: 4/22/19	Time: 12:25			
Parameter	Result	Units	Method	Analysis Date/Time	Lab/Tech	NELAC	Qual.	
Lead, Total	< 0.0010	mg/L	EPA 200.8	4/25/19 15:07	W SJM	A		
050	Site: ABS - 25B			Date Sampled: 4/22/19	Time: 12:26			
Parameter	Result	Units	Method	Analysis Date/Time	Lab/Tech	NELAC	Qual.	
Lead, Total	< 0.0010	mg/L	EPA 200.8	4/25/19 15:10	W SJM	A		
051	Site: ABS - 26A			Date Sampled: 4/22/19	Time: 12:25			

Laboratory Report

DATE REPORTED: 04/26/2019

CLIENT: ATC Group Services
 PROJECT: Allen Brook School

WORK ORDER: **1904-08727**
 DATE RECEIVED: 04/22/2019

051	Site: ABS - 26A			Date Sampled: 4/22/19	Time: 12:25			
<u>Parameter</u>	<u>Result</u>	<u>Units</u>	<u>Method</u>	<u>Analysis Date/Time</u>	<u>Lab/Tech</u>	<u>NELAC</u>	<u>Qual.</u>	
Lead, Total	< 0.0010	mg/L	EPA 200.8	4/25/19 15:18	W SJM	A		

052	Site: ABS - 026B			Date Sampled: 4/22/19	Time: 12:27			
<u>Parameter</u>	<u>Result</u>	<u>Units</u>	<u>Method</u>	<u>Analysis Date/Time</u>	<u>Lab/Tech</u>	<u>NELAC</u>	<u>Qual.</u>	
Lead, Total	< 0.0010	mg/L	EPA 200.8	4/25/19 15:25	W SJM	A		

CHAIN-OF-CUSTODY-RECORD
 280 FM 00349

Special Reporting Instructions/PO#:

Project Name: **Allen Brook School**
 State of Origin: VT NY NH Other
 Endyne WO #

Client/Contact Name: **ATC Group Services**
 Phone #: **82 812 1980**
 Mailing Address: **177 Commerce St. Williston VT**

Sampler Name: **Harold Miller**
 Phone #: **802 852 1980**
 Billing Address:

Sample Location	Matrix	G R A B	C O V P	Date/Time Sampled	Sample Containers		Sample Preservation	Analysis Required	Field Results/Remarks	Due Date
					No.	Type/Size				
ABS-01A	W	X		4/22/19	1	1122			4/22/19	
ABS-01B				1057						
ABS-02A				1059						
ABS-02B				1900 1100						
ABS-03A				1002 1102						
ABS-03B				1008 1108						
ABS-04A				1008 1108						
ABS-04B				1012 1112						
ABS-05A				1019 1119						
ABS-05B				1017 1117						
ABS-05B				1019 1119						

Relinquished by: **AM** Date/Time: **4/22 1700** Received by: **Stoney** Date/Time: **4/22/19 @ 13:08**

Received by:		Date/Time		Received by:		Date/Time	
21	1664 TPH/FOG	26	8270 PAH Only	26	8270 PAH Only	26	8270 PAH Only
22	8015 GRO	27	8081 Pest	27	8081 Pest	27	8081 Pest
23	8015 DRO	28	8082 PCB	28	8082 PCB	28	8082 PCB
24	VT PCF						
20	VOCF						
19	Turbidity						
18	COD						
17	Coliform (Specify)						
16	Sulfate						
15	Conductivity						
14	BOD						
13	Total Diss. P						
12	TSS						
11	Total Solids						
10	Alkalinity						
9	Nitrite N						
8	Ammonia N						
7	Total P						
6	TKN						
5	Nitrate N						
4	pH						
3	Chloride						
2	TKN						
1	pH						

1904-08727



ATC Group Services
 Allen Brook School

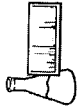

ENDYNE, INC.

160 James Brown Drive
Williston, Vermont 05495
(802) 879-4333

CHAIN-OF-CUSTODY-RECORD

Special Reporting Instructions/PO#:

Project Name: **ABS**

State of Origin: VT NY NH Other

Endyne WO #

Client/Contact Name: _____

Phone #: _____

Mailing Address: _____

Sampler Name: _____

Phone #: _____

Billing Address: _____

Sample Location	Matrix	C R A B	O M P	Date/Time Sampled	Sample Containers		Sample Preservation	Analysis Required	Field Results/Remarks	Due Date
					No.	Type/Size				
ABS-06A				1120						
ABS-06B				1122						
ABS-07A				1127						
ABS-07B				1129						
ABS-08A				1130						
ABS-08B				1132						
ABS-09A				1136						
ABS-09B				1137						
ABS-10A				1139						
ABS-10B				1140						

Relinquished by: *[Signature]* Date/Time: **1/12 1300**

Received by: *[Signature]* Date/Time: **4/22/19 @ 1308**

No.	Parameter	Date/Time	Received by:	
			Date/Time	Date/Time
1	pH			
2	Chloride			
3	Ammonia N			
4	Nitrite N			
5	Nitrate N			
6	TKN			
7	Total P			
8	Total Diss. P			
9	BOD			
10	Alkalinity			
11	Total Solids			
12	TSS			
13	TDS			
14	Turbidity			
15	Conductivity			
16	Sulfate			
17	Coliform (Specify)			
18	COD			
19	VT PCF			
20	VOC Halocarbons			
21	1664 TPH/FOG			
22	8015 GRO			
23	8015 DRO			
24	8260B			
25	8270 B/N or Acid			
26	8270 PAH Only			
27	8081 Pest			
28	8082 PCB			
29	PP13 Metals			
30	Total RCRA8			
31	Metals (Total, Diss.) Ag, Al, As, B, Ba, Be, Ca, Cd, Co, Cr, Cu, Fe, Hg, K, Mg, Mn, Mo, Na, Ni, Pb, Sb, Se, Sn, Ti, U, V, Zn			
32	TCLP (volatiles, semi-volatiles, metals, pesticides, herbicides)			
33	Other			
34	Corrosivity			
35	Ignitability			
36	Reactivity			
37	Other			
38	Other			

LAB USE ONLY

Delivery: *Client*

Temp: *22.3*

Comment:

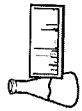

ENDYNE, INC.

160 James Brown Drive
Williston, Vermont 05495
(802) 879-4333

CHAIN-OF-CUSTODY-RECORD

Special Reporting Instructions/PO#:

Project Name: ABS	Client/Contact Name:	Sampler Name:
State of Origin: VT <u>X</u> NY NH Other	Phone #:	Phone #:
Endyne WO #	Mailing Address:	Billing Address:

Sample Location	Matrix	C R A B	C O M P	Date/Time Sampled	Sample Containers		Sample Preservation	Analysis Required	Field Results/Remarks	Due Date
					No.	Type/Size				
ABS- 11A				1142						
ABS- 11B				1145						
ABS- 12A				1145						
ABS- 12B				1172						
ABS- 13A				1179						
ABS- 13B				1150						
ABS- 14A				1151						
ABS- 14B				1152						
ABS- 15A				1154						
ABS- 15B				1155						

Relinquished by: <i>[Signature]</i>	Date/Time: 4/22/19 1300	Received by: <i>[Signature]</i>	Date/Time: 4/22/19 @ 1308
-------------------------------------	-------------------------	---------------------------------	---------------------------

No.	Parameter	Date/Time	Received by:	Date/Time	Sample No.	Sample Type/Size	Sample Preservation	Analysis Required	Field Results/Remarks	Due Date	
											1
2	Chloride	7	Total P	12	TSS	17	Coliform (Specify)	22	8015 GRO	27	8081 Pest
3	Ammonia N	8	Total Diss. P	13	TDS	18	COD	23	8015 DRO	28	8082 PCB
4	Nitrite N	9	BOD	14	Turbidity	19	VT PCF	24	8260B	29	PP13 Metals
5	Nitrate N	10	Alkalinity	15	Conductivity	20	VOC Halocarbons	25	8270 B/N or Acid	30	Total RCRA8
31	Metals (Total, Diss.) Ag, Al, As, B, Ba, Be, Ca, Cd, Co, Cr, Cu, Fe, Hg, K, Mg, Mn, Mo, Na, Ni, Pb, Sb, Se, Sn, Tl, U, V, Zn										
32	TCLP (volatiles, semi-volatiles, metals, pesticides, herbicides)										
34	Corrosivity	35	Ignitability	36	Reactivity	37	Other	38	Other		

LAB USE ONLY
 Delivery: Client
 Temp: 22.3
 Comment:

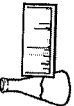

ENDYNE, INC.

160 James Brown Drive
Williston, Vermont 05495
(802) 879-4333

CHAIN-OF-CUSTODY-RECORD

Special Reporting Instructions/PO#:

Project Name: AGSS Client/Contact Name: _____
 State of Origin: VT NY NH Other _____
 Endyne WO # _____
 Sampler Name: _____
 Phone #: _____
 Billing Address: _____

Sample Location	Matrix	G R A B	C O M P	Date/Time Sampled	Sample Containers		Sample Preservation	Analysis Required	Field Results/Remarks	Due Date
					No.	Type/Size				
AGSS-16A				1156						
AGSS-16B				1157						
AGSS-17A				1159						
AGSS-17B				1201						
AGSS-18A				1203						
AGSS-18B				1205						
AGSS-19A				1217						
AGSS-19B				1204						
AGSS-20A				1211						
AGSS-20B				1213						

Relinquished by: HAL Date/Time: 4/22/13 Received by: Stoney Date/Time: 4/22/13 1300

Received by:		Date/Time	
21	1664 TPH/FOG	26	8270 PAH Only
22	Coliform (Specify)	27	8081 Pest
23	COD	28	8082 PCB
24	VT PCF	29	PPI3 Metals
25	VOC Halocarbons	30	Total RCRA8
11	Total Solids	16	Sulfate
12	TSS	17	Coliform (Specify)
13	Total Diss. P	18	COD
14	BOD	19	VT PCF
15	Alkalinity	20	VOC Halocarbons
31	Metals (Total, Diss.) Ag, Al, As, B, Ba, Be, Ca, Cd, Co, Cr, Cu, Fe, Hg, K, Mg, Mn, Mo, Na, Ni, Pb, Sb, Se, Sn, Tl, U, V, Zn		
32	TCLP (volatiles, semi-volatiles, metals, pesticides, herbicides)	33	Other
34	Corrosivity	35	Ignitability
36	Reactivity	37	Other
38	Other		

LAB USE ONLY
 Delivery: Client
 Temp: 22.3
 Comment: _____

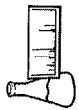

ENDYNE, INC.

160 James Brown Drive
Williston, Vermont 05495
(802) 879-4333

CHAIN-OF-CUSTODY-RECORD

Special Reporting Instructions/PO#:

Project Name: **ABS** Client/Contact Name: _____
 State of Origin: VT NY NH Other _____
 Endyne WO # _____
 Phone #: _____
 Mailing Address: _____
 Billing Address: _____

Sample Location	Matrix	C R A B	C O M P	Date/Time Sampled	Sample Containers		Sample Preservation	Analysis Required	Field Results/Remarks	Due Date
					No.	Type/Size				
ABS-21A				1214						
ABS-21B				1216						
ABS-22A				1217						
ABS-22B				1219						
ABS-23A				1219						
ABS-23B				1221						
ABS-24A				1223						
ABS-24B				1225						
ABS-25A				1225						
ABS-25B				1226						

Relinquished by: *[Signature]* Date/Time: *4/22 1:30* Received by: *CTDORNEY* Date/Time: *4/22/19 @ 1300*

LAB USE ONLY	
1	pH
2	Chloride
3	Ammonia N
4	Nitrite N
5	Nitrate N
6	TKN
7	Total P
8	Total Diss. P
9	BOD
10	Alkalinity
11	Total Solids
12	TSS
13	TDS
14	Turbidity
15	Conductivity
16	Sulfate
17	Coliform (Specify)
18	COD
19	VT PCF
20	VOC Halocarbons
21	1664 TPH/FOG
22	8015 GRO
23	8015 DRO
24	8260B
25	8270 B/N or Acid
26	8270 PAH Only
27	8081 Pest
28	8082 PCB
29	PP13 Metals
30	Total RCRA8
31	Metals (Total, Diss.) Ag, Al, As, B, Ba, Be, Ca, Cd, Co, Cr, Cu, Fe, Hg, K, Mg, Mn, Mo, Na, Ni, Pb, Sb, Se, Sn, Ti, U, V, Zn
32	TCLP (volatiles, semi-volatiles, metals, pesticides, herbicides)
33	Other
34	Corrosivity
35	Ignitability
36	Reactivity
37	Other
38	Other

Delivery: *Client*
 Temp: *223*
 Comment: _____

APPENDIX B
Sample Location Diagram

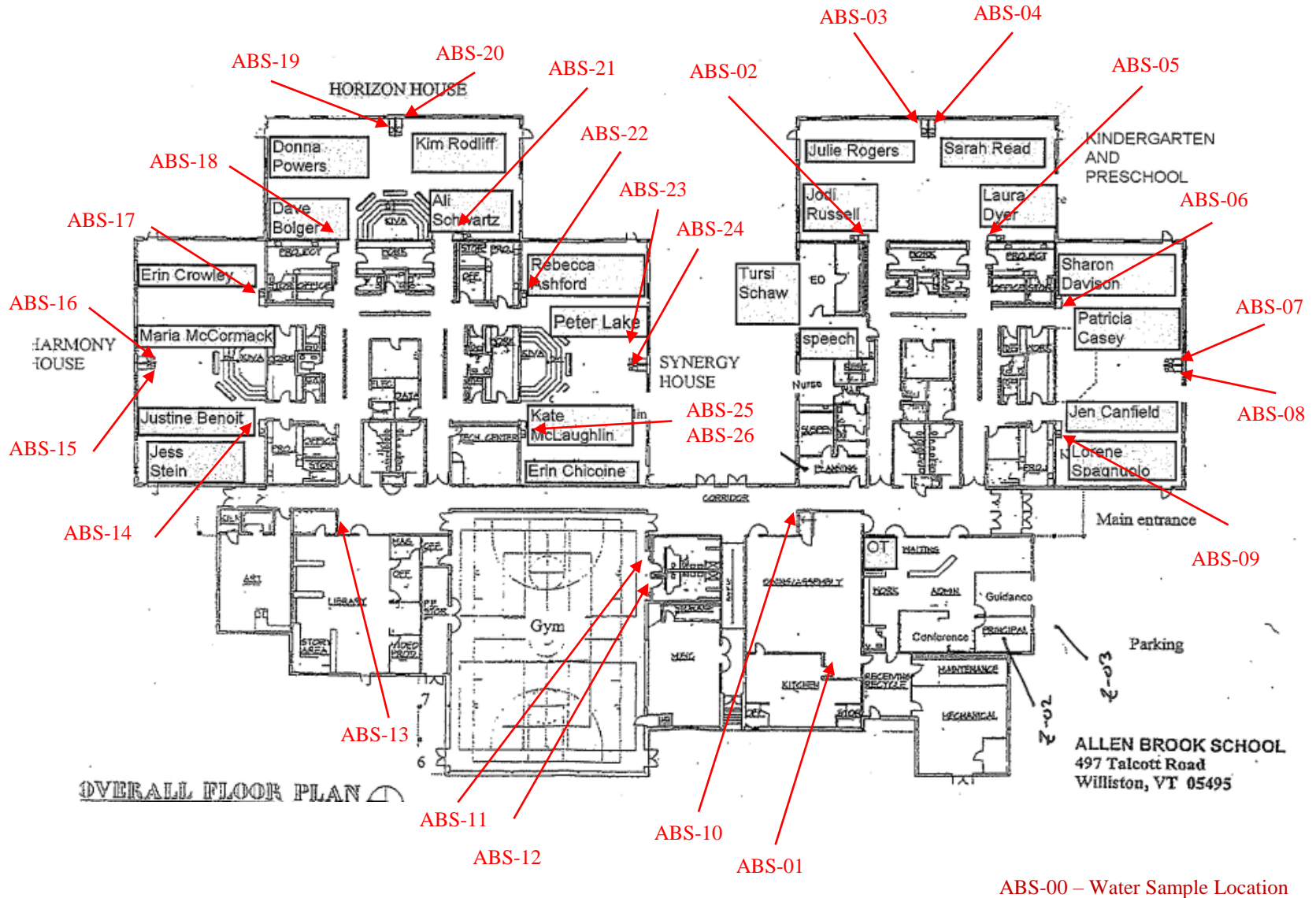

ABS-00 – Water Sample Location

Water Sample Location Diagram – 4/22/19

Address: Allen Brook School
195 Central School Drive
Williston, Vermont

Project Number: 280EM00349



171 Commerce St. Williston, Vermont 05495
Phone: (802) 862-1980 Fax: (802) 862-1405

APPENDIX C
ATC and Laboratory Certifications

Vermont Drinking Water Certification
Analytical Methods
 Issued December 29, 2018 as provided for in 18 VSA 501b
 Expiration Date December 31, 2019
 This listing is not valid without accompanying Vermont Certificate
Endyne, Inc.
Williston, VT

DRINKING WATER MICROBIOLOGY

Total coliform and *E. coli* (SM 9223 B):

Colilert, P/A Colisure, P/A Colilert, QuantiTray

Uranium: EPA 200.8
 Vanadium: EPA 200.8
 Zinc: fere EPA 200.7 EPA 200.8

DRINKING WATER METALS

Aluminum: EPA 200.7 EPA 200.8
 Antimony: EPA 200.8
 Arsenic: EPA 200.8
 Barium: EPA 200.7 EPA 200.8
 Beryllium: EPA 200.7 EPA 200.8
 Cadmium: EPA 200.7 EPA 200.8
 Calcium: EPA 200.7
 Chromium: EPA 200.7 EPA 200.8
 Copper: EPA 200.7 EPA 200.8
 Iron: EPA 200.7
 Lead: EPA 200.8
 Magnesium: EPA 200.7
 Manganese: EPA 200.7 EPA 200.8
 Mercury: EPA 200.8 EPA 245.1
 Molybdenum: EPA 200.8
 Nickel: EPA 200.7 EPA 200.8
 Selenium: EPA 200.8
 Silver: EPA 200.7 EPA 200.8
 Sodium: EPA 200.7
 Thallium: EPA 200.8

DRINKING WATER INORGANIC CONTAMINANTS

Chloride: EPA 300.0
 Color: SM 2120 B
 Conductivity (Specific Conductance):
 EPA 120.1
 Corrosivity (Langlier Index):
 SM 2330 B
 Fluoride: EPA 300.0
 Hardness (Calc.): EPA 200.7
 Nitrate-N: EPA 300.0
 Nitrite-N: EPA 300.0
 Odor: SM 2150 B
 Orthophosphate: EPA 300.0
 Residue, Total Filterable (TDS):
 SM 2540 C
 Sulfate: EPA 300.0
 Turbidity: EPA 180.1
 UV 254: SM 5910 B

DRINKING WATER ACIDS, BASE/NEUTRALS

Benzo(a)pyrene: EPA 525.2
 Di(2-ethylhexyl)adipate: EPA 525.2
 Di(2-ethylhexyl)phthalate: EPA 525.2

DRINKING WATER METALS

DRINKING WATER HERBICIDES

2,4-D: EPA 515.4
Dalapon: EPA 515.4
Dicamba: EPA 515.4
Dinoseb: EPA 515.4
Pentachlorophenol: EPA 515.4
Picloram: EPA 515.4
2,4-TP (Silvex): EPA 515.4

DRINKING WATER INSECTICIDES (PESTICIDES)

Alachlor: EPA 525.2
Aldrin: EPA 505
Atrazine: EPA 525.2
Butachlor: EPA 525.2
Chlordane: EPA 505
Dieldrin: EPA 505
Endrin: EPA 505
Heptachlor: EPA 505
Heptachlor Epoxide: EPA 505
Lindane: EPA 505
Methoxychlor: EPA 505
Metolachlor: EPA 525.2
Metribuzin: EPA 525.2
Propachlor: EPA 525.2
Simazine: EPA 525.2
Toxaphene: EPA 505

INDIVIDUAL DRINKING WATER ORGANIC CONTAMINANTS

DBCP: EPA 504.1
EDB: EPA 504.1
1,2,3 Trichloropropane: EPA 524.2

DRINKING WATER TRIHALOMETHANES

Bromodichloromethane: EPA 524.2

Bromoform: EPA 524.2
Chlorodibromomethane: EPA 524.2
Chloroform: EPA 524.2
Total Trihalomethanes: EPA 524.2

DRINKING WATER VOLATILE ORGANICS

Benzene: EPA 524.2
Bromobenzene: EPA 524.2
Bromochloromethane: EPA 524.2
Bromodichloromethane: EPA 524.2
Bromoform: EPA 524.2
Bromomethane: EPA 524.2
n-Butylbenzene: EPA 524.2
sec-Butylbenzene: EPA 524.2
tert-Butylbenzene: EPA 524.2
Carbon Tetrachloride: EPA 524.2
Chlorobenzene: EPA 524.2
Chloroethane: EPA 524.2
Chloroform: EPA 524.2
Chloromethane: EPA 524.2
2-Chlorotoluene: EPA 524.2
4-Chlorotoluene: EPA 524.2
Dibromochloromethane: EPA 524.2
Dibromomethane: EPA 524.2
1,2-Dichlorobenzene: EPA 524.2
1,3-Dichlorobenzene: EPA 524.2
1,4-Dichlorobenzene: EPA 524.2
Dichlorodifluoromethane: EPA 524.2
1,1-Dichloroethane: EPA 524.2
1,2-Dichloroethane: EPA 524.2
c-1,2-Dichloroethene: EPA 524.2
t 1,2-Dichloroethylene: EPA 524.2

DRINKING WATER VOLATILE ORGANICS (cont.)

1,1-Dichloroethylene: EPA 524.2

Dichloromethane:
EPA 524.2
1,2-Dichloropropane:
EPA 524.2
1,3-Dichloropropane:
EPA 524.2
2,2-Dichloropropane:
EPA 524.2
1,1-Dichloropropene:
EPA 524.2
c 1,3-Dichloropropene:
EPA 524.2
t 1,3-Dichloropropene:
EPA 524.2
Ethylbenzene:
EPA 524.2
Hexachlorbutadiene:
EPA 524.2
Isopropylbenzene:
EPA 524.2
4-Isopropyltoluene:
EPA 524.2
Methyl t-Butyl Ether (MTBE):
EPA 524.2
Naphthalene:
EPA 524.2
n-Propylbenzene:
EPA 524.2
Styrene:
EPA 524.2
1,1,1,2-Tetrachloroethane:
EPA 524.2
1,1,2,2-Tetrachloroethane:
EPA 524.2
Tetrachloroethylene:
EPA 524.2
Toluene:

1,2,3-Trichlorobenzene:
EPA 524.2
1,2,4-Trichlorobenzene:
EPA 524.2
1,1,1-Trichloroethane:
EPA 524.2
1,1,2-Trichloroethane:
EPA 524.2
Trichloroethylene:
EPA 524.2
Trichlorofluoromethane:
EPA 524.2
1,2,3 Trichloropropane:
EPA 524.2
1,2,4-Trimethylbenzene:
EPA 524.2
1,3,5-Trimethylbenzene:
EPA 524.2
Total Xylenes:
EPA 524.2
Vinyl Chloride:
EPA 524.2

**DRINKING WATER ORGANIC DISINFECTION BY-
PRODUCTS HALOACETIC ACIDS**

Bromoacetic Acid:
EPA 552.2
Chloroacetic Acid:
EPA 552.2
Dibromoacetic Acid:
EPA 552.2
Dichloroacetic Acid:
EPA 552.2
Trichloroacetic Acid:
EPA 552.2
Total Haloacetic Acids:
EPA 552.2

DRINKING WATER VOLATILE ORGANICS (cont.)
EPA 524.2

By:



William G. Mills
Certification Officer
Date signed and effective December 29, 2018

As of December 29, 2018, this listing supersedes all previous lists for this certificate number.
Vermont Certification is based in part upon current New York Accreditation Certificate of Approval NY lab ID **11263-58567**, April 1, 2018 – April 1, 2019 {Revised August 27, 2018}. Laboratories are certified in Vermont based, in part, upon its Primary Accrediting Body(ies) drinking water accreditation(s). Also, loss of drinking water primary accreditation (in part or whole) constitutes loss of certification in Vermont for the same drinking water tests.



DEPARTMENT OF HEALTH

*State of Vermont Department of Health
Drinking Water Laboratory Certification*

Endyne, Inc.
Williston, Vermont

Is certified to perform microbiological, inorganic and organic analyses on drinking water pursuant to the certification letter dated December 29, 2018.



Commissioner of Health

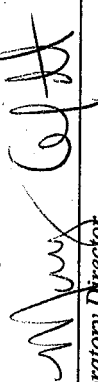

Laboratory Director



Laboratory Certification Officer

January 1, 2019
Date certified

VT - 2021
Laboratory Number

December 31, 2019
Certificate expiration date