

MARK	DESCRIPTION	IN CONTRACT	COUNT
A2.1	32 IN. COLD FOOD UNIT (WITH SNEEZE GUARD)	Yes	4
A2.2	74" FROST TOP UNIT (WITH SNEEZE GUARD)	Yes	4
A2.7	DROP-IN FROST TOP	Yes	4
A3.2	32 IN. WARMING TOP UNIT (WITH SNEEZE GUARD)	Yes	4
A3.3	5 WELL HOT FOOD UNIT (WITH SNEEZE GUARD)	Yes	4
A4.1	18 IN. FLAT COUNTER UNIT (4 WITH SNEEZE GUARD)	Yes	4
A4.2	CASHER STAND	Yes	2
A5.1	8 CRATE MILK COOLER	Yes	4
B2.1	PASS-THRU REFRIGERATOR	Yes	2
B4.1	PASS-THRU HEATED CABINET	Yes	4
B6.1	BLAST CHILLER	Yes	1
B7.1	PROOFING CABINET	Yes	1
B8.1	ICE MACHINE	Yes	1
B8.2	ICE AND WATER DISPENSER NIC	No	1
B9.1	WALK-IN COOLER/FREEZER	Yes	1
C1.0	POT, PAN, UTENSIL WASHER	Yes	1
D1.1	VEGETABLE PREP SINK	Yes	1
D2.1	POT WASHING SINK	Yes	1
D3.1	MEAT PREP SINK	Yes	1
E1.1	72 IN. COOK'S TABLE	Yes	1
E3.1	WORK TABLE (30' X 72")	Yes	7
E3.2	WORK TABLE (30' X 48")	Yes	1
E6.1	RECEIVING TABLE (30' X 72")	Yes	4
F7.1	VERTICAL CUTTERMIXER	Yes	1
G3.2	TILTING SKILLET - 30 GALLON (ELECT)	Yes	1
G3.3	TILTING SKILLET - 40 GALLON (ELECT)	Yes	1
G4.1	DOUBLE CONVECTION OVEN (ELECT)	Yes	1
G7.1	COMBI OVEN STEAMER (ELECT)	Yes	3
G8.1	MICROWAVE OVEN	Yes	1
H1.1	COOLER/FREEZER SHELVING 24"	Yes	10
H1.2	COOLER/FREEZER SHELVING 18"	Yes	28
H2.1	24IN FOOD STORAGE SHELVING	Yes	5
H2.2	18IN FOOD STORAGE SHELVING	Yes	13
H2.3	CHEMICAL STORAGE SHELVING	Yes	1
H4.1	MOBILE DUNNAGE RACK	Yes	8
H7.1A	WIRE WALL SHELF (4'-0")	Yes	1
H7.1B	WIRE WALL SHELF (11'-6")	Yes	1
J1.1	UTILITY CART	Yes	1
J1.2	UTILITY CART	Yes	12
J1.3	UNIVERSAL PAN RACKS	Yes	8
J1.4	MOBILE TRAY DRYING RACK	Yes	1
J1.5	MOBILE TRAY DRYING RACK	Yes	1
J1.6	MOBILE TRAY DRYING RACK	Yes	1
M2.1	HOSE REEL	Yes	6
M3.1A	DRAIN TROUGH	Yes	1
M3.1B	DRAIN TROUGH	Yes	1
M4.1	S.S. TRAY SLIDE	Yes	1
M6.1A	STAINLESS STEEL RAILING SYSTEM	Yes	4
M6.1B	STAINLESS STEEL RAILING SYSTEM	Yes	1
M7.0	30 IN CONDIMENT CART	Yes	4

1 1/4" ENLARGED PLAN - KITCHEN  
SCALE: 1/4" = 1'-0"

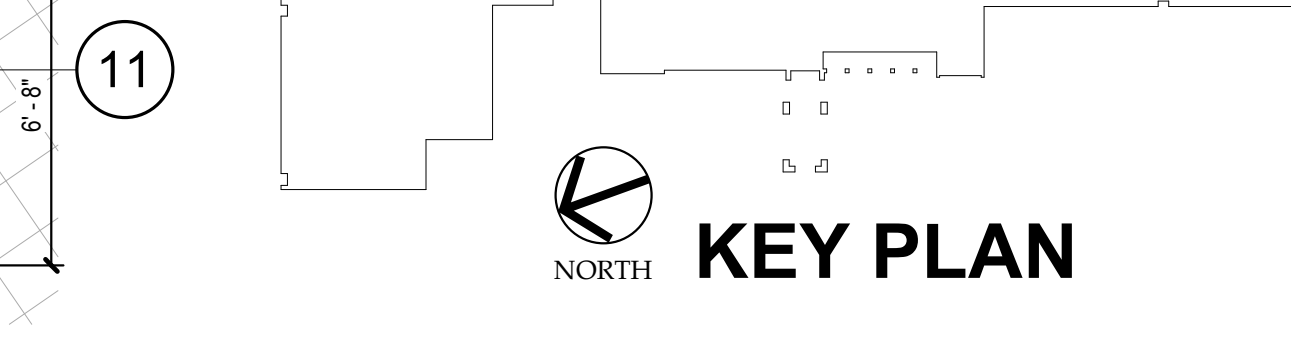

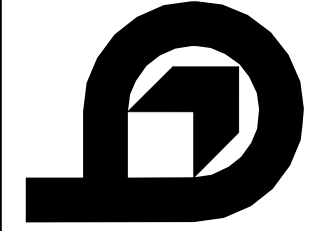

**BLUEJAY ELEMENTARY SCHOOL**  
EFFINGHAM COUNTY BOARD OF EDUCATION  
SCHOOL CODE: 651-0393

**JAMES W. BUCKLEY & ASSOCIATES INC. - ARCHITECTS**  
SWANBORO, ALABAMA (HOME AND MAIN OFFICE)

---

RINCON

---

ENLARGED FLOOR PLAN - KITCHEN

---

**ISSUED FOR:**

FINAL/BID

ADDENDUM 1: 07-19-2024

FS 001: 09-13-2024

FS 003: 09-23-2024

---

PMP  
DRAWN BY  
HGB  
CHECKED BY  
CRB  
APPROVED BY  
06/27/2024  
PROJECT DATE  
23-035  
PROJECT NUMBER

---

**SHEET NUMBER: A8.6**

Copyright (c) 2019  
All Rights Reserved