

REFER TO A2.0 FOR CONT.

REFER TO A2.0 FOR CONT.

REFER TO A2.4 FOR CONT.

1 1/8" FLOOR PLAN - KITCHEN/DINING
SCALE: 1/8" = 1'-0"

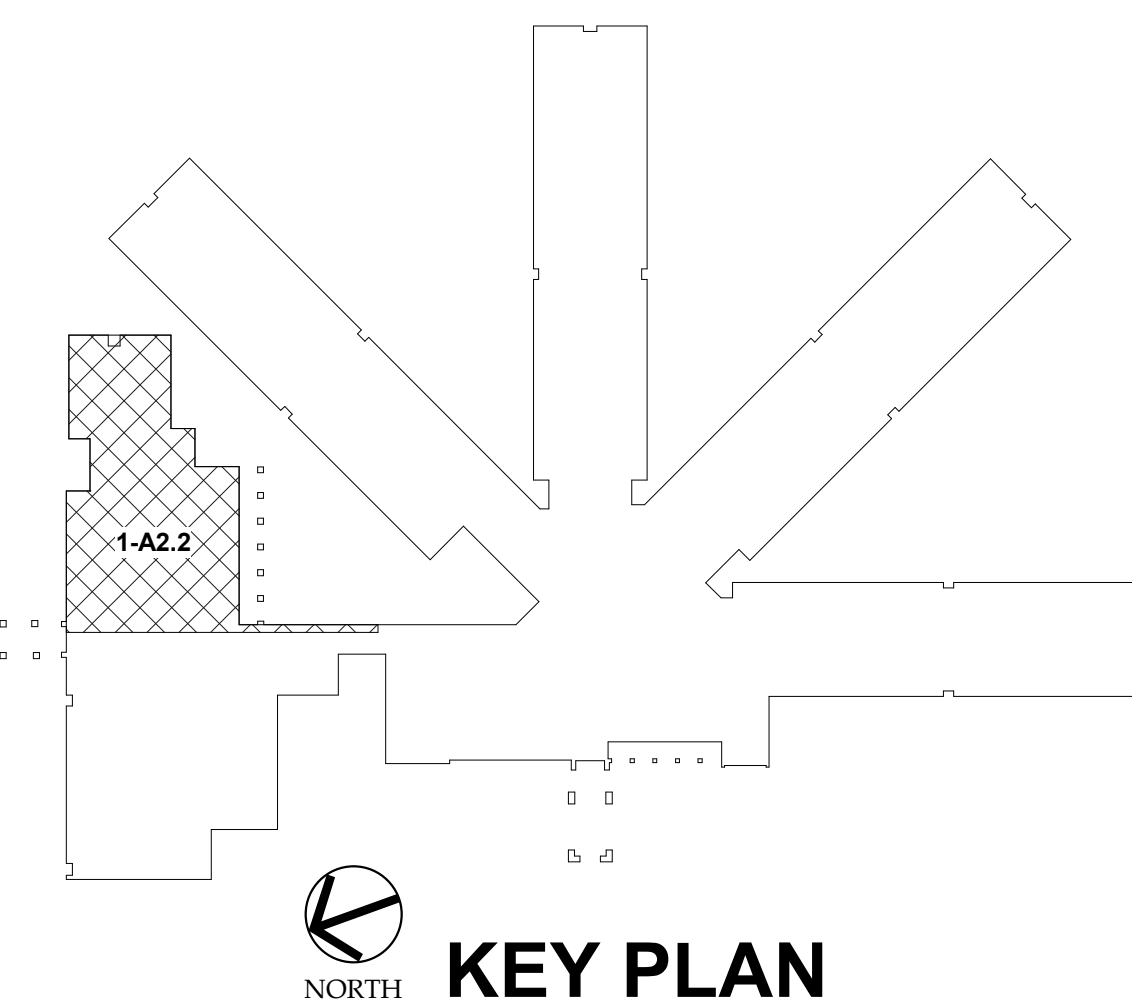

KEY PLAN

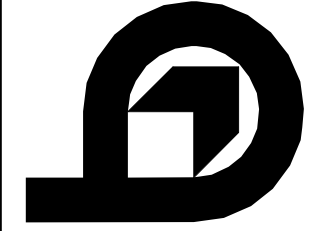

BLUEJAY ELEMENTARY SCHOOL
EFFINGHAM COUNTY BOARD OF EDUCATION
SCHOOL CODE: 6511-0393

RINCON

JAMES W. BUCKLEY & ASSOCIATES INC. - ARCHITECTS
SWANBORO ALABAMA 36571

WARNING: Contractors, subcontractors, vendors and suppliers are advised that the contract documents consist of the numbered blue or black-line prints, addendum, posted addendum, and change orders only. Documents reproduced by parties other than the Architect, whether in hard copy or in electronic form, shall not be considered part of the contract documents. The Architect, its agents, representatives, and suppliers are not responsible for verification of information utilized in building development of shop drawings, and construction of the facility are essential to the contract documents.



NOT VALID UNLESS SIGNED

ISSUED FOR:

- FINAL/BID
- ADDENDUM 1: 07-19-2024
- ADDENDUM 3: 08-09-2024
- FS 001: 09-13-2024
- FS 003: 09-23-2024

TDP
DRAWN BY: HGB
CHECKED BY: CRB
APPROVED BY: 06/27/2024
PROJECT DATE: 23-035
PROJECT NUMBER:

SHEET NUMBER: A2.2

Copyright (c) 2019 All Rights Reserved