



CHERRY HILL SCHOOL DISTRICT

THOMAS PAINE ELEMENTARY SCHOOL

51,866 SF 1968, 1995, 2000

Site

**Additional Site Improvements - ADA Compliance, Site Drainage, Paving, Signage, etc.,
Playground Enhancements/Replacement and New Side Entrance Ramp/Stair(s) (District
Consultant)**

Qty	Unit Cost	Cost Estimate
	Lump Sum	\$700,000
	25% Soft Costs (A/E Fees, Contingency, CM, Legal, etc.)	\$175,000
	Estimated Total	\$875,000

Exterior Renovations

Exterior Door, Hardware, Frame Replacement

11 @ \$10,000 \$110,000

Masonry Repairs - Window Lintels, Windows, Coating EIFS Repairs, Caulking, etc.

Lump Sum \$475,000

Subtotal \$585,000

25% Soft Costs (A/E Fees, Contingency, CM, Legal, etc.) \$146,250

Estimated Total \$731,250

Interior Renovations

Classroom Flooring - New VCT Flooring & Base and Painting

16,000 SF @ \$12 \$192,000

Corridor Ceiling Replacement and Painting Walls

7,750 SF @ \$20 \$155,000

New Interior Fire-Rated Doors, Frames, Closers, ADA Modifications, Intruder Hardware

99 @ \$4,000 \$396,000

Renovate Hall Toilet Rooms - Finishes, Fixtures, ADA Compliance

4 @ \$125,000 \$500,000

Renovate Unisex Staff & Classroom Toilet Rooms - Finishes, Fixtures, ADA Compliance

6 @ \$50,000 \$300,000

Teacher's Room - Replace Finishes, Sink, Cabinets, Stove and Refrigerator

Lump Sum \$50,000

Library - Replace Finishes, Lights, etc.

Lump Sum \$175,000

New ADA Compliant Interior Signage

51,866 SF @ \$1 \$51,866

Classroom Conversion to (6) SGI's - Finishes, Building Systems, etc.

1,600 SF @ \$200 \$320,000

All Purpose Room - Replace Finishes, New Ceilings, Expand Warmup Kitchen

Lump Sum \$250,000

Hazardous Materials Abatement - VAT, Pipe Insulation, etc. (District Consultant)

Lump Sum \$200,000

Subtotal \$2,589,866

25% Soft Costs (A/E Fees, Contingency, CM, Legal, etc.) \$647,467

Estimated Total \$3,237,333



CHERRY HILL SCHOOL DISTRICT

THOMAS PAINE ELEMENTARY SCHOOL

51,866 SF 1968, 1995, 2000

Building Systems

HVAC Construction

New Unit Ventilators - Remove Existing Perimeter Units, New Unit Ventilators with New Air Conditioning (APR), New Perimeter Hot Water Radiation, Book Shelving, etc.

Lump Sum \$1,149,000

Exhaust Fans - Replace Rooftop Units

15 @ \$2,500 \$37,500

HVAC Replacement (4) Split Systems

Lump Sum \$56,000

Replacement of the Pneumatic Energy Management System with New DDC Electronic Controls

51,866 SF @ \$6.00 \$311,196

Subtotal \$1,553,696

25% Soft Costs (A/E Fees, Contingency, CM, Legal, etc.) \$388,424

Estimated Total \$1,942,120

Electrical Construction

Replace PA System, Clock System and Technology

Lump Sum \$111,623

Power/Lighting Branch/HVAC Panel Upgrades

4 @ \$25,000 \$100,000

Subtotal \$211,623

25% Soft Costs (A/E Fees, Contingency, CM, Legal, etc.) \$52,906

Estimated Total \$264,529



CHERRY HILL SCHOOL DISTRICT

THOMAS PAINE ELEMENTARY SCHOOL

51,866 SF 1968, 1995, 2000

	Total Estimated Cost	ACTUAL State Share	Local Share
Site Work	\$875,000	(\$350,000)	\$525,000
Exterior Renovations	\$731,250	(\$292,500)	\$438,750
Interior Renovations	\$3,237,333	(\$1,294,933)	\$1,942,400
HVAC Construction	\$1,942,120	(\$776,848)	\$1,165,272
Electrical Construction	\$264,529	(\$105,812)	\$158,717
Total Renovations	\$7,050,232	(\$2,820,093)	\$4,230,139
		40%	60%

Renovations = Architect's estimate of eligible projects @ 40% State Aid
New Construction – Eligible Square Footage x \$143/SF @ 40% State Aid



CHERRY HILL SCHOOL DISTRICT

THOMAS PAINE ELEMENTARY SCHOOL

51,866 SF 1968, 1995, 2000

Additional Site Improvements -
ADA Compliance, Site
Drainage, Paving, Signage,
etc., Playground
Enhancements/Replacement
New Side Entrance
Ramp/Stair(s) (District
Consultant)





CHERRY HILL SCHOOL DISTRICT

THOMAS PAINE ELEMENTARY SCHOOL

51,866 SF 1968, 1995, 2000

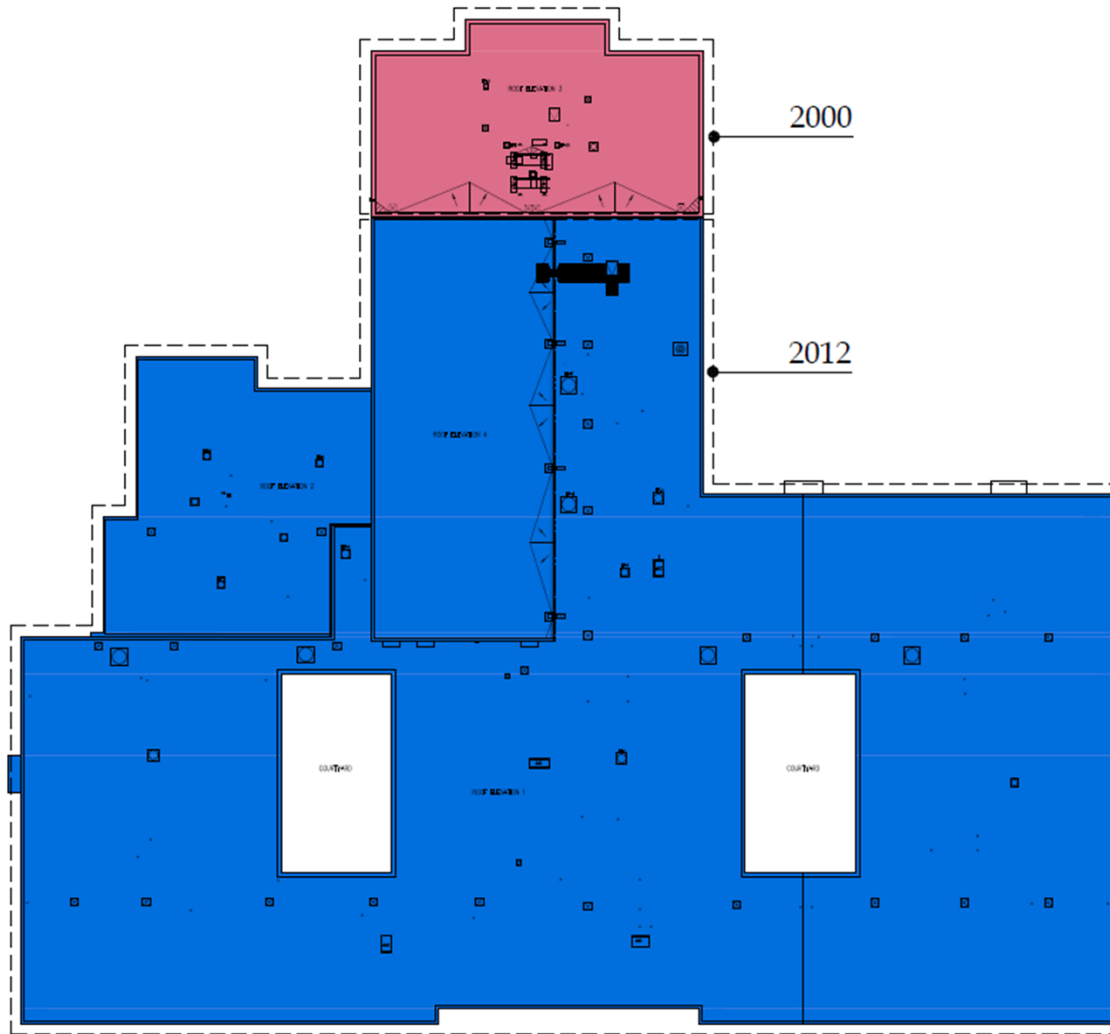

1 ROOF PLAN
RP-1.0 SCALE: 1/32"=1'-0"



CHERRY HILL SCHOOL DISTRICT

THOMAS PAINE ELEMENTARY SCHOOL

51,866 SF 1968, 1995, 2000

LEGEND

FLOORING

CLASSROOMS FLOORING - NEW VCT & BASE

CEILING/PAINT

NEW CORRIDOR & CLASSROOM CEILING TILE & PAINTING WALLS THRU-OUT



NEW INTERIOR DOORS, FRAMES & ADA HARDWARE THRU-OUT



NEW EXTERIOR DOORS, FRAMES & ADA HARDWARE

UV

UNIT VENTILATOR REPLACEMENT



BUILDING RENOVATION AREA



BATHROOM RENOVATION



REBUILD H/C RAMP / STEPS



Floor plan