



# BOND ADVISORY COMMITTEE

Meeting 2: September 26, 2024





# Agenda

- Welcome back (5mins)
  - Meeting Norms, Charter, Parking Lot Reminder
  - BAC Meeting Roadmap
- Meeting 1 Overview (10mins)
  - Meeting 1 Minutes
  - Teams Account
- Region 1 Community (40mins)
- Break (5mins)
- Region 1 Project Overviews (40mins)
  - Table Discussions (10mins)
- Group Share Out (10mins)
- Closing



# Meeting Norms



Preserve this as a safe space for open, honest discussion.

Assume Good Intentions.  
Give grace and space





If you present a problem, then you should also present a solution.



Engage fully with honesty and integrity



Respect the rights, differences, and dignity of others



Keep an infectious sense of possibility of what we can accomplish

Come with an open mind.







# CHARTER

The Bond Advisory Committee (BAC) is commissioned to submit a recommendation to the superintendent and school board regarding a bond scope and attendant financing plan. This recommendation includes the timing of an election that would preserve the option of running a February 11th, 2025, Bond Issue Election. The committee will submit the final report and recommendation on November 18th, 2024.

This committee may also provide support to the superintendent to present a progress report to the board of directors as desired by the superintendent. The committee may participate in facilitation of public bond planning forums and support the superintendent in a board work session if called upon.



# BAC Meeting Roadmap

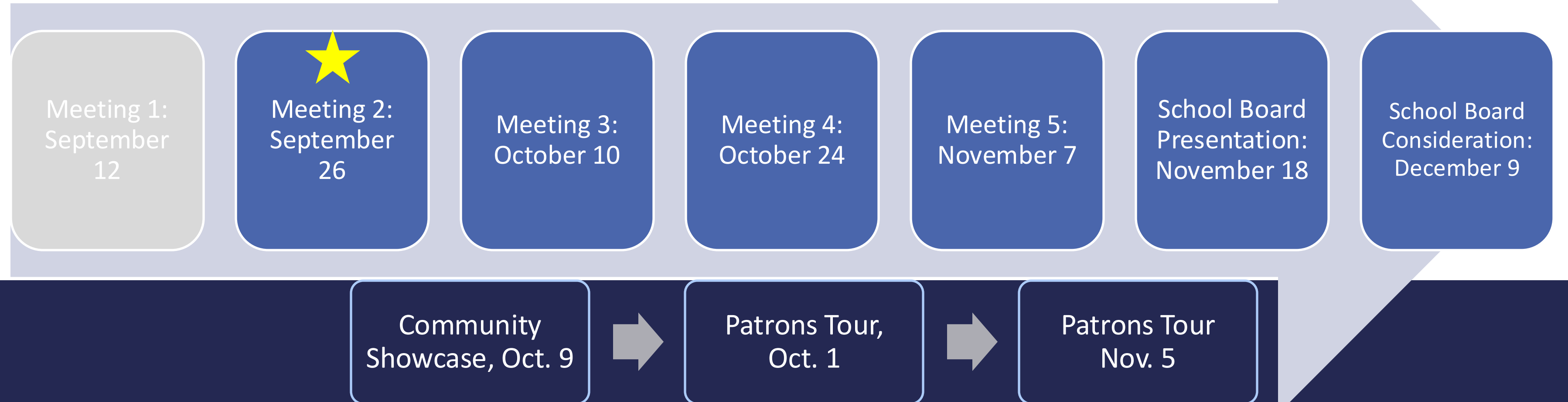

[PuyallupSD.org/BAC](https://puyallupsd.org/BAC)



# Have Questions? Scan the QR Code on Your Meeting Norms Card!

Use the QR code on the back of your meeting norms card, found at each table, to submit your questions during the presentation.







**FOUNDATIONS**  
FOR OUR **FUTURE**

# Recap: Meeting #1

## Bond Overview



# Review & Approve Meeting 1 Minutes

- Meeting Minutes are emailed with upcoming meeting agenda
- Minutes are available on the MS TEAMS page



# TEAMS Page Access

---

1. Download the Teams App
2. Click on emailed link from Microsoft Teams
3. Enter Microsoft username and password
4. The **Bond Advisory Committee Channel** will appear
5. Click on "File" top of screen and all meeting folders will appear

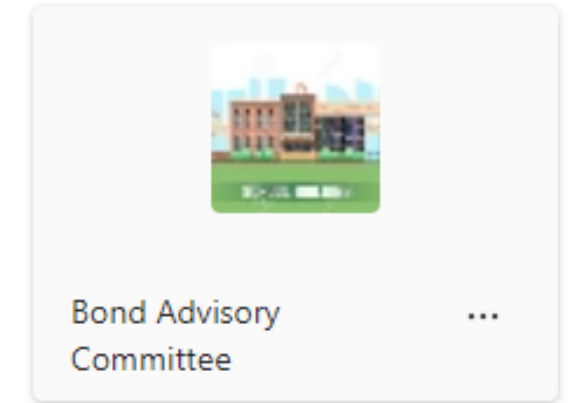



**FOUNDATIONS**  
FOR OUR **FUTURE**

# Committee Exit Survey Feedback



# Meeting 1 BAC Feedback

1. What is your key takeaway from today's discussion?

1	anonymous	The projects laid out and the state match funding
2	anonymous	The multiple moving parts to determine a bond list of projects and funding
3	anonymous	A good overview of the process and the tasks at hand.
4	anonymous	Good information and well organized
5	anonymous	How important it is to do a bond this upcoming election.
6	anonymous	Funding sources, defining the potential projects, address the needs
7	anonymous	Clear explanation about the bond process.
8	anonymous	It's a very involved process.
9	anonymous	Feeling glad to be part of this group and the ability to be part of the solution moving forward. But disappointed and frustrated in the community for being unable to pass multiple bonds in a row. Feels like we have a significant backlog of projects to address.
10	anonymous	History of bonds in Puyallup school district
11	anonymous	The background work has been extensive and the format and information is very well organized and professional. That makes me feel hopeful that we will be good stewards of the funds.
12	anonymous	We're going to have some tough decisions to make to prioritize the 1.26B in needs into a reasonable bond package.
13	anonymous	That it was well organized and provided all the back information to make an informed decision.
14	anonymous	Learning the functioning and background of the PSD and neighboring districts bond utilization.
15	anonymous	District buildings need a lot of work. Not very many people vote.
16	anonymous	I feel like we need a feel-good campaign about the schools and district. There is a lot to feel good about, and when people feel positive, they are more willing to help. There is a lot of negativity rampant on Facebook neighborhood groups about the schools, and it feels like it becomes a self-fulfilling prophecy.
17	anonymous	Introduction, and overview of what's to come in the future Meeting discussions.

2. How do you feel about the potential bond scenarios that were presented, and what aspects stood out to you the most?

1	anonymous	I feel that I would vote for the bond. I feel the bond addresses all regions of the district.
2	anonymous	Seems logical to maintain a level tax rate at the 800M level
3	anonymous	To be determined
4	anonymous	Concerned that with the \$800 million proposal that over 1/3 of needed projects will be left on the table
5	anonymous	Feel confident, didn't know the high needs that PHS needed.
6	anonymous	There are a lot of needs and not enough bond funding to meet the needs
7	anonymous	I feel good about the options and keeping the costs 'as is'. I am worried about getting the information out to the voters and then getting the votes submitted, as approval.
8	anonymous	I feel that this bond is of the utmost importance.
9	anonymous	They seem reasonable considering the long list of projects.
10	anonymous	I think people will like to see that \$4.14 to stay the same over the next 21 years
11	anonymous	Right now I think we need at least the \$800 million scenario, but will the voters choke on that number and vote no?
12	anonymous	800 m sounds good.
13	anonymous	\$800 million option would be most efficient and have the greatest impact. Less of an administrative burden.
14	anonymous	The amount, I feel open forums to see the school would let other understand the severity and may help get public input/support when you explain why.
15	anonymous	The scenarios seem logical. It makes sense to keep the tax rate at \$4.14. We should try to take advantage of the freeze on state matching funds at the 2019 enrollment.
16	anonymous	It feels a little overwhelming to see even the short list of need and know there's more out there. But it's definitely not a time to shirk responsibility. Go big.
17	anonymous	Not much talk about the actual bond scenarios, only that it'll be further discussed in future meetings.

# Meeting 1 BAC Feedback

3. What additional information or clarification would you need to feel more confident about making a recommendation regarding a future bond?

1	anonymous	None
2	anonymous	I don't have concerns at this point. I'll ask for info as needed.
3	anonymous	Nothing at this moment
4	anonymous	N/A
5	anonymous	I'm okay at this point.
6	anonymous	I'd like to talk about communication to those citizens who don't read the Connection.
7	anonymous	Has the district already determined the \$4.14 rate as the ceiling for what voters would accept? What are the contingency plans if the bond should fail? Run same bond again, run a smaller bond the same year?
8	anonymous	What is the plan for getting the community to vote yes and pass the bond
9	anonymous	Am currently impressed.
10	anonymous	What specific things at each site will be done or postponed
11	anonymous	I think it would be good to highlight to make decisions based on community as a whole and not necessarily personal opinions. Focus on all rather than self interest.
12	anonymous	We need to talk about the projects that will be part of the bond package.
13	anonymous	I feel like it is going to be a battle with the school board because there are several members who are openly anti-public-school to begin with. So any assurances or guidance to combat that would be helpful.
14	anonymous	I'd like to further understand budgeting, expenses, and further understand how our district uses funds in a responsible and efficient manner before making any recommendations regarding asking the community for additional moneys.

4. Any additional feedback or questions?

1	anonymous	Not now
2	anonymous	N/A
3	anonymous	Thanks - lots of information shared. Good snacks, by the way.
4	anonymous	I realize our time is short but like know who is who on our name tags.
5	anonymous	Could the question QR code be added to the back of our name tags or passed out to each person? Would be easier to scan and fill out mid-meeting without needing to reach across the table to the shared center materials. Thank you for organizing, for providing some snacks, and including me in the committee.
6	anonymous	Is Ferucci long remodel time going to reflect poorly on this process to the public? What is the plan for the builds going to look like? Will there be design review committees and interior design committees to guide the new builds? How can we make this tangible for the voting public?
7	anonymous	None
8	anonymous	Not right now.
9	anonymous	Not at this time, but I'm sure many will present itself as time goes on.





**FOUNDATIONS**  
FOR OUR **FUTURE**

# Question of the Week: Community Feedback

STRONGER  
TOGETHER

## Objectives:

- **Gather meaningful community feedback** to guide the Bond Advisory Committee in its recommendations to the Puyallup School Board.
- **Encourage community participation** in the decision-making process by actively seeking opinions on bond-related scenarios and priorities.
- **Foster transparency** by sharing the committee's progress and using community feedback to inform next steps.
- **Prioritize community values** and ensure that the bond package aligns with both current needs and future growth of the district.

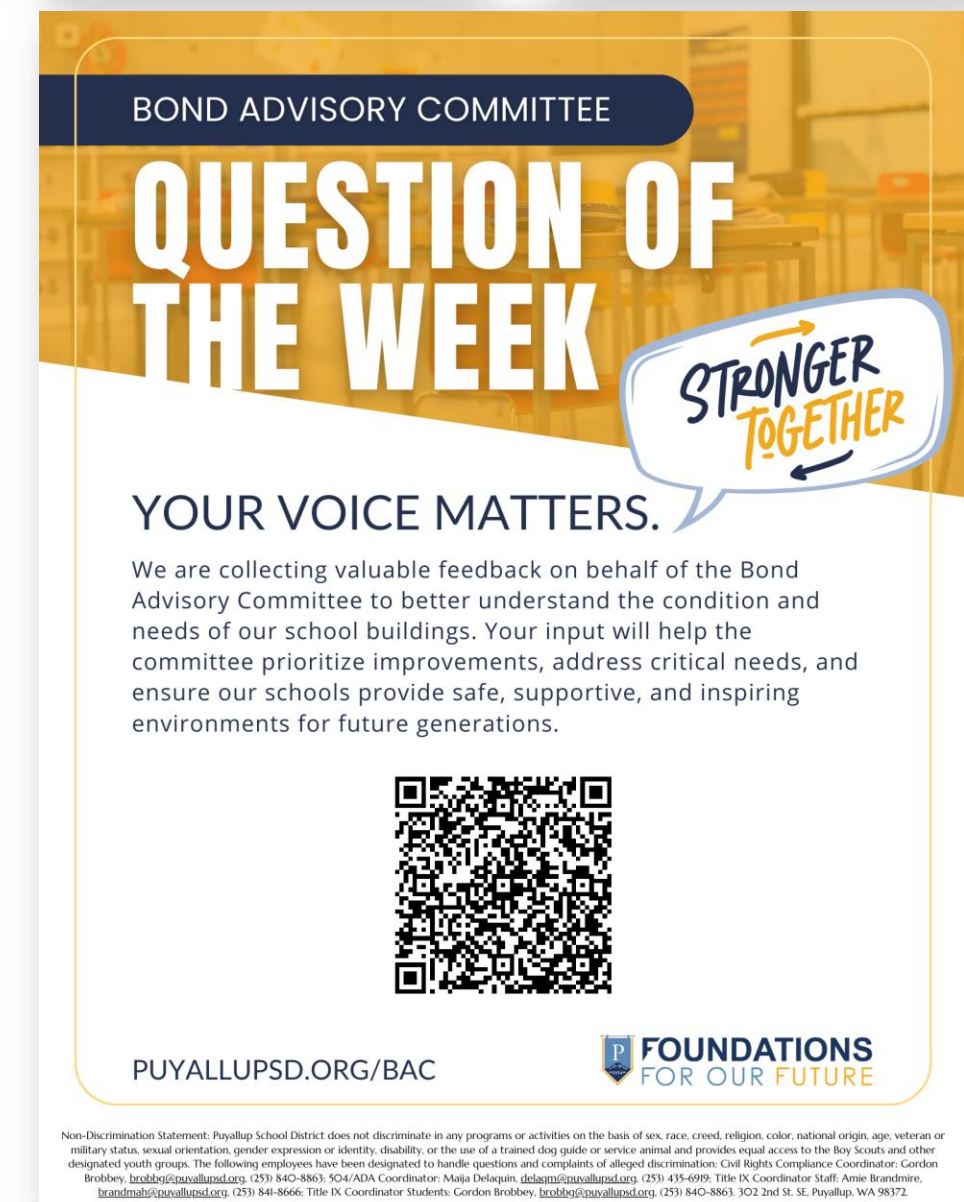
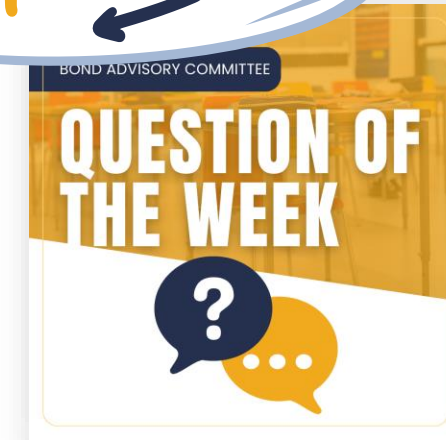



## Last Week's Questions

- Do you have any additional comments or suggestions for the Bond Advisory Committee as they move forward?
- What school construction projects or improvements do you think should be prioritized, and why?
- How do you feel about the approach to maintaining a consistent tax rate? Do you have any concerns about the potential financial impact of the bond on the community? If so, please elaborate.

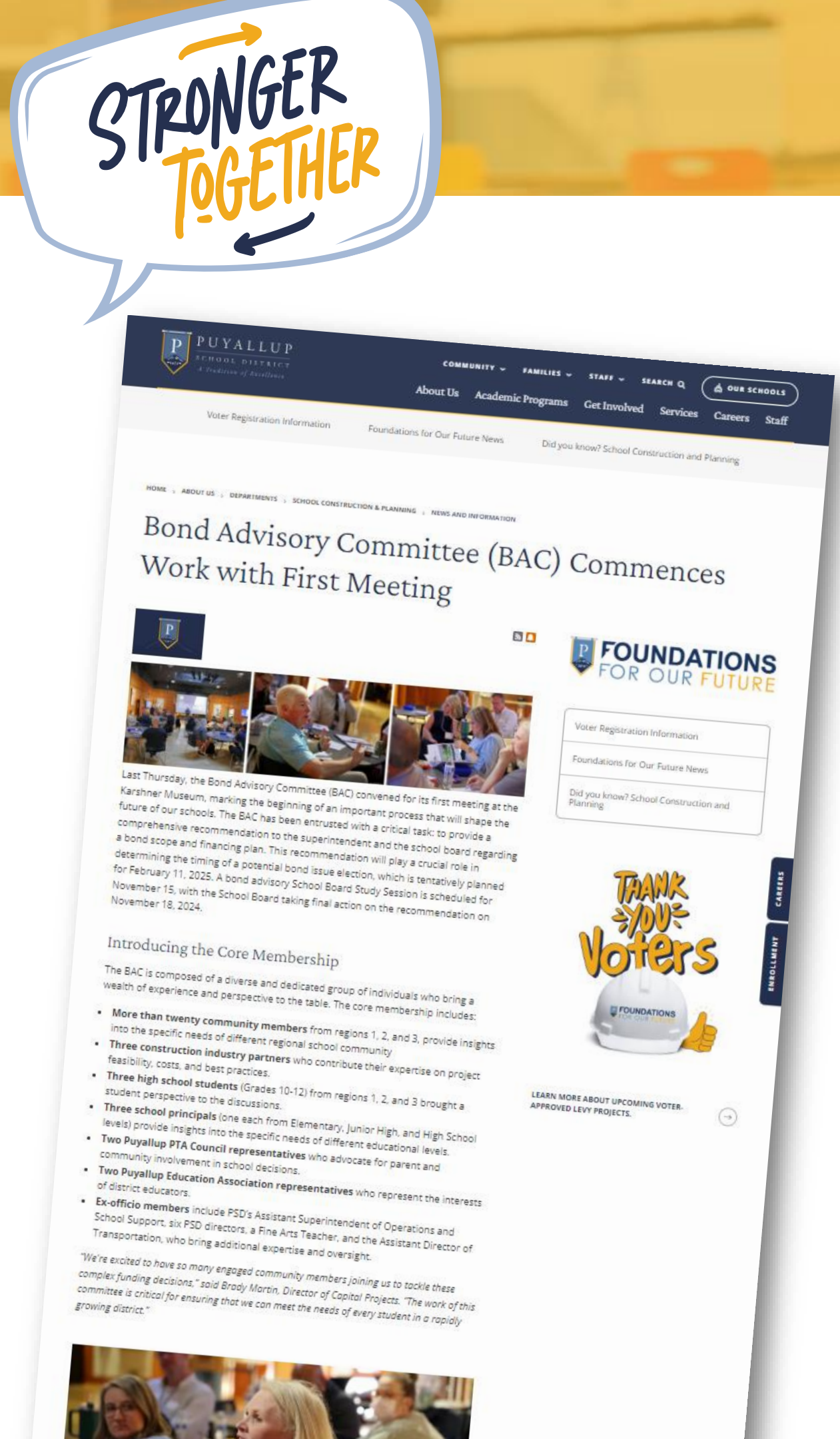

# QUESTION OF THE WEEK



Id	Email	Do you have any additional comments or suggestions for the Bond Advisory Committee as they move forward?	What school construction projects or improvements do you think should be prioritized, and why?	How do you feel about the approach to maintaining a consistent tax rate? Do you have any concerns about the potential financial impact of the bond on the community? If so, please elaborate.
1	anonymous	test	test	test
2	anonymous	Heating and cooling system at PHS Water quality as well. We are one of the oldest buildings in the PSD	New Gym building, classrooms and Library for PHS	None
3	anonymous	I would really like to see the bond committee discuss and consider the potential to reconfigure and consider putting 6th grade in the junior highs. If a new high school is built and grades are reallocated properly I would anticipate an increase in student achievement. This is a long time coming and I think it is worth considering.	I definitely think that all of our older buildings need to be prioritized like Spinning. We should also consider building a new high school rather than building a new elementary if we build a new high school we could reallocate students to the K-5, 6-8 and 9-12 model.	
4	anonymous	an addition to Northwood and Mt. View is necessary to support the growth in the Edgewood/Fife area.	I believe with the growth that Northwood Elementary is experiencing, that additional portable or an addition be added on to the building.	no concerns if the rate stays the same.
5	anonymous	Move toward middle school model		
6	anonymous		Please prioritize the construction of a NEW Waller Road Elementary School! The school is over 100 years old and the patchwork HVAC, electrical, plumbing, etc. make it one of the most inefficient places in the entire district. Also, the parking is not just outdated and small, but it is downright DANGEROUS! This school is in desperate need of new construction, not just more cosmetic improvements, that time has passed. The students and staff of Waller Road deserve better and have waited a VERY long time for a new building.	
7	anonymous		Waller Road has not been remodeled in 63 years! Our kids and staff deserve equity in their learning/teaching environment. Waller Road should be made a priority on the bond.	
8	anonymous		Waller Road Elementary is in desperate need of a new building. The technology is outdated, and the parking situation is dangerous.	I think maintaining a consistent tax rate is helpful to obtaining community support.
9	anonymous	Our children deserve equitable buildings to learn in! We have some older buildings in the district, primarily in the valley that are limping along with patched together spaces, poor ventilation, insufficient office spaces for itinerant staff to co-treat or co-meet because they have to be at the school on different days due to space issues-ultimately impacted our students. We have buildings that smell of mold/mildew/old water smells that cannot possibly be healthy to breath. Old plumbing is a problem with water that tastes gross--imagine that---valley water that tastes gross?!? I was just in a classroom and the teacher spent several minutes teaching the children how to let the water run before drinking or filling their water bottles to help make it taste better and avoid lead. Would the public be pleased about this state of affairs? I don't think so.	Clean, healthy air that is free of mold/mildew/old water smells--breathing is a basic human need. Next would be safe, healthy water to drink in these buildings.	I'm concerned that a large percentage of our tax base comes from parts of our district with more money causing a situation where tax payers may not be aware (or care?) about poorer parts of our district that desperately need significant improvements.





Id	Email	Do you have any additional comments or suggestions for the Bond Advisory Committee as they move forward?	What school construction projects or improvements do you think should be prioritized, and why?	How do you feel about the approach to maintaining a consistent tax rate? Do you have any concerns about the potential financial impact of the bond on the community? If so, please elaborate.
10	anonymous		New school for Waller Road Elementary. Students deserve to learn in an updated, modern building. A new facility would enhance student learning and sense of pride in their school. Waller Road is the only school on Puyallup Tribal land and our native community deserves access to an updated elementary building.	I support raising taxes to complete these important initiatives.
11	anonymous		Prioritize Waller Road Elementary for a new building. It's more than 100 years old, with HVAC and other issues that are health hazards. The parking is dangerous for staff and parents. Restrooms facilities for staff are inadequate. Program space for band, orchestra, ML, and Title/LAP are inadequate. There is no breakout space for small groups, meetings, student groups, etc.	
12	anonymous	Please visit the buildings together to SEE what actually needs to be done to improve the safety of our staff and students and support an environment that is conducive to the needs of the learners. What is truly needed versus what will look pretty or benefit only athletes? There are huge inequities from one elementary school to another...	Rebuild Waller Road Elementary School. It is in dire need of a completely new building. The heating and air conditioning system and air circulation/ventilation system are ancient. This is resulting in mold, moisture, condensation, etc. It is a safety concern that is causing staff and students to get sick. It is difficult to regulate the temperature, and some rooms are freezing while others are too hot. Again, this makes learning and teaching difficult. There is also asbestos in the walls. This presents a danger anytime work needs to be done and these areas are disturbed. Attendance is already a concern at this building. There is also not adequate parking. There are not enough workspaces for all of the therapists and itinerant staff. Instruction has been interrupted frequently because of alarms getting triggered because the systems are old and glitchy. Even with the carpets freshly shampooed, your feet will be black if you walk barefoot on it. The toilets leak in the staff bathroom. There is not adequate store for all of the needed materials and curriculum resulting in rooms looking unorganized and crowded. There are used whiteboards layered over chalkboards and cork boards. The portable classrooms are too small for the intermediate students and much time is wasted with them traveling into the building for lunch, specialists, bathroom breaks, etc.	Our community wants to support education. A reasonable increase is expected with the current housing market.
13	anonymous	Waller Road School needs a new building	Waller Road School	
14	anonymous		heating/AC, because the schools are to cold in the winter and too hot in the summer. kitchens, some are outdated and small.	
15	anonymous		Waller Road Elementary. We have asbestos in our flooring that has simply been covered up with carpeting. We have a gym that has not been retrofitted for earthquakes. We have an antiquated HVAC system.	

**(DRAFT) Upcoming Questions**

- In your opinion, what schools or areas of our schools require immediate attention to enhance student and staff experience?
- How do you see Puyallup School District buildings evolving to meet the future needs of our students, educators, and community?
- How important is considering a tax rate that maintains a consistent tax rate in order to address the critical needs of our school buildings, including the modernizing or replacing nine facilities? Do you feel that maintaining a steady tax rate is a reasonable approach to fund long-term improvements in our district?
- What specific building needs are required to effectively support key programs, such as Career and Technical Education, Dual Language, or Preschool? Should these programs have their own dedicated buildings, or would it be more beneficial to reconfigure an existing building to better accommodate their unique needs and foster a cohesive school culture?
- What types of spaces (e.g., specialized classrooms, labs, or early learning centers) would enhance these programs and better serve students?
- What are your thoughts on the potential impact of a higher tax rate on the number of school building projects and improvements we could support? If so, what types of projects or improvements would you prioritize with the additional funding?

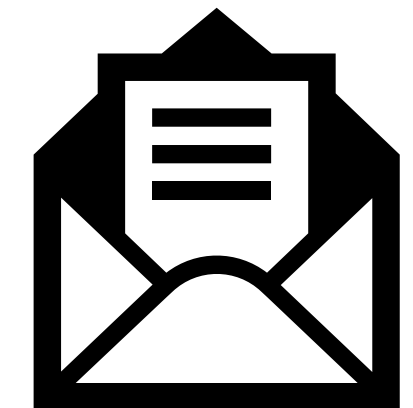
**Question suggestions?**

Email your ideas to Rae.  
**[mcnalra@puyallupsd.org](mailto:mcnalra@puyallupsd.org)**



**FOUNDATIONS**  
FOR OUR **FUTURE**

# Learning Targets

1. Understand Anticipated Enrollment
2. Understand Anticipated Community Growth
3. Understand CFAC Identified Projects & Costs





**FOUNDATIONS**  
FOR OUR **FUTURE**

# Region 1 Community

# School Boundary Maps

PSD Web Maps  
[www.psd3.maps.arcgis.com](http://www.psd3.maps.arcgis.com)

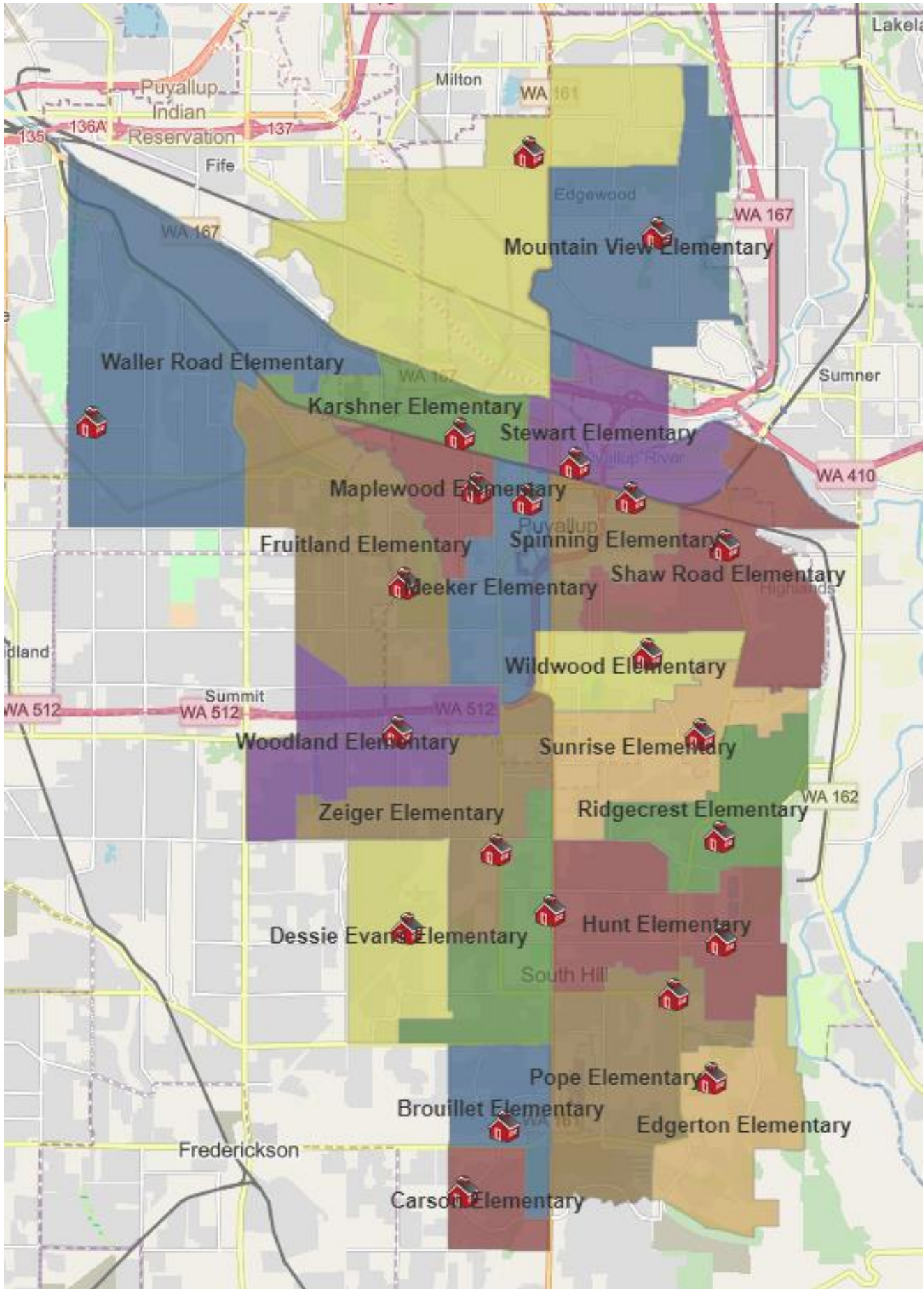
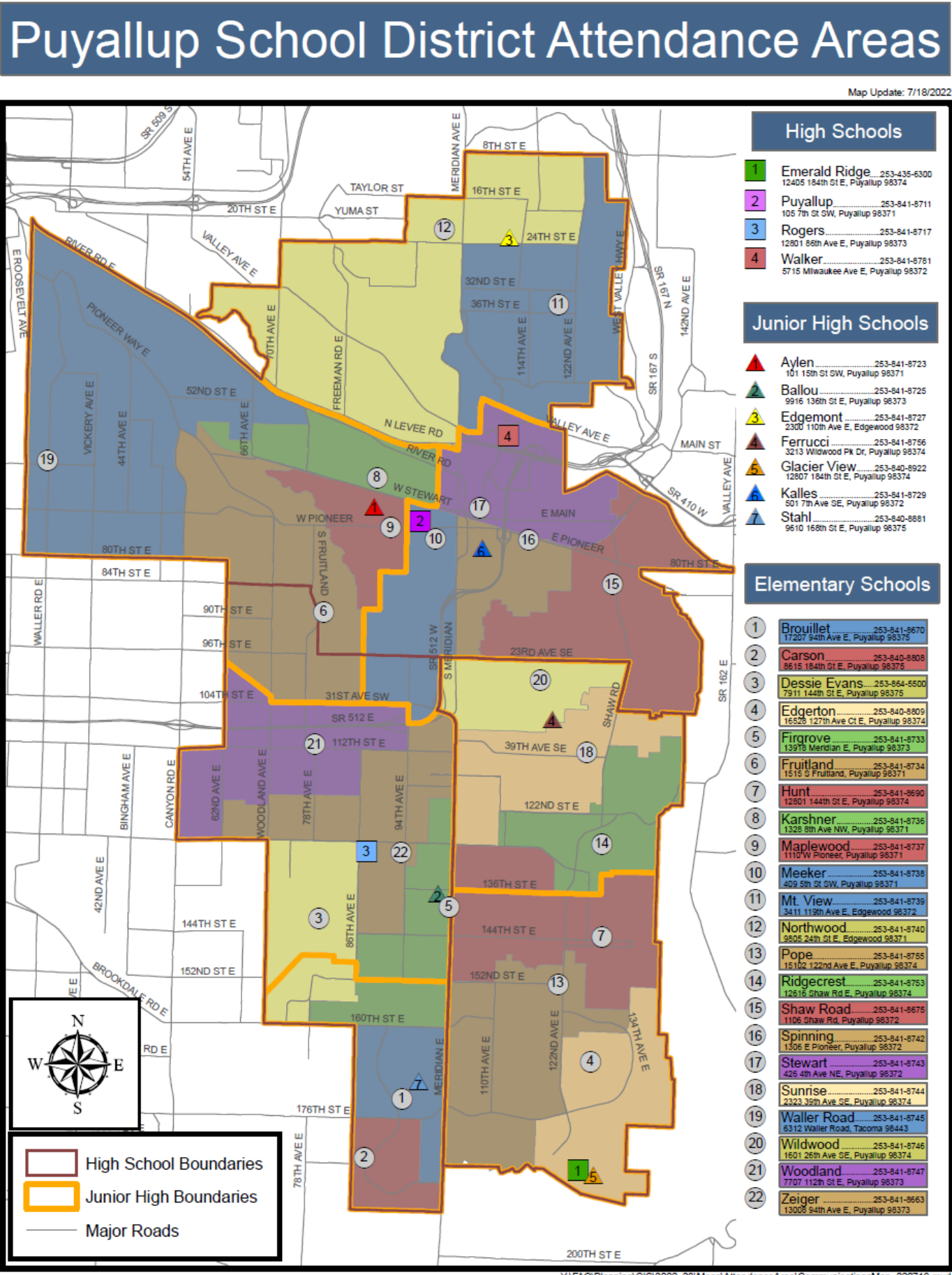



# School Boundaries

The Puyallup School District Board of Directors approved a package of school boundary changes precipitated from the 2015 Bond construction projects, including a new service area for Dessie Evans Elementary. Overall, the boundary changes, impacted:

- 20 of 22 Elementary schools
- 5 of 7 Junior High Schools
- Minor Adjustments to all three comprehensive high schools.

The boundary adjustments helped “right-size” enrollment (current and projected) to building capacity. The boundary changes were implemented in the 2019-20 and 2020-21 school year.



## PSD Region Map

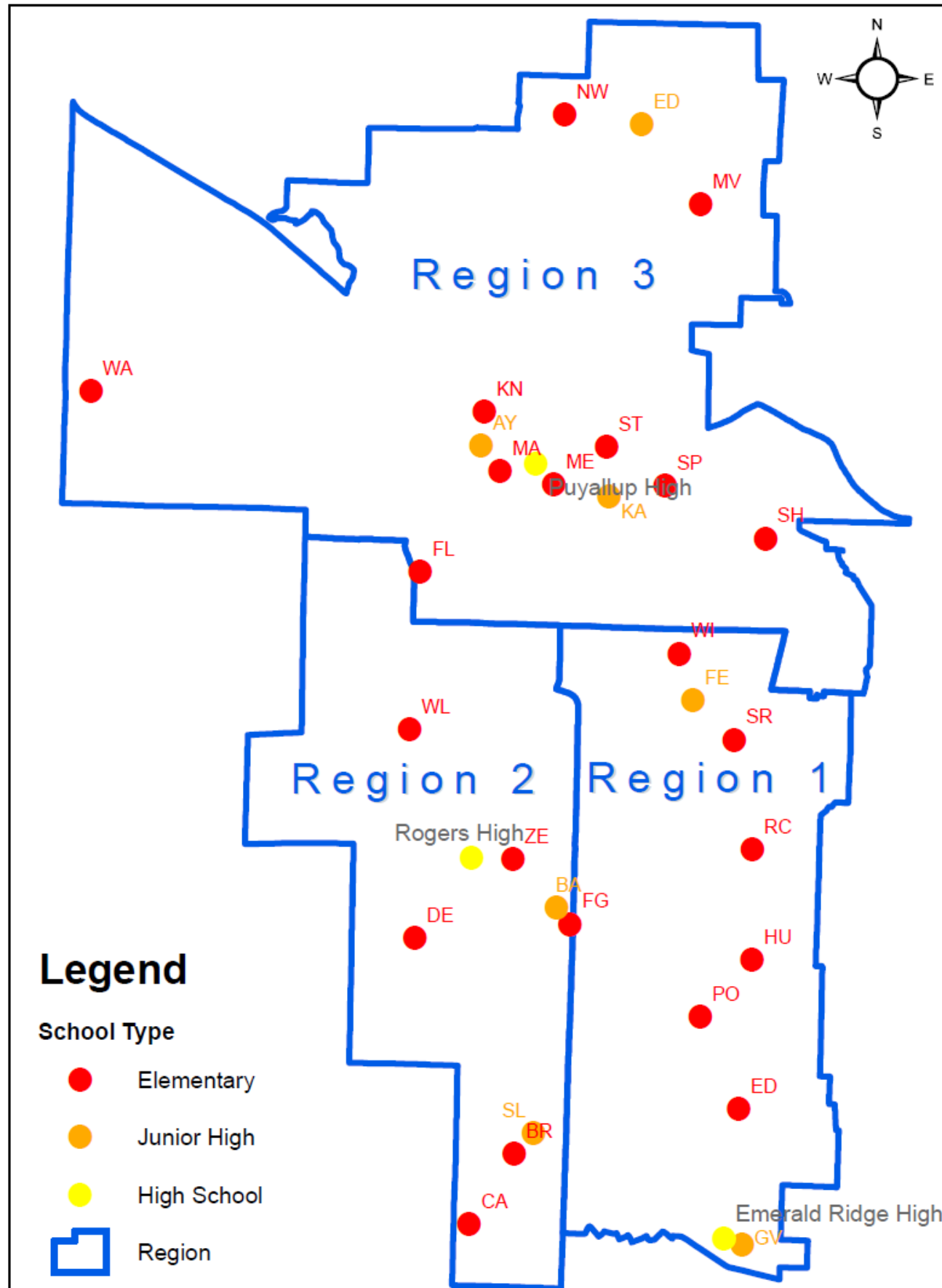

# School Regions

# Region 1: Existing Schools

- Emerald Ridge High School
- Glacier View Junior High
- Ferrucci Junior High
- Edgerton Elementary
- Pope Elementary
- Hunt Elementary
- Ridgecrest Elementary
- Sunrise Elementary
- Wildwood Elementary

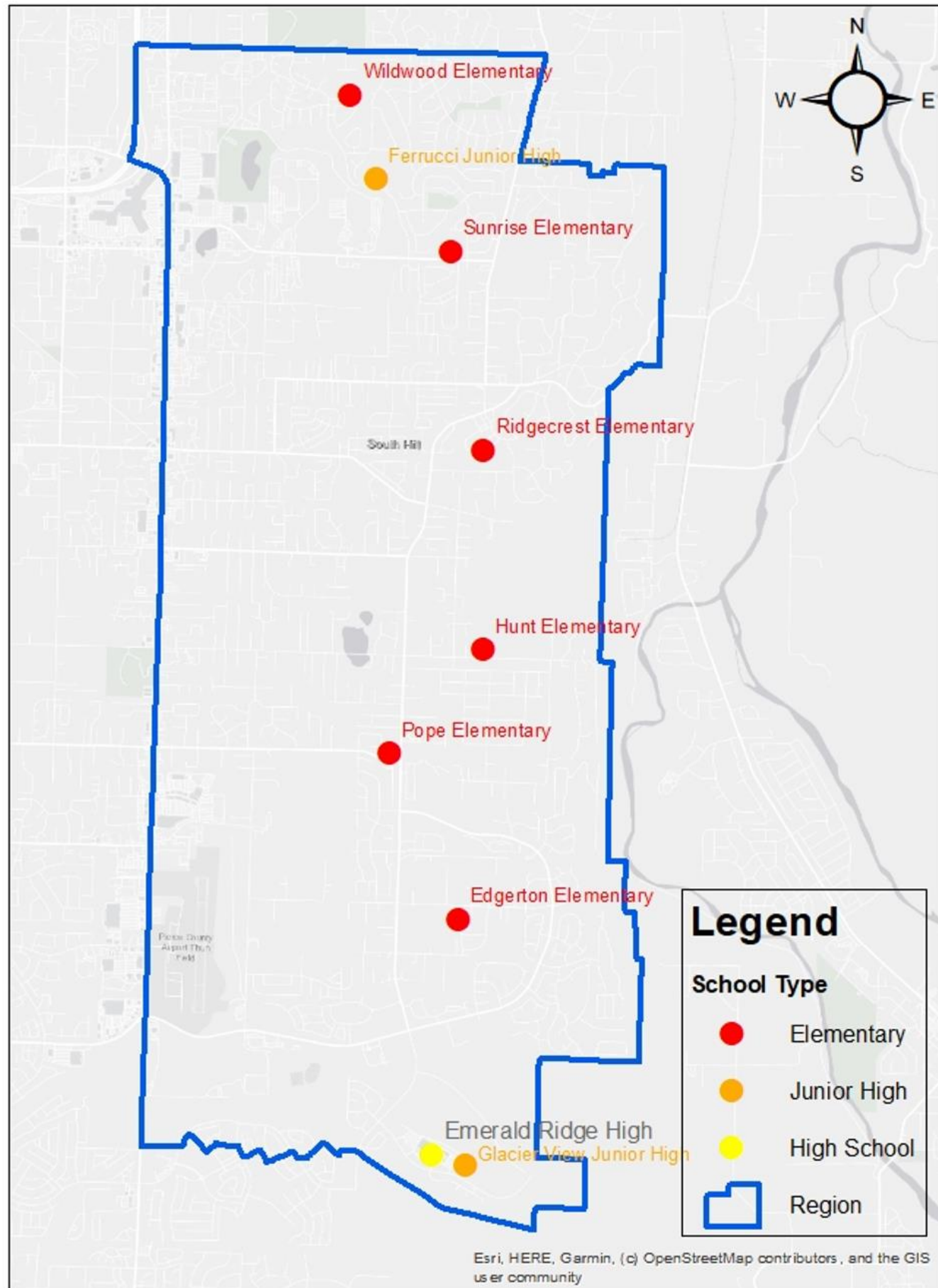

# Region 1 Schools

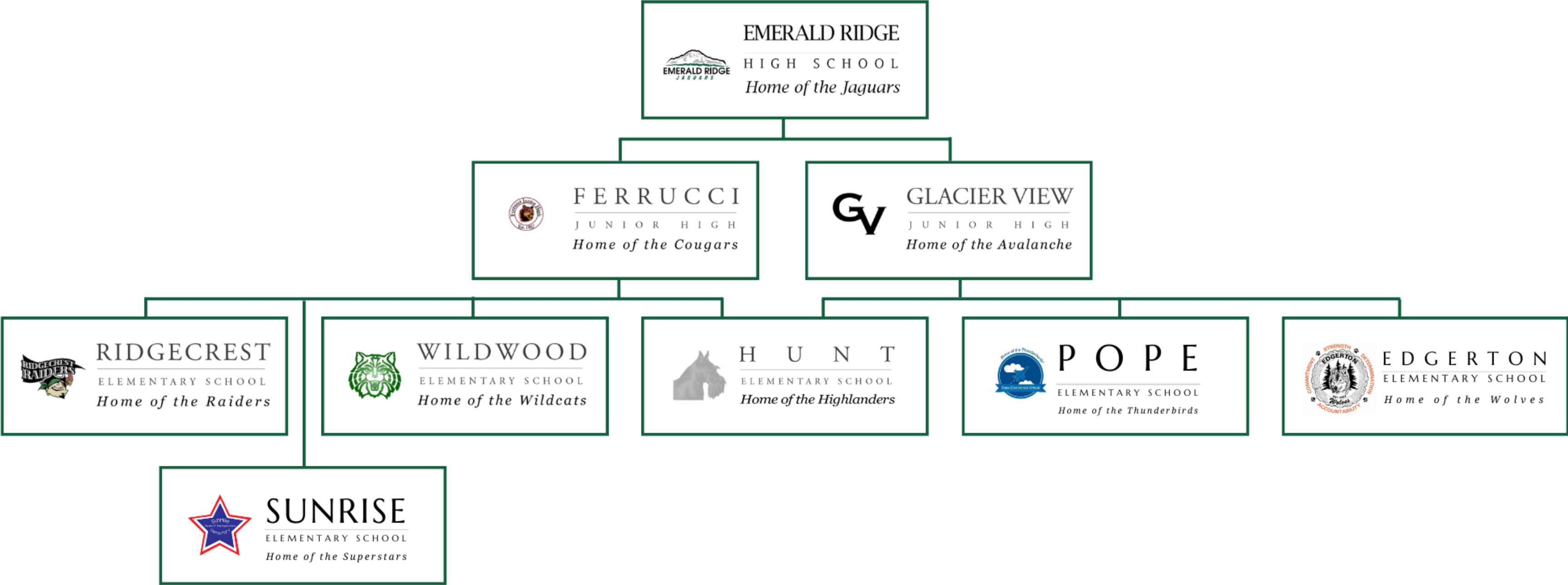



# PSD Grade Configuration

PSD operates under the following grade configurations:

- Elementary: Pre-Kindergarten – 6<sup>th</sup> grade
- Junior High: 7<sup>th</sup> – 9<sup>th</sup> grade
- High School: 10<sup>th</sup> - 12<sup>th</sup> grade

The exception is in the North Hill area (portion of Region 3):

- Mt. View & Northwood Elementary: Pre-Kindergarten – 5<sup>th</sup> grade
- Edgemont Junior High: 6<sup>th</sup> – 9<sup>th</sup> grade.



# 2023-28 (5-Yr) New Housing Weighted Student Generation % by Elementary Attendance Area

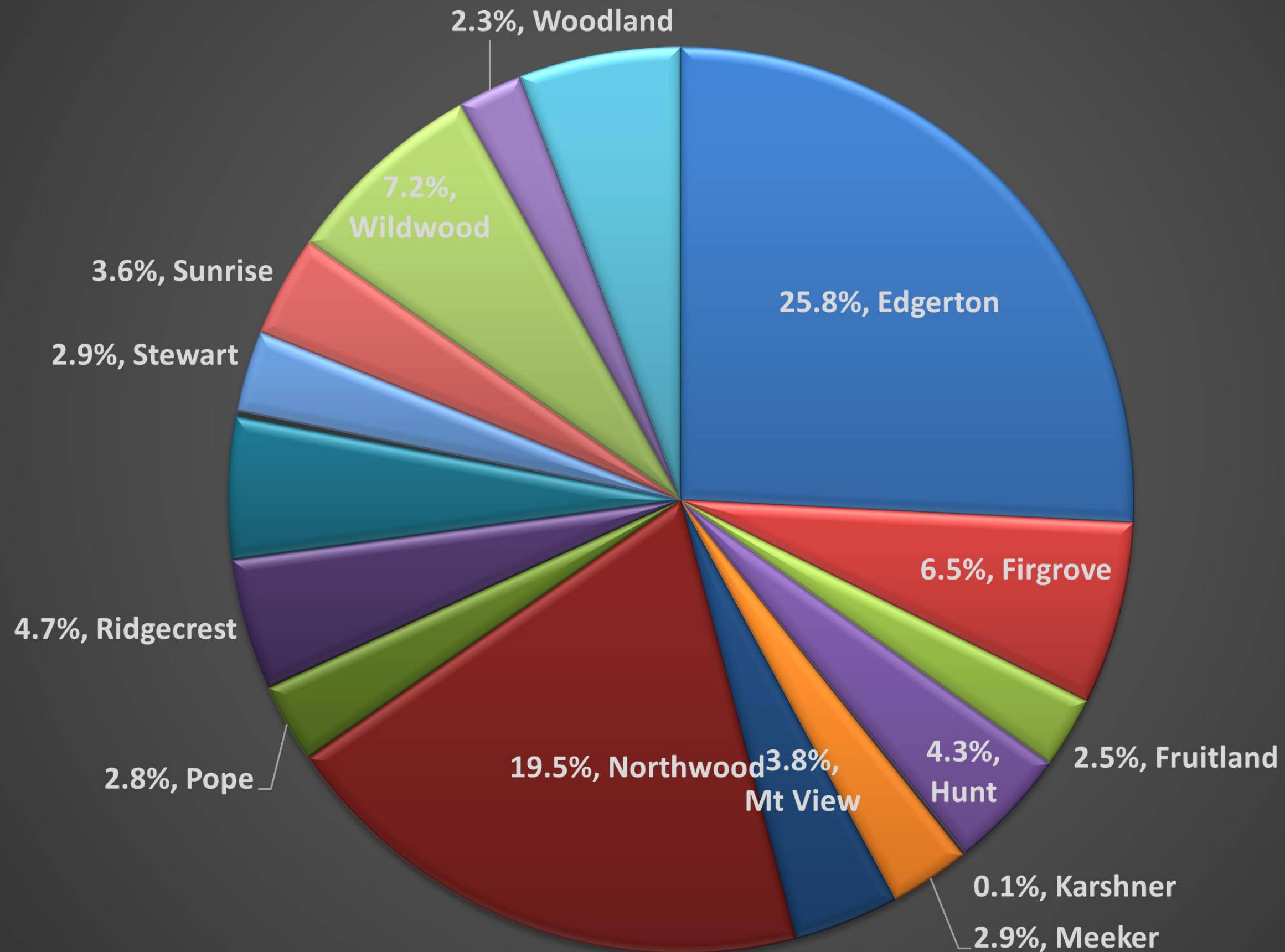



# 2023-28 (5-Yr) New Housing Weighted Student Generation % by Junior High School Attendance Area

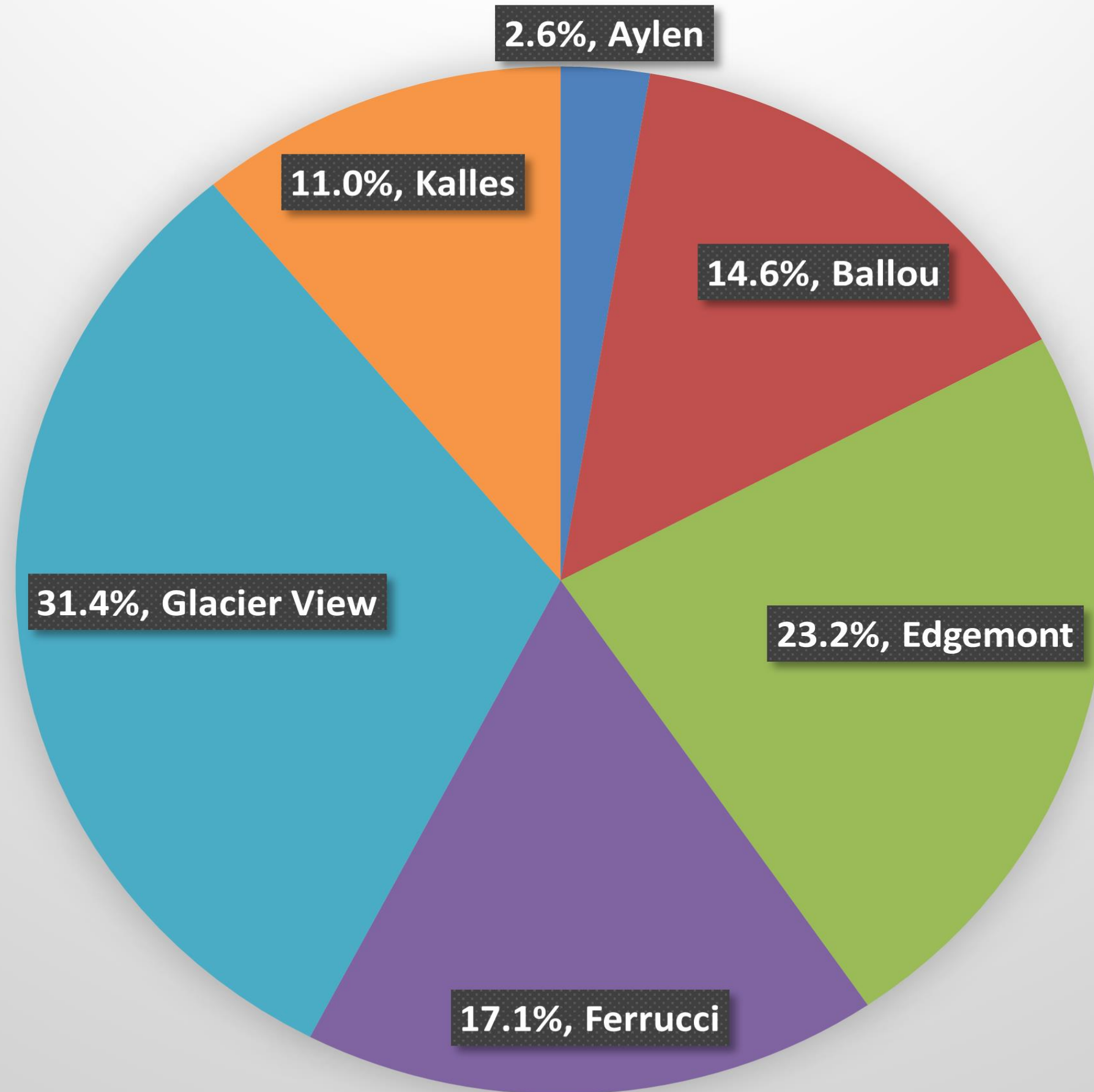

# 2023-28 (5-Yr) New Housing Weighted Student Generation % by High School Attendance Area

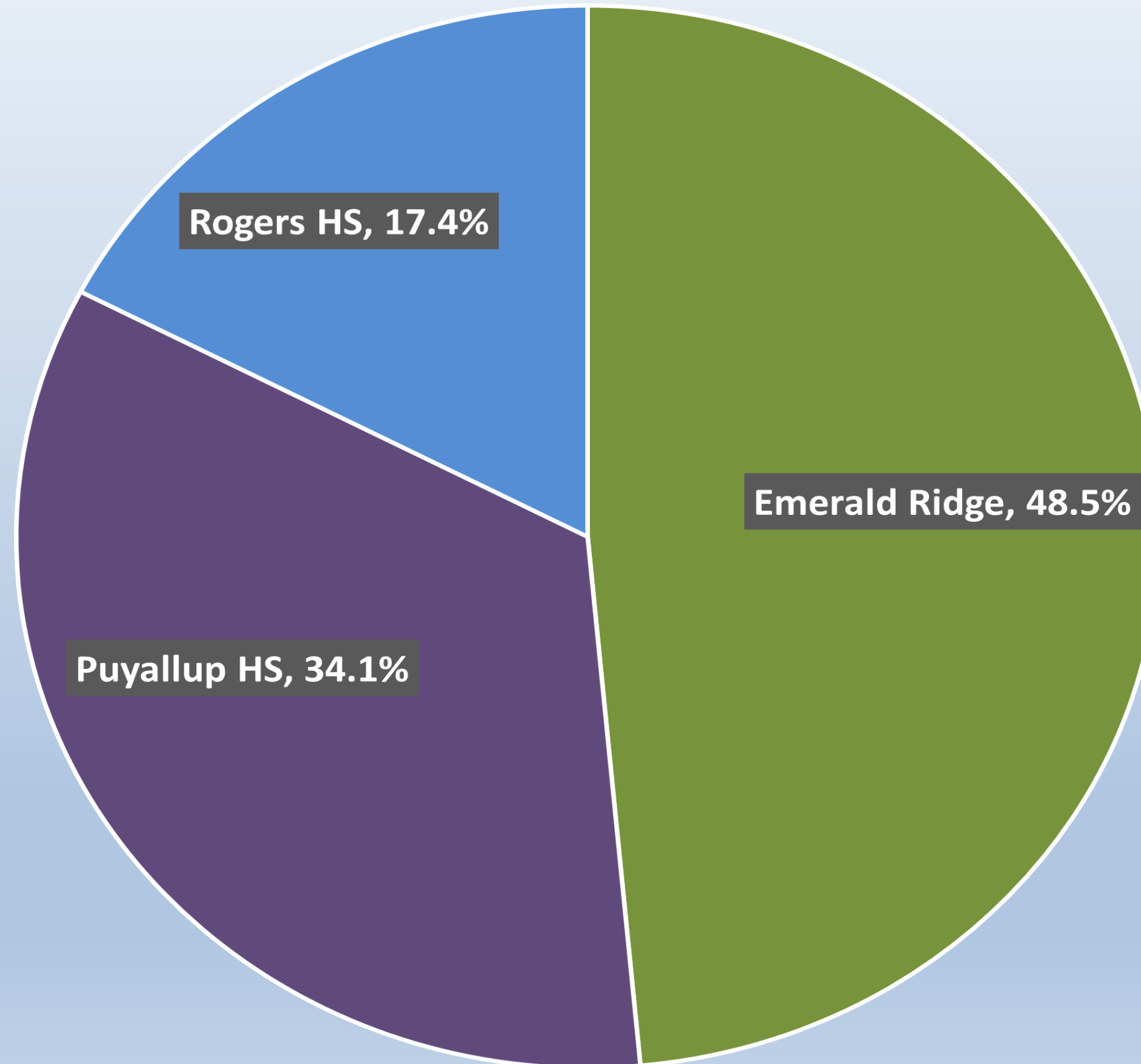

# Sunrise Master Plan

- 5,201 units/homes  
w/ Minor Amendment approval from Pierce County
- 3,203 units occupied
- 992 planned units in Orting SD
- 1,006 planned units remain within Puyallup SD

\*data compiled Sept. 2024\*

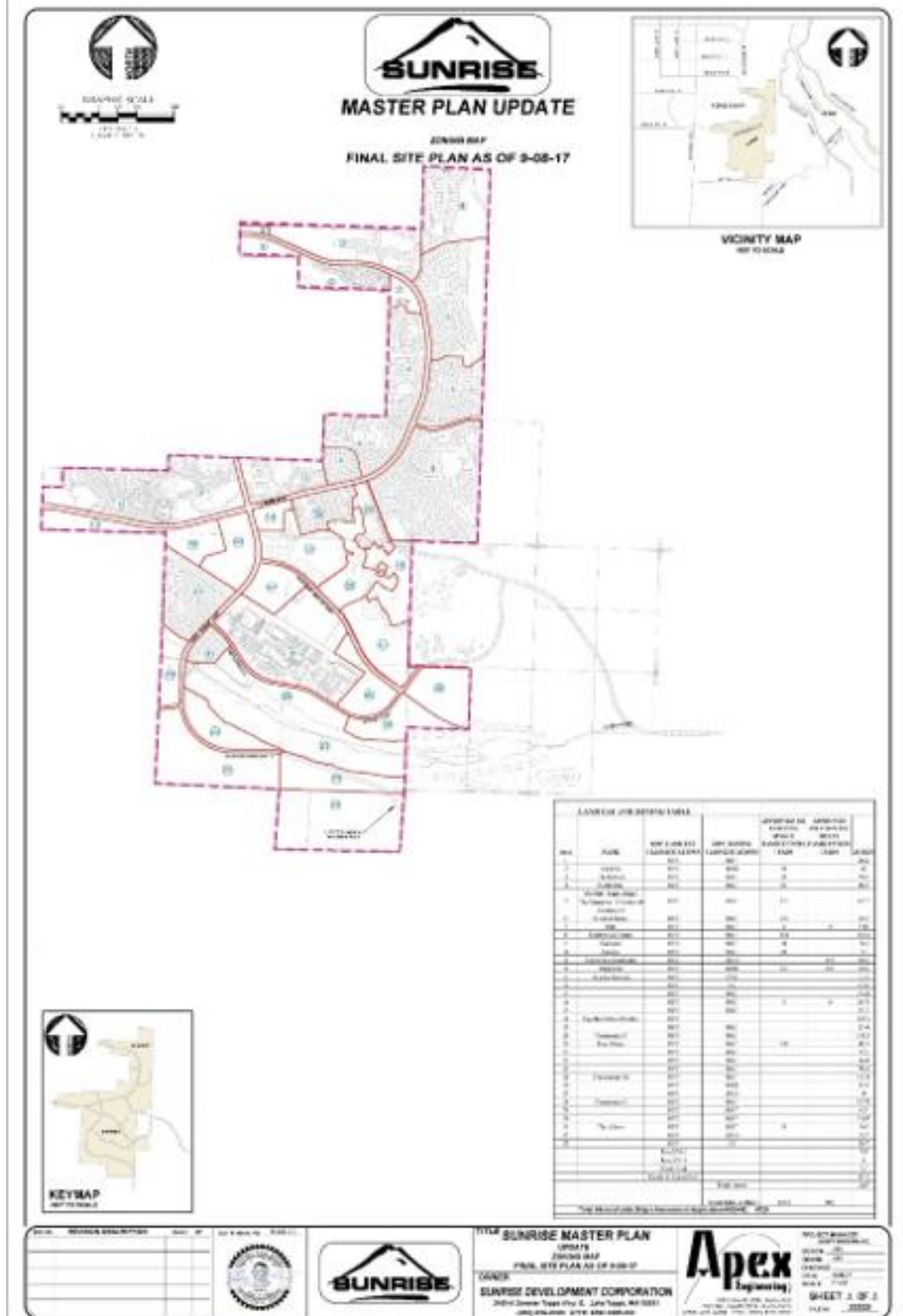



# Orting / Puyallup SD boundary

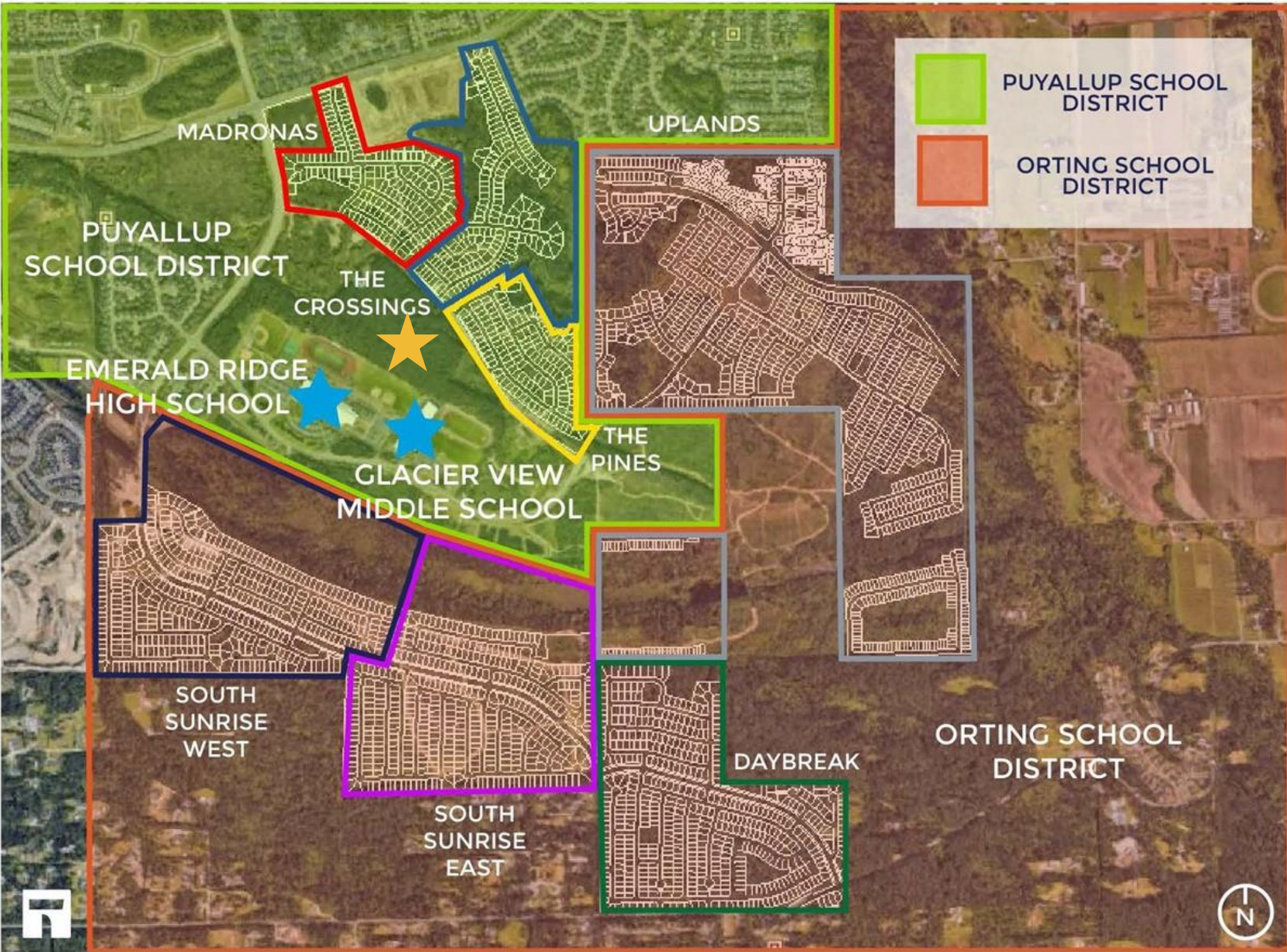

Best 20 min 3h 19m 51 min

Glacier View Junior High, 12807 184th St

Orting High School, 320 Washington Ave N

Add destination

Leave now Options

Send directions to iPhone Copy link

via 200th St E and Orting Kapowsin Hwy E	20 min	9.3 miles
Fastest route, the usual traffic		
Details		
via 122nd Ave E and WA-162 E	21 min	10.0 miles

Explore nearby Orting High School

Restaurants Hotels Gas stations Parking Lots More





Puyallup SD ★

27 SFD homes  
Elem – 10 students  
JH – 4 students  
HS – 3 students  
TAHOMA  
LOOKOUT

703 SFD homes  
411 SFA homes  
Elem – 350 students  
JH – 140 students  
HS – 120 students

SUNRISE  
HEIGHTS  
137 SFD homes  
Elem – 52 students  
JH – 21 students  
HS – 18 students

Orting SD

\*Red line represents district boundary



# District to District Boundary Change

---

## Transfer of Territory by Petition (RCW 28A.315.195) – Citizen Initiated Petition

- Petition must be signed by 50% +1 of the registered voters residing in the territory subject to the petition.
- Petition submitted to Puget Sound Educational Service District.
- School districts must negotiate and reach an outcome within 90 days from receiving notification of the petition.
- A mediator may be requested by either district.
- If affected school districts cannot agree on the petition, the school district in which the citizens reside must contact PSESD in writing a request a hearing before the Regional Committee.







# Capital Planning Enrollment Projection

## 2024-2035 CAPITAL PROJECTS PLANNING PROJECTION

1/16/2024

### Puyallup School District October Headcount Projection for Capital Projects Planning (Excludes Chief Leschi, Full-Time Running Start, POA, POD, P4, & KA students)

															Projected Births																			
Birth Year	2001-02	2002-03	2003-04	2004-05	2005-06	2006-07	2007-08	2008-09	2009-10	2010-11	2011-12	2012-13	2013-14	2014-15	2015-16	2016-17	2017-18					2018-19	2019-20	2020-21	2021-22	2022-23	2023-24	2024-25	2025-26	2026-27	2027-28	2028-29		
Pierce Co. Births	10039	10063	10201	10393	10871	11290	11479	11596	10823	10976	11485	10926	11617	11512	11804	11468	11419					11143	11002	11022	11057	11112	11168	11224	11280	11336	11393	11450		
% of PSD Cohort	13.6%	13.7%	13.4%	13.0%	12.6%	12.5%	12.4%	13.8%	14.7%	13.9%	14.3%	15.1%	15.4%	12.2%	13.6%	14.0%	12.7%	12.9%	13.6%	14.2%	12.7%					14.0%	14.0%	14.0%	14.0%	14.0%	14.0%	14.0%	14.0%	14.0%
	GRADE	Oct 07	Oct 08	Oct 09	Oct 10	Oct 11	Oct 12	Oct 13	Oct 14	Oct 15	Oct 16	Oct 17	Oct 18	Oct 19	Oct 20	Oct 21	Oct 22	Oct 23	Cohort Survival multipliers (non-weighted Avgs.)				Grade	Oct 24	Oct 25	Oct 26	Oct 27	Oct 28	Oct 29	Oct 30	Oct 31	Oct 32	Oct 33	Oct 34
	K	1361	1374	1363	1347	1371	1414	1426	1603	1593	1529	1638	1651	1789	1404	1609	1603	1453	2008-2011	2008-2019	2016-2019	2022-2023	K	1558	1538	1541	1546	1553	1561	1569	1577	1585	1593	1600
	1	1498	1443	1450	1462	1403	1426	1555	1552	1683	1629	1603	1679	1680	1679	1519	1739	1623	1.057	1.051	1.030	1.012	1	1497	1605	1585	1587	1592	1600	1608	1616	1625	1633	1641
	2	1516	1568	1410	1477	1463	1422	1491	1620	1607	1744	1681	1692	1712	1588	1669	1613	1794	0.999	1.025	1.036	1.032	2	1674	1544	1656	1635	1638	1643	1651	1659	1668	1676	1684
	3	1539	1549	1584	1452	1528	1458	1466	1533	1664	1666	1777	1730	1744	1612	1566	1819	1616	1.025	1.025	1.026	1.002	3	1839	1716	1583	1697	1675	1678	1684	1692	1700	1709	1717
	4	1542	1568	1568	1606	1457	1479	1521	1508	1595	1697	1697	1860	1793	1654	1589	1659	1825	1.010	1.021	1.034	1.003	4	1650	1877	1752	1616	1732	1710	1714	1719	1728	1736	1745
	5	1572	1552	1576	1599	1610	1471	1522	1560	1540	1647	1747	1751	1932	1704	1613	1690	1654	1.009	1.022	1.033	0.997	5	1866	1687	1919	1791	1652	1771	1749	1752	1757	1766	1775
	6	1597	1632	1626	1632	1653	1620	1544	1605	1615	1602	1681	1791	1800	1906	1690	1716	1708	1.039	1.034	1.025	1.011	6	1695	1912	1728	1966	1835	1693	1815	1792	1795	1801	1810
	Total	10625	10686	10577	10575	10485	10290	10525	10981	11297	11514	11824	12154	12450	11547	11255	11839	11673					Total	11778	11879	11763	11838	11678	11657	11788	11807	11857	11913	11972
	7	1704	1643	1658	1680	1670	1679	1690	1614	1658	1700	1658	1748	1824	1729	1848	1770	1745	1.024	1.032	1.031	1.017	7	1761	1747	1971	1782	2027	1892	1745	1871	1847	1851	1857
	8	1654	1732	1658	1677	1700	1701	1717	1723	1667	1703	1743	1707	1754	1766	1707	1901	1773	1.011	1.019	1.019	1.002	8	1779	1795	1781	2009	1817	2067	1929	1779	1907	1883	1887
	9	1824	1681	1748	1644	1652	1695	1713	1721	1783	1671	1696	1735	1709	1734	1759	1714	1858	0.995	1.002	0.997	0.977	9	1769	1774	1791	1777	2004	1812	2062	1924	1775	1903	1878
	Total	5182	5056	5064	5001	5022	5075	5120	5058	5108	5074	5097	5190	5287	5229	5314	5385	5376					Total	5309	5317	5543	5568	5848	5771	5736	5574	5529	5636	5622
	10	1738	1810	1696	1738	1632	1683	1734	1729	1749	1840	1723	1739	1746	1679	1706	1792	1726	0.999	1.014	1.021	1.007	10	1885	1794	1800	1817	1802	2033	1838	2091	1952	1800	1930
	11	1715	1628	1746	1681	1649	1572	1623	1686	1685	1681	1661	1612	1601	1585	1543	1575	1681	0.968	0.954	0.920	0.938	11	1619	1768	1683	1688	1704	1691	1907	1724	1962	1831	1689
	12	1625	1614	1586	1832	1589	1606	1582	1583	1570	1639	1572	1564	1489	1474	1493	1426	1471	0.990	0.966	0.933	0.934	12	1570	1512	1651	1572	1577	1591	1579	1781	1610	1832	1710
	Total	5078	5052	5028	5251	4870	4861	4939	4998	5004	5160	4956	4915	4836	4738	4742	4793	4878					Total	5074	5074	5134	5077	5083	5315	5324	5597	5524	5463	5329
	District	20885	20794	20669	20827	20377	20226	20584	21037	21409	21748	21877	22259	22573	21514	21311	22017	21927						22160	22270	22440	22483	22610	22743	22849	22978	22910	23013	22923
	K-6 Growth		61	-109	-2	-90	-195	235	456	316	217	310	330	296	-903	-292	584	-166						105	101	-116	75	-160	-21	132	18	50	56	60
	K-6 %		0.6%	-1.0%	0.0%	-0.9%	-1.9%	2.3%	4.3%	2.9%	1.9%	2.7%	2.8%	2.4%	-7.3%	-2.5%	5.2%	-1.4%						0.9%	0.9%	-1.0%	0.6%	-1.3%	-0.2%	1.1%	0.2%	0.4%	0.5%	0.5%
	7-9 Growth		-126	8	-63	21	53	45	-62	50	-34	23	93	97	-58	85	71	-9						-67	9	226	25	280	-77	-35	-162	-45	107	-15
	7-9 %		-2.4%	0.2%	-1.2%	0.4%	1.1%	0.9%	-1.2%	1.0%	-0.7%	0.5%	1.8%	1.9%	-1.1%	1.6%	1.3%	-0.2%						-1.3%	0.2%	4.3%	0.5%	5.0%	-1.3%	-0.6%	-2.8%	-0.8%	1.9%	-0.3%
	10-12 Growth		-26	-24	223	-381	-9	78	59	6	156	-204	-41	-79	-98	4	51	85						196	0	60	-57	7	232	9	272	-73	-61	-135
	10-12 %		-0.5%	-0.5%	4.4%	-7.3%	-0.2%	1.6%	1.2%	0.1%	3.1%	-4.0%	-0.8%	-1.6%	-2.0%	0.1%	1.1%	1.8%						4.0%	0.0%	1.2%	-1.1%	0.1%	4.6%	0.2%	5.1%	-1.3%	-1.1%	-2.5%
	K-12 Growth		-91	-125	158	-450	-151	358	453	372	339	129	382	314	-1059	-203	706	-90						233	110	170	43	127	133	106	129	-68	102	-90
	K-12 %		-0.4%	-0.6%	0.8%	-2.2%	-0.7%	1.8%	2.2%	1.8%	1.6%	0.6%	1.7%	1.4%	-4.7%	-0.9%	3.3%	-0.4%						1.1%	0.5%	0.8%	0.2%	0.6%	0.6%	0.5%	0.6%	-0.3%	0.4%	-0.4%
															COVID	COVID	COVID recovery																	

Notes:

Future Birth Counts: An increase by 0.5% is used for the annual birth count multiplier, based on the AVERAGE annual increase in Pierce County from 2002 - 2022.

Future Kindergarten: 14.0 % is used as the PSD Kindergarten cohort % of Countywide births from five years previous.

Past enrollment numbers for Grades 10-12 include enrollment at the four high schools only (exclude POA, POD, Full-time Running Start & Chief Leschi students (reported on P223 through 2017).

The 2020-21 school year began instruction with remote-learning only. 2021-22 school year began with full-time in-class instruction, but with expanded P4/POA programs.



# High School Capacity Forecast through 2031-32

High School 2024-25 (Current)	Emerald Ridge
Student Capacity (excluding portables)	1,228
9/24/2024 Enrollment*	1,558
Capacity +/-	(330)

High School Forecast	Emerald Ridge
Student Capacity (excluding portables)	1,228
Projected Enrollment Apex	1,751
Capacity +/-	(523)

*\*Enrollment from Facilities Extract Cognos report pulled 9/24/2024. Does not include PDL or Full-time Running Start students.*



# Junior High Capacity Forecast through 2031-32

Junior High 2024-25 (Current)	Ferrucci	Glacier View
Student Capacity (excluding portables)	906	792
9/23/2024 Enrollment*	819	851
Capacity +/-	87	(59)

Junior High Forecast	Ferrucci	Glacier View
Student Capacity (excluding portables)	906	792
Projected Enrollment Apex	862	967
Capacity +/-	44	(175)

*\*Enrollment from PSD Insights pulled 9/23/2024*

# Elementary Capacity Forecast through 2031-32

Elementary 2024-25 (Current)	Edgerton	Hunt	Pope	Ridgecrest
Student Capacity (excluding portables)	634	686	726	426
9/26/2024 Enrollment*	770	702	754	456
Capacity +/-	(136)	(16)	(28)	(30)

Elementary Forecast	Edgerton	Hunt	Pope	Ridgecrest
Student Capacity (excluding portables)	634	686	726	426
Projected Enrollment Apex	900	722	762	495
Capacity +/-	(266)	(36)	(36)	(69)

- Staff recommendation for New Elementary Student Capacity of 750 students based on:
- **407** Projected Capacity Deficit projected by 2031-32.
  - Recommended 50-student (**200**-total) capacity buffer at each existing school (list based on anticipated school boundary change impacts) for future growth past 2031-32 and for cohort variables.
  - Expectation that Sunrise Master Plan will generate up to an additional **100** students for housing completed after 2031-32.
  - New schools are an enrollment magnet. Dessie Evans Elementary being a recent example. **50**-student buffer Some buffer should be given for this phenomenon.

*\*Enrollment from PSD Insights pulled 9/26/2024*



**FOUNDATIONS**  
FOR OUR **FUTURE**

**Break**





**FOUNDATIONS**  
FOR OUR **FUTURE**

# Region 1 CFAC Proposed Projects

# Estimated Bond Project Costs

BOND PROJECT	ESTIMATED PROJECT COST
Puyallup High School – 304,759 Square Feet New	\$470,800,000 * <i>Master Plan Build Out</i>
Rogers High School – 96,380 Square Feet New	\$125,265,000
Emerald Ridge High School – 85,700 Square Feet New	\$109,900,000
Glacier View Junior High Addition – 23,000 Square Feet New	\$23,380,000
Walker High School Addition – 18,700 Square Feet New	\$26,880,000
New Elementary 24 – 103,250 Square Feet New	\$122,350,000
Replace Mt. View Elementary School – 74,500 Square Feet New	\$99,410,000 * <i>Not included in 2021 CFAC</i>
Replace Spinning Elementary – 61,350 Square Feet New	\$84,050,000
Replace Waller Road Elementary – 61,350 Square Feet New	\$84,050,000
+ 10% Bond Contingency	\$114,610,000
<b>BOND FUNDING NEEDED</b>	<b>\$1,260,693,500</b>



**FOUNDATIONS**  
FOR OUR **FUTURE**



# Region 1: Emerald Ridge



# Emerald Ridge High School



**Needs Statement**

Emerald Ridge High School serves the highest growth area for the District’s high school population. The current building and site improvements do not meet the program needs for classroom space, athletics, or core facilities (commons/library ...). Some building systems are at or near the end of their useful life. The existing building is not eligible for State match modernization funding until 2031.

**Facts:**

**Program/Educational Specification Improvements**

Classroom spaces for 1800 students	Aux gym, weight room, gymnastics facility, pool?
Two science rooms	Two new tennis courts
Digital media center (new library)	Outdoor field restrooms
Conference rooms, storage, restrooms and support spaces as part of the classroom addition	Added Baseball/Fast Pitch Fields

BCA Score	100 Scale	WAC	Description
Main Building	64.00	2.44	Fair
# Portables	13		

**Proposed Scope of Work**

The Master Plan Phase 1 proposes to build a 400-student addition. The work will include; construction of a two-story building, relocation of the library and expansion of the commons and parking improvements. The project will include construction of two tennis courts, infield improvements for baseball and fast pitch, an auxiliary gym and weight room and preserve the option for future expansion to accommodate a 9-12th grade configuration. Phase 2 includes major modernization of the building and additional baseball and fast pitch fields.



# Estimated Costs: Classroom Addition Two-Story



PROJECT	ESTIMATED COST
Midpoint Construction January 2029 4.5% Escalation	\$45,500,000

ADDITIONAL ESTIMATE INFORMATION

2024 COST ESTIMATE	38,000,000
Total 4 Year 2024-2029 Escalation( G-F)	7,500,000
10% Bond Contingency (10%*G)	4,550,000



# Estimated Costs: Gymnastic Gym, Weight Room

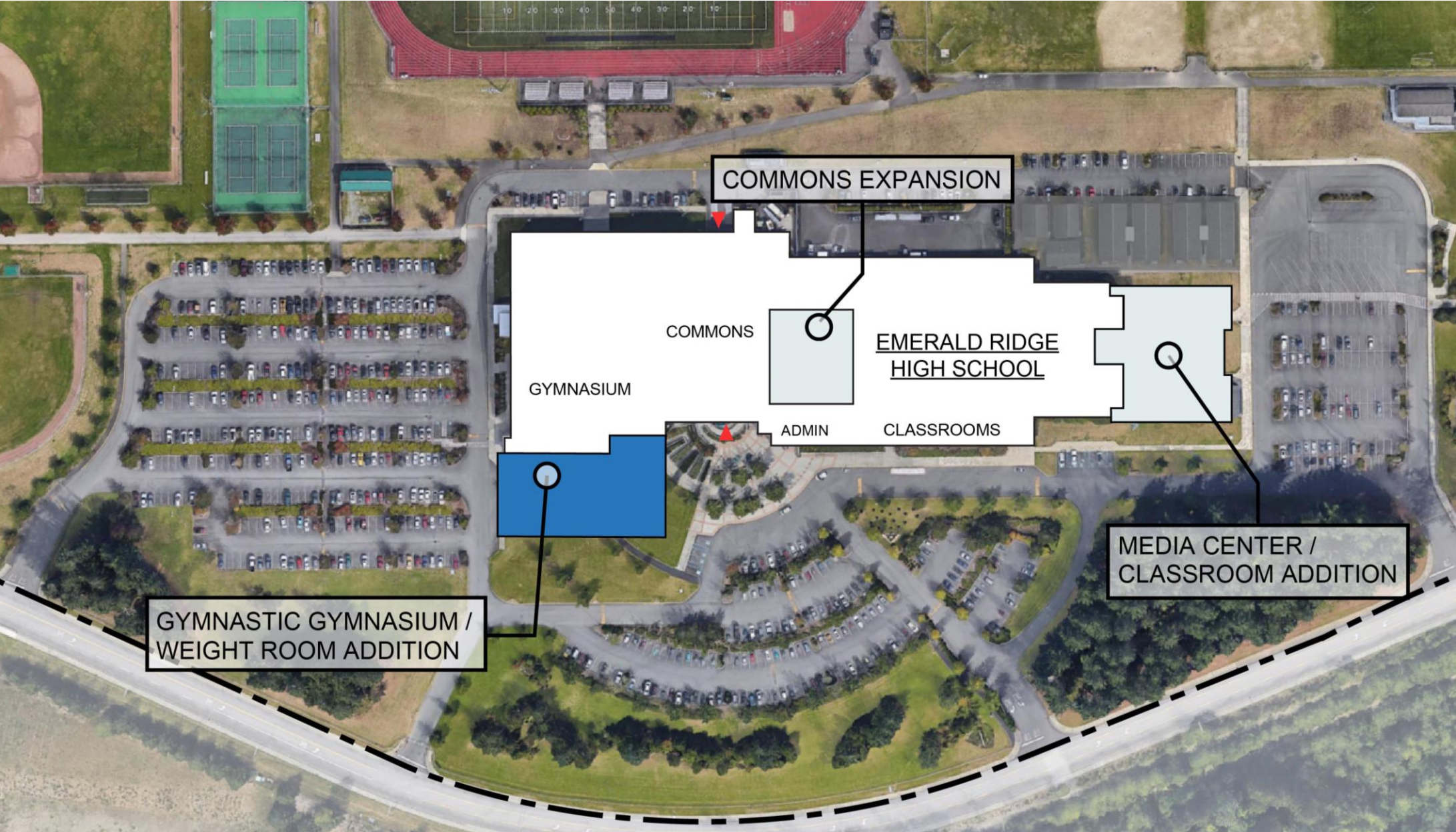

PROJECT	ESTIMATED COST
---------	----------------

Midpoint Construction January 2029  
4.5% Escalation

\$25,000,000

### ADDITIONAL ESTIMATE INFORMATION

2024 COST ESTIMATE	20,000,000
Total 4 Year 2024-2029 Escalation( G-F)	5,000,000
10% Bond Contingency (10%*G)	2,500,000



# Estimated Costs: Commons Addition

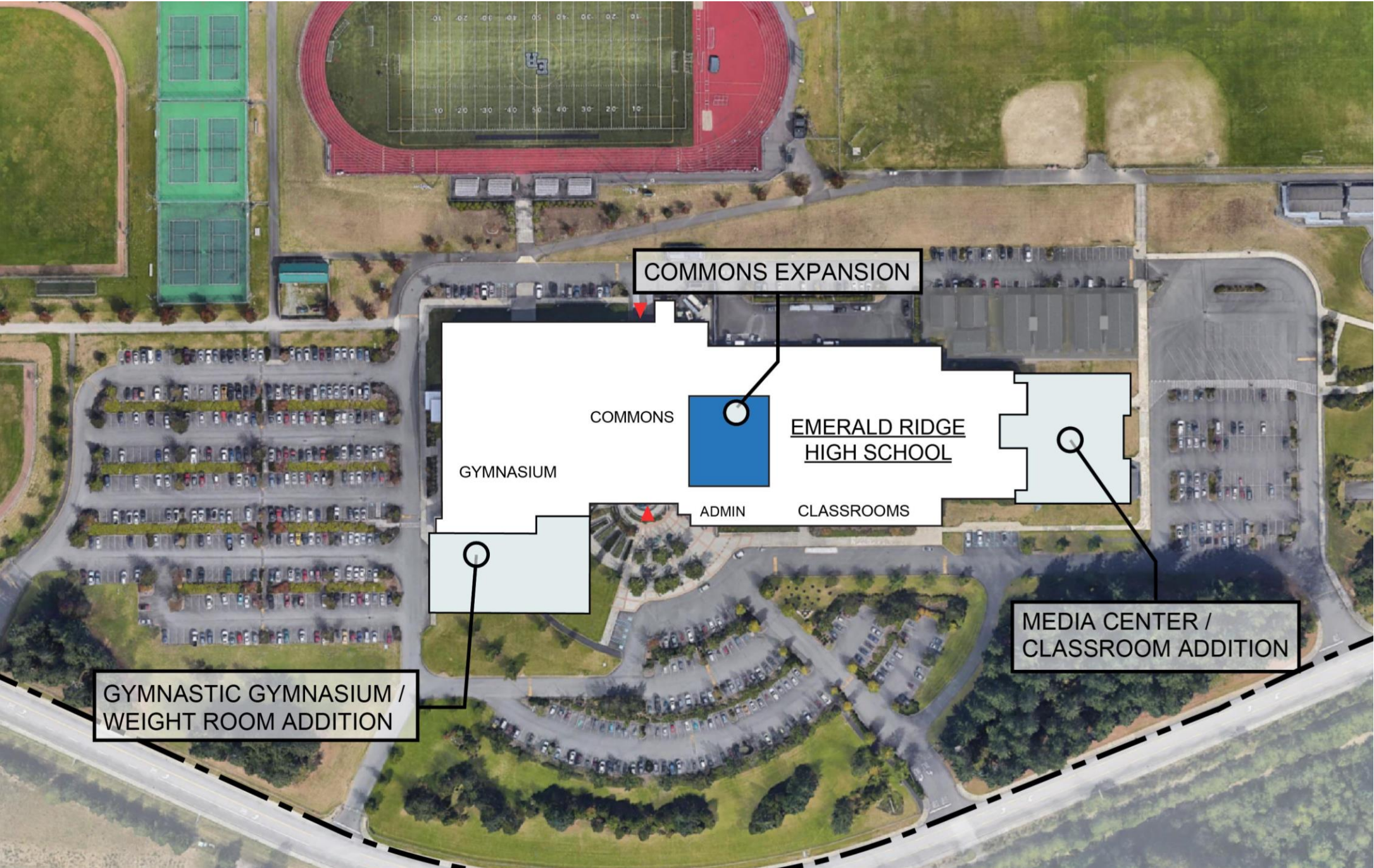

PROJECT	ESTIMATED COST
---------	----------------

Midpoint Construction January 2029  
4.5% Escalation

\$11,000,000

ADDITIONAL ESTIMATE INFORMATION

2024 COST ESTIMATE	9,000,000
Total 4 Year 2024-2029 Escalation( G-F)	2,000,000
10% Bond Contingency (10%*G)	1,100,000



# Estimated Costs: Pool Addition



PROJECT	ESTIMATED COST
---------	----------------

Midpoint Construction January 2029  
4.5% Escalation

**\$36,000,000**

ADDITIONAL ESTIMATE INFORMATION

2024 COST ESTIMATE	30,200,000
Total 4 Year 2024-2029 Escalation( G-F)	5,800,000
10% Bond Contingency (10%*G)	3,600,000



# Estimated Costs: Two Tennis Courts



PROJECT	ESTIMATED COST
---------	----------------

Midpoint Construction January 2029  
4.5% Escalation

\$1,450,000

ADDITIONAL ESTIMATE INFORMATION

2024 COST ESTIMATE	1,200,000
Total 4 Year 2024-2029 Escalation( G-F)	250,000
10% Bond Contingency (10%*G)	145,000



# Estimated Costs: 2400 Student 9-12 Model

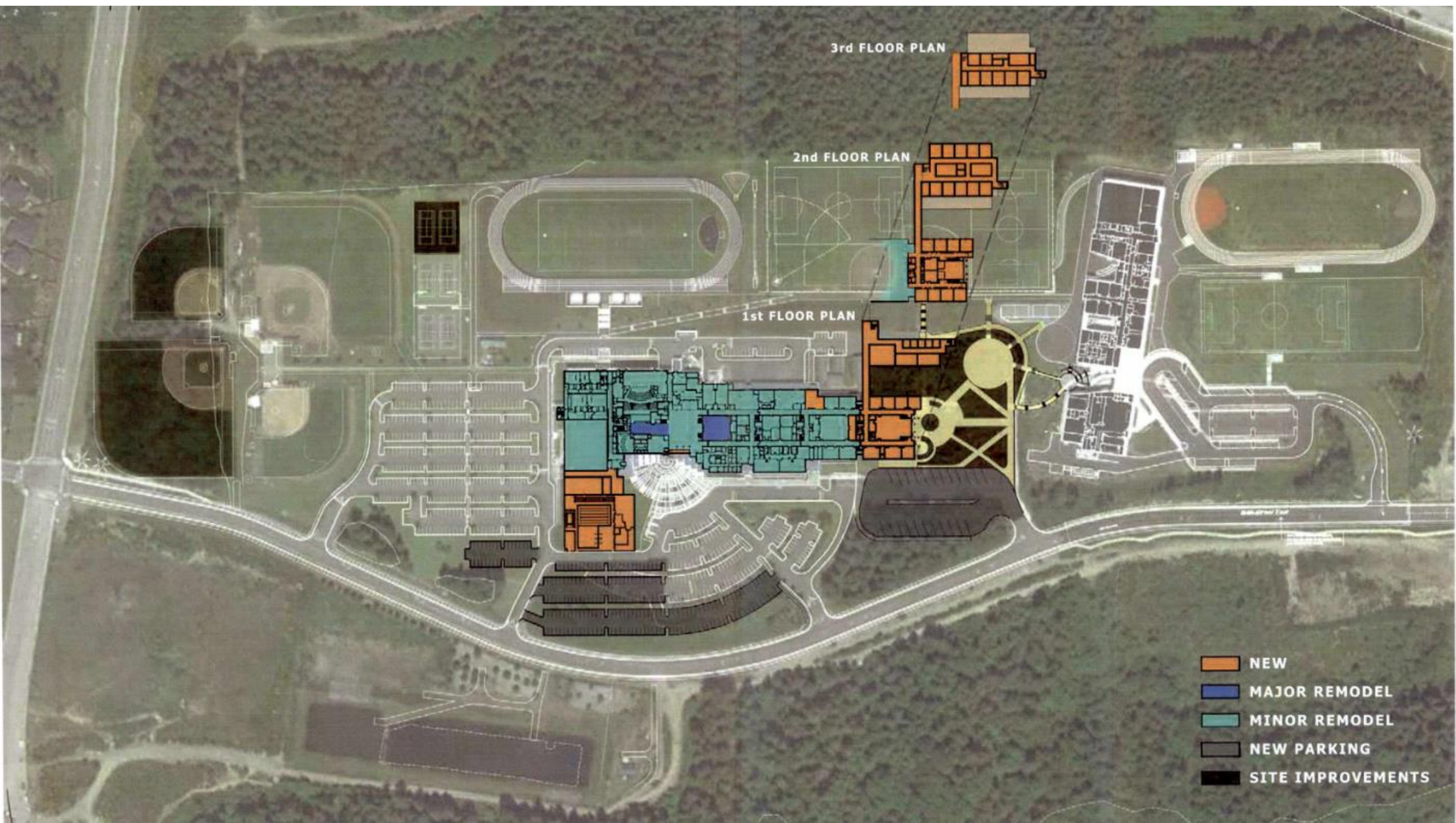

PROJECT	ESTIMATED COST
---------	----------------

Midpoint Construction January 2029

4.5% Escalation

\* Classroom Addition, Commons

\$124,000,000

Expansion cost to be added to this Option

### ADDITIONAL ESTIMATE INFORMATION

2024 COST ESTIMATE	104,500,000
Total 4 Year 2024-2029 Escalation( G-F)	20,000,000
10% Bond Contingency (10%*G)	12,450,000

# Estimated Costs - ERHS

1800 Student		SQFT	2024 COST	Midpoint Construction January 2029 4.5% Escalation	Total 4 Year 2024-2029 Escalation( G-F)	10% Bond Contingency (10%*G)
Base	Classroom Addition Two Story	34,800	\$38,000,000	\$45,500,000	\$7,500,000	\$4,550,000
Option	Auxiliary Gym\Weight Room	16,000	\$20,000,000	\$25,000,000	\$5,000,000	\$2,500,000
Option	Commons Addition	3,200	\$9,000,000	\$11,000,000	\$2,000,000	\$1,100,000
Option	2 Additional Tennis Courts		\$1,200,000	\$1,450,000	\$250,000	\$145,000
Option	Pool	25,750	\$30,200,000	\$36,000,000	\$5,800,000	\$3,600,000
Option	2400 Student 9-12 Model	107,000	\$104,500,000	\$124,500,000	\$20,000,000	\$12,450,000





**FOUNDATIONS**  
FOR OUR **FUTURE**



# Region 1: Glacier View

# Glacier View Junior High



**Needs Statement**

Glacier Junior High School serves 7th-9th grades in the South Hill area of Puyallup. The school is projected to need to provide housing for 200 additional students. Some building systems are at or near the end of their useful life. The existing building is not eligible for State match modernization funding until 2041.

**Facts:**

**Program/Educational Specification Improvements**

Provide capacity for 1000 students.	
Add 6 General Ed Classrooms, 1 Science Room and Special Ed space.	
Add teacher planning space.	
Enlarge commons by approximately 3,000 SF	

BCA Score	100 Scale	WAC	Description
Main Building	71.75	2.13	Good
# Portables	4		

**Proposed Scope of Work**

The plan proposes to build a classroom addition for 200 students, expand the commons, add special ed, science and support spaces and improve parking and drop off facilities. The existing building is not eligible for State match modernization funding until 2041.



# Estimated Costs: Glacier View, Classrooms



PROJECT	ESTIMATED COST
---------	----------------

Midpoint Construction January 2029  
4.5% Escalation

**\$24,650,000**

### ADDITIONAL ESTIMATE INFORMATION

2024 COST ESTIMATE	18,000,000
Total 4 Year 2024-2029 Escalation( G-F)	6,650,000
10% Bond Contingency (10%*G)	2,650,000

\*School Construction Assistance Program (SCAP) - State funding



# Estimated Costs: Glacier View, Commons Addition

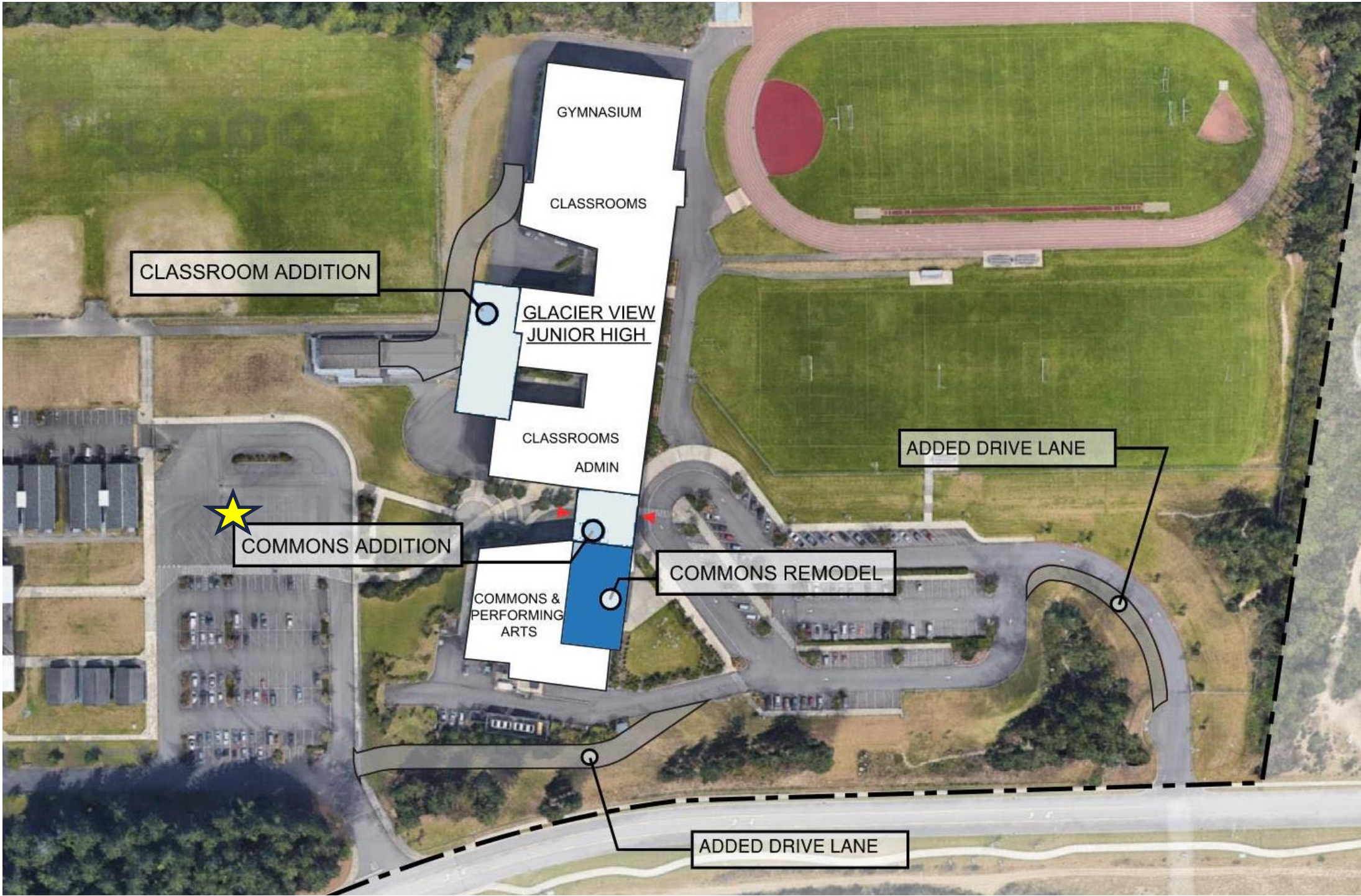

PROJECT	ESTIMATED COST
---------	----------------

Midpoint Construction January 2029  
4.5% Escalation

**\$6,800,000**

ADDITIONAL ESTIMATE INFORMATION

2024 COST ESTIMATE	5,750,000
Total 4 Year 2024-2029 Escalation( G-F)	1,050,000
10% Bond Contingency (10%*G)	680,000



# Estimated Costs: Glacier View, SPED RM to Science



PROJECT	ESTIMATED COST
Midpoint Construction January 2029	\$1,650,000
4.5% Escalation	

ADDITIONAL ESTIMATE INFORMATION

2024 COST ESTIMATE	1,375,000
Total 4 Year 2024-2029 Escalation( G-F)	275,000
10% Bond Contingency (10%*G)	165,000

# Estimated Costs: Glacier View; Full Plan

200 Student Addition		SQFT	2024 COST	Midpoint Construction January 2029 4.5% Escalation	Total 4 Year 2024-2029 Escalation( G-F)	10% Bond Contingency (10%*G)
Base	Classroom Addition\SPED Rm	15,500	\$18,000,000	\$24,650,000	\$6,650,000	\$2,465,000
Option	Convert SPED RM to Science	1,150	\$1,375,000	\$1,650,000	\$275,000	\$165,000
Option	Commons Addition\Remodel	5,000	\$5,750,000	\$6,800,000	\$1,050,000	\$680,000





**FOUNDATIONS**  
FOR OUR **FUTURE**

# Region 1: Elementary #24

# Elementary #24



**Needs Statement**

A new elementary school would serve grades Pk-6 students in the southeast area of the District. The school is planned to provide housing for 550-1000 students to meet growth in the area. Building elementary 24 will significantly reduce overcrowding at Edgerton Elementary. The school would be built on property adjacent to Emerald Ridge and Glacier View Junior High.

**Facts:**

**Program/Educational Specification Improvements**

Provide capacity for 550 to 1000 students.

BCA Score	100 Scale	WAC	Description
Main Building	N\A	N\A	N\A
# Portables	N\A		

**Proposed Scope of Work**

The plan proposes to build a new school for 550 -1000 students to address future growth and overcrowding at Edgerton.



# Estimated Costs: Elementary #24; 550 Student



PROJECT	ESTIMATED COST
Midpoint Construction January 2029	\$94,500,000
4.5% Escalation	

ADDITIONAL ESTIMATE INFORMATION

2024 COST ESTIMATE	79,350,000
Total 4 Year 2024-2029 Escalation( G-F)	15,150,000
10% Bond Contingency (10%*G)	9,450,000



# Estimated Costs: Elementary #24; 750 Student



PROJECT	ESTIMATED COST
---------	----------------

Midpoint Construction January 2029  
4.5% Escalation

\$124,000,000

ADDITIONAL ESTIMATE INFORMATION

2024 COST ESTIMATE	104,000,000
Total 4 Year 2024-2029 Escalation( G-F)	20,000,000
10% Bond Contingency (10%*G)	15,350,000



# Estimated Costs: Elementary #24

200 Student Addition		SQFT	2024 COST	Midpoint Construction January 2029 4.5% Escalation	Total 4 Year 2024-2029 Escalation( G-F)	10% Bond Contingency (10%*G)
Option	750 Student	New Building	100,000	\$104,000,000	\$124,000,000	\$20,000,000
Option	550 Student	New Building	75,000	\$79,350,000	\$94,500,000	\$15,150,000

# Elementary Capacity Forecast through 2031-32

Elementary 2024-25 (Current)	Edgerton	Hunt	Pope	Ridgecrest
Student Capacity (excluding portables)	634	686	726	426
9/26/2024 Enrollment*	770	702	754	456
Capacity +/-	(136)	(16)	(28)	(30)

Elementary Forecast	Edgerton	Hunt	Pope	Ridgecrest
Student Capacity (excluding portables)	634	686	726	426
Projected Enrollment Apex	900	722	762	495
Capacity +/-	(266)	(36)	(36)	(69)

- Staff recommendation for New Elementary Student Capacity of 750 students based on:
- **407** Projected Capacity Deficit projected by 2031-32.
  - Recommended 50-student (**200**-total) capacity buffer at each existing school (list based on anticipated school boundary change impacts) for future growth past 2031-32 and for cohort variables.
  - Expectation that Sunrise Master Plan will generate up to an additional **100** students for housing completed after 2031-32.
  - New schools are an enrollment magnet. Dessie Evans Elementary being a recent example. **50**-student buffer Some buffer should be given for this phenomenon.

*\*Enrollment from PSD Insights pulled 9/26/2024*





**FOUNDATIONS**  
FOR OUR **FUTURE**

# Table Discussions

# Project Costs- Estimates Toolbox

					Help us identify the project's priority. Place an X in one of the three categories.			If you've selected "Critical Need" add the dollar amount to the total		
STUDENT CAPACITY	BASE & OPTIONS	PROJECT	SQFT	2024 COST		Critical Need	Need	Postpost		Identified Critical Need Costs
	Base	Classroom Addition Two Story	34,800	\$45,500,000		X				\$45,500,000
	Option	Auxiliary Gym\WeightRoom	16,000	\$25,000,000						
	Option	Commons Addition	3,200	\$11,000,000						
	Option	2 Additional Tennis Courts		\$1,450,000						
	Option	Pool	25,750	\$36,000,000						
*Requires Base Option	*Option	2400 Student 9-12 Model	107,000	\$124,000,000						
1800 Student	All Updates			\$118,950,000						
2400 Student	All Updates			\$242,950,000						
Glacier View Junior High School										
	Base	Classroom Addition\SPED Rm	15,500	\$24,650,000						
	Option	Convert SPED RM to Science	1,150	\$1,650,000						
	Option	Commons Addition\Remodel	5,000	\$6,800,000						
200 Student	All Updates			\$33,100,000						
Elementary #24										
550 Student	Build	New Building	75,000	\$79,350,000						
750 Student	Build	New Building	100,000	\$104,000,000						
Total Region 1 Investment Costs										

Consider how you'd fund each project to best serve the school community within our budget.

You can choose to fund part of a project, or an entire project.



# Project Costs - Estimates Toolbox

Place one X in Critical Need, Need or Postpone

Place one X in Critical Need, Need or Postpone					Help us identify the project’s priority. Place an X in one of the three categories.			If you’ve selected “Critical Need” add the dollar amount to the total	
					Critical Need	Need	Postpone		Identified Critical Need Costs
	Base	Classroom Addition Two Story	34,800	\$45,500,000	X				\$45,500,000
	Option	Auxiliary Gym\WeightRoom	16,000	\$25,000,000					
	Option	Commons Addition	3,200	\$11,000,000					
	Option	2 Additional Tennis Courts		\$1,450,000					
	Option	Pool	25,750	\$36,000,000					
*Requires Base Option	*Option	2400 Student 9-12 Model	107,000	\$124,000,000					
1800 Student	All Updates			\$118,950,000					
2400 Student	All Updates			\$242,950,000					
Glacier View Junior High School									
	Base	Classroom Addition\SPED Rm	15,500	\$24,650,000					
200 Student									
Elementary #2									
550 Student	Build	New Building	75,000	\$79,350,000					
750 Student	Build	New Building	100,000	\$104,000,000					
Total Region 1 Investment Costs									
									\$45,500,000

If you select "Critical Need" add the cost in the final category and calculate a total for all of Region 1 projects.

# Table Discussion

- 1. Does this project address critical capacity need to reduce overcrowding in classrooms? (Yes/No, How?)
- 2. Is this project essential for maintaining or expanding key educational programs? (Yes/No, Why?)

3. Rate this project:

- 1. Critical Need
- 2. Need
- 3. Postpone

Bond Advisory Committee, September 2024

**REGION 1 PROJECT WORKSHEET**

Help us identify the project's priority. Place an X in one of the three categories.

If you've selected "Critical Need" add the dollar amount to the total.

STUDENT CAPACITY	BASE & OPTIONS	PROJECT	SQFT	2024 COST	Critical Need	Need	Postpone	Identified Critical Need Costs
	Base	Classroom Addition Two Story	34,800	\$45,500,000				
	Option	Auxiliary Gym/Weightroom	16,000	\$25,000,000				
	Option	Commons Addition	3,200	\$11,000,000				
	Option	2 Additional Tennis Courts		\$1,450,000				
	Option	Pool	25,750	\$36,000,000				
*Requires Base Option	*Option	2400 Student 9-12 Model	107,000	\$124,000,000				
1800 Student	All Updates			\$118,950,000				
2400 Student	All Updates			\$242,950,000				
<b>Glacier View Junior High School</b>								
	Base	Classroom Addition/SPED Rm	15,500	\$24,650,000				
	Option	Convert SPED RM to Science	1,150	\$1,650,000				
	Option	Commons Addition/Remodel	5,000	\$6,800,000				
200 Student	All Updates			\$33,100,000				
<b>Elementary #24</b>								
550 Student	Build	New Building	75,000	\$79,350,000				
750 Student	Build	New Building	100,000	\$104,000,000				
Total Region 1 Investment Costs								





# Table Discussion Group Share Out

- What factors influenced your table's decisions, and how did you prioritize certain projects over others?
- Are there any specific projects that you believe need more in-depth discussion or clarification?
- How confident are you in your current investment choices as we shift focus to Regions 2 and 3? Do you foresee the need to make any adjustments?

Bond Advisory Committee, September 2024

## REGION 1 PROJECT WORKSHEET

Help us identify the project's priority. Place an X in one of the three categories.

If you've selected "Critical Need" add the dollar amount to the total Identified Critical Need Costs

STUDENT CAPACITY	BASE & OPTIONS	PROJECT	SQFT	2024 COST	Critical Need	Need	Postpost	Identified Critical Need Costs
	Base	Classroom Addition Two Story	34,800	\$45,500,000				
	Option	Auxiliary Gym\WeightRoom	16,000	\$25,000,000				
	Option	Commons Addition	3,200	\$11,000,000				
	Option	2 Additional Tennis Courts		\$1,450,000				
	*Option	Pool		\$36,000,000				
1800 Student	All Updates	2400 Student 9-12 Model	25,750	\$124,000,000				
2400 Student	All Updates		107,000	\$118,950,000				
				\$242,950,000				
<b>Glacier View Junior High School</b>								
	Base	Classroom Addition\SPED Rm	15,500	\$24,650,000				
	Option	Convert SPED RM to Science	1,150	\$1,650,000				
200 Student	Option	Commons Addition\Remodel	5,000	\$6,800,000				
	All Updates			\$33,100,000				
<b>Elementary #24</b>								
550 Student	Build	New Building	75,000	\$79,350,000				
750 Student	Build	New Building	100,000	\$104,000,000				
Total Region 1 Investment Costs								

**FOUNDATIONS FOR OUR FUTURE**

# Let's Review Your Questions

Thank you for submitting your questions! Let's take a moment to review and address them.





# You're invited to tour our schools

Join us Tuesday, October 1, or Tuesday, November 1 for an insider's look into our schools. Patron Tours also provide a sneak peek inside our central kitchen, EdTec, print shop, and warehouse.



## October 1 (Region 1)

- Emerald Ridge High School
- Ferrucci Junior High
- Sunrise Elementary

## November 5 (Region 3)

- Puyallup High School
- Aylen Junior High
- Waller Road Elementary

A promotional graphic for Patron Tours. It features a collage of photos showing people inside school buildings. The text "YOU'RE INVITED TO TOUR OUR SCHOOLS" is prominently displayed in a yellow banner. Below this, a smaller text says "Join us for an insider's look into our schools. Patron Tours also provide a sneak peek inside our central kitchen, EdTec, print shop, and warehouse." A central table lists the dates and schools for the tours. At the bottom, there is a "REGISTER ONLINE" link and a smaller QR code.

**YOU'RE INVITED TO TOUR OUR SCHOOLS**

Join us for an insider's look into our schools. Patron Tours also provide a sneak peek inside our central kitchen, EdTec, print shop, and warehouse.

**REGISTER FOR AN UPCOMING PATRON TOUR**

<b>OCTOBER 1</b> EMERALD RIDGE FERRUCCI SUNRISE	<b>NOVEMBER 5</b> PUYALLUP HS AYLEN WALLER ROAD	<b>DECEMBER 3</b> ROGERS HS STAHL CARSON
<b>JANUARY 7</b> PUYALLUP HS EDGEMONT NORTHWOOD	<b>FEBRUARY 4</b> EMERALD RIDGE GLACIER VIEW POPE	<b>MARCH 4</b> ROGERS HS BALLOU ZEIGER
<b>APRIL 1</b> WALKER HS KALLES STEWART	<b>MAY 6</b> ROGERS HS STAHL DESSIE EVANS	<b>JUNE 3</b> EMERALD RIDGE FERRUCCI RIDGECREST

**REGISTER ONLINE**  
[puyallupsd.org/patronstours](http://puyallupsd.org/patronstours)

# Closing Survey & Homework

Bond Advisory Committee  
Meeting Feedback Survey,  
Meeting 2, September 26



- Help us educate our community about Capital Projects and the work you're doing.
- **Follow and share: PSD Foundations for Our Future** on Facebook, Instagram, Twitter, and LinkedIn.

Next Meeting:

**Thursday, October 10**

5-7 p.m.

Karsher Center, 309 4<sup>th</sup> Street NE





# OUR TEAM



Dr. Vincent  
Pecchia

Asst. Supt  
Operations and  
School Support



Brady  
Martin

Director of  
Capital Projects



Brian  
Devereux

Director of  
Facilities  
Planning



**FOUNDATIONS**  
FOR OUR FUTURE

- +253-841-8641
- capitalprojects@puyallupsd.org
- energy@puyallupsd.org
- puyallupsd.org/capital
- 323 12th St. NW, Puyallup, WA 98371



**PUYALLUPSD.ORG/BAC**