

REFERENDUM NEWSLETTER



SHOREWOOD SCHOOL DISTRICT | MARCH 2019

Dear Shorewood Community,

Thank you for all you do to support the Shorewood School District. We are proud of all that we have achieved together, and our accomplishments are possible because of the curious students, engaged families, committed staff and supportive community who value public education. In Shorewood, this includes upholding the legacy of our District founders and preserving the many historic buildings that make up our school facilities and that are at the heart of our Village activities.

We invite you to review this special newsletter with information about the two referendum questions that will be on the April 2, 2019 ballot. This referendum is the result of more than three years of assessment and prioritizing work by the Board, with ongoing engagement from parents, students, staff and community members.

We acknowledge the significance of the investment the community is being asked to consider. The scope of the proposed plans reflects continuous feedback throughout the three-year process, as well as the results of the community-wide survey. The proposed plans provide a comprehensive solution that supports all students at all schools, as well as the larger community, and positions the District for continued success as we strive to prepare our students for success in all they do.

We ask that you consider the facts, attend one of the information sessions, review the facilities webpage at www.shorewood.k12.wi.us/referendum/ for much more information and, of course, contact us with any questions. We're committed to answering all of your questions. **And please, remember to vote on April 2!**

Sincerely,

Paru Shah, President

Hilary DeBlois,
Vice President

Pablo Muirhead,
Clerk

Joanne Lipo Zovic,
Treasurer

Lance Weinhardt,
Member at Large

WHAT'S INSIDE

- » Preliminary Plans
- » Two Ballot Questions
- » Tax Impact
- » Construction Schedule
- » Priorities & Projects
- » Why Now
- » Voting Information

EQUITY, GROWTH AND EXCELLENCE FOR ALL!



ATWATER ELEMENTARY // PRELIMINARY FLOOR PLANS

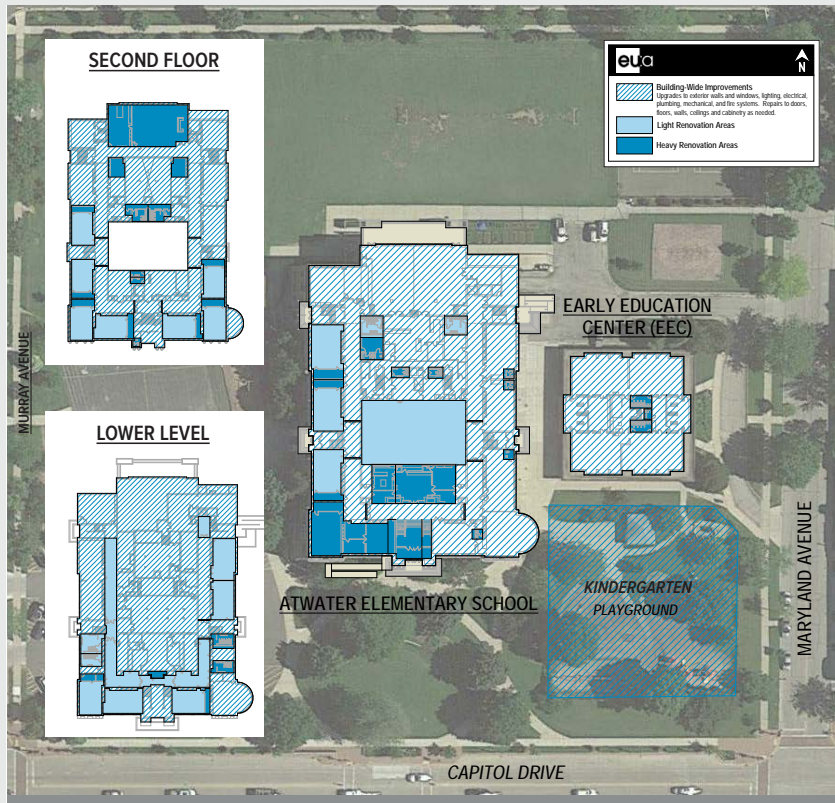

ATWATER PROJECT SCOPE

SAFETY & SECURITY

- Renovate/improve secure entrance; relocate office for improved security
- Replace exterior doors and locks for monitoring access (as needed)
- Fire alarm system upgrades
- Emergency lighting improvements

ADA ACCESSIBILITY

- Replace/repair existing exterior ramps, stairs, and sidewalks
- Create new ADA ramp at main entrance
- Renovate restrooms and create new student restrooms on 2nd floor *
- Floor modifications for better access (classrooms and gymnasium)
- Classroom door hardware modifications *

BUILDING SYSTEMS AND INFRASTRUCTURE

- Building systems upgrades (HVAC, electrical, plumbing) *
- Infrastructure upgrades (clocks, bells, wireless access)
- Window replacement *
- Refurbish/replace interior doors (as needed) *
- Partial roof replacement and exterior brick repair *
- Kitchen modifications
- Storm water and site-related improvements *
- Playground replacement *

LEARNING SPACES

- Refurbish ceilings and upgrade lighting to LED *
- Repair plaster walls and paint as needed *
- Renovate student support/resource spaces
- Renovate/expand library
- Casework replacement/repair/refurbishment *

* Improvements included at Atwater EEC Building

LAKE BLUFF ELEMENTARY // PRELIMINARY FLOOR PLANS

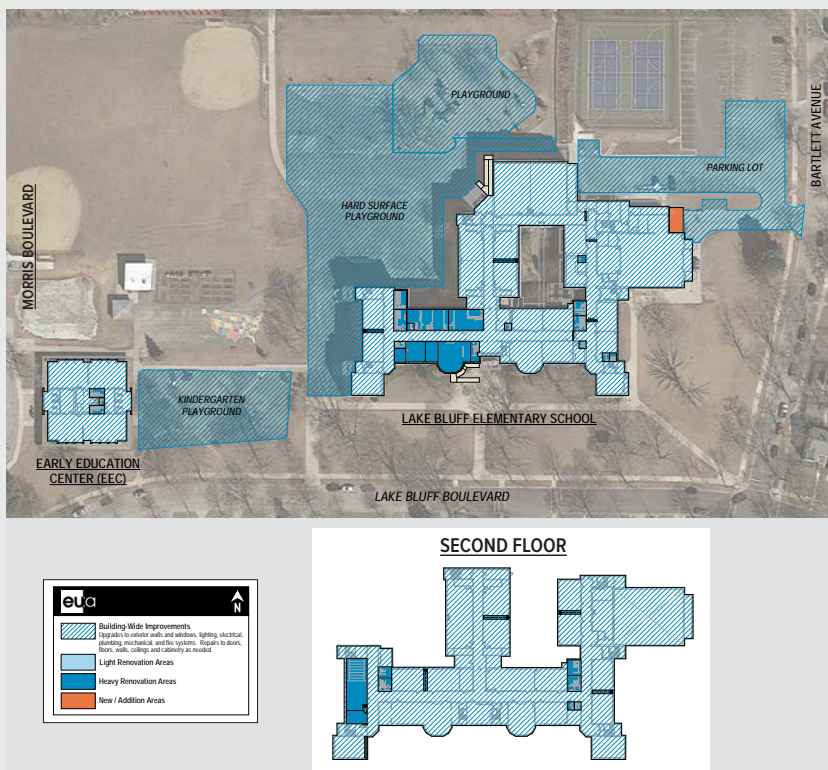

LAKE BLUFF PROJECT SCOPE

SAFETY & SECURITY

- Renovate/improve secure entrance; relocate office for improved security
- Replace exterior doors and locks for monitoring access (as needed)
- Fire alarm system upgrades
- Emergency lighting improvements

ADA ACCESSIBILITY

- Replace/repair existing exterior ramps, stairs, and sidewalks
- Create new ADA ramps at main entrance and for playground access
- Restroom renovations *
- Classroom door hardware modifications *

BUILDING SYSTEMS AND INFRASTRUCTURE

- Building systems upgrades (HVAC, electrical, plumbing) *
- Infrastructure upgrades (clocks, bells, wireless access)
- Window replacement *
- Refurbish/replace interior doors (as needed) *
- Partial roof replacement and exterior brick repair *
- Kitchen modifications and expansion
- Storm water and site-related improvements *
- Playground replacement *
- Asphalt replacement at hard-surface playground and a portion of main parking lot

LEARNING SPACES

- Refurbish ceilings and upgrade lighting to LED *
- Repair plaster walls and paint as needed *
- Renovate student support/resource spaces
- Casework replacement/repair/refurbishment *

* Improvements included at Lake Bluff EEC Building

SHOREWOOD HIGH // PRELIMINARY FLOOR PLANS

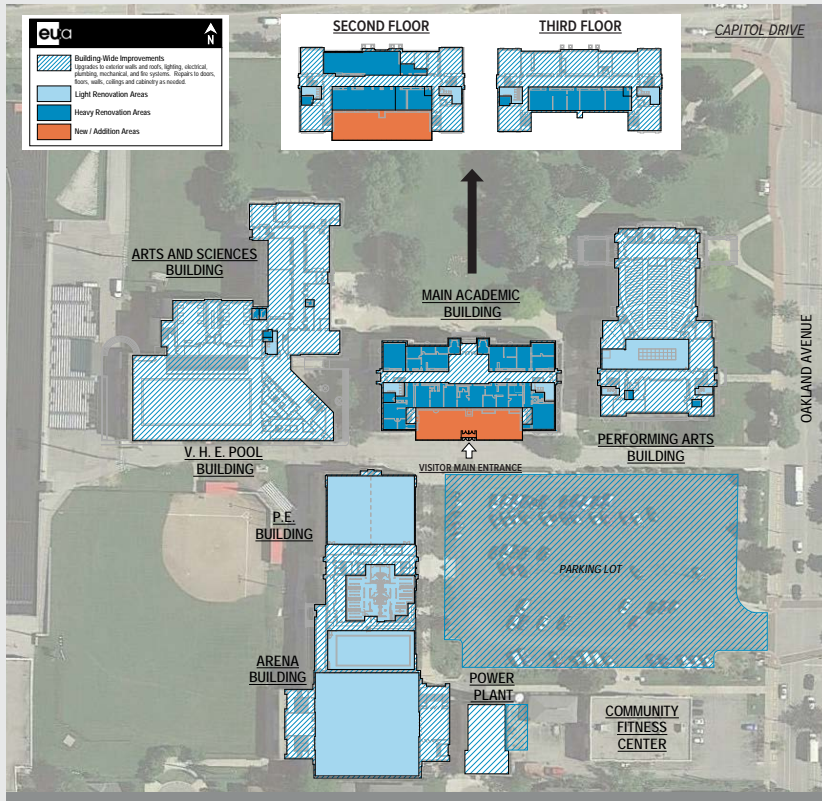

HIGH SCHOOL PROJECT SCOPE

SAFETY AND SECURITY

- Renovate/improve secure entrances; create main visitor entrance
- Replace exterior doors and locks for monitoring access (as needed)
- Emergency lighting improvements

ADA ACCESSIBILITY

- Replace/repair existing exterior ramps, stairs, and sidewalks
- Restroom renovations
- Classroom door hardware modifications

BUILDING SYSTEMS AND INFRASTRUCTURE

- Building systems upgrades (HVAC, electrical, plumbing)
- Infrastructure upgrades (clocks, bells, wireless access)
- Refurbish/replace interior doors (as needed)
- Kitchen modifications
- Partial roof repair and exterior brick repair
- Replace copper dome roofing
- Storm water and site-related improvements
- Asphalt replacement at main parking lot

LEARNING SPACES

- Refurbish ceilings and upgrade lighting to LED
- Repair plaster walls and paint as needed
- Renovate student support/resource spaces; expand student services
- Renovate/expand library
- Casework replacement/repair/refurbishment

SHOREWOOD INTERMEDIATE // PRELIMINARY FLOOR PLANS

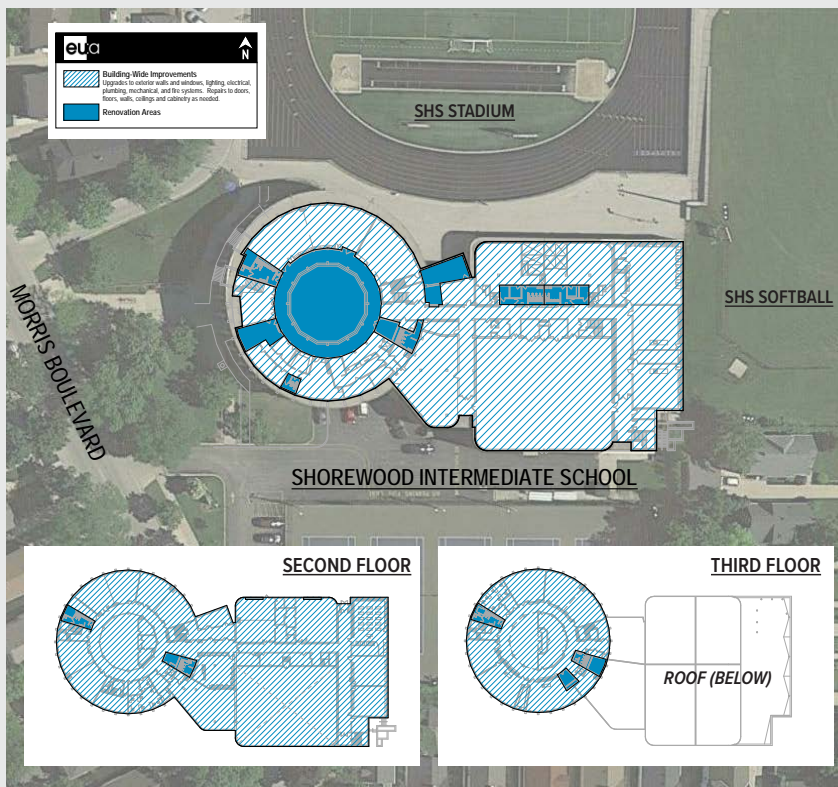

INTERMEDIATE PROJECT SCOPE

SAFETY & SECURITY

- Renovate/improve secure entrance
- Replace exterior doors and locks for monitoring access (as needed)
- Fire alarm system upgrades
- Emergency lighting improvements

ADA ACCESSIBILITY

- Restroom renovations
- Floor modifications for better access (cafeteria/commons)
- Classroom door hardware modifications

BUILDING SYSTEMS AND INFRASTRUCTURE

- Building systems upgrades (HVAC, electrical, plumbing)
- Infrastructure upgrades (clocks, bells, wireless access)
- Window replacement
- Refurbish/replace interior doors (as needed)
- Partial roof repair and exterior brick repair
- Storm water and site-related improvements
- Kitchen modifications

LEARNING SPACES

- Refurbish ceilings and upgrade lighting to LED
- Repair plaster walls and paint as needed
- Casework replacement/repair/refurbishment

TWO BALLOT QUESTIONS



- ✓ If both Questions 1 and 2 are approved, this would represent an estimated tax increase over the current level of \$31.00 per \$100,000 of fair market property value.

QUESTION 1: DISTRICT-WIDE FACILITIES PROJECTS

\$65M

\$65 million to address critical projects across the District, including safety, security, Americans with Disabilities Act (ADA) accessibility, building systems and infrastructure, targeted renovations to learning spaces at Lake Bluff and Atwater Elementary Schools, and a small expansion on the main academic building at Shorewood High School.

INCLUDED IN QUESTION 1

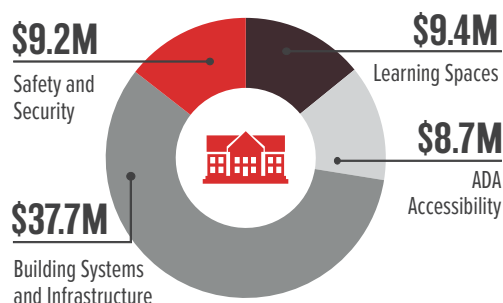

QUESTION 2: EXCEED REVENUE LIMIT

**\$275,000/
YR**

\$275,000 per year in ongoing funding for district-wide maintenance costs, beginning with the 2019-2020 school year. In addition to maintaining the improved and updated spaces included in the \$65M upgrades, ongoing annual costs include roof maintenance, asphalt and masonry repairs, and HVAC maintenance at all school campuses.

TAX INCREASE OVER CURRENT RATE

QUESTIONS 1 & 2 COMBINED

FAIR MARKET PROPERTY VALUE	PER YEAR
\$100,000	\$31.00
\$300,000	\$93.00
\$500,000	\$155.00

\$0.31 per \$1000 of fair market property value for both Questions 1 and 2. Factors: no estimated growth in Equalized Valuation (TID OUT) through 2025 and 0.50% thereafter; State aid impact of -33% (2018-19 tertiary reimbursement percentage) on incremental dollars spent above current spending level; assumes multi-phased borrowing within 5 years of approval, each at a 20-year amortization at 4.25%-4.50%. Preliminary financing plan is subject to change based on market conditions. Source: PMA Financial Advisors. Visit the district website to calculate estimated taxes: www.shorewood.k12.wi.us/referendum.

DESIGN AND CONSTRUCTION TIMELINES

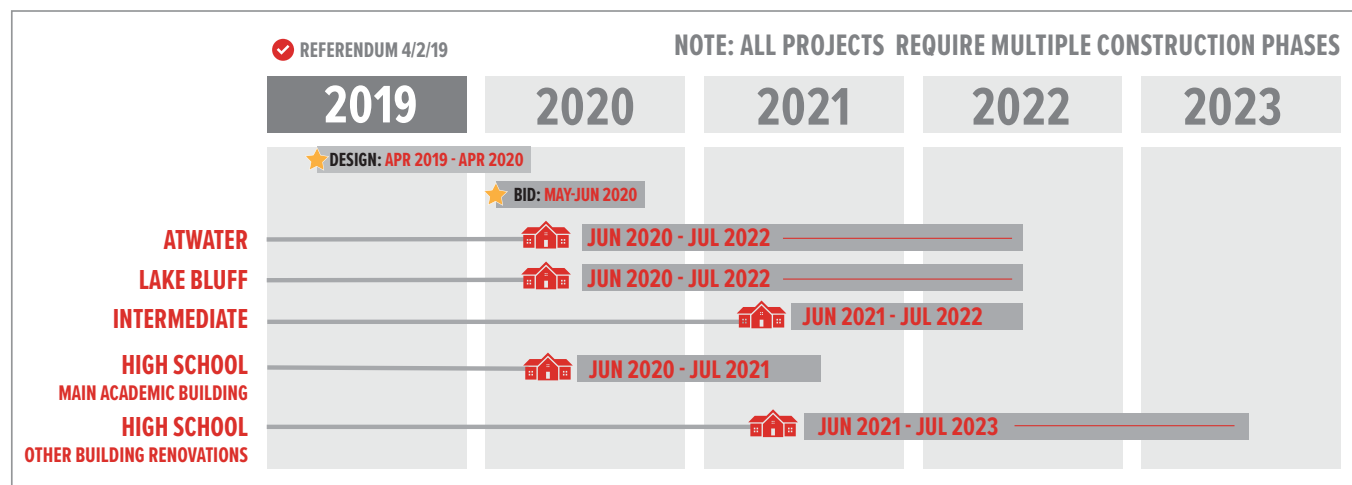

QUESTIONS? Interested in a presentation or tour? Please contact Dr. Bryan Davis, Superintendent, at bdavis@shorewood.k12.wi.us or 414-963-6900.

KEY PRIORITIES



All Students, All Schools

The proposed referendum plan impacts infrastructure and learning spaces at each of our four school campuses, three of which are 90+ years old.



Responsible Planning

The proposed plan stewards Shorewood School District's beautiful, historic buildings that require significant care, infrastructure renewal and safety improvements.



Safety and Accessibility

The proposed plan provides secure entrances, improved building accessibility and functionality, and other improvements to meet Americans with Disabilities Act (ADA).



Community Driven

The proposed plan reflects extensive input from staff workshops, community engagement and a district-wide community survey.

WHY NOW?

The Board of Education developed the proposed plan over the past several years with extensive community and staff input. The multi-year process involved a community summit, community-wide surveys, more than a dozen staff and community workshops, and ongoing input from design and construction experts, resulting in a plan that reflects community priorities. Effective instruction and authentic learning opportunities for students will be supported through the learning space improvements in the facilities referendum plan.

SURVEY SAYS

2018 Community Survey Results:

69%

of all residents who responded would likely support a \$275,000 operational referendum

58%

of all residents who responded would likely support school improvement projects up to \$65 million

Three of our four school campuses are 90+ years old!



Atwater Elementary



Lake Bluff Elementary



Shorewood Intermediate



Shorewood High School

**ALL STUDENTS
ALL SCHOOLS**

SHOREWOOD SCHOOL DISTRICT REFERENDUM



Shorewood

SCHOOL DISTRICT

1701 E. Capitol Dr.

Shorewood, WI 53211

414-963-6900

GET THE FACTS

[www.shorewood.k12.wi.us/
referendum/](http://www.shorewood.k12.wi.us/referendum/)



35+ FAQs



**Calculate Estimated
Tax Increase**



Voting Information

ELECTION DAY: APRIL 2, 2019

To determine your voter status, register to vote, request an absentee ballot, find your polling location, and view sample ballots, please visit the My Vote Wisconsin website at <https://myvote.wi.gov/>. View the Shorewood Voters Ward Map (PDF) on the District website.



Voting Locations and Hours:

Wards 1-4

Library/Village Center
3920 N. Murray Ave.

Wards 5-8

Shorewood High School
1701 E. Capitol Drive

Wards 9-2

North Shore Presbyterian Church
4048 N. Bartlett Avenue

**VILLAGE OF SHOREWOOD
POLLS OPEN**

7:00a.m. - 8:00p.m.

OFFICIAL BALLOT LANGUAGE



Question #1 - \$65M for District-Wide Facility Projects:

Shall the School District of Shorewood, Milwaukee County, Wisconsin, be authorized to issue pursuant to Chapter 67 of the Wisconsin Statutes, general obligation bonds in an amount not to exceed \$65,000,000 for the public purpose of paying the cost of a District-wide facility improvement program consisting of: infrastructure and building systems projects at all four schools, including improved safety and security, and ADA accessibility upgrades; renovations, expansion and updates of instructional areas at the High School Main Academic Building; targeted renovations at Lake Bluff and Atwater Elementary Schools; and the acquisition of related equipment?

☐ YES

☐ NO

Question #2 - \$275,000 Recurring Revenue Limit Extension:

Shall the School District of Shorewood, Milwaukee County, Wisconsin, be authorized to exceed the revenue limit specified in Section 121.91, Wisconsin Statutes, by \$275,000 beginning with the 2019-2020 school year, for recurring purposes consisting of ongoing District-wide facility maintenance costs?

☐ YES

☐ NO