

Promethean *pro tip* connect YOUR windows computer wirelessly ActivPanel®

GET A Windows 10 or 11 device? You can connect to your ActivPanel wirelessly, using the native Wi-Fi Direct



You may wish to adjust the resolution on your device for a better picture.

1 OPEN THE Screen Share app on the ActivPanel

2 ON THE computer, press the Windows key + K



3 SELECT the ActivPanel to connect

Check here for touchback!

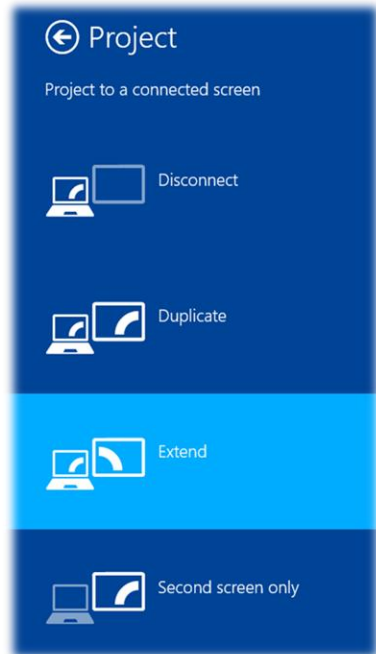

Tip: "Change Projection Mode" On your laptop, allows you to share your screen a number of ways:

Duplicate: This mode duplicates the video output from the primary display onto a second display, which can be ideal for presentations.

Extend: This mode extends the desktop across as many displays as you have connected. It stitches them all into one large virtual desktop, and you can move windows between them.

Second screen only: This mode only shows video on the second display, while the primary display remains blank and unused.