

MEASURE BB BOND: BID BUNDLE #6:
21st Century Classroom Improvements
Phase B
Four Sites

Baldwin Academy
California Elementary School
Grazide Elementary School
Los Molinos Elementary School

HACIENDA LA PUENTE UNIFIED SCHOOL DISTRICT

District Administrative Offices
15959 East Gale Avenue
City of Industry, Ca 91716

CUMMING MANAGEMENT.

120 Vantis, Suite 510
Aliso Viejo, CA 92656
Phone: (949) 392-9727

BN: 2024-25.01

Date: September 13, 2024

Addendum No. 02

THE FOLLOWING CORRECTIONS, MODIFICATIONS, OR ADDITIONS SHALL BE INCLUDED IN THE DRAWINGS, SPECIFICATIONS, AND OTHER CONTRACT DOCUMENTS AND SHALL BE TAKEN INTO CONSIDERATION BY CONTRACTORS IN SUBMITTING BIDS ON THE ABOVE-NAMED PROJECT.

GENERAL

GENERAL REQUIREMENTS:

Add the following 2 documents to "Section 11, District CWA and Amendment No. 1" of the pdf file "BID AND CONTRACT DOCS":

1. Continuity of Work Agreement ("CWA") (Exhibit A)
2. Amendment No. 1 to the Continuity of Work Agreement (Exhibit B)

Baldwin Academy

1. Replace "Phasing Plan - Balwin" with "Phasing Plan_Balwin_24-0912 (Exhibit C)." Duration of each phase has been added.

California Elementary School

1. Replace "Phasing Plan - California" with "Phasing Plan_California_24-0912 (Exhibit D)." Duration of each phase has been added.

Grazide Elementary School

1. Replace "Phasing Plan - Grazide" with "Phasing Plan_Grazide_24-0912 (Exhibit E)." Duration of each phase has been added.

Los Molinos Elementary School

1. Replace "Phasing Plan - Los Molinos" with "Phasing Plan_Los Molinos_24-0912 (Exhibit F)." Duration of each phase has been added.

ATTACHMENTS (Attached on the following pages)

- Exhibit A: Continuity of Work Agreement**
- Exhibit B: Amendment 1 to Continuity of Work Agreement**
- Exhibit C: Phasing Plan_Baldwin_24-0912**
- Exhibit D: Phasing Plan_California_24-0912**
- Exhibit E: Phasing Plan_Grazide_24-0912**
- Exhibit F: Phasing Plan_Los Molinos_24-0912**

END OF ADDENDUM

EXHIBIT A

CONTINUITY OF WORK AGREEMENT

BY AND AMONG

THE HACIENDA LA PUENTE UNIFIED SCHOOL DISTRICT

AND

LOS ANGELES AND ORANGE COUNTIES
BUILDING AND CONSTRUCTION TRADES COUNCIL

AND

THE SIGNATORY CRAFT COUNCILS AND UNIONS

TABLE OF CONTENTS		Page
ARTICLE 1	INTENT AND PURPOSE; DEFINITIONS.....	2
ARTICLE 2	SCOPE OF THE AGREEMENT.....	4
ARTICLE 3	UNION RECOGNITION AND EMPLOYMENT.....	8
ARTICLE 4	UNION ACCESS AND STEWARDS.....	12
ARTICLE 5	WAGES AND BENEFITS	13
ARTICLE 6	HOURS OF WORK, OVERTIME, SHIFTS AND HOLIDAYS.....	15
ARTICLE 7	WORK STOPPAGES AND LOCKOUTS	16
ARTICLE 8	WORK ASSIGNMENTS AND JURISDICTIONAL DISPUTES	20
ARTICLE 9	MANAGEMENT RIGHTS	21
ARTICLE 10	SETTLEMENT OF GRIEVANCES AND DISPUTES	23
ARTICLE 11	REGULATORY COMPLIANCE	25
ARTICLE 12	SAFETY AND PROTECTION OF PERSON AND PROPERTY.....	26
ARTICLE 13	TRAVEL AND SUBSISTENCE.....	27
ARTICLE 14	APPRENTICES.....	27
ARTICLE 15	WORKING CONDITIONS.....	28
ARTICLE 16	PRE-JOB CONFERENCES.....	29
ARTICLE 17	LABOR/MANAGEMENT COOPERATION.....	29
ARTICLE 18	SAVINGS AND SEPARABILITY.....	30
ARTICLE 19	WAIVER.....	30
ARTICLE 20	AMENDMENTS.....	30
ARTICLE 21	DURATION OF THE AGREEMENT.....	31
ATTACHMENT A – LETTER OF ASSENT		
ATTACHMENT B – PROJECTS		
ATTACHMENT C – CRAFT EMPLOYEE REQUEST FORM		
ATTACHMENT D – LIST OF NEUTRAL ARBITRATORS		

**HACIENDA LA PUENTE UNIFIED SCHOOL DISTRICT
CONTINUITY OF WORK AGREEMENT**

This Continuity of Work Agreement (hereinafter, "Agreement") is entered into this _____ day of _____, 2013 by and among the Board of Education of the Hacienda La Puente Unified School District (the "District"), the Los Angeles/Orange Counties Building and Construction Trades Council (the "Council"), and the signatory Craft Councils and Unions signing this Agreement (hereinafter together with the Council, collectively, the "Union" or "Unions"). This Agreement establishes the labor relations guidelines and procedures for the District and for the Contractors and craft employees represented by the Unions and engaged in Project Work. The District, Council and Unions are hereinafter referred to herein, as the context may require, as "Party" or "Parties."

It is understood by the Parties to this Agreement that if this Agreement is acceptable to the District, it will become the policy of the District for the Project Work to be contracted exclusively to Contractors who agree to execute and be bound by the terms of this Agreement, directly or through the Letter of Assent (a form of which is attached as "*Attachment A*"), and to require each of its subcontractors, of whatever tier, to become bound. The District shall include, directly or by incorporation by reference, the requirements of this Agreement in the advertisement of and/or specifications for each and every contract for Project Work to be awarded by the District.

It is further understood that the District shall actively administer and enforce the obligations of this Agreement to ensure that the benefits envisioned from it flow to all signatory Parties, the Contractors and crafts persons working under it, and the residents and students of the District. The District shall therefore designate a "Project Labor Coordinator," either from its own staff or an independent contractor acting on behalf of the District, to monitor compliance with this Agreement; assist, as the authorized representative of the District, in developing and implementing the programs referenced herein, all of which are critical to fulfilling the intent and purposes of the Parties and this Agreement; and to otherwise implement and administer this Agreement. For such purposes, each Contractor recognizes and appoints the Project Labor Coordinator, its successors or assigns, as its agent; and together with District and the Unions, the Project Labor Coordinator shall be considered a "negotiating party" of this Agreement.

The Union and all Contractors agree to abide by the terms and conditions of this Agreement and agree that this Agreement represents the complete understanding of the Parties. No Contractor is or will be required to sign or otherwise become a party to any other collective bargaining agreement with a signatory Union as a condition of performing work within the scope of this Agreement.

The Parties agree that this Agreement will be made available to, and will fully apply to, any successful bidder for Project Work, without regard to whether that successful bidder performs work at other District sites on either a union or non-union basis. This Agreement shall not apply to any work of any Contractor other than that on Project Work specifically covered by this Agreement.

The use of masculine or feminine gender or titles in this Agreement should be construed as including both genders and not as gender limitations unless the Agreement clearly requires a different construction. Further, the use of Article titles and/or Section headings are for information only, and carry no legal significance.

ARTICLE 1 INTENT AND PURPOSE; DEFINITIONS

Section 1.1 Background. The goal of the Board of Education is to continue to improve and rehabilitate the District's facilities so as to provide sufficient facilities and technologies to properly educate the children within the District's boundaries. The District's repair, upgrade, renovation, rehabilitation, improvement work and new construction projects described on *Attachment B* to this Agreement in furtherance of the District's goals and policies with respect to its facilities. The District, therefore, wishing to utilize the most modern, efficient and effective procedures for construction, including assurances of a sufficient supply of skilled craft persons, and the elimination of disruptions or interference with Project Work, adopts this Agreement in the best interests of the students, parents, District staff, and the taxpayers of the District to meet the District's goal that the Project Work be completed on time and within budget.

Section 1.2 Definitions. The following terms shall have the following meanings when used herein:

1.2.1 "Apprentice" means those employees registered and participating in Joint Labor/Management Apprenticeship Programs approved by the Division of Apprenticeship Standards, Department of Industrial Relations of the State of California.

1.2.2 "Contractor" means any individual, firm, partnership, or corporation, or combination thereof, including joint ventures, which as an independent Contractor has entered into a contract with the District with respect to the Project Work, or a subcontractor of whatever tier utilized by a Contractor for Project Work.

1.2.3 "District" means the Hacienda La Puente Unified School District.

1.2.4 "Joint Labor/Management Apprenticeship Program" means a joint Union and Contractor administered apprenticeship program certified by the Division of Apprenticeship Standards, Department of Industrial Relations of the State of California.

1.2.5 "Letter of Assent" means the document, in the form attached hereto as *Attachment A*, that each Contractor (of any tier) must sign and submit to the Project Labor Coordinator and the Council, before beginning any Project Work, which formally binds them to adherence to all the forms, requirements and conditions of this Agreement.

1.2.6 "Project" or "Projects" or "Project Work" means the District's repair, renovation, rehabilitation, upgrade and improvement projects listed and described on *Attachment B* to this Agreement, as may be hereafter amended by the District.

1.2.7 "Schedule A Agreement" means the local collective bargaining agreements of the signatory Unions having jurisdiction over the Project Work and which have signed this

Agreement, as such Schedule A Agreement(s) may be changed from time-to-time and which are incorporated herein by reference.

1.2.8 "Subscription Agreement" means the contract between a Contractor and a Union's Labor/Management Trust Fund(s) that allows the Contractor to make the appropriate fringe benefit contributions in accordance with the terms of Schedule A Agreement.

Section 1.1 Identification and Retention of Skilled Labor and Employment of District Resident. The work on the Projects is anticipated to require large numbers of craft personnel and other supporting workers. It is therefore the explicit understanding and intention of the Parties to this Agreement to use the opportunities provided by the extensive amount of work to be covered by this Agreement to identify and promote, through cooperative efforts, programs and procedures (which may include, for example, programs to prepare persons for entrance into formal apprenticeship programs, or outreach programs to the community describing opportunities available as a result of the Project Work), the interest and involvement of District residents in the construction industry; assist them in entering the construction trades, and through utilization of the joint labor/management sponsored apprenticeship programs, provide training opportunities for those District residents and other individuals wishing to pursue a career in construction. Further, with assistance of the Project Labor Coordinator, the District, the Contractors, the Unions and their affiliated regional and national organizations, will work jointly to promptly develop and implement procedures for the identification of craft needs, the scheduling of work to facilitate the utilization of available craft workers, and the securing of services of craft workers in sufficient numbers to meet the high demands of the Project Work to be undertaken.

Section 1.2 Encouragement of Small Local Business. The Project Work will provide many opportunities for local small business enterprises to participate as Contractors or suppliers, and the Parties therefore agree that they will cooperate with all efforts of the District, the Project Labor Coordinator, and other organizations retained by the District for the purpose, to encourage and assist the participation of local small businesses in Project Work. Each Party agrees that it shall employ demonstrable efforts to encourage utilization in an effort to achieve such goals. This may include, for example, participation in outreach programs, education and assistance to businesses not familiar with working on a project of this scope, and the encouragement of local residents to participate in Project Work through programs and procedures jointly developed to prepare and encourage such local residents for apprenticeship programs and formal employment on the Project Work through the referral programs sponsored and/or supported by the Parties to this Agreement. Further, the Parties shall ensure that the provisions of this Agreement do not inadvertently establish impediments to participation of such small local businesses and residents of the District.

Section 1.3 Project Cooperation. The Parties recognize that the construction to take place under this Agreement involves unique and special circumstances which dictate the need for the Parties to develop specific procedures to promote high quality, rapid and uninterrupted construction methods and practices. The smooth operation and successful and timely completion of the Project Work is vitally important to the parents and the students of the District. The Parties therefore agree that maximum cooperation among all Parties involved is required; and that with construction work of this magnitude, with multiple Contractors and crafts performing work on multiple sites of over an extended period of time, it is essential that all Parties work in a spirit of

harmony and cooperation, and with an overriding commitment to maintain the continuity of Project Work. Further, the Parties recognize that an Act of God or an Act of War could require the District to partially or fully suspend Project Work. The Parties shall fully cooperate with any request by the District to redirect their equipment, skills and expertise to support the District's efforts necessitated by such events.

Section 1.4 Workers' Compensation Carve-out. Further, the Parties recognize the potential which the Project Work may provide for the implementation of a cost effective workers' compensation system, as permitted by revised California Labor Code Section 3201.5, and it is understood that the District is in an ongoing review of the value of such a program. Should the District request, the Union parties agree to meet and negotiate in good faith with representatives of the District for the development, and subsequent implementation, of an effective program involving improved and revised dispute resolution and medical care procedures for the delivery of workers' compensation benefits and medical coverage as permitted by the California Labor Code.

Section 1.5 Peaceful Resolution of Disputes. In recognition of the special needs of the Project Work and to maintain a spirit of harmony, labor-management peace and stability during the term of this Continuity of Work Agreement, the Parties agree to establish effective and binding methods for the settlement of all misunderstandings, disputes and grievances; and in recognition of such methods and procedures, the Unions agree not to engage in any strike, slowdowns or interruptions or disruption of Project Work, and the Contractors agree not to engage in any lockout.

Section 1.6 Binding Agreement of the Parties and Inclusion of District Residents and Businesses. By executing this Agreement, the District, Council, Unions and Contractors agree to be bound by each and all of the provisions of this Agreement, and pledge that they will work together to adopt, develop and implement processes and procedures which are inclusive of the residents and businesses of the District.

ARTICLE 2 SCOPE OF THE AGREEMENT

Section 2.1 General. This Agreement shall apply and is limited to all of the District's Project Work, as specified in Section 2.2 of this Article, performed by those Contractor(s) of whatever tier that have contracts awarded for such work, for the development of the District's facilities which, jointly, constitute the Project, and have been designated by the District for construction or rehabilitation.

Section 2.2 Specific. The work covered by this Agreement is defined as and limited to the work, authorized during the Term hereof, on Projects listed on **Attachment B** hereto, as may be hereafter amended by the District.

It is understood by the Parties that the District may at any time, and at its sole discretion, determine to build portions of the Projects under this Agreement which were not currently proposed, or to modify or not to build any one or more particular portions proposed to be covered.

Section 2.3 Bundling of Contracts. The Parties agree that, to the maximum extent feasible, and consistent with goals of the District to (i) utilize this Agreement as the labor relations Policy for the Projects, and (ii) fully utilize the services of local small business enterprises for work on the Projects:

(a) The District, in its sole discretion, with the advice of the Project Labor Coordinator, will seek to group (or "bundle") for bidding, contracts not meeting the thresholds of Section 2.2 (a) above. This provision applies to small contracts for like types of work, scheduled to be undertaken at the same school or project site, and within the same timeframe, will be considered for such bundling, consistent with economies of scale, and the purposes of this Agreement; and

(b) Project Work will not be split, divided or otherwise separated for contract award purposes to avoid application of this Agreement.

Section 2.4 Exclusions. Items specifically excluded from the Scope of this Agreement include the following:

(a) Work of non-manual employees, including but not limited to: superintendents; teachers; supervisors; staff engineers; time keepers, mail carriers, clerks, office workers, messengers; guards, safety personnel, emergency medical and first aid technicians; and other professional, engineering, administrative, supervisory and management employees;

(b) Equipment and machinery owned or controlled and operated by the District;

(c) All off-site manufacture and handling of materials, equipment or machinery; provided, however, that lay down or storage areas for equipment or material and manufacturing (prefabrication) sites, dedicated solely to the Project or Project Work, and the movement of materials or goods between locations on a Project site are within the scope of this Agreement;

(d) All employees of the District, Project Labor Coordinator, design teams (including, but not limited to architects engineers and master planners), or any other consultants for the District (including, but not limited to, project managers and construction managers and their employees were not engaged in Project Work) and their sub-consultants, and other employees of professional service organizations, not performing manual labor within the scope of this Agreement; provided, however, that it is understood and agreed that Building/Construction Inspector and Field Soils and Materials Testers (Inspectors) are a covered craft under the PLA. (This inclusion applies to the scope of work defined in the State of California Wage Determination for said Craft. This shall also specifically include such work where it is referred to by utilization of such terms as "quality control" or "quality assurance." Every Inspector performing under the Wage classification of Building/Construction Inspector and Field Soils and Material Testers under a professional services agreement of a construction contract shall be bound to all applicable requirements of the PLA.) Covered Work as defined by this Agreement shall be performed pursuant to the terms and conditions of this Agreement regardless of the manner in which the work was awarded;

(e) Any work undertaken by state, county, city or other governmental bodies, or their contractors; or by public utilities, or their contractors; and/or by the District or its contractors (for work for which is not within the scope of this Agreement):

(f) Off-site maintenance of leased equipment and on-site supervision of such work:

(g) Work by employees of a manufacturer or vendor necessary to maintain such manufacturer's or vendor's warranties or guaranty. It is recognized that certain materials, equipment and systems of a highly technical and specialized nature will have to be installed at the Project. The nature of the materials, equipment and systems, together with requirements of manufacturer's or vendor's warranty, may dictate that it be prefabricated, pre-piped, and/or pre-wired and that it be installed under the supervision and direction of Owner's and/or manufacturer's personnel. The Unions agree to install such material, equipment and systems without incident:

(h) Non-construction support services contracted by the District, Project Labor Coordinator, or Contractor in connection with this Project; and

(i) Laboratory work for testing.

Section 2.5 Awarding of Contracts.

(a) The District and/or the Contractors, as appropriate, have the absolute right to award contracts or subcontracts on this Project to any Contractor notwithstanding the existence or non-existence of any agreements between such Contractor and any Union parties, provided only that such Contractor is willing, ready and able to execute and comply with this Continuity of Work Agreement should such Contractor be awarded work covered by this Agreement.

(b) It is agreed that all Contractors and subcontractors of whatever tier, who have been awarded contracts for work covered by this Agreement, shall be required to accept and be bound to the terms and conditions of this Agreement, and shall evidence their acceptance by the execution of the Letter of Assent as set forth in *Attachment A* hereto, prior to the commencement of any Project Work. At the time that any Contractor enters into a subcontract with any subcontractor of any tier providing for the performance on the construction contract, the Contractor shall provide a copy of this Agreement to said subcontractor and shall require the subcontractor, as a part of accepting the award of a construction subcontract, to agree in writing in the form of a Letter of Assent to be bound by each and every provision of this Agreement prior to the commencement of work on the Project. No Contractor or subcontractor shall commence Project Work without having first provided a copy of the Letter of Assent as executed by it to the Project Labor Coordinator and to the Council forty-eight (48) hours before the commencement of Project Work, or within forty-eight (48) hours after the award of Project Work to that Contractor (or subcontractor), whichever occurs later. Further, Contractors not signatory to the established Joint Labor/Management Trust Fund Agreements, as described in the Schedule A Agreement for the craft workers in their employ, shall sign a "Subscription Agreement" with the appropriate Joint Labor/Management Trust Funds covering the work performed under this Agreement before work is commenced on the Project.

(c) The District agrees that to the extent permitted by law and consistent with the economy and efficiency of construction and operation, it will use its best efforts to purchase materials, equipment and supplies which will not create labor strife. Under all circumstances, however, the District shall retain the absolute right to select the lowest reliable and responsible bidder for the award of contracts on all projects.

Section 2.6 Coverage Exception. This Agreement shall not apply if the District receives funding or assistance from any Federal, State, local or other public entity for the Construction Contract if a requirement, condition or other term of receiving that funding or assistance, at the time of the awarding of the contract, is the District not require, bidders, contractors, subcontractors or other persons or entities to enter into an agreement with one or more labor organizations or enter into an agreement that contains any of the terms set forth herein. The District agrees that it will make every effort to establish the enforcement of this Agreement with any governmental agency or granting authority.

Section 2.7 Schedule A Agreements.

(a) The provisions of this Agreement, including the Schedule A Agreements, shall apply to the work covered by this Agreement, notwithstanding the provisions of any other local, area and/or national agreement which may conflict with or differ from the terms of this Agreement. However, such does not apply to work performed under the National Cooling Tower Agreement, the National Stack Agreement, the National Transit Division Agreement (NTD), or within the jurisdiction of the International Union of Elevator Constructors and all instrument calibration and loop checking work performed under the terms of the UA/IBEW Joint National Agreement for Instrument and Control Systems Technicians, except that Articles dealing with Work Stoppages and Lock-Outs, Work Assignments and Jurisdictional Disputes, and Settlement of Grievances and Disputes shall apply to such work. It is specifically agreed that no later agreement shall be deemed to have precedence over this Agreement unless signed by all Parties signatory hereto who are then currently employed or represented at the Project. Where a subject covered by the provisions of this Agreement is also covered by a Schedule A, the provisions of this Agreement shall apply. Where a subject is covered by a provision of a Schedule A and not covered by this Agreement, the provisions of the Schedule A shall prevail. Any dispute as to the applicable source between this Agreement and any Schedule A for determining the wages, hours of working conditions of employees on this Project shall be resolved under the procedures established in Article 10.

(b) It is understood that this Agreement, together with the referenced Schedule A Agreements, constitutes a self-contained, stand-alone agreement and by virtue of having become bound to this Continuity of Work Agreement, the Contractor will not be obligated to sign any other local, area or national collective bargaining agreement as a condition of performing work within the scope of this Agreement (provided, however, that the Contractor may be required to sign an uniformly applied, non-discriminatory Participation Agreement at the request of the trustees or administrator of a trust fund established pursuant to Section 302 of the Labor Management Relations Act, and to which such Contractor is bound to make contributions under this Agreement, provided that such Participation Agreement does not purport to bind the Contractor beyond the terms and conditions of this Agreement and/or expand its obligation to make contributions pursuant thereto). It shall be the responsibility of the prime Contractor to

have each of its subcontractors sign the documents with the appropriate Craft Union prior to the subcontractor beginning Project Work.

Section 2.8 Binding Signatories Only. This Agreement shall only be binding on the signatory Parties hereto, and shall not apply to the parents, affiliates, subsidiaries, or other ventures of any such Party.

Section 2.9 Other District Work. This Agreement shall be limited to the construction work within the Scope of this Agreement including, specifically, site preparation and related demolition, major rehabilitation, new construction and other work on the Projects referenced in Section 2.2 above. Nothing contained herein shall be interpreted to prohibit, restrict, or interfere with the performance of any other operation, work or function not covered by this Agreement, which may be performed by District Employees or contracted for by the District for its own account, on its property or in and around a Project site.

Section 2.10 Separate Liability. It is understood that the liability of the Contractor(s) and the liability of the separate Unions under this Agreement shall be several and not joint. The Unions agree that this Agreement does not have the effect of creating any joint employment status between or among the District or Project Labor Coordinator and/or any Contractor.

Section 2.11 Completed Project Work. As areas of covered work are accepted by the District, this Agreement shall have no further force or effect on such items or areas except where the Contractor is directed by the District or its representatives to engage in repairs, modification, check-out and/or warranties functions required by its contract(s) with the District.

ARTICLE 3 UNION RECOGNITION AND EMPLOYMENT

Section 3.1 Recognition. The Contractor recognizes the Council and the signatory local Unions as the exclusive bargaining representative for the employees engaged in Project Work.

Section 3.2 Contractor Selection of Employees. The Contractor shall have the right to determine the competency of all employees, the number of employees required, the duties of such employees within their craft jurisdiction, and shall have the sole responsibility for selecting employees to be laid off, consistent with Section 3.3 and Section 4.3, below. The Contractor shall also have the right to reject any applicant referred by a Union for any reason, subject to any reporting pay required by Section 6.6; provided, however, that such right is exercised in good faith and not for the purpose of avoiding the Contractor's commitment to employ qualified workers through the procedures endorsed in this Agreement.

Section 3.3 Referral Procedures.

(a) For signatory Unions now having a job referral system contained in a Schedule A, the Contractor agrees to comply with such system and it shall be used exclusively by such Contractor, except as modified by this Agreement. Such job referral system will be operated in a nondiscriminatory manner and in full compliance with federal, state, and local laws and regulations which require equal employment opportunities and non-discrimination. All of the foregoing hiring procedures, including related practices affecting apprenticeship, shall be

operated so as to consider the goals of the District to encourage employment of District residents and utilization of small local businesses on the Project, and to facilitate the ability of all Contractors to meet their employment needs.

The local Unions will exert their best efforts to recruit and refer sufficient numbers of skilled craft workers to fulfill the labor requirements of the Contractor, including specific employment obligations to which the Contractor may be legally and/or contractually obligated; and to refer apprentices as requested to develop a larger, skilled workforce. The local Unions will work with their affiliated regional and national unions, and jointly with the Project Labor Coordinator and others designated by the District, to identify and refer competent craft persons as needed for Project Work, and to identify and hire individuals, particularly residents of the District, for entrance into joint labor/management apprenticeship programs, or to participation in other identified programs and procedures to assist individuals in qualifying and becoming eligible for such apprenticeship programs, all maintained to increase the available supply of skilled craft personnel for Project Work and future construction of maintenance work to be undertaken by the District.

(b) The Union shall not knowingly refer an employee currently employed by a Contractor on Project Work to any other Contractor.

(c) The Parties are aware of the District's policy that Contractors and other employers shall not employ, on Project Work when minors may be present on or around the site of such Project Work during working hours, a person who would not be eligible for employment by the District under California Educational Code Section 45123. The Parties shall endeavor to employ persons under this Article in compliance with this policy, and the Contractors agree to remove such an individual in their employ from the particular Project site at the request of the District or the Project Labor Coordinator.

Section 3.4 Non-Discrimination in Referral, Employment, and Contracting. The Unions and Contractors agree that they will not discriminate against any employee or applicant for employment in hiring and dispatching on the basis of race, color, religion, sex, gender, national origin, age, membership in a labor organization, sexual orientation, political affiliation, marital status or disability. Further, it is recognized that the District has certain policies, programs, and goals for the utilization of local small business enterprises. The Parties shall jointly endeavor to assure that these commitments are fully met, and that any provisions of this Agreement which may appear to interfere within a local small business enterprises successfully bidding for work within the scope of this Agreement shall be carefully reviewed, and adjustments made as may be appropriate and agreed upon among the Parties, to ensure full compliance with the spirit and letter of the District's policies and commitment to its goals for the significant utilization of local small businesses as direct Contractors or suppliers Project Work.

Section 3.5 Employment of District Residents.

(a) In recognition of the District's mission to serve the residents residing within the zip codes within the District's geographic area ("Local Residents"), the Unions and Contractors will exert their best efforts, to the extent allowed by law, to refer and/or recruit sufficient numbers of skilled craft Local Residents to fulfill the requirements of the Employers performing Project Work first from qualified employees who are District residents. If the 30%

local hire goal is not attained utilizing Local Residents, the outreach shall expand to qualified employees who reside within the zip codes covering the territorial boundaries of any city bordering on the geographical area which makes up the District. If 30% local hire is still not attained utilizing these Local Residents, the outreach shall expand to other qualified employees whose names appear on the signatory Unions' out of work list. For purposes of this Agreement, Local Residents shall include persons residing within those U.S. Postal Service zip codes whose territorial boundaries overlap with the territorial boundaries of the District, which, as of the date of this Agreement include **91744, 91745, 91746, 91748, 91790 and 91792**. In the event any or all of the foregoing zip codes cease to include territory lying within the territorial boundaries of the District, such zip codes shall be excluded from the range of eligible zip codes. Conversely, if any new zip codes are created whose territory overlaps with the territory of the District, such zip codes shall be included within the list of eligible zip codes.

(b) A goal of 30% of all of the labor and craft positions shall be from workers residing within the District area described in (a) above. To facilitate the dispatch of local residents, all Contractors will be required to utilize the Craft Employee Request Form whenever they are requesting the referral of any employee from a Union referral list for any Covered Project, a sample of which is attached as *Attachment C*.

(c) The Project Labor Coordinator shall work with the Unions and Contractors in the administration of this local residency preference; and the Contractors and Unions shall cooperate by maintaining adequate records to demonstrate to the Project Labor Coordinator that such preferences have been pursued. As part of this process, and in order to facilitate the contract administration procedures, as well as appropriate benefit fund coverage, all Contractors shall require their "core work force" and any other persons employed other than through the referral process, to register with the appropriate hiring hall, if any, prior to beginning work on the Project.

Section 3.6 Helmets to Hardhats. The Contractors and the Unions recognize a desire to facilitate the entry into the building and construction trades of veterans who are interested in careers in the building and construction industry. The Contractors and Unions agree to utilize the services of the Center for Military Recruitment, Assessment and Veterans Employment (hereinafter "Center") and the Center's "Helmets to Hardhats" program to serve as a resource for preliminary orientation, assessment of construction aptitude, referral to apprenticeship programs or hiring halls, counseling and mentoring, support network, employment opportunities and other needs as identified by the Parties. For purposes of this Agreement the term "Eligible Veteran" shall have the same meaning as the term "veteran" as defined under Title 5, Section 2108(1) of the United States Code as the same may be amended or re-codified from time to time. It shall be the responsibility of each qualified District resident to provide the Unions with proof of his/her status as an Eligible Veteran.

The Unions and Contractors agree to coordinate with the Center to create and maintain an integrated database of veterans interested in working on this Project and of apprenticeship and employment opportunities for this Project. To the extent permitted by law, the Unions will give credit to such veterans for bona fide, provable past experience.

Section 3.7 Core Employees.

(a) Except as otherwise provided in separate collective bargaining agreement(s) to which the Contractor is signatory, Contractors and specialty or sub-contractors may employ, as needed, first, a member of its core workforce, then an employee through a referral from the appropriate Union hiring hall, then a second core employee, then a second employee through the referral system, and so on until a maximum of five (5) core employees are employed, thereafter, all additional employees in the affected trade or craft shall be requisitioned from the craft hiring hall in accordance with Section 3.3. In the laying off of employees, the number of core employees shall not exceed one-half plus one of the workforce for an employer with 10 or fewer employees, assuming the remaining employees are qualified to undertake the work available. This provision applies only to employees not currently working under a current Schedule A Agreement and is not intended to limit the transfer provisions of the Schedule A Agreement of any trade.

(b) The core work force is comprised of those employees: (i) whose names appeared on the Contractor's active payroll for sixty (60) of the one hundred (100) working days immediately before award of Project Work to the Contractor;

(ii) who possess any license required by state or federal law for the Project Work to be performed;

(iii) who have the ability to safely perform the basic functions of the applicable trade; and

(iv) who are residents of the District on the effective date of this Agreement, or have been residing within the zip codes identified in Section 3(a) as the geographic area served by the District for the one hundred (100) working days immediately prior to the award of Project Work to the Contractor.

(c) Prior to each Contractor performing any work on the Project, each Contractor shall provide a list of his core employees to the Project Labor Coordinator and the Council. Failure to do so will prohibit the Contractor from using any core employees. Upon request by any Party to this Agreement, the Contractor hiring any core employee shall provide satisfactory proof (i.e., payroll records, quarterly tax records, driver's license, voter registration, postal address and such other documentation) evidencing the core employee's qualification as a core employee to the Project Labor Coordinator and the Council.

(d) This Section 3.7 shall only apply to employees who are not working under the terms of a Schedule A Agreement at the time of their transfer to work covered under this Agreement and is not intended to limit the transfer provisions of the Schedule A Agreements of any of the Unions signatory hereto.

Section 3.8 Time for Referral. If any Union's registration and referral system does not fulfill the requirements for specific classifications of covered employees (including residency standards) requested by any Contractor within forty-eight (48) hours (excluding Saturdays, Sundays and holidays), that Contractor may use employment sources other than the Union registration and referral services, and may employ applicants meeting such standards from any other available source. The Contractor shall, within forty-eight (48) hours of such applicant

being hired, inform the Union of any applicants hired from other sources, and such applicants shall register with the appropriate hiring hall, if any.

Section 3.9 Lack of Referral Procedure. If a signatory local Union does not have a job referral system as set forth in Section 3.3 above, the Contractors shall give the Union equal opportunity to refer applicants. The Contractors shall notify the Union of employees so hired, as set forth in Section 3.5.

Section 3.10 Union Membership. No employee covered by this Agreement shall be required to join any Union as a condition of being employed, or remaining employed, for the completion of Project Work; provided, however, that any employee who is a member of the referring Union at the time of referral shall maintain that membership in good standing while employed under this Agreement. All employees shall, however, be required to comply with the Union security provisions of the applicable Schedule A for the period during which they are performing on-site Project Work to the extent, as permitted by law, of rendering payment of the applicable monthly and working dues only, as uniformly required of all craft employees while working on the Project and represented by the applicable signatory Union.

Section 3.11 Individual Seniority. Except as provided in Section 4.3, individual seniority shall not be recognized or applied to employees working on the Project; provided, however, that group and/or classification seniority in a Union's Schedule A as of the effective date of this Agreement shall be recognized for purposes of layoffs.

Section 3.12 Foremen. The selection and number of craft foreman and/or general foreman shall be the responsibility of the Contractor. All foremen shall take orders exclusively from the designated Contractor representatives. Craft foreman shall be designated as working foreman at the request of the Contractors.

Section 3.13 District Security Requirements. The Parties are aware of the District's policy that Contractors and other employers shall not employ a person who would not be eligible for employment by the District under Education Code Section 45123. All persons working on Project Work, including all employees hired by a Contractor (or referred by a Signatory Union) to work on Project Work shall be required to comply with all criminal background check certification requirements and policies of District for those persons who may come in contact with, or work in close proximity to, minors in the course of performing work on a Project. Contractors may refuse to employ any person who declines to comply with District's background check requirements or who otherwise is determined to be disqualified from participating in Project Work because of a disqualifying conviction. Similarly, District may ban or order the immediate removal of any person disqualified from working in the presence of, or in close proximity to, minors.

ARTICLE 4 UNION ACCESS AND STEWARDS

Section 4.1 Access to Project Sites. Authorized representatives of the Union shall have access to Project Work, provided that they do not interfere with the work of employees and further provided that such representatives fully comply with posted visitor, security and safety rules.

Section 4.2 Stewards.

(a) Each signatory local Union shall have the right to dispatch a working journey person as a steward for each shift, and shall notify the Contractor in the writing of the identity of the designated steward or stewards prior to the assumption of such person's duties as steward. Such designated steward or stewards shall not exercise any supervisory functions. There will be no non-working stewards. Stewards will receive the regular rate of pay for their respective crafts.

(b) In addition to his/her work as an employee, the steward should have the right to receive, but not to solicit, complaints or grievances and to discuss and assist in the adjustment of the same with the employee's appropriate supervisor. Each steward should be concerned only with the employees of the steward's Contractor and, if applicable, subcontractor(s), and not with the employees of any other Contractor. A Contractor will not discriminate against the steward in the proper performance of his/her Union duties.

(c) When a Contractor has multiple, non-contiguous work locations at one site, the Contractor may request and the Union shall appoint such additional working stewards as the Contractor requests to provide independent coverage of one or more such locations. In such cases, a steward may not service more than one work location without the approval of the Contractor.

(d) The stewards shall not have the right to determine when overtime shall be worked or who shall work overtime.

Section 4.3 Steward Layoff/Discharge. The relevant Contractor agrees to notify the appropriate Union twenty-four (24) hours before the layoff of a steward, except in the case of disciplinary discharge for just cause. If the steward is protected against such layoff by the provisions of the applicable Schedule A, such provisions shall be recognized when the steward possesses the necessary qualifications to perform the remaining work. In any case in which the steward is discharged or disciplined for just cause, the appropriate Union will be notified immediately by the Contractor, and such discharge or discipline shall not become final (subject to any later filed grievance) until twenty-four (24) hours after such notice have been given.

Section 4.4 Employees on Non-Project Work. On work where the personnel of the District may be working in close proximity to the construction activities covered by this Agreement, the Union agrees that the Union representatives, stewards, and individual workers will not interfere with the District personnel, or with personnel employed by the any other employer not a Party to this Agreement.

**ARTICLE 5
WAGES AND BENEFITS**

Section 5.1 Wages. All employees covered by this Agreement shall be classified in accordance with work performed and paid by the Contractors the hourly wage rates for those classifications in compliance with the applicable prevailing wage rate determination established pursuant to applicable law. If a prevailing rate increases under law, the Contractor shall pay that rate as of its effective date under the law. This Agreement does not relieve Contractors from any

independent contractual or other obligation they may have to pay wages in excess of the prevailing wage rate as required.

Section 5.2 Benefits.

(a) Contractors shall pay contributions to the established employee benefit funds in the amounts designated in the appropriate Schedule A and make all employee – authorized deductions in the amounts designated in the appropriate Schedule A: provided, however, that the Contractor and Union agree that only such bona fide employee benefits as accrue to the direct benefit of the employees (such as pension and annuity, health and welfare, vacation, apprenticeship, training funds, etc.) shall be included in this requirement and required to be paid by the Contractor on the Project; and provided further, however, that such contributions shall not exceed the contribution amounts set forth in the applicable prevailing wage determination. Notwithstanding Section 2.7(a), Contractors directly signatory to one or more of the Schedule A Agreements are required to make all contributions set forth in those Schedule A Agreements without reference to the forgoing. Bona fide jointly-trusted benefit plans or authorized employee deduction programs established or negotiated under the applicable Schedule A or by the Parties to this Agreement during the life of this Agreement may be added.

(b) The Contractor adopts and agrees to be bound by the written terms of the applicable, legally established, trust agreement(s) specifying the detailed basis on which payments are to be made into, and benefits paid out of, such trust funds for its employees. The Contractor authorizes the Parties to such trust funds to appoint trustees and successor trustees to administer the trust funds and hereby ratifies and accepts the trustees so appointed as if made by the Contractor.

(c) Each Contractor and subcontractor is required to certify to the Project Labor Coordinator that it has paid all benefit contributions due and owing to the appropriate Trust(s) prior to the receipt of its final payment and/or retention. Further, upon timely notification by a Union to the Project Labor Coordinator, the Project Labor Coordinator shall work with any prime Contractor or subcontractor who is delinquent in payments to assure that proper benefit contributions are made, to the extent of requesting the District or the prime Contractor to withhold payments otherwise due such Contractor, until such contributions have been made or otherwise guaranteed.

Section 5.3 Wage Premiums. Wage premiums, including but not limited to pay based on height of work, hazard pay, scaffold pay and special skills shall not be applicable to work under this Agreement, except to the extent provided for in any applicable prevailing wage determination.

Section 5.4 Compliance with Prevailing Wage Laws. The Parties agree that the Project Labor Coordinator shall monitor the compliance by all Contractors and subcontractors with all applicable federal and state prevailing wage laws and regulations, and that such monitoring shall include Contractors engaged in what would otherwise be Project Work but for the exceptions to Agreement coverage in Article 2, Section 2.2. All complaints regarding possible prevailing wage violations shall be referred to the Project Labor Coordinator for processing, investigation and resolution, and if not resolved within thirty calendar days, may be referred by any party to the state labor commissioner.

ARTICLE 6
HOURS OF WORK, OVERTIME, SHIFTS AND HOLIDAYS

Section 6.1 Hours of Work. Eight (8) hours per day between the hours of 6:00 a.m. and 5:30 p.m., plus one-half (½) hour unpaid lunch approximately mid-way through the shift, shall constitute the standard work day. Forty (40) hours per week shall constitute a regular week's work. The work week will start on Sunday and conclude on Saturday. The foregoing provisions of this Article are applicable unless otherwise provided in the applicable prevailing wage determination, or unless changes are permitted by law and such are agreed upon by the Parties. Nothing herein shall be construed as guaranteeing any employee eight (8) hours per day or forty (40) hours per week, or a Monday through Friday work standard work schedule.

Section 6.2 Place of Work. Employees shall be at their place of work (as designated by the Contractor), at the starting time and shall remain at their place of work, performing their assigned functions, until quitting time. The place of work is defined as the gang or tool box or equipment at the employee's assigned work location or the place where the foreman gives instructions. The Parties reaffirm their policy of a fair day's work for a fair day's wage. There shall be no pay for time not worked unless the employee is otherwise engaged at the direction of the Contractor.

Section 6.3 Overtime. Overtime shall be paid in accordance with the requirements of the applicable prevailing wage determination. There shall be no restriction on the Contractor's scheduling of overtime or the nondiscriminatory designation of employees who will work overtime. There shall be no pyramiding of overtime (payment of more than one form of overtime compensation for the same hour) under any circumstances.

Section 6.4 Shifts and Alternate Work Schedules.

(a) Alternate starting and quitting time and/or shift work may be performed at the option of the Contractor upon three (3) days' prior notice to the affected Union(s), unless a shorter notice period is provided for in the applicable Schedule A, and shall continue for a period of not less than five (5) working days. Saturdays and Sundays, if worked, may be used for establishing the five (5) day minimum work shift. If two shifts are worked, each shall consist of eight (8) hours of continuous work exclusive of a one-half (½) hour non-paid lunch period, for eight (8) hours pay. The last shift shall start on or before 6:00 p.m. The first shift starting at or after 6:00 a.m. is designated as the first shift, with the second shift following.

(b) Contractors, the Council and the Union recognize the economic impact upon the District and District residents of the massive Project being undertaken by the District and agree that all Parties to this Agreement desire and intend Project Work to be undertaken in a cost efficient and effective manner to the highest standard of quality and craftsmanship. Recognizing the economic conditions, the Parties agree that, except to the extent permitted by law, employees performing Project Work shall not be entitled to any differentials or additional pay based upon the shift or work schedule of the employees. Instead, all employees working on Project Work shall be paid at the same base rate regardless of shift or work schedule worked.

(c) Because of operational necessities, the second shift may, at the District's direction, be scheduled without the preceding shift having been worked. It is recognized that the District's operations and/or mitigation obligations may require restructuring of normal work

schedules. Except in an emergency or when specified in the District's bid specification, the Contractor shall give affected Union(s) at least three (3) days' notice of such schedule changes.

Section 6.5 Holidays. Recognized holidays on this Project shall be those set forth and governed by the prevailing wage determination(s) applicable to this Project, unless or until such may be, and are, revised by mutual agreement of the Parties to this Agreement.

Section 6.6 Show-up Pay.

(a) Except as otherwise required by State law, Employees reporting for work and for whom no work is provided, except when given prior notification not to report to work, shall receive two (2) hours pay at the regular straight time hourly rate. Employees who are directed to start work shall receive four (4) hours of pay at the regular straight time hourly rate. Employees who work beyond four (4) hours shall be paid for actual hours worked. Whenever reporting pay is provided for employees, they will be required to remain at the Project Site and available for work for such time as they receive pay, unless released earlier by the principal supervisor of the Contractor(s) or his/her designated representative. Each employee shall furnish his/her Contractor with his/her current address and telephone number, and shall promptly report any changes to the Contractor.

(b) An employee called out to work outside of his/her shift shall receive a minimum of two (2) hours pay at the appropriate rate. This does not apply to time worked as an extension of (before or after) the employee's normal shift.

(c) When an employee leaves the job or work location of his/her own volition, or is discharged for cause or is not working as a result of the Contractor's invocation of Article XII, Section 12.3, the employee shall only be paid for actual time worked.

Section 6.7 Meal Periods. The Contractor will schedule a meal period of no more than one-half hour duration at the work location at approximately mid-point of the schedule shift; provided, however, that the Contractor may, for efficiency of the operation, establish a schedule which coordinates the meal periods of two or more crafts. An employee may be required to work through his meal period because of an emergency or a threat to life or property, or for such other reasons as are in the applicable Schedule A, and if he is so required, he shall be compensated in the manner established in the applicable Schedule A.

Section 6.8 Make-up Days. To the extent permitted by the applicable general wage determination, when an employee has been prevented from working for reasons beyond the control of the employer, including, but not limited to inclement weather or other natural causes, during the regularly scheduled work week, a make-up day may be worked on a non-regularly scheduled work day for which an employee shall receive eight (8) hours pay at the straight time rate of pay or any premium rate required for such hours under the prevailing wage law.

ARTICLE 7 WORK STOPPAGES AND LOCK-OUTS

Section 7.1 No Work Stoppages or Disruptive Activity. The Council and the Unions signatory hereto agree that neither they, and each of them, nor their respective officers or agents or representatives, shall incite or encourage, condone or participate in any strike, walk-out, slow-

down, picketing, observing picket lines or other activity of any nature or kind whatsoever, for any cause or dispute whatsoever with respect to or any way related to Project Work, or which interferes with or otherwise disrupts, Project Work, or with respect to or related to the District or Contractors or subcontractors, including, but not limited to, economic strikes, unfair labor practice strikes, safety strikes, sympathy strikes and jurisdictional strikes whether or not the underlying dispute is arbitrable. Any such actions by the Council, or Unions, or their members, agents, representatives or the employees they represent shall constitute a violation of this Agreement. The Council and the Union shall take all steps necessary to obtain compliance with this Article and neither should be held liable for conduct for which it is not responsible.

Section 7.2 Employee Violations. The Contractor may discharge any employee violating Section 7.1 above and any such employee will not be eligible for rehire under this Agreement.

Section 7.3 Standing to Enforce. The District, the Project Labor Coordinator, or any Contractor affected by an alleged violation of Section 7.1 shall have standing and the right to enforce the obligations established therein.

Section 7.4 Expiration of Schedule A Agreements. If the Schedule A Agreement, or any local, regional, and other applicable collective bargaining agreements expire during the term of the Project, the Union(s) agree that there shall be no work disruption of any kind as described in Section 7.1 above as a result of the expiration of any such agreement(s) having application on this Project and/or failure of the involved Parties to that agreement to reach a new contract. Terms and conditions of employment established and set at the time of bid shall remain established and set. Otherwise to the extent that such agreement does expire and the Parties to that agreement have failed to reach concurrence on a new contract, work will continue on the Project on one of the following two (2) options, both of which will be offered by the Unions involved to the Contractors affected:

(a) Each of the Unions with a contract expiring must offer to continue working on the Project under interim agreements that retain all the terms of the expiring contract, except that the Unions involved in such expiring contract may each propose wage rates and employer contribution rates to employee benefit funds under the prior contract different from what those wage rates and employer contributions rates were under the expiring contracts. The terms of the Union's interim agreement offered to Contractors will be no less favorable than the terms offered by the Union to any other employer or group of employers covering the same type of construction work in Los Angeles County.

(b) Each of the Unions with a contract expiring must offer to continue working on the Project under all the terms of the expiring contract, including the wage rates and employer contribution rates to the employee benefit funds, if the Contractor affected by that expiring contract agrees to the following retroactive provisions: if a new Schedule A Agreement, local, regional or other applicable labor agreement for the industry having application at the Project is ratified and signed during the term of this Agreement and if such new labor agreement provides for retroactive wage increases, then each affected Contractor shall pay to its employees who performed work covered by this Agreement at the Project during the hiatus between the effective dates of such expired and new labor agreements, an amount equal to any such retroactive wage increase established by such new labor agreement, retroactive to whatever date

is provided by the new labor agreement for such increase to go into effect, for each employee's hours worked on the Project during the retroactive period. All Parties agree that such affected Contractors shall be solely responsible for any retroactive payment to its employees.

(c) Some Contractors may elect to continue to work on the Project under the terms of the interim agreement option offered under paragraph (a) above and other Contractors may elect to continue to work on the Project under the retroactivity option offered under paragraph (b) above. To decide between the two options, Contractors will be given one week after the particular labor agreement has expired or one week after the Union has personally delivered to the Contractors in writing its specific offer of terms of the interim agreement pursuant to paragraph (a) above, whichever is the later date. If the Contractor fails to timely select one of the two options, the Contractor shall be deemed to have selected option (b).

Section 7.5 No Lockouts. Contractors shall not cause, incite, encourage, condone or participate in any lock-out of employees with respect to Project Work during the term of this Agreement. The term "lock-out" refers only to a Contractor's exclusion of employees in order to secure collective bargaining advantage, and does not refer to the discharge, termination or layoff of employees by the Contractor for any reason in the exercise of rights pursuant to any provision of this Agreement, or any other agreement, nor does "lock-out" include the District's decision to stop, suspend or discontinue any Project Work or any portion thereof for any reason.

Section 7.6 Best Efforts to End Violations.

(a) If a Contractor contends that there is any violation of this Article or Section 8.3, it shall notify, in writing, the Executive Secretary of the Council, the Senior Executive of the involved Union(s) and the Project Labor Coordinator. The Executive Secretary and the leadership of the involved Union(s) will immediately instruct, order and use their best efforts to cause the cessation of any violation of the relevant Article.

(b) If the Union contends that any Contractor has violated this Article, it will notify that the Contractor and the Project Labor Coordinator, setting forth the facts which the Union contends violate the Agreement, at least twenty-four (24) hours prior to invoking the procedures of Section 7.8. The Project Labor Coordinator shall promptly order the involved Contractor(s) to cease any violation of the Article.

Section 7.7 Withholding of services for failure to pay wages and fringe benefits. Notwithstanding any provision of this Agreement to the contrary, it shall not be a violation of this Agreement for any Union to withhold the services of its members (but not the right to picket) from a particular Contractor who:

(a) fails to timely pay its weekly payroll; or

(b) fails to make timely payments to the Union's Joint Labor/Management Trust Funds in accordance with the provisions of the applicable Schedule A Agreements. Prior to withholding its members services for the Contractor's failure to make timely payments to the Union's Joint Labor/Management Trust Funds, the Union shall give at least ten (10) days (unless a lesser period of time is provided in the Union's Schedule A Agreement, but in no event less than forty-eight (48) hours) written notice of such failure to pay by registered or certified mail.

return receipt requested, and by facsimile transmission to the involved Contractor. Union will meet within the ten (10) day period to attempt to resolve the dispute.

(c) Upon the payment of the delinquent Contractor of all monies due and then owing for wages and/or fringe benefit contributions, the Union shall direct its members to return to work and the Contractor shall return all such members back to work.

Section 7.8 Expedited Enforcement Procedure. Any party, including the District, which the Parties agree is a Party to the Agreement for purposes of this Article and an intended beneficiary of this Article, or the Project Labor Coordinator, may institute the following procedures, in lieu of or in addition to any other action at law or equity, when a breach of Section 7.1 or 7.5, above, or Section 8.3 is alleged.

(a) The Party invoking this procedure shall notify the permanent arbitrator next in sequence from the list of neutral arbitrators mutually agreed to by the Parties under *Attachment D* (hereinafter, the "Permanent Neutral Arbitrators"). The Parties agree these shall be the permanent neutral arbitrators under this procedure. In the event that none of the Permanent Neutral Arbitrators are available for a hearing within twenty-four (24) hours, the Party invoking the procedure shall have the option of delaying the proceedings until one of the Permanent Neutral Arbitrators is available or the Parties shall make a joint request of the State Mediation and Conciliation Service of the California Department of Industrial Relations (hereinafter, "SMCS")¹ for a list of five (5) qualified neutral arbitrators with labor and employment expertise reasonably related to the nature of the dispute. The Parties shall select a neutral arbitrator from the SMCS list by striking one name from the list in succession until only one name remains. If any of the Permanent Neutral Arbitrators ask to be relieved from their status as a Permanent Neutral Arbitrator, the Parties shall mutually select a new Permanent Neutral Arbitrator by again submitting a joint request to the SMCS for a list of five (5) qualified arbitrators with the new arbitrator selected by striking names from the list until only one name remains, who has been selected by the negotiating Parties, and whom the Parties agree shall be the permanent arbitrator under this procedure. If the permanent arbitrator is unavailable at any time, the party invoking this procedure shall notify one of the alternates selected by the Parties, in that order on an alternating basis. Expenses incurred in arbitration shall be borne equally by the Parties involved in the arbitration and the decision of the arbitrator shall be final and binding on the Parties; provided, however, that the arbitrator shall only have the authority to interpret and apply the provisions of this Agreement. Notice to the arbitrator shall be by the most expeditious means available, with notices to the Parties alleged to be in violation, and to the Council if it is a Union alleged to be in violation. For purposes of this Article, written notice may be given by telegram, facsimile, hand delivery or overnight mail and will be deemed effective upon receipt.

(b) Upon receipt of said notice, the arbitrator named above or his/her alternate shall sit and hold a hearing within twenty-four (24) hours if it is contended that the violation still exists, but not sooner than twenty-four (24) hours after notice has been dispatched to the Executive Secretary and the Senior Official(s) as required by Section 7.6, as above.

¹ As of the effective date of this Agreement, the offices of the SMCS can be contacted at the following address and/or by means of the following e-mail address and facsimile number: 1515 Clay Street, Suite 2206, Oakland, California 94612. E-mail: SMCSInfo@dir.ca.gov, Facsimile Number: (510) 873-6475.

(c) The arbitrator shall notify the Parties of the place and time chosen for this hearing. Said hearing shall be completed in one session, which, with appropriate recesses at the arbitrator's discretion, shall not exceed twenty-four (24) hours unless otherwise agreed upon by all Parties. A failure of any Party or Parties to attend said hearings shall not delay the hearing of evidence or the issuance of any award by the arbitrator.

(d) The sole issue at the hearing shall be whether or not a violation of Sections 7.1 or 7.5, above, or Section 8.3 has in fact occurred. The arbitrator shall have no authority to consider any matter in justification, explanation or mitigation of such violation or to award damages, (except for damages as set forth in 7.8 below) which issue is reserved for court proceedings, if any. The award shall be issued in writing within three (3) hours after the close of the hearing, and may be issued without an opinion. If any Party desires a written opinion, one shall be issued within fifteen (15) days, but its issuance shall not delay compliance with, or enforcement of, the Award. The arbitrator may order cessation of the violation of the Article and other appropriate relief, and such award shall be served on all Parties by hand or registered mail upon issuance.

(e) Such award shall be final and binding on all Parties and may be enforced by any court of competent jurisdiction upon the filing of this Agreement and all other relevant documents referred to herein above in the following manner. Written notice of the filing of such enforcement proceedings shall be given to the other Party. In any judicial proceeding to obtain a temporary order enforcing the arbitrator's award as issued under Section 7.7(d) of this Article, all Parties waive the right to a hearing and agree that such proceedings may be ex parte. Such agreement does not waive any Party's right to participate in a hearing for a final order of enforcement. The court's order or orders enforcing the arbitrator's award shall be served on all Parties by hand or by delivery to their address as shown on this Agreement (for a Union), as shown on their business contract for work under this Agreement (for a Contractor) and to the representing Union (for an employee), by certified mail by the Party or Parties first alleging the violation.

(f) Any rights created by statute or law governing arbitration proceedings inconsistent with the above procedure or which interfere with compliance hereto are hereby waived by the Parties to whom they accrue.

(g) The fees and expenses of the arbitrator shall be equally divided between the Party or Parties initiating this procedure and the respondent Party or Parties.

ARTICLE 8 WORK ASSIGNMENTS AND JURISDICTIONAL DISPUTES

Section 8.1 Assignment of Work. The assignment of work will be solely the responsibility of the Contractor performing the work involved; and such work assignments will be in accordance with the Plan for the Settlement of Jurisdictional Disputes in the Construction Industry (the "Plan") currently in effect, or any successor plan.

Section 8.2 The Plan. All jurisdictional disputes between or among Building and Construction Trades Unions and Contractors, shall be settled and adjusted according to the Plan, or any other plan or method of procedures that may be adopted in the future by the Building and

Construction Trades Department. Decisions rendered shall be final, binding and conclusive on the Contractors and Union.

(a) For the convenience of the parties, and in recognition of the expense of travel between Southern California and Washington D.C., at the request of any party to a jurisdictional dispute under this Agreement an Arbitrator shall be chosen by the procedures specified in Article V, Section 5, of the Plan from a list composed of John Kagel, Thomas Angelo, Robert Hirsh, and Thomas Pagan, and the Arbitrator's hearing on the dispute shall be held at the offices of the Council. All other procedures shall be as specified in the Plan.

Section 8.3 No Work Disruption Over Jurisdiction. All jurisdictional disputes shall be resolved without the occurrence of any strike, work stoppage, disruption, or slowdown of any nature, and the Contractor's assignments shall be adhered to until the dispute is resolved. Individuals violating this section shall be subject to immediate discharge.

Section 8.4 Pre-Job Conferences. As provided in Article 16, each Contractor will conduct a pre-job conference with the appropriate affected Union(s) prior to commencing work. The Council and the Project Labor Coordinator shall be advised in advance of all such conferences and may participate if they wish.

Section 8.5 Resolution of Jurisdictional Disputes. If any actual or threatened strike, sympathy strike, work stoppage, slow down, picketing, hand-billing or otherwise advising the public that a labor dispute exists, or interference with the progress of Project Work by reason of a jurisdictional dispute or disputes occurs, the Parties shall exhaust the expedited procedures set forth in the Plan, if such procedures are in the plan then currently in effect, or otherwise as in Article 7 above.

ARTICLE 9 MANAGEMENT RIGHTS

Section 9.1 Contractor and District Rights. The Contractors and the District have the sole and exclusive right and authority to oversee and manage construction operations on Project Work without any limitations unless expressly limited by a specific provision of this Agreement. In addition to the following and other rights of the Contractors enumerated in this Agreement, the Contractors expressly reserve their management rights and all the rights conferred upon them by law. The Contractor's rights include, but are not limited to, the right to:

- (a) Plan, direct and control operations of all work;
- (b) Hire, promote, transfer and layoff their own employees, respectively, as deemed appropriate to satisfy work and/or skill requirements;
- (c) Promulgate and require all employees to observe reasonable job rules and security and safety regulations;
- (d) Discharge, suspend or discipline their own employees for just cause;
- (e) Utilize, in accordance with District approval, any work methods, procedures or techniques, and select, use and install any types or kinds of materials, apparatus or

equipment, regardless of source of manufacture or construction; assign and schedule work at their discretion; and

(f) Assign overtime, determine when it will be worked and the number and identity of employees engaged in such work, subject to such provisions in the applicable Schedule A(s) requiring such assignments be equalized or otherwise made in a nondiscriminatory manner.

Section 9.2 Specific District Rights. In addition to the following and other rights of the District enumerated in this Agreement, the District expressly reserves its management rights and all the rights conferred on it by law. The District's rights (and those of the Contractor Administrator on its behalf) include but are not limited to the right to:

(a) Inspect any construction site or facility to ensure that the Contractor follows the applicable safety and other work requirements;

(b) Require Contractors to establish a different work week or shift schedule for particular employees as required to meet the operational needs of the Project Work at a particular locations or in order to accommodate the instructional programs and pupil control problems at various project sites where school may be in session during periods of construction activity;

(c) At its sole option, terminate, delay and/or suspend any and all portions of the covered work at any time; prohibit some or all work on certain days or during certain hours of the day to accommodate the ongoing operations of the District's educational facilities and/or to mitigate the effect of ongoing Project Work on businesses and residents in the neighborhood of the Project site; and/or require such other operational or schedule changes it deems necessary, in its sole judgment, to effectively maintain its primary mission and remain a good neighbor to those in the area of its facilities. (In order to permit the Contractors and Unions to make appropriate scheduling plans, the District will provide the Project Labor Coordinator, and the affected Contractor(s) and Union(s) with reasonable notice of any changes it requires pursuant to this section; provided, however, that if notice is not provided in time to advise employees not to report for work, show-up pay shall be due pursuant to the provision of Article 6, Section 6.6);

(d) Approve any work methods, procedures and techniques used by Contractors whether or not these methods, procedures or techniques are part of industry practices or customs; and

(e) Investigate and process complaints, through its Project Labor Coordinator, in the matter set forth in Articles 7 and 10.

Section 9.3 Use of Materials. There should be no limitations or restriction by Union upon a Contractor's choice of materials or design, nor, regardless of source or location, upon the full use and utilization, of equipment, machinery, packaging, precast, prefabricated, prefinished, or preassembled materials, tools or other labor saving devices, subject to the application of the State Public Contracts and Labor Codes as required by law in reference to offsite construction. Generally, the onsite installation or application of such items shall be performed by the craft having jurisdiction over such work. The District and its Project Labor Coordinator shall advise

all Contractors of, and enforce as appropriate, the off-site application of the prevailing wage law as it affects Project Work.

Section 9.4 Special Equipment, Warranties and Guaranties.

(a) It is recognized that certain equipment of a highly technical and specialized nature may be installed at Project Work sites. The nature of the equipment, together with the requirements for manufacturer's warranties, may dictate that it be prefabricated pre-piped and/or pre-wired and that it be installed under the supervision and direction of the District's and/or manufacturer's personnel. The Unions agree that such equipment is to be installed without incident.

(b) The Parties recognize that the Contractor will initiate from time to time the use of new technology, equipment, machinery, tools, and other labor-savings devices and methods of performing Project Work. The Union agrees that they will not restrict the implementation of such devices or work methods. The Unions will accept and will not refuse to handle, install or work with any standardized and/or catalogue: parts, assemblies, accessories, prefabricated items, preassembled items, partially assembled items, or materials whatever their source of manufacture or construction.

(c) If any disagreement between the Contractor and the Unions concerning the methods of implementation or installation of any equipment, or device or item, or method of work, arises, or whether a particular part or pre-assembled item is a standardized or catalog part or item, the work will precede as directed by the Contractor and the Parties shall immediately consult over the matter. If the disagreement is not resolved, the affected Union(s) shall have the right to proceed through the procedures set forth in Article 10.

Section 9.5 No Less Favorable Treatment. The Parties expressly agree that Project Work will not receive less favorable treatment than that on any other project which the Unions, Contractors and employees work.

**ARTICLE 10
SETTLEMENT OF GRIEVANCES AND DISPUTES**

Section 10.1 Cooperation and Harmony on Site.

(a) This Agreement is intended to establish and foster continued close cooperation between management and labor. The Council shall assign a representative to this Project for the purpose of assisting the local Unions, and working with the Project Labor Coordinator, together with the Contractors, to complete the construction of the Project economically, efficiency, continuously and without any interruption, delays or work stoppages.

(b) The Project Labor Coordinator, the Contractors, Unions, and employees collectively and individually, realize the importance to all Parties of maintaining continuous and uninterrupted performance Project Work, and agree to resolve disputes in accordance with the grievance provisions set forth in this Article or, as appropriate, those of Article 7 or 8.

(c) The Project Labor Coordinator shall oversee the processing of grievances under this Article and Articles 7 and 8, including the scheduling and arrangements of facilities

for meetings, selection of the arbitrator from the agreed-upon panel to hear the case, and any other administrative matters necessary to facilitate the timely resolution of any dispute; provided, however, it is the responsibility of the principal parties to any pending grievance to insure the time limits and deadlines are met.

Section 10.2 Processing Grievances. Any questions arising out of and during the term of this Agreement involving its interpretation and application, which includes applicable provisions of the Schedule A Agreements, but not jurisdictional disputes or alleged violations of Section 7.1 and 7.4 and similar provisions, shall be considered a grievance and subject to resolution under the following procedures.

Step 1. Employee Grievances. When any employee subject to the provisions of this Agreement feels aggrieved by an alleged violation of this Agreement, the employee shall, through his local Union business representative or, job steward, within ten (10) working days after the occurrence of the violation, give notice to the work site representative of the involved Contractor stating the provision(s) alleged to have been violated. A business representative of the local Union or the job steward and the work site representative of the involved Contractor shall meet and endeavor to adjust the matter within ten (10) working days after timely notice has been given. If they fail to resolve the matter within the prescribed period, the grieving party may, within ten (10) working days thereafter, pursue Step 2 of this grievance procedure provided the grievance is reduced to writing, setting forth the relevant information, including a short description thereof, the date on which the alleged violation occurred, and the provision(s) of the Agreement alleged to have been violated. Grievances and disputes settled at Step 1 shall be non-precedential except as to the parties directly involved.

Union or Contractor Grievances. Should the Union(s) or any Contractor have a dispute with the other Party(ies) and, if after conferring within ten (10) working days after the disputing Party knew or should have known of the facts or occurrence giving rise to the dispute, a settlement is not reached within five (5) working days, the dispute shall be reduced to writing and processed to Step 2 in the same manner as outlined in 1(a) above for the adjustment of an employee complaint.

Step 2. The business manager of the involved local Union or his designee, together with the site representative of the involved Contractor, and the labor relations representative of the Project Labor Coordinator, shall meet within seven (7) working days of the referral of the dispute to this second step to arrive at a satisfactory settlement thereof. If the Parties fail to reach an agreement, the dispute may be appealed in writing in accordance with the provisions of Step 3 within seven (7) calendar days after the initial meeting at Step 2.

Step 3. (a) If the grievance shall have been submitted but not resolved under Step 2, either the Union or Contractor Party may request in writing to the Project Labor Coordinator (with copy (ies) to the other Party (ies)) within seven (7) calendar days after the initial Step 2 meeting, that the grievance be submitted to an arbitrator selected from the agreed upon list on **Attachment D** hereto, on a rotational basis in the order listed. The decision of the arbitrator shall be final and binding on all Parties and the fee and expenses of such arbitrations shall be borne equally by the involved Contractor(s) and the involved Union(s).

(b) Failure of the grieving Party to adhere to the time limits established herein shall render the grievance null and void. The time limits established herein may be extended only by written consent of the Parties involved at the particular step where the extension is agreed upon. The arbitrator shall have the authority to make decisions only on issues presented and shall only have the authority to interpret and apply the provisions of this Agreement.

(c) The fees and expenses incurred by the arbitrator, as well as those jointly utilized by the Parties (i.e., conference room, court reporter, etc.) in arbitration, shall be divided equally by the Parties to the arbitration, including Union(s) and Contractor(s) involved.

Section 10.3 Limit on Use of Procedures. Procedures contained in this Article shall not be applicable to any alleged violation of Articles 7 or 8, with a single exception that any employee discharged for violation of Section 7.2, or Section 8.3, may resort to the procedures of this Article to determine only if he/she was, in fact, engaged in that violation.

Section 10.4 Notice. The Project Labor Coordinator (and the District, in the case of any grievance regarding the Scope of this Agreement), shall be notified by the involved Contractor of all actions at Steps 2 and 3, and further, the Project Labor Coordinator shall, upon its own request, be permitted to participate fully as a party in all proceedings at such steps.

ARTICLE 11 REGULATORY COMPLIANCE

Section 11.1 Compliance with All Laws. The Council and all Unions, Contractors, subcontractors and their employed shall comply with all applicable federal and state laws, ordinances and regulations including, but not limited to, those relating to safety and health, employment and applications for employment. All employees shall comply with the safety regulations established by the District, the Project Labor Coordinator or the Contractor. Employees must promptly report any injuries or accidents to a supervisor.

Section 11.2 Monitoring Compliance. The Parties agree that the District shall require, and that the Project Labor Coordinator and Council shall monitor, compliance by all Contractors and subcontractors with all federal and state laws regulation that, from time to time may apply to Project Work. It shall be the responsibility of both the Council and the Project Labor Coordinator (on behalf of the District) to investigate or monitor compliance with these various laws and regulations. The Council may recommend to the Project Labor Coordinator and/or the District procedures to encourage and enforce compliance with these laws and regulations.

Section 11.3 Prevailing Wage Compliance. The Council or Union shall refer all complaints regarding any potential prevailing wage violation to the Project Labor Coordinator, who on its own, or with the assistance of the District's labor compliance program, shall process, investigate and resolve such complaints, consistent with Article 5, Section 5.4. The Council or Union, as appropriate, shall be advised in a timely manner with regard to the facts and resolution, if any, of any complaint. It is understood that this Section does not restrict any individual rights as established under the State Labor Code, including the rights of an individual to file a complaint with the State Labor Commissioner.

Section 11.4 Violations of Law. Based upon a finding of violation by the District of a federal and state law, and upon notice to the Contractor that it or its subcontractors is in such violation, the District, in the absence of the Contractor or subcontractor remedying such violation, shall take such action as it is permitted by law or contract to encourage that Contractor to come into compliance, including, but not limited to, assessing fines and penalties and/or removing the offending Contractor from Project Work. Additionally, in accordance with the Agreement between the District and the Contractor, the District may cause the Contractor to remove from Project Work any subcontractor who is in violation of state or federal law.

ARTICLE 12 SAFETY AND PROTECTION OF PERSON AND PROPERTY

Section 12.1 Safety.

(a) It shall be the responsibility of each Contractor to ensure safe working conditions and employee compliance with any safety rules contained herein or established by the District, the Project Labor Coordinator or the Contractor. It is understood that employees have an individual obligation to use diligent care to perform their work in a safe manner and to protect themselves and the property of the Contractor and the District.

(b) Employees shall be bound by the safety, security and visitor rules established by the Contractor, the Project Labor Coordinator and/or the District. These rules will be published and posted. An employee's failure to satisfy his/her obligations under this section will subject him/her to discipline, up to and including discharge.

(c) The Parties agree that the Labor/Management Memorandum of Understanding (MOU) on Drug Abuse Prevention and Detection negotiated with the various General Contractor Associations and the Basic Trades' Unions (Titled Memorandum of Understanding Testing Policy for Drug Abuse; International Union of Operating Engineers Local Union No. 12; Revised June 2009 as shown in Exhibit __) shall be utilized under this Agreement.

Section 12.2 Inspection. The inspection of incoming shipments of equipment, machinery, and construction materials of every kind shall be performed at the discretion of the Contractor by individuals of its choice.

Section 12.3 Suspension of Work for Safety. A Contractor may suspend all or a portion of the job to protect the life and safety of employees. In such cases, employees will be compensated only for the actual time worked; provided, however, that where the Contractor requests employees to remain at the site and be available for work, the employees will be compensated for stand-by time at their basic hourly rate of pay.

Section 12.4 Water and Sanitary Facilities . The Contractor shall provide adequate supplies of drinking water and sanitary facilities for all employees as required by state law or regulation.

**ARTICLE 13
TRAVEL AND SUBSISTENCE**

Travel expenses, travel time, subsistence allowances, zone rates and parking reimbursements shall be paid in accordance with the applicable Schedule A Agreement unless superseded by the applicable prevailing wage determination.

**ARTICLE 14
APPRENTICES**

Section 14.1 Importance of Training. The Parties recognize the need to maintain continuing support of the programs designed to develop adequate numbers of competent workers in the construction industry, the obligation to capitalize on the availability of the local work force in the area served by the District, and the opportunities to provide continuing work under the construction program. To these ends, the Parties will facilitate, encourage, and assist local residents to commence and progress in Labor/Management Apprenticeship and/or training Programs in the construction industry leading to participation in such apprenticeship programs. The District, the Project Labor Coordinator, other District consultants, and the Council, will work cooperatively to identify, or establish and maintain, effective programs and procedures for persons interested in entering the construction industry and which will help prepare them for the formal joint labor/management apprenticeship programs maintained by the signatory Unions.

Section 14.2 Use of Apprentices.

(a) Apprentices used on Projects under this Agreement shall be registered in Joint Labor Management Apprenticeship Programs approved by the State of California. Apprentices may comprise up to thirty percent (30%) of each craft's work force at any time, unless the standards of the applicable joint apprenticeship committee confirmed by the Division of Apprenticeship Standards ("DAS"), establish a lower maximum percentage, and where such is the case, the applicable Union should use its best efforts with the Joint Labor Management apprenticeship committee and, if necessary, the DAS to permit up to thirty percent (30%) apprentices on the Project.

(b) The Unions agree to cooperate with the Contractor in furnishing apprentices as requested up to the maximum percentage. The apprentice ratio for each craft shall be in compliance, at a minimum, with the applicable provisions of the Labor Code relating to utilization of apprentices. The District shall encourage such utilization, and, both as to apprentices and the overall supply of experienced workers, the Project Labor Coordinator will work with the Council to assure appropriate and maximum utilization of apprentices and the continuing availability of both apprentices and journey persons.

(c) The Parties agree that apprentices will not be dispatched to Contractors working under this Agreement unless there is a journeyman working on the project where the apprentice is to be employed who is qualified to assist and oversee the apprentice's progress through the program in which he is participating.

(d) All apprentices shall work under the direct supervision of a journeyman from the trade in which the apprentice is indentured. A journeyman shall be defined as set forth in the California Code of Regulations, Title 8 [apprenticeship] section 205, which defines a

journeyman as a person who has either completed an accredited apprenticeship in his or her craft, or has completed the equivalent of an apprenticeship in length and content of work experience and all other requirements in the craft which has workers classified as journeyman in the apprenticeable occupation. Should a question arise as to a journeyman's qualification under this subsection, the Contractor shall provide adequate proof evidencing the worker's qualification as a journeyman to the Construction Manager and the Council.

Section 14.3 Joint Subcommittee on Training and Apprenticeship. To carry out the intent and purposes of this Article, a subcommittee of the Labor Management Committee established pursuant to Article 17 shall be established, jointly chaired by a designee of the District and a designee of the Council, to oversee the identification and/or effective development of procedures and programs leading to the full utilization of apprenticeship programs, and to work with representatives of each signatory craft's joint apprenticeship committee ("JAC") and representatives of the District's technical schools to establish appropriate criteria for recognition by such JAC's of the educational and work experience possessed by District students and graduates toward qualifying for entry or advanced level in the apprenticeship programs under the direction under such JAC's. The Subcommittee will meet as necessary at the call of the joint chairs to promptly facilitate its purposes in an expeditious manner as soon as this Agreement becomes effective. In addition to the joint chairs, the membership of the committee will consist of at least three representatives of the signatory local Unions and three representatives of Contractors signatory to this Agreement and experienced in overseeing and participating in joint labor management apprenticeship programs (or organizations to which the Contractors belong).

ARTICLE 15 WORKING CONDITIONS

Section 15.1 Meal and Rest Periods. There will be no non-working times established during working hours except as may be required by applicable state law or regulations. Meal periods and Rest periods shall be as provided for in Wage Order 16. Individual coffee containers will be permitted at the employees' work location; however, there will be no organized coffee breaks.

Section 15.2 Work Rules. The District, the Project Labor Coordinator, and/or relevant Contractor shall establish such reasonable work rules as they deem appropriate and not inconsistent with this Agreement. These rules will be posted at the work sites by the Contractor and may be amended thereafter as necessary. Failure to observe these rules and regulations by employees may be grounds for discipline up to and including discharge.

Section 15.3 Emergency Use of Tools and Equipment. There should be no restrictions on the emergency use of any tools by any qualified employee or supervisor, or on the use of any tools or equipment for the performance of work within the jurisdiction, provided the employee can safely use the tools and/or equipment involved and is in compliance with applicable governmental rules and regulations.

Section 15.4 Access Restrictions for Cars. Recognizing the nature of the work being conducted on the site, employee access by a private automobile may be limited to certain roads and/or parking areas.

**ARTICLE 16
PRE-JOB CONFERENCES**

(a) Each Contractor will conduct a pre-job conference with the appropriate affected Union(s) prior to commencing work. The Council and the Project Labor Coordinator shall be notified in advance of all such conferences and may participate if they wish. All work assignments should be disclosed by the Contractor at the pre-job conference held in accordance with industry practice. Should there be any formal jurisdictional dispute raised under Article 8, the Project Labor Coordinator shall be promptly notified.

(b) If they have not already done so before the pre-job conference, each Contractor shall provide to the Unions, at the pre-job conference, a list of core employees which Contractor intends on using on this Project.

**ARTICLE 17
LABOR/MANAGEMENT COOPERATION**

Section 17.1 Joint Committee. The Parties to this Agreement shall establish a [six (6)] person Joint Administrative Committee (JAC). This JAC shall be comprised of [three (3)] representatives selected by the District and [three (3)] representatives selected by the Council to monitor compliance with the terms and conditions of this Agreement. Each representative shall designate an alternate who shall serve in his or her absence for any purpose contemplated by this Agreement.

Section 17.2 Functions of Joint Committee. The Committee shall meet on a schedule to be determined by the Committee or at the call of the joint chairs, to discuss the administration of the Agreement, the progress of the Projects, general labor management problems that may arise, and any other matters consistent with this Agreement. Substantive grievances or disputes arising under Articles 7, 8 or 10 shall not be reviewed or discussed by this Committee, but shall be processed pursuant to the provisions of the appropriate Article. The Project Labor Coordinator shall be responsible for the scheduling of the meetings, the preparation of the agenda topics for the meetings, with input from the Unions the Contractors and the District. Notice of the date, time and place of meetings, shall be given to the Committee members at least three (3) days prior to the meeting. If the Project Labor Coordinator is not a member of the District staff, the District must be notified of the meetings and invited to send a representative(s) to participate.

The Project Labor Coordinator shall be responsible for the scheduling of the meetings, the preparation of the agenda topics for the meetings, with input from the Unions, the Contractors, and the District. Notice of the date, time and place of meetings, shall be given to the Committee members at least three (3) days prior to the meeting.

Section 17.3 Subcommittees. The Committee may form subcommittees to consider and advise the full Committee with regard to safety and health issues affecting the Project and other similar issues affecting the overall Project, including any workers compensation program initiated under this Agreement.

**ARTICLE 18
SAVINGS AND SEPARABILITY**

Section 18.1 Savings Clause. It is not the intention of the District, the Project Labor Coordinator, Contractor or the Union parties to violate any laws governing the subject matter of this Agreement. The Parties hereto agree that in the event any provision of this Agreement is finally held or determined to be illegal or void as being in contravention of any applicable law or regulation, the remainder of the Agreement shall remain in full force and effect unless the part or parts so found to be void are wholly inseparable from the remaining portions of this Agreement. Further, the Parties agree that if and when any provision(s) of this Agreement is finally held or determined to be illegal or void by a court of competent jurisdiction, the Parties will promptly enter into negotiations concerning the substantive effect of such decision for the purposes of achieving conformity with the requirements of any applicable laws and the intent of the Parties hereto. If the legality of this Agreement is challenged and any form of injunctive relief is granted by any court, suspending temporarily or permanently the implementation of this Agreement, then the Parties agree that all Project Work that would otherwise be covered by this Agreement should be continued to be bid and constructed without application of this Agreement so that there is no delay or interference with the ongoing planning, bidding and construction of any Project Work.

Section 18.2 Effect of Injunctions or Other Court Orders. The Parties recognize the right of the District to withdraw, at its absolute discretion, the utilization of the Agreement as part of any bid specification should a Court of competent jurisdiction issue any order, or any applicable statute which could result, temporarily or permanently in delay of the bidding, awarding and/or construction on the Project. Notwithstanding such an action by the District, or such court order or statutory provision, the Parties agree that the Agreement shall remain in full force and the fact on covered Project Work to the maximum extent legally possible.

**ARTICLE 19
WAIVER**

A waiver of or a failure to assert any provisions of this Agreement by any or all of the Parties hereto shall not constitute a waiver of such provision for the future. Any such waiver shall not constitute a modification of the Agreement or change in the terms and conditions of the Agreement and shall not relieve, excuse or release any of the Parties from any of their rights, duties or obligations hereunder.

**ARTICLE 20
AMENDMENTS**

The provisions of this Agreement can be renegotiated, supplemented, rescinded or otherwise altered only by mutual agreement in writing, hereafter signed by the negotiating Parties hereto.

**ARTICLE 21
DURATION OF THE AGREEMENT**

Section 21.1 Duration.

(a) This Agreement shall be effective from the date signed by all Parties and shall remain in effect for a period of three (3) years. Any covered Project awarded during the term of this Agreement shall continue to be covered hereunder, until completion of the Project, notwithstanding the expiration date of this Agreement.

(b) This Agreement may be extended by mutual consent of the District and the signatory Unions for such further periods as the Parties shall agree to.

Section 21.2 Turnover and Final Acceptance of Completed Work.

(a) Construction of any phase, portion, section, or segment of Project Work shall be deemed complete when such phase, portion, section or segment has been turned over to the District by the Contractor and the District has accepted such phase, portion, section, or segment. As areas and systems of the Project are inspected and construction-tested and/or approved and accepted by the District or third parties with the approval of the District, the Agreement shall have no further force or effect on such items or areas, except when the Contractor is directed by the District to engage and repairs or modifications required by its contract(s) with the District.

(b) Notice of each final acceptance received by the Contractor will be provided to the Council with the description of what portion, segment, etc. has been accepted. Final acceptance may be subject to a "punch" list, and in such case, the Agreement will continue to apply to each such item on the list until it is completed to the satisfaction of the District and Notice of Acceptance is given by the District or its representative to the Contractor. At the request of the Union, complete information describing any "punch" list work, as well as any additional work required of a Contractor at the direction of the District pursuant to (a) above, involving otherwise turned-over and completed facilities which have been accepted by the District, will be available from the Project Labor Coordinator.

IN WITNESS whereof the Parties have caused this Continuity of Work Agreement to be executed as of the date and year above stated.

HACIENDA I.A PUENTE UNIFIED
SCHOOL DISTRICT

LOS ANGELES/ORANGE COUNTIES
BUILDING & CONSTRUCTION
TRADES COUNCIL

By:  
Cynthia Parulan- Coffey, Superintendent

By: 
Ron Miller, Executive Secretary

Signatory Unions and Councils (see attached)

**LOS ANGELES/ORANGE COUNTIES BUILDING AND CONSTRUCTION
TRADES COUNCIL CRAFT UNIONS AND DISTRICT COUNCILS**

CEMENT MASONS L. OCC

Plasterers Local 200

HEAT & FROST INSULATORS LOCAL 5

[Signature]

[Signature]

Walter W. Weldon

[Signature]

St. Delmont Iron

Jim Thurman

Watt KEEBLE

P. Brown

John L. Vazquez GA

Stanley Cole

[Signature]

[Signature]

Gene Brown

[Signature]

Raymond Johnson

Frank W. Miller

[Signature]

[Signature]

[Signature]

[Signature]

[Signature]

SCDC

FUEL Local 18

Bricklayers #4

SHEET METAL 105

RWA 36

Local 733

UA LOCAL 398

Ironworkers Local 416

Ironworkers Local 933

U.A. Local 250

PAT DC 30

T. Lo MARBLE & TERRAZZO #18

IBEW #1

IRONWORKERS LOCAL #416

Tomasas Local 986

Boilermakers #92

LABORERS Local 300

Sprinkler Fitters UA 709

Grate Workers Local 345

U.A. Local 345

**LOS ANGELES/ORANGE COUNTIES BUILDING AND CONSTRUCTION
TRADES COUNCIL CRAFT UNIONS AND DISTRICT COUNCILS**

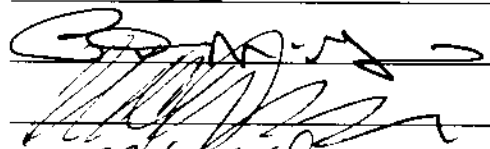

Mickel J. Wilson
Dan S. Hallen

Plaster Tenders #1414
Southwest Carpenters
IUCOE #12
IUCOE Local 12
IUCOE Local 12

ATTACHMENT A – LETTER OF ASSENT

[To be signed by all contractors and subcontractors awarded work covered by the Continuity of Work Agreement prior to commencing work on any Project.]

[Contractor's Letterhead]

Project Labor Coordinator
c/o Hacienda La Puente Unified School District
15959 East Gale Avenue,
City Of Industry, California 91745
Attn: Mark Hansberger

Re: Letter of Assent - Continuity of Work Agreement for Certain Listed Projects

Dear Sir:

This is to confirm that [name of company] ("Company") agrees to be party to and bound by the Hacienda La Puente Unified School District Continuity of Work Agreement effective _____, 2013, as such Agreement may, from time to time, be amended by the negotiating parties or interpreted pursuant to its terms. Such obligation to be a party and bound by this Agreement shall extend to all work covered by the agreement undertaken by this Company on the project and this Company shall require all of its contractors and subcontractors of whatever tier to be similarly bound for all work within the scope of the Agreement by signing and furnishing to you an identical letter of assent prior to their commencement of work.

Sincerely,

[Name of Construction Company]

By: [_____] Name and Title of Authorized Executive

[Copies of this letter must be submitted to the District Coordinator and to the Council Consistent with Article II, Section 2.5(b).]

**ATTACHMENT B
LIST OF PROJECTS**

- A. Energy Efficiency Projects being performed under the District's contract with Schneider Electric

**ATTACHMENT C
CRAFT EMPLOYEE REQUEST FORM**

See attached.

HACIENDA LA PUENTE UNIFIED SCHOOL DISTRICT CONTINUITY OF WORK AGREEMENT

CRAFT REQUEST FORM

CONTRACTOR USE ONLY	Contractor Information
Requesting Contractor:	
Phone:	Fax:

Job Site Information	
Project Name:	
Address:	
Job Superintendent:	
Work Request Start Date and Time:	Estimated Work Duration:

Contractor Requirements					
Employee Classification					
Indicate Level	Craft Position	Quantity	General Dispatch	Local Hire	Requested Skills, Experience, or Certifications and Equipment to Be Utilized
Journeyman	<input type="checkbox"/>				
Apprentice	<input type="checkbox"/>				

UNION USE ONLY	Dispatch Information
Name of Applicant(s) Dispatched:	
Date of Dispatch:	

UNION DISPATCHER: PLEASE CIRCLE THE ZIP CODE OF THE DISPATCHED WORKER(S)													
Local Resident ZIP codes	91744	91745	91746	91748	91790	91792							
Second Tier ZIP codes	91733	91732	90601	90602	90605	90603	90631	92821	91765	91789	91791	91723	91722 91706

ATTACHMENT D
LIST OF NEUTRAL ARBITRATORS

The approved list of Permanent Neutral Arbitrators is as follows:

- (1) Louis Zigman (Bar #48916);
473 South Holt Avenue
Los Angeles, CA 90048
Phone Number: (310) 556-3748

- (2) Edna Francis
3865 Fillion Street
Los Angeles, CA 90065
Phone Number: (323) 344-1026
Joseph Gentile (Bar#40180)

- (3) Law Office of Joseph F Gentile PC
PO Box 7418
Thousand Oaks, California 91359-7418
Phone Number: (805) 499-4282

- (4) Fredric Horowitz (Bar#66237);
P O Box 3613
Santa Monica, CA 90408-3613
Phone Number: (310) 829-6064

EXHIBIT B

AMENDMENT NO. 1

TO THE

CONTINUITY OF WORK AGREEMENT

BY AND BETWEEN

THE HACIENDA LA PUENTE UNIFIED SCHOOL DISTRICT

AND

LOS ANGELES/ORANGE COUNTIES BUILDING AND

CONSTRUCTION TRADES COUNCIL

AND THE SIGNATORY

LOCAL UNIONS AND DISTRICT COUNCILS

THIS AMENDMENT NO. 1 to the Continuity of Work Agreement (“**Amendment**”) is entered into as of April 1st, 2019 and is by and between the Los Angeles/Orange Counties Building and Construction Trades Council and the signatory Local Unions and District Councils (collectively “**Unions**”) and the Board of Education of the Hacienda La Puente Unified School District (“**District**”) (collectively “**Parties**”).

RECITALS:

- A. In 2013, the Parties entered into that certain Continuity of Work Agreement (“**Existing CWA**”).
- B. The Existing CWA applies to the District’s repair, upgrade, renovation, rehabilitation, improvement work and new construction projects awarded by District, as more particularly described in the Existing CWA.
- C. The Parties desire to add to scope of the Existing CWA, and further desire to extend the term of the Existing CWA for an additional five (5) year period.
- D. District and the Unions desire to amend the Existing PLA as set forth in this Amendment.

NOW, THEREFORE, it is mutually agreed by and between the Parties as follows:

AGREEMENT:

1. Section 1.1 of the Existing CWA is hereby amended by deleting it in its entirety and replacing it with the following new Section 1.1 as follows:

Background. The goal of the Board of Education is to continue to improve and rehabilitate the District’s facilities so as to provide sufficient facilities and technologies to properly educate the children within the District’s boundaries. The District’s repair, upgrade, renovation, rehabilitation, improvement work and new construction work described in Section 2.2 of this Agreement are in furtherance of the District’s goals and policies with respect to its facilities. The District, therefore, wishing to utilize the most modern, efficient and effective procedures for construction, including assurances of a sufficient supply of skilled craft persons, and the elimination of disruptions or interference with Project Work, adopts this Agreement in the best interests of the students, parents, District staff, and the taxpayers of the District to meet the District’s goal that the Project Work be completed on time and within budget.

2. Section 1.2.6 of the Existing CWA is hereby amended by deleting it in its entirety and replacing it with the following new Section 1.2.6 as follows:

“Project” or “Projects” or “Project Work” means the District’s repair, renovation, rehabilitation, upgrade and improvement work described in Section 2.2 of this Agreement.

3. Section 2.2 of the Existing CWA is hereby amended by deleting it in its entirety and replacing it with the following new Section 2.2:

Section 2.2 Specific The work covered by this Agreement is defined and limited to:

(a) All repair, upgrade, renovation, rehabilitation, improvement work and new construction work for contracts that exceed \$200,000.00; and

(b) It is understood by the Parties that the District may at any time, and at its sole discretion, determine to build additional projects under this Agreement which are not currently proposed or do not meet the threshold requirement under subsection (a), above.

4. The first sentence of Section 21.1(a) of the Existing CWA is hereby amended by deleting it in its entirety and replacing it with the following new paragraph:

This Agreement shall be effective from April 1, 2019 and shall remain in effect until April 1, 2024.

5. Attachment B of the existing PLA is hereby deleted.
6. Except as expressly amended by this Amendment, the Existing PLA remains in full force and effect as originally executed.

IN WITNESS WHEREOF, the parties have caused this Amendment to be duly executed and delivered as of the above date.

LOS ANGELES/ORANGE COUNTIES
BUILDING AND CONSTRUCTION
TRADES COUNCIL

Dated: 5-2-19

BY: 

HACIENDA LA PUENTE UNIFIED
SCHOOL DISTRICT

Dated: 4/16/19

BY: 

EXHIBIT C

PHASE 1

PHASE 3

PHASE 2

60 working days

45 working days

60 working days

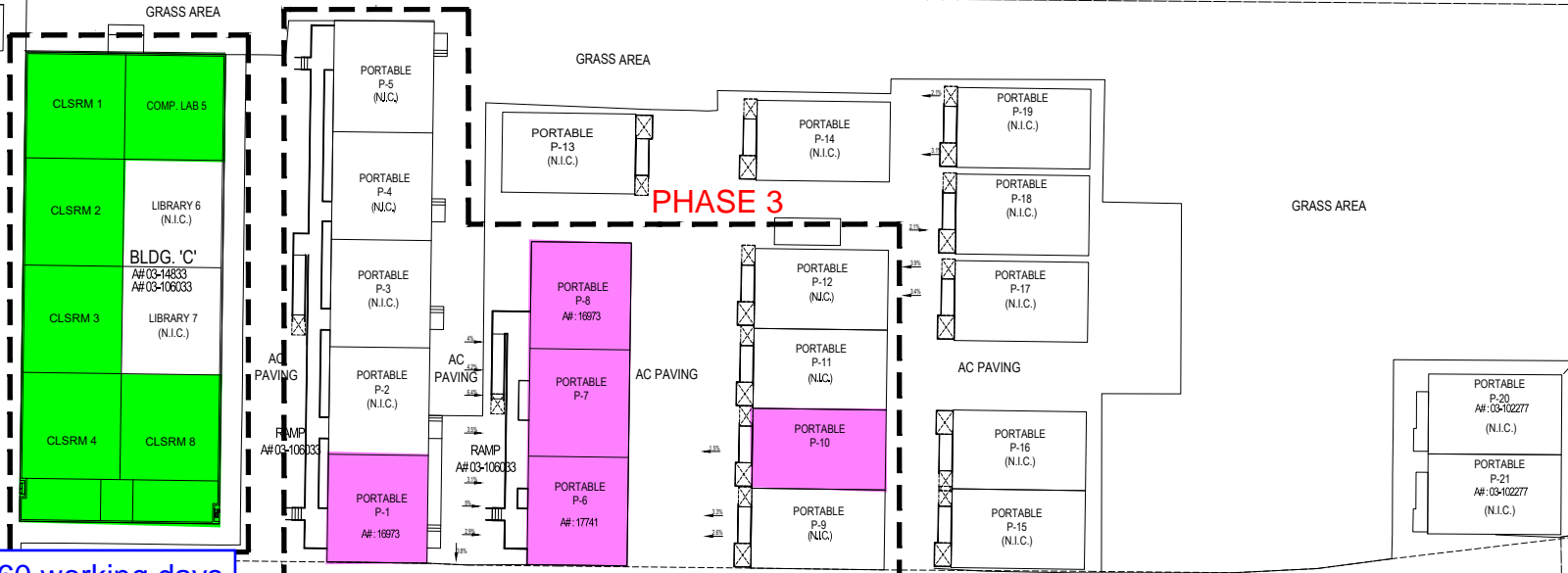

BALDWIN ACADEMY PHASING PLAN

EXHIBIT D

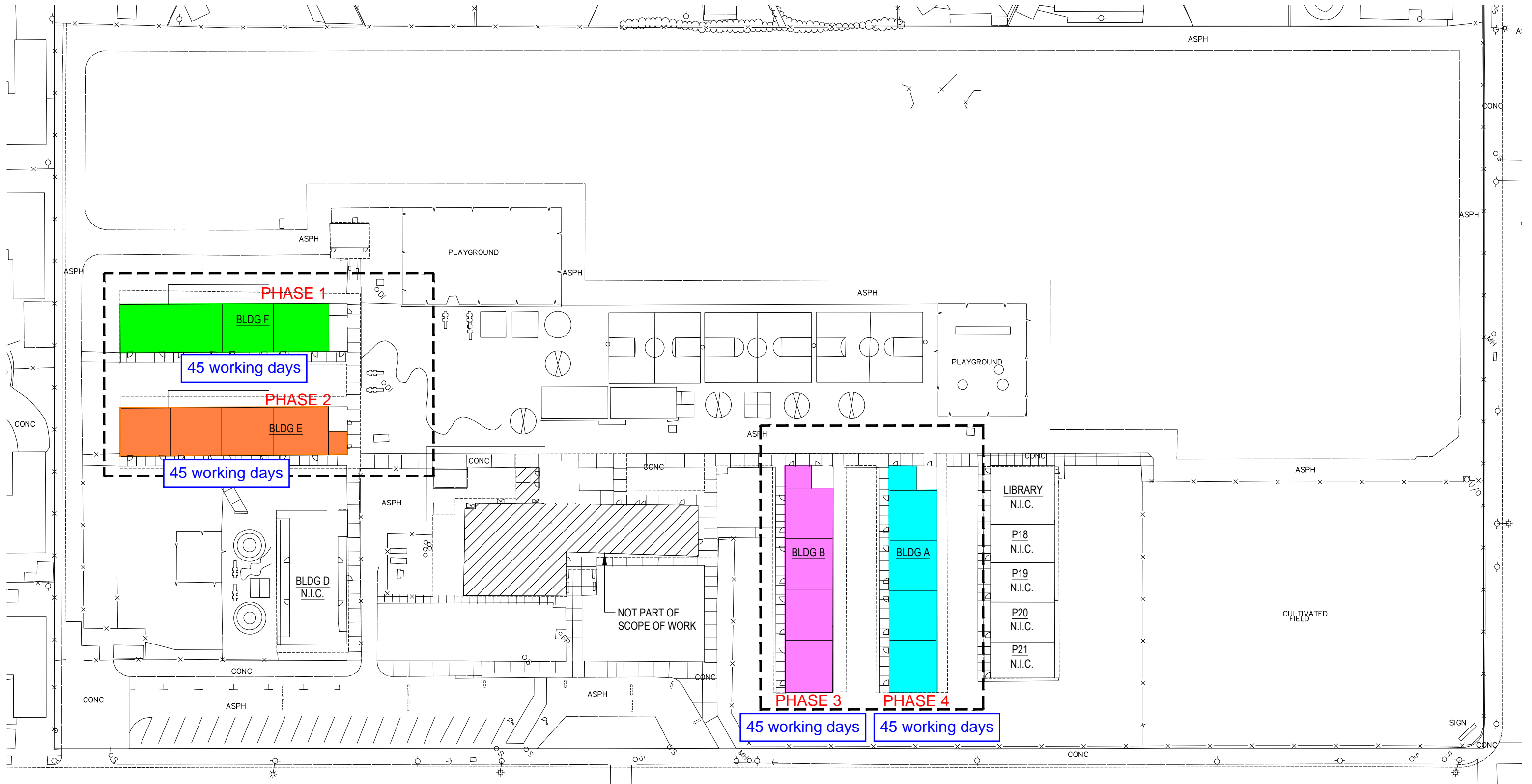

CALIFORNIA ELEMENTARY SCHOOL PHASING PLAN

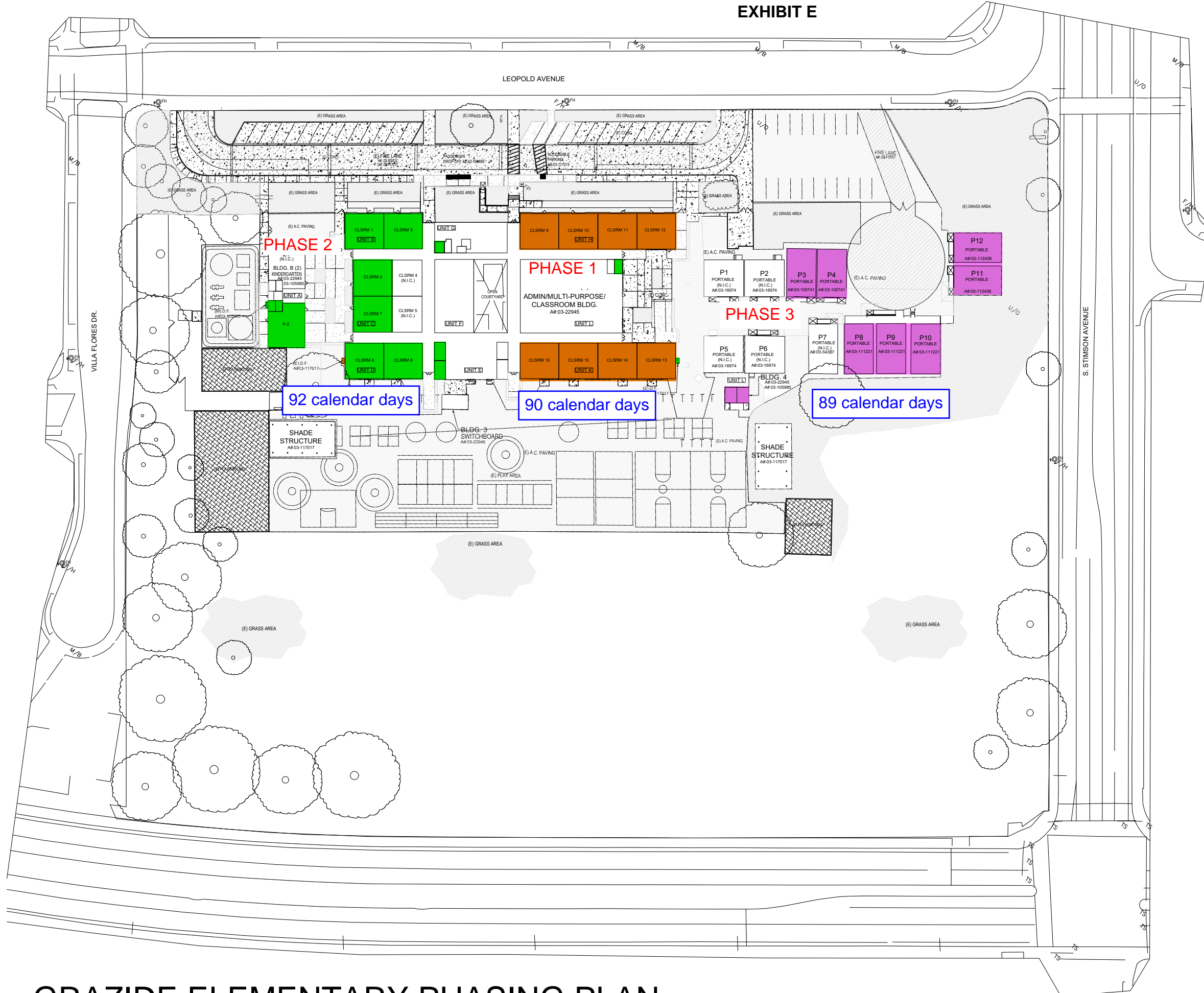

GRAZIDE ELEMENTARY PHASING PLAN

EXHIBIT F

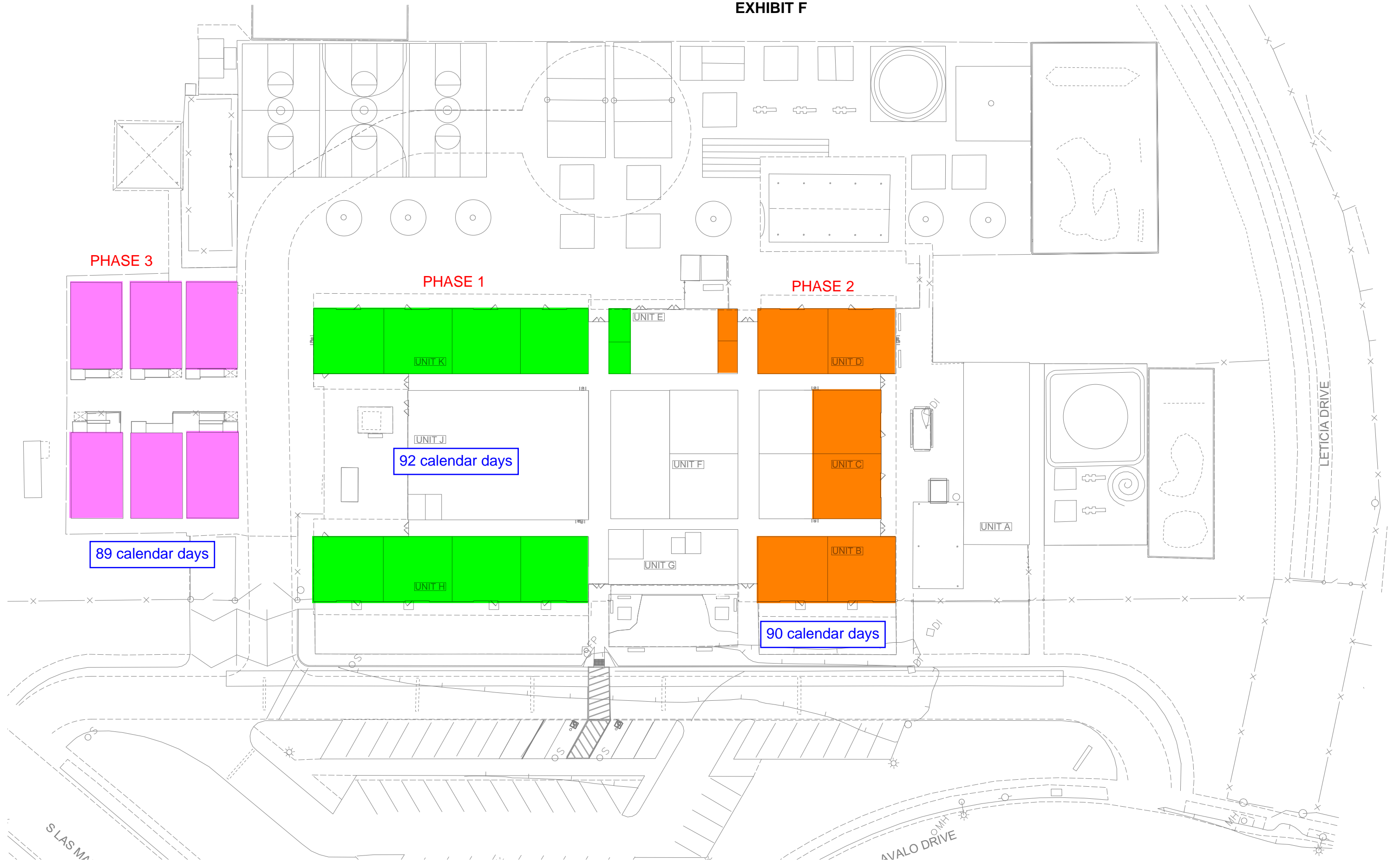

LOS MOLINOS ELEMENTARY SCHOOL PHASING PLAN