



## The Proposed Referendum Plan

This plan includes renovations to the existing school to improve building organization by creating grade-level neighborhoods, ensuring that all grade levels are grouped in the same area. The proposed floor plan also incorporates flexible spaces designed for small group instruction and individualized learning, enhancing the educational environment. Additionally, the design creates a central core area for student common spaces, fostering a sense of community and collaboration among students.

### INFRASTRUCTURE UPDATES

- Update the original heating and ventilation system throughout the building to address a system that is at double its life expectancy. In the winter, temperatures in classrooms can vary from 60 to 85 degrees.
- Update electrical and lighting systems throughout to be more energy efficient and meet current building and educational needs.

## Preliminary Plan

The plan is conceptual at this time. The final design will evolve through further engagement as the building design progresses, pending a successful referendum.

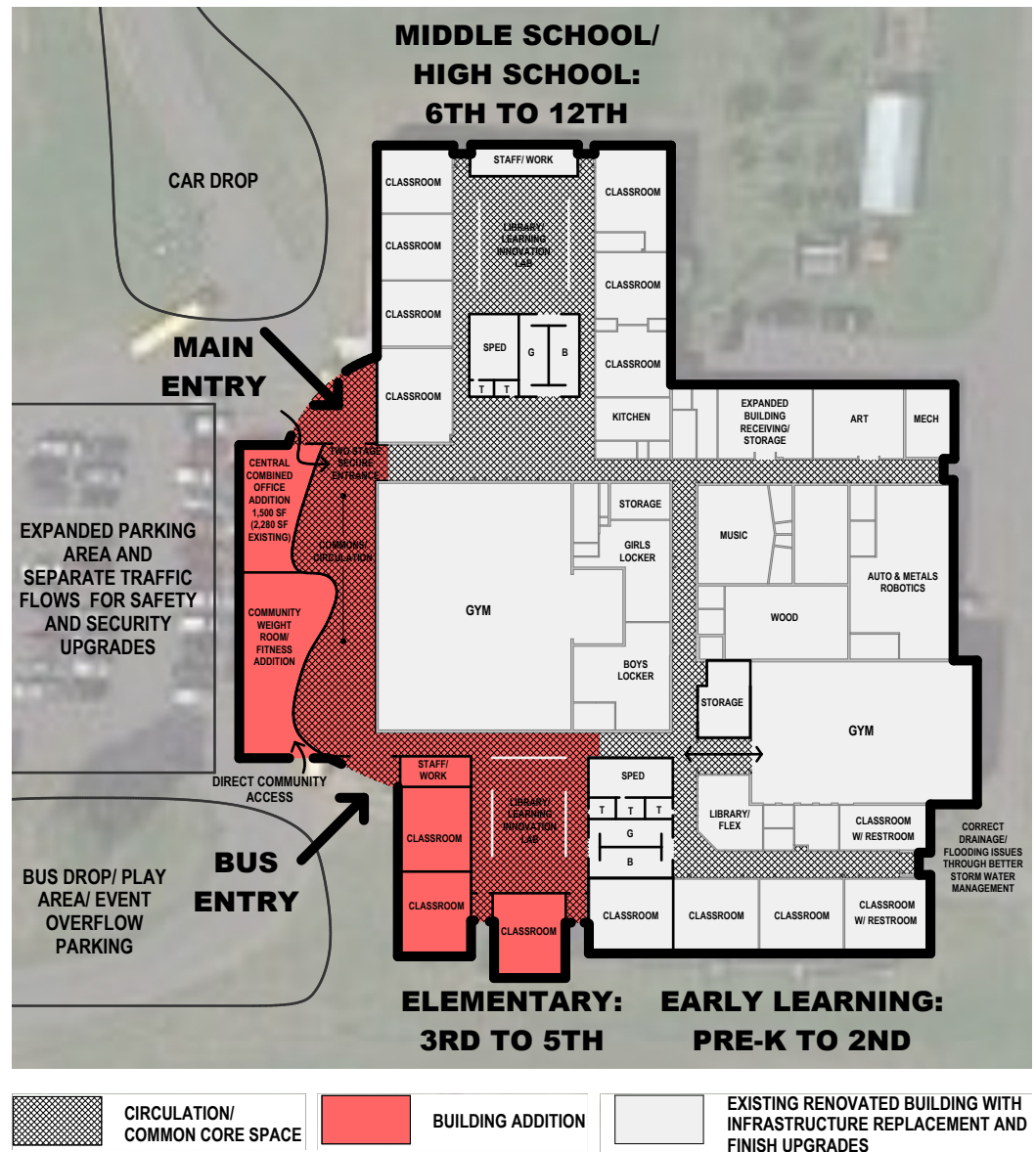

## For More Information

CALL District Office 715.774.3167 | EMAIL referendum2024@sshore.k12.wi.us | VISIT sshore.org | FOLLOW