

Fresno Unified Student Emails

Review the steps below to access students' fresnou.org emails for communications and important school and district messaging

1. Click this [link](#) to go to Outlook Office mail at <https://outlook.office.com/mail/inbox> or by googling Office 365 Login
2. Student emails are their username used to sign into FUSD computers, devices, and [Student Atlas Portal](#) <username>@fresnou.org
3. Usernames and passwords can be found on ATLAS, in the [Parent Portal](#) in the 'Portal Access' tab

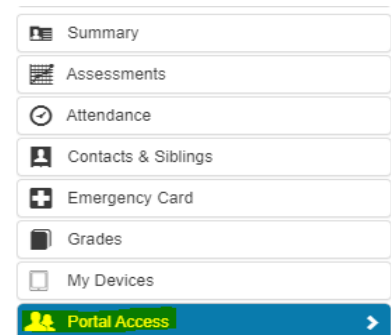
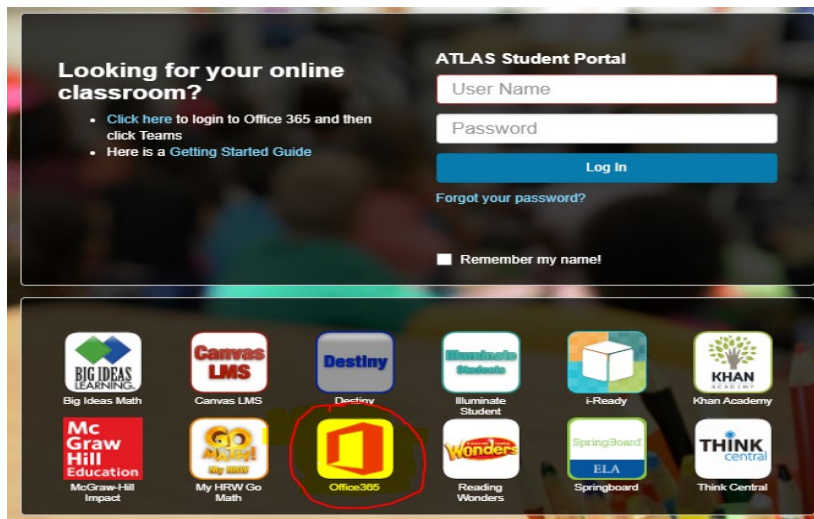
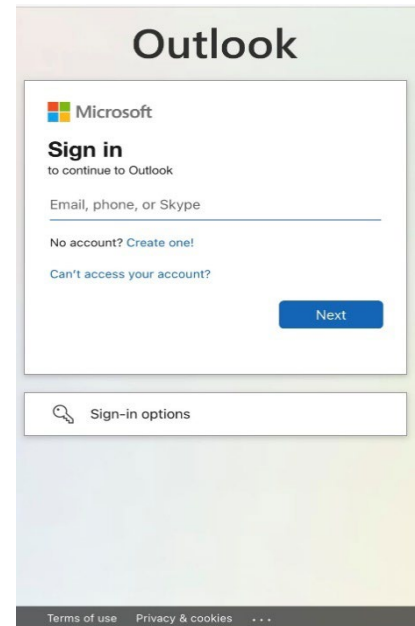

4. If your child does not know their username and password, please contact their teacher or school site for the information or call 559-457-3934.
5. Once logged in, please find the email titled **“ACTION NEEDED: 2024-25 Confidential Family Survey.”**
6. If you have any questions, please contact Kristin Shamlin at 559-457-3934.

Fresno Unified Messaging through ParentSquare

Review the steps below to register for ParentSquare for communications and important school and district messaging!

How to set up your Parent/Guardian account:

1. Download the free iOS or Android app or visit www.parentsquare.com/signin

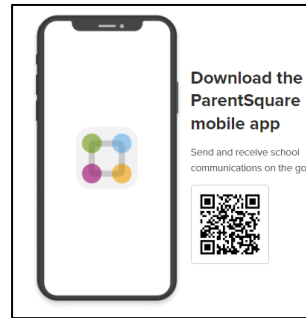

2. Log in with the email or mobile phone and password you have listed in ATLAS

A screenshot of the ParentSquare registration form. The form has a title "Register" and a field for "Email or Phone Number". Below the field is a "Get Started" button. At the bottom of the form, there is a note: "You must use the email/phone you provided to your school". An orange oval highlights this note, and an orange arrow points from it towards the next step.

3. Set up your notification and language preferences in Account settings.

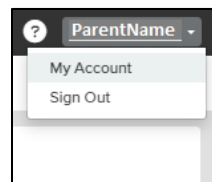

4. Start receiving posts relevant to your student.

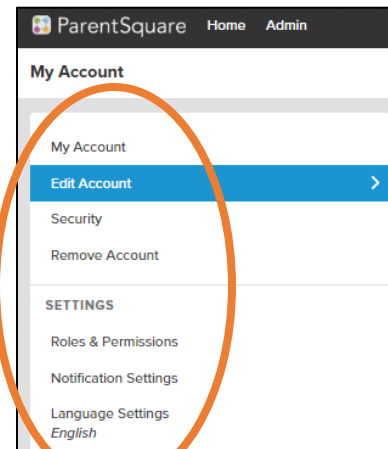

It is important to make sure parents/guardians have an updated and valid mobile number and/or email address in ATLAS to receive notifications from ParentSquare.

Note: For more information about **ATLAS Parent Portal**, please visit our website at:

[Atlas Parent Portal - Fresno Unified School District](#)

If you would like to receive text messages in the case of emergencies, make sure you have a mobile number registered.

For more information, please visit our website at: [ParentSquare - Fresno Unified School District](#)