

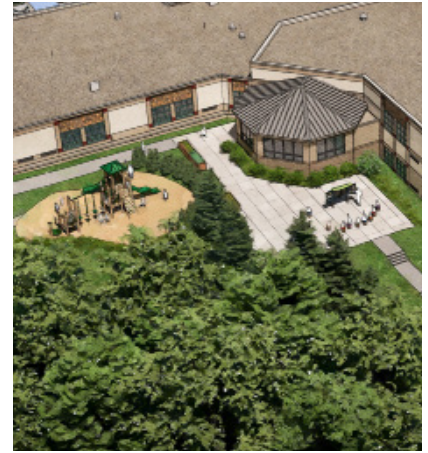

DUNN'S CORNERS ELEMENTARY
DBVW ARCHITECTS



STATE STREET ELEMENTARY
TSKP STUDIO + NORTHEAST COLLABORATIVE



SPRINGBROOK ELEMENTARY
DBVW ARCHITECTS

GROUNDBREAKING ANNOUNCEMENT



Thursday, August 29th
35 State Street
3:30 PM



The Town of Westerly plans to celebrate the upcoming construction of the new State Street Elementary School and renovations of Dunn's Corners and Springbrook Elementary Schools with a groundbreaking ceremony that will be held August 29th at 3:30pm on the grounds of State Street Elementary School at 35 State Street.

The new 48,000 square foot State Street Elementary School will sit behind the existing school and will serve 300 students in grades K-4. Students and staff will transition to the new building in the summer of 2026, after which the existing school will be demolished, and site work will be completed in the fall of 2026.

The improvements at Dunn's Corners and Springbrook Elementary Schools will refresh the interiors, add new community spaces including a new cafeteria and kitchen at Dunn's Corners and an expanded media center at Springbrook, and create lab spaces to promote group learning. The work is currently underway and is scheduled to be completed by the end of summer 2025.

These projects represent a significant investment in the future of Westerly's education infrastructure, providing students with modern, purpose-built learning environments designed to meet the needs and standards of 21st-century education. We hope you will join us for this event!

For more information, please visit www.wpsri.org/quicklinks



RIDE Rhode Island
Department
of Education

TSKP
STUDIO

NCA

DBVW
ARCHITECTS

D
DOWNES
CONSTRUCTION COMPANY