



Stafford County Public Schools High School #6 - Design Update

SCHOOL BOARD MEETING

September 13, 2022



Current Site Plan

Overall First Floor Plan

- Department Legend
- 01 ADMINISTRATION
 - 03 TEACHING AND LEARNING
 - 05 SCIENCES
 - 10 MEDIA
 - 11 FOOD SERVICES
 - 12 BUILDING SERVICES
 - 15 STAIRS
 - 16 CIRCULATION
 - Next Gen

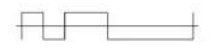



Main Entrance



Gym Entrance



Dining



Café at Library

Learning Cluster Axon

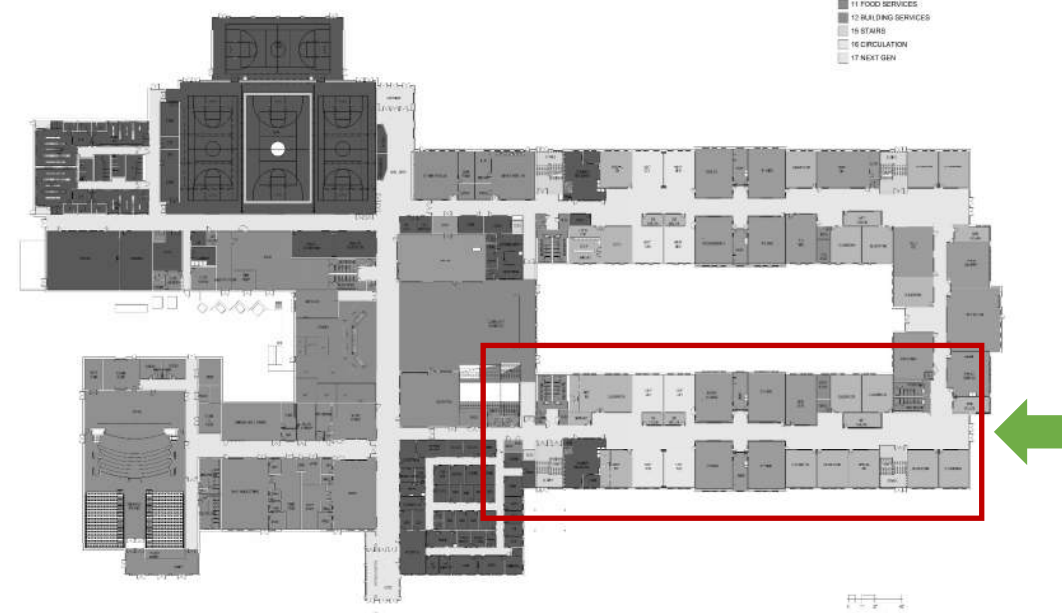
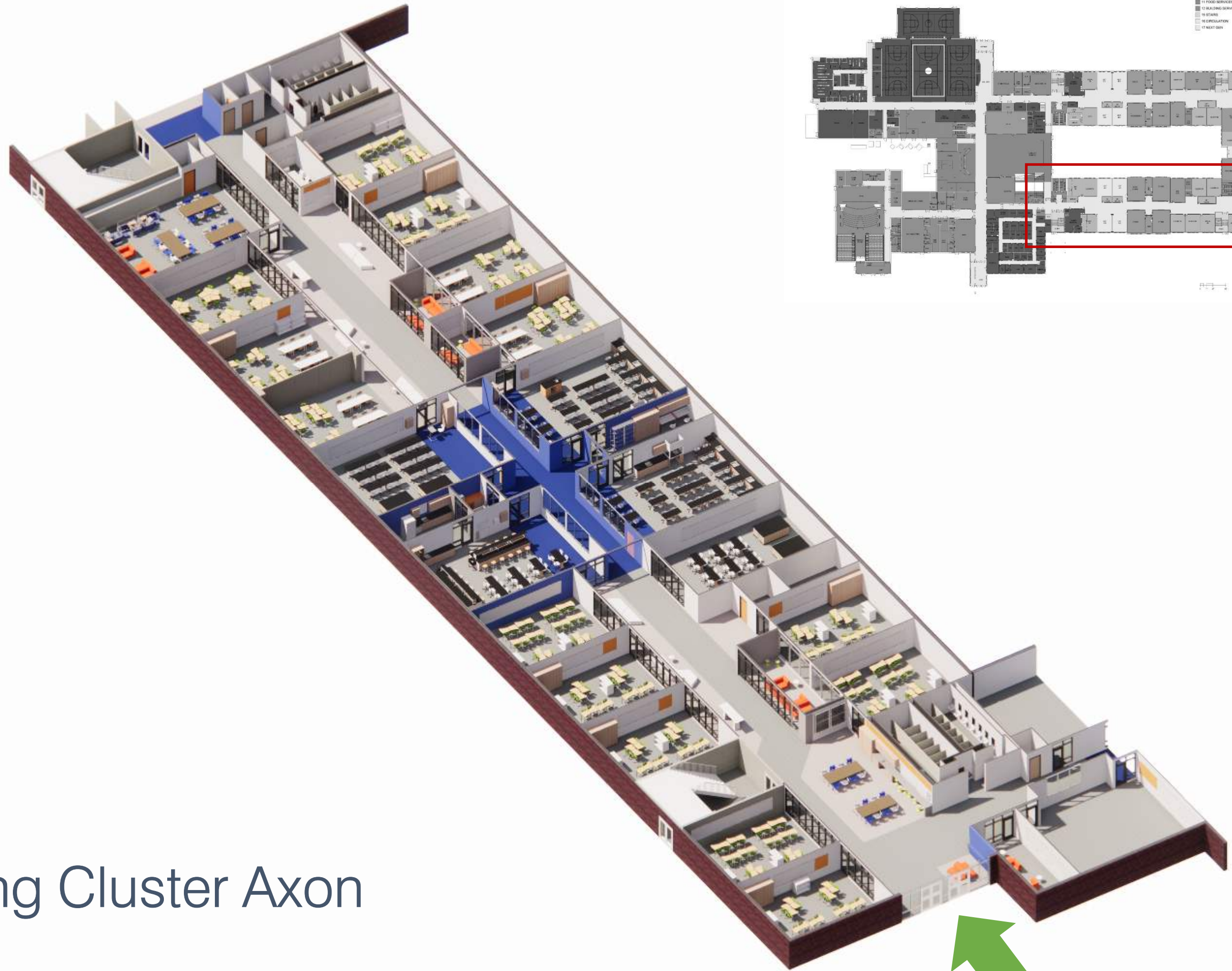

Comparison to other High Schools

High School #6

- 293,000 gsf
- 2,150 students

Rebuild Stafford High School

- 290,557 gsf
- 2,150 students

Mountain View High School

- 271,439 gsf
- 2,150 students

Colonial Forge High School

- 269,195 gsf
- 2,175 students

Brooke Point High School

- 281,637 gsf
- 2,125 students

North Stafford High School

- 304,096 gsf
- 2,050 students



Cost Saving Ideas

- Two story building vs. three story building allows for a reduction in square footage
- Maximizing wall stacking
- Flexible spaces
- Low slope roofs
- Regular structural grid
- Concrete foundation walls
- Mix of masonry & metal panel
- All electric building
- Solar panel ready



Managing Risks

- Prequalify contractors
- Additional construction time
- Supply chain issues
- Current market conditions
- Value engineering
- Coordination with County staff
- Permit review
- Community engagement

