



# sparks



## INDIVIDUAL CAMPUS SUPPLEMENT

---

2024-2025

# TABLE OF CONTENTS

OPENING LETTER FROM PRINCIPAL .....	4
CAMPUS ACADEMIC SUPPORT .....	5
Academic Support .....	5
Homework Policy .....	5
Tutorial Requirements .....	6
Special Education .....	6
CAMPUS CULTURE.....	7
Student Recognition .....	7
Awards & Ceremonies .....	7
Positive Incentives and Rewards .....	8
Academic Field Trips.....	8
Chaperone Procedures .....	8
Special Needs.....	9
Requesting a Teacher Conference .....	9
Before School Expectations and Procedures.....	9
Building Hours .....	9
Morning Drop Off.....	9
Walking Students to Class .....	10
After School Expectations and Procedures.....	10
After School Programming .....	10
Food and Drink Expectations .....	10
Birthday Celebrations.....	11
Dress Code Expectations .....	11
Uniform Daily Expectations.....	12
CAMPUS OPERATIONS.....	13
Front Office Hours.....	13
Students Arriving Late to School.....	13
Lunch Time Expectations.....	13
Lunch Visitors .....	13
Procedures to Drop off Student Lunch .....	13
Traffic Procedures.....	14
Parking Lot .....	14
Flow of Traffic .....	14
Early Line Up .....	15
Dropping off Items for Students.....	15
Former Student Visits.....	15
Family Compact.....	16

Statement of Purpose.....16  
2024-2025 Parent & Family Engagement (PFE) Program .....16

# OPENING LETTER FROM PRINCIPAL

Welcome to East End Elementary, home of the Sparks!

We are overjoyed to have you become a part of our family. You are joining a community that will work as one to ensure each student reaches their potential. Throughout the school year, we are committed to providing an engaging and inspiring educational journey. Our team is devoted to helping every student reach their fullest potential, both academically and personally.

We embrace a culture of inclusivity and respect, where diversity is celebrated, and differences are seen as strengths. Collaboration is encouraged, and we firmly believe by working together, we can achieve remarkable accomplishments.

Our school has been built with many different supports for you and your students. We have a nurse and clinic to help with physical health. We have a Student Support Counselor and a social-emotional learning program to help relational and mental health. We also offer daily recess, PE twice a week, and a balanced nutrition program for students to build physical health. By assisting with the many different needs of our scholars, we make sure they are ready to do their best learning each day because we believe that with our goal to nurture brilliant minds. Together we will...



Yes, that's right! We believe that by working together, we will win for our students.

Parents and guardians, we value your partnership in this educational journey. Your involvement and support are integral to your child's success, and we welcome your active participation in school activities and initiatives.

The school year ahead promises to be filled with excitement, growth, and discovery. We are eager to witness the sparks of brilliance that will undoubtedly illuminate our school community. Once again, welcome to East End Elementary: Where we will Win as One!

If you have questions about the school or your student's experience, please contact me. I want your experience at our school to be out of this world!

Sincerely,  
*Brian Vannest*

Brian Vannest  
School Principal

[Brian.Vannest@yesprep.org](mailto:Brian.Vannest@yesprep.org)  
[Back to Top](#)

Below you can find the contact information for our admin team here at East End Elementary. Feel free to contact them as needed. We are all here to Win as One!

Name	Role	Contact Information
Brian Vannest	School Principal	<a href="mailto:Brian.Vannest@yesprep.org">Brian.Vannest@yesprep.org</a> (713) 924-5679
Evelyn Gutierrez	Assistant Principal	<a href="mailto:Evelyn.Gutierrez@yesprep.org">Evelyn.Gutierrez@yesprep.org</a> (713) 967-9860
Elizabeth (Liz) Rodriguez	Assistant Principal	<a href="mailto:Elizabeth.Rodriguez@yesprep.org">Elizabeth.Rodriguez@yesprep.org</a> (713) 924-5327
Sandra Lewis Allen	Director of Campus Operations	<a href="mailto:Sandra.LewisAllen@yesprep.org">Sandra.LewisAllen@yesprep.org</a> (713) 924-0532
Marisol Tovar	Student Support Counselor	<a href="mailto:Marisol.Tovar@yesprep.org">Marisol.Tovar@yesprep.org</a> (713) 967-7908
Anais Barrera	Dean of Instruction	<a href="mailto:Anais.Barrera@yesprep.org">Anais.Barrera@yesprep.org</a> (713) 924-5545
Caroline Frederick	Resident Principal	<a href="mailto:Caroline.Frederick@yesprep.org">Caroline.Frederick@yesprep.org</a> (713) 842-5567

## CAMPUS ACADEMIC SUPPORT

### Academic Support

YES Prep East End Elementary strives to ensure that in every classroom, every day, all students engage in rigorous and active learning increasing their college readiness. Our academic program will reflect this vision and execute on this promise. Our elementary academic programming has been thoughtfully designed to ensure students achieve and become passionate learners through high volume reading, solving real world and complex math problems, engaging in scientific inquiry, practicing persistence, building positive relationships, and understanding the world around us in a collaborative community. Each day at YES Prep East End Elementary is designed to be filled with joy and opportunities for students to find their own voice to express their ideas, advocate for their needs, and discover new talents to be on track for sixth grade and ultimately college and beyond. We firmly believe that doing is at the core of learning. At YES Prep East End Elementary, students will benefit from aligned, knowledge building, and active instruction, facilitated by passionate teachers, leaders, and support staff in the areas of literacy, math, science, and social studies. Additionally, we are committed to the entire child through fine arts, physical education, and STEM programming along with daily recess, social and emotional support, free breakfast and lunch, and after school opportunities. Our 7:25 a.m. to 3:00 p.m. school day has been designed for active learning. This includes whole group, small group, and independent TEKS-based instruction, guided inquiry, hands-on learning, instructional technology, and relationship and community building to meet the needs of all students.

Students who demonstrate a need for increased academic/behavioral support through our Multi-Tiered Systems of Support & Response to Intervention (RTI) process may be assigned additional support to ensure their success at school. If students qualify for these additional supports, guardians will be notified. In addition, East End Elementary will have interventionists, a Special Education Manager, and additional Special Education staffing to support our special populations of students so that ALL students can show academic, social-emotional and linguistic achievement and growth.

### Homework Policy

Homework is any task assigned by teachers and meant to be completed outside of the school day.

[Back to Top](#)

The purpose of homework is to reinforce concepts and skills taught during the day. Homework is an opportunity to practice what a student learns during the day. We also encourage students to engage with Imagine Learning apps for 20 mins at least two times a week at home.

- Allow your student to work as independently as possible.
- Create homework routines that support daily homework time.
- Communicate with the teacher if your student needs special considerations regarding homework.

**Note:** Please understand that teachers cannot accommodate requests for homework in advance. Homework will be communicated upon return from an absence but is not required for the student. For extended absences, families should reach out to campus administration.

Grade Level	Homework Requirements: Assigned by teacher
Pre-K	<ul style="list-style-type: none"> <li>• Read or listen to a book with your student for 15 minutes</li> <li>• Complete a ReadyRosie activity assigned by your teacher</li> <li>• Ask them to retell what they learned in Language Arts or Math</li> </ul>
Kindergarten	<ul style="list-style-type: none"> <li>• Read or listen to a book with your student for 15 minutes</li> <li>• Optional 10 minutes of homework pages from Eureka Math, Arriba, or FUNdations</li> <li>• Ask them to retell what they learned in Language Arts or Math</li> </ul>
First Grade	<ul style="list-style-type: none"> <li>• Read or listen to an audio book with students for 15 minutes</li> <li>• Required 10 minutes of Eureka Math, FUNdations, or Arriba homework</li> </ul>
Second Grade	<ul style="list-style-type: none"> <li>• Read a book with students for 20 minutes</li> <li>• Required 10 minutes of Eureka Math, FUNdations, or Arriba homework</li> </ul>
Third Grade	<ul style="list-style-type: none"> <li>• Read a book with students for 20 minutes</li> <li>• Required 10 minutes of Eureka Math, FUNdations, or Arriba homework</li> </ul>
Fourth Grade	<ul style="list-style-type: none"> <li>• Read a book with students for 20 minutes</li> <li>• Required 15 minutes of Eureka Math, FUNdations, or Arriba homework</li> </ul>
GLOW/SHINE	<ul style="list-style-type: none"> <li>• Read or listen to a book with your student for 15 minutes</li> <li>• Converse with student about their school day</li> <li>• Ask them to retell what they learned in Language Arts or Math</li> </ul>

## Tutorial Requirements

YES Prep East End Elementary is committed to supporting students academically and strives for every student to achieve on grade level. To provide students with additional academic support, some students will be assigned **required** tutorials after school. Required students will be identified by The EEE Academics Team based on data from previous year’s STAAR scores, previous and current MAP scores, and TELPAS scores. More information is forthcoming about specific days/times that students will be staying for required tutorials. Students required to stay will receive written communication from the school about their assigned tutorials.

We will prioritize tutorials over extracurricular activities such as clubs, sports, and events.

## Special Education

YES Prep complies with the Individuals with Disabilities Education Act (IDEA). When a student enrolls at YES Prep, we provide that student with a free and appropriate public education that meets their needs. The Special Education team at East End Elementary School, as well as other Elementary schools within YES Prep, provide a continuum of services deemed appropriate by the ARD committee for each student from direct instruction to in-class support in

[Back to Top](#)

the general education classroom. Our Special Education teams also offer support for socio-emotional and behavioral needs.

If there is a concern within a child's academic or behavioral needs, our staff is trained to monitor and recognize when a child is to be referred for Special Education evaluation. If families have academic or behavioral concerns about their child, they may reach out to our SpEd Manager. Families may request Special Education testing at any time by reaching out to the Special Education Manager or using the QR code on the poster in the front office.

## CAMPUS CULTURE

### Student Recognition

YES Prep celebrates high academic achievement as well as student academic progress and social-emotional growth. At YES Prep East End Elementary school, students will be recognized during the weekly family gathering where we will celebrate students for displaying characteristics of the core value being celebrated during that grading period (nine-week marking period).

Every Friday during recess time, grade levels will meet during Family Gathering to create community, celebrate each other and recognize students who exemplified the school's core values. One student per class will be recognized for celebrating the core value of the quarter. One student per class will also be given the student of the week award and yard sign. Yard signs will be sent home on Fridays and should be returned by Wednesday of the following week.

### Awards & Ceremonies

At the end of each quarter, we'll have small grade level ceremonies for students to celebrate with each other. Parents of students receiving awards will be invited to the small gathering. Students will be recognized with the following awards:

- **Attendance Award:** Recognizing all students that achieved perfect attendance throughout the quarter
- **Passionate Award:** Recognizing one student per class who engaged the most in Imagine Learning Usage
- **Achiever Award:** Recognizing a student who is committed to academic excellence by consistently going beyond expectations.
- **Relentless Award:** Recognizing a student who demonstrated a commitment to their growth.
- **Kind Award:** Recognizing one student per class who works together to create a joyful environment with their EEE community.
- **SPARKS Award:** Recognizing two students per classroom who demonstrated the current core value regularly.
- **Core Enrichment Awards:** Core Enrichment teachers will recognize students from each grade level (roughly 2 per class) who show special talents, growth, and/or dedication in Core Enrichment.

At the end of the year, we'll have an EOY Ceremony for each grade level so families can gather to celebrate their student's accomplishments. Students will be chosen to receive awards for attendance (in alignment with district policy), commitment to academic excellence, commitment to growth, and exemplifying core values.

- **Attendance:** Recognizing all students who achieved perfect attendance for the entire year
- **Core Value Awards:** Recognizing two students per classroom for demonstrating each of the SPARKS core values throughout the year.
- **Core Enrichment Awards:** recognizing a student per grade level that exhibits Energizer=PE, Creator=Art, Innovator =Stem, Community Leader=library

- **MAP Awards:** All students that met or exceeded their MAP Reading and/or Math growth goals will be eligible to receive a MAP award.
- **Individual student awards:** Every student will receive an individual certificate highlighting their special contribution to the class. These will be given in classrooms or grade level celebrations at the end of year.

## Positive Incentives and Rewards

YES Prep East End Elementary is always looking for ways to celebrate SPARKS who are living out our core values and going above and beyond. Students can be recognized for their hard work and actions by receiving ClassDojo Points.

In addition, there will be opportunities for our SPARKS to receive other positive incentives and rewards for whole class recognition or in conjunction with a school goal.

## Academic Field Trips

Field trips are recognized as important moments in learning; a shared social experience that provides the opportunity for students to encounter and explore novel things in an authentic setting. Field trips will be arranged by the teacher as an extension of the school curriculum. All students will be expected to attend field trips as it is a learning activity unless families decide they do not want their child to attend. In cases where a student's attendance is below 90%, we reserve the right to not invite a student on a field trip. We value the experiences children can get through field trip experiences and want to highlight that academic readiness is our priority, especially for our students with excessive absences.

Field trip dates will be communicated to guardians in advance. Guardian approval forms will be sent home to be signed and returned. No student will be permitted to attend a trip without written permission on the appropriate form. The signed permission form must be returned to the teacher no later than three days before the field trip.

There will be at least 2 adults per classroom, not including the classroom teacher. Assisting teachers with field trips is an integral part of our volunteer program for guardians (see chaperones section below). A guardian may be requested to accompany their child on the field trip if the teacher has concerns regarding the student's ability to stay with the group or follow directions.

## **Chaperone Procedures**

Guardians will be allowed to assist as a chaperone on field trips but must follow the process put in place to ensure that our students are safe. If guardians are interested in being a chaperone, they must submit a form to complete a background check. Our front office and administration will share a web link through which guardians can complete the form. It is the same form used for any volunteering guardians do on campus. Guardians who are serving as chaperones must be cleared at least 72 hours before a field trip. It can take up to two weeks for a background check to be processed and cleared, so we recommend an interested guardian to complete it ASAP. The day of the field trip, chaperones must report to the front office for a visitor's tag.

If the campus gets more volunteers than the destination requires, names will be drawn to designate who will be the official chaperones. We will prioritize guardians not selected in a previous school year at YES to chaperone.

Adults must ride school buses with the class they are chaperoning. Appropriate attire must be worn that is conducive to a school setting. Guardians may not bring siblings or other family members or friends on field trips. Guardians on field trips are there as chaperones to support the educational extensions of the classroom. To protect all students' safety, guardians are not to take their child or any children away from the group or outside of the teacher supervision. The principal reserves the right to limit the number of chaperones or deny certain individuals from acting as chaperones.

Students identified with special needs will have equal access to the school program, including field trips. All students with special needs are encouraged to participate in field trips unless the ARD committee has decided otherwise and is clearly stated in the student's annual ARD. Students with special needs will most likely join the field trip for the grade level they are in.

To ensure that students with disabilities have equal access to the school program, any student with a disability that requires an accommodation or related aids and services to participate in the field trip that is being offered to their peers, will be provided those services. If your child requires special accommodation, please communicate and share documentation with the school as soon as possible to ensure adequate access at school and during field trip opportunities.

### Requesting a Teacher Conference

Strong family engagement is key to student success. There will be at least two scheduled family-teacher conference times during the school year. Our official conference dates this school year are October 11<sup>th</sup> and March 24<sup>th</sup>. Teachers will also let families know in advance when to sign up for these conferences. YES Prep East End Elementary will have several events during the year to build relationships with families and discuss academic and behavioral progress (Meet the Teacher, family conferences regarding report cards, open house, academic nights, etc.) We have regular systems of communication regarding classroom and school information (Family Sparks News, ClassDojo communication, phone calls etc.). In addition to the events and structures mentioned, teachers and staff are available to meet with families. To request a teacher conference, families should do the following:

1. Contact the teacher or staff member directly through ClassDojo to request a conference. All staff members are connected to our School ClassDojo.
2. If a staff member cannot be reached, the family should contact the front office, and a member of the staff will follow up within 48 hours.
3. Conferences with teachers will not be scheduled during instructional time. Conference times will be held during the teacher's conference times or before/after school, depending on their availability. If cancelling a conference appointment, please call at least 24 hours in advance so another guardian conference may be scheduled. If you call during the day, the teacher may not have a break until after school is out. Therefore, teachers make every effort to return messages and phone calls within 24 hours.

### Before School Expectations and Procedures

#### **Building Hours**

YES Prep East End Elementary will be open to students and guardians from 7:00 am to 3:45 pm on Monday – Friday. Between 2:00 – 3:00 pm, our building is closed to visitors to allow us to prepare for dismissal. However, you can still call our front office during this time. There are events for which our building is closed to visitors, such as STAAR testing. Parent communication will go out in advance of these dates, so parents have time to plan accordingly.

#### **Morning Drop Off**

Morning Drop off is from 7:00 – 7:25am. Students are expected to be in the school ready to learn by 7:25am.

Car Riders: The YES Prep East End Elementary gate will open to allow guardians to begin morning drop-off at 7:00 am. Staff members will begin unloading students from the guardian's vehicle. For the safety of our students, guardians should place their vehicles in park and remain in their vehicles as the staff member unloads your child. The staff member will guide students to the entrance, and the students must walk to the cafeteria.

[Back to Top](#)

Walkers: Walkers should walk to the front entrance and walk directly to the cafeteria side door; this is only reserved for families in which there is no possibility of joining the car line. Families/students that arrive in a vehicle and park in our parking lot will be asked to join our car line.

Late Arrival (7:25am+): Parents will park in our front parking lot (San Saba) and check their student in at the front office. Students should be checked in by an adult as a signature is required.

## **Walking Students to Class**

YES Prep East End Elementary allows guardians to walk their student to the front office of the building. Once a staff member has received the student being walked to school, the guardian is free to leave and should not accompany the student to the classroom.

## **After School Expectations and Procedures**

The YES Prep Elementary after-school expectations and procedures detailed below have been designed to ensure the safety of our students.

- YES Prep East End Elementary begins regular dismissal at 3:00 PM.
- Students are not allowed to stay on campus after school unless they have teacher supervision or are staying for our after-school program.
- If a student leaves campus at dismissal, they are not allowed to return to campus. If students are found on campus without supervision after dismissal, a guardian will be notified immediately.
- Guardians are given a 15-minute grace period to pick up their student. If a concern arises with a family continually picking up their child late from school, the leadership team will address this with the family and YES Prep Public Schools may report to local authorities and/or Child Protective Services.
- The YES Prep Public Schools Code of Conduct applies to students at any time while on campus, including after school activities and events.

## **After School Programming**

YES Prep East End Elementary will continue to offer after-school programming. ASPIRE will provide a safe and engaging program for students to focus on skill building, academic enhancement, relationship building and athletics. The program begins immediately after school and ends at 4:45 pm. To remain in the program, students must be picked up by 5:00 pm daily; they cannot be picked up before 4:45 pm so that staff can remain with students and ensure they are safe and supervised. All students should be picked up by 5:00pm. Dismissal will be the same as car rider arrival and dismissal. Enrollment is completed online and accepted year-round based on available seats. Anyone interested in programming should complete the student registration form that will be distributed later.

## **Food and Drink Expectations**

Food and drink are only permitted in the classroom during designated snack times. Food is not permitted in other areas (including the hallways) except for students whose medical needs require them to eat at other times during the day.

Water is the only drink permitted outside of the cafeteria. Sugary and /or caffeinated drinks are strongly discouraged during breakfast or lunch.

Any food that students bring must be sized for an individual person – students may not bring “family size” chips as students are not allowed to share food with each other. Students are discouraged from bringing candy or other items

[Back to Top](#)

with minimal nutritional value as their meals. All YES Prep students can eat free breakfast each morning and access free lunch during the school day.

## Birthday Celebrations

YES Prep elementary staff members look forward to celebrating each child’s special day with them and their classmates. To minimize disruption to instruction, families must follow the birthday guidelines below:

- Birthday celebrations in the classroom will ONLY take place on Friday. If there isn’t school on Friday that week, it should occur on the last school day of the week\*.
- Birthday celebrations will start at 2:40 pm and should end by 3:00 pm to ensure safe dismissal procedures.
- Birthday treats must be store bought. Food made at home may NOT be distributed within school.
- Families are encouraged to bring individual servings such as cupcakes or cookies; whole cakes or cookie cakes are not allowed.
- Guardians are welcome to attend the classroom celebration and should arrive by 2:30 pm.
- YES Prep understands not all guardians will be able to attend classroom celebrations. In these cases, birthday treats must be dropped off at the front office on Friday\* no later than 1:30 pm. The campus Front Office will deliver birthday treats to classrooms by the time the classroom teacher and classmates will celebrate the child’s birthday.

## Dress Code Expectations

See more about the YES Prep Dress Code Philosophy and Policy in the [YES Prep Student Handbook](#). The following table breaks down how the campus expects students to follow the dress code policy. As a reminder, a student’s most outer visible layer of top must be YES Prep branded.

Dress Item	Expectation
<b>YES Prep Shirts</b>	<p>Students are required to wear a YES Prep Polo or YES Prep Spirit Shirt 5 days of the week to strengthen school pride, unify the community, and to promote a college-going culture. We highly recommend that students wear their YES Prep Polo on Monday’s.</p> <p>All YES Prep students should own at least 1 campus polo.</p> <p><i>Students are not required to tuck in shirts.</i></p>
<b>YES Prep Outerwear</b>	<p>Students are required to wear YES Prep-branded outerwear to continue to strengthen school pride, unify the community, and promote a college-going culture.</p> <p>Outerwear must be purchased from YES Prep or the campus Athletic Department.</p> <p>Students may choose from the following:</p> <ul style="list-style-type: none"> <li>• YES Prep sweatshirt (purchased through YES Prep)</li> <li>• Campus athletics department outerwear (purchased through campus Athletics Department)</li> <li>• Campus-issued grade level or spirit sweatshirts, etc. (purchased through campus as applicable)</li> </ul>
<b>Bottoms</b>	<p>Students may choose between pants, skirts, or shorts of the following:</p> <ul style="list-style-type: none"> <li>• Khakis (any color)</li> <li>• Jeans (any color)</li> </ul>

[Back to Top](#)

	<ul style="list-style-type: none"> <li>• Athletic bottoms (any color)</li> </ul> <p>Students should wear bottoms that allow them to comfortably participate in PE. Students may not wear pajama pants or bottoms with holes.</p> <p><i>Shorts and skirts should be no shorter than mid-thigh.</i></p> <p>Bottoms may not have holes/tears below the knee/with leggings underneath.</p> <p>Students are not required to wear belts.</p>
<b>Shoes</b>	<p>Tennis shoes are recommended so students can safely participate in activities at recess and in PE.</p> <p>For safety purposes, all shoes must meet the following criteria:</p> <ul style="list-style-type: none"> <li>• Closed-toed</li> <li>• Must have backs (i.e. no slides)</li> <li>• Must have hard soles (i.e. no slippers)</li> <li>• Any color is permitted</li> <li>• No shoes with heels over .5 inches</li> <li>• Crocs are allowed in sport mode only (straps behind the ankle)</li> </ul>
<b>Accessories &amp; Styling</b>	<ul style="list-style-type: none"> <li>• Spiked accessory items (bracelets, belts, collars) are not allowed for safety reasons.</li> <li>• Students may wear a variety of hairstyles and colors. Head shaving designs are permitted if images are school-appropriate.</li> <li>• Hats and sunglasses are not permitted for safety purposes.</li> <li>• Religious head coverings are permitted.</li> </ul>
<b>Free Dress Tops</b>	<p>Clothing should meet the following criteria:</p> <ul style="list-style-type: none"> <li>• T-shirts are acceptable; however, all clothing and accessories must be school appropriate: YES Prep prohibits pictures, emblems, or writings on T-shirts that are lewd, offensive, vulgar, or obscene or that advertise or depict tobacco products, alcoholic beverages, drugs, or any other substance, show gang affiliation, or depict violence in any way.</li> <li>• No tank tops, halter tops, tube tops, net or sheer tops, shirts with spaghetti straps, or strapless tops for any student.</li> <li>• No bare midriffs (half shirts) allowed for any student.</li> <li>• No open-toed shoes.</li> </ul>

## Uniform Daily Expectations

Students must follow the specific daily expectations for uniforms at their campus as outlined below. Please note that there may be some exceptions to these dress code expectations to accommodate cultural celebrations and traditions. Exceptions to uniform expectations will be communicated to students and families in advance.

Day of the Week	Dress Code Expectations
<b>Monday</b>	<i>(highly recommended)</i> Campus polo and navy, khaki, or denim bottoms May wear other YES Prep Spirit on Mondays
<b>Tuesday</b>	Campus polo or YES Prep spirit shirt and navy, khaki or denim bottoms
<b>Wednesday</b>	Campus polo or YES Prep spirit shirt and navy, khaki or denim bottoms
<b>Thursday</b>	Campus polo or YES Prep spirit shirt and navy, khaki or denim bottoms

[Back to Top](#)

<b>Friday</b>	Campus polo, YES Prep spirit shirt, or college shirt and navy, khaki or denim bottoms

Uniform t-shirts, polos, and outerwear can be purchased at our online storefront. Your order will then be prepared by our Operations Team, and we will contact you about picking up your order in our campus main office. The online storefront is located at <https://yesprep.revtrak.net/elementary-schools-/east-end-elementary/#/list>.

# CAMPUS OPERATIONS

## Front Office Hours

7:00 – 2:00 and 3:00 – 3:30

YES Prep East End Elementary will be open to students and guardians from 7:00 am to 3:45 pm on Monday – Friday. Between 2:00 – 3:00 pm, our building is closed to visitors to allow us to prepare for dismissal. However, you can still call our front office during this time. There are events for which our building is closed to visitors, such as STAAR testing. Parent communication will go out in advance of these dates, so parents have time to plan accordingly.

## Students Arriving Late to School

East End Elementary encourages guardians to send students to school regularly and on time because learning is a top priority. Students who arrive after 7:25 am are considered tardy. Parents will park in our front parking lot (San Saba) and check their student in at the front office. Students should be checked in by an adult as a signature is required. After 5 tardies within a 9-week grading cycle, a parent/guardian must meet with a member of the leadership team to discuss the cause of the tardiness and how to best support the student.

## Lunch Time Expectations

### **Lunch Visitors**

All families will be invited to eat with their child at school during special occasions. Notes will be sent home notifying guardians of the dates and times. On most other days, 5 guests per grade level can [sign up](#) to have lunch with the exception of campus testing dates. Families can register using the Sign-Up Genius link in Family Notes.

### **Procedures to Drop off Student Lunch**

If guardians are bringing in lunch for a student, it must be taken to the Front Office by 9:30 am on Monday-Friday. The lunch bag must have the student’s name on it. The meal will be delivered to the cafeteria during their lunchtime. We do not want to interrupt classroom instruction; therefore, we do not notify students that their lunch is in the office and guardians cannot take lunches to students’ classrooms. For the safety of our students, sharing is not allowed.

East End Elementary does not allow food delivery services to students, such as DoorDash, Uber Eats, etc.

## Traffic Procedures

The following procedures have been updated to address the traffic and safety issues. These procedures should be taken seriously, as your student's safety is our absolute priority. Please take the time to read the procedures below and communicate these procedures to ALL family members and childcare providers.

### **Parking Lot**

During designated times at the beginning and end of each normal school day, there will be staff or parking lot attendants outside monitoring activity in the parking lot. Please pay attention to the directions they are giving and ask questions if you are not sure where to go. It is important for all families to follow the same guidelines as this allows each driver and student to know what to expect. Drivers who park and leave their cars unattended in a drive-thru lane pose a safety hazard. If a family needs to park and/or leave their vehicle, please park at the front entrance on San Saba Street.

All students will be shown to use crosswalks properly and advised that they need to walk safely. There should not be any running or playing in the parking lot.

### **Flow of Traffic**

**When:** Drop off is from 7:00 a.m. to 7:25 a.m.

Arrival entrances (including Car Rider Entrance, Special Education Entrance, and Walker Entrance doors close at 7:25 a.m. After 7:25, all students must enter through the main front office doors and be signed in.

**Where (see map):** The drop offline BEGINS at the entrance on Lawndale Street. All cars must stay to the right. DO NOT PASS any cars.

Dropping off: Put your car in park before you let your student out quickly and carefully.

Students are NOT allowed to exit on the left side of the car.

Guardians may NOT get out of the car while in drop-off line.

Do NOT hold up the line to watch your student walk into school.

Leaving: When leaving the drop-off line, wait and follow the car in front of you.

Do not pass cars.

Do not pull out into the center drop-off lane.

Other Notes: On campus, there is a max speed of 10 MPH and NO cell phone use in school zones.

Most importantly, we have around 600 children arriving between 7:00 and 7:25 a.m. every morning. Please be kind and patient with one another. Thank you for helping to make our school campus safe for everyone.

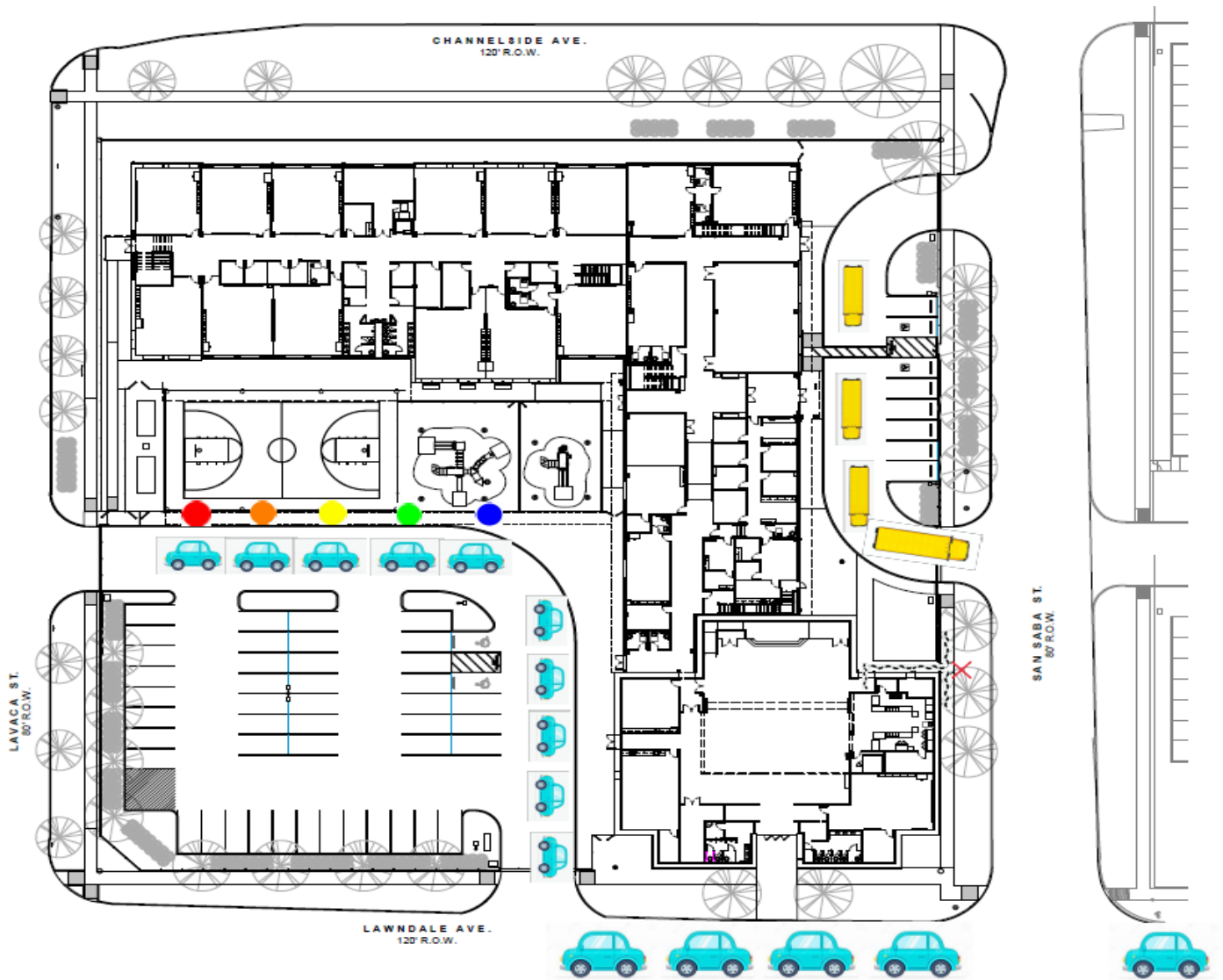

## Early Line Up

Gates will open at 7:00 a.m. We ask that all guardians wait until 7:00 a.m. to arrive on campus. There will be no supervision before 7:00 a.m. Please do not park outside the gate before 7:00 am as this will cause city traffic and may result in a ticket given from the Houston Police Department.

## Dropping off Items for Students

If guardians are dropping items off for a student such as homework, projects, PE clothes, etc., please go to the Front Office. Items should be clearly marked with the student's name and grade. The receptionist will deliver the items to the student's homeroom teacher.

## Former Student Visits

Students not enrolled in YES Prep Elementary will only be allowed on campus with prior approval.

[Back to Top](#)

YES Prep students admitted to partner campuses will only be allowed admittance under the supervision of an adult employee of YES Prep.

# FAMILY COMPACT

## Statement of Purpose

YES Prep Public Schools is committed to working in collaboration with students, families, and other community stakeholders to achieve ambitious student learning outcomes. We recognize that parents and families play an important role as their child’s first teacher and are valued partners in the educational process. As a result, parents and families will be included in appropriate decision-making opportunities to support student achievement. A **school compact** is an agreement between the school, parents, and students to help the student succeed. We will work together to create a strong support network for your child.

ESSA 1116 (d) states, “As a component of the school-level parent and family engagement policy developed under subsection (b), each school served under this part shall jointly develop with parents... a school-parent compact...”

## 2024-2025 Parent & Family Engagement (PFE) Program

What is it?	YES Prep Public Schools strives to provide high-quality education individualized for each student by developing and maintaining relationships with families and the community. One way we continue to do this is by participating in the Title I, Part A State Program. This program provides funding for low socioeconomic schools. In return, we promise to meet the expectations laid out for us by the Texas Education Agency and the United States Department of Education													
Funding	Title I funds will be allocated for the parent and family engagement program. Parents and family members of children receiving Title I, Part A services shall be involved in the decisions regarding use of funds for parental involvement activities.													
Review	YES Prep Public Schools will involve parents in an active and engaging manner to plan, review and improve Title I Part A programs. The LEA’s and campus’s Title I, Part A programs are subject to audit by the Texas Education Agency to ensure that Title I, Part A program requirements are being met.													
Family Meetings	<p>Parent Meetings will be scheduled at your school to plan and communicate relevant information.</p> <p>Meetings will always take place in the cafeteria.</p> <table border="1" data-bbox="310 1493 1511 1860"> <thead> <tr> <th data-bbox="310 1493 570 1528">Meetings</th> <th data-bbox="570 1493 1511 1528">Dates &amp; Notes</th> </tr> </thead> <tbody> <tr> <td data-bbox="310 1528 570 1570">Title I Meeting</td> <td data-bbox="570 1528 1511 1570">Fall Semester</td> </tr> <tr> <td data-bbox="310 1570 570 1633">Open house / Meet the Teacher</td> <td data-bbox="570 1570 1511 1633">Fall Semester – August/September</td> </tr> <tr> <td data-bbox="310 1633 570 1703">Parent Teacher Conferences</td> <td data-bbox="570 1633 1511 1703">Elementary- Fall and Spring All other campuses- scheduled as needed and/or upon Family request</td> </tr> <tr> <td data-bbox="310 1703 570 1797">Family Association Meetings</td> <td data-bbox="570 1703 1511 1797">Dates shared on social media, Family Notes, and YES Prep website By Parent and Family Engagement Policy, hosted once a month on all YES Prep Campuses</td> </tr> <tr> <td data-bbox="310 1797 570 1860">Coffee with the Principal</td> <td data-bbox="570 1797 1511 1860">Dates shared on social media, Family Notes, and YES Prep website</td> </tr> </tbody> </table>		Meetings	Dates & Notes	Title I Meeting	Fall Semester	Open house / Meet the Teacher	Fall Semester – August/September	Parent Teacher Conferences	Elementary- Fall and Spring All other campuses- scheduled as needed and/or upon Family request	Family Association Meetings	Dates shared on social media, Family Notes, and YES Prep website By Parent and Family Engagement Policy, hosted once a month on all YES Prep Campuses	Coffee with the Principal	Dates shared on social media, Family Notes, and YES Prep website
Meetings	Dates & Notes													
Title I Meeting	Fall Semester													
Open house / Meet the Teacher	Fall Semester – August/September													
Parent Teacher Conferences	Elementary- Fall and Spring All other campuses- scheduled as needed and/or upon Family request													
Family Association Meetings	Dates shared on social media, Family Notes, and YES Prep website By Parent and Family Engagement Policy, hosted once a month on all YES Prep Campuses													
Coffee with the Principal	Dates shared on social media, Family Notes, and YES Prep website													
Ways to request regular or	<ul style="list-style-type: none"> <li>• Email campus staff, teachers</li> <li>• Call campus directly</li> </ul>													

[Back to Top](#)

one on one meetings:				
Curriculum & Academic Assessments	<a href="#">YES Prep Curriculum - Academics</a>			
School-Parent Compact	Schools Responsibilities	Guadian/Caregiver's Responsibility	Student's Responsibility	On-going Communication
	<ul style="list-style-type: none"> <li>• Provide academic support to students who need it</li> <li>• Host Title I Meetings and Workshops</li> <li>• Communicate with families about student performance through the Family Portal and School Messenger</li> <li>• Participate in Parent-Teacher Conferences</li> <li>• Build relationships with students and families through home visits and Open Houses</li> <li>• Provide volunteer opportunities for families</li> <li>• Welcome families to observe their child in class</li> <li>• Host Family Association Meetings on a monthly basis and provide a summary of the meeting through Family Notes</li> <li>• Communicate with families, regularly</li> </ul>	<ul style="list-style-type: none"> <li>• Be your child's best advocate.</li> <li>• Make sure your child attends school regularly and on time</li> <li>• Provide transportation for your child to and from school</li> <li>• Encourage, empower, and motivate your child to succeed academically and prepare for college</li> <li>• Create a home environment that supports learning</li> <li>• Make reading a priority at home</li> <li>• Communicate regularly with the school</li> <li>• Attend school events and conferences</li> <li>• Follow the school rules and provide feedback to the staff</li> <li>• Promote your child's health and wellness</li> </ul>	<ul style="list-style-type: none"> <li>• Attend school regularly and be on time</li> <li>• Complete your homework and do your best</li> <li>• Get good grades and strive to maintain a 3.0 GPA</li> <li>• Ask for help when you need it and never give up</li> <li>• Be respectful and take pride in yourself, your community, and your school</li> <li>• Follow the Code of Conduct and protect myself and the safety of others</li> <li>• Practice healthy behaviors</li> <li>• Do whatever it takes to be accepted to and graduate from college</li> </ul>	<ul style="list-style-type: none"> <li>• Campus Communication Platform</li> <li>• Family Notes</li> <li>• Social Media – Instagram and Facebook</li> <li>• STAAR Family Portal <a href="#">LINK</a></li> <li>• Family Association Communication</li> </ul>
	<ul style="list-style-type: none"> <li>• <i>(Campus partner inserts 1-3 additional requests)</i></li> </ul>	<ul style="list-style-type: none"> <li>• <i>(Campus partner inserts 1-3 additional requests)</i></li> </ul>	<ul style="list-style-type: none"> <li>• <i>(Campus partner inserts 1-3 additional requests)</i></li> </ul>	<ul style="list-style-type: none"> <li>• <i>(Campus partner inserts 1-3 additional requests)</i></li> </ul>