

Memorial High School

New Parent Orientation



The Spring Branch Way



• **EVERY CHILD** • **COLLECTIVE GREATNESS** • **COLLABORATIVE SPIRIT**
• **LIMITLESS CURIOSITY** • **MORAL COMPASS**

6 Core Characteristics



Academically Prepared



Ethical & Service-minded



Empathetic & Self-aware



Persistent & Adaptable



Resourceful Problem-solver



Communicator & Collaborator

The Mustang Way



MORALITY IS THE HUMAN ATTEMPT TO DEFINE WHAT IS RIGHT AND WRONG ABOUT OUR ACTIONS AND THOUGHTS. **UNDERSTANDING** IS THE ABILITY TO BE SYMPATHETICALLY AWARE OF OTHER PEOPLE'S FEELINGS AND RESPOND WITH TOLERANCE AND FORGIVENESS. **SPIRIT** IS THE SENSE OF IDENTITY, COMMUNITY, AND ENTHUSIASM SHARED BY MEMBERS OF A COMMUNITY. **TRUTH** REFERS TO A FACET OF MORAL CHARACTER AND ENCOURAGES INTEGRITY AND HONESTY IN ALL SITUATIONS. **APPRECIATION** IS THE ABILITY TO UNDERSTAND AND ACKNOWLEDGE THE WORTH, QUALITY, OR IMPORTANCE OF SOMETHING OR SOMEONE. **NOTEWORTHINESS** REFERS TO THE PRIDE AND HUMILITY ASSOCIATED WITH BEING RECOGNIZED AS INTERESTING. **GRIT** IS PERSISTENCE TOWARD A PURPOSE OR ACTION THAT YOU HAVE DECIDED TO EMBARK UPON IN THE FACE OF ALL SORTS OF DIFFICULTIES. **SELF-RESPECT** IS MAKING CHOICES THAT ALLOW YOU TO FEEL YOUR BEST AND REPRESENT YOUR BEST SELF.

MUST *ang*
LOVE
#MUSTANGLOVE

“Darkness cannot drive out darkness; only light can do that. Hate cannot drive out hate; only love can do that”

Martin Luther King



Administrative Team

Lisa Weir	Building Principal	Ext. 2500	Lisa.Weir@springbranchisd.com
Jennifer Starnes	Associate Principal	Ext. 2537	Jennifer.Starnes@springbranchisd.com
Justin Wright	9th Grade Principal	Ext. 2708	Justin.Wright@springbranchisd.com
Dana Johnson	10th Grade Principal	Ext. 2536	Dana.Johnson@springbranchisd.com
Aly Vanek	11th Grade Principal	Ext. 2512	Alyson.Vanek@springbranchisd.com
Buffie Matthews	12th Grade Principal	Ext. 2511	Buffie.Matthews@springbranchisd.com

Counseling Team

Amina Johnson	A-CI	Ext. 2509	Amina.Johnson@springbranchisd.com
Kelly Turner	Co-Go	Ext. 2538	Kelly.Turner@springbranchisd.com
Teeanna Kelly	Gr-La	Ext. 2514	Teeanna.Kelly@springbranchisd.com
Stephanie Jackson	Le-N	Ext. 2552	Stephanie.Jackson2@springbranchisd.com
Vanessa Benavides	Admin Asst. to Red Office	Ext. 2519	Vanessa.Benavides@springbranchisd.com
Kate Dudek	O-Si	Ext. 2545	Katherine.Dudek@springbranchisd.com
Stephanie Renfrow	Sk-Z	Ext. 2551	Stephanie.Renfrow@springbranchisd.com
Susan Hansen	Admin Asst. to Gray Office	Ext. 2518	Susan.Hansen@springbranchisd.com
Jennifer Mikes	College Rep/Scholarship Asst.	Ext. 2516	Jennifer.Mikes@springbranchisd.com
Karen Mintsioulis	STAT/504 Facilitator	Ext. 2546	Karen.Mintsioulismckim@springbranchisd.com
Brittney Harris	Special Education Facilitator	Ext.2513	Brittney.Harris@springbranchisd.com
Jackson Womack	Wellness Counselor	Ext. 2553	Jackson.Womack@springbranchisd.com
Allison MacKenzie	Wellness Counselor	Ext. 2520	Allison.Mackenzie@springbranchisd.com

Wellness Center

- Located in the new building in room M-205
- Provide students in crisis with interventions that alleviate emotional and behavioral challenges, enhance coping skills, improve student emotional and physical health, and in turn, scholastic achievement
- Interventions target conflict in the home, grief and loss, developmental concerns, Identity issues, verbal or physical aggression, anxiety, withdrawal, suspected drug/alcohol use, and unusual behavior.
- Children in need of these counseling services are identified by referrals from school principals and teachers, and parents.

mustangs4mustangs

Registration/Attendance

Mary Crane	Registrar	Ext. 2504	Mary.Crane@springbranchisd.com
Jackie Vega	Admin Asst. to Registrar	Ext. 2503	Marie.Vega@springbranchisd.com
Rhonda Reese	Attendance Clerk (9 th /11 th)	Ext. 2505	Rhonda.Reese@springbranchisd.com
Janie Sosa	Attendance Clerk (10 th /12 th)	Ext. 2506	Janie.Sosa@springbranchsid.com

PTA

- **President – Kelly Siblik**
- **Click [here](#) for the PTA website**
- **Big Form - Join the PTA and more**
- **Wellness Counselors, Horseshoe Fund, Golden Saddles, Teacher Appreciation**
- **Volunteer Opportunities around the school**
- **The Mustang Express**
- **Student Directory**
- **First PTA Meeting – September 18th at 9:00 am at the Memorial Church of Christ (across the street from MHS)**



Booster Club

- Christi and JP Bennett– Presidents
- Website: [Booster Club](#)
- Freshman and New Families Coffee –
August 27th at 9:00 AM at the home of
Kristie Kafka (503 Fall River - 77024)
- The Big Easy Roadhouse – October 25th at
The Houston Racquet Club

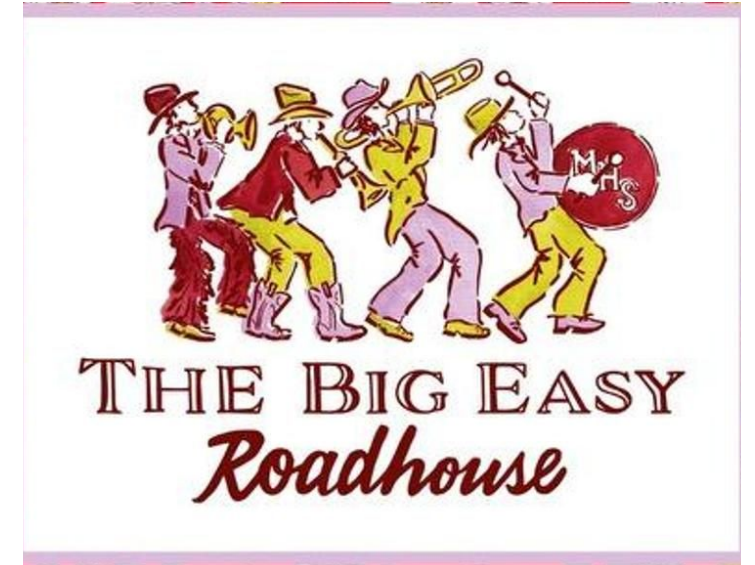

Communication

- Skyward Family Access
- Twitter @MHShouston
- [My School Bucks](#)
- PTA weekly email newsletter “The Mustang Express”
- School website <http://mhs.springbranchisd.com/>
- Campus Events calendar
- Open House – September 3rd at 6:30PM



Bell Schedule

REGULAR

1st 7:45 – 8:35 AM

2nd 8:41 – 9:31 AM

3rd 9:37 – 10:29 AM

4th 10:35 – 11:27 AM

5A 11:33 – 12:25 PM

5B 12:31 – 1:23 PM

6th 1:29 – 2:19 PM

7th 2:25 – 3:15 PM

Mustang Cafe

- **Hub of the School**
- **Student Center/Commons**
- **Lunch is the same length as a class period**
- **Lunch is during periods 5A and 5B**
- **Study, collaborate, see your counselor, go to the Library**
- **Lunch vendors**
- **Graze coffee bar**



Pep Rally Days

ADVISORY/PEP RALLY

1st 7:45 – 8:32 AM

2nd 8:38 – 9:25 AM

3rd 9:31 – 10:17 AM

ADV 10:23-10:53 AM

4th 10:59 – 11:45 AM

5A 11:51 – 12:37 PM

5B 12:43 – 1:29 PM

6th 1:35 – 2:22 PM

7th 2:28 – 3:15 PM

Date	Theme
Sept 6	Super Heros
Sept 27	Camo (Homecoming)
Oct 18	Rock n Roll
Nov 8	Red Out
Spring	TBD

Advisory Days

ADVISORY/PEP RALLY

1st 7:45 – 8:32 AM

2nd 8:38 – 9:25 AM

3rd 9:31 – 10:17 AM

ADV 10:23-10:53 AM

4th 10:59 – 11:45 AM

5A 11:51 – 12:37 PM

5B 12:43 – 1:29 PM

6th 1:35 – 2:22 PM

7th 2:28 – 3:15 PM

- Assist students in monitoring their own academic progress
- Encourage students' academic, personal, and social development
- Provide guidance in post-secondary planning
- Communicate with parents / guardians of students
- Provide an advocate for every student
- Guest Speakers
- Advisory Lessons

Grading Periods

1 st 9 weeks	2 nd 9 weeks	3 rd 9 weeks	4 th 9 weeks
Progress Report September 6	Progress Report November 1	Progress Report January 27	Progress Report April 4
Progress Report September 27	Progress Report November 22	Progress Report February 14	Progress Report April 28
Report Card October 10	Report Card December 20	Report Card March 7	Report Card May 29



Learning Tools

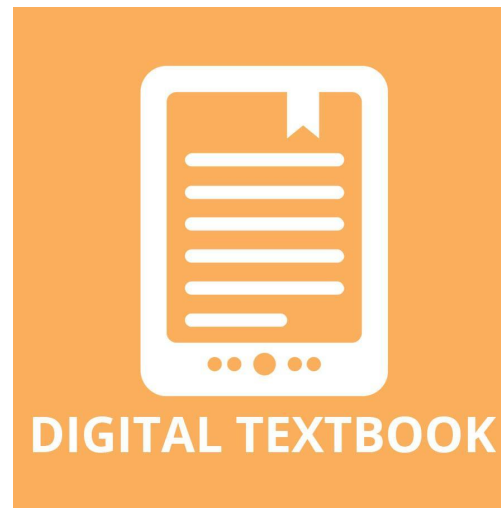

Parking/Drop Off

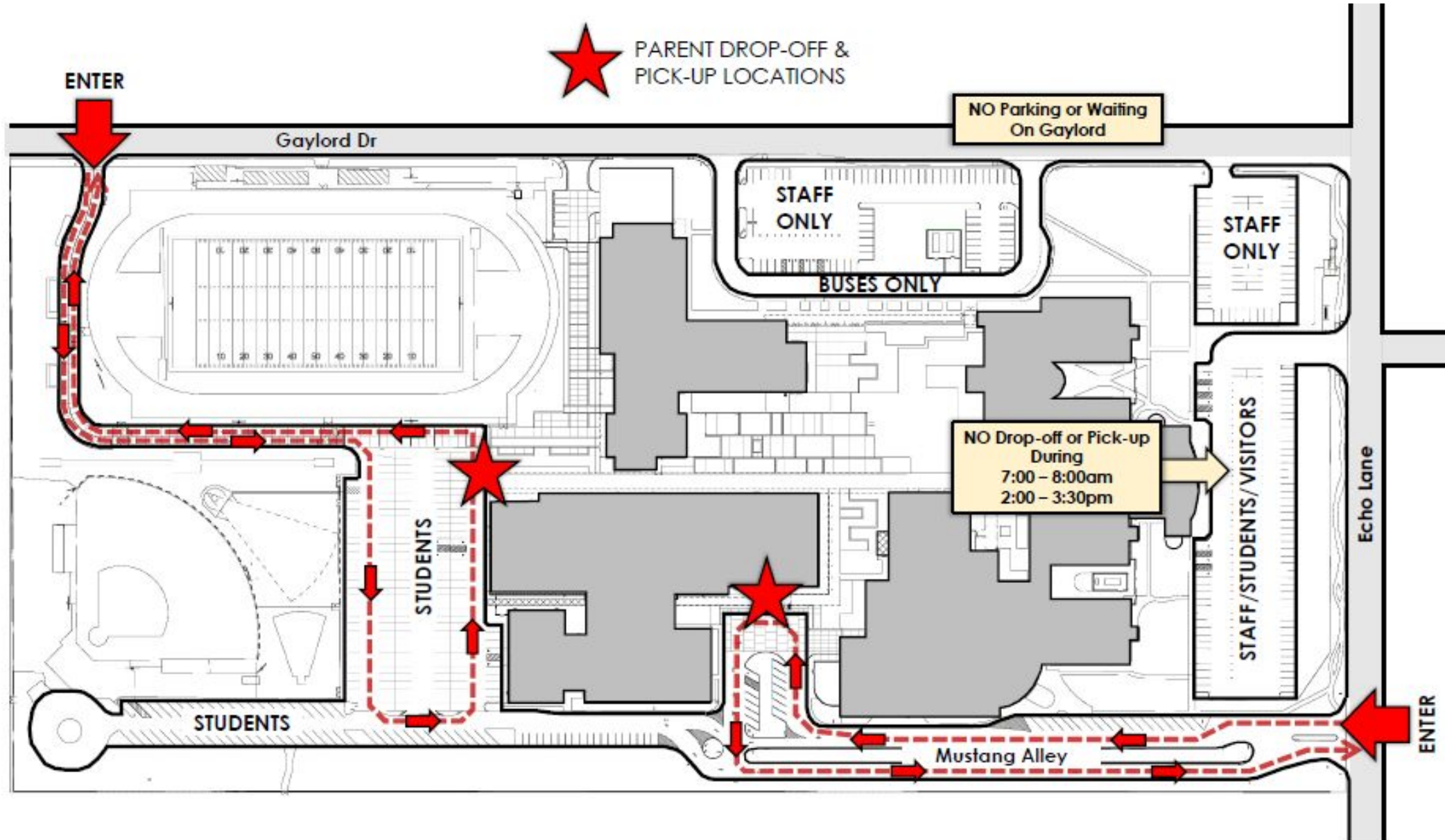



Questions?