



UNION ATHLETIC TRAINING

MEDICAL EMERGENCY ACTION PLAN

Facility: UMAC

Year: 2020-2021

Address: 6836 S Mingo Road, Tulsa 74133

Emergency Protocol:

- First person to arrive on scene provides initial care.
- Send for AED.
 - ✓ Location: **Arena, north wall/2nd floor west wall/on floor during games w/Athletic Trainer**
- Send a coach, manager, or uninjured student-athlete to notify the Athletic Trainer if not on site.
- If the Athletic Trainer cannot be located, the head coach will become the leader.

Leader:

- This person will be in charge of the emergency and will instruct others on the emergency team accordingly.

Leader's assistant:

- Will assist the leader in the primary evaluation of the injured athlete.

Phone caller (a designated adult with access to phone):

- Call EMS (911) and communicate the following information
 - ✓ The nature of injury
 - ✓ Level of consciousness
 - ✓ Age / sex of injured
 - ✓ Caller will not hang up until EMS operator until advised to do so.

Person to meet EMS:

- Ambulance entrance: **Loading Dock, southeast corner of UMAC**
- Will contact necessary staff to assure full access for ambulance
- Will meet ambulance at the designated entrance and lead to injured athlete

Person to accompany athlete to hospital:

- Ride with the athlete in the ambulance in the event the parent / guardian cannot be contacted
- Will have athletes physical and emergency information in hand.

It is the responsibility of the Athletic Trainer to inform Athletic Director of the incident

It is the responsibility of the Athletic Trainer or head coach to inform athlete's parent / guardian

It is the responsibility of the Athletic Trainer to document incident and all actions taken

Head Athletic Trainer:	Dan Newman	918-852-2066	
Assistant Athletic Trainer:	Meagan DeShane	918-521-4940	
Assistant Athletic Trainer:	Jacob Newby	918-607-1437	EMS: 911
Athletic Training Facility:	UMAC	918-357-7493	fire, police, or ambulance
Athletic Department:	6836 S Mingo Rd Tulsa, 74133	918-357-7410	

UMAC Arena
6836 S. Mingo Rd.

UMAC Arena Level
(ground floor)

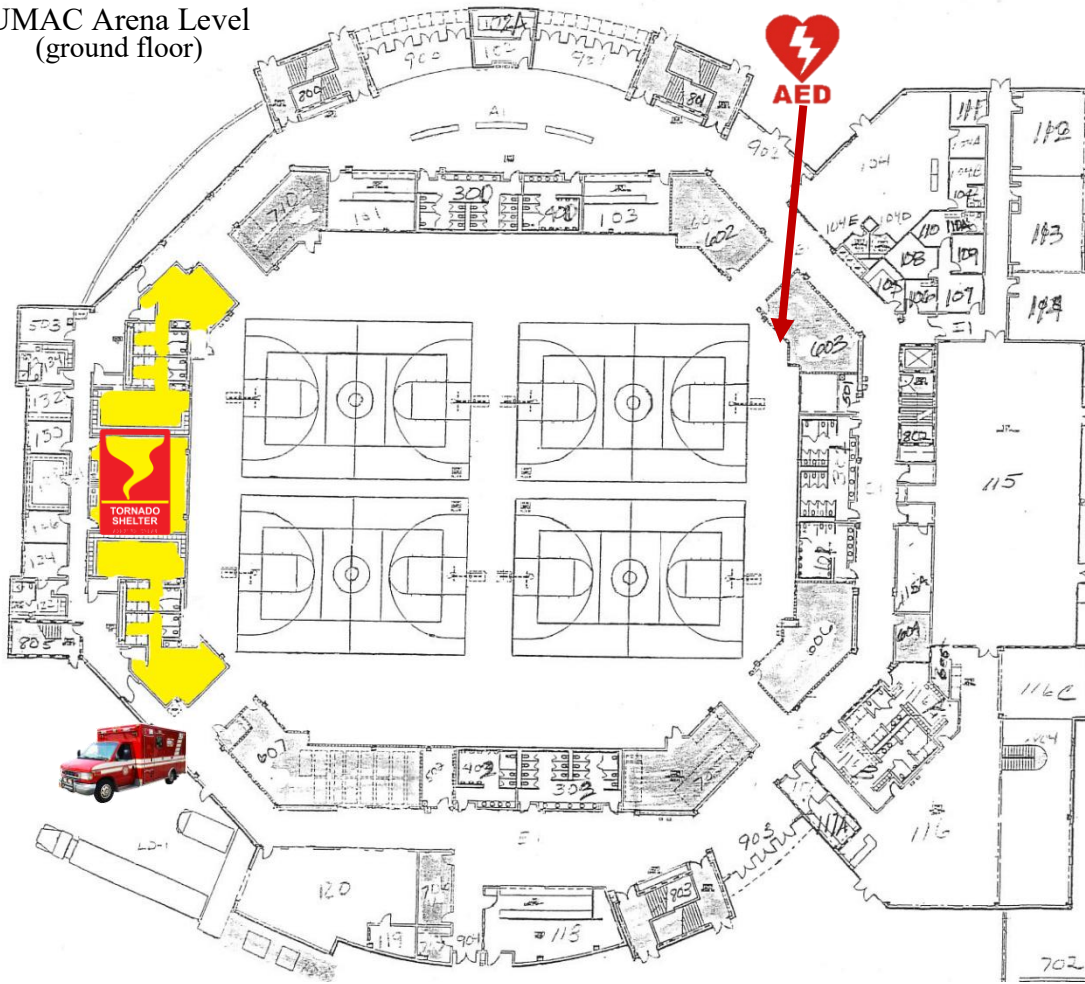

AED Locations:

- Arena Level-northwest wall inside arena
- Concourse Level-west wall near concession stand

Ambulance enter via loading dock, southeast corner

Tornado Shelter in highlighted areas

UMAC Field Level

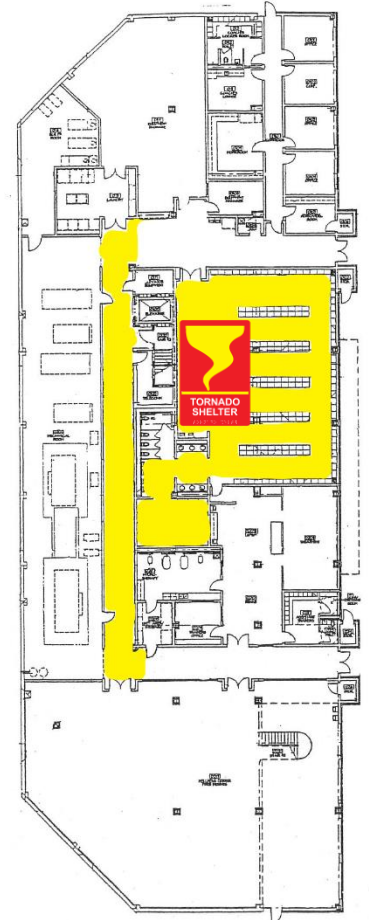

UMAC Concourse Level
(2nd floor)

