

ADDENDUM

Lindhout Associates architects aia pc
10465 citation drive, brighton, michigan 48116

www.lindhout.com

810-227-5668 (fax) 810-227-5855



PROJECT NAME:
Brighton Area Schools 2019 Bond-Phase 6 Projects (BECC Building)

COMM. NO. 23085

ADDENDUM NO. 01

DATE: March 15, 2024

TO: Brighton Area Schools & Bidding Contractors

It is understood and accepted that the work of this Addendum shall supplement and form a part of the original Specifications, Drawings, General Conditions, Special Conditions, Instructions to Bidders, and any and all stipulations thereof.

This Addendum is issued prior to the receipt of bids and the intent thereof is to record and insert certain changes, additions, and clarifications of the contract documents. All items shall be considered in connection with the various Contractors' Proposals.

CONTENTS

This Addendum contains the accompanying 1 pages and drawing sheet CA.

NO. DESCRIPTION

- 01 CLARIFY – The BECC Building's fire alarm panel and device renovations ("EF" Drawing Sheets) shall be bid as a separate project from the rest of the BECC Building Renovations. Only qualified contractors with fire alarm devices and fire alarm panels should consider bidding.

END OF ADDENDUM

BRIGHTON AREA SCHOOLS - B.E.C.C. BLDG.

MISC. IMPROVEMENTS

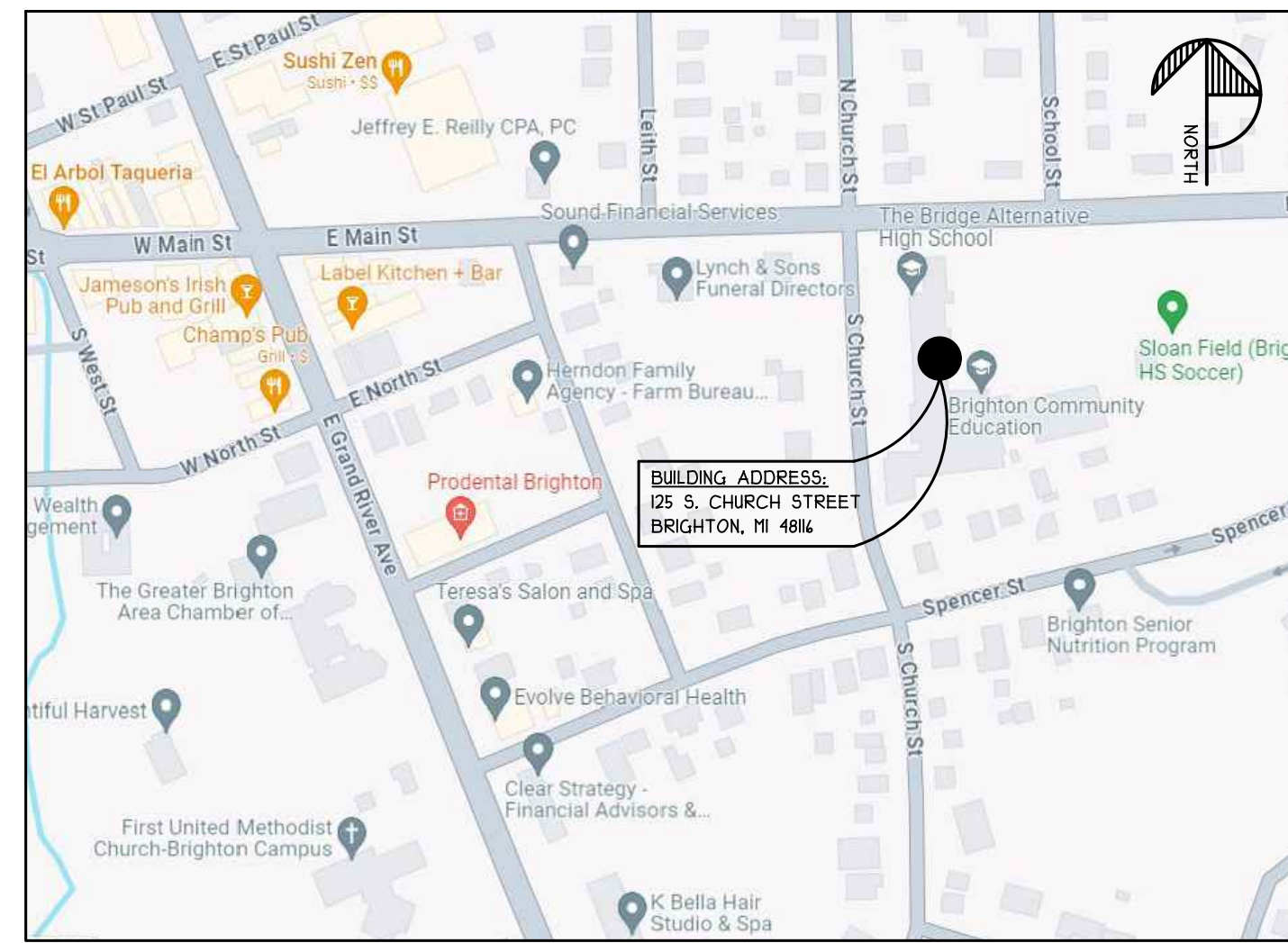

LOCATION MAP
NOT TO SCALE

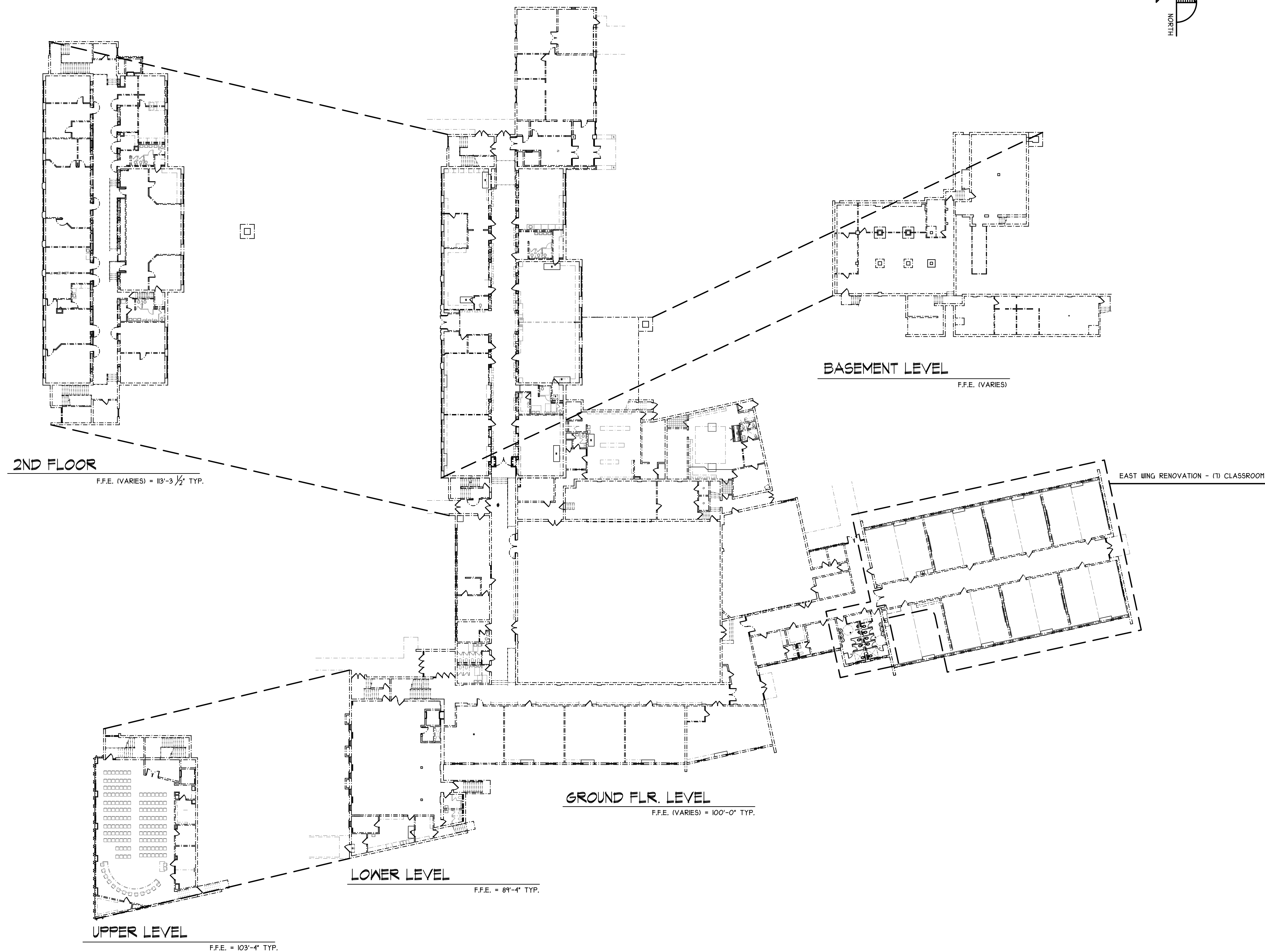

COMPOSITE PLANS

SCALE: 1/32" = 1'-0"

PROJECT NARRATIVE
THIS PROJECT CONSISTS OF FIVE COMPONENTS W/IN THE BRIGHTON AREA SCHOOLS B.E.C.C. BUILDING:
1. REMOVE AND REPLACE EXISTING 1ST FLOOR MECHANICAL UNITS AS NEEDED TO PROVIDE AIR CONDITIONING.
2. REMOVE AND REPLACE EXISTING EXTERIOR WINDOWS THROUGHOUT.
3. REMOVE AND REPLACE EXISTING FIRE ALARM PANEL AND DEVICES.
4. (EAST WING) RENOVATE 1 FORMER CLASSROOM INTO NEW/UPDATED CLASSROOMS FOR THE DISTRICT.
5. MISCELLANEOUS ROOM RENOVATIONS. GENERAL SCOPE INCLUDES FINISHES AND MEP FIXTURES AS NOTED.

ALTERATIONS DO NOT AFFECT EXISTING EGRESS, OCCUPANCY TYPE, OR OCCUPANT LOAD. EXISTING BUILDING SIZE, CONSTRUCTION TYPE, OR FIRE RATINGS TO REMAIN UNCHANGED AS WELL. THIS WORK IS CLASSIFIED AS LEVEL 2 ALTERATIONS UNDER THE MICHIGAN REHABILITATION CODE, 206. THE BUILDING IS NON-SPRINKLERED.

APPLICABLE CODES:
206 MICHIGAN REHABILITATION CODE
206 MICHIGAN BUILDING CODE
206 INTERNATIONAL BUILDING CODE
2004 MICHIGAN BARRIER FREE
202 NFPA 101
208 MICHIGAN PLUMBING CODE
206 MICHIGAN MECHANICAL CODE
206 INTERNATIONAL FIRE CODE
201 NATIONAL ELECTRIC CODE

BUILDING INFORMATION:
UNCHANGED

FIRE RESISTANCE RATING (UNCHANGED CONSTRUCTION):
UNCHANGED

OCCUPANCY CALCULATIONS (BUSINESS OCCUPANCY):
UNCHANGED

REQUIRED EGRESS COMPONENTS:
UNCHANGED

PLUMBING FIXTURE REQUIREMENTS, PER MICHIGAN LABOR PLUMBING CODE, TABLE 403.1
* (2) EXISTING MULTI-OCCUPANT BATHROOMS PROPOSED RENOVATIONS SHALL REDUCE WATER CLOSET COUNTS BY ONE (1) FIXTURE TO MEET 4 IMPROVE ADA REQUIREMENTS *



PROJECT INFORMATION		ISSUANCE			
		BIDS & PERMITS	ADD 01	ADD 02	BULL 01
ARCHITECTURAL & INTERIORS					
CA	COVER & CODE INFORMATION	X	X		
D1	DEMO PLANS	X			
D2	ENLARGED DEMO PLANS	X			
AI1	ENLARGED FLOOR PLANS	X			
AI2	ENLARGED REFL. CLG. PLAN	X			
A2.1	INTERIOR ELEVATIONS & DETAILS	X			
ID100	FINISH PLAN & KEY	X			
ID200	FINISH PLAN, KEY, & BID ALTERNATES	X			
ID400	REFLECTED CEILING PLANS	X			
W1.1	WINDOW REPLACEMENT PLAN - FIRST FLR.	X			
W1.2	WINDOW REPLACEMENT PLAN - 2ND FLR.	X			
W2.1	WINDOW REPLACEMENT EXT. ELEVATIONS.	X			
W2.2	WINDOW REPLACEMENT EXT. ELEVATIONS	X			
PLUMBING					
F1.0	GENERAL PLUMBING INFORMATION	X			
PD1.1	1ST FLR. - PLUMBING DEMOLITION PLAN	X			
PL.1	1ST FLR. - PLUMBING NEW WORK PLAN	X			
MECHANICAL					
M1.0	MECHANICAL SPECIFICATIONS AND LEGEND	X			
MD1.1	1ST FLR. - PARTIAL MECHANICAL DEMO PLAN	X			
MD1.2	1ST FLR. - PARTIAL MECHANICAL DEMO PLAN	X			
MD1.3	1ST FLR. - PARTIAL MECHANICAL DEMO PLAN	X			
MD1.4	1ST FLR. - PARTIAL MECHANICAL DEMO PLAN	X			
M1.1	PARTIAL 1ST FLR. - MECHANICAL NEW WORK PLAN	X			
M1.2	PARTIAL 1ST FLR. - MECHANICAL NEW WORK PLAN	X			
M1.3	PARTIAL 1ST FLR. - MECHANICAL NEW WORK PLAN	X			
M1.4	PARTIAL 1ST FLR. - MECHANICAL NEW WORK PLAN	X			
M2.1	PARTIAL ROOF - MECHANICAL NEW WORK PLAN	X			
M2.2	PARTIAL ROOF - MECHANICAL NEW WORK PLAN	X			
M2.3	PARTIAL ROOF - MECHANICAL NEW WORK PLAN	X			
M2.4	PARTIAL ROOF - MECHANICAL NEW WORK PLAN	X			
M3.1	MECHANICAL DETAILS	X			
M4.1	MECHANICAL SCHEDULE	X			
M4.2	MECHANICAL SCHEDULE	X			
M4.3	MECHANICAL SCHEDULE	X			
ELECTRICAL					
E0.1	GENERAL ELECTRICAL INFORMATION	X			
E0.2	LIGHTING FIXTURE, CONTROLS SCHEDULE, & NOTES	X			
ED1.1	1ST FLR. - ELECTRICAL DEMOLITION PLAN	X			
E1.1	PARTIAL 1ST FLR. - NEW WORK ELECTRICAL PLAN	X			
E1.2	PARTIAL 1ST FLR. - NEW WORK ELECTRICAL PLAN	X			
E1.3	PARTIAL 1ST FLR. - NEW WORK ELECTRICAL PLAN	X			
E1.4	PARTIAL 1ST FLR. - NEW WORK ELECTRICAL PLAN	X			
E2.1	PARTIAL ROOF PLAN - NEW WORK ELECTRICAL PLAN	X			
E2.2	PARTIAL ROOF PLAN - NEW WORK ELECTRICAL PLAN	X			
E2.3	PARTIAL ROOF PLAN - NEW WORK ELECTRICAL PLAN	X			
E2.4	PARTIAL ROOF PLAN - NEW WORK ELECTRICAL PLAN	X			
E3.1	PARTIAL 1ST FLR. - NEW WORK LIGHTING PLAN	X			
E4.1	PARTIAL ONE-LINE DIAGRAM & SCHEDULE	X			
E5.1	ELECTRICAL SPECIFICATIONS	X			
E5.2	ELECTRICAL SPECIFICATIONS	X			
FIRE ALARM					
EF0.1	GENERAL ELECTRICAL INFORMATION	X			
EF1.1	PARTIAL 1ST FLR. - NEW FIRE ALARM SYSTEMS WORK	X			
EF1.2	PARTIAL 1ST FLR. - NEW FIRE ALARM SYSTEMS WORK	X			
EF1.3	PARTIAL 1ST FLR. - NEW FIRE ALARM SYSTEMS WORK	X			
EF1.4	PARTIAL 1ST FLR. - NEW FIRE ALARM SYSTEMS WORK	X			
EF1.5	PARTIAL 1ST FLR. - NEW FIRE ALARM SYSTEMS WORK	X			
EF2.1	PARTIAL 2ND FLR. - NEW FIRE ALARM SYSTEMS WORK	X			
EF2.2	PARTIAL 2ND FLR. - NEW FIRE ALARM SYSTEMS WORK	X			
EF3.1	ELECTRICAL SPECIFICATIONS	X			
EF3.2	ELECTRICAL SPECIFICATIONS	X			

SHEET INDEX

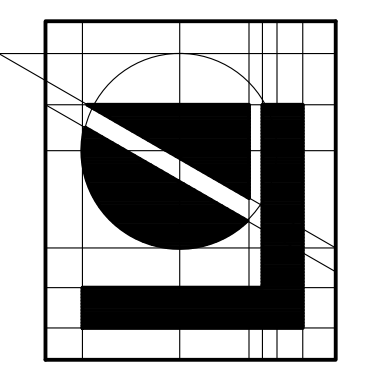

Lindhout Associates
architects aia pc
10466 Clinton Ave., Brighton, Michigan 48116-9510
www.lindhout.com Fax: (810)227-5855 (810)227-5688

consultant

ADDENDUM OF THIS COVER REVIEW OTHER REVIEW issued for

DATE: 3/15/2024
3/18/2024
3/27/2024
11/2/2023
date

RENOVATIONS for:
BRIGHTON AREA SCHOOLS
(B.E.C.C. BLDG.) BRIGHTON, MICHIGAN
COVER

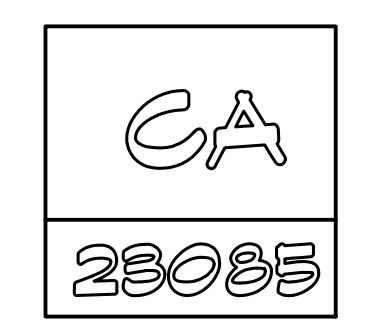

FILE LOCATION: H:\23084-088 BAS phase A\23085 Project 2 - BECC East wing remodel\CD\23085-CA code & cover.dwg
 DATE PLOTTED: 2/14/2024
 LINDHOUT ASSOCIATES architects aia pc
 THIS DOCUMENT AND THE SUBJECT MATTER CONTAINED THEREIN IS PROPRIETARY AND IS NOT TO BE USED OR REPRODUCED WITHOUT PRIOR WRITTEN APPROVAL.
 COPYRIGHT © 2023