

EXPLODED VIEW

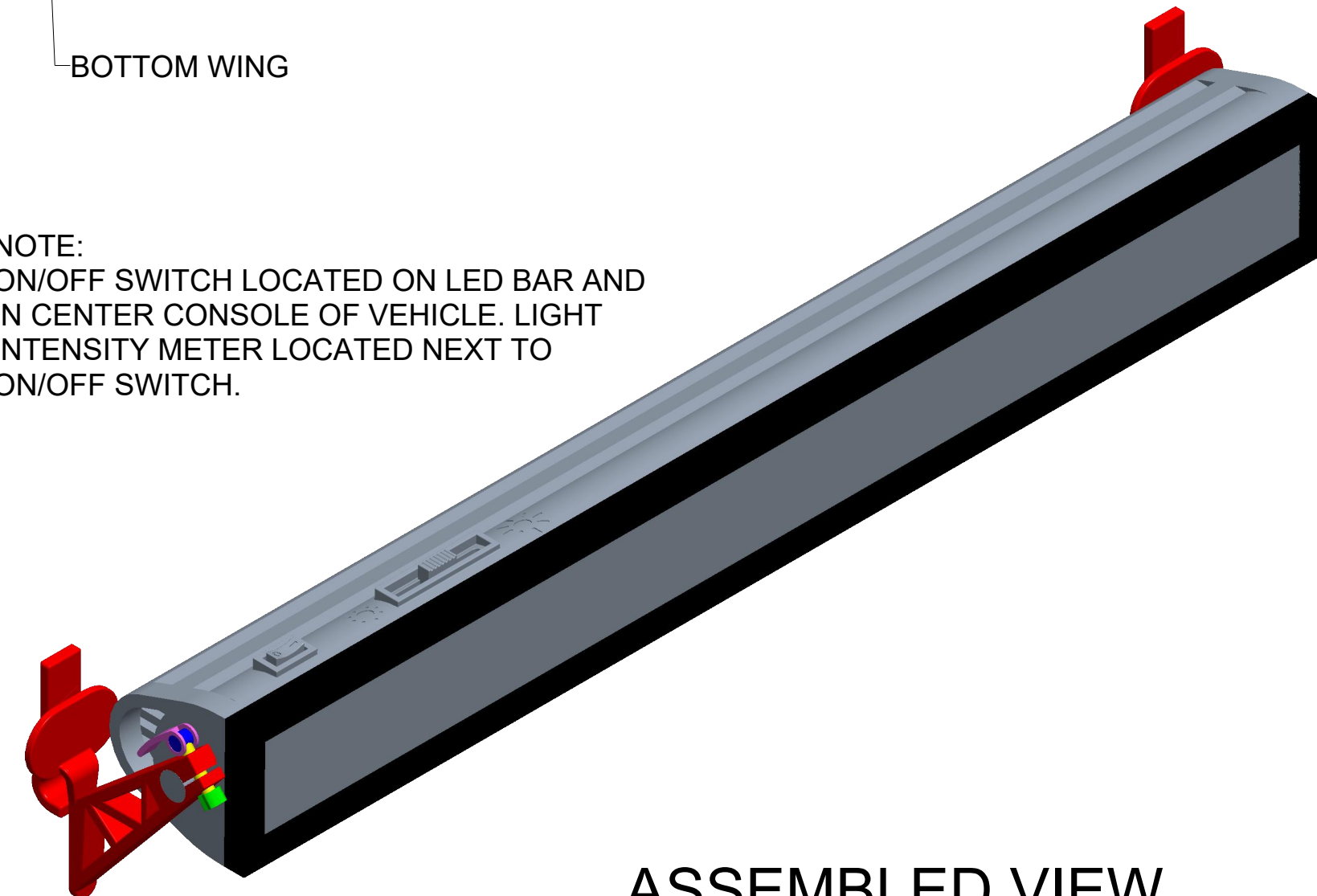

LIGHT BAR ASSEMBLY VIEW

NOTE:
ON/OFF SWITCH LOCATED ON LED BAR AND IN CENTER CONSOLE OF VEHICLE. LIGHT INTENSITY METER LOCATED NEXT TO ON/OFF SWITCH.



ASSEMBLED VIEW

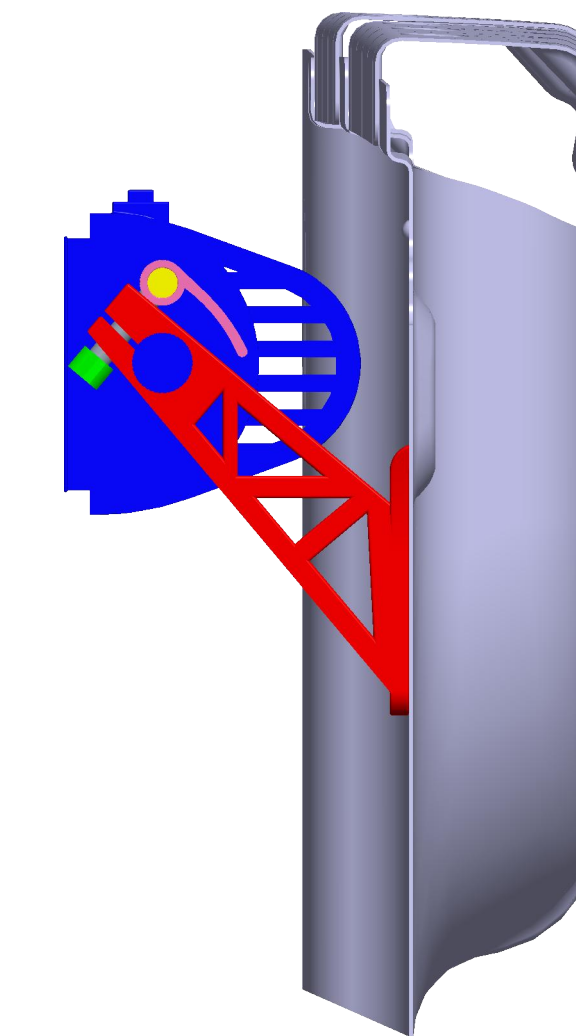

FRAME CONNECTION SECTION

NOTE:
1.
- ALIGN FRAME ASSEMBLY BRACKET TO HOLE D IN TRUCK BED (HOLE D;TRUCK ASSEMBLY)
- ANGLE AND INSERT TOP WING OF LED FRAME ASSEMBLY INTO HOLE D IN TRUCK BED
- ROTATE LED FRAME UNTIL THE TOP WING IS VERTICAL
- LIFT LIGHT BAR ASSEMBLY UP TO ALLOW SPACE FOR BOTTOM WING TO SLIDE THROUGH TRUCK BED HOLE D (NOTE:SEE LIGHT BAR ASSEMBLY VIEW FOR TOP/BOTTOM WING)
2.
- ADJUST LIGHT BAR UNTIL A SNUG FIT IS OBTAINED

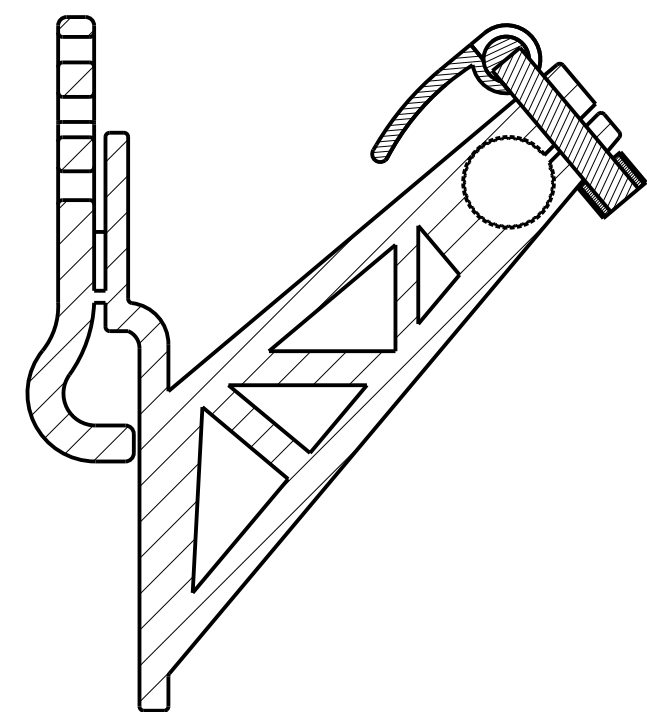

CLAMP SECTION CLOSED

NOTE:
1. INSERT PIN STOP (PART 5) INTO HOLE C (HOLE C; EXPLODED VIEW) UNTIL FLUSH ON BOTH SIDES OF CLAMP ARM (PART 6)
2. INSERT PIN STOP ONTO TOP OF CLAMP PIN (PART 3) UNTIL TOP OF CLAMP PIN IS FLUSH WITH BOTTOM OF PIN STOP (PART 5)
3. INSERT THE BOTTOM OF CLAMP PIN INTO HOLE A (HOLE A; EXPLODED VIEW) UNTIL BOTTOM OF CLAMP ARM CONTACTS LED BAR FRAME
4. THREAD ON PIN FASTNER (PART 4) INTO BOTTOM OF CLAMP PIN UNTIL TIGHT
5. REPEAT STEPS 1-4 FOR THE OTHER END OF THE FRAME AND CLAMP SYSTEM
6. INSERT LED BAR (PART 2) INTO HOLE B (HOLE B; EXPLODED VIEW) UNTIL FLUSH ON BOTH ENDS
7. PUSH LED BAR SCREEN (PART 7) ONTO FRONT OF LED BAR UNTIL SNAP IS ACHIEVED
8. SEE FRAME CONNECTION SECTION FOR HOW TO INSTALL ON TRUCK BODY

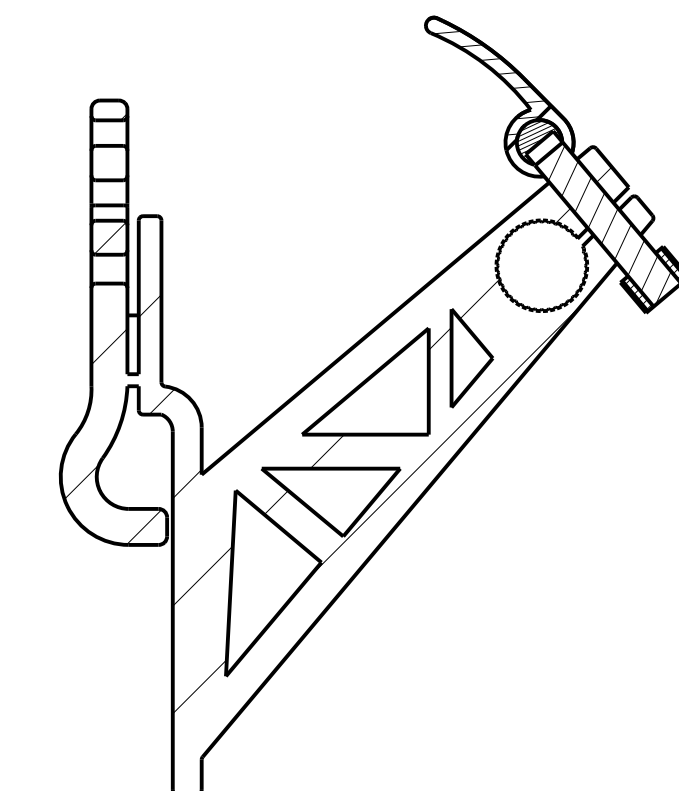

CLAMP SECTION OPEN

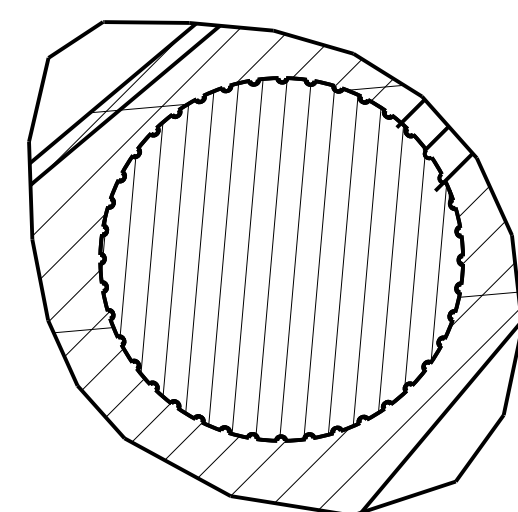

FRAME BAR AND LED CONNECTION SECTION

NOTE:0.4MM CHANNEL IN LED BAR ARMS AND 0.4MM BUMP IN LED BAR FRAME. TO ADD GRIP FOR WHEN THE LED BAR IS SET AT DIFFERENT ANGLES.

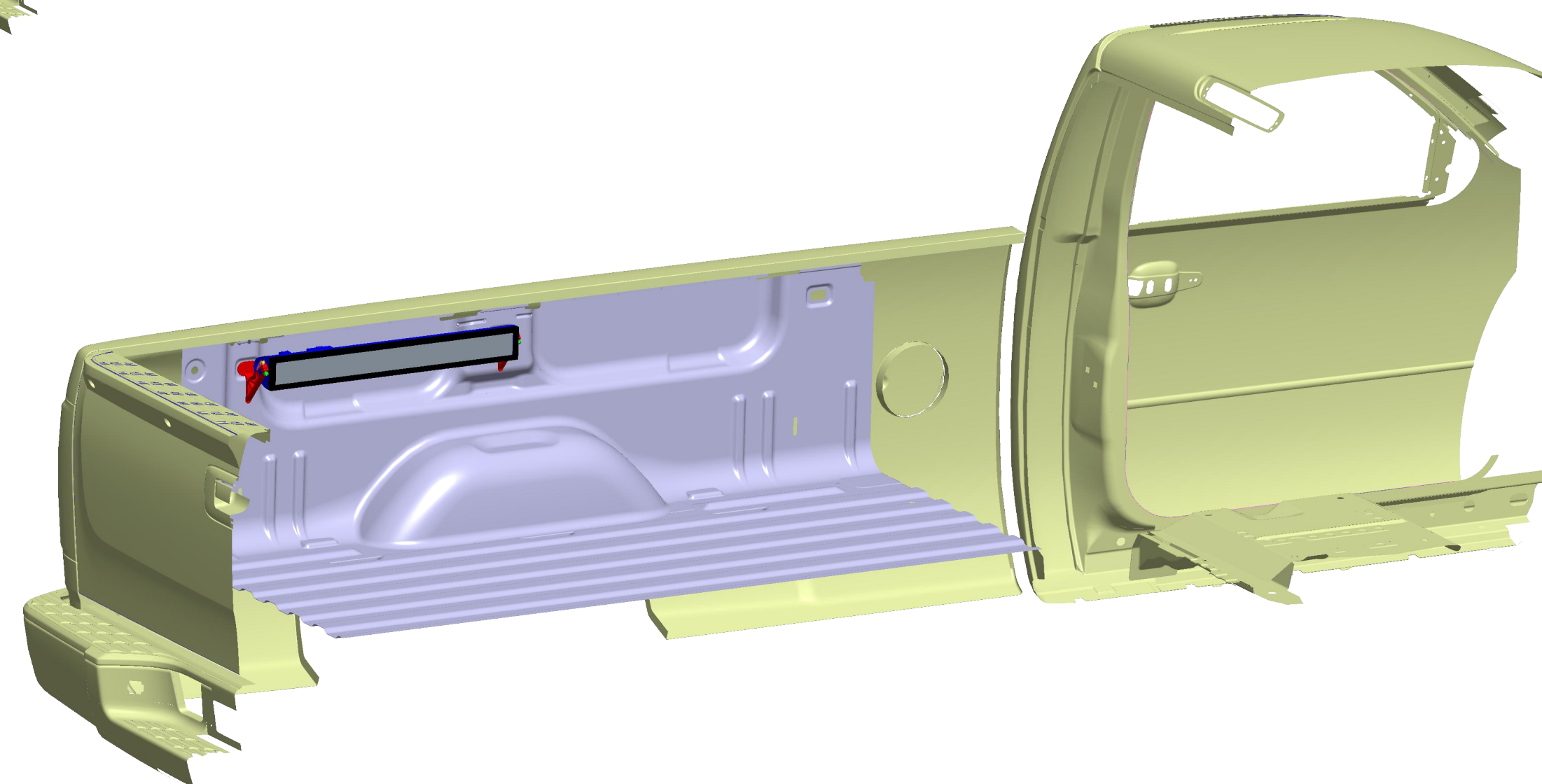
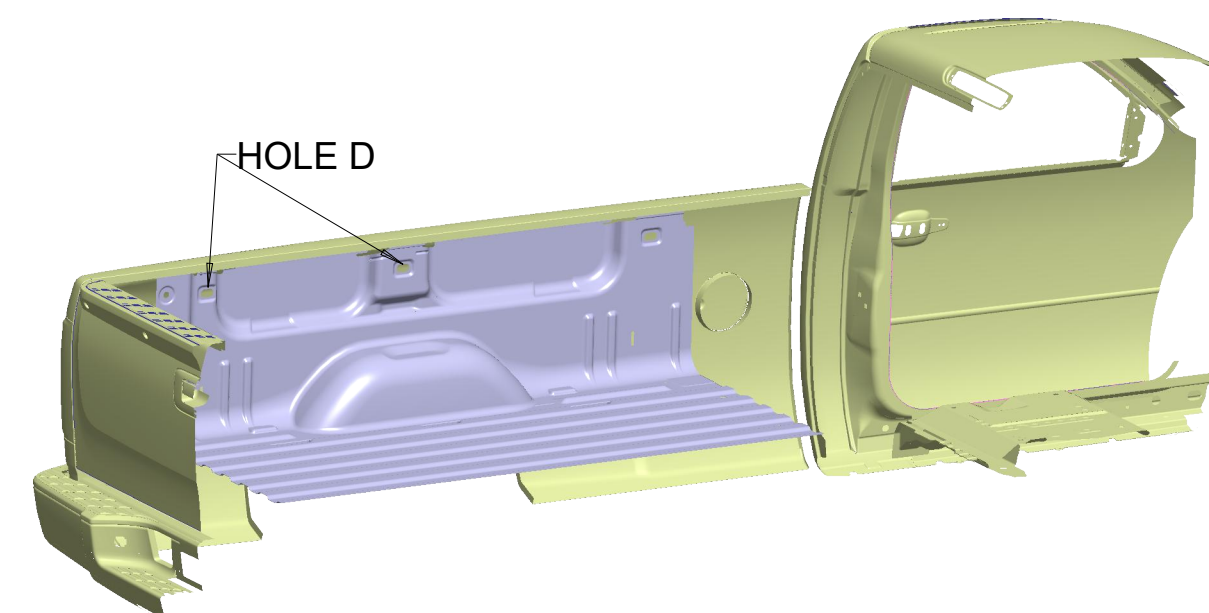

TRUCK ASSEMBLY

| PART # | PART NAME | QTY. |
|--------|----------------|------|
| 1 | LED BAR FRAME | 2 |
| 2 | LED BAR | 1 |
| 3 | CLAMP PIN | 2 |
| 4 | PIN FASTNER | 2 |
| 5 | PIN STOP | 2 |
| 6 | CLAMP ARM | 2 |
| 7 | LED BAR SCREEN | 1 |

METRIC

STUDENT NAME: NOLAN MCGAHAN
 SCHOOL: BRIGHTON HIGH SCHOOL
 GRADE LEVEL: CATEGORY: ENGINEERING DESIGN
 12
 EMAIL ADDRESS: McGahanNM19@brightonk12.com
 TEACHER NAME: MATTHEW JOURDEN