

EXPLODED VIEW

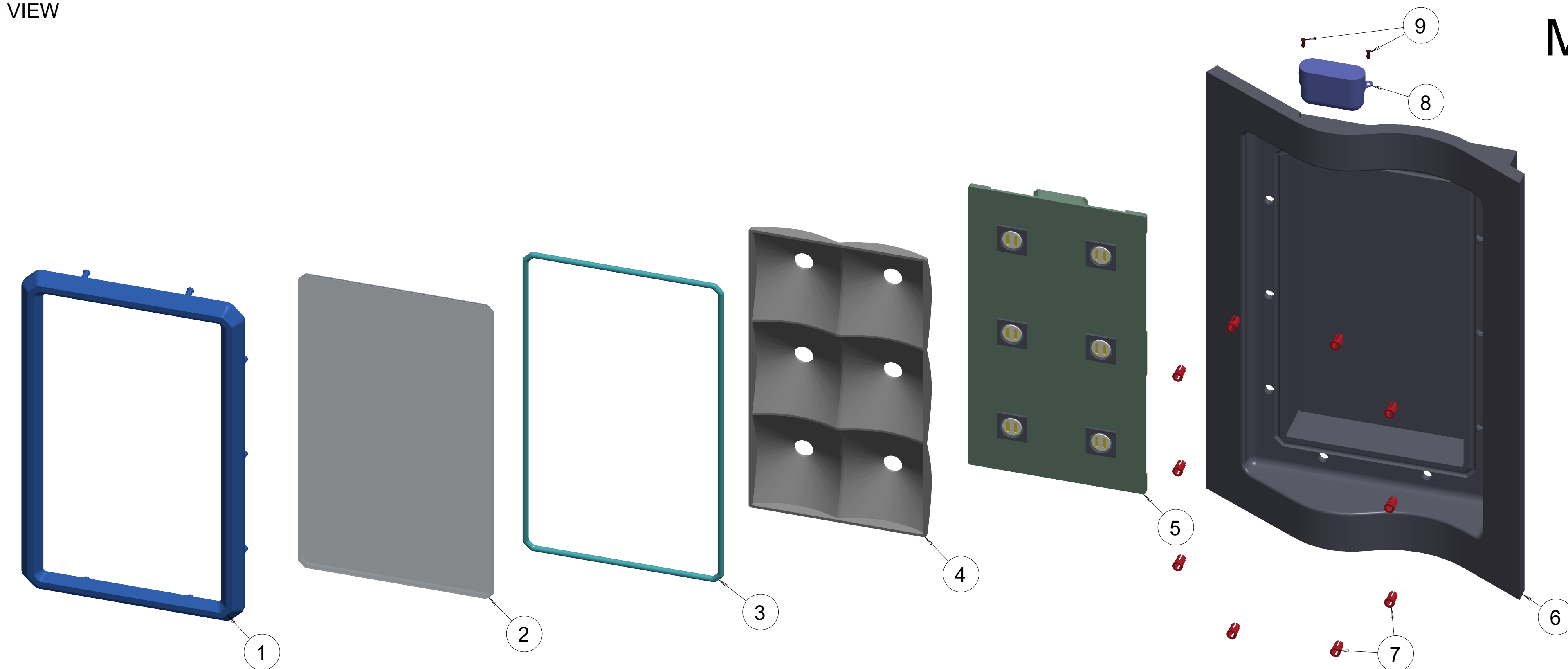

METRIC

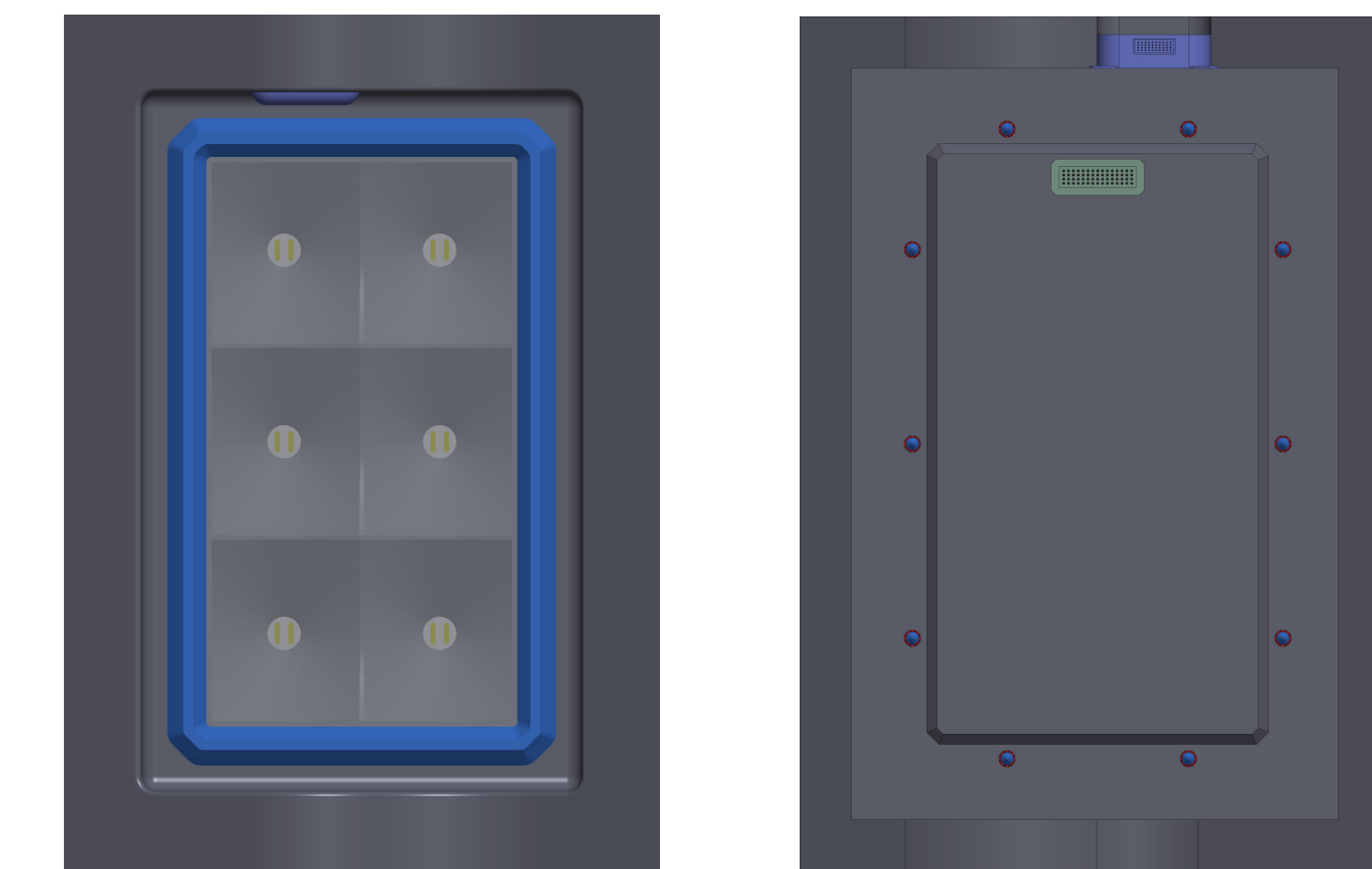

WIRING DIAGRAM

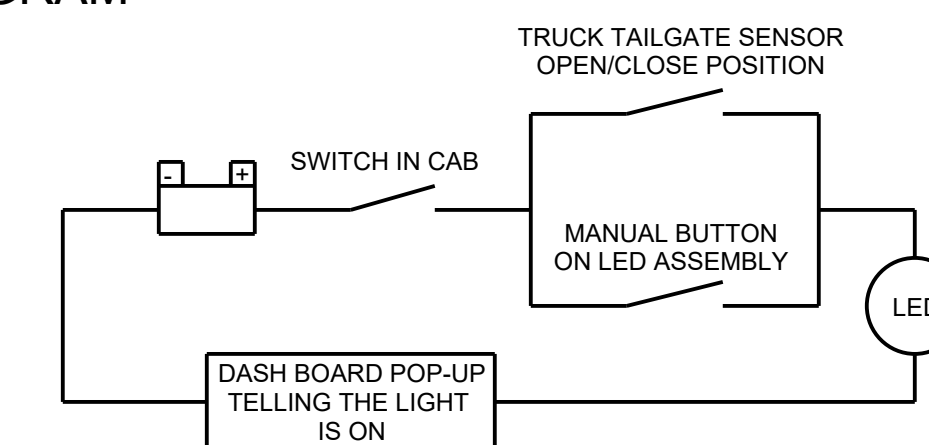

MOUNTING LOCATION

LIGHT ASSEMBLY RECESSED IN FROM BED FACE TO REDUCE IMPACTS AND CHANGE ANGLE OF LIGHT TO PROVIDE WIDER COVERAGE OF ILLUMINATION IN THE TRUCK BED.
NOTE: LIGHT COVERS NOT NEEDED DUE TO THE LIGHT ASSEMBLY BEING CONTAINED IN THE TRUCK BED AREA.

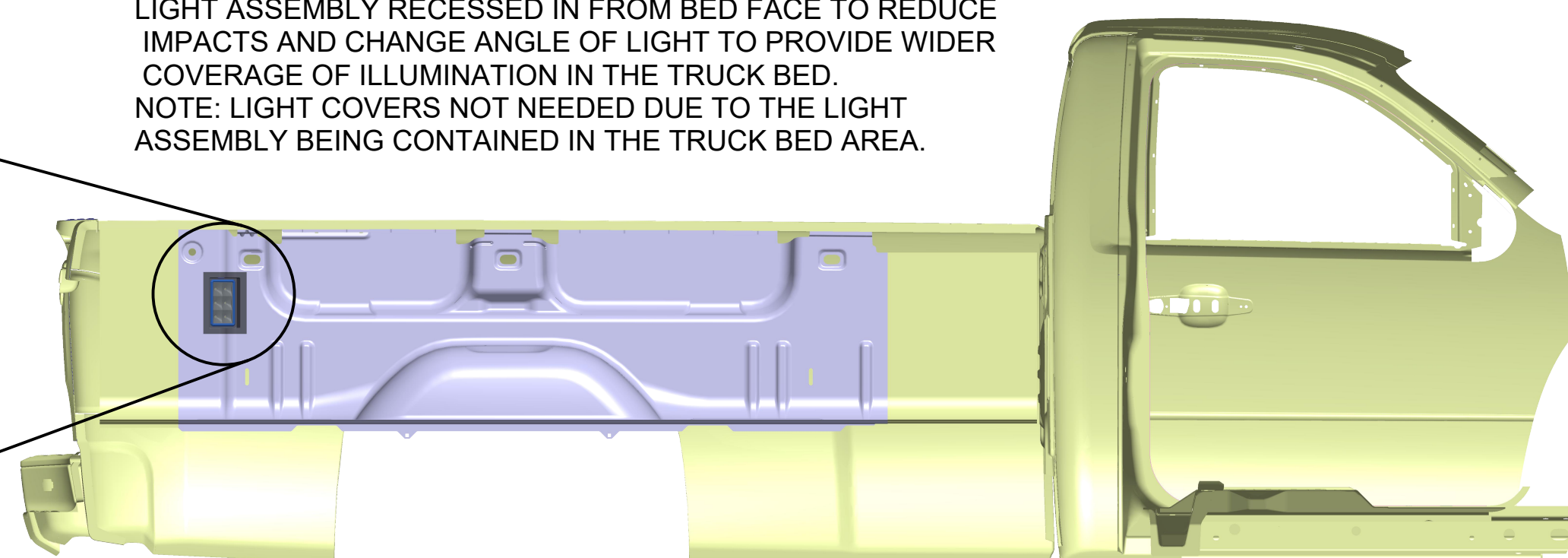
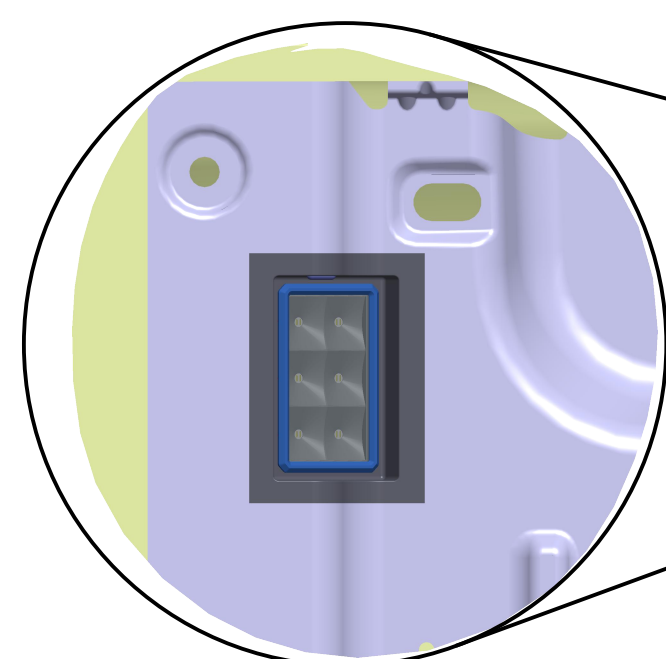

NOTE: LIGHT ASSEMBLY SAME LOCATION ON THE PASSENGER SIDE
LIGHT WILL WORK WITH TONNEAU COVER AND BED CAP

ASSEMBLY INSTRUCTIONS:

- STEP 1.) MODIFY TRUCK BED PART MANIFOLD_SOLID_BREP_607 WITH A CUT CONTOUR FOR FABRICATED PART # 6 BED MOLD TO ACCOMMODATE LIGHT COMPONENTS AND EXTERNAL TRIM BEING FLUSH WITH THE EXTERIOR OF PART MANIFOLD_SOLID_BREP_607
- STEP 2.) FASTEN PART # 8 BUTTON TO PART # 6 BED MOLD WITH PART # 9 BUTTON PIN BY USING HOLE A SEE BOX FASTENING VIEWS
- STEP 3.) PRESS FIT PART # 7 CLASPS TO PART # 6 BED MOLD USING HOLE B
- STEP 4.) PLACE PART # 5 PCBA INTO THE CENTER CAVITY OF PART # 6 BED MOLD AND ALIGN EDGES AND WIRE HARNESS
- STEP 5.) ALIGN PART # 4 REFLECTOR ON PART # 5 PCBA INSIDE THE CENTER CAVITY OF PART # 6 BED MOLD
- STEP 6.) SET PART # 2 POLYCARBONATE LENS INTO PART # 1 FACEPLATE SO BOTH GASKET GROOVES ARE ALIGNED
- STEP 7.) SET PART # 3 GASKET IN THE GASKET GROOVE OF ASSEMBLY MADE IN STEP 6
- STEP 8.) PRESS PART # 1 FACEPLATE PINS WHICH IS NOW PART OF FACEPLATE ASSEMBLY INTO PART # 7 CLASPS SEEN IN FASTENING VIEWS BOX THAT ARE LOCATED IN HOLE B (SEE PART 6 VIEWS)
- NOTE: STEPS 1-8 CREATE A WATERTIGHT SEAL AND SECURE LIGHT ASSEMBLY TO TRUCK BED
- STEP 9.) SEE WIRE HARNESS VIEWS FOR WIRE CONNECTION (SEE WIRE DIAGRAM VIEWS FOR ELECTRICAL CIRCUIT)

FASTENING VIEWS

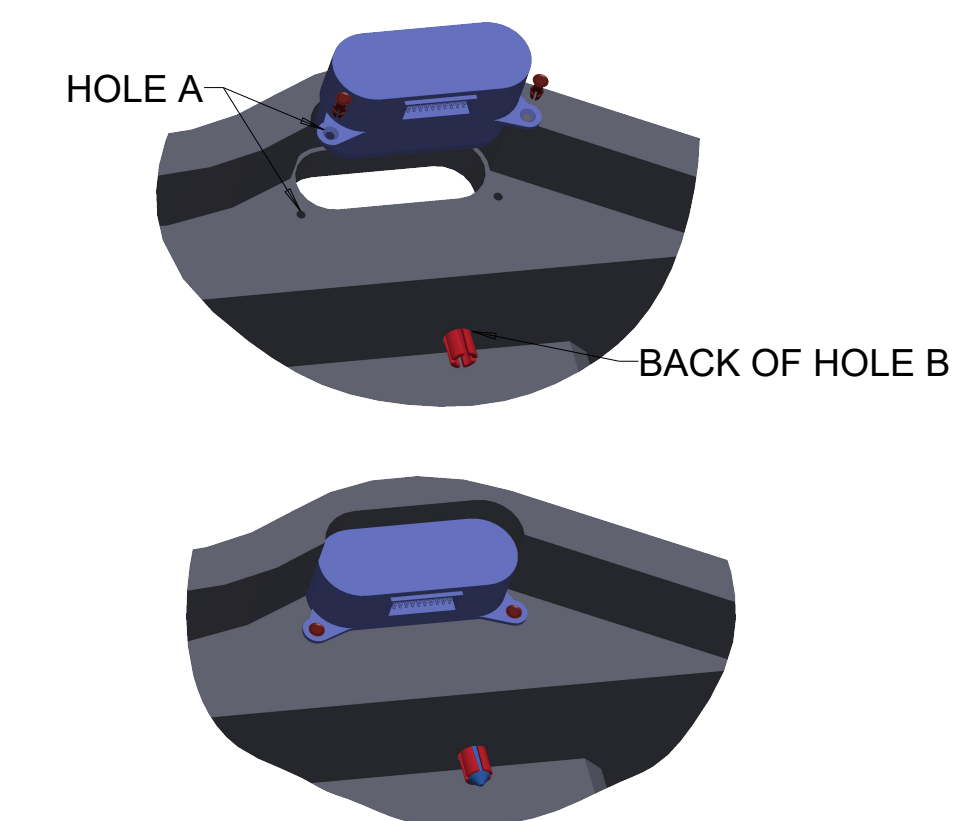

PARTS 1, 2 & 3 ASSEMBLED

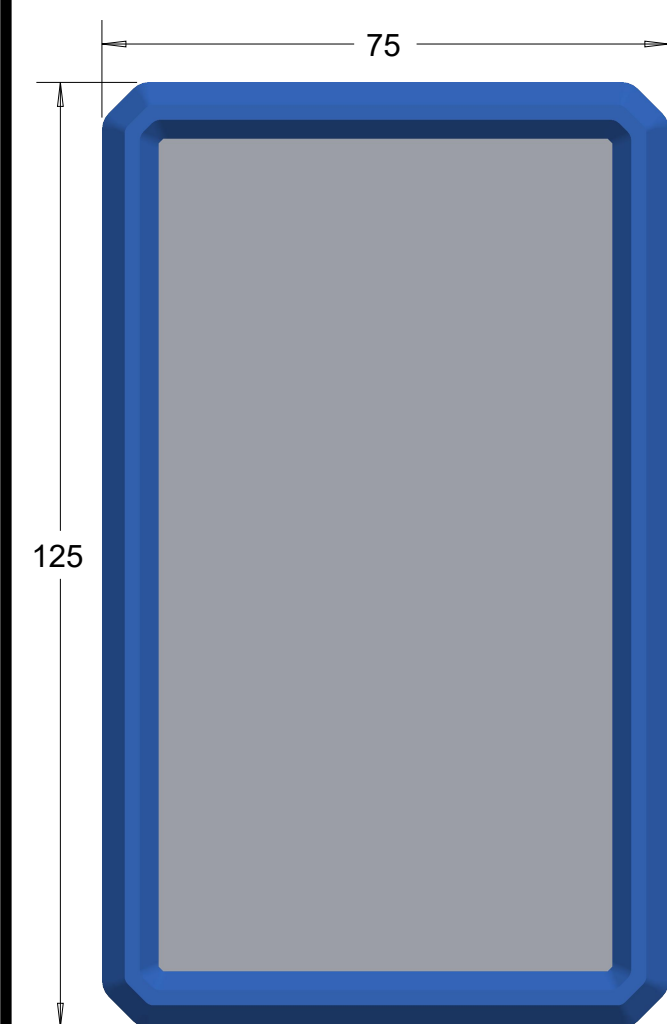

FACEPLATE ASSEMBLY

GASKET TRIM PROVIDES WATER TIGHT SEAL
GASKET PRESS FIT BETWEEN PART #1, 2, 6 SHOWN IN EXPLODED VIEW

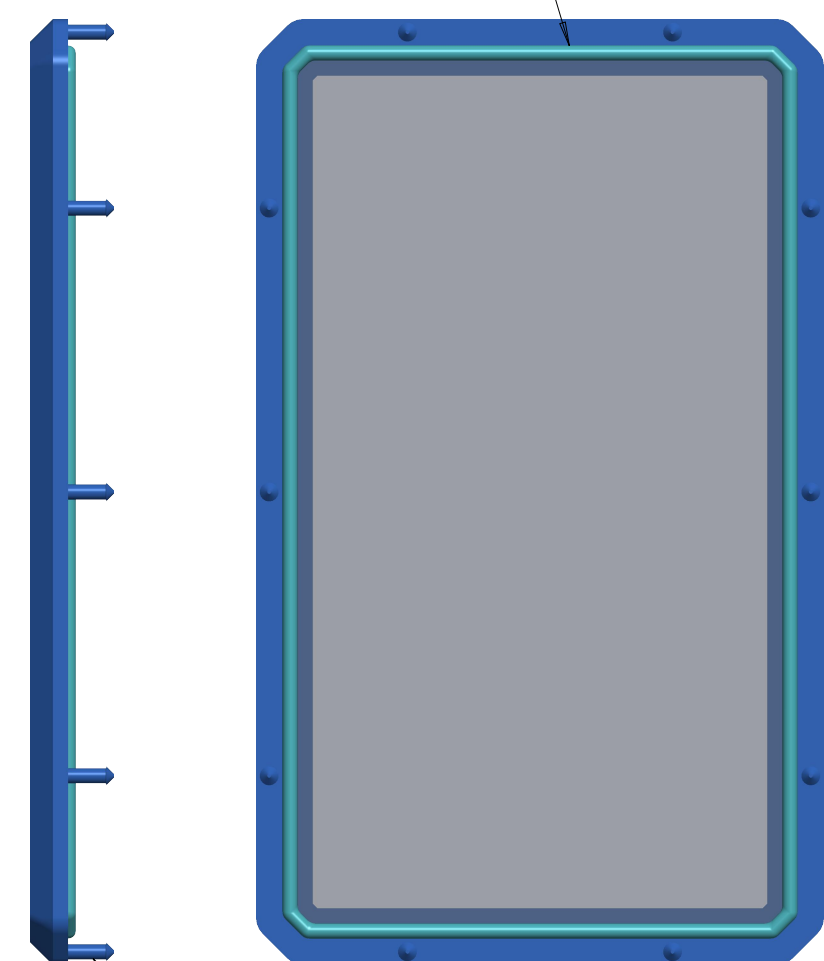

FACEPLATE PINS

7

PLACE CLASP ON FACEPLATE PINS (SEE 1, 2 & 3 ASSEMBLED) CLASPS PROVIDED A TIGHTER TOLERANCE FIT (SEE FASTENING VIEWS)

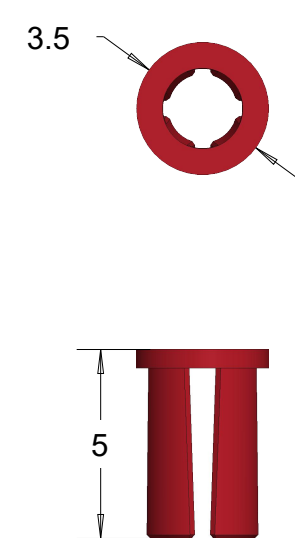

6

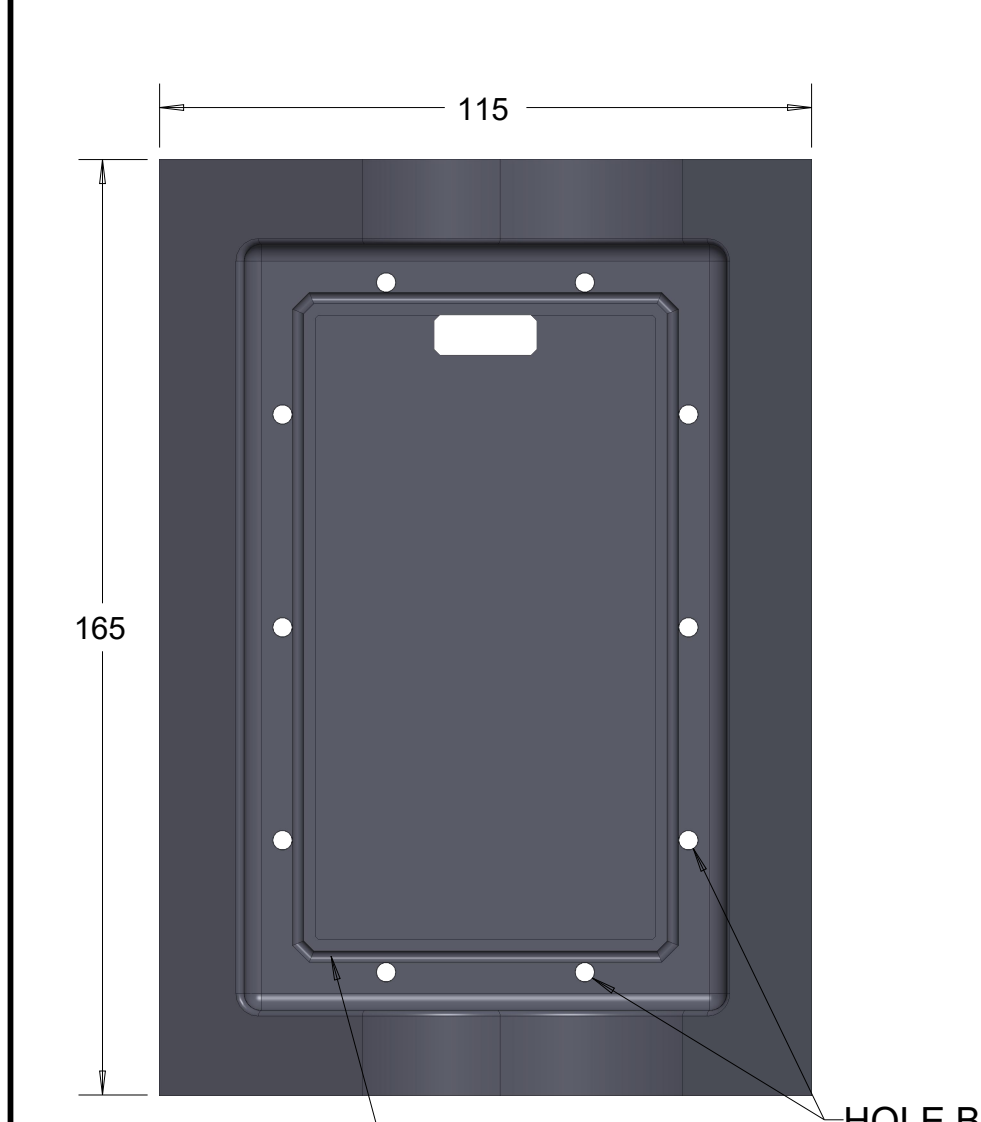

WIRE HARNESS SLOT

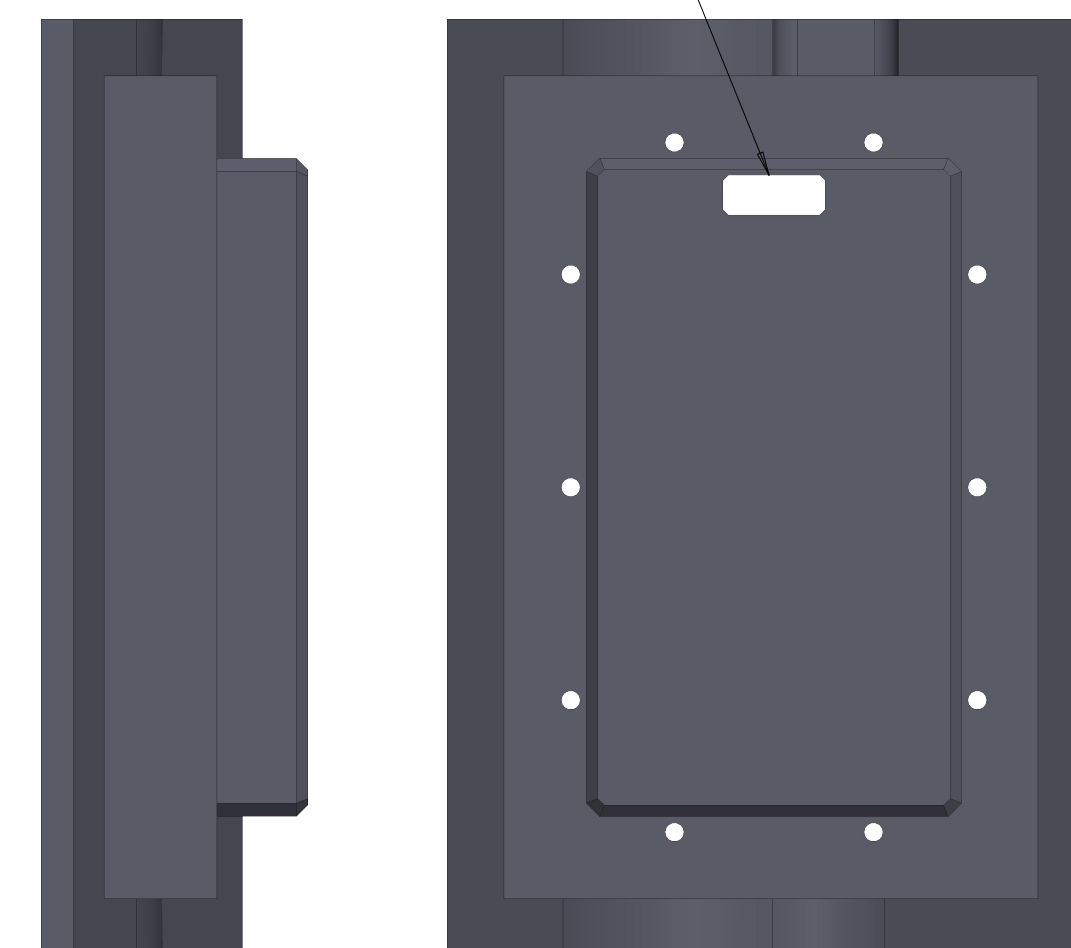

WIRE HARNESS VIEWS

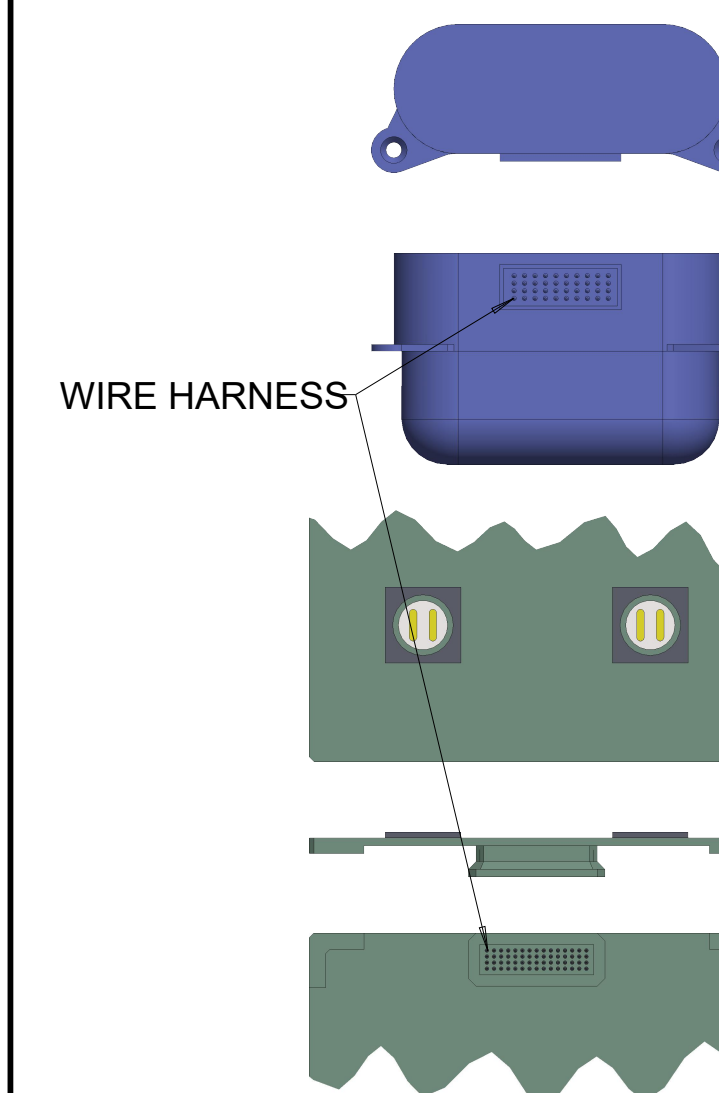

NOTE: WIRE HARNESS PORTS FOR EASE OF ASSEMBLY

B.O.M. CHART

PART NAME	PART #	QUANTITY
FACEPLATE	1	1
POLYCARBONATE LENS	2	1
GASKET	3	1
REFLECTOR	4	1
PCBA	5	1
BED MOLD	6	1
CLASPS	7	10
BUTTON	8	1
BUTTON PINS	9	2

STUDENT NAME:

THOMAS BOLITHO

SCHOOL:

BRIGHTON HIGH SCHOOL

GRADE LEVEL: CATEGORY:

12 ENGINEERING DESIGN

EMAIL ADDRESS:

BOLITHOTD19@BRIGHTONK12.COM

TEACHER NAME:

MATTHEW JOURDEN