



Crabtree, Rohrbaugh & Associates

STATE COLLEGE AREA SCHOOL DISTRICT

District-Wide
Facility Master Plan Update
STEERING COMMITTEE MEETING

June 12, 2024

PARK FOREST EDUCATIONAL PLANNING



**PLANS PURPOSELY
OMITTED FOR
SECURITY
PURPOSES, WILL BE
DISCUSSED AT IN
PERSON MEETING**

FUNCTION AND AREA SUMMARY		EXISTING PFMS			NEW PFMS PROGRAM							
		PROGRAM SPACES			REVISED PROGRAM REQUIREMENTS							
SPACE NAME		# OF	NET	SUBTOTAL	AREA	# OF	NET	SUBTOTAL	CAP	TOTAL	REMARKS	
		ROOMS	AREA		PER	ROOMS	AREA		PER	PDE		
			(S.F.)		ROOM		(S.F.)		ROOM	CAP		
GENERAL EDUCATIONAL SPACES												
GENERAL CLASSROOMS		26			850	26	22,100		25	650	Discuss S.F. since existing school has 910-930 classrooms	
	English	6	5,510			6	5,100				Grade Based, 2 Teams/Grade, 1 per Team	
	Math	7	6,365			7	5,950				Grade Based, 2 Teams/Grade, 1 per Team + (1) 6,7,8 Clsm.	
	Social Studies	6	5,530			6	5,100				Grade Based, 2 Teams/Grade, 1 per Team	
	Foreign Language	4	3,370			4	3,400					
	Health	3	2,855			3	2,550				Anticipated in Proximity to Physical Education, Department Based	
SCIENCE CLASSROOMS/LABS		7	6,245			7	9,500		20	140		
	General Lab				1,250	7	8,750					
	Chemistry Lab				1,250	0	0					
	Physics Lab/Classroom				1,250	0	0					
	Environmental Science Lab/Classroom				1,250	0	0					
	Science Office/ Prep Room	1	445		250	3	750				Designed in Tandem w/ Classrooms	
	Science Chemical Storage				150	0	0					
LEARNING SUPPORT							17,200					
	Small Group Instruction				500	6	3,000					
	Academic Literacy	6	5,055		850	6	5,100		25	150	(2) per grade	
	Tutoring Center	1	420		450	1	450		25	25		
	6,7,8 Learning Support				850	3	2,550					
	Grade Level Learning Support	3	1,705		450	3	1,350				Confirm if (3) 450's will be adequate	
	Learning Support	2	1,030		450	2	900				Confirm if 450's are adequate	
	6,7,8 Speed	1	180		450	1	450				Confirm Purpose of Program	
	6,7,8 Math 180	1	600		850	1	850					
	MTSS Interventionalist	1	655		850	1	850					
	6,7,8 Win Intervention	1	910		850	1	850					
	6,7,8 ESL	1	570		850	1	850					
				41,445					48,800			

Educational planning except of working document being utilized to evaluate existing school as new program is developed.

PARK FOREST MIDDLE SCHOOL DEVELOPMENT





Valley Vista Site Analysis- 18.5 Acres



Valley Vista Site Analysis- 18.5 Acres

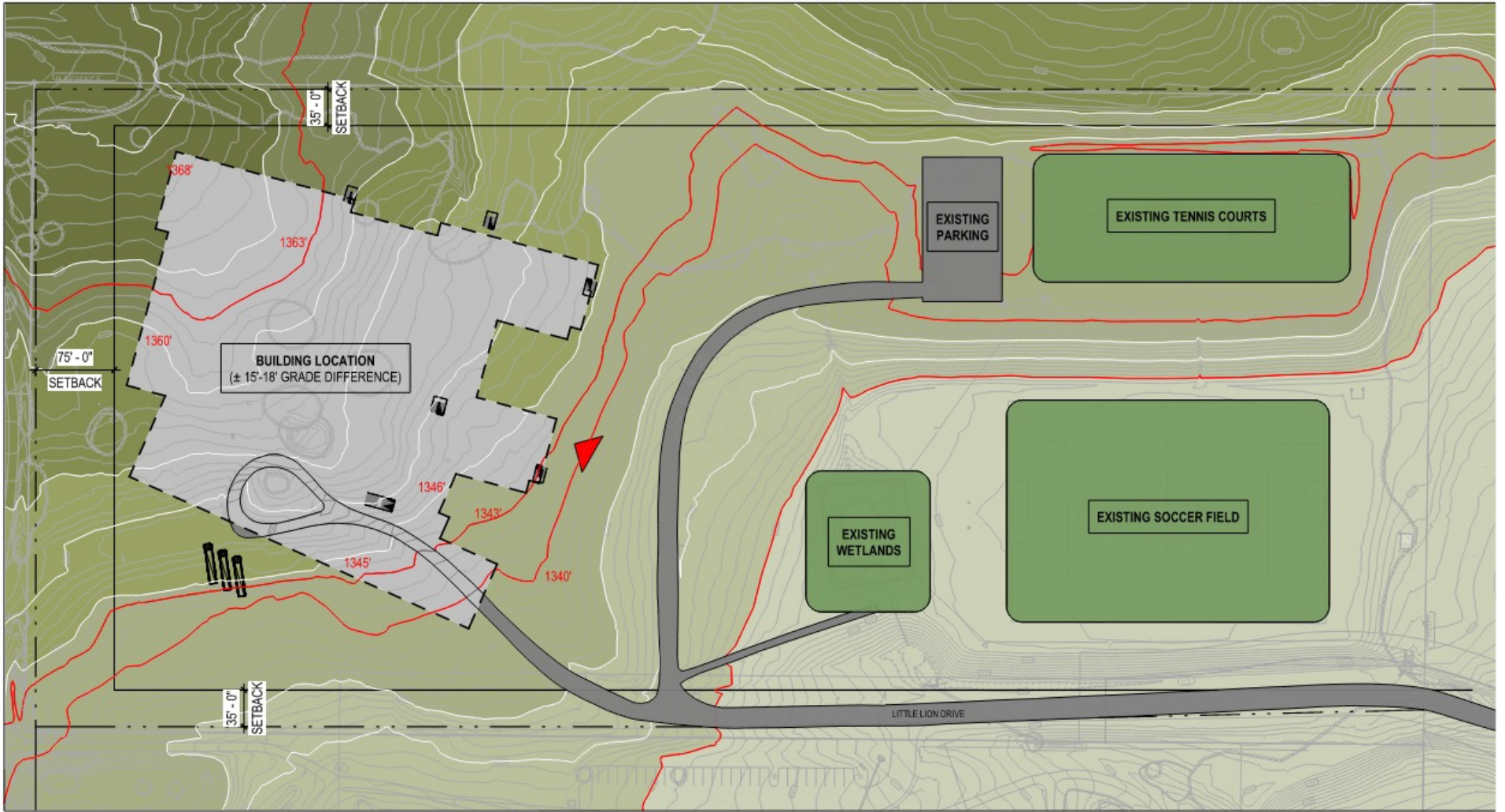

Valley Vista Site Analysis



Lot Addition- Approximately 7.5 Acres to accommodate 2 entrances & stormwater



**PLANS PURPOSELY OMITTED
FOR SECURITY PURPOSES,
WILL BE DISCUSSED AT IN
PERSON MEETING**

**PLANS PURPOSELY OMITTED
FOR SECURITY PURPOSES,
WILL BE DISCUSSED AT IN
PERSON MEETING**



Site & Building Design Evolution over Past 3 Months



Proposed Site Plan

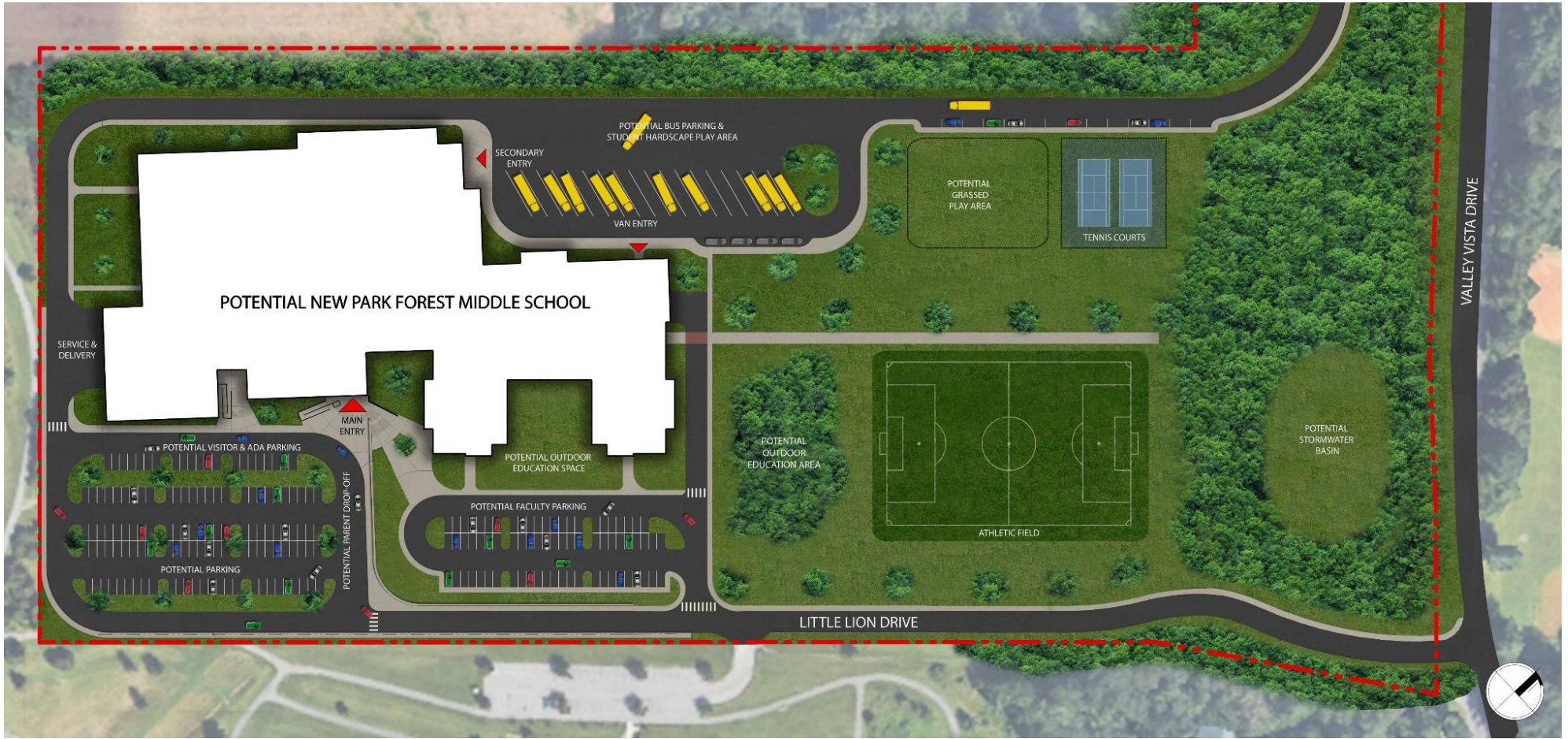

Proposed Site Plan



Proposed Site Plan- Parking Organization

POTENTIAL NEW PARK FOREST MIDDLE SCHOOL

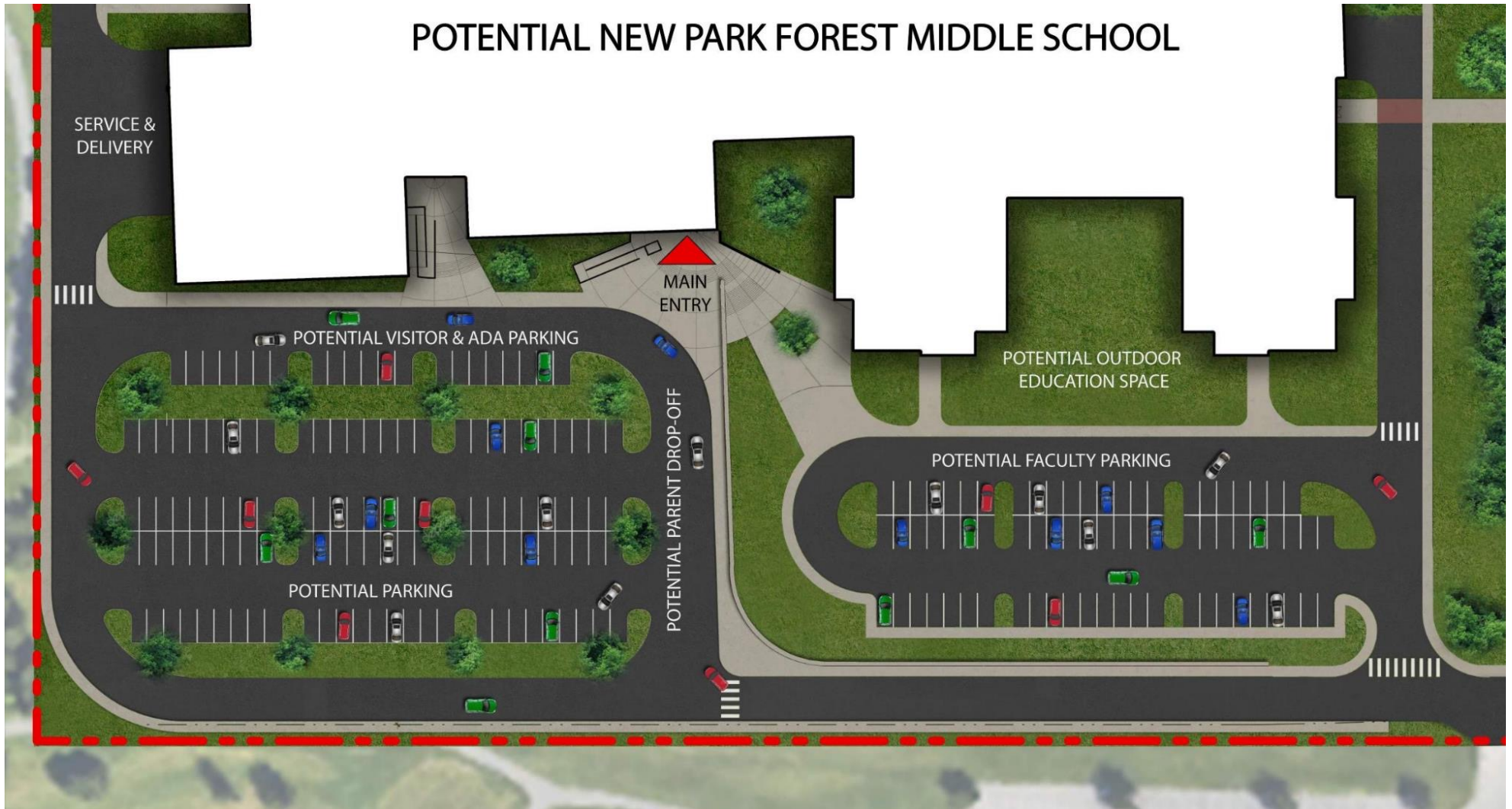

Proposed Site Plan- Little Lion Drive Entry

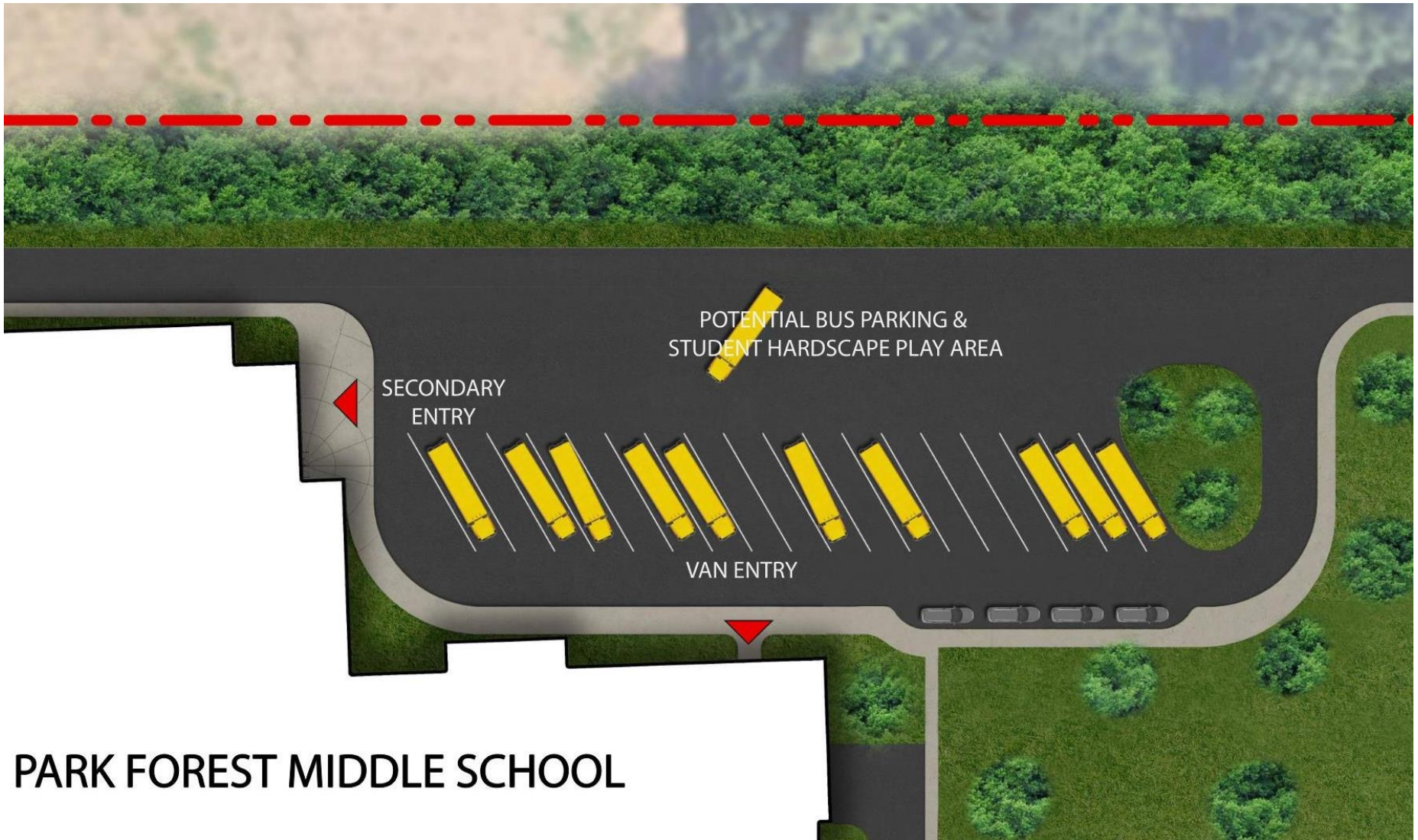

PARK FOREST MIDDLE SCHOOL

Proposed Site Plan- Bus & Van Entry (Amblewood Way)



Building Tours Completed

5 Middle Schools completed over the past 15 years throughout Pennsylvania.

- Keith Valley Middle School
- Mountain View Middle School
- Bermudian Middle School
- Middletown Middle School
- Manheim Township Middle School



Building Tours of Middle Schools



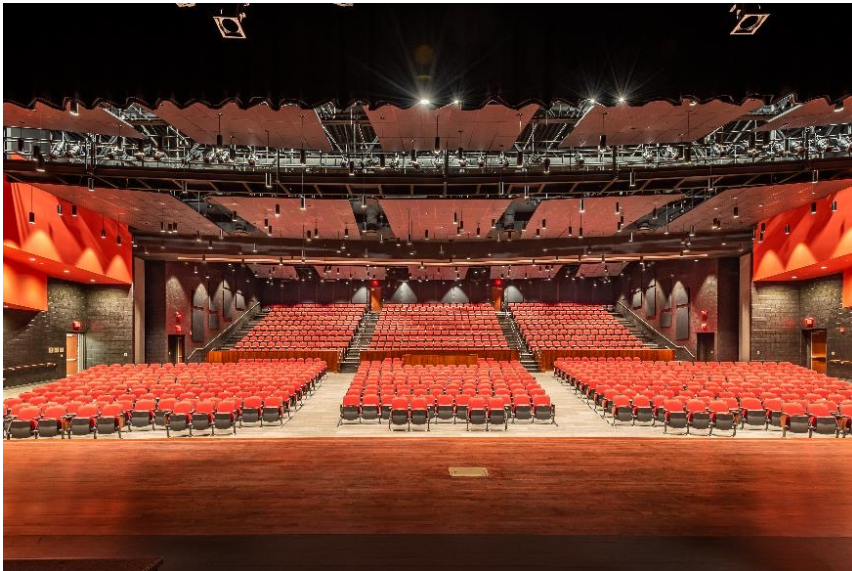

Building Tour Discussions



Building Tour Discussions

**PLANS PURPOSELY
OMITTED FOR
SECURITY
PURPOSES, WILL BE
DISCUSSED AT IN
PERSON MEETING**

**PLANS PURPOSELY
OMITTED FOR
SECURITY
PURPOSES, WILL BE
DISCUSSED AT IN
PERSON MEETING**

**PLANS PURPOSELY
OMITTED FOR
SECURITY
PURPOSES, WILL BE
DISCUSSED AT IN
PERSON MEETING**

**PLANS PURPOSELY
OMITTED FOR
SECURITY
PURPOSES, WILL BE
DISCUSSED AT IN
PERSON MEETING**

**PLANS PURPOSELY
OMITTED FOR
SECURITY
PURPOSES, WILL BE
DISCUSSED AT IN
PERSON MEETING**

Next Steps

Park Forest Middle School

- Final Confirmation of Building Program
- Floor Plan Refinement
 - Examples include
 - Office Layouts
 - Mechanical Support Design
 - Educational Support Program Design
- Three-Dimensional Design (What Does the School Look Like?)
 - Interior & Exterior
- Site Design Confirmation
 - Preliminary Land Development Discussions
- Building Code Integration
- Sustainable Design
- Cost Estimate Updates
- Transition from Study/Schematic Design to Full Design.
 - Anticipated Fall 2024 with approval by SCASD Board of School Directors.
- One year of Final Design w/ anticipated Start of Construction Fall 2025.
- Anticipated Building Opening- Fall 2027.

District-wide Facility Master Plan

- Team continues to complete DWFMP including facility assessments, athletic & field utilization, greenhouse gas emissions & option development.

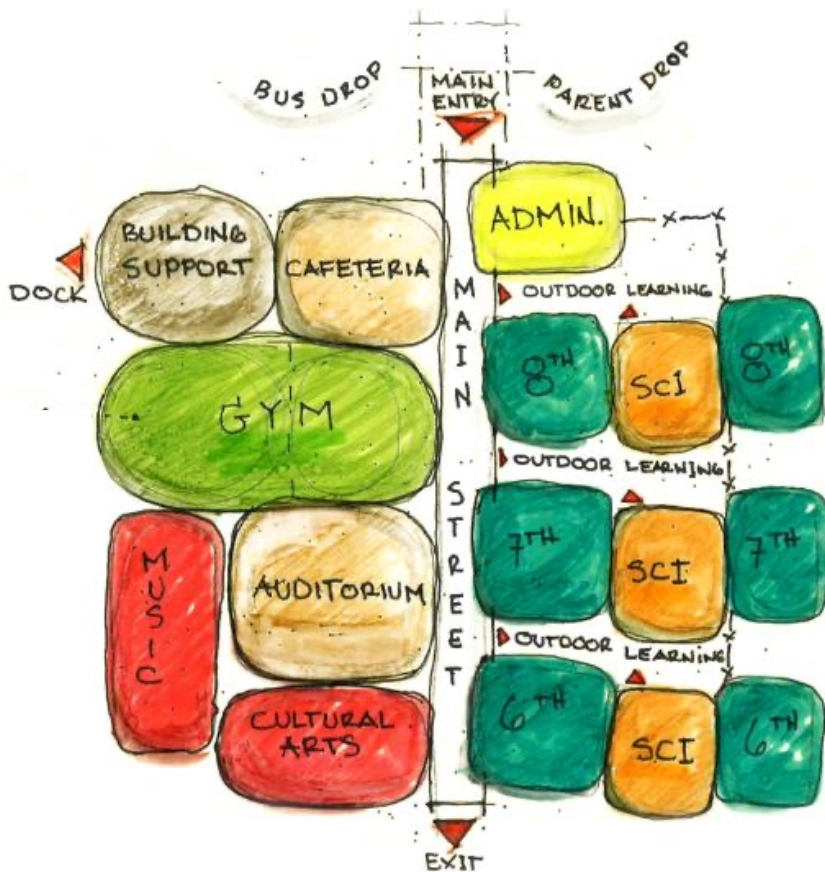



QUESTIONS

