



ALEDO
GROWTH
COMMITTEE

November 7, 2022

GROUP NORMS

01

Only one speaker at a time...no side conversations

02

Respect the person speaking...value the input of others

03

Listen with an open mind and a desire to learn...do not assume you know

04

Share ideas freely in a safe environment...do not be afraid to voice your honest opinion

05

It's not personal, it's collective...focus on the district as a whole

06

Honor the groups' time commitment...attend all meetings, be on time, stay on topic





Aledo HS Renovation Options

What's included and what's not?

- Aledo High School Minor Renovation (Option C):
 - What's included:
 - Ag Building Renovation for Additional Fine Arts/Athletic Space (Dance, Wrestling), Additional Locker Rooms
 - Interior Renovation for Performing Arts: Ensemble, Dressing & Storage
 - Expand Ag Barn
 - Add Athletic Field House Space
 - Furniture, Fixtures, and Equipment for affected areas
 - What's not included:
 - Finish updates throughout
 - Creation of collaboration spaces
 - Will not increase capacity



OPTION C

AHS Minor Renovation: Concept



OPTION C

AHS Minor Renovation: Concept



OPTION C

AHS Minor Renovation: Concept

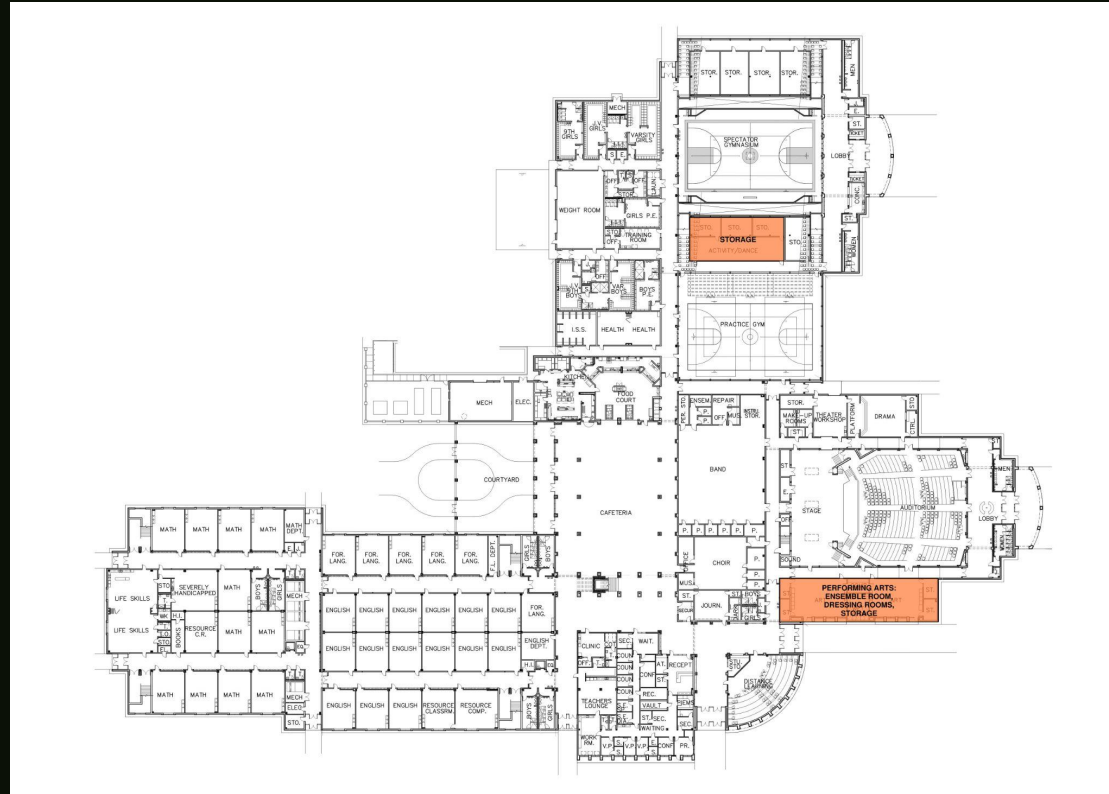

OPTION C

AHS Minor Reno: Cost Breakdown

Building Component		Construction OPC (Escalated)	Soft Costs, Fees, & Contingency	Furniture, Fixtures, & Equipment (FFE)	Project Budget OPC
Athletic Field House Addition		\$9.5M ±	\$1.5M ±	\$775K ±	\$11.8M ±
Ag Barn Expansion		\$2M ±	\$324K ±	\$161K ±	\$2.5M ±
Ag Shop Remodel (For Dance, Wrestling, Locker Rooms)		\$5.7M ±	\$933K ±	\$500K ±	\$7.1M ±
Minor Interior Renovation of AHS (For Performing Arts: Ensemble, Dressing & Storage)		\$1.6M ±	\$267K ±	\$133K ±	\$2M ±
Construction Duration	Estimated Square Footage	Total Construction OPC (Escalated)	Total Soft Costs, Fees, & Contingency	Total Furniture, Fixtures, & Equipment (FFE)	Total Project Budget OPC
10 Months	Existing + Addition	\$18.8M ±	\$3.1M ±	\$1.5M ±	\$23.4M ±



Aledo HS Renovation Options

What's included and what's not?

- Aledo High School Renovation (Option A & D):
 - What's included:
 - Will update finishes throughout the 10-12 building
 - Paint, flooring, tile, ceilings, lighting
 - New Auditorium seats and stage curtain
 - Minimal furniture updates in select areas
 - What's not included:
 - Will not address any of the program items included on the Minor Renovation option
 - Creation of collaboration spaces
 - Will not increase capacity



Aledo HS Renovation Options

What's included and what's not?

- Aledo High School Renovation & Addition (Option B & E):
 - What's included:
 - Finish updates from previous option (paint, flooring, tile, ceilings, lighting)
 - New Auditorium seats and stage curtain
 - Increased student capacity
 - Expansion to Library, Kitchen/Cafeteria, Classrooms, Band, Administration, Athletics, Dance, CTE, Theater Arts
 - Major renovation for creation of collaboration spaces
 - \$5M of Total Project Budget OPC
 - Furniture, Fixtures, and Equipment for additions, renovated areas, and existing areas in AHS 10-12 building
 - Competition Gym: 3,000± capacity:
 - \$45.1M of Total Project Budget OPC
 - What's not included:
 - Expansion of the Ag Barn
 - Renovation of Ag Mech Shop for Dance, Wrestling, Lockers
 - These spaces are addressed in expansion
 - Furniture, Fixtures, and Equipment updates at DNG



OPTION B

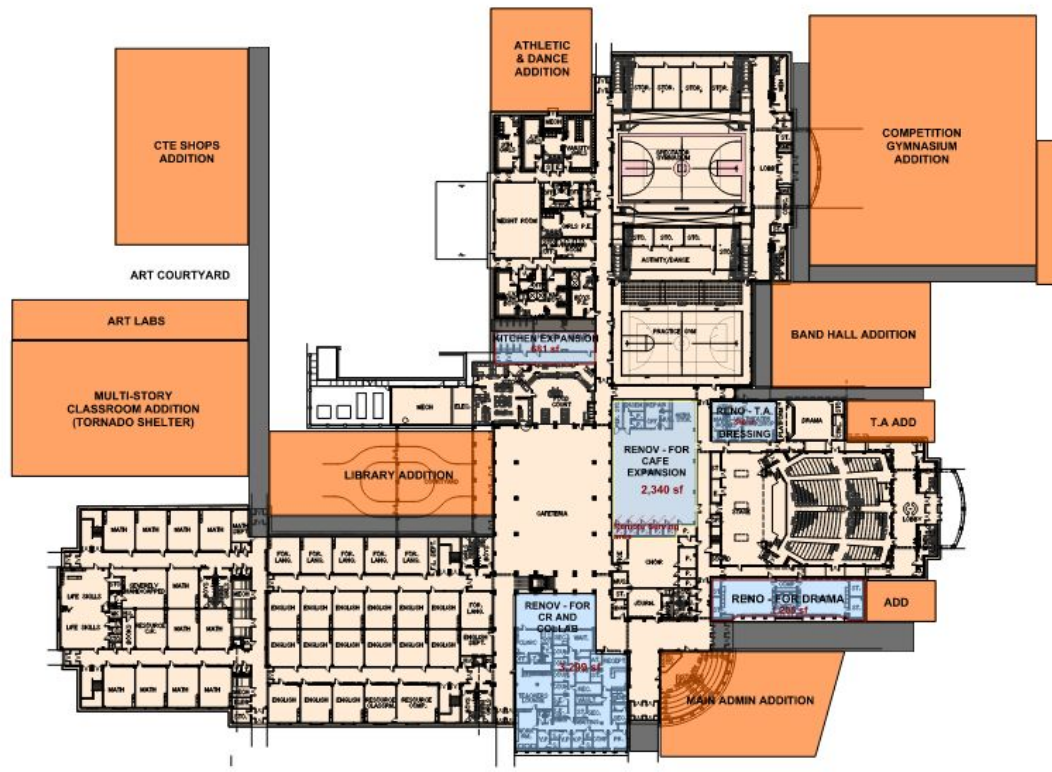

AHS Addition & Renovation: Concept

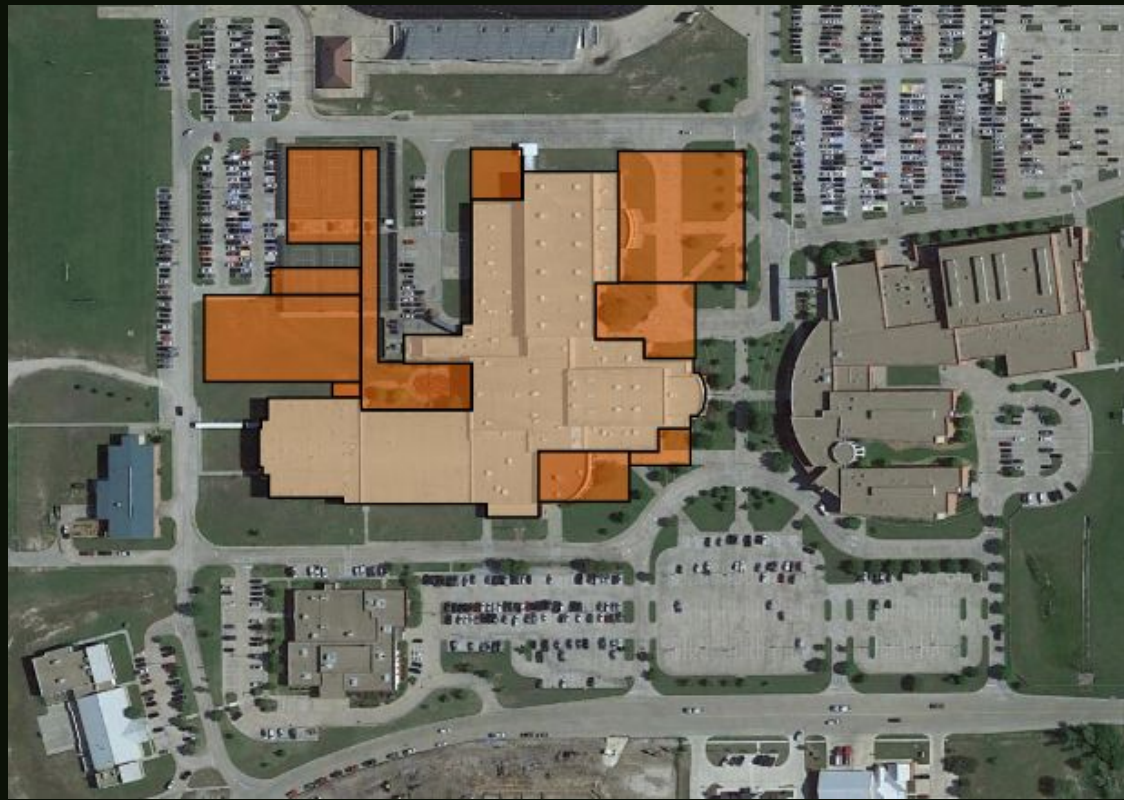

OPTION B

AHS Addition & Renovation: Concept



	EXISTING BUILDING
	POSSIBLE ADDITIONS



TEA & Code Requirements

- TEA Facility Standards:
 - As capacity grows TEA requires the following:
 - Additional Classroom and Lab space
 - Additional Library space
- Code:
 - As capacity grows code requires the following:
 - Dining/Kitchen sized appropriately for student capacity
 - Fine Arts, Athletics, Administration would need to grow to avoid overcrowding with increased occupant load
 - Tornado Shelter if addition is for 50 or more occupants
- Not required:
 - Competition Gym
 - Creation of Collaboration Spaces



Option A: Academics

AISSD would build a comprehensive HS #2 (grades 9-12) and complete a renovation of AHS

- 2 “comprehensive” high schools = all programs offered at both high schools (including all advanced/college courses & CTE)
- Many options for grade levels at HS#2
 - open only with limited grade levels & grow to 9-12
 - choice for some grades (i.e., 11&12)
 - some other scenario
- In the first year/2 years of opening, there may be some sharing of staff for efficiency
- Renovation of AHS would not increase academic spaces, create collaborative learning spaces, or expand library



Option A: Co-curricular Activities

AISSD would build a comprehensive HS #2 (grades 9-12) and complete a renovation of AHS

- 2 “comprehensive” high schools = all programs offered at both high schools (including all co-curricular activities)
- Many options for grade levels at HS#2 means options for UIL/competition
 - open with limited grade levels & grow to 9-12
 - choice for some grades (i.e., 11&12)
 - When to start varsity competition?
 - High schools could be in 2 different UIL classifications at start
- Facilities differences:
- AHS:
 - Varsity competition stadium (to be shared)
 - No facility changes for fine arts or athletics
- HS#2:
 - 3000-seat gym included
 - Black box theater included
 - No varsity competition stadium included



Option B: Academics

AISD would construct an addition and renovation to AHS.

- All academic programming would remain at AHS/DNG
- AHS addition/renovation would:
 - Add instructional/classroom space
 - Create collaborative learning spaces
 - Expand library
- AHS addition/renovation makes AHS a stand-alone 3000-student high school



Option B: Co-curricular activities

AISSD would construct an addition and renovation to AHS.

- All co-curricular programming would remain at AHS/DNG
- AHS addition/renovation makes AHS a stand-alone 3000-student high school
- AHS addition/renovation would:
 - Add fine arts space (band, dance, theater arts, black box theater, art labs)
 - Add 3,000-seat competition gym
 - Add wrestling/locker rooms/field house space



Option C: Academics

AISD would construct a college & career academy and complete a minor renovation to AHS to repurpose some spaces for student programs.

- For state purposes, Aledo ISD would have one high school
- Some academic programs would be offered at AHS/DNG & some would be offered at the College/Career Academy
- At CCA:
 - College credit courses
 - CTE courses
- It is likely that every high school student would attend the CCA
- There are many options for scheduling
- There are options related to bus shuttles
- Use of CCA could flex over time due to enrollment



Option C: Co-curricular Activities

AISD would construct a college & career academy and complete a minor renovation to AHS to repurpose some spaces for student programs.

- Aledo High School (every single student is an Aledo HS student)
 - Larger UIL classification
 - Options for scheduling, bus shuttles
 - Dedicated space for dance/wrestling with locker rooms
 - Interior renovation for performing arts
 - Auditorium renovations
 - Black box Theatre
 - Ensemble, dressing, and storage for band
 - Expand athletic field house space, additional locker rooms



Option D: Academics

AISSD would construct phase 1 of a new comprehensive HS #2 and complete a renovation of AHS.

- 2 “comprehensive” high schools = all programs offered at both high schools (including all advanced/college courses & CTE)
- Many options for grade levels at HS#2
 - open only with limited grade levels & grow to 9-12
 - choice for some grades (i.e., 11&12)
 - some other scenario
- In the first year/2 years of opening, there may be some sharing of staff for efficiency
- HS#2 would operate as a smaller high school till Phase 2 of the school is complete



Option D: Co-curricular Activities

AISSD would construct phase 1 of a new comprehensive HS #2 and complete a renovation of AHS.

- 2 “comprehensive” high schools = all programs offered at both high schools (including all co-curricular activities)
 - 2nd high school would be 1500 students and so in a different UIL classification until phase 2 of 2nd high school was completed in a future bond
- Many options for grade levels at HS#2 means options for UIL/competition
 - open with limited grade levels & grow to 9-12
 - choice for some grades (i.e., 11&12)
 - When to start varsity competition?
- Facilities differences:
 - AHS:
 - Varsity competition stadium (to be shared)
 - No facility changes for fine arts or athletics
 - HS#2:
 - 3000-seat gym included
 - Black box theater included
 - No varsity competition stadium included



Option E: Academics

AISSD would construct an addition and renovation of AHS and phase 1 of a new comprehensive HS #2

- 2 “comprehensive” high schools = all programs offered at both high schools (including all advanced/college courses & CTE)
- Many options for grade levels at HS#2
 - open only with limited grade levels & grow to 9-12
 - choice for some grades (i.e., 11&12)
 - some other scenario
- In the first year/2 years of opening, there may be some sharing of staff for efficiency
- HS#2 would operate as a smaller high school till Phase 2 of the school is complete



Option E: Academics

AISSD would construct an addition and renovation of AHS and phase 1 of a new comprehensive HS #2

- AHS addition/renovation would:
 - Add instructional/classroom space
 - Create collaborative learning spaces
 - Expand library



Option E: Co-curricular Activities

AISSD would construct an addition and renovation of AHS and phase 1 of a new comprehensive HS #2

- Aledo High School addition/renovation
 - All co-curricular programming would remain at AHS/DNG
 - AHS addition/renovation makes AHS a stand-alone 3,000-student high school
 - AHS addition/renovation would:
 - Add fine arts space (band, dance, theater arts, black box theater, art labs)
 - Add 3,000-seat competition gym
 - Add wrestling/locker rooms/field house space
- High School #2
 - 2 “comprehensive” high schools = all programs offered at both high schools (including all co-curricular activities)
 - 2nd high school would be 1500 students and so in a different UIL classification until phase 2 of 2nd high school was completed in a future bond
 - Many options for grade levels at HS#2 means options for UIL/competition
 - open with limited grade levels & grow to 9-12
 - choice for some grades (i.e., 11&12)
 - When to start varsity competition?
- Facilities differences:
 - Varsity competition stadium (to be shared)



Reflection/Discussion/Report/ Rethink (RDRR) Process (STEPS)

1. Individual **reflection**
2. Group **discussion**
3. Group **report**
4. Individual **rethink**



Reflection/Discussion/Report/ Rethink (RDRR) Process

Considering each option through each of 4 lenses, then as a whole

1. Academic opportunities
2. Co-curricular opportunities
3. Capacity/growth
4. Finance



Reflection/Discussion/Report/ Rethink (RDRR) Process

Roles:

- Facilitator
- Reporters (2)
- Time keeper



Reflection/Discussion/Report/ Rethink (RDRR) Process

We will ask you to repeat the RDRR process for each of the 4 lenses:

1. Academic opportunities
2. Co-curricular opportunities
3. Capacity/growth
4. Finance

Then we will ask you to review the options broadly



Reflection/Discussion/Report (RDR) Process

Tonight's lenses:

- Academic experience
- Co-curricular experience



Reflection/Discussion/Report (RDR) Process

academic experience lens



RDRR Process (STEP 1)



5:00

1. Individual **reflection**

- 5 minutes
- Consider each option through one lens at a time
- Consider these through the **academic experience** lens:
 - *Creating the most opportunity for students academically*
 - *Creating the most flexibility for current and future academic opportunities for students*
- Record the score and provide written feedback
- You will be able to revise if you'd like after the group discussion
- Want to see another option? Write it on the “other option” worksheet.



15:00

2. Group **discussion**

- 15 minutes
- Facilitator will record
- Answer these questions related to **academic experience** as a group:
 - *Which option do you believe creates the most opportunity for students academically? Why?*
 - *Which option do you believe creates the most flexibility for current and future academic opportunities for students? Why?*
- Share any questions for recording by facilitator
- Share any other options or adjustments to the options that you would like more info about



10:00

3. Group **report**

- 10 minutes
- Choose 2 reporters (1 for each question)
- Each group will report to the large group the answers to these questions related to **academic experience**:
 - *Which option do you believe creates the most opportunity for students academically? Why?*
 - *Which option do you believe creates the most flexibility for current and future academic opportunities for students? Why?*



RDRR Process (STEP 4)



5:00

4. Individual **rethink**

- 5 minutes
- Individually, look back at the ratings and comments that you marked on your worksheet and indicate if you made any adjustments after discussions/reports in the box marked
- We will synthesize the individual reports and provide that synthesized information to the group



Reflection/Discussion/Report (RDR) Process

co-curricular experience lens



RDRR Process (STEP 1)



5:00

1. Individual **reflection**

- 5 minutes
- Consider each option through one lens at a time
- Consider these through the **co-curricular experience** lens:
 - *Creating the most opportunity for students for co-curricular activities*
 - *Creating the most flexibility for current and future academic opportunities for students*
- Record the score and provide written feedback
- You will be able to revise if you'd like after the group discussion
- Want to see another option? Write it on the “other option” worksheet.



RDRR Process (STEP 2)

A graphic showing a timer set to 15:00. The numbers are white with a black outline, set against a background of colorful, overlapping geometric shapes in shades of green, blue, and orange.

2. Group **discussion**

- 15 minutes
- Facilitator will record
- Answer these questions related to **co-curricular experience** as a group:
 - *Which option do you believe creates the most opportunity for students in co-curricular activities? Why?*
 - *Which option do you believe creates the most flexibility for current and future co-curricular opportunities for students? Why?*
- Share any questions for recording by facilitator
- Share any other options or adjustments to the options that you would like more info about



10:00

3. Group **report**

- 10 minutes
- Choose 2 reporters (1 for each question)
- Each group will report to the large group the answers to these questions related to **co-curricular experience**:
 - *Which option do you believe creates the most opportunity for students in co-curricular activities? Why?*
 - *Which option do you believe creates the most flexibility for current and future co-curricular opportunities for students? Why?*



RDRR Process (STEP 4)



5:00

4. Individual **rethink**

- 5 minutes
- Individually, look back at the ratings and comments that you marked on your worksheet and indicate if you made any adjustments after discussions/reports in the box marked
- We will synthesize the individual reports and provide that synthesized information to the group





HIGH SCHOOL PROJECT PLANNING ADDITIONAL OPTIONS

OPTION F:



**EXISTING
DNG/AHS**
(3,135)



**COLLEGE & CAREER
ACADEMY**
(+1,200)
Open 2026-2027



**PHASE 1
HIGH SCHOOL #2**
(+1,500)
Open 2026-2027

**2023 BOND
Capacity: 5,835**



AHS MINOR RENO
(No capacity increase)
Open 2026-2027



OPTION F

Cost Analysis: \$368.6M ±*

*Cost shown does not include cost of land.



COLLEGE & CAREER ACADEMY (+1,200)

Open 2026-2027

Construction Duration	Estimated Square Footage	Total Construction OPC (Escalated)	Soft Costs, Fees, & Contingency	Furniture, Fixtures, & Equipment (FFE)	Total Project Budget OPC
24 Months	155,000 SF ±	\$81.3M ±	\$13.3M ±	\$6.6M ±	\$101.2M ±

ALEDO HIGH SCHOOL MINOR RENOVATION (+0)

Open 2026-2027

Construction Duration	Estimated Square Footage	Total Construction OPC (Escalated)	Soft Costs, Fees, & Contingency	Furniture, Fixtures, & Equipment (FFE)	Total Project Budget OPC
10 Months	Existing + Addition	\$18.8M ±	\$3.1M ±	\$1.5M ±	\$23.4M ±

PHASE 1 HIGH SCHOOL #2 (+1,500)

Open 2026-2027

Construction Duration	Estimated Square Footage	Total Construction OPC (Escalated)	Soft Costs, Fees, & Contingency	Furniture, Fixtures, & Equipment (FFE)	Total Project Budget OPC
24 Months	346,500 SF ±	\$201.5M ±	\$34.2M ±	\$8.3M ±	\$244M ±

OPTION G:

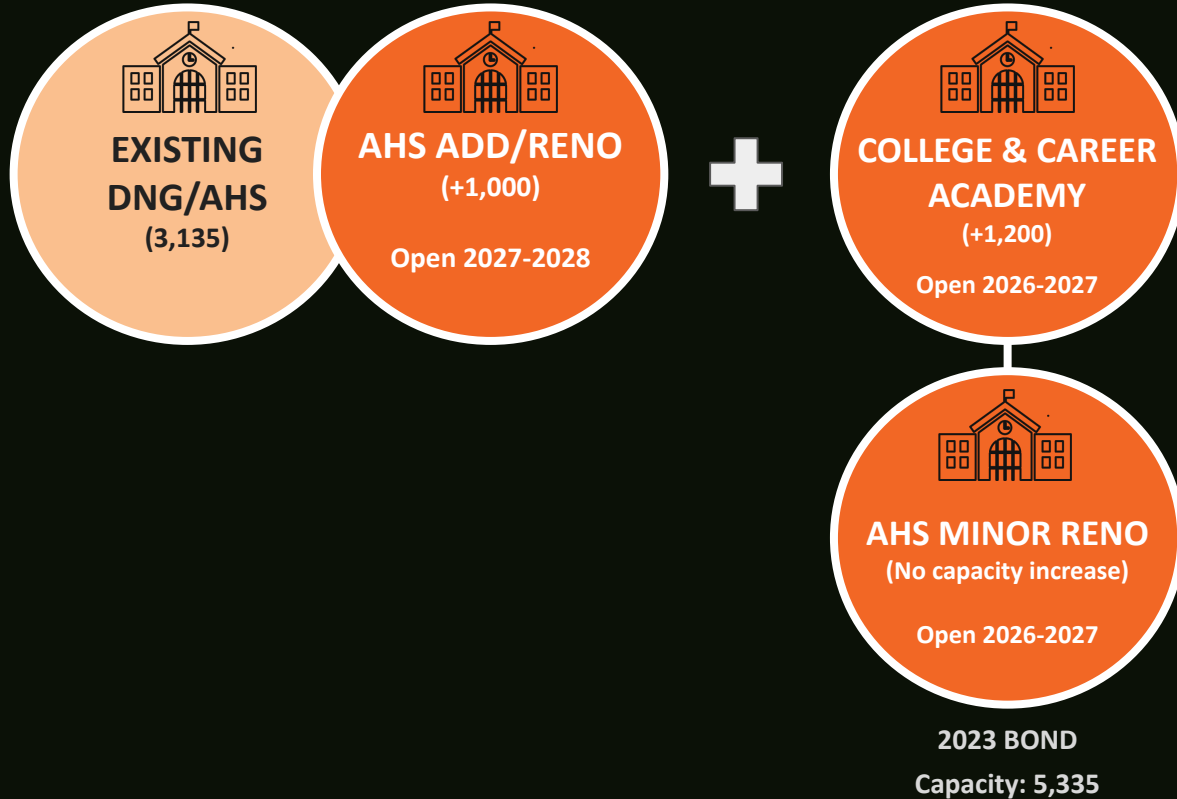

OPTION G

Cost Analysis: \$340.6M ±*

*Cost shown does not include cost of land.

*Cost on this option reduced by \$600,000 to avoid overlap in scope



ALEDO HIGH SCHOOL ADDITION & RENOVATION (+1,000)

Open 2027-2028

Construction Duration	Estimated Square Footage	Total Construction OPC (Escalated)	Soft Costs, Fees, & Contingency	Furniture, Fixtures, & Equipment (FFE)	Total Project Budget OPC
32 Months	237,000 SF ± (Addition)	\$172.6M ±	\$29.8M ±	\$14.2M ±	\$216.6M ±

COLLEGE & CAREER ACADEMY (+1,200)

Open 2026-2027

Construction Duration	Estimated Square Footage	Total Construction OPC (Escalated)	Soft Costs, Fees, & Contingency	Furniture, Fixtures, & Equipment (FFE)	Total Project Budget OPC
24 Months	155,000 SF ±	\$81.3M ±	\$13.3M ±	\$6.6M ±	\$101.2M ±

ALEDO HIGH SCHOOL MINOR RENOVATION (+0)

Open 2026-2027

Construction Duration	Estimated Square Footage	Total Construction OPC (Escalated)	Soft Costs, Fees, & Contingency	Furniture, Fixtures, & Equipment (FFE)	Total Project Budget OPC
10 Months	Existing + Addition	\$18.8M ±	\$3.1M ±	\$1.5M ±	\$23.4M ±

OPTION H:

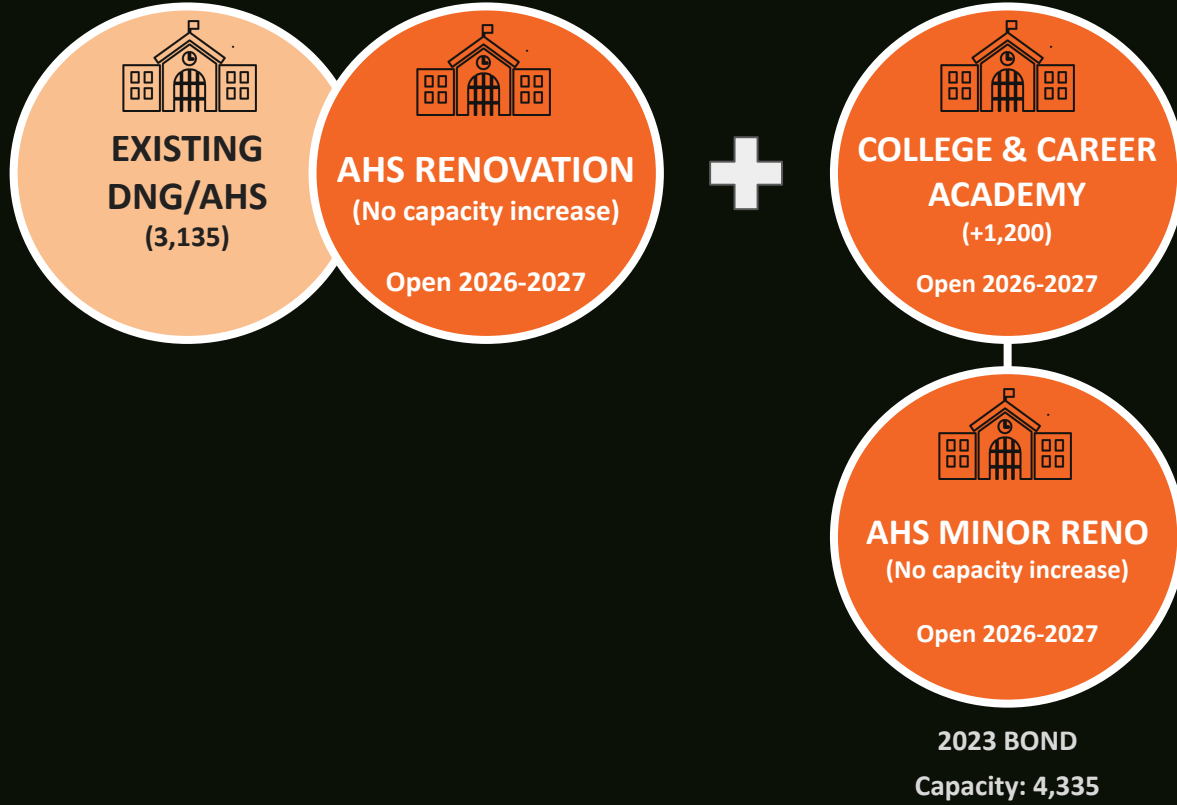

OPTION H

Cost Analysis: \$176.2M ±*

*Cost shown does not include cost of land.

*Cost on this option reduced by \$600,000 to avoid overlap in scope



ALEDO HIGH SCHOOL RENOVATION (+0)

Open 2026-2027

Construction Duration	Estimated Square Footage	Total Construction OPC (Escalated)	Soft Costs, Fees, & Contingency	Furniture, Fixtures, & Equipment (FFE)	Total Project Budget OPC
24 Months	AHS	\$41.9M ±	\$6.9M ±	\$3.4M ±	\$52.2M ±

COLLEGE & CAREER ACADEMY (+1,200)

Open 2026-2027

Construction Duration	Estimated Square Footage	Total Construction OPC (Escalated)	Soft Costs, Fees, & Contingency	Furniture, Fixtures, & Equipment (FFE)	Total Project Budget OPC
24 Months	155,000 SF ±	\$81.3M ±	\$13.3M ±	\$6.6M ±	\$101.2M ±

ALEDO HIGH SCHOOL MINOR RENOVATION (+0)

Open 2026-2027

Construction Duration	Estimated Square Footage	Total Construction OPC (Escalated)	Soft Costs, Fees, & Contingency	Furniture, Fixtures, & Equipment (FFE)	Total Project Budget OPC
10 Months	Existing + Addition	\$18.8M ±	\$3.1M ±	\$1.5M ±	\$23.4M ±

OPTION I:



**EXISTING
DNG/AHS**
(3,135)



AHS ADD/RENO
(+1,000)
Open 2027-2028



**COLLEGE & CAREER
ACADEMY**
(+1,200)
Open 2026-2027



**PHASE 1
HIGH SCHOOL #2**
(+1,500)
Open 2026-2027



AHS MINOR RENO
(No capacity increase)
Open 2026-2027

**2023 BOND
Capacity: 6,835**



OPTION I

Cost Analysis: \$584.6M ±*

*Cost shown does not include cost of land.

*Cost on this option reduced by \$600,000 to avoid overlap in scope



ALEDO HIGH SCHOOL ADDITION & RENOVATION (+1,000)

Open 2027-2028

Construction Duration	Estimated Square Footage	Total Construction OPC (Escalated)	Soft Costs, Fees, & Contingency	Furniture, Fixtures, & Equipment (FFE)	Total Project Budget OPC
32 Months	237,000 SF ± (Addition)	\$172.6M ±	\$29.8M ±	\$14.2M ±	\$216.6M ±

COLLEGE & CAREER ACADEMY (+1,200)

Open 2026-2027

Construction Duration	Estimated Square Footage	Total Construction OPC (Escalated)	Soft Costs, Fees, & Contingency	Furniture, Fixtures, & Equipment (FFE)	Total Project Budget OPC
24 Months	155,000 SF ±	\$81.3M ±	\$13.3M ±	\$6.6M ±	\$101.2M ±

ALEDO HIGH SCHOOL MINOR RENOVATION (+0)

Open 2026-2027

Construction Duration	Estimated Square Footage	Total Construction OPC (Escalated)	Soft Costs, Fees, & Contingency	Furniture, Fixtures, & Equipment (FFE)	Total Project Budget OPC
10 Months	Existing + Addition	\$18.8M ±	\$3.1M ±	\$1.5M ±	\$23.4M ±

PHASE 1 HIGH SCHOOL #2 (+1,500)

Open 2026-2027

Construction Duration	Estimated Square Footage	Total Construction OPC (Escalated)	Soft Costs, Fees, & Contingency	Furniture, Fixtures, & Equipment (FFE)	Total Project Budget OPC
24 Months	346,500 SF ±	\$201.5M ±	\$34.2M ±	\$8.3M ±	\$244M ±

OPTION J:



**EXISTING
DNG/AHS**
(3,135)



AHS RENOVATION
(No capacity increase)
Open 2026-2027



**COLLEGE & CAREER
ACADEMY**
(+1,200)
Open 2026-2027



**PHASE 1
HIGH SCHOOL #2**
(+1,500)
Open 2026-2027



AHS MINOR RENO
(No capacity increase)
Open 2026-2027

2023 BOND
Capacity: 5,835



OPTION I

Cost Analysis: \$420.2M ±*

*Cost shown does not include cost of land.
*Cost on this option reduced by \$600,000
to avoid overlap in scope



ALEDO HIGH SCHOOL RENOVATION (+0)

Open 2026-2027

Construction Duration	Estimated Square Footage	Total Construction OPC (Escalated)	Soft Costs, Fees, & Contingency	Furniture, Fixtures, & Equipment (FFE)	Total Project Budget OPC
24 Months	AHS	\$41.9M ±	\$6.9M ±	\$3.4M ±	\$52.2M ±

COLLEGE & CAREER ACADEMY (+1,200)

Open 2026-2027

Construction Duration	Estimated Square Footage	Total Construction OPC (Escalated)	Soft Costs, Fees, & Contingency	Furniture, Fixtures, & Equipment (FFE)	Total Project Budget OPC
24 Months	155,000 SF ±	\$81.3M ±	\$13.3M ±	\$6.6M ±	\$101.2M ±

ALEDO HIGH SCHOOL MINOR RENOVATION (+0)

Open 2026-2027

Construction Duration	Estimated Square Footage	Total Construction OPC (Escalated)	Soft Costs, Fees, & Contingency	Furniture, Fixtures, & Equipment (FFE)	Total Project Budget OPC
10 Months	Existing + Addition	\$18.8M ±	\$3.1M ±	\$1.5M ±	\$23.4M ±

PHASE 1 HIGH SCHOOL #2 (+1,500)

Open 2026-2027

Construction Duration	Estimated Square Footage	Total Construction OPC (Escalated)	Soft Costs, Fees, & Contingency	Furniture, Fixtures, & Equipment (FFE)	Total Project Budget OPC
24 Months	346,500 SF ±	\$201.5M ±	\$34.2M ±	\$8.3M ±	\$244M ±

Additional High School Options: Original Options



Previous High School Options: Summary

Option	Building Components	Year of Bond Election	Total Project Budget OPC
A	High School #2 + Aledo High School Renovation	2023	\$553.9M ±
B	Aledo High School Addition & Renovation	2023	\$216.6M ±
C	New College & Career Academy + Aledo High School Minor Renovation	2023	*\$124.6M ±
D	Phase 1 of High School #2 + Aledo High School Renovation	2023	\$296.2M ±
E	Aledo High School Addition & Renovation + Phase 1 of High School #2	2023	\$460.6M ±

* Cost updated since last meeting to reflect revised cost of College & Career Academy

Additional High School Options: New Options



New High School Options: Summary

Option	Building Components	Year of Bond Election	Total Project Budget OPC
F	New College & Career Academy + Aledo High School Minor Renovation + Phase 1 of High School #2	2023	\$368.6M ±
G	New College & Career Academy + Aledo High School Minor Renovation + Aledo High School Addition & Renovation	2023	\$340.6M±
H	New College & Career Academy + Aledo High School Minor Renovation + Aledo High School Renovation	2023	\$176.2M±
I	New College & Career Academy + Aledo High School Minor Renovation + Aledo High School Addition & Renovation + Phase 1 of High School #2	2023	\$584.6M±
J	New College & Career Academy + Aledo High School Minor Renovation + Phase 1 of High School #2 + Aledo High School Renovation	2023	\$420.2M±

Future Dates

- Eagle Mountain Saginaw Tour
 - Tentatively November 30th
- Community Meetings
 - December 6th 5:30-7:30 p.m.
 - December 8th 5:30-7:30 p.m.



Thoughts?

- What bond program are you thinking about right now?



GROWING GREATNESS | CONNECTING COMMUNITY



ALL IN ALEDO



ALEDO GROWTH COMMITTEE

Where are we now???

Charge



- The Aledo Growth Committee is charged by the Board of Trustees to:
 - represent the priorities, expectations and values of the entire community,
 - consider the needs of all of the district's students,
 - use facts and data to make informed decisions,
 - understand the district's finances to develop a program that is fiscally sound and efficient,
 - recommend a long-range facility master plan that meets the district's building capacity needs into the future, and
 - recommend to the Board of Trustees a bond program for a possible upcoming bond election.

Purpose



- The purpose of the Aledo Growth Committee is to represent the Aledo ISD community in:
 - the study of data related to enrollment, finances, instructional priorities and facility needs,
 - constructing a long-range facility master plan for the district to address districtwide educational infrastructure needs due to rapidly growing student enrollment and aging facilities, and
 - recommending to the Board of Trustees a bond program for a possible upcoming bond election.

GROUP NORMS

01

Only one speaker at a time...no side conversations

02

Respect the person speaking...value the input of others

03

Listen with an open mind and a desire to learn...do not assume you know

04

Share ideas freely in a safe environment...do not be afraid to voice your honest opinion

05

It's not personal, it's collective...focus on the district as a whole

06

Honor the groups' time commitment...attend all meetings, be on time, stay on topic



Summer 2022

Population and Survey
Analysts

www.pasatx.com



Aledo ISD

Demographic Study

Three Scenarios of Growth

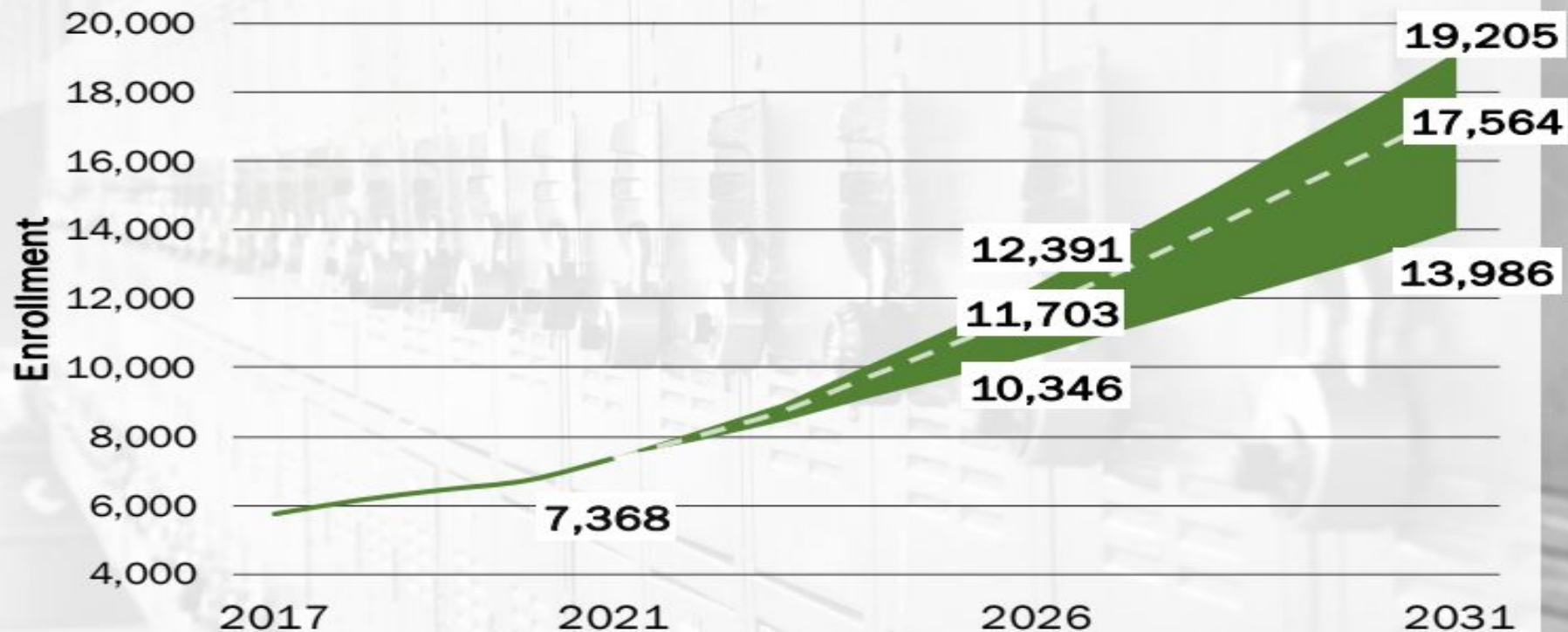

Low/High Range

Actual

Projected



Projected KN-5th Enrollment Compared to Capacity

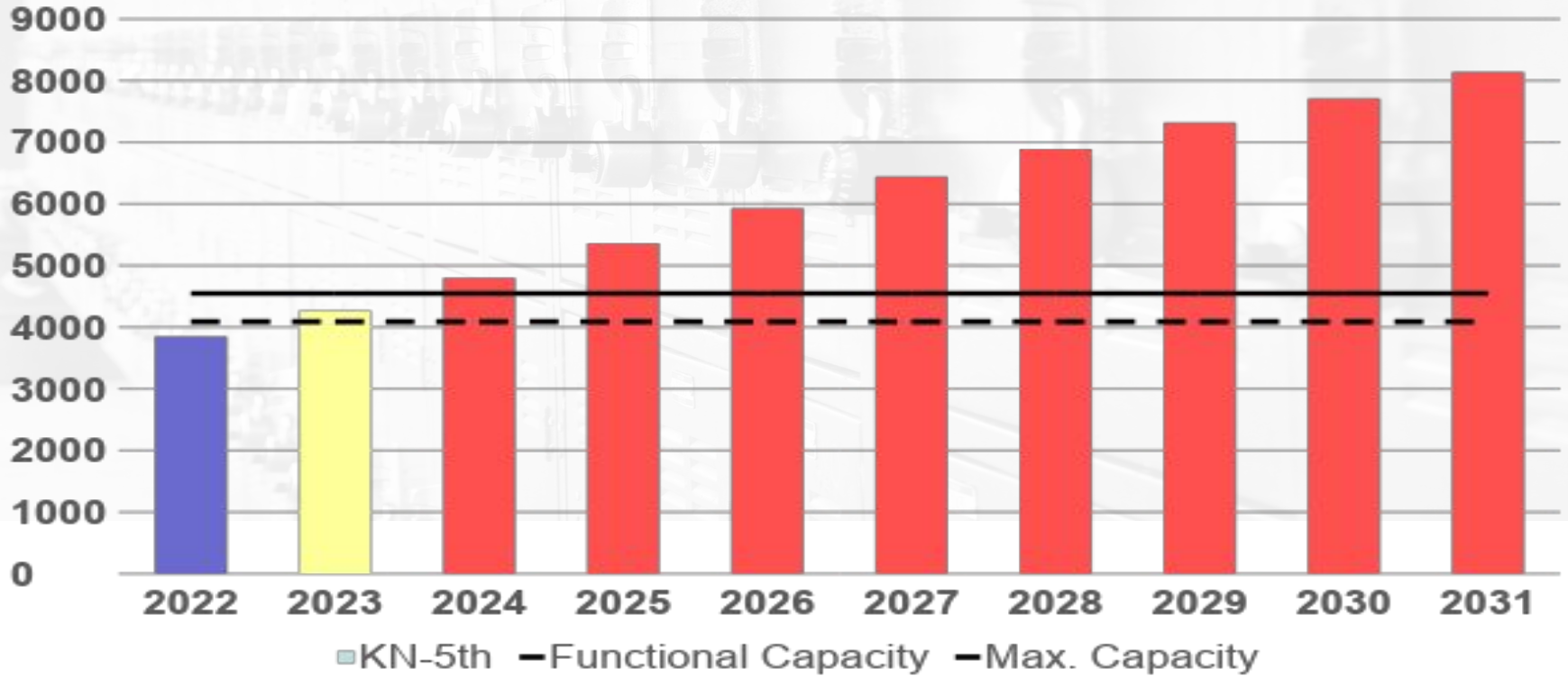

Projected 6th-8th Enrollment Compared to Capacity

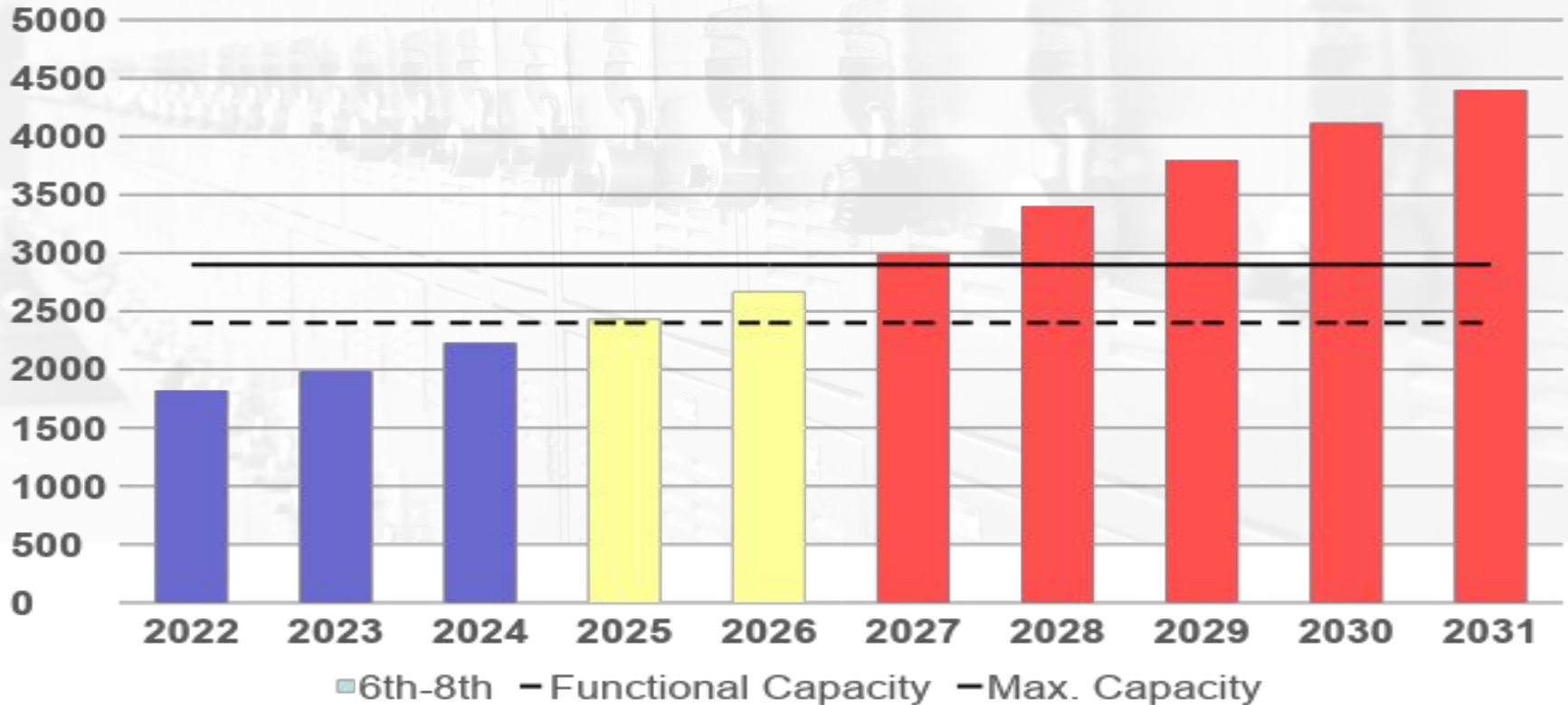

Projected 9th-12th Enrollment Compared to Capacity

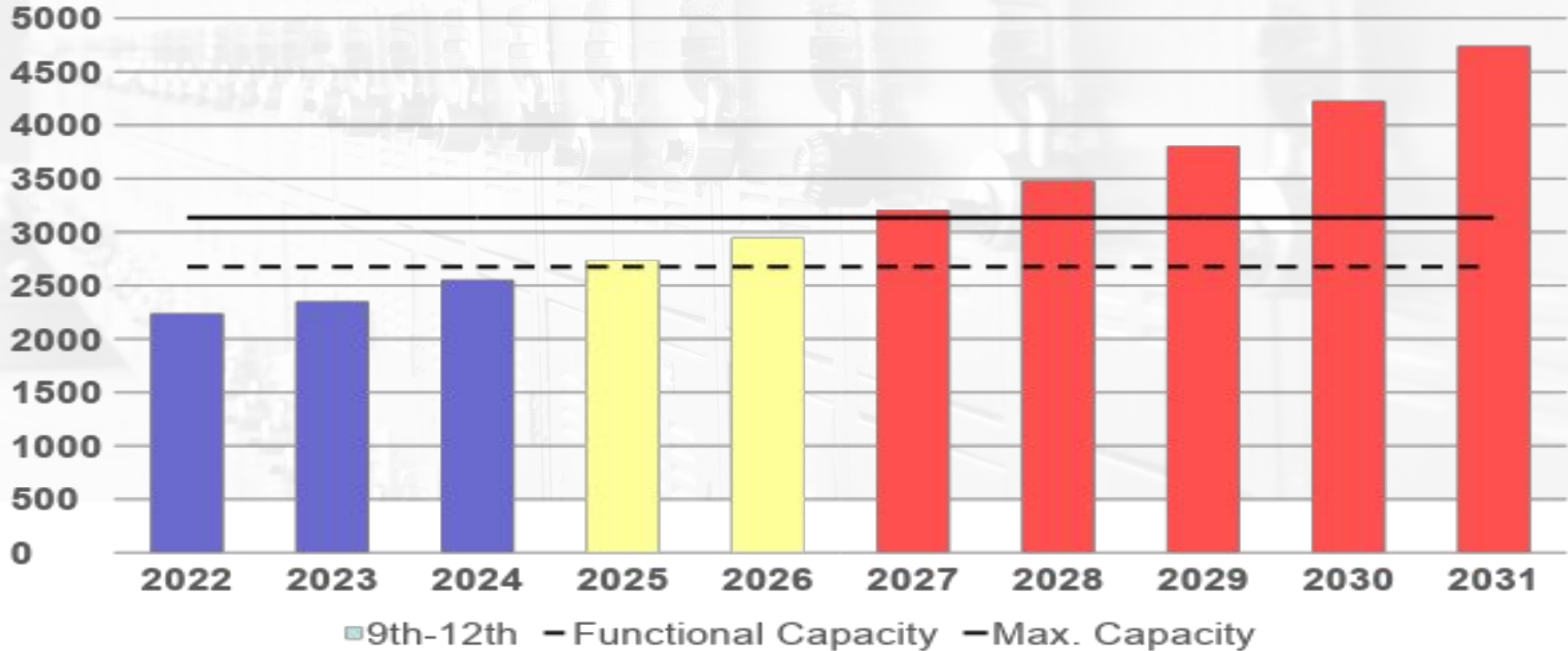



Preliminary Bond Capacity Analysis

- The following demonstrates Aledo ISD's projected bond capacity for a May 2023 bond election based upon the assumptions summarized herein.

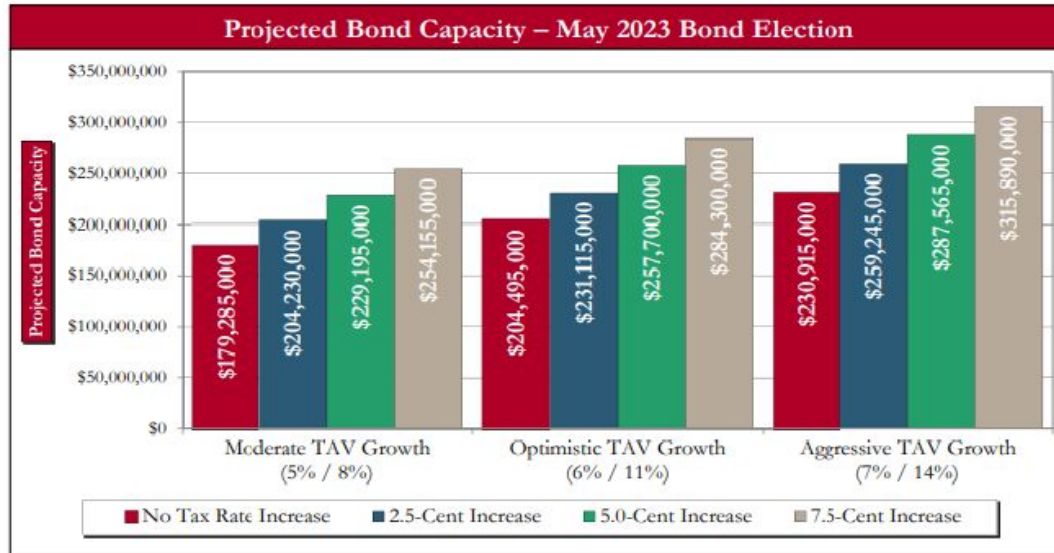

GROWTH BOND ???



Preliminary Bond Capacity Analysis – Growth Bond: Optimistic TAV Growth Scenarios

BOK FINANCIAL SECURITIES

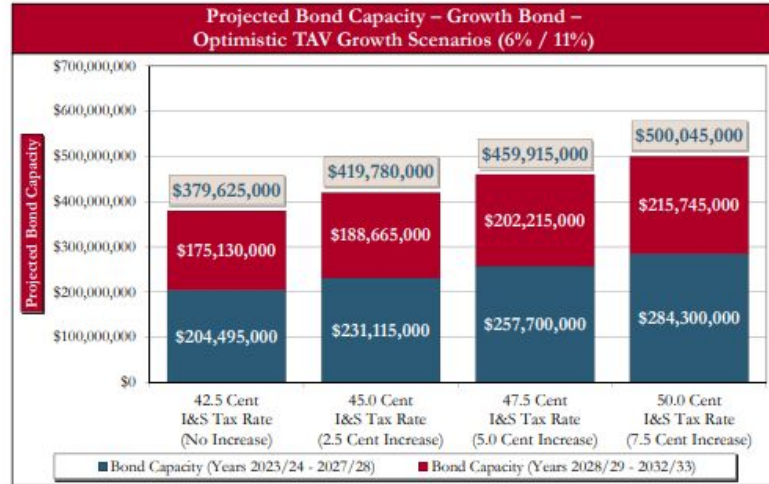

29



Preliminary Bond Capacity Analysis – Growth Bond: Aggressive TAV Growth Scenarios

BOK FINANCIAL SECURITIES

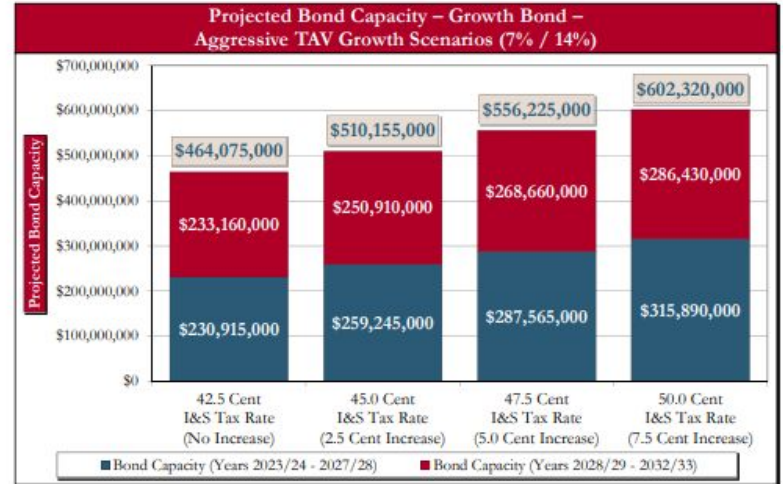

30

A landscape photograph showing a field in the foreground, likely a crop field, with a bright sun low on the horizon in the distance, creating a lens flare effect. The sky is a mix of grey and blue tones. The foreground field is partially obscured by a semi-transparent orange overlay.

LAND UPDATE



CONSTRUCTION

CURRENT STATE

Inflation Schedule

Year	% Inflation Per Year
2023	12%
2024	12%
2025	8%
2026	6%
2027	6%
2028	6%
2029	6%
2030	6%
2031	6%

Opinion of Construction Cost

Elementary School

- \$325 - \$450 per sqft

Middle School

- \$350 - \$500 per sqft

High School

- \$425 - \$600 per sqft

Soft Cost

25%



CONSTRUCTION

Costs vs. bid prices for new nonresidential construction

Year-over-year change in PPIs, Sep 2020-Apr 2022, not seasonally adjusted



AGC
THE CONSTRUCTION
ASSOCIATION

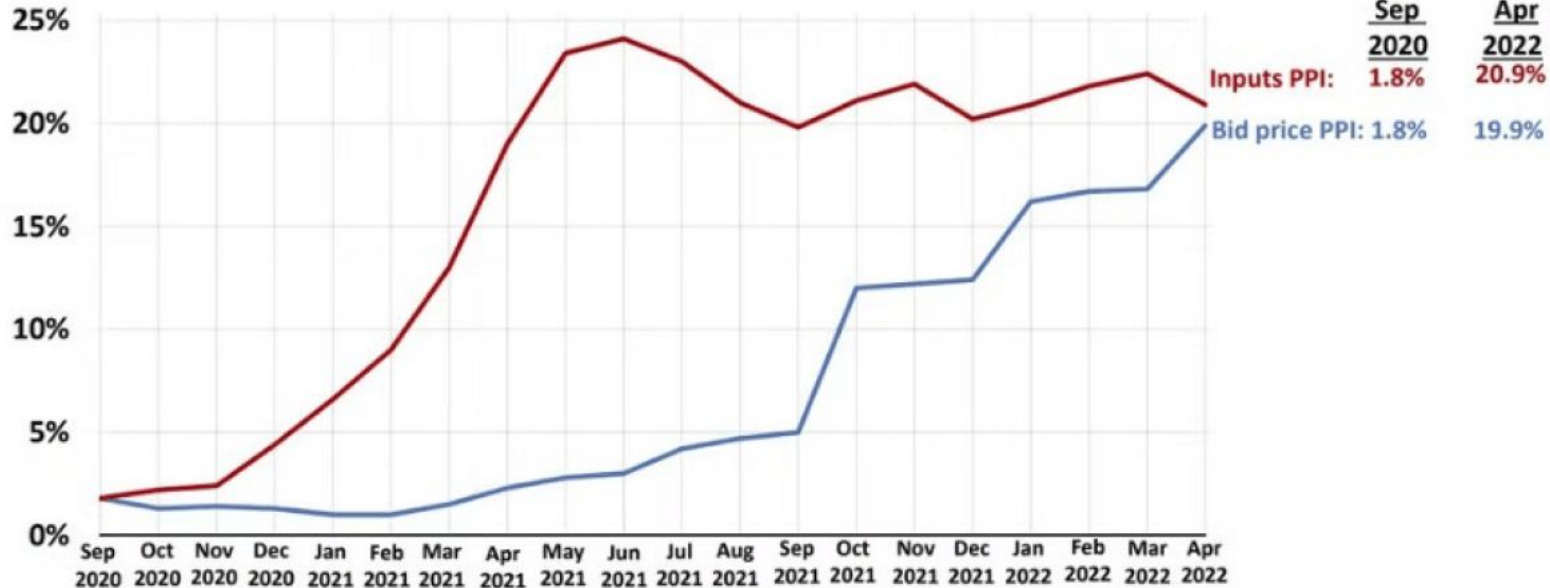



**ELEMENTARY NEW CONSTRUCTION
PROJECT PLANNING**

Elementary school If opened in 2024

Project Dates	2022			2023			2024																										
	A	M	J	J	A	S	O	N	D	J	F	M	A	M	J	J	A	S	O	N	D	J	F	M	A	M	J	J	A	S	O	N	D
Schematic Design																																	
Design Development																																	
Construction Documents																																	
Jurisdictional Review																																	
Bidding																																	
Construction																																	

July 2024

Construction Duration	Estimated Square Footage	Total Construction OPC (Escalated)	Soft Costs, Fees, & Contingency	Furniture, Fixtures, & Equipment (FFE)	Total Project Budget OPC
18 Months	110,000 SF	\$52.8M ±	\$11.6M ±	\$1.6M ±	\$66M ±

*Bids in 2023

*Cost shown does not include cost of land.



Elementary #8

If opened in 2026

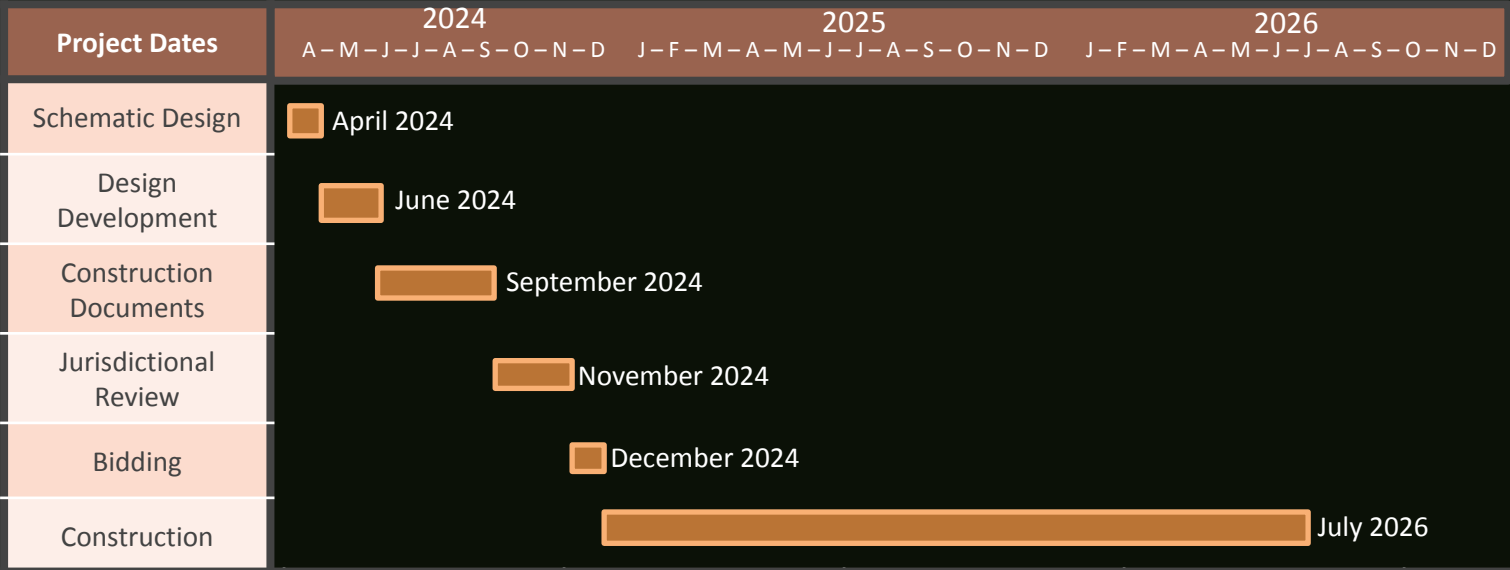

Construction Duration	Estimated Square Footage	Total Construction OPC (Escalated)	Soft Costs, Fees, & Contingency	Furniture, Fixtures, & Equipment (FFE)	Total Project Budget OPC
18 Months	110,000 SF	\$59.1M ±	\$13M ±	\$1.8M ±	\$73.9M ±

*Bids in 2024 // Opens in 2026

*Cost shown does not include cost of land.



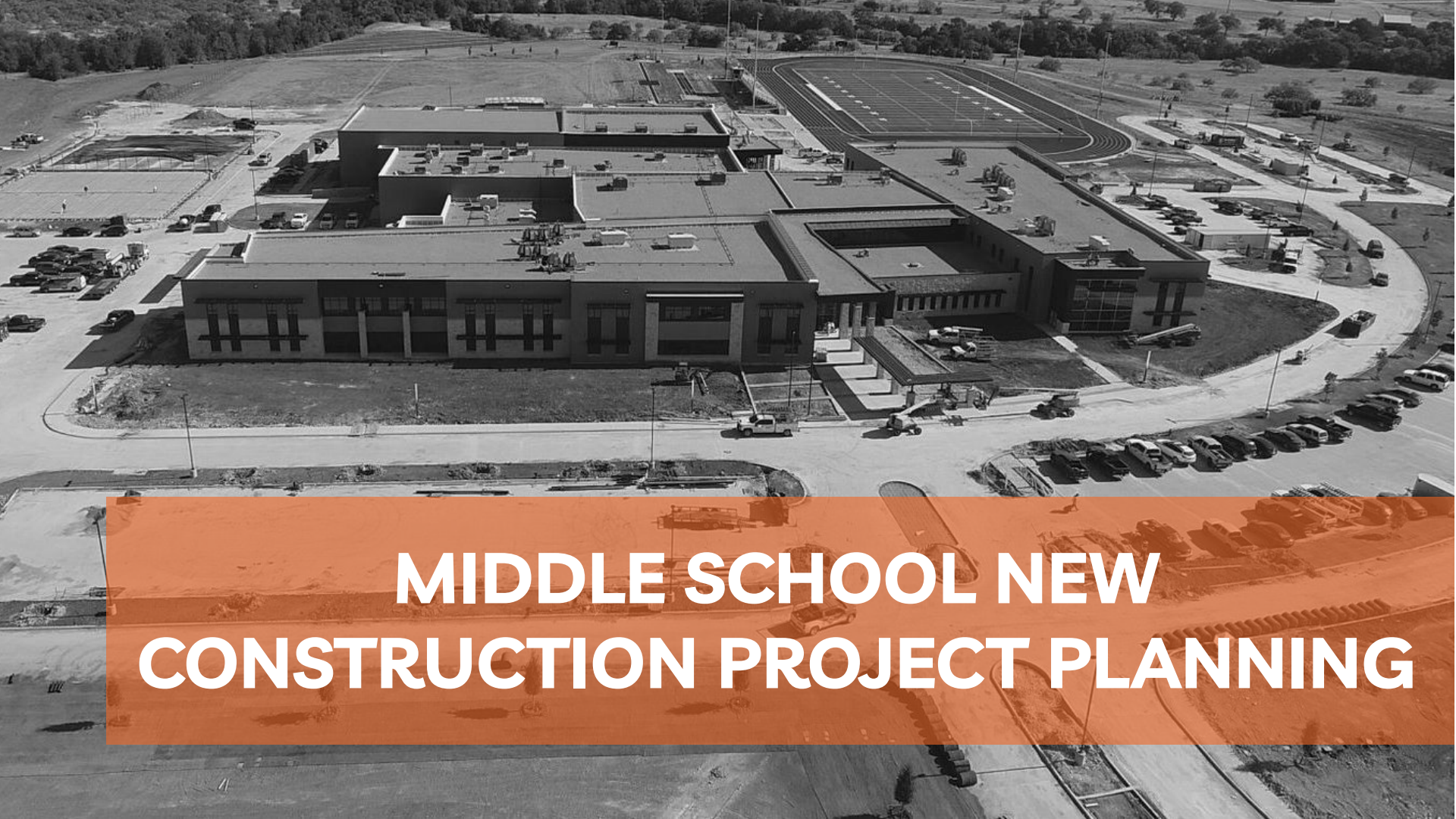

MIDDLE SCHOOL NEW CONSTRUCTION PROJECT PLANNING

Middle School #3

If opened in 2027

Project Dates	2024			2025			2026	2027												
	F	M	A	M	J	J	A	S	O	N	D	J	F	M	A	M	J	J	A	S
Schematic Design	[Bar] July 2024																			
Design Development	[Bar] October 2024																			
Construction Documents	[Bar] January 2025																			
Jurisdictional Review	[Bar] April 2025																			
Bidding	[Bar] May 2025																			
Construction	[Bar] May 2027																			
Construction Duration	Estimated Square Footage	Total Construction OPC (Escalated)	Soft Costs, Fees, & Contingency	Furniture, Fixtures, & Equipment (FFE)	Total Project Budget OPC															
24 Months	181,000 SF ±	\$111.4M ±	\$19.2M ±	\$9.1M ±	\$139.8M ±															

*Bids in 2025

*Cost shown does not include cost of land.





HIGH SCHOOL PROJECT PLANNING



Exploring Options (A thru Z)

- Capacity
- Finances
- Academics
- Co-Cirricular



TECHNOLOGY

TECHNOLOGY

2023 - 2027 - \$12,250,000

- Network - \$5,000,000
- Security - \$4,250,000
- Promethean - \$3,000,000

2028 - 2032 - \$15,350,000

- Network - \$7,250,000
- Security - \$4,500,000
- Promethean - \$3,600,000





ALEDO I.S.D.

SCHOOL BUS

STOP

ALEDO

SCHOOL BUS

TRANSPORTATION

TRANSPORTATION

School Bus Projected Needs											
Description	2022-2023	2023-2024	2024-2025	2025-2026	2026-2027	2027-2028	2028-2029	2029-2030	2030-2031	2031-2032	Totals
For Student Growth	9	10	10	10	11	11	12	12	13	0	98
Current Fleet Replacement	38	2	0	0	0	12	6	2	0	4	64
Totals	47	12	10	10	11	23	18	14	13	4	162
Estimated Cost per Bus	\$135,000	\$135,000	\$135,000	\$135,000	\$135,000	\$150,000	\$150,000	\$150,000	\$150,000	\$150,000	
Total Estimated Costs	\$6,345,000	\$1,620,000	\$1,350,000	\$1,350,000	\$1,485,000	\$3,450,000	\$2,700,000	\$2,100,000	\$1,950,000	\$600,000	\$22,950,000
Total Cumulative Costs	\$6,345,000	\$7,965,000	\$9,315,000	\$10,665,000	\$12,150,000	\$15,600,000	\$18,300,000	\$20,400,000	\$22,350,000	\$22,950,000	



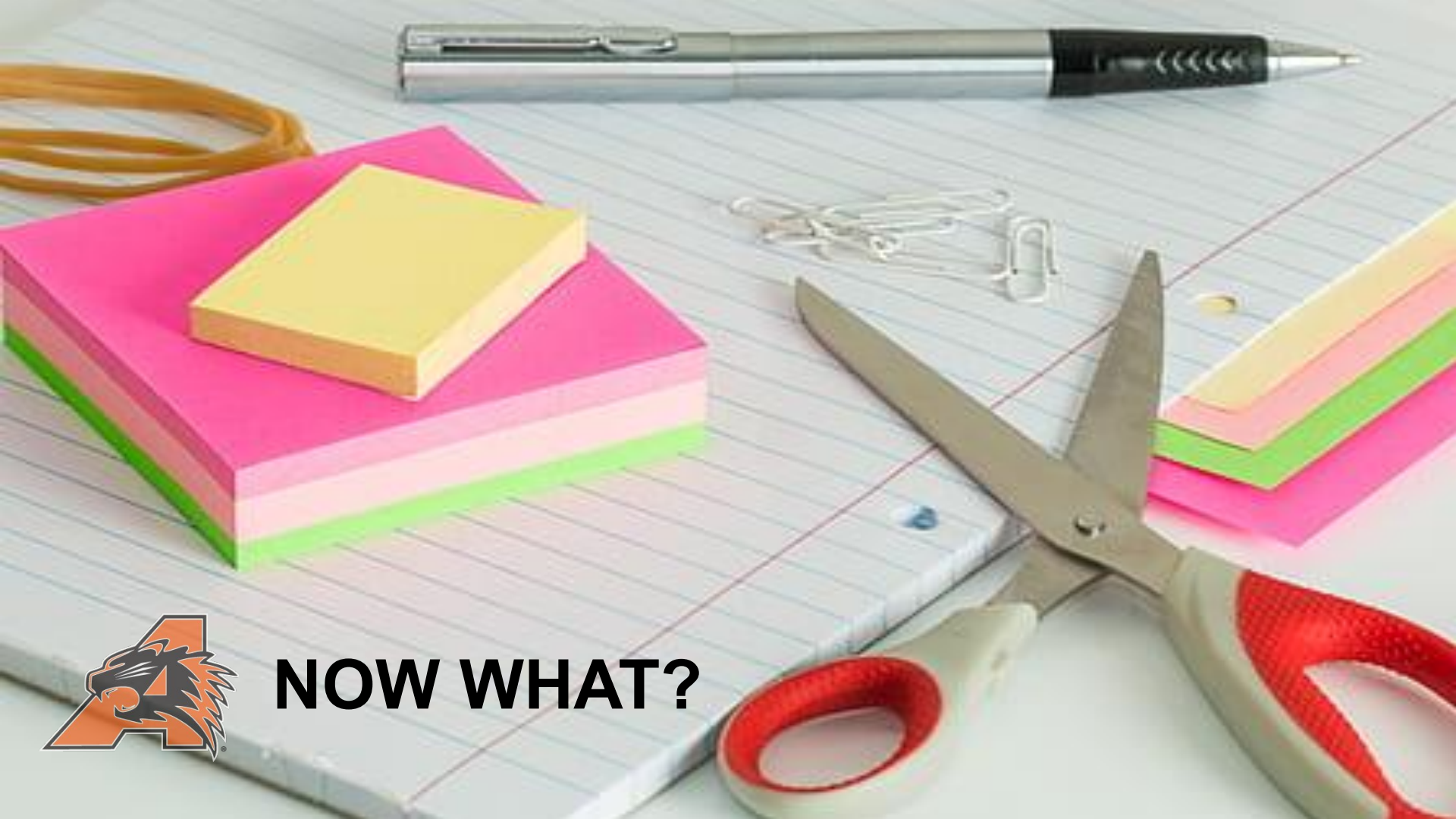

NOW WHAT?

NEXT MEETING:

November 28th

**Board Meeting on
November 14th**

