

M

E.R.S.

E

September 4, 2012

M

GLRVTS  
Mark Byrne  
250 Pawtucket Blvd.  
Tyngsboro, MA 01879

O

Mark:

Please add the enclosed Three-Year report to the O & M Plan.

I will see you in February to do the next six-month update.

Call me if you have any questions.

Sincerely,  
Environmental Remediation Services



Dan Slowe  
Environmental Consultant

Enclosure

Environmental Remediation Services, Inc.  
20 Vernon Street • Norwood, MA 02062  
(781) 762-1772

August 29, 2012

Greater Lowell Regional Technical High School  
PTO Chairperson  
c/o Mr. Mark Byrne  
Pawtucket Boulevard  
Tyngsboro, MA 01879

Environmental Remediation Services, Inc.  
20 Vernon Street  
Norwood, MA 02062  
(781) 762-1772  
FAX (781) 762-1779

RE: Three Year Asbestos Building Survey According to the Asbestos Hazard Emergency Response Act (AHERA).

Dear PTO Chairperson:

Environmental Remediation Services, Inc. was retained to conduct the three year asbestos building assessment of the Greater Lowell Regional Technical High School. The three year asbestos survey was conducted in accordance with the EPA Asbestos Hazard Emergency Response Act (AHERA) - 40 CFR 763 AHERA 1987.

The AHERA Regulation requires that all Schools be inspected for asbestos, that management plans and response actions are developed, and that periodic surveillance inspections be conducted every six months to ensure the safety of the building occupants. The most recent assessment was conducted on August 29, 2012 and all asbestos, and suspect asbestos, materials were observed to be in good condition.

The AHERA regulation requires that three year assessments are conducted and Management Planner recommendations are developed every three years. All building materials in the School should be considered asbestos containing and sampled for asbestos content if they become damaged or if they are scheduled for disturbance by upcoming renovation procedures.

The original Management Plans were developed in 1989 by an AHERA accredited and Massachusetts DLI licensed Asbestos Inspector and Management Planner. The subsequent six month and three year assessments have been added to the original Management Plan. As you will notice all asbestos containing materials throughout the school, and all suspect asbestos containing materials, are currently in good condition and do not pose a health risk to building occupants. ERS, Inc. recommends that the periodic surveillance of all building materials continue to ensure that asbestos containing materials do not become damaged.

The Management Plans are available for public inspection in the Office of the Principal. If you have any questions regarding the update of the Management Plan please do not hesitate to give me a call at (781) 762-1772.

Sincerely,  
Environmental Remediation Services, Inc.

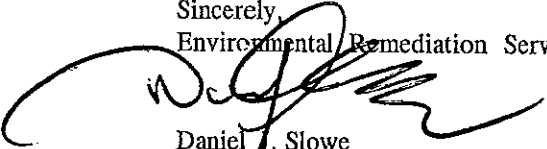

Daniel J. Slowe  
MA Asbestos Inspector AI 60336



Patricia Riley  
MA Asbestos Management Planner AP 60296

Mr. Mark Byrne  
L.E.A.

Enclosure.

Environmental Testing & Consulting

Sample Reinspection Form 2 Reinspection of ACBM Findings and Management Planner Recommendations

School Greater Lowell Reg./VOC - Building Date(s) of Reinspection 8/29/12

Homogeneous Sampling Area: Material Description transite wall panels/VAT & mastic ID Number throughout

REINSPECTION FINDINGS FOR ACBM					MANAGEMENT PLANNER RECOMMENDATIONS		
Location(s) of ACBM by assessment category	Quantity	Friability	Assessment category (1-7, X)	Justification of assessment category	Change in assessment	Preventive measures, response actions, and initial/additional cleanings	Schedule
					Yes		Begin
					No		Complete
transite	approx. 131,500 SF	F		non-friable/intact	Yes	continue O & M Plan	
floor tiles & mastic	approx. 2,500 sq/ft.	F		non-friable/intact	Yes	continue O & M Plan	
All other building materials sampled and proven otherwise. is scheduled for disturbance.		F		should be considered asbestos containing until that becomes damaged, or abated, if necessary.	Yes		

Were additional samples of this ACBM collected? Yes No all intact

Date of management planner review: \_\_\_\_\_

Inspector name Daniel J. Slove  
 Inspector signature [Signature]  
 Accreditation #/State AI 60336  
 Expiration date \_\_\_\_\_

Management planner name Patty Riley  
 Management planner signature [Signature]  
 Accreditation #/State AP 60296  
 Expiration date \_\_\_\_\_

I, the LEA's Designated Person, have read and understood the recommendations made above \_\_\_\_\_ Date \_\_\_\_\_

**APPENDIX A:**

**INVENTORY OF ASBESTOS-CONTAINING BUILDING MATERIALS IN THE  
GREATER LOWELL REGIONAL VOCATIONAL TECHNICAL HIGH SCHOOL**

**First Floor**

Main entrance outside information booth  
Transite Wall Board, 700 sq. ft., good

Room 1143  
Transite Wall Board, 1000 sq. ft., good

Room 1144  
Transite Wall Board, 300 sq. ft., good

Room 1145  
Transite Wall Board, 1000 sq. ft., good

Room 1145 office  
Transite Wall Board, 300 sq. ft., good

Womens lockers - 1146  
Transite Wall Board, 350 sq. ft., good

Mens lockers - 1148  
Transite Wall Board, 350 sq. ft., good

Room 1151  
Transite Wall Board, 750 sq. ft., good

Cooking room - 1157  
Transite Wall Board, 750 sq. ft., good

Room 1160 and observation room  
Transite Wall Board, 800 sq. ft., good

Child care - 1164  
Transite Wall Board, 200 sq. ft., good  
Vinyl Asbestos Floor Tile, 750 sq. ft., good

Dining hall  
Transite Wall Board, 450 sq. ft., good

Office next to freezers in Room 1248

Project No. 5585

HYGEIA INC.

Transite Wall Board, 200 sq. ft., good

Media center - 1256

Transite Wall Board, 750 sq. ft., good

Cosmetology - 1265

Transite Wall Board, 750 sq. ft., good

*Removed 7/1/97  
ECS-Specs. DECTAM*

Autobody - 1300

Transite Wall Board, 1100 sq. ft., good

Lockers in autobody (1300)

Transite Wall Board, 750 sq. ft., good

Room 1304

Transite Wall Board, 700 sq. ft., good

Plastics lab - 1320

Transite Wall Board, 900 sq. ft., good

Room 1321

Transite Wall Board, 800 sq. ft., good

Room 1327

Transite Wall Board, 800 sq. ft., good

Room 1341

Transite Wall Board, 800 sq. ft., good

Room 1342 A and B

Transite Wall Board, 400 sq. ft., good

Auto mechanics classroom - 1406

Transite Wall Board, 1800 sq. ft., good

*Removed 6/17/98 by Carlinas Free. On  
ECS Specs*

Manufacturing media center - 1407

Transite Wall Board, 1000 sq. ft., good

Machine shop - 1420

Transite Wall Board, 1400 sq. ft., good

Welding related - 1420

Transite Wall Board, 800 sq. ft., good

Sheet metal and welding

Transite Wall Board, 1800 sq. ft., good

Project No. 5585

HYGEIA INC.

Lockers 1421

Transite Wall Board, 300 sq. ft., good

Room 1422

Transite Wall Board, 800 sq. ft., good

Pipefitting shop - 1440

Transite Wall Board, 1000 sq. ft., good

Construction media - 1444

Transite Wall Board, 1000 sq. ft., good

Upholstery - 1450

Transite Wall Board, 1200 sq. ft., good

Pipefitting - 1453

Transite Wall Board, 750 sq. ft., good

Room 1463

Transite Wall Board, 400 sq. ft., good

Painting and paint storage

Transite Wall Board, 1400 sq. ft., good

Room 1464

Transite Wall Board, 800 sq. ft., good

Room 1465

Transite Wall Board, 800 sq. ft., good

Advanced auto mechanics - 1500

Transite Wall Board, 1800 sq. ft., good

Media center - 1503

Transite Wall Board, 1000 sq. ft., good

Room 1504

Transite Wall Board, 1000 sq. ft., good

Renovated 2006 - NATIONAL  
ASSET

Tools and storage - 1522

Transite Wall Board, 800 sq. ft., good

Carpentry - 1540

Transite Wall Board, 1400 sq. ft., good

Room 1560

Transite Wall Board, 1000 sq. ft., good

Project No. 5585

HYGEIA INC.

Room 1562

Transite Wall Board, 600 sq. ft., good

Room 1564

Transite Wall Board, 800 sq. ft., good *Removed 2 panels*

Room 1565

Transite Wall Board, 1800 sq. ft., good

Power mechanics - 1600 and Room 1601

Transite Wall Board, 2000 sq. ft., good

~~Girls locker room~~

~~Transite Wall Board, 800 sq. ft., good~~

*Removed 7/94 by Mancoski  
Ziggy's Inc - Spent*

~~Mens locker room~~

~~Transite Wall Board, 2000 sq. ft., good~~

*Removed 7/94 by Mancoski Inc  
Breggo Inc. - Spent*

~~Trainers room~~

~~Transite Wall Board, 800 sq. ft., damaged~~

*repaired / removed 4/06/94  
Removed completely 7/94  
by Mancoski, Inc*

Second Floor

Health media center - 2140

Transite Wall Board, 600 sq. ft., good

Health occupations lab - 2141

Transite Wall Board, 800 sq. ft., good

Room 2142

Transite Wall Board, 800 sq. ft., good

Offices 2144, 2145, 2146, 2147, 2148

Transite Wall Board, 1250 sq. ft., good

Lab tech - 2149

Transite Wall Board, 800 sq. ft., good

Room 2254

Transite Wall Board, 400 sq. ft., good

Vinyl Asbestos Floor Tile, 800 sq. ft., good

Dental assistant - 2154

Transite Wall Board, 1000 sq. ft., good

Project No. 5585

HYGEIA INC.

Steel room - 2157

Transite Wall Board, 1000 sq. ft., good

Business machine center - 2160

Transite Wall Board, 800 sq. ft., good

General office lab - 2162 and Room 2163

Transite Wall Board, 1100 sq. ft., good

Bilingual - 2240 and Files - 2243

Transite Wall Board, 500 sq. ft., good

Curriculum services - 2241

Transite Wall Board, 250 sq. ft., good

Rooms 2240, 2242, 2243

Transite Wall Board, 2200 sq. ft., good

Rooms 2244, 2246, 2247, 2248

Transite Wall Board, 3000 sq. ft., good

Health - 2256

Transite Wall Board, 800 sq. ft., good

Vinyl Asbestos Floor Tile, 1000 sq. ft., good

Communications room - 2260A

Transite Wall Board, 500 sq. ft., good

Administrative offices - 2260 and all offices inside

Transite Wall Board, 2000 sq. ft., good

Administrative office - 2262

Transite Wall Board, 200 sq. ft., good

Business office media center - 2271

Transite Wall Board, 800 sq. ft., good

Applied physics - 2320

Transite Wall Board, 500 sq. ft., good

Rooms 2321, 2322

Transite Wall Board, 900 sq. ft., good

Science and math media center - 2325

Transite Wall Board, 900 sq. ft., good

Quest - 2328



Project No. 5585

HYGEIA INC.

Transite Wall Board, 600 sq. ft., good  
Carrel area - 2330  
Transite Wall Board, 400 sq. ft., good  
Room 2333  
Transite Wall Board, 400 sq. ft., good  
Teachers resource rooms - 2340s  
Transite Wall Board, 15000 sq. ft., good  
Copy center - 2340 and mail room - 2340A  
Transite Wall Board, 1800 sq. ft., good  
Mrs. Mahon - 2363 and conference room - 2366  
Transite Wall Board, 1000 sq. ft., good  
Chemistry/physics - 2420  
Transite Wall Board, 1000 sq. ft., good  
Quest - 2424, 2425, 2426  
Transite Wall Board, 1500 sq. ft., good  
Math lab - 2426  
Transite Wall Board, 1000 sq. ft., good  
Quest - 2428  
Transite Wall Board, 800 sq. ft., good  
Prep room - 2430  
Transite Wall Board, 1000 sq. ft., good  
Print shops - 2440  
Transite Wall Board, 1800 sq. ft., good  
Sewing - 2460  
Transite Wall Board, 1500 sq. ft., good  
Art - 2480  
Transite Wall Board, 600 sq. ft., good  
Electricity - 2520  
Transite Wall Board, 1100 sq. ft., good  
Communications media center - 2521  
Transite Wall Board, 300 sq. ft., good

*removed 5/10 2006 Watson  
Asst.*

*Received 6/7/98 - Artists Fee, etc.  
ERS - Spec*

Project No. 5585

HYGEIA INC.

Beginning drafting - 2540  
Transite Wall Board, 1200 sq. ft., good

Storage - 2542  
Transite Wall Board, 1000 sq. ft., good

Drafting - 2563  
Transite Wall Board, 1000 sq. ft., good

Conference - 2564  
Transite Wall Board, 350 sq. ft., good

Graphics media center - 2565  
Transite Wall Board, 1500 sq. ft., good

Electronics - hallway outside 2621  
Transite Wall Board, 900 sq. ft., good

Electronics - 2621  
Transite Wall Board, 800 sq. ft., good

Etching and radio club - 2624  
Transite Wall Board, 350 sq. ft., good

Lecture room - 2524  
Transite Wall Board, 300 sq. ft., good

*removed 5/12/06  
By Martin Mc Hunt.*

Third Floor

West Commons - 3140  
Transite Wall Board, 1500 sq. ft., good

Rooms 3143, 3144, 3145  
Transite Wall Board, 1500 sq. ft., good

Conference, guidance - 3160, 3164  
Transite Wall Board, 800 sq. ft.

Rooms 3161, 3166, 3167, 3170, 3172, 3173, 3174, 3175, 3176  
Transite Wall Board, 4500 sq. ft., good

Work room - 3240  
Transite Wall Board, 1800 sq. ft., good

Carrels - 3240

Project No. 5585

HYGEIA INC.

Transite Wall Board, 1500 sq. ft., good

Carrels - 3245, 3246, 3247, 3248  
Transite Wall Board, 1800 sq. ft., good

Typing area and offices - 3251  
Transite Wall Board, 1800 sq. ft., good

Testing - 3260 and Room 3263  
Transite Wall Board, 1100 sq. ft., good

Rooms 3440, 3441, 3442, 3443  
Transite Wall Board, 1500 sq. ft., good

Rooms 3444, 3445, 3446, 3447, 3448, 3449, 3450, 3451  
Transite Wall Board, 6400 sq. ft., good

Rooms 3461, 3462, 3463  
Transite Wall Board, 2000 sq. ft., good

Rooms 3466, 3467, 3468, 3469, 3470, 3471, 3472, 3473  
Transite Wall Board, 6400 sq. ft., good

South commons - 3480  
Transite Wall Board, 1000 sq. ft., good

Rooms 3540, 3541, 3542, 3543  
Transite Wall Board, 1800 sq. ft., good

Rooms 3544, 3546, 3547, 3548, 3549, 3550, 3551, 3552  
Transite Wall Board, 6400 sq. ft., good

Carrels - 3554  
Transite Wall Board, 800 sq. ft., good

Rooms 3561, 3564, 3565, 3566  
Transite Wall Board, 3800 sq. ft., good

East commons - 3640  
Transite Wall Board, 1500 sq. ft., good

Library  
Transite Wall Board, 3000 sq. ft., good

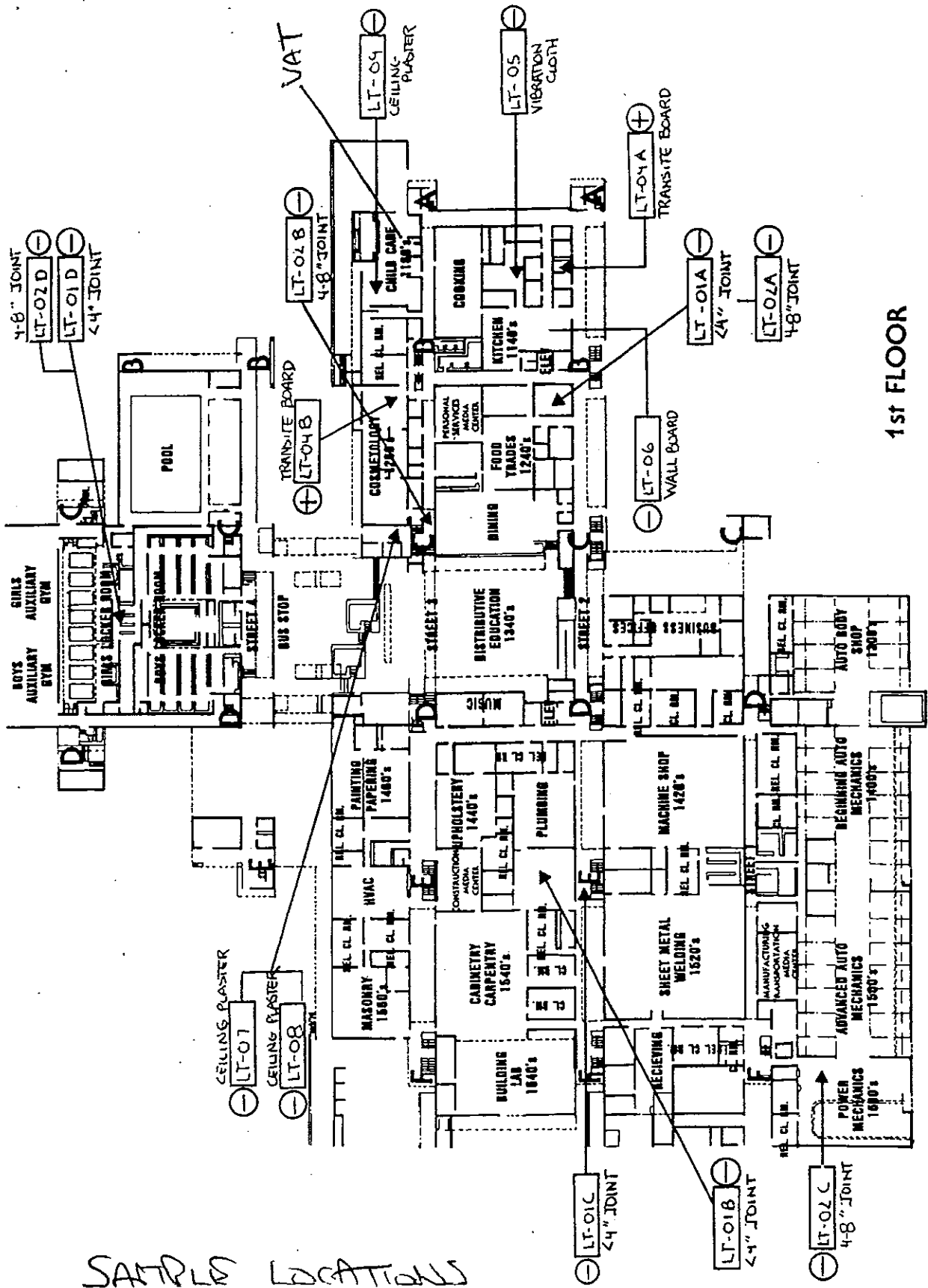

1st FLOOR

SAMPLE LOCATIONS

GREATER LOWELL REGIONAL VOCATIONAL-TECHNICAL HIGH SCHOOL

SAMPLE LOCATIONS

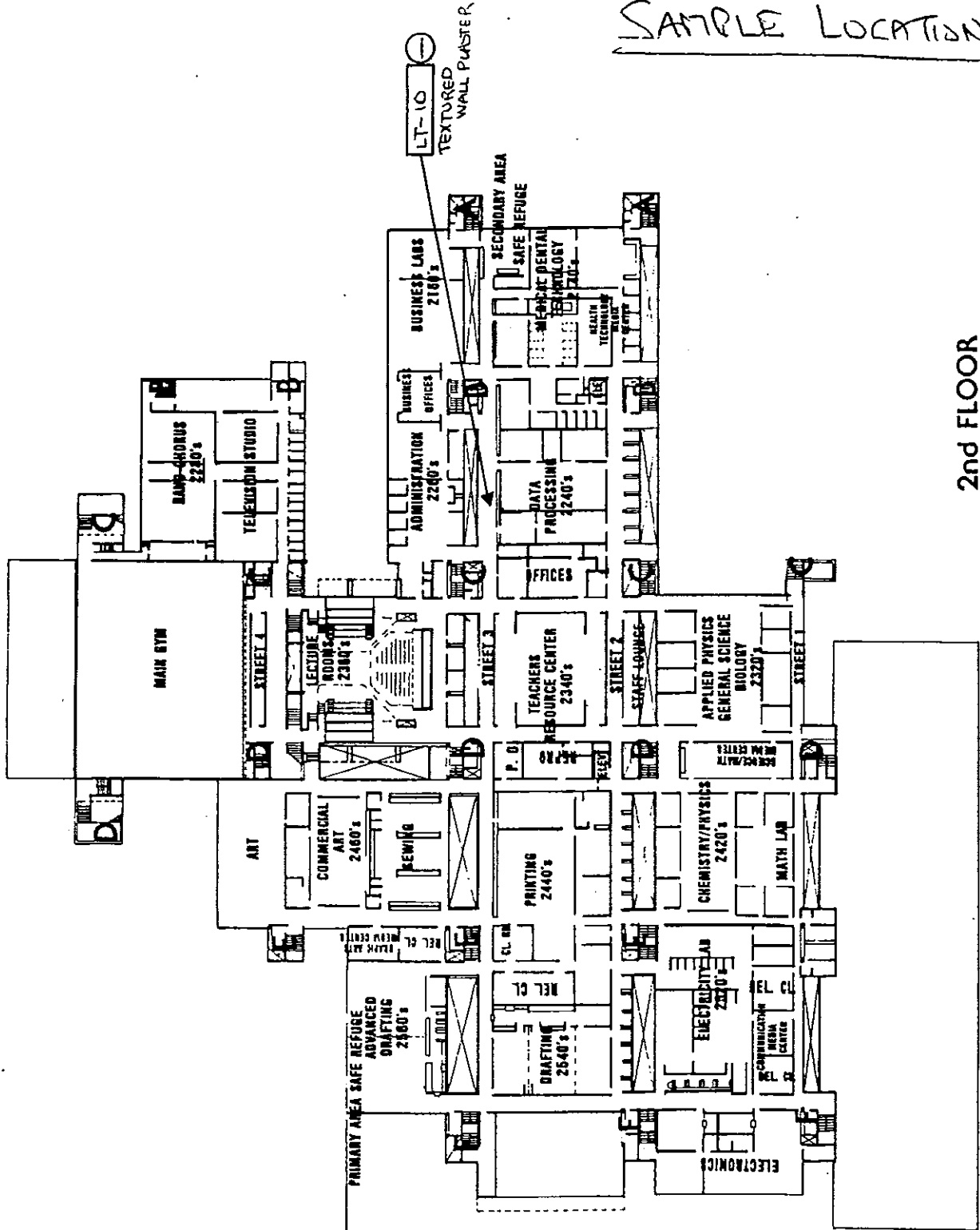

2nd FLOOR

GREATER LOWELL REGIONAL VOCATIONAL-  
TECHNICAL HIGH SCHOOL

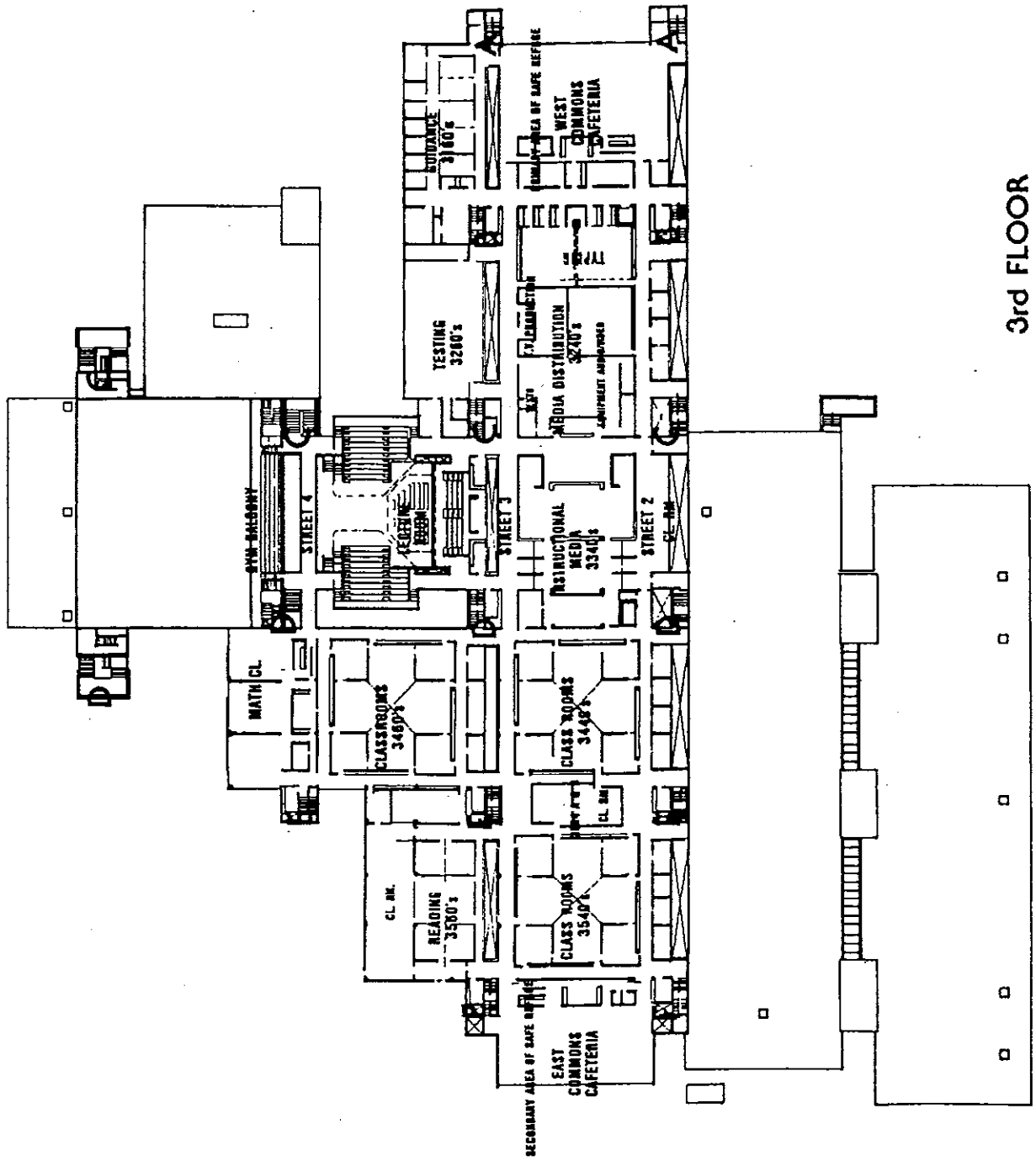

3rd FLOOR

SAMPLE LOCATIONS

GREATER LOWELL REGIONAL  
HIGH SCHOOL

LOCATIONAL TECHNICAL



THE COMMONWEALTH OF MASSACHUSETTS  
DEPARTMENT OF LABOR  
**DIVISION OF OCCUPATIONAL SAFETY**  
www.mass.gov/dos

**MITT ROMNEY**  
Governor  
**KERRY HEALEY**  
Lieutenant Governor

**JOHN S. ZIEMBA**  
Director, DOL  
**ROBERT J. PREZIOSO**  
Commissioner

August 10, 2006

07A-4020

Mr. Mark Byrne, Director of Plant Services  
Greater Lowell Technical High School  
250 Pawtucket Blvd.  
Tyngsboro, MA 01879

Dear Mr. Byrne:

On August 3, 2006, a duly designated representative of the Massachusetts Division of Occupational Safety (DOS) and the U.S. EPA reviewed the records of the Greater Lowell Technical High School to ensure compliance and implementation of 40 Code of Federal Regulations (CFR) Part 763 Subpart E - Asbestos Containing Materials in Schools (ASHERA).

At the time of the inspection, the management plan was complete, with records to indicate that the plan had been updated on a regular basis, including three year reinspections and response action records.

To ensure that the Greater Lowell Technical High School remains in compliance with the ASHERA regulation, continue the present course of action, updating the management plan with dated copies of annual notifications and six month surveillance. The school's written policy regarding the disturbance of asbestos panels by shop teachers and/or students should continue to be posted and enforced. DOS is available to provide an informational seminar to the school and school personnel on this matter, should the need arise.

If you have any questions regarding this inspection or any asbestos related issues, please feel free to contact me at 413-781-2676.

Sincerely,

Janet McKenna  
Environmental Engineer