

# BACK TO SCHOOL NEWSLETTER

## 24-25 School Year



### What's Inside?

District Updates	2
New Student Registration	3
Returning Student Registration	3
Bus Rider Registration	3
Immunization Requirements	3
Back To School Rally	3
Free or Reduced Meals	4
Meal Prices	4
School Hours	4
Connect With Us	4
School Supplies List	4
Homecoming Parade & Pep Rally	4
Special Dress Days	5
Back to School Dates	6
Dress Guidelines	7
Academic Calendar	8

# West Early Learners Academy



## Welcome Back Bears!

We can't wait to see our students on Aug. 14! Families of returning students, please help us plan ahead and ensure that your child has a spot by completing the online Returning Student Verification process immediately. This will ensure that you receive your child's schedule at Back to School/Meet the Teacher Night.

We're excited that several projects included in the 2022 bond program will be completed by the first day of school. The new West Early Learners Academy will open to all pre-kindergarten and kindergarten students. Brewer High School's expanded competition gym and band hall and the new drill team floor will also be completed.

The new classrooms at Liberty Elementary will be completed by the start of school, and the new gym and cafeteria expansion will be ready for students next school year. Brewer Middle School construction is also well underway! The Sixth Grade Center, new competition gym, and cafeteria and fine arts expansions will be completed for the 2025-26 school year.

We appreciate the patience and support of our families and community as we make improvements that will enable us to provide amazing facilities for our future leaders!



**Frank Molinar**  
WSISD Superintendent



West Early Learners Academy



West Early Learners Academy



6th Grade Center

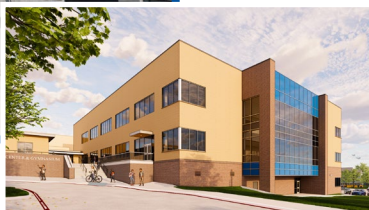

Brewer High



**SAVE YOUR SPOT ENROLL TODAY!**

**NEW STUDENT  
REGISTRATION**  
Now Open!

Now Enrolling Resident  
and Non-Resident  
Students for the  
2024-25 School Year!

Visit [wsisd.com](http://wsisd.com) for more info.



**RETURNING STUDENT  
ENROLLMENT  
VERIFICATION**  
2024-25 School Year

Visit [wsisd.com](http://wsisd.com) for more info!

REGISTRATION DEADLINE

**BUS RIDERS**

SUNDAY, AUG. 11



## Bus Rider Registration Deadline

WSISD provides bus transportation to students who live two or more miles from their home campus. Families with students who will ride the bus **MUST** complete the Bus Rider Registration Form no later than Aug. 11. Students who submit a Bus Rider Registration Form after Aug. 11 will not be eligible to ride the bus until Sept. 4. This will enable our drivers to prepare for the upcoming school year.

After completing the Bus Rider Registration Form, the Transportation Department will make contact by phone or email to confirm bus stop and pick up times within 3 to 5 days. Students will be required to ride the bus they're assigned.

White Settlement ISD  
**Back To  
School Rally**

Thursday, Aug. 22  
6:30-8 p.m.

BHS Stadium



## Immunization Requirements

All seventh graders must have an updated shot record for schedule pickup. [Click here](#) for immunization requirements for all students.

# Qualify for Free or Reduced Meals

[Complete Free and Reduced Meal Application Starting Aug. 1](#)

To be eligible for free or reduced breakfast and lunch, families MUST complete an application starting Aug. 1. Applications from last year will be valid through the end of September. The state approved funding to provide free breakfast for students who are also on the reduced meal plan.

Families must apply through their Schoolcafe account. Create an account or request a paper application from the school's front office or Child Nutrition Office, 817.367.1310.

Individuals who do not apply will start the 2024-25 school year as a paid student. Families who received a notification letter that the student is directly certified for free or reduced meals should not complete an application. Contact the Child Nutrition Office if any children in the household attending school are not listed in the letter.

All Liberty Elementary and West Early Learners Academy students will receive free breakfast through the Universal Free Breakfast program in 2024-25. Our schools can participate in the Universal Free Breakfast program if 80 percent or more of the students at that school qualify and complete the application for Free and/or Reduced Meals.

## 2024-25 Meal Prices



	Lunch	Breakfast
Elementary, Intermediate, & Middle School	\$2.85	\$1.50
High School	\$2.95	\$1.50

### SCHOOL SUPPLY LISTS

Available Online Now!

WSISD @whitesettlementisd

## Connect WITH US!



## Homecoming Parade, Pep Rally & Fireworks Show - Wednesday, Sept. 25

Save the Date! The Brewer Homecoming Parade will be at 6 p.m. Wednesday, Sept. 25 at Brewer High School with a Community Rally to follow.

## School Hours

- Brewer High**  
8:20 a.m.-4 p.m.
- Brewer Middle & Fine Arts Academy**  
8 a.m.-3:40 p.m.
- Tannahill Intermediate**  
7:15 a.m.-3 p.m.
- Blue Haze & Liberty Elementaries & North STEAM Academy**  
7:30 a.m.-3:10 p.m.
- West Early Learners Academy**  
7:45 a.m.-3:25 p.m.
- DAEP**  
8:15 a.m. - 3:15 p.m.

Counselors will provide students with a guidance lesson that coincides with our character trait(s).  
Look for resources families can help to reinforce what students learn!



<b>August</b> Respect, Courtesy, School Pride & GRIT - Gumption, Resiliency, Integrity & Tenacity	<b>September</b> Courage & School Pride	<b>October</b> Responsibility, Accountability, Diligence, Perseverance & Self-Control	<b>November</b> Generosity, Charity & Good Citizenship (Patriotism & Concern for Community)
<b>December</b>  Gratitude  12/9 Hope Day  12/18 College & Career Day	<b>January</b>  Trustworthiness, Honesty, Reliability, Punctuality, Loyalty & Integrity  1/13 Hope Day  1/22 College & Career Day	<b>February</b>  Caring, Kindness, Empathy, Compassion, Consideration & Patience  2/4 100th Day  2/13 Childhood Cancer Awareness Day - Wear Gold.  2/18-21 Hope & Random Acts of Kindness Week - Special Dress  2/24 Go Red for Heart Health Day  2/26 College & Career Day	<b>March</b>  Fairness, Justice & Freedom from Prejudice  Take A Stand  3/18 Hope Day  3/21 Down Syndrome Awareness Day- Wear Blue  3/26 College & Career Day
<b>April</b>  Courage  Act & Adjust - Positive Thinking  4/2 Autism Awareness Day - Blue Out  4/9 Child Abuse Awareness & Prevention Day - Blue Out  4/14 Hope Day  4/23 College & Career Day	<b>May</b>  GRIT: Finish Strong  5/12 Hope Day  5/12-16 Mental Health Awareness Week  Link Special Dress days & activities  5/21 College & Career Day	<div data-bbox="803 1333 1583 1900" style="border: 2px solid blue; border-radius: 15px; padding: 10px; text-align: center;">  <p><b>WSISD</b> <i>Character Spotlight</i> <b>Calendar</b></p> </div>	

**SCHOOL SPIRIT FRIDAYS:** Wear your Brewer/School Shirt & show your Bear Pride!

If Friday is a holiday, School Spirit Day is Thursday.

**HOPE DAY:** Wear yellow, teal & purple, or a Hope Shirt for Suicide Prevention & Awareness.

**COLLEGE & CAREER DAY:** Wear a college, military or trade school shirt or dress as your future career.

# WSISD BACK TO SCHOOL DATES

## West Early Learners Academy

**ECSE, PreK and Life Skills**

**Meet the Teacher Night**

**Tuesday, Aug. 6**

Last names A-M: 5-6 p.m.

Last names N-Z: 6-7 p.m.

**Kindergarten**

**Meet the Teacher Night**

**Thursday, Aug. 8**

Last names A-M: 5-6 p.m.

Last names N-Z: 6-7 p.m.

## Blue Haze Elementary

**Meet the Teacher Night**

**Monday, Aug. 12**

Last Names A-M: 5-6 p.m.

Last Names N-Z: 6-7 p.m.

## Liberty Elementary

**Meet the Teacher Night**

**Monday, Aug. 12**

5-6:30 p.m.

## District-Wide Dates

**Back to School Rally**

**Thursday, Aug. 22**

6:30-8 p.m.

Brewer High Stadium

**Grace Baptist**

**Back to School Bash**

(For registered families)

**Saturday, July 27**

10 a.m.-12 p.m.

**1st Day of School**

**Wednesday, Aug. 14**

**Holiday**

**Monday, Sept. 2**

For more detailed information, visit your school's website and Facebook Page.

## Fine Arts Academy

**Meet the Teacher Night**

**Monday, Aug. 12**

5:30-6:30 p.m.

**Meet the Teacher**

Life Skills Students

**Tuesday, Aug. 6**

5-6 p.m.

## North Elementary STEAM Academy

**Popcorn with Principals**

**Thursday, Aug. 8**

4:30-6:30 p.m.

**Meet the Teacher Night**

**Monday, Aug. 12**

Life Skills: 4:30-5 p.m.

Last Names A-L: 5:15-6 p.m.

Last Names M-Z: 6-6:45 p.m.

## Tannahill Intermediate

**Meet the Teacher Night**

**Wednesday, Aug. 7**

5:30-6:30 p.m.

## Athletics

**Football Parent Meeting**

**Thursday, July 25**

6 p.m.

BHS Auditorium

**Brewer Middle Football Football Pad Pickup**

**Friday, Aug. 9**

1-5 p.m. or

**Saturday, Aug. 10**

9 a.m.-2 p.m.

BMS Field House

Students must have physical.

Deadline to submit physical for all sports Aug. 23 by end of school day.

## Brewer Middle

**Schedule Pick Up**

**Monday, Aug. 12**

8 a.m.-6 p.m.

OR

**Tuesday, Aug. 13**

8 a.m.-4 p.m.

**Meet the Teacher Night**

**Wednesday, Aug. 28**

5-6:30 p.m.

## Brewer High School

**Monday, Aug. 12**

**Fish Camp for Freshmen**

**& Laptop Pickup**

6-8 p.m.

**Senior Laptop Pickup**

9 a.m.-12 p.m.

**Tuesday, Aug. 13**

**Junior Laptop Pickup**

9 a.m.-12 p.m.

**Sophomore Laptop Pickup**

3-6 p.m.

**Monday, Sept. 16**

**Meet the Teacher Night**

6-7:30 p.m.

## Fine Arts

**BHS Band Parent Meeting**

**Tuesday, July 30**

7 p.m.

BHS Auditorium

**Tannahill/FAA Band Parent Meeting**

**Tuesday, Aug. 27**

6:30 p.m.

TIS Cafeteria

**BMS Band Parent Meeting**

**Thursday, Aug. 29**

6:30 p.m.

BMS Band Hall

## 2024-2025 WHITE SETTLEMENT ISD DRESS GUIDELINES

ITEM	ACCEPTABLE ATTIRE	SPECIAL COMMENTS & INTERPRETATIONS
<b>Tops</b>	<p>Tops may be:</p> <ul style="list-style-type: none"> <li>• Any collared, polo or oxford-style dress shirts or knit-collared shirts</li> <li>• Sweaters, sweatshirts and hoodies. (To ensure student safety, hoods may NOT be worn in the building.)</li> <li>• T-shirts and other pullover tops</li> <li>• School designs/logos; College/Military: Brand names and any/or other appropriate words are acceptable.</li> </ul>	<p>Students are prohibited from wearing tops that:</p> <ul style="list-style-type: none"> <li>• are oversized or immodestly undersized including crop tops, tops that are tight, low-cut or show cleavage or stomach when the arms are raised.</li> <li>• depict or reference alcohol, drugs, tobacco, weapons, nudity, gang affiliation, death, violence, vulgar/obscene language or images/insults to race, religion, gender or ethnicity, emblems/writing that could be deemed controversial/political and any emblems/writing that may cause a disruption or interference with normal school operations. * <p>Sleeveless shirts, tank tops and any tops/dresses that expose the back are not allowed.</p> </li></ul>
<b>Pants/ Bottoms</b>	<p>Pants must fit appropriately and at the waist.</p> <ul style="list-style-type: none"> <li>• Jeans</li> <li>• Shorts, skirts, skorts, capris, Dockers® or similar style pants, dress pants in denim or solid colors</li> <li>• Joggers, sweats and warm-up pants and athletic shorts</li> </ul> <p>All shorts, skirts, jumpers and skorts must be finger-tip length or longer.</p>	<ul style="list-style-type: none"> <li>• Torn, cut/slashed material higher than fingertip length that reveals any area of the skin or undergarments is not allowed unless leggings are worn underneath.</li> <li>• Form-fitting garments such as leggings and spandex must be worn with an appropriate shirt, dress, skirt, jumper, etc. that is fingertip length. Shirts must fully cover the bottom. Sheer/see-through leggings/spandex are not allowed.</li> <li>• Oversized, sagging or baggy clothing is not allowed.</li> <li>• Bike shorts/spandex shorts are not allowed.</li> </ul>
<b>Dresses</b>	<p>Dresses must have sleeves and be at least finger-tip length.</p> <p>Jumpers must be finger-tip length.</p> <p>Rompers must be finger-tip length and have sleeves.</p>	<ul style="list-style-type: none"> <li>• Slits/kick pleats in skirts or dresses must be modest.</li> <li>• Dresses/skirts/jumpers must meet the acceptable length requirements regardless of whether leggings are worn.</li> <li>• Pre-kindergarten through fourth grade girls must wear shorts under dresses, skirts and jumpers.</li> </ul>
<b>Shoes</b>	<p>Shoes should be worn that enhance the student's safety.</p> <p>Students participating in PE/athletics must wear athletic footwear to participate.</p>	<ul style="list-style-type: none"> <li>• Maximum shoe height is 2 inches for students in grades pre-kindergarten through 4.</li> <li>• Shoes over 2 inches are not recommended for all other grade levels for safety reasons.</li> <li>• Flip flops, aqua socks and non-athletic toe shoes, slippers, house shoes, skate shoes and Heelies® are not allowed.</li> </ul>
<b>Jewelry/ Accessories</b>	<p>Jewelry/accessories cannot be a safety hazard.</p>	<ul style="list-style-type: none"> <li>• Fishnet hosiery/clothing is not allowed.</li> <li>• Gages in ears must be plugged.</li> <li>• Hoods, hats, caps, visors, head coverings, do-rags, bandannas, sweatbands and sunglasses are not allowed in the building.</li> <li>• Any jewelry, accessories, tattoos that contain vulgar, obscene or offensive images are not allowed (<i>See paragraph in Tops above</i>). *</li> </ul>
<b>IDs</b>	<p>Brewer High and Brewer Middle School students must wear school IDs at all times.</p>	

Administrative discretion will be given for all dress guideline decisions. Anything deemed to be distracting in the classroom/school environment will not be allowed. The principal has the right to appraise any current fashion or fad and determine whether it fits within the dress guidelines. Questions? [dcoyle@wsisd.net](mailto:dcoyle@wsisd.net) or 817.367.5389

Spirit Days will be every Friday so wear your school T-shirt! If Friday is a holiday, Spirit Day will be Thursday.

\* Principals/the district may designate certain days per year as spirit days and will determine what can be worn on those days. •



# 24|25 ACADEMIC CALENDAR



### AUGUST 2024

Sun	M	T	W	T	F	Sat
				1	2	3
4	5	6	7	8	9	10
11	12	13	14	15	16	17
18	19	20	21	22	23	24
25	26	27	28	29	30	31
July 29, 30 & 31 First Year Teachers						
Aug. 1-13 Staff Development						
Aug. 14 First Day/1st 9 Weeks						

### SEPTEMBER 2024

Sun	M	T	W	T	F	Sat
1	2	3	4	5	6	7
8	9	10	11	12	13	14
15	16	17	18	19	20	21
22	23	24	25	26	27	28
29	30	Sept. 2 Holiday				

### OCTOBER 2024

Sun	M	T	W	T	F	Sat
		1	2	3	4	5
6	7	8	9	10	11	12
13	14	15	16	17	18	19
20	21	22	23	24	25	26
27	28	29	30	31	Oct. 9 1st 9 Weeks Ends	
Oct. 10 & 11 Staff Development/Student Holidays						
Oct. 14 Holiday						
Oct. 15 2nd 9 Weeks Begins						

### NOVEMBER 2024

M	T	W	T	F	Sat
				1	2
3	4	5	6	7	8
10	11	12	13	14	15
17	18	19	20	21	22
24	25	26	27	28	29
Nov. 1 Holiday					
Nov. 25-29 Thanksgiving Break					

### DECEMBER 2024

Sun	M	T	W	T	F	Sat
1	2	3	4	5	6	7
8	9	10	11	12	13	14
15	16	17	18	19	20	21
22	23	24	25	26	27	28
29	30	31	Dec. 3-13 EOC Testing Window			
Dec. 18 2nd 9 Weeks Ends						
Dec. 19-31 Winter Break						

### JANUARY 2025

Sun	M	T	W	T	F	Sat
			1	2	3	4
5	6	7	8	9	10	11
12	13	14	15	16	17	18
19	20	21	22	23	24	25
26	27	28	29	30	31	Jan. 1-3 Winter Break
Jan. 6 & 7 Staff Development/Student Holidays						
Jan. 8 3rd 9 Weeks Begins						
Jan. 20 Holiday						

### FEBRUARY 2025

Sun	M	T	W	T	F	Sat
						1
2	3	4	5	6	7	8
9	10	11	12	13	14	15
16	17	18	19	20	21	22
23	24	25	26	27	28	
Feb. 14 Holiday						
Feb. 17 Holiday						

### MARCH 2025

Sun	M	T	W	T	F	Sat
						1
2	3	4	5	6	7	8
9	10	11	12	13	14	15
16	17	18	19	20	21	22
23	24	25	26	27	28	29
30	31	March 7 3rd 9 Weeks Ends				
March 10-14 Spring Break						
March 17 Staff PD/Student Holiday						
March 18 4th 9 Weeks Begins						

### APRIL 2025

Sun	M	T	W	T	F	Sat
		1	2	3	4	5
6	7	8	9	10	11	12
13	14	15	16	17	18	19
20	21	22	23	24	25	26
27	28	29	30	April 8-30 STAAR Testing Window		
April 18 Holiday						
April 21 Weather Make Up						

### MAY 2025

Sun	M	T	W	T	F	Sat
				1	2	3
4	5	6	7	8	9	10
11	12	13	14	15	16	17
18	19	20	21	22	23	24
25	26	27	28	29	30	31
May 1 & 2 STAAR/EOC Testing						
May 16 Weather Makeup Day						
May 23 9 Weeks Ends/Last Day						
May 26 Holiday						
May 27 & 28 Staff Development						

### JUNE 2025

Sun	M	T	W	T	F	Sat
1	2	3	4	5	6	7
8	9	10	11	12	13	14
15	16	17	18	19	20	21
22	23	24	25	26	27	28
29	30	June 16-20 STAAR Retesting				
June 30 Offices Closed						

### JULY 2025

Sun	M	T	W	T	F	Sat
		1	2	3	4	5
6	7	8	9	10	11	12
13	14	15	16	17	18	19
20	21	22	23	24	25	26
27	28	29	30	31	July 1-4 Offices Closed	