

Measure BB Bond

21st Century Classroom Improvements

July 18, 2024

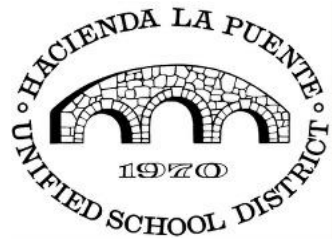

CUMMING
GROUP

//////////////////// BUILDING VALUE THROUGH EXPERTISE



HLPUSD MEASURE BB - SUMMARY

SCHOOLS IN PROGRESS

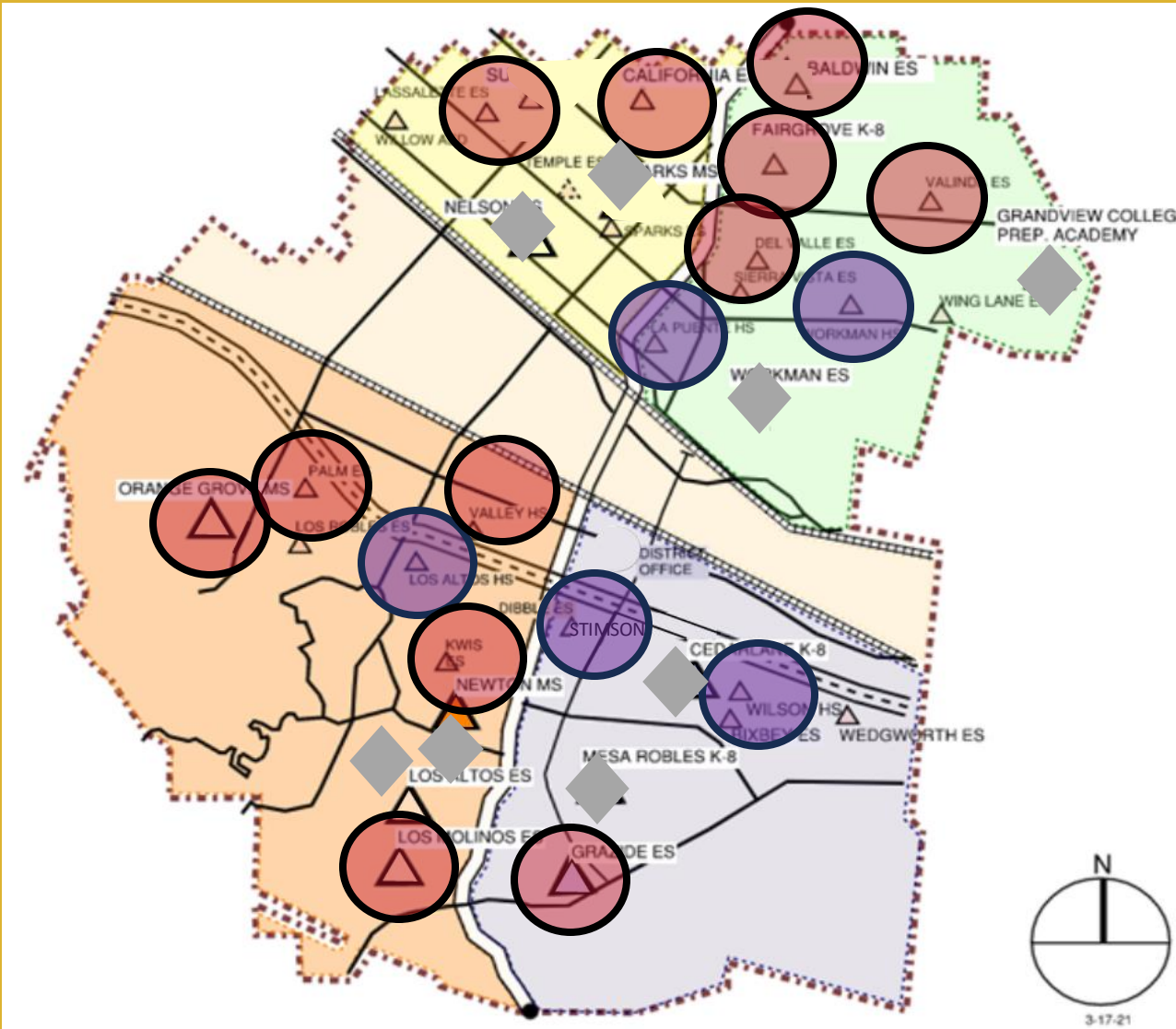

IN PROGRESS CONSTRUCTION

- La Puente HS
- Workman HS
- Los Altos HS
- Wilson HS
- Stimson EC

PREP FOR BID

- California ES
- Baldwin ES

AT DSA FOR REVIEW

- Los Molinos ES
- Graziade ES

IN DESIGN

- Kwis ES
- Lassalette ES
- Fairgrove K-8
- Orange Grove MS
- Sierra Vista MS
- Palm ES
- Valinda ES
- Sparks ES
- Wing Lane ES
- Valley Alternative

COMPLETED

- ◆ Nelson ES
- ◆ Los Altos ES
- ◆ Workman ES
- ◆ Mesa Robles K-8
- ◆ Cedarlane K-8
- ◆ Sparks MS
- ◆ Newton MS
- ◆ Grandview MS

PHASE B PROGRESS

- | | | |
|------------------|---|------------------------|
| 1. Baldwin ES | Construction Documents to DSA 1/23/2024 | DSA approved 6/27/2024 |
| 2. California ES | Construction Documents to DSA 1/23/2024 | DSA approved 6/27/2024 |

Anticipated Construction Start Fall of 2024

- | | | |
|-------------------|--|---------------------------------------|
| 3. Los Molinos ES | Construction Documents at DSA returned 5/7/2024 | Back-Check Submitted to DSA 6/7/2024 |
| 4. Grazide ES | Construction Documents at DSA returned 4/18/2024 | Back-Check Submitted to DSA 6/17/2024 |

Anticipated Construction Start Winter of 2024

- | | | |
|------------------|--|---------------------------|
| 5. Kwis ES | Construction Documents 50% Construction Documents | District Reviewed 6/26/24 |
| 6. Lassalette ES | Construction Documents 50% Construction Documents | District Review 6/26/2024 |

Anticipated Construction Start New Year of 2025

- | | | |
|---------------|--|---------------------------|
| 7. Palm ES | Construction Documents Schematic Design | District Review 6/24/2024 |
| 8. Valinda ES | Construction Documents Schematic Design | District Review 6/24/2024 |

Anticipated Construction Start Spring of 2025

- | | | |
|---------------------|--|----------------------------|
| 9. Fairgrove K-8 | Construction Documents 50% Construction Documents | District Reviewed 7/3/2024 |
| 10. Orange Grove MS | Construction Documents Schematic Design Documents | |

Anticipated Construction Start Summer of 2025

- | | | |
|------------------|--|-----------------------------|
| 11. Sierra Vista | Construction Documents Schematic Design | District Reviewed 6/14/2024 |
| 12. Sparks ES | Construction Documents Schematic Design | District Reviewed 6/21/2024 |

Anticipated Construction Start Summer -Fall of 2025

- | | | |
|------------------------|--|-------------------------------------|
| 13. Wing Lane ES | Construction Documents Schematic Design | District Review Scheduled 7/10/2024 |
| 14. Valley Alternative | Construction Documents Schematic Design | District Review Scheduled 8/12/2024 |

Anticipated Construction Start Fall of 2025

DSA PLAN APPROVAL BALDWIN & CALIFORNIA



Los Angeles Basin Regional Office
355 South Grand Ave. Suite 2100 | (213) 897-3995
Los Angeles, CA 90071
www.dsa.dgs.ca.gov

STATE OF CALIFORNIA
GOVERNOR GAVIN NEWSOM

6/27/2024 - APPROVAL OF PLAN(S)

Dr. Alfonso Jimenez
HACIENDA-LA PUENTE UNIFIED SCHOOL DISTRICT
15959 EAST GALE AVENUE
CITY OF INDUSTRY, CA 91745

Project: Baldwin Academy

Total Scope of Project: Alterations to 2-Classroom Buildings C & D (A-14833, A03-106033), 2-Relocatable Classroom Buildings E & F (A03-106033), and Associated Sitework

Increment #: 0

Application #: 03-123988

File #: 19-38



Los Angeles Basin Regional Office
355 South Grand Ave. Suite 2100 | (213) 897-3995
Los Angeles, CA 90071
www.dsa.dgs.ca.gov

STATE OF CALIFORNIA
GOVERNOR GAVIN NEWSOM

6/27/2024 - APPROVAL OF PLAN(S)

Dr. Alfonso Jimenez
HACIENDA-LA PUENTE UNIFIED SCHOOL DISTRICT
15959 EAST GALE AVENUE
CITY OF INDUSTRY, CA 91745

Project: California Elementary School

Total Scope of Project: Alterations to 4-Classroom Buildings A, B, E, & F (A-15158, A03-106032), 1-Relocatable Classroom Building P20 (A03-111921), and Associated Sitework

Increment #: 0

Application #: 03-123989

File #: 19-38



HIGH SCHOOL
REFRESH
PROJECTS

HIGH SCHOOL REFRESH GROUP 1

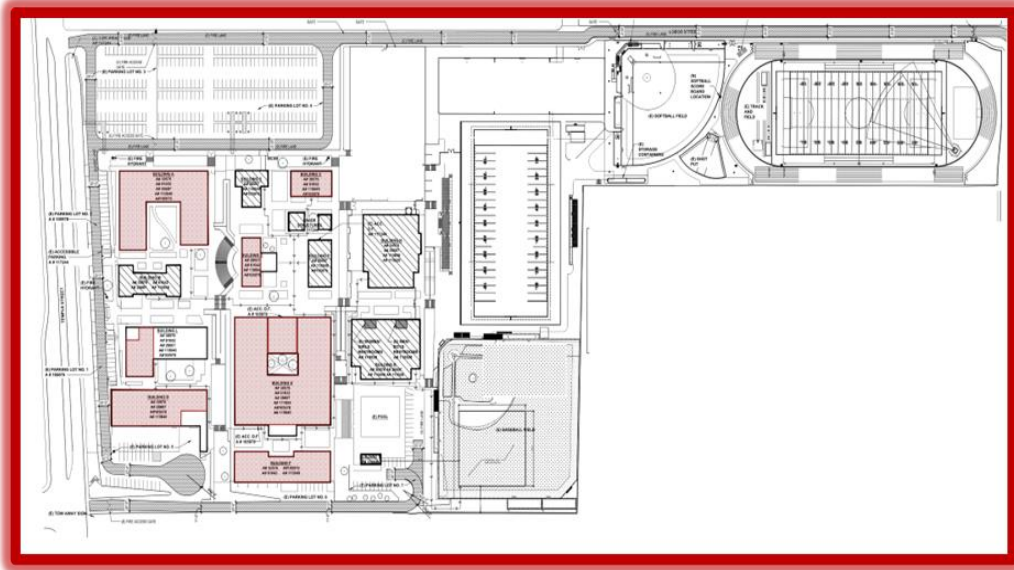

WORKMAN HIGH SCHOOL
43 CLASSROOMS

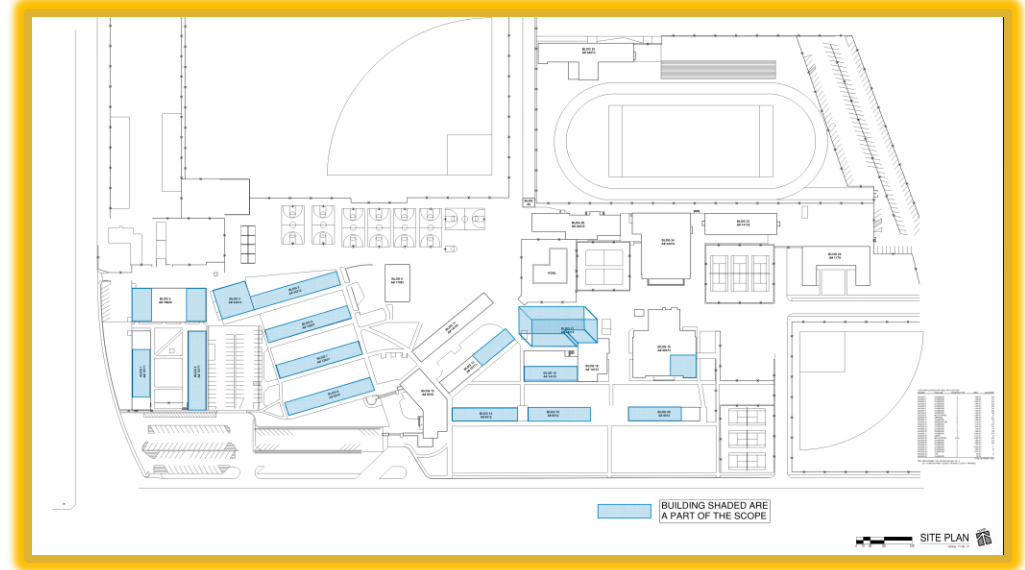

LA PUENTE HIGH SCHOOL
55 CLASSROOMS

SCHOOL	START DATE	ANTICIPATED COMPLETION DATE
WORKMAN HS	1/16/2024	11/1/2024
LA PUENTE HS	1/16/2024	11/1/2024

REFRESH GROUP 1

Workman HS Phase 3:
Classroom E-25.

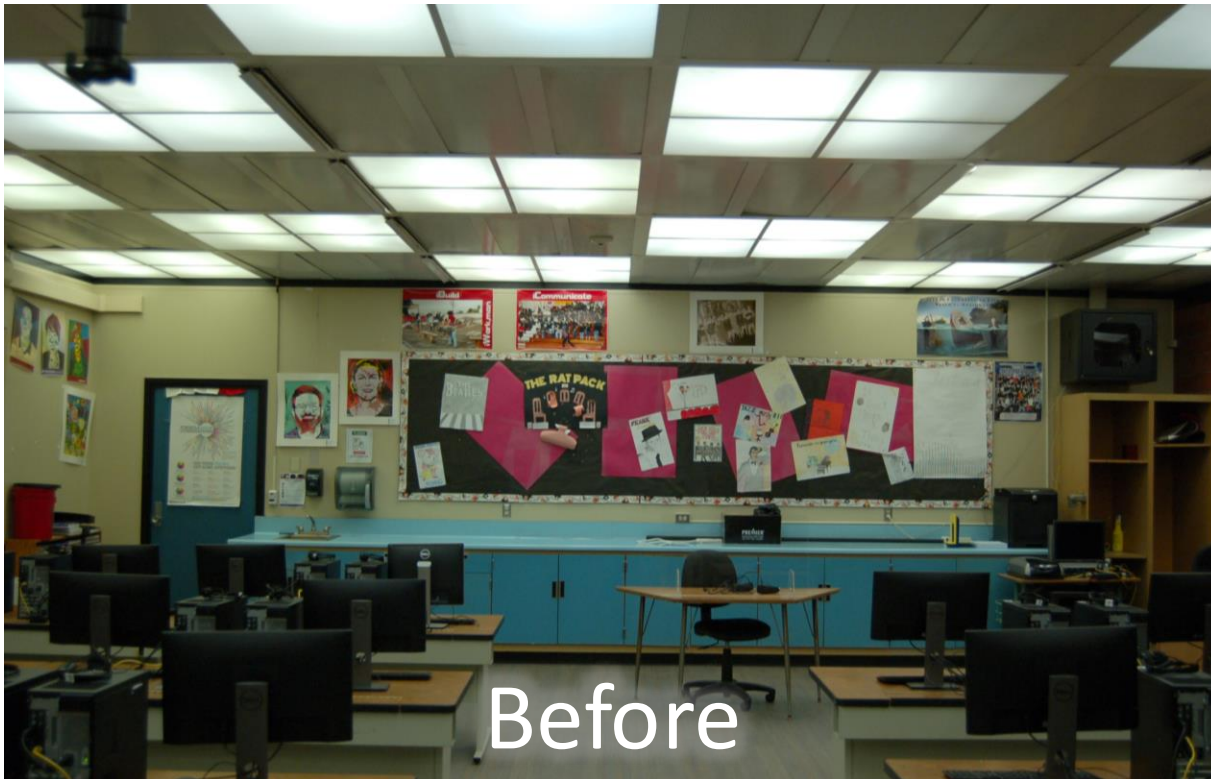

REFRESH GROUP 1

La Puente HS Phase 4:
Classroom 106.



Before



In Progress

HIGH SCHOOL REFRESH GROUP 2

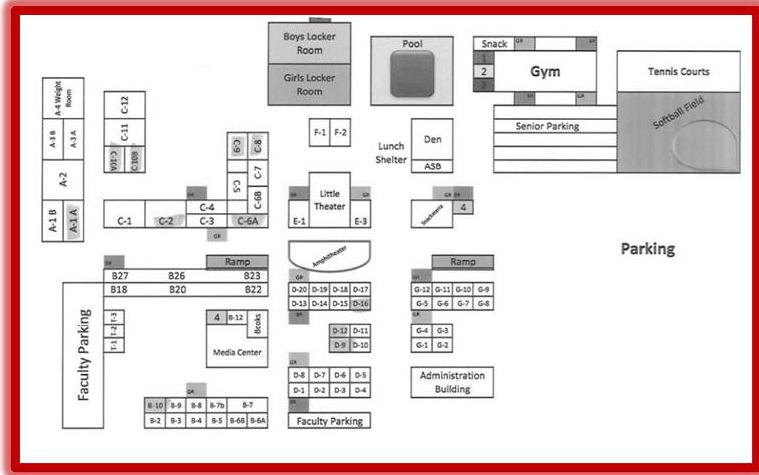

WILSON HIGH SCHOOL
59 CLASSROOMS

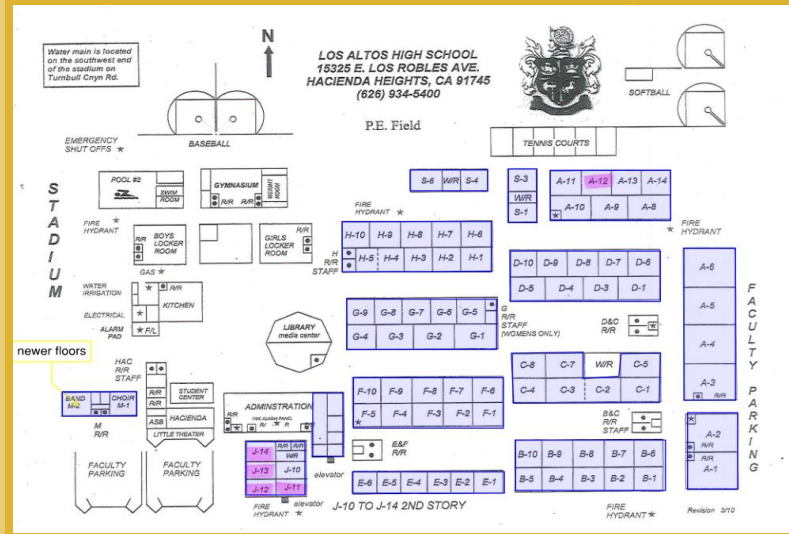

LOS ALTOS HIGH SCHOOL
69 CLASSROOMS

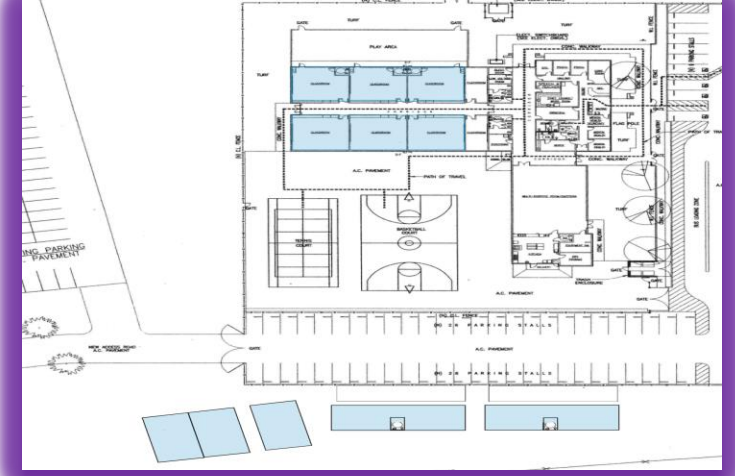

STIMSON LEARNING CENTER
10 CLASSROOMS

SCHOOL	START DATE	ANTICIPATED COMPLETION DATE
WILSON HS	3/4/2024	2/21/2025
LOS ALTOS HS	3/4/2024	4/18/2025
STIMSON LC	7/1/2024	7/31/2024

REFRESH GROUP 2

Wilson HS Phase 2:

Classroom B-7.



REFRESH GROUP 2

Los Altos HS Phase 2: Classroom A-10.

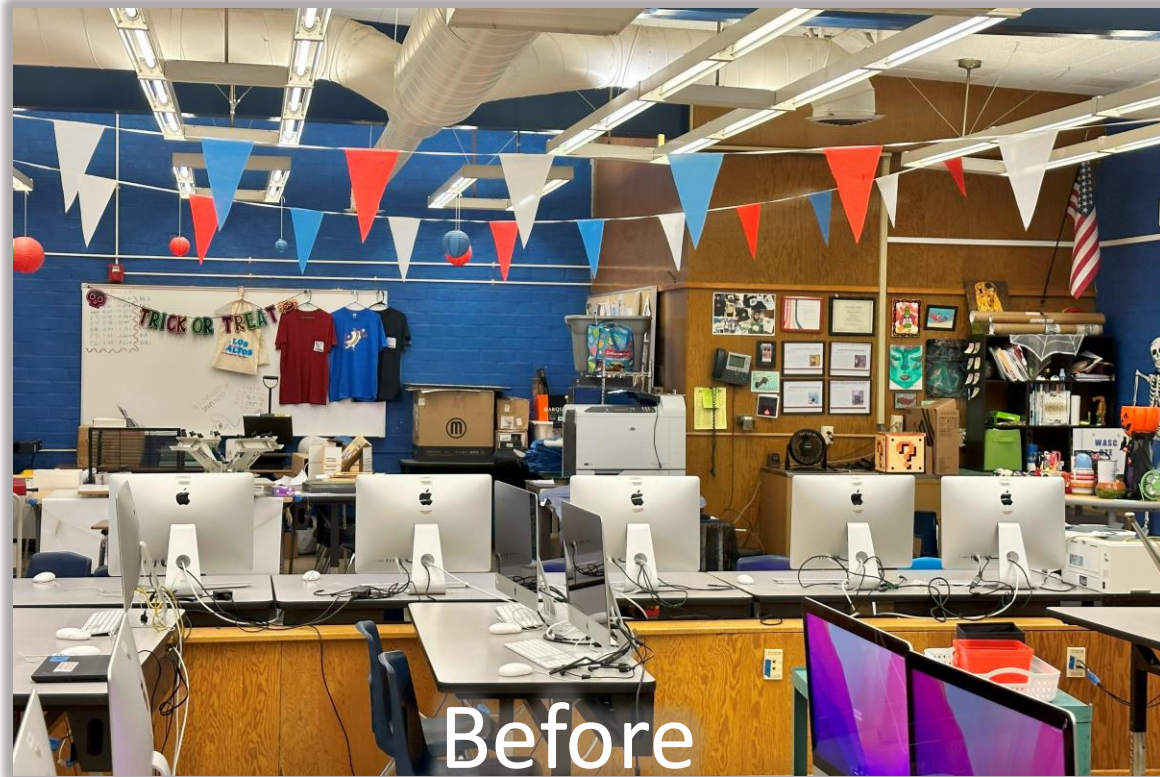

REFRESH GROUP 2

Stimson Learning Center:
Classroom.



Preparation



Demolition



QUESTIONS & ANSWERS