

January 18, 2024



Jason Bichler
Director of Buildings and Grounds
St. Michael-Albertville ISD #885
11343 50th Street NE
Albertville, MN 55301

**RE: St. Michael-Albertville ISD #885
Lead-in-Water First Draw – Follow-up Testing
IEA Project #202310887**

Dear Mr. Bichler:

At the request of St. Michael-Albertville ISD #885, IEA collected nine (9) follow-up water samples for lead analyses in response to previously elevated sample results. This current sampling occurred on January 9, 2024. The purpose of the sampling was to document lead content of water in the nine (9) locations post-remediation and to compare the results to initial “first draw” sampling conducted on November 14, 2023, and November 15, 2023, and document current lead content in the sampled locations regarding the district designated action level of 5 parts per billion (ppb).

INTRODUCTION

Minnesota Statute 121A.335 requires public school buildings serving pre-kindergarten through grade 12 to test for lead in potable water fixtures every five years. The *3Ts for Reducing Lead in Drinking Water Toolkit (2018)* and the Lead Contamination Control Act (LCCA) of 1988 were created by the Environmental Protection Agency (EPA) to identify and reduce lead in drinking water. Lead is a metal that usually enters drinking water through the distribution system, including pipes, solders, faucets, and valves. Lead content in water may increase when the water is allowed to sit undisturbed in the system. Exposure to lead is a health concern.

The EPA recommends taking action when elevated lead levels are noted in water fixtures. The MDH and MDE recommend taking a fixture out of service if levels are 20 parts per billion (ppb) or higher. The MDH and MDE also recommend taking action according to their guidelines for fixtures with levels of 2 parts per billion (ppb) or higher.

First draw samples taken on November 14, 2023, and November 15, 2023, showed one hundred and forty-five (145) samples had elevated lead content above the Action Level.

INSTITUTE FOR ENVIRONMENTAL ASSESSMENT, INC.
www.ieasafety.com

BROOKLYN PARK
9201 West Broadway, #600
Brooklyn Park, MN 55445
763-315-7900 / FAX 763-315-7920
800-233-9513

MANKATO
610 North Riverfront Drive
Mankato, MN 56001
507-345-8818 / FAX 507-345-5301
800-233-9513

ROCHESTER
210 Woodlake Drive SE
Rochester, MN 55904
507-281-6664 / FAX 507-281-6695
800-233-9513

BRAINERD
601 NW 5th Street, Ste. #4
Brainerd, MN 56401
218-454-0703 / FAX 218-454-0703
800-233-9513

MARSHALL
1420 East College Drive
Marshall, MN 56258
507-476-3599 / FAX 507-537-6985
800-233-9513

VIRGINIA
5525 Emerald Avenue
Mountain Iron, MN 55768
218-410-9521
800-233-9513

METHODOLOGY

IEA collected nine (9) first-draw (unless otherwise noted) samples of approximately 250 milliliters (ml) of water. “First draw” means the samples are collected before the fixture is used or flushed during the day. The first-draw sample results reflect a worst-case scenario, i.e., the highest lead level that would be consumed by building occupants. MDH recommends water stand in pipes for at least 8 hours, but not more than 18 hours prior to sampling identified fixtures.

Water samples were analyzed by Minnesota Valley Testing Laboratories (MVTL) in New Ulm, Minnesota, which uses EPA-approved analytical methods and quality control/assurance procedures. Samples were analyzed using the ICP/MS EPA Method 200.8.

RESULTS & DISCUSSION

The lead-in-water sampling results ranged from 2.62 ppb to 9.23 ppb. These nine (9) locations are displayed in *Table 1: Water Testing Results*. The laboratory reports are provided in Appendix A. Laboratory results are reported in micrograms per liter (µg/L) which is equivalent to ppb.

Table 1: Water Testing Results – November 14 and 15, 2023, and January 9, 2024

| Sample Number | Building | Sampling Location | Fixture Type | Remediation Method | Lead Results (ppb) | |
|---------------|----------------------|----------------------------------|-------------------|--------------------|--------------------------------|----------|
| | | | | | 11/14/2023 or 11/15/2023 | 1/9/2024 |
| 01092024AP-1 | Albertville Primary | Room 214 | Drinking Fountain | Fixture Replaced | 49.2 | 9.18 |
| 01092024BW-1 | Big Woods Elementary | Room 325 | Drinking Fountain | Fixture Replaced | 8.06 | 5.0 |
| 01092024MSW-1 | Middle School West | Room H106 North Wall | Sink | Fixture Replaced | 17.6 | 7.53 |
| 01092024MSW-2 | Middle School West | Room H106 West Wall Middle | Sink | Fixture Replaced | 19 | 5.98 |
| 01092024MSW-3 | Middle School West | Room H106 West Wall South | Sink | Fixture Replaced | 13.3 | 7.67 |
| 01092024MSW-4 | Middle School West | Room H106 South Wall West | Sink | Fixture Replaced | 16.1 | 6.28 |
| 01092024MSW-5 | Middle School West | Room H106 South Wall Middle | Sink | Fixture Replaced | 11.4 | 9.23 |
| 01092024MSW-6 | Middle School West | Room H106 South Wall East | Sink | Fixture Replaced | 15.8 | 5.98 |
| 01092024MSW-7 | Middle School West | Room F128 South Wall West Middle | Sink | No Remediation | 971 | 2.62 |

ppb – parts per billion

RECOMMENDATIONS

IEA recommends implementing one of the following treatment options for the eight (8) fixtures with lead content exceeding the district designated action level of 5 ppb.

- The fixture should be removed from service by disconnecting it from the water supply and/or posting signs that the water is not potable and notify staff accordingly.
- Bottled water should be provided to occupants which meets FDA and state standards. A written statement from the bottled water distributor guaranteeing the standards are met should be filed with the district.
- Lead pipes on the property and district portion of the service line should be replaced.
- The plumbing system should be reconfigured to redirect the water to bypass any known sources of lead contamination.
- The fixture should be replaced with a "lead-free" fixture certified to NSF/ANSI 372 or NSF/ANSI 61-G. The *Reduction of Lead in Drinking Water Act* redefines "lead-free" as "not more than a weighted average of 0.25% lead when used with respect to wetted surfaces of pipes, pipe fittings, plumbing fittings, and fixtures." Effective January 4, 2014, drinking water system components sold or installed must adhere to this new requirement.
- A drinking water treatment unit certified to NSF/ANSI 53 or NSF/ANSI 42 for lead reduction should be installed.
- Flush testing should be conducted in accordance with MDH, MDE, and EPA guidelines to determine if flushing will reduce lead content. If results indicate that flushing will reduce lead to acceptable levels:
 - A flushing program should be implemented which includes documentation of daily flushing and periodic program review.
 - It should be noted that elevated levels can return quickly following flushing depending upon the age and condition of the plumbing. The plumbing components should be replaced to ensure any repair or replacement is done using only "lead-free" solder can address high lead levels.
 - Existing wires in the building that could be grounded to lead piping should be checked, since the electrical current produced may accelerate the corrosion of the pipes. The wires could also be checked to find an alternative grounding system.

In addition, MDH recommends labeling water fixtures not included in the sampling program, including bathroom taps, hose bibbs, laboratory faucets/sinks, or custodial closet sinks.

If the school receives its water from a Community Public Water Supply, such as a municipal water supply, MDH encourages the school to work with them to assess the source contribution of lead coming into the school.

It is recommended that a copy of the district's Lead-in-Drinking Water Testing Report be made available to staff and the public through the district's administrative offices. Per Minnesota Statutes, section 121A.335, a school district that has tested its buildings for the presence of lead shall make the results of the testing available to the public for review and must notify parents of the availability of the information.

GENERAL CONDITIONS

The analysis and opinions expressed in this report are based upon data obtained from St. Michael-Albertville ISD #885 at the indicated locations. This report does not reflect variations in conditions that may occur across the site, property, or facility. Actual conditions may vary and may not become evident without further assessment.

The report is prepared for the exclusive use of our client for specific application to the project discussed and has been prepared in accordance with generally accepted environmental, health and safety practices. Other than as provided in the preceding sentence and in our Proposal #11536 dated August 15, 2023, regarding lead-in-water sampling for St. Michael-Albertville ISD #885, including the General Conditions attached thereto, no warranties are extended or made.

Please contact IEA if you would like assistance with any of the above recommendations or have questions regarding this report.

Sincerely,

IEA, Inc.

A handwritten signature in blue ink, appearing to read "Dan Holcomb", is written over a light blue rectangular background.

Daniel Holcomb, CSP, CHMM
EH&S Senior Account Manager

DH/khb 01182024

Enc.

Appendix A

Laboratory Testing Reports and Building Maps

**MINNESOTA VALLEY TESTING LABORATORIES, INC.**

1126 North Front St. ~ New Ulm, MN 56073 ~ 800-782-3557 ~ Fax 507-359-2890
2616 East Broadway Ave. ~ Bismarck, ND 58501 ~ 800-279-6885 ~ Fax 701-258-9724
1201 Lincoln Hwy. ~ Nevada, IA 50201 ~ 800-362-0855 ~ Fax 515-382-3885
www.MVTL.com



Workorder: Albertville Primary (38331)
Account #: 2190
Project #: 202310887

Client: Institute for Environmental Assessment (IEA)
PO: 202310887

Emma Squires-Sperling
IEA / Brooklyn Park
9201 W Broadway Suite #600
Brooklyn Park, MN 55445

Certificate of Analysis**Approval**

All data reported has been reviewed and approved by:

Dave Smahel, Inorganic Chemistry/Feed Lab Manager New Ulm, MN

Analyses performed under Minnesota Department of Health Accreditation conforms to the current TNI standards.

NEW ULM LAB CERTIFICATIONS:
MN LAB # 027-015-125ND WW/DW # R-040

BISMARCK LAB CERTIFICATIONS:
MN LAB # 038-999-267ND W/DW # ND-016

Workorder Comments

All samples were preserved with nitric acid upon receipt at the laboratory.

MVTL guarantees the accuracy of the analysis done on the sample submitted for testing. It is not possible for MVTL to guarantee that a test result obtained on a particular sample will be the same on any other sample unless all conditions affecting the sample are the same, including sampling by MVTL. As a mutual protection to clients, the public and ourselves, all reports are submitted as the confidential property of clients, and authorization for publication of statements, conclusions or extracts from or regarding our reports is reserved pending our written approval.

Report Date: Friday, January 12, 2024 1:08:28 PM



MINNESOTA VALLEY TESTING LABORATORIES, INC.

1126 North Front St. ~ New Ulm, MN 56073 ~ 800-782-3557 ~ Fax 507-359-2890
2616 East Broadway Ave. ~ Bismarck, ND 58501 ~ 800-279-6885 ~ Fax 701-258-9724
1201 Lincoln Hwy. ~ Nevada, IA 50201 ~ 800-362-0855 ~ Fax 515-382-3885
www.MVTL.com



Workorder: Albertville Primary (38331)

Client: Institute for Environmental Assessment (IEA)

Analytical Results

| | | | | | | |
|---------------------|--------------|-----------------|------------------|-----------|------------------|------|
| Lab ID: | 38331001 | Date Collected: | 01/09/2024 06:30 | Matrix: | Potable Water | |
| Sample ID: | 01092024AP-1 | Date Received: | 01/09/2024 13:30 | | | |
| Temp @ Receipt (C): | | | | | | |
| Sample Desc: | Room 214-DF | | | | | |
| Parameter | Results | Units | MCL | Method | Analyzed | Qual |
| Lead | 9.18 | ug/L | 15 | EPA 200.8 | 01/11/2024 17:07 | |

MVTL guarantees the accuracy of the analysis done on the sample submitted for testing. It is not possible for MVTL to guarantee that a test result obtained on a particular sample will be the same on any other sample unless all conditions affecting the sample are the same, including sampling by MVTL. As a mutual protection to clients, the public and ourselves, all reports are submitted as the confidential property of clients, and authorization for publication of statements, conclusions or extracts from or regarding our reports is reserved pending our written approval.

Report Date: Friday, January 12, 2024 1:08:28 PM



MINNESOTA VALLEY TESTING LABORATORIES, INC.

1126 North Front St. ~ New Ulm, MN 56073 ~ 800-782-3557 ~ Fax 507-359-2890
2616 East Broadway Ave. ~ Bismarck, ND 58501 ~ 800-279-6885 ~ Fax 701-258-9724
1201 Lincoln Hwy. ~ Nevada, IA 50201 ~ 800-362-0855 ~ Fax 515-382-3885
www.MVTL.com



Workorder: Albertville Primary (38331)

Client: Institute for Environmental Assessment (IEA)

Institute for Environmental
WO: 38331



MVTL guarantees the accuracy of the analysis done on the sample submitted for testing. It is not possible for MVTL to guarantee that a test result obtained on a particular sample will be the same on any other sample unless all conditions affecting the sample are the same, including sampling by MVTL. As a mutual protection to clients, the public and ourselves, all reports are submitted as the confidential property of clients, and authorization for publication of statements, conclusions or extracts from or regarding our reports is reserved pending our written approval.

Report Date: Friday, January 12, 2024 1:08:28 PM

Page 3 of 5



MINNESOTA VALLEY TESTING LABORATORIES, INC.

1126 North Front St. ~ New Ulm, MN 56073 ~ 800-782-3557 ~ Fax 507-359-2890
2616 East Broadway Ave. ~ Bismarck, ND 58501 ~ 800-279-6885 ~ Fax 701-258-9724
1201 Lincoln Hwy. ~ Nevada, IA 50201 ~ 800-362-0855 ~ Fax 515-382-3885
www.MVTL.com



Workorder: Albertville Primary (38331)

Client: Institute for Environmental Assessment (IEA)

1 of 1

38331

Chain of Custody

9301 West Broadway North, Suite 600
Brooklyn Park, MN 55445
763.315.7900 1.800.233.9513
IEA

| Client Name | | St. Michael-Albertville ISD #885 | | Building Name | | Albertville Primary | | Analytical Lab | | MVTL | |
|-------------------|---------------|--------------------------------------|-------------|---------------|-------|---------------------|------------------------|---------------------------|-------------------------|--------------------|--|
| Contact Name | | Emma Squires-Sperling Daniel Holcomb | | Project # | | 202310887 | | Project Name | | 2023-2024 STMA LIW | |
| Phone # | | 763-315-7900 | | IEA Fax # | | 763-315-7927 | | Written Sample Results To | | lab@ieasafety.com | |
| Other Information | | | | | | | | | | | |
| Sampled By | | Daniel Holcomb | | Date | | 1/9/2024 | | Time | | 6:30 a.m. | |
| Reviewed By | | | | Date | | | | Turnaround Time | | | |
| Shipped By | | Daniel Holcomb | | Date | | 1/9/2024 | | Notes | | | |
| Received By | | | | Date | | | | Sample Condition | | Temperature | |
| Lab Number | Sample Number | Sample Location | Sample Type | | | Date Sampled | Volume/ Bottle Type | Analysis Required | Comments & Observations | | |
| | | | Water | Soil | Other | | | | | | |
| | 01092024AP-1 | Room 214 - DF | X | | | 1/9/2024 | 250mL unpreserved | Lead | | | |
| | | | X | | | | 250mL unpreserved | Lead | | | |
| | | | X | | | | 250mL unpreserved | Lead | | | |
| | | | X | | | | 250mL unpreserved | Lead | | | |
| | | | X | | | | 250mL unpreserved | Lead | | | |
| | | | X | | | | 250mL unpreserved | Lead | | | |
| | | | X | | | | 250mL unpreserved | Lead | | | |
| | | | X | | | | 250mL unpreserved | Lead | | | |
| | | | X | | | | 250mL unpreserved | Lead | | | |
| | | | X | | | | 250mL unpreserved | Lead | | | |

Original - Analytical Lab
Copy - Client File
Copy - IEA Lab

AMB 9 Jan 24 0925 AMB
AMB 9 Jan 24 1350
AMB ST 09 JAN 24 1350 9.2°C TM 774

MVTL guarantees the accuracy of the analysis done on the sample submitted for testing. It is not possible for MVTL to guarantee that a test result obtained on a particular sample will be the same on any other sample unless all conditions affecting the sample are the same, including sampling by MVTL. As a mutual protection to clients, the public and ourselves, all reports are submitted as the confidential property of clients, and authorization for publication of statements, conclusions or extracts from or regarding our reports is reserved pending our written approval.

Report Date: Friday, January 12, 2024 1:08:28 PM



MINNESOTA VALLEY TESTING LABORATORIES, INC.

1126 North Front St. ~ New Ulm, MN 56073 ~ 800-782-3557 ~ Fax 507-359-2890
2616 East Broadway Ave. ~ Bismarck, ND 58501 ~ 800-279-6885 ~ Fax 701-258-9724
1201 Lincoln Hwy. ~ Nevada, IA 50201 ~ 800-362-0855 ~ Fax 515-382-3885
www.MVTL.com



Workorder: Albertville Primary (38331)

Client: Institute for Environmental Assessment (IEA)

Sample Condition Checklist

Date: 09 JAN 24 Time: 1330 ☐ AM ☒ PM By: SS

Account Name: IEA - 2 Michael Albertville ISD #885 AP Account #

Bill of Lading #: Cooler #:

Temp: 9.2 °C ROI ☐ Ambient ☒ Tracking #:

TM#: 774 Ice Crystals Present In Sample ☐ Other:

MVTL Courier: Dan

MVTL Route: Metro Walk-In ☐ UPS Air ☐ FedEx Air ☐ SpeedDee ☐
Mail ☐ UPS Ground ☐ FedEx Ground ☐

Containers Supplied by MVTL: Yes ☒ No ☐ Designate customer supplied containers as "Other" in container size column

| Comments: | | Containers Size (mL) | | | | Container Type | | | | Preservation | | | | | | | | pH | | | |
|-----------|--|---|-------|------|------|--------------------|---|--------------------------------|------------------|--------------------------------|------|-----|------|----|----|-----|-----|-----|--|--|--|
| Number | | (G) | (P) | (AG) | (AP) | NaHSO ₄ | Na ₂ O ₃ S ₂ | NONE | HNO ₃ | H ₂ SO ₄ | NaOH | HCl | SUB* | <2 | >9 | >12 | N/A | Add | | | |
| 1 | (100) (120) (125) (250) (290) (500) (1000) Other | (G) | (P) | (AG) | (AP) | NaHSO ₄ | Na ₂ O ₃ S ₂ | NONE | HNO ₃ | H ₂ SO ₄ | NaOH | HCl | SUB* | <2 | >9 | >12 | N/A | Add | | | |
| | (100) (120) (125) (250) (290) (500) (1000) Other | (G) | (P) | (AG) | (AP) | NaHSO ₄ | Na ₂ O ₃ S ₂ | NONE | HNO ₃ | H ₂ SO ₄ | NaOH | HCl | SUB* | <2 | >9 | >12 | N/A | Add | | | |
| | (100) (120) (125) (250) (290) (500) (1000) Other | (G) | (P) | (AG) | (AP) | NaHSO ₄ | Na ₂ O ₃ S ₂ | NONE | HNO ₃ | H ₂ SO ₄ | NaOH | HCl | SUB* | <2 | >9 | >12 | N/A | Add | | | |
| | (100) (120) (125) (250) (290) (500) (1000) Other | (G) | (P) | (AG) | (AP) | NaHSO ₄ | Na ₂ O ₃ S ₂ | NONE | HNO ₃ | H ₂ SO ₄ | NaOH | HCl | SUB* | <2 | >9 | >12 | N/A | Add | | | |
| | (100) (120) (125) (250) (290) (500) (1000) Other | (G) | (P) | (AG) | (AP) | NaHSO ₄ | Na ₂ O ₃ S ₂ | NONE | HNO ₃ | H ₂ SO ₄ | NaOH | HCl | SUB* | <2 | >9 | >12 | N/A | Add | | | |
| | (100) (120) (125) (250) (290) (500) (1000) Other | (G) | (P) | (AG) | (AP) | NaHSO ₄ | Na ₂ O ₃ S ₂ | NONE | HNO ₃ | H ₂ SO ₄ | NaOH | HCl | SUB* | <2 | >9 | >12 | N/A | Add | | | |
| | (100) (120) (125) (250) (290) (500) (1000) Other | (G) | (P) | (AG) | (AP) | NaHSO ₄ | Na ₂ O ₃ S ₂ | NONE | HNO ₃ | H ₂ SO ₄ | NaOH | HCl | SUB* | <2 | >9 | >12 | N/A | Add | | | |
| | (100) (120) (125) (250) (290) (500) (1000) Other | (G) | (P) | (AG) | (AP) | NaHSO ₄ | Na ₂ O ₃ S ₂ | NONE | HNO ₃ | H ₂ SO ₄ | NaOH | HCl | SUB* | <2 | >9 | >12 | N/A | Add | | | |
| | Low Level Mercury Kit | **I DO NOT OPEN THE PLASTIC BAGS HOLDING THE SAMPLE BOTTLES!!** | | | | | | | | | | | | | | | | | | | |
| | 4 oz Jar | Clear | Amber | | | MeOH | | None | | | | | | | | | | n/a | | | |
| | 2 oz Jar | Clear | Amber | | | MeOH | | None | | | | | | | | | | n/a | | | |
| | Vials Individual Set of 2 Set of 3 | Clear | Amber | | | HCl | H ₃ PO ₄ | H ₂ SO ₄ | None | | | | | | | | | n/a | | | |
| | Vials Individual Set of 2 Set of 3 | Clear | Amber | | | HCl | H ₃ PO ₄ | H ₂ SO ₄ | None | | | | | | | | | n/a | | | |
| | Trip Blank Individual Set of 2 Set of 3 | | | | | | | | | | | | | | | | | n/a | | | |
| | Moisture Vial | | | | | | | | | | | | | | | | | n/a | | | |
| | Manure Bottle | | | | | | | | | | | | | | | | | n/a | | | |

*ANY CONTAINER SENT TO A SUBCONTRACT LABORATORY WILL NOT BE CHECKED FOR PRESERVATION!

MVTL guarantees the accuracy of the analysis done on the sample submitted for testing. It is not possible for MVTL to guarantee that a test result obtained on a particular sample will be the same on any other sample unless all conditions affecting the sample are the same, including sampling by MVTL. As a mutual protection to clients, the public and ourselves, all reports are submitted as the confidential property of clients, and authorization for publication of statements, conclusions or extracts from or regarding our reports is reserved pending our written approval.

Report Date: Friday, January 12, 2024 1:08:28 PM

LEGEND

- DRINKING FOUNTAIN
- RE-SAMPLED

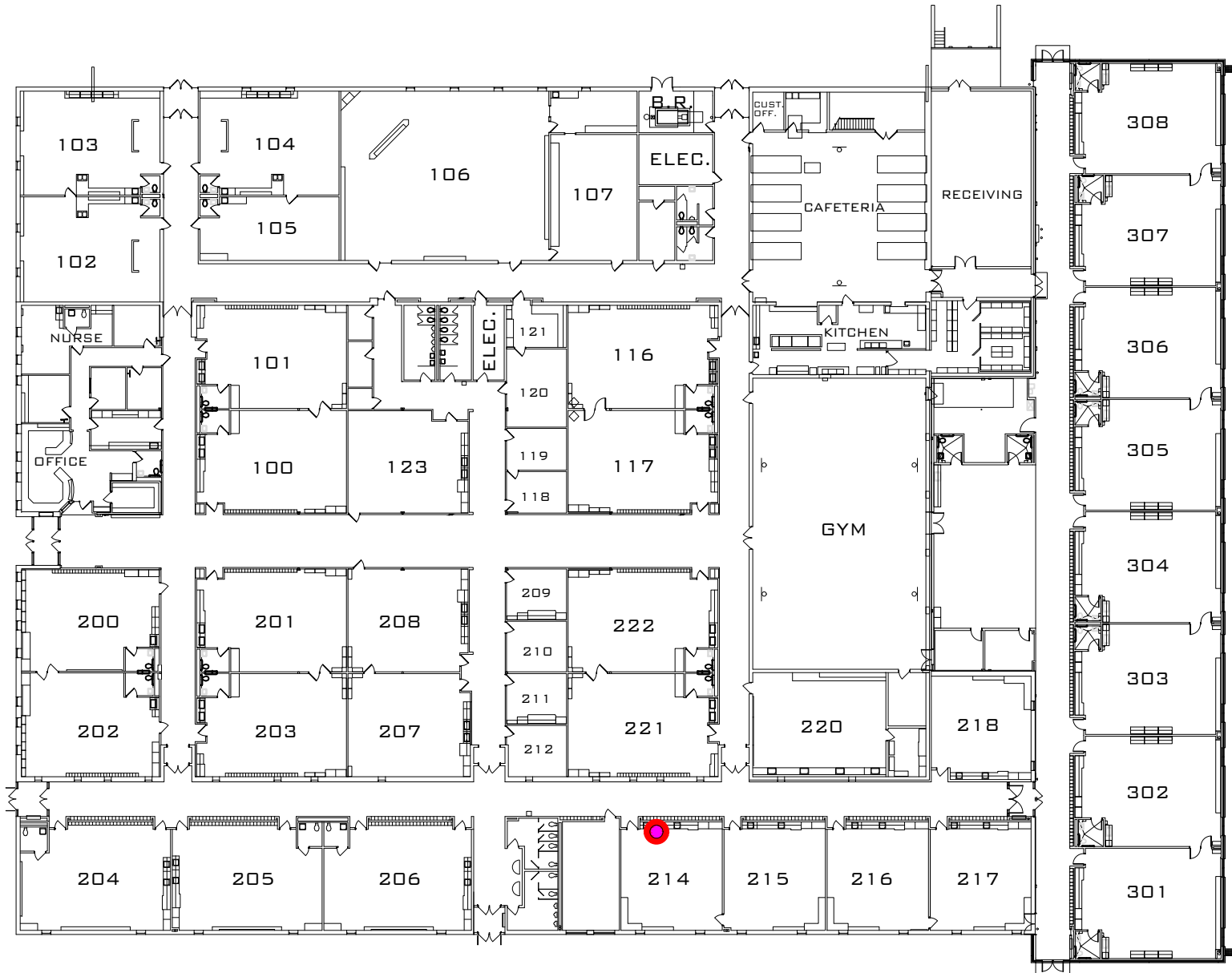

**MINNESOTA VALLEY TESTING LABORATORIES, INC.**

1126 North Front St. ~ New Ulm, MN 56073 ~ 800-782-3557 ~ Fax 507-359-2890
2616 East Broadway Ave. ~ Bismarck, ND 58501 ~ 800-279-6885 ~ Fax 701-258-9724
1201 Lincoln Hwy. ~ Nevada, IA 50201 ~ 800-362-0855 ~ Fax 515-382-3885
www.MVTL.com



Workorder: Big Woods Elementary (38332)
Account #: 2190
Project #: 202310887

Client: Institute for Environmental Assessment (IEA)
PO: 202310887

Emma Squires-Sperling
IEA / Brooklyn Park
9201 W Broadway Suite #600
Brooklyn Park, MN 55445

Certificate of Analysis**Approval**

All data reported has been reviewed and approved by:

Dave Smahel, Inorganic Chemistry/Feed Lab Manager New Ulm, MN

Analyses performed under Minnesota Department of Health Accreditation conforms to the current TNI standards.

NEW ULM LAB CERTIFICATIONS:
MN LAB # 027-015-125ND WW/DW # R-040

BISMARCK LAB CERTIFICATIONS:
MN LAB # 038-999-267ND W/DW # ND-016

Workorder Comments

All samples were preserved with nitric acid upon receipt at the laboratory.

MVTL guarantees the accuracy of the analysis done on the sample submitted for testing. It is not possible for MVTL to guarantee that a test result obtained on a particular sample will be the same on any other sample unless all conditions affecting the sample are the same, including sampling by MVTL. As a mutual protection to clients, the public and ourselves, all reports are submitted as the confidential property of clients, and authorization for publication of statements, conclusions or extracts from or regarding our reports is reserved pending our written approval.

Report Date: Friday, January 12, 2024 1:08:28 PM



MINNESOTA VALLEY TESTING LABORATORIES, INC.

1126 North Front St. ~ New Ulm, MN 56073 ~ 800-782-3557 ~ Fax 507-359-2890
2616 East Broadway Ave. ~ Bismarck, ND 58501 ~ 800-279-6885 ~ Fax 701-258-9724
1201 Lincoln Hwy. ~ Nevada, IA 50201 ~ 800-362-0855 ~ Fax 515-382-3885
www.MVTL.com



Workorder: Big Woods Elementary (38332)

Client: Institute for Environmental Assessment (IEA)

Analytical Results

| | | | | | | |
|----------------------------|----------------|------------------------|------------------|----------------|------------------|-------------|
| Lab ID: | 38332001 | Date Collected: | 01/09/2024 06:45 | Matrix: | Potable Water | |
| Sample ID: | 01092024BW-1 | Date Received: | 01/09/2024 13:30 | | | |
| Temp @ Receipt (C): | | | | | | |
| Sample Desc: | Room 325-DF | | | | | |
| Parameter | Results | Units | MCL | Method | Analyzed | Qual |
| Lead | 5.00 | ug/L | 15 | EPA 200.8 | 01/11/2024 17:24 | |

MVTL guarantees the accuracy of the analysis done on the sample submitted for testing. It is not possible for MVTL to guarantee that a test result obtained on a particular sample will be the same on any other sample unless all conditions affecting the sample are the same, including sampling by MVTL. As a mutual protection to clients, the public and ourselves, all reports are submitted as the confidential property of clients, and authorization for publication of statements, conclusions or extracts from or regarding our reports is reserved pending our written approval.

Report Date: Friday, January 12, 2024 1:08:28 PM



MINNESOTA VALLEY TESTING LABORATORIES, INC.

1126 North Front St. ~ New Ulm, MN 56073 ~ 800-782-3557 ~ Fax 507-359-2890
2616 East Broadway Ave. ~ Bismarck, ND 58501 ~ 800-279-6885 ~ Fax 701-258-9724
1201 Lincoln Hwy. ~ Nevada, IA 50201 ~ 800-362-0855 ~ Fax 515-382-3885
www.MVTL.com



Workorder: Big Woods Elementary (38332)

Client: Institute for Environmental Assessment (IEA)

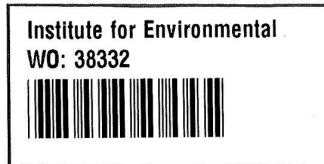

MVTL guarantees the accuracy of the analysis done on the sample submitted for testing. It is not possible for MVTL to guarantee that a test result obtained on a particular sample will be the same on any other sample unless all conditions affecting the sample are the same, including sampling by MVTL. As a mutual protection to clients, the public and ourselves, all reports are submitted as the confidential property of clients, and authorization for publication of statements, conclusions or extracts from or regarding our reports is reserved pending our written approval.

Report Date: Friday, January 12, 2024 1:08:28 PM

Page 3 of 5



MINNESOTA VALLEY TESTING LABORATORIES, INC.

1126 North Front St. ~ New Ulm, MN 56073 ~ 800-782-3557 ~ Fax 507-359-2890
2616 East Broadway Ave. ~ Bismarck, ND 58501 ~ 800-279-6885 ~ Fax 701-258-9724
1201 Lincoln Hwy. ~ Nevada, IA 50201 ~ 800-362-0855 ~ Fax 515-382-3885
www.MVTL.com



Workorder: Big Woods Elementary (38332)

Client: Institute for Environmental Assessment (IEA)

1 of 1

38332

Chain of Custody

9201 West Broadway North, Suite 600
Brooklyn Park, MN 55445
763.315.7900 1.800.233.9517



| Client Name | | St. Michael-Albertville ISD #885 | | Building Name | | Big Woods Elementary | | Analytical Lab | | MVTL | |
|-------------------|---------------|--------------------------------------|-------------|---------------|-------|----------------------|------------------------|---------------------------|-------------------------|--------------------|--|
| Contact Name | | Emma Squires-Sperling Daniel Holcomb | | Project # | | 202310887 | | Project Name | | 2023-2024 STMA LIW | |
| Phone # | | 763-315-7900 | | IEA Fax # | | 763-315-7927 | | Written Sample Results To | | lab@ieasafety.com | |
| Other Information | | | | | | | | | | | |
| Sampled By | | Daniel Holcomb | | Date | | 1/9/2024 | | Time | | 6:45am | |
| Reviewed By | | | | Date | | | | Analyzed By (Company) | | Analyst | |
| Shipped By | | Daniel Holcomb | | Date | | 1/9/2024 | | Turnaround Time | | Notes | |
| Received By | | | | Date | | | | Sample Condition | | Temperature | |
| Lab Number | Sample Number | Sample Location | Sample Type | | | Date Sampled | Volume/ Bottle Type | Analysis Required | Comments & Observations | | |
| | | | Water | Soil | Other | | | | | | |
| | 01092024BW-1 | Room 325 - DF | X | | | 1/9/2024 | 250mL unpreserved | Lead | | | |
| | | | X | | | | 250mL unpreserved | Lead | | | |
| | | | X | | | | 250mL unpreserved | Lead | | | |
| | | | X | | | | 250mL unpreserved | Lead | | | |
| | | | X | | | | 250mL unpreserved | Lead | | | |
| | | | X | | | | 250mL unpreserved | Lead | | | |
| | | | X | | | | 250mL unpreserved | Lead | | | |
| | | | X | | | | 250mL unpreserved | Lead | | | |
| | | | X | | | | 250mL unpreserved | Lead | | | |
| | | | X | | | | 250mL unpreserved | Lead | | | |
| | | | X | | | | 250mL unpreserved | Lead | | | |

From SS 01 JAN 24 1330 9.2°C
AMB 7m 774

1/9/24 1330 AMB

Original - Analytical Lab
Copy - Client File
Copy - IEA Lab

MVTL guarantees the accuracy of the analysis done on the sample submitted for testing. It is not possible for MVTL to guarantee that a test result obtained on a particular sample will be the same on any other sample unless all conditions affecting the sample are the same, including sampling by MVTL. As a mutual protection to clients, the public and ourselves, all reports are submitted as the confidential property of clients, and authorization for publication of statements, conclusions or extracts from or regarding our reports is reserved pending our written approval.

Report Date: Friday, January 12, 2024 1:08:28 PM

Page 4 of 5



MINNESOTA VALLEY TESTING LABORATORIES, INC.

1126 North Front St. ~ New Ulm, MN 56073 ~ 800-782-3557 ~ Fax 507-359-2890
2616 East Broadway Ave. ~ Bismarck, ND 58501 ~ 800-279-6885 ~ Fax 701-258-9724
1201 Lincoln Hwy. ~ Nevada, IA 50201 ~ 800-362-0855 ~ Fax 515-382-3885
www.MVTL.com



Workorder: Big Woods Elementary (38332)

Client: Institute for Environmental Assessment (IEA)

Sample Condition Checklist

Date: 09/30/24 Time: 1230 ☐ AM ☒ PM By: SJ

Account Name: IEA - St. Michael-Albertville ISD #885 Account #

Bill of Lading #: Biv Cooler #:

Temp: 9.2 °C ROI ☐ Ambient ☒ Tracking #:

TMH: 774 Ice Crystals Present In Sample ☐

MVTL Courier: Dan Other:

MVTL Route: Metro Walk-In ☐ UPS Air ☐ FedEx Air ☐ SpeedDee ☐

Mail ☐ UPS Ground ☐ FedEx Ground ☐

Containers Supplied by MVTL: Yes ☒ No ☐ Designate customer supplied containers as "Other" in container size column.

Comments:

| Number | Containers Size (mL) | Container Type | Preservation | pH |
|--------|--|---|---|-------------------|
| 1 | (100) (120) (125) (250) (290) (500) (1000) Other | (G) (P) (AG) (AP) | NaHSO ₄ Na ₂ O ₅ S ₂ NONE HNO ₃ H ₂ SO ₄ NaOH HCl SUB* | <2 >9 >12 N/A Add |
| | (100) (120) (125) (250) (290) (500) (1000) Other | (G) (P) (AG) (AP) | NaHSO ₄ Na ₂ O ₅ S ₂ NONE HNO ₃ H ₂ SO ₄ NaOH HCl SUB* | <2 >9 >12 N/A Add |
| | (100) (120) (125) (250) (290) (500) (1000) Other | (G) (P) (AG) (AP) | NaHSO ₄ Na ₂ O ₅ S ₂ NONE HNO ₃ H ₂ SO ₄ NaOH HCl SUB* | <2 >9 >12 N/A Add |
| | (100) (120) (125) (250) (290) (500) (1000) Other | (G) (P) (AG) (AP) | NaHSO ₄ Na ₂ O ₅ S ₂ NONE HNO ₃ H ₂ SO ₄ NaOH HCl SUB* | <2 >9 >12 N/A Add |
| | (100) (120) (125) (250) (290) (500) (1000) Other | (G) (P) (AG) (AP) | NaHSO ₄ Na ₂ O ₅ S ₂ NONE HNO ₃ H ₂ SO ₄ NaOH HCl SUB* | <2 >9 >12 N/A Add |
| | (100) (120) (125) (250) (290) (500) (1000) Other | (G) (P) (AG) (AP) | NaHSO ₄ Na ₂ O ₅ S ₂ NONE HNO ₃ H ₂ SO ₄ NaOH HCl SUB* | <2 >9 >12 N/A Add |
| | (100) (120) (125) (250) (290) (500) (1000) Other | (G) (P) (AG) (AP) | NaHSO ₄ Na ₂ O ₅ S ₂ NONE HNO ₃ H ₂ SO ₄ NaOH HCl SUB* | <2 >9 >12 N/A Add |
| | (100) (120) (125) (250) (290) (500) (1000) Other | (G) (P) (AG) (AP) | NaHSO ₄ Na ₂ O ₅ S ₂ NONE HNO ₃ H ₂ SO ₄ NaOH HCl SUB* | <2 >9 >12 N/A Add |
| | Low Level Mercury Kit | **I DO NOT OPEN THE PLASTIC BAGS HOLDING THE SAMPLE BOTTLES!!** | | |
| | 4 oz Jar | Clear Amber | MeOH None | n/a |
| | 2 oz Jar | Clear Amber | MeOH None | n/a |
| | Vials Individual Set of 2 Set of 3 | Clear Amber | HCl H ₃ PO ₄ H ₂ SO ₄ None | n/a |
| | Vials Individual Set of 2 Set of 3 | Clear Amber | HCl H ₃ PO ₄ H ₂ SO ₄ None | n/a |
| | Trip Blank Individual Set of 2 Set of 3 | | n/a | |
| | Moisture Vial | | n/a | |
| | Manure Bottle | | n/a | |

*ANY CONTAINER SENT TO A SUBCONTRACT LABORATORY WILL NOT BE CHECKED FOR PRESERVATION!

MVTL guarantees the accuracy of the analysis done on the sample submitted for testing. It is not possible for MVTL to guarantee that a test result obtained on a particular sample will be the same on any other sample unless all conditions affecting the sample are the same, including sampling by MVTL. As a mutual protection to clients, the public and ourselves, all reports are submitted as the confidential property of clients, and authorization for publication of statements, conclusions or extracts from or regarding our reports is reserved pending our written approval.

Report Date: Friday, January 12, 2024 1:08:28 PM

LEGEND

- DRINKING FOUNTAIN
- RE-SAMPLED

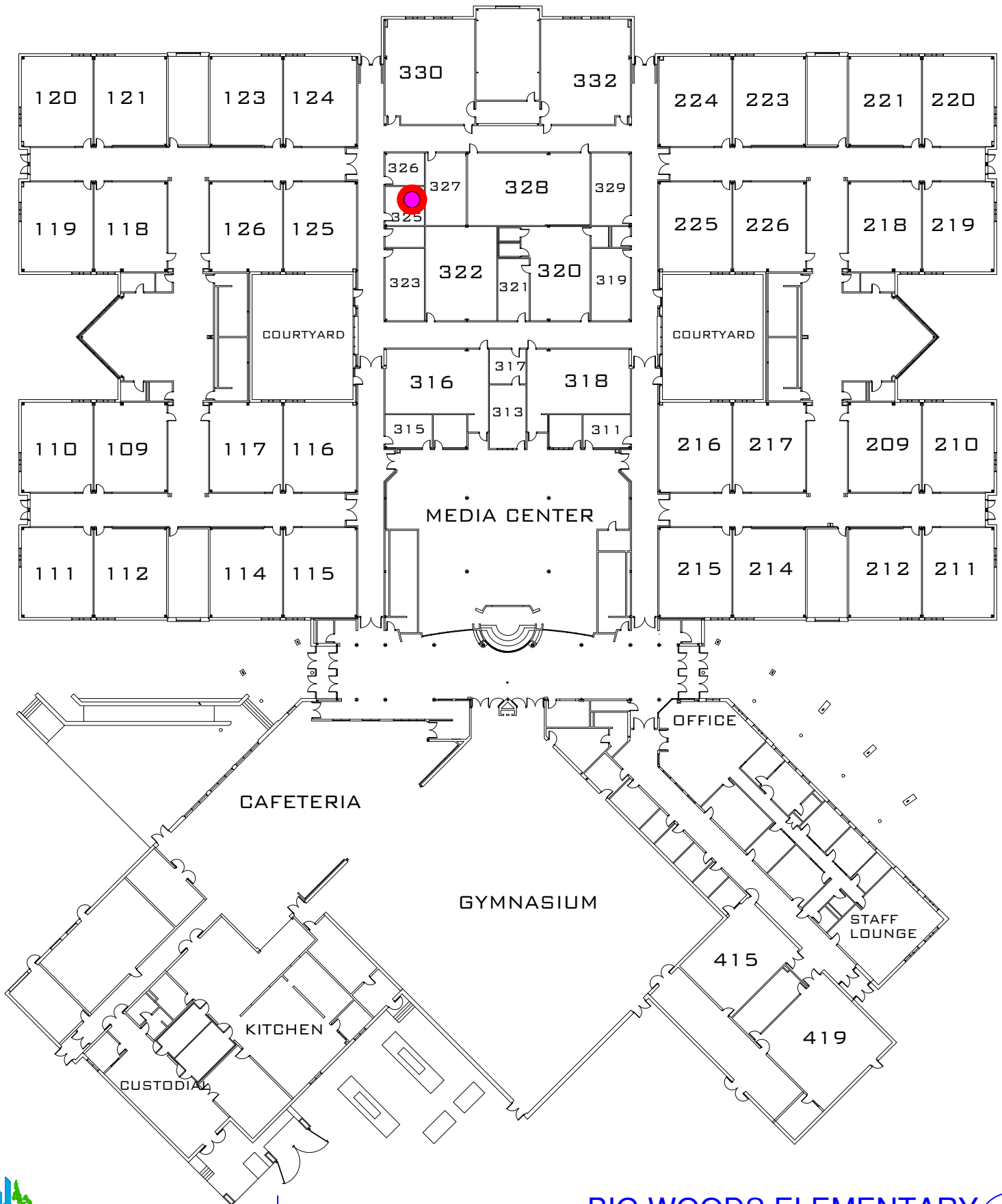

**MINNESOTA VALLEY TESTING LABORATORIES, INC.**

1126 North Front St. ~ New Ulm, MN 56073 ~ 800-782-3557 ~ Fax 507-359-2890
2616 East Broadway Ave. ~ Bismarck, ND 58501 ~ 800-279-6885 ~ Fax 701-258-9724
1201 Lincoln Hwy. ~ Nevada, IA 50201 ~ 800-362-0855 ~ Fax 515-382-3885
www.MVTL.com



Workorder: Middle School West (38329)
Account #: 2190
Project #: 202310887

Client: Institute for Environmental Assessment (IEA)
PO: 202310887

Emma Squires-Sperling
IEA / Brooklyn Park
9201 W Broadway Suite #600
Brooklyn Park, MN 55445

Certificate of Analysis**Approval**

All data reported has been reviewed and approved by:

Dave Smahel, Inorganic Chemistry/Feed Lab Manager New Ulm, MN

Analyses performed under Minnesota Department of Health Accreditation conforms to the current TNI standards.

NEW ULM LAB CERTIFICATIONS:
MN LAB # 027-015-125ND WW/DW # R-040

BISMARCK LAB CERTIFICATIONS:
MN LAB # 038-999-267ND W/DW # ND-016

Workorder Comments

All samples were preserved with nitric acid upon receipt at the laboratory.

MVTL guarantees the accuracy of the analysis done on the sample submitted for testing. It is not possible for MVTL to guarantee that a test result obtained on a particular sample will be the same on any other sample unless all conditions affecting the sample are the same, including sampling by MVTL. As a mutual protection to clients, the public and ourselves, all reports are submitted as the confidential property of clients, and authorization for publication of statements, conclusions or extracts from or regarding our reports is reserved pending our written approval.

Report Date: Friday, January 12, 2024 1:08:28 PM

Page 1 of 6

**MINNESOTA VALLEY TESTING LABORATORIES, INC.**

1126 North Front St. ~ New Ulm, MN 56073 ~ 800-782-3557 ~ Fax 507-359-2890
2616 East Broadway Ave. ~ Bismarck, ND 58501 ~ 800-279-6885 ~ Fax 701-258-9724
1201 Lincoln Hwy. ~ Nevada, IA 50201 ~ 800-362-0855 ~ Fax 515-382-3885
www.MVTL.com

**Workorder:** Middle School West (38329)**Client:** Institute for Environmental Assessment (IEA)**Analytical Results**

Lab ID: 38329001 **Date Collected:** 01/09/2024 07:00 **Matrix:** Potable Water
Sample ID: 01092024MSW-1 **Date Received:** 01/09/2024 13:20
Temp @ Receipt (C):
Sample Desc: Room H106 North Wall-SNK

| Parameter | Results | Units | MCL | Method | Analyzed | Qual |
|-----------|---------|-------|-----|-----------|------------------|------|
| Lead | 7.53 | ug/L | 15 | EPA 200.8 | 01/11/2024 16:52 | |

Lab ID: 38329002 **Date Collected:** 01/09/2024 07:00 **Matrix:** Potable Water
Sample ID: 01092024MSW-2 **Date Received:** 01/09/2024 13:20
Temp @ Receipt (C):
Sample Desc: Room H106 West Wall-Middle SNK

| Parameter | Results | Units | MCL | Method | Analyzed | Qual |
|-----------|---------|-------|-----|-----------|------------------|------|
| Lead | 5.98 | ug/L | 15 | EPA 200.8 | 01/11/2024 16:54 | |

Lab ID: 38329003 **Date Collected:** 01/09/2024 07:00 **Matrix:** Potable Water
Sample ID: 01092024MSW-3 **Date Received:** 01/09/2024 13:20
Temp @ Receipt (C):
Sample Desc: Room H106 West Wall-South SNK

| Parameter | Results | Units | MCL | Method | Analyzed | Qual |
|-----------|---------|-------|-----|-----------|------------------|------|
| Lead | 7.67 | ug/L | 15 | EPA 200.8 | 01/11/2024 16:56 | |

Lab ID: 38329004 **Date Collected:** 01/09/2024 07:00 **Matrix:** Potable Water
Sample ID: 01092024MSW-4 **Date Received:** 01/09/2024 13:20
Temp @ Receipt (C):
Sample Desc: Room H106 South Wall-West SNK

| Parameter | Results | Units | MCL | Method | Analyzed | Qual |
|-----------|---------|-------|-----|-----------|------------------|------|
| Lead | 6.28 | ug/L | 15 | EPA 200.8 | 01/11/2024 16:58 | |

Lab ID: 38329005 **Date Collected:** 01/09/2024 07:00 **Matrix:** Potable Water
Sample ID: 01092024MSW-5 **Date Received:** 01/09/2024 13:20
Temp @ Receipt (C):
Sample Desc: Room H106 South Wall-Middle SNK

| Parameter | Results | Units | MCL | Method | Analyzed | Qual |
|-----------|---------|-------|-----|-----------|------------------|------|
| Lead | 9.23 | ug/L | 15 | EPA 200.8 | 01/11/2024 17:00 | |

Lab ID: 38329006 **Date Collected:** 01/09/2024 07:00 **Matrix:** Potable Water
Sample ID: 01092024MSW-6 **Date Received:** 01/09/2024 13:20
Temp @ Receipt (C):
Sample Desc: Room H106 South Wall-East SNK

| Parameter | Results | Units | MCL | Method | Analyzed | Qual |
|-----------|---------|-------|-----|-----------|------------------|------|
| Lead | 5.98 | ug/L | 15 | EPA 200.8 | 01/11/2024 17:03 | |

MVTL guarantees the accuracy of the analysis done on the sample submitted for testing. It is not possible for MVTL to guarantee that a test result obtained on a particular sample will be the same on any other sample unless all conditions affecting the sample are the same, including sampling by MVTL. As a mutual protection to clients, the public and ourselves, all reports are submitted as the confidential property of clients, and authorization for publication of statements, conclusions or extracts from or regarding our reports is reserved pending our written approval.

Report Date: Friday, January 12, 2024 1:08:28 PM

**MINNESOTA VALLEY TESTING LABORATORIES, INC.**

1126 North Front St. ~ New Ulm, MN 56073 ~ 800-782-3557 ~ Fax 507-359-2890
2616 East Broadway Ave. ~ Bismarck, ND 58501 ~ 800-279-6885 ~ Fax 701-258-9724
1201 Lincoln Hwy. ~ Nevada, IA 50201 ~ 800-362-0855 ~ Fax 515-382-3885
www.MVTL.com

**Workorder:** Middle School West (38329)**Client:** Institute for Environmental Assessment (IEA)**Analytical Results**

| | | | | | | |
|----------------------------|--------------------------------------|------------------------|------------------|----------------|------------------|-------------|
| Lab ID: | 38329007 | Date Collected: | 01/09/2024 07:00 | Matrix: | Potable Water | |
| Sample ID: | 01092024MSW-7 | Date Received: | 01/09/2024 13:20 | | | |
| Temp @ Receipt (C): | | | | | | |
| Sample Desc: | Room F128 South Wall West-Middle SNK | | | | | |
| Parameter | Results | Units | MCL | Method | Analyzed | Qual |
| Lead | 2.62 | ug/L | 15 | EPA 200.8 | 01/11/2024 17:05 | |

MVTL guarantees the accuracy of the analysis done on the sample submitted for testing. It is not possible for MVTL to guarantee that a test result obtained on a particular sample will be the same on any other sample unless all conditions affecting the sample are the same, including sampling by MVTL. As a mutual protection to clients, the public and ourselves, all reports are submitted as the confidential property of clients, and authorization for publication of statements, conclusions or extracts from or regarding our reports is reserved pending our written approval.

Report Date: Friday, January 12, 2024 1:08:28 PM



MINNESOTA VALLEY TESTING LABORATORIES, INC.

1126 North Front St. ~ New Ulm, MN 56073 ~ 800-782-3557 ~ Fax 507-359-2890
2616 East Broadway Ave. ~ Bismarck, ND 58501 ~ 800-279-6885 ~ Fax 701-258-9724
1201 Lincoln Hwy. ~ Nevada, IA 50201 ~ 800-362-0855 ~ Fax 515-382-3885
www.MVTL.com



Workorder: Middle School West (38329)

Client: Institute for Environmental Assessment (IEA)

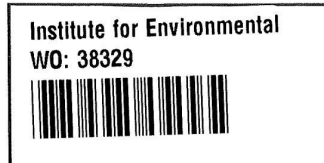

MVTL guarantees the accuracy of the analysis done on the sample submitted for testing. It is not possible for MVTL to guarantee that a test result obtained on a particular sample will be the same on any other sample unless all conditions affecting the sample are the same, including sampling by MVTL. As a mutual protection to clients, the public and ourselves, all reports are submitted as the confidential property of clients, and authorization for publication of statements, conclusions or extracts from or regarding our reports is reserved pending our written approval.

Report Date: Friday, January 12, 2024 1:08:28 PM

Page 4 of 6



MINNESOTA VALLEY TESTING LABORATORIES, INC.

1126 North Front St. ~ New Ulm, MN 56073 ~ 800-782-3557 ~ Fax 507-359-2890
2616 East Broadway Ave. ~ Bismarck, ND 58501 ~ 800-279-6885 ~ Fax 701-258-9724
1201 Lincoln Hwy. ~ Nevada, IA 50201 ~ 800-362-0855 ~ Fax 515-382-3885
www.MVTL.com



Workorder: Middle School West (38329)

Client: Institute for Environmental Assessment (IEA)

1 of 1

38329

Chain of Custody

9201 West Broadway North, Suite 600
Brooklyn Park, MN 55445
763.315.7900 1.800.233.9513
IEA

| Client Name | | St. Michael-Albertville ISD #885 | | Building Name | | Middle School West | | Analytical Lab | | MVTL | |
|-------------------|---------------|--|-------------|---------------|-------|--------------------|------------------------|---------------------------|-------------------------|--------------------|--|
| Contact Name | | Emma Squires-Sperling Daniel Holcomb | | Project # | | 202310887 | | Project Name | | 2023-2024 STMA LIW | |
| Phone # | | 763-315-7900 | | IEA Fax # | | 763-315-7927 | | Written Sample Results To | | lab@ieasafety.com | |
| Other Information | | | | | | | | | | | |
| Sampled By | | Daniel Holcomb | | Date | | 1/9/2024 | | Time | | 7:00 AM | |
| Reviewed By | | | | Date | | | | Analyzed By (Company) | | | |
| Shipped By | | Daniel Holcomb | | Date | | 1/9/2024 | | Time | | Turnaround Time | |
| Received By | | | | Date | | | | Sample Condition | | Temperature | |
| Lab Number | Sample Number | Sample Location | Sample Type | | | Date Sampled | Volume/ Bottle Type | Analysis Required | Comments & Observations | | |
| | | | Water | Soil | Other | | | | | | |
| | 01092024MSW-1 | Room H106 North Wall - SNK | X | | | 1/9/2024 | 250mL unpreserved | Lead | | | |
| | 01092024MSW-2 | Room H106 West Wall - Middle SNK | X | | | 1/9/2024 | 250mL unpreserved | Lead | | | |
| | 01092024MSW-3 | Room H106 West Wall - South SNK | X | | | 1/9/2024 | 250mL unpreserved | Lead | | | |
| | 01092024MSW-4 | Room H106 South Wall - West SNK | X | | | 1/9/2024 | 250mL unpreserved | Lead | | | |
| | 01092024MSW-5 | Room H106 South Wall - Middle SNK | X | | | 1/9/2024 | 250mL unpreserved | Lead | | | |
| | 01092024MSW-6 | Room H106 South Wall - East SNK | X | | | 1/9/2024 | 250mL unpreserved | Lead | | | |
| | 01092024MSW-7 | Room F128 South Wall West - Middle SNK | X | | | 1/9/2024 | 250mL unpreserved | Lead | | | |

HL 9 Jan 24 1320 PMB

AMB SS 09 JAN 24 1320 9.2°C TM724

Original - Analytical Lab
Copy - Client File
Copy - IEA Lab

MVTL guarantees the accuracy of the analysis done on the sample submitted for testing. It is not possible for MVTL to guarantee that a test result obtained on a particular sample will be the same on any other sample unless all conditions affecting the sample are the same, including sampling by MVTL. As a mutual protection to clients, the public and ourselves, all reports are submitted as the confidential property of clients, and authorization for publication of statements, conclusions or extracts from or regarding our reports is reserved pending our written approval.

Report Date: Friday, January 12, 2024 1:08:28 PM

Page 5 of 6



MINNESOTA VALLEY TESTING LABORATORIES, INC.

1126 North Front St. ~ New Ulm, MN 56073 ~ 800-782-3557 ~ Fax 507-359-2890
2616 East Broadway Ave. ~ Bismarck, ND 58501 ~ 800-279-6885 ~ Fax 701-258-9724
1201 Lincoln Hwy. ~ Nevada, IA 50201 ~ 800-362-0855 ~ Fax 515-382-3885
www.MVTL.com



Workorder: Middle School West (38329)

Client: Institute for Environmental Assessment (IEA)

Sample Condition Checklist

Date: 09 JAN 24 Time: 1320 ☐ AM ☒ PM By: SS

Account Name: St. Michael-Albertrine ISO # 885 MSW Account #

Bill of Lading #: Cooler #:

Temp: 9.2 °C ROI ☐ Ambient ☒ Tracking #:

TMH: 774 Ice Crystals Present in Sample ☐

MVTL Courier: Dan Other:

MVTL Route: Metro Walk-In ☐ UPS Air ☐ FedEx Air ☐ SpeedDee ☐

Mail ☐ UPS Ground ☐ Fed Ex Ground ☐

Containers Supplied by MVTL: Yes ☒ No ☐ Designate customer supplied containers as "Other" in container size column.

| Comments: | | | | | | | | | Container Type | | | | Preservation | | | | | | | | pH | | | | |
|-----------|-----------------------|------------|----------|----------|------------|----------|----------|-------|--|-------|------|------|--------------------------------|---|------|------------------|--------------------------------|------|-----|------|----|----|-----|-----|-----|
| Number | Containers Size (mL) | | | | | | | | | | | | | | | | | | | | | | | | |
| 7 | (100) | (120) | (125) | (250) | (290) | (500) | (1000) | Other | (G) | (P) | (AG) | (AP) | NaHSO ₄ | Na ₂ O ₃ S ₂ | NONE | HNO ₃ | H ₂ SO ₄ | NaOH | HCl | SUB* | <2 | >9 | >12 | N/A | Add |
| | (100) | (120) | (125) | (250) | (290) | (500) | (1000) | Other | (G) | (P) | (AG) | (AP) | NaHSO ₄ | Na ₂ O ₃ S ₂ | NONE | HNO ₃ | H ₂ SO ₄ | NaOH | HCl | SUB* | <2 | >9 | >12 | N/A | Add |
| | (100) | (120) | (125) | (250) | (290) | (500) | (1000) | Other | (G) | (P) | (AG) | (AP) | NaHSO ₄ | Na ₂ O ₃ S ₂ | NONE | HNO ₃ | H ₂ SO ₄ | NaOH | HCl | SUB* | <2 | >9 | >12 | N/A | Add |
| | (100) | (120) | (125) | (250) | (290) | (500) | (1000) | Other | (G) | (P) | (AG) | (AP) | NaHSO ₄ | Na ₂ O ₃ S ₂ | NONE | HNO ₃ | H ₂ SO ₄ | NaOH | HCl | SUB* | <2 | >9 | >12 | N/A | Add |
| | (100) | (120) | (125) | (250) | (290) | (500) | (1000) | Other | (G) | (P) | (AG) | (AP) | NaHSO ₄ | Na ₂ O ₃ S ₂ | NONE | HNO ₃ | H ₂ SO ₄ | NaOH | HCl | SUB* | <2 | >9 | >12 | N/A | Add |
| | (100) | (120) | (125) | (250) | (290) | (500) | (1000) | Other | (G) | (P) | (AG) | (AP) | NaHSO ₄ | Na ₂ O ₃ S ₂ | NONE | HNO ₃ | H ₂ SO ₄ | NaOH | HCl | SUB* | <2 | >9 | >12 | N/A | Add |
| | (100) | (120) | (125) | (250) | (290) | (500) | (1000) | Other | (G) | (P) | (AG) | (AP) | NaHSO ₄ | Na ₂ O ₃ S ₂ | NONE | HNO ₃ | H ₂ SO ₄ | NaOH | HCl | SUB* | <2 | >9 | >12 | N/A | Add |
| | Low Level Mercury Kit | | | | | | | | **DO NOT OPEN THE PLASTIC BAGS HOLDING THE SAMPLE BOTTLES!** | | | | | | | | | | | | | | | | |
| | 4 oz Jar | | | | | | | | Clear | Amber | MeOH | | | | None | | | | n/a | | | | | | |
| | 2 oz Jar | | | | | | | | Clear | Amber | MeOH | | | | None | | | | n/a | | | | | | |
| | Vials | Individual | Set of 2 | Set of 3 | | | | | Clear | Amber | HCl | | H ₃ PO ₄ | H ₂ SO ₄ | None | | n/a | | | | | | | | |
| | Vials | Individual | Set of 2 | Set of 3 | | | | | Clear | Amber | HCl | | H ₃ PO ₄ | H ₂ SO ₄ | None | | n/a | | | | | | | | |
| | Trip Blank | | | | Individual | Set of 2 | Set of 3 | n/a | | | | | | | | | | | | | | | | | |
| | Moisture Vial | | | | | | | | n/a | | | | | | | | | | | | | | | | |
| | Manure Bottle | | | | | | | | n/a | | | | | | | | | | | | | | | | |

*ANY CONTAINER SENT TO A SUBCONTRACT LABORATORY WILL NOT BE CHECKED FOR PRESERVATION!

MVTL guarantees the accuracy of the analysis done on the sample submitted for testing. It is not possible for MVTL to guarantee that a test result obtained on a particular sample will be the same on any other sample unless all conditions affecting the sample are the same, including sampling by MVTL. As a mutual protection to clients, the public and ourselves, all reports are submitted as the confidential property of clients, and authorization for publication of statements, conclusions or extracts from or regarding our reports is reserved pending our written approval.

Report Date: Friday, January 12, 2024 1:08:28 PM

LEGEND

- SINK
- RE-SAMPLED
- X NON-OPERABLE

