



Crabtree, Rohrbaugh & Associates

CONEWAGO VALLEY SCHOOL DISTRICT

Conewago Township ES &
New Oxford ES

Project Update
June 3, 2024

AGENDA

1 Project Update

2 Visual Listening

3 CTE

4 NOE

5 Next Steps



Project Update

Project Status Report

PROJECT UPDATE - CTE

1. Move from Schematic Design to Design Development
2. Interior Design Layouts – on-going
3. Zoning Variance (over-sized vehicles) - completed
4. Civil Engineering due diligence: Traffic study & Geotech – on-going
5. Land Development – On-going
6. Expand Design Professional Team: Structural Engineers & Food Service Consultant - on-going

PROJECT UPDATE - NOE

1. Finalize Schematic Design - **completed**
2. Civil Engineering due diligence: Traffic study, Geotech, Zoning requirements – **on-going**
3. Expand Design Professional Team: Structural Engineers & Food Service Consultant - **on-going**

A top-down view of several people's hands and forearms stacked in a circle, creating a sense of unity and teamwork. The hands are of various skin tones, and the clothing includes an orange shirt, a blue sweater, and a grey hoodie. A semi-transparent dark grey banner is overlaid across the center of the image.

Visual Listening

Faculty & Students Provide Input

VISUAL LISTENING SUMMARY

Interactive, graphic based exercise to communicate the District's:

- Vision
- Goals
- Ideas

1. Display images/portions of images of educational spaces and grouping of learners

2. Students and Teachers participate by placing a:

- **Green dot** – Consistent with the educational approach and vision for the project
- **Red dot** – Inconsistent with the educational approach and vision for the project

3. After participants placed their dots the groups discuss their selections

- Flexibility
- Supervision
- Proximity

VISUAL LISTENING SUMMARY

Faculty:

Likes:

- Wide Hallways
- Wayfinding
- Visibility
- Group Assembly Spaces
- Integrated Technology

Students:

Likes:

- Natural Light / Big Windows
- Bright Colors
- Variety of Learning Spaces
- Flexible Furniture
- Outdoor Play Areas – Views to Nature

VISUAL LISTENING EXERCISE



ENCLASURE
- VISIBILITY
- SOUND
- STAIRS

SIZES
- BUSHOLES
- STAIRS

SIZE OF CR
OPEN CR

The collage consists of eight photographs of school interiors, each with handwritten notes and colored dots (green and red) marking specific features:

- Top Left:** A photograph of a school cafeteria with a large sign that reads "CAFETERIA". Handwritten notes include "- WINDOW" and "- WAYFARING".
- Top Right:** A photograph of a gymnasium with a wooden floor and basketball hoops. Handwritten notes include "SOME ARE ACTIVISTS", "BENCHES", "EQUIPMENT", and "TOUCH".
- Middle Left:** A photograph of a library or study area with bookshelves, tables, and chairs. Handwritten notes include "- VARIETY OF FURNITURE".
- Middle Right:** A photograph of a large, modern interior space with a prominent staircase and large windows. Handwritten notes include "- COLORS", "TEXTURES", "HALLWAY", and "SIZE".
- Bottom Left (Top):** A photograph of a long, brightly lit hallway with a polished floor and large windows. Handwritten notes include "CAFETERIA" and "TABLE/SEATING".
- Bottom Left (Bottom):** A photograph of a large, open-plan space with a high ceiling and large windows. Handwritten notes include "CAFETERIA" and "TABLE/SEATING".
- Bottom Right (Top):** A photograph of a large, open-plan space with a high ceiling and large windows. Handwritten notes include "CAFETERIA" and "TABLE/SEATING".
- Bottom Right (Bottom):** A photograph of a classroom or study area with students sitting at tables, working on laptops. Handwritten notes include "CAFETERIA" and "TABLE/SEATING".

NOE Students

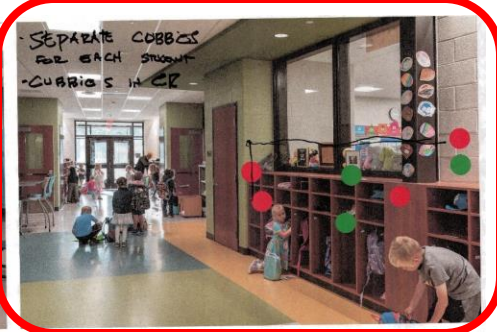

NOE Faculty

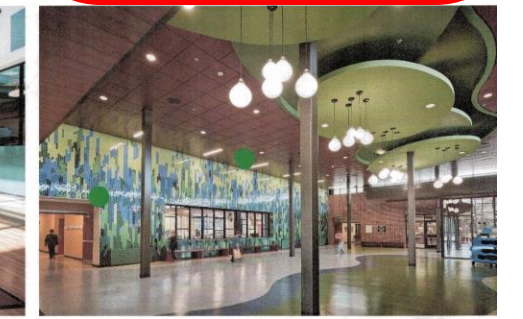
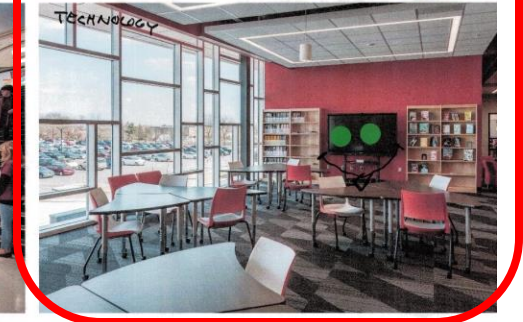
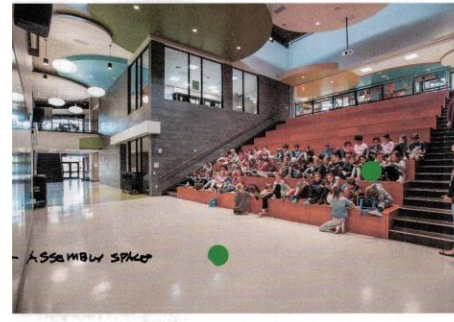
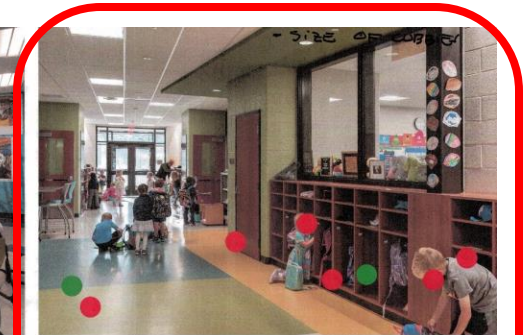

CTE Students



CTE Faculty



CTE Students

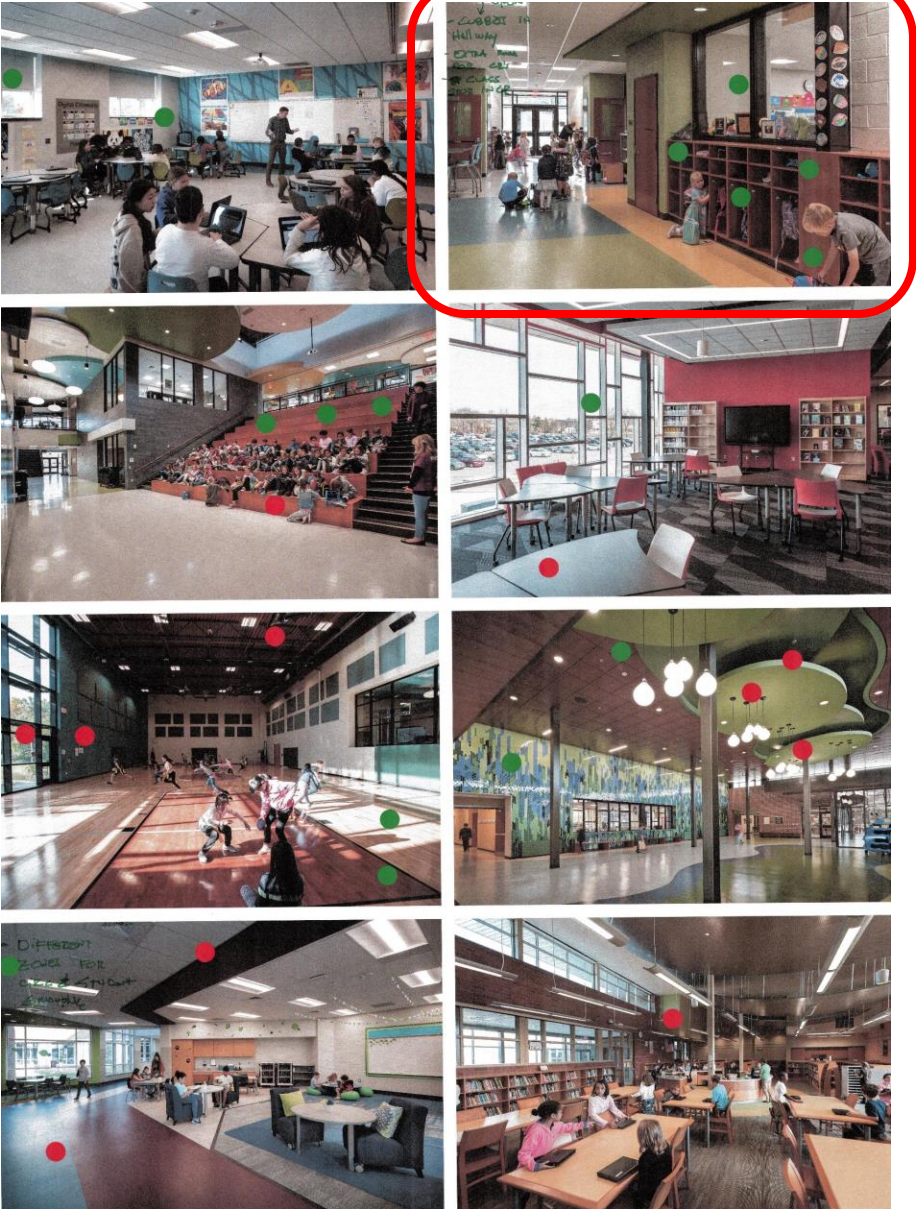

CTE Faculty

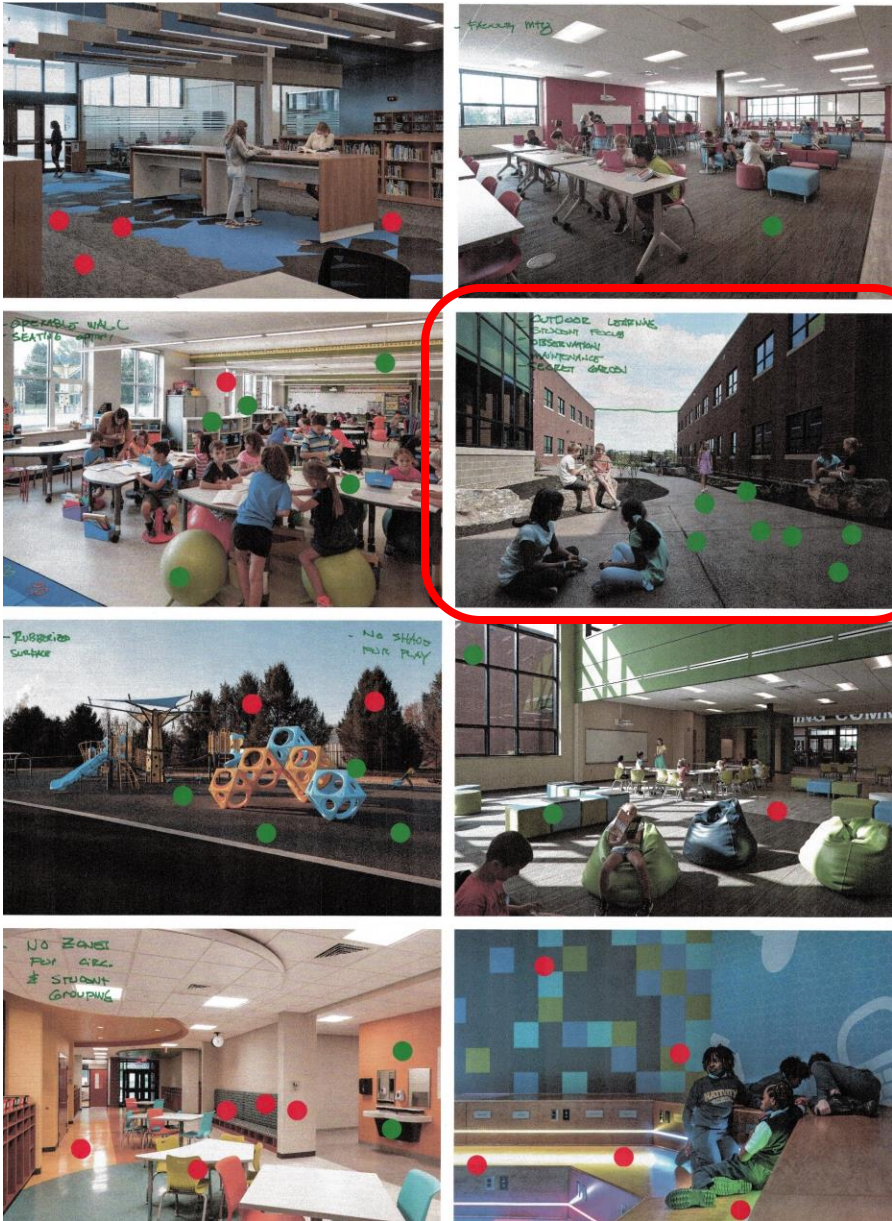



Conewago Township ES

Design Development

CTE – SITE PLAN

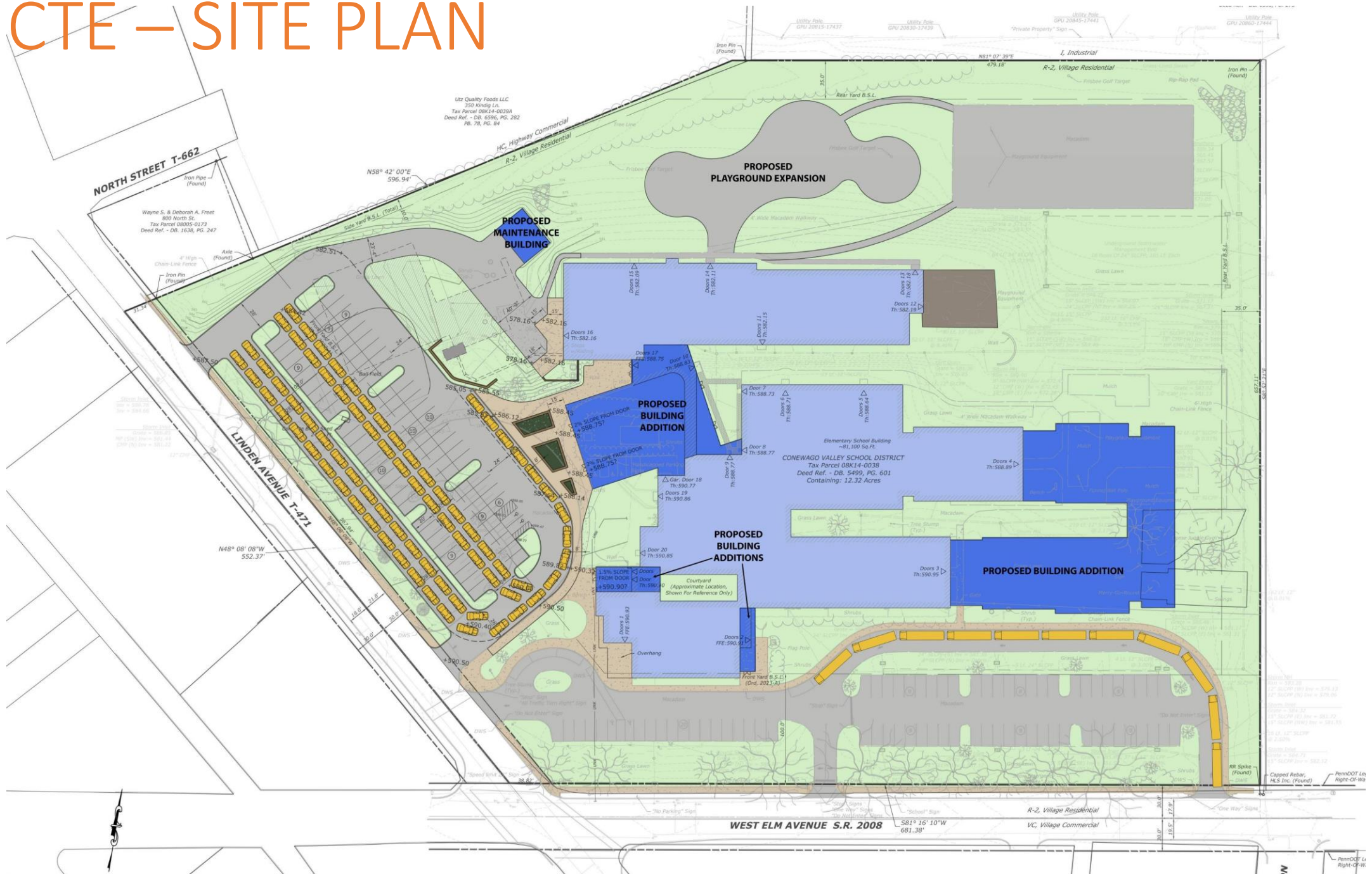

CTE – FLOOR PLAN

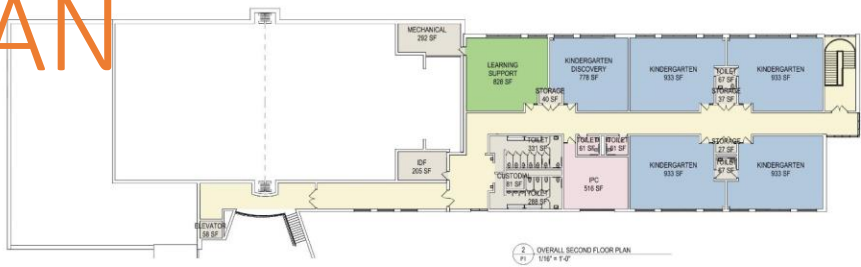

Floor Plan

- General Classrooms
- Special Education
- Small Group Instruction
- Music
- Art
- Library/Cafeteria/Gymnasium
- Faculty
- Building Support



INTERIOR DESIGN MEETINGS

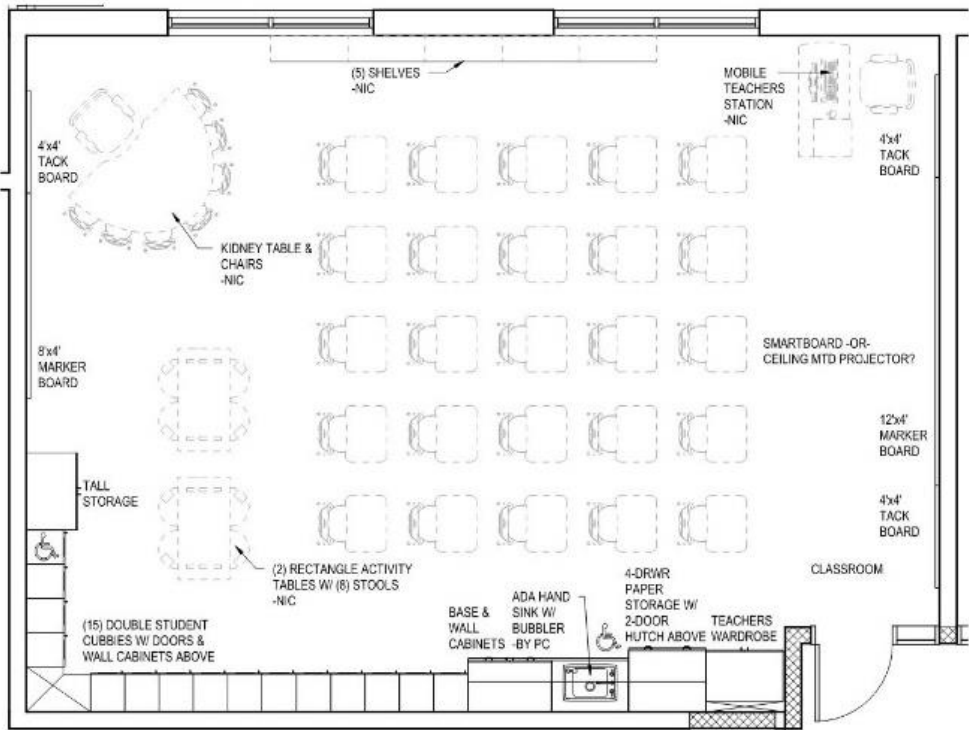

1
14.3
TYPICAL CLASSROOM
1/4" = 1'-0"

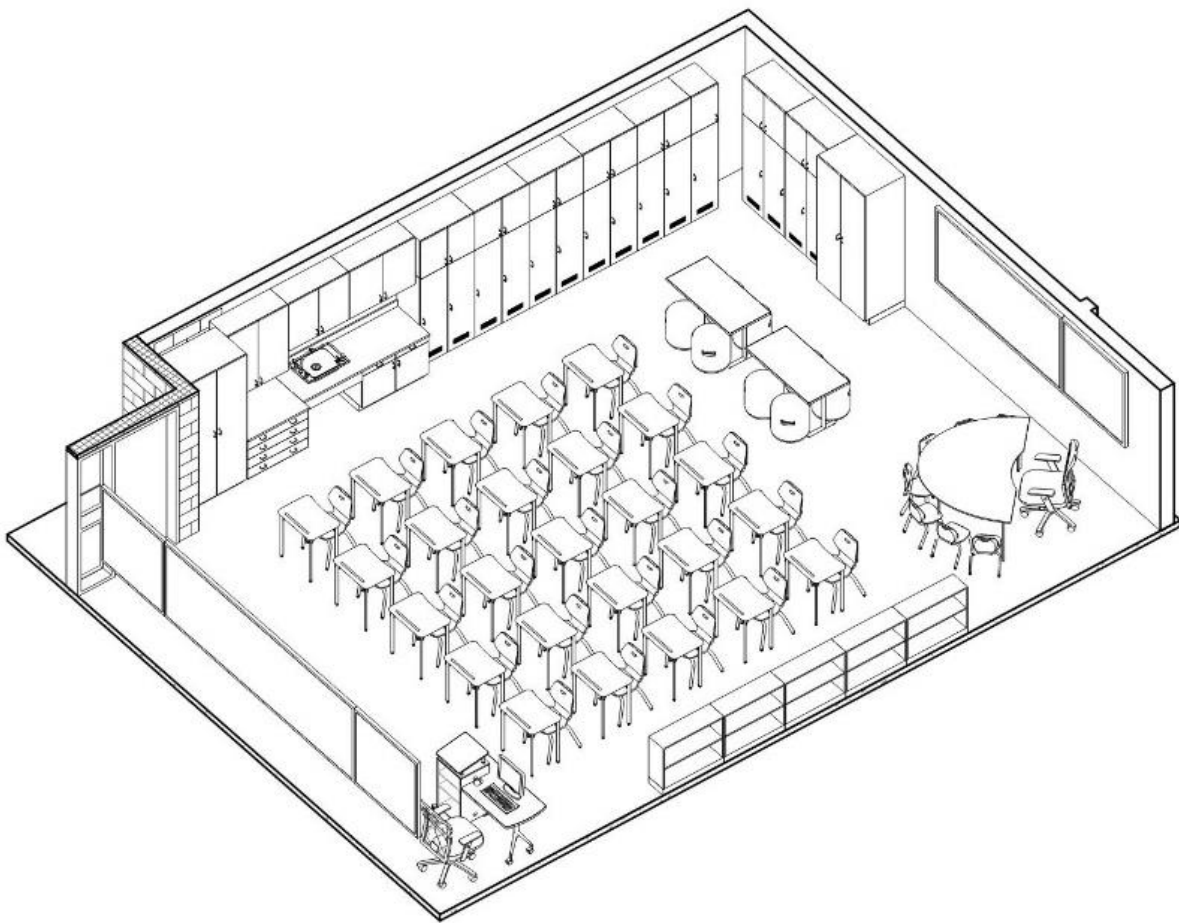

2
14.3
AXON-TYPICAL CLASSROOM

Draft Layout

Draft Layout

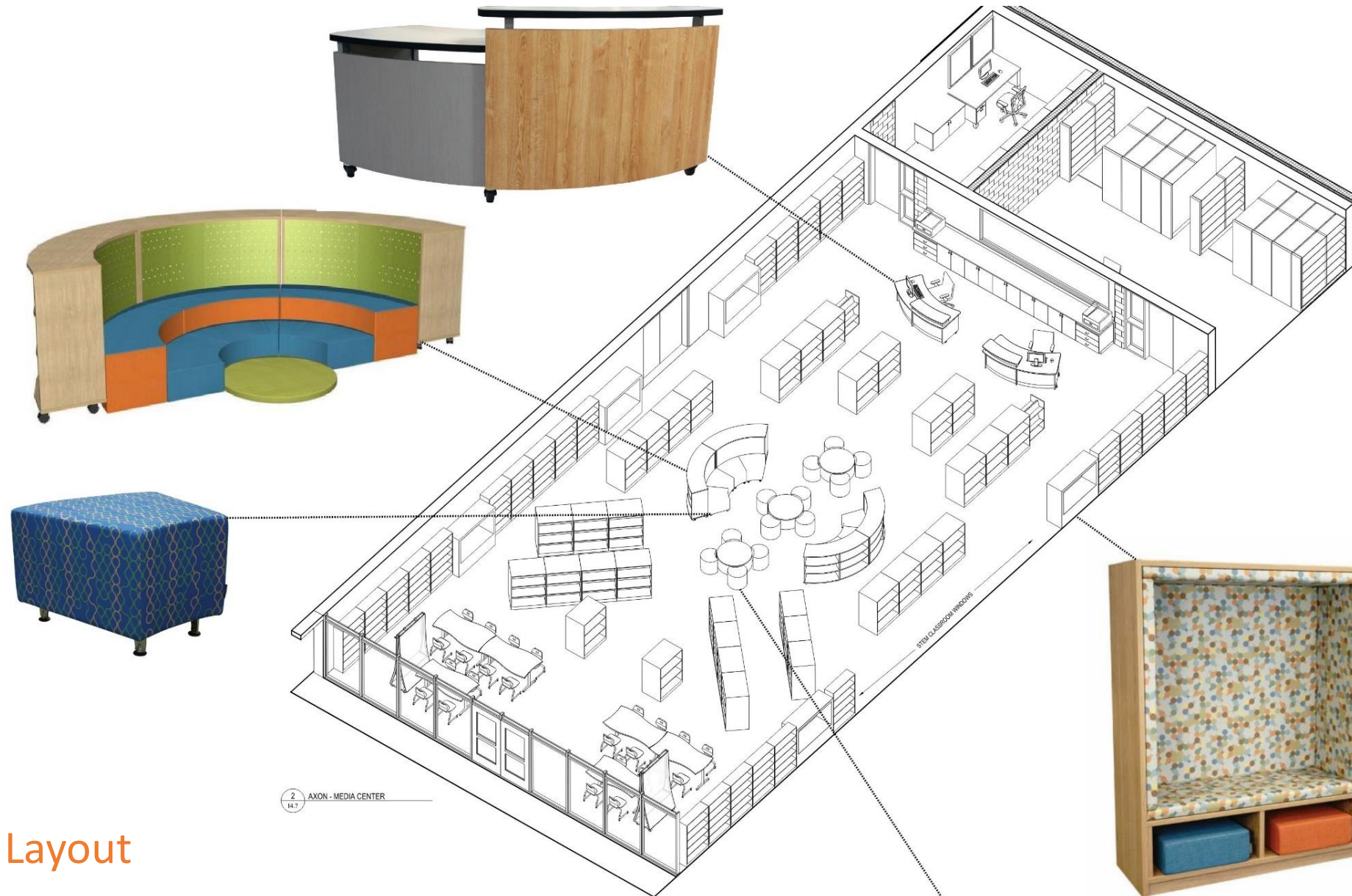



New Oxford ES

Schematic Design

NOE – SITE PLAN

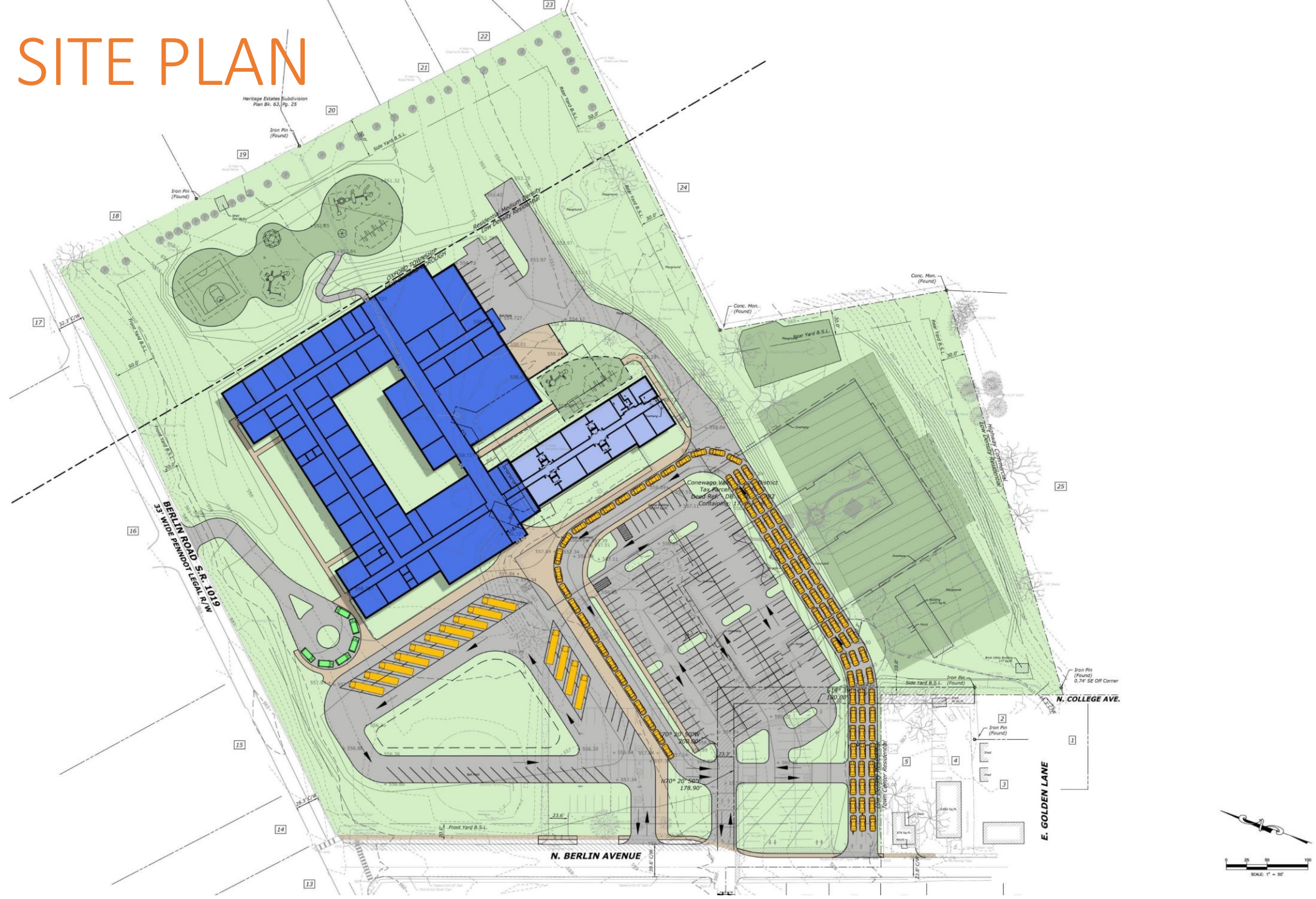

NOE – FLOOR PLAN

Floor Plan

- General Classrooms
- Special Education
- Small Group Instruction
- Music
- Art
- Library/Cafeteria/Gymnasium
- Faculty
- Building Support





Next Steps

Upcoming Tasks

NEXT STEPS

1. Civil Engineering due diligence: Traffic study, Geotech, Zoning requirements – on-going
2. Determine Municipal Approval timeline to determine Project Schedule - NOE
3. Expand Design Professional Team: Structural Engineers & Food Service Consultant - on-going
4. Interior Design Meetings with faculty - CTE

Questions?



Crabtree, Rohrbaugh & Associates
www.cra-architects.com