



Waco Independent School District

Waco High School Schematic Design Presentation

09.09.2021

Design Process

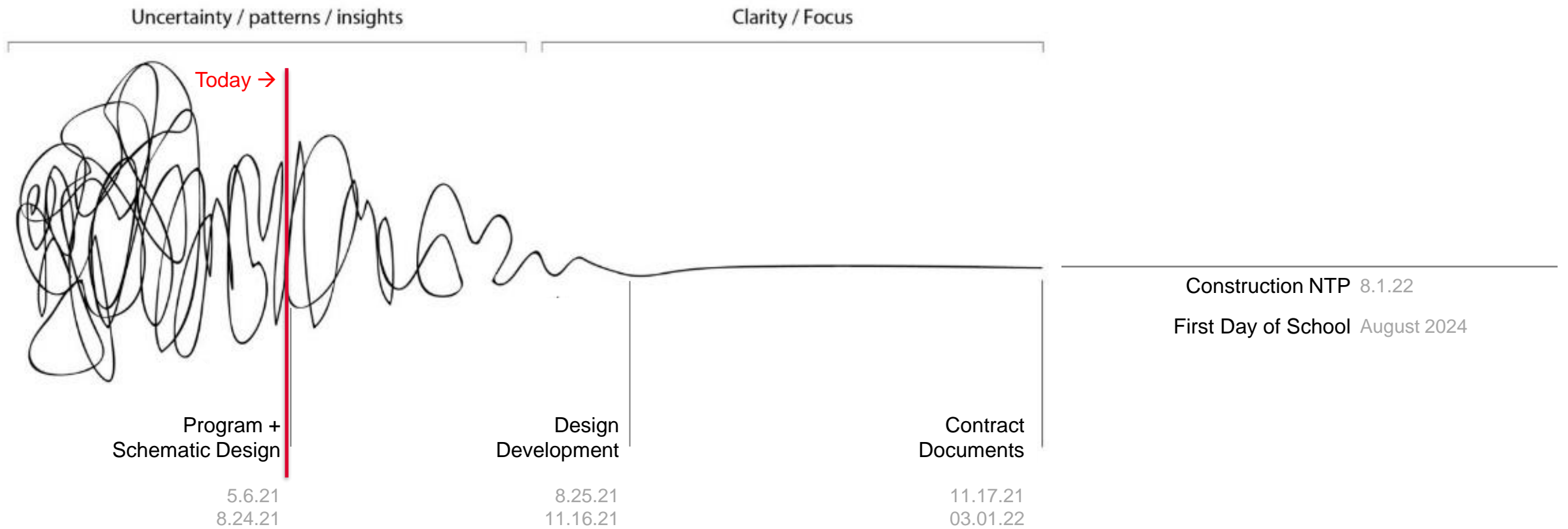

Note: New construction will be phased to accommodate operations of the existing facility. Refer to phasing slide for additional scope breakdown



Design Process To-Date

- 7 Design Committee Meetings
- 3 Rounds of User Group Meetings
- In-person campus tours
- Exterior & Interior Visioning Exercises
- Design Team Coordination Meetings
- Construction Manager Engagement and Feedback

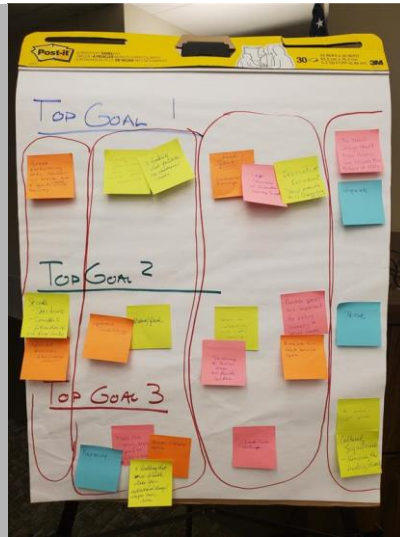

Site Development



Existing Site



With Paul Tyson Field Completed

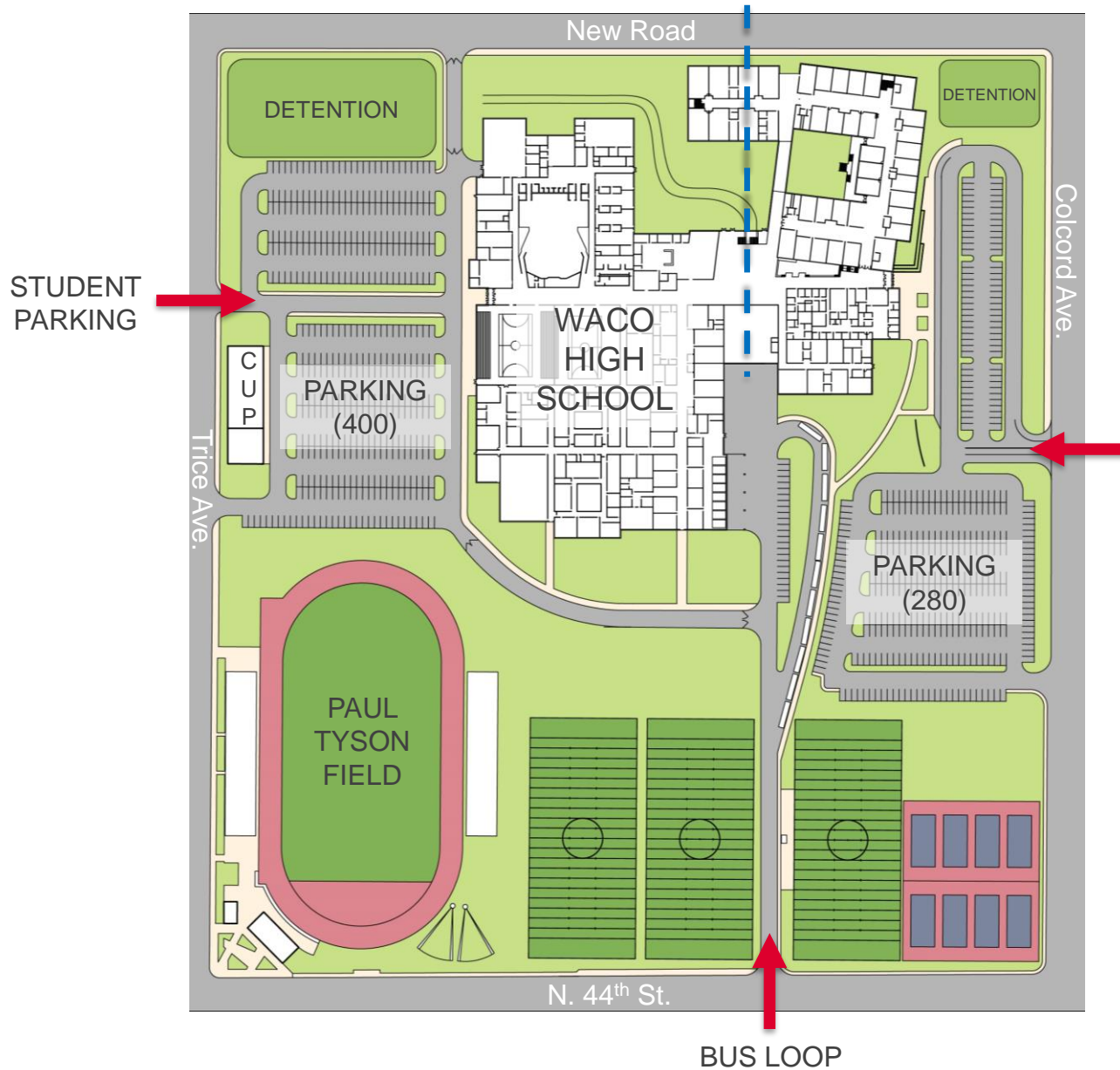

Tiered Courtyard: aligns lower floor of classrooms with New Road; aligns upper floor of classrooms with ground floor of single-story areas

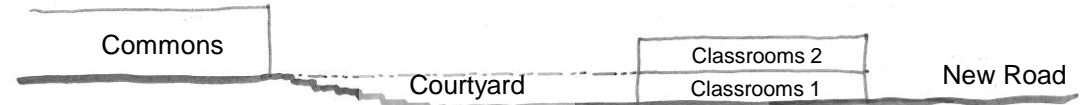

PARENT
DROP OFF

Site Design Considerations

- Closure of N. 42nd St.
- Single, contiguous campus property
- Protected pedestrian access to athletic fields
- Grading and detention areas

Program and Floor Plan

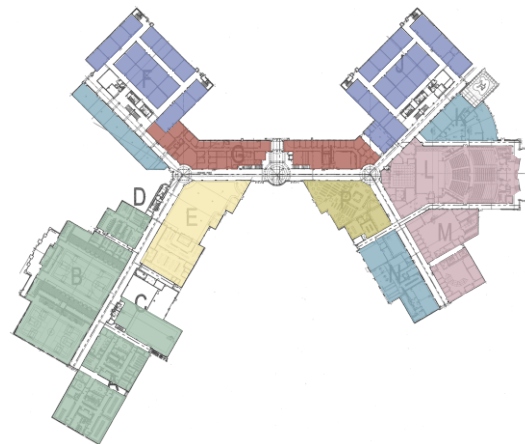
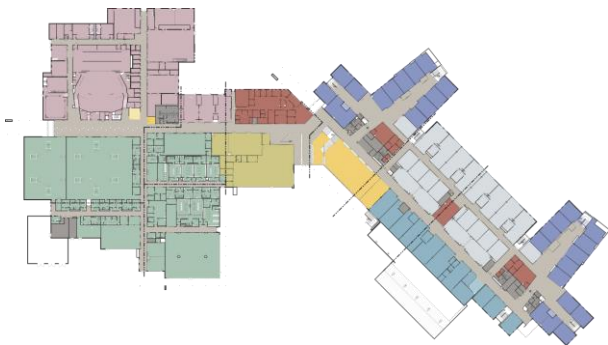

PLAN ORGANIZATION
CONCEPT EXAMPLES

Design Committee Initial Input and Key Goals:

- Co-locate athletics and performing arts to restrict **after-hours access** to one entry
- Academic Neighborhoods: **4 core curriculum** (with some special education resource spaces) + 1 science + 1 special education
- Library located in a **high-profile**, central location such as at the front door and/or **visible/accessible** from the general academic neighborhoods
- Dining + Food Service to be **dispersed** in learning neighborhoods

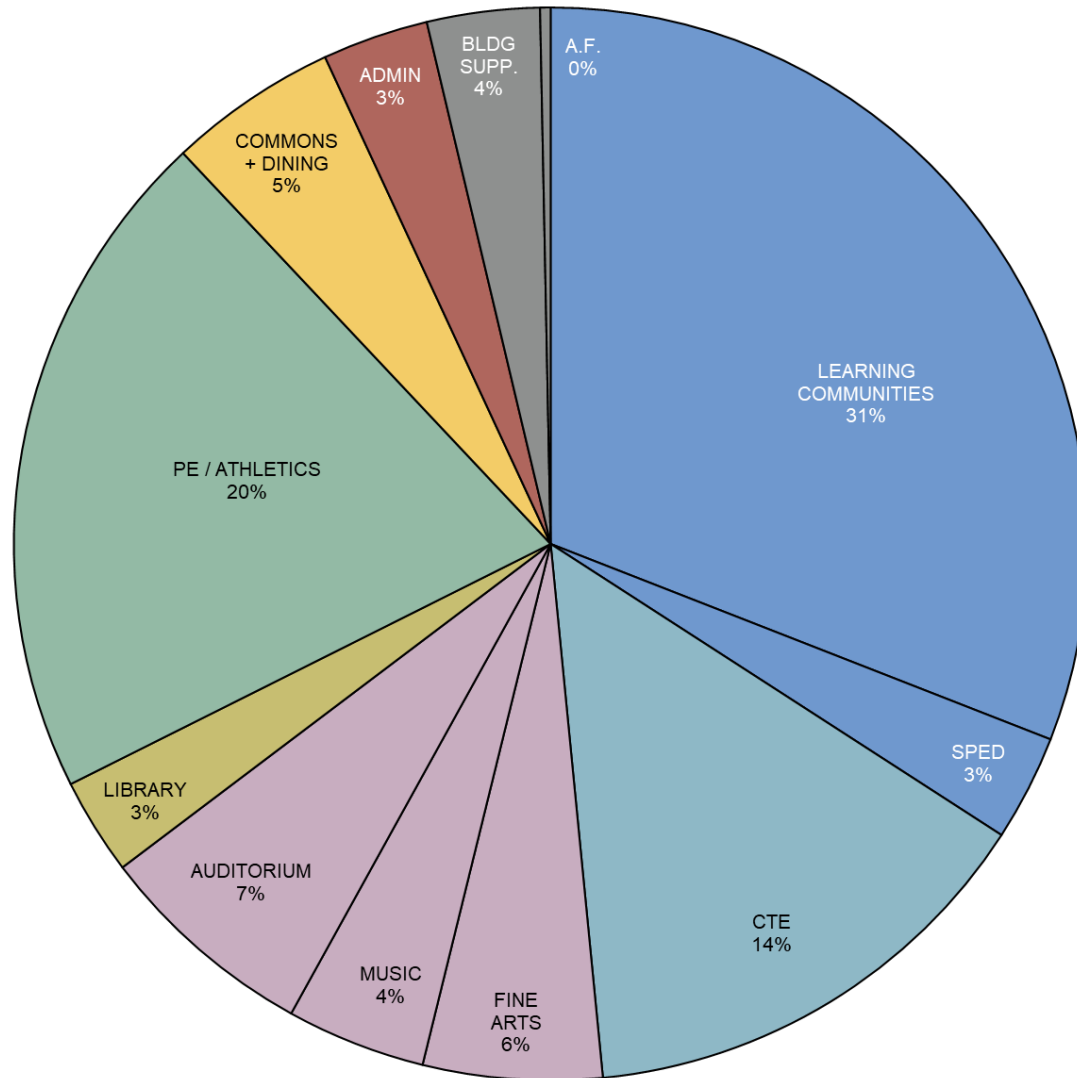

| | |
|-----------------------------|----------------|
| LEARNING COMMUNITIES | 85,760 |
| SPECIAL POPULATIONS | 8,860 |
| CTE SPACES | 39,690 |
| FINE + PERFORMING ARTS | 14,940 |
| MUSIC | 11,630 |
| AUDITORIUM | 18,480 |
| LIBRARY | 8,080 |
| P.E. / ATHLETICS | 56,495 |
| COMMONS + FOOD SERVICE | 14,150 |
| ADMINISTRATION | 8,860 |
| BUILDING SUPPORT | 9,410 |
| ANCILLARY FACILITIES | 872 |
| MAIN BUILDING SUBTOTAL | 277,227 |
| CIRCULATION/WALLS/RESTROOMS | 93,961 |
| TOTAL | 371,187 |

Structural

- a. Foundation likely to be slab on grade with drilled piers
- b. Structural system likely to be steel framing with bar joists – currently verifying with Construction Manager at Risk based on current market conditions.
- c. Expansion joints (at yellow lines); may also be fire wall between building phases pending final construction type selection.

Mechanical, Electrical, Plumbing (MEP)

- a. Central utility plant (CUP) to be remotely located on site to reduce acoustical conflicts with adjacent educational space, and to provide for easier future connections.
- b. Basis of design for mechanical system is water-cooled chillers served by cooling towers located at the remote CUP.
- c. Existing gyms will need access to the existing central utility plant during phase 2 construction.
- d. New facility to have all roof-mounted air handlers. No anticipated mechanical mezzanines within the building.

Foodservice

- a. Primary kitchen near the commons to support four dedicated serving lines near the commons.
- b. Two remote kitchen/serving locations on the same level as the main kitchen for distributed serving and dining in the learning neighborhoods.
- c. Culinary arts commercial kitchen with adjacent café and serving room near after-hours entry.
- d. Coffee bar similar to University High School, directly accessible from Main Street. Highly visible and accessible for students entering in the morning.

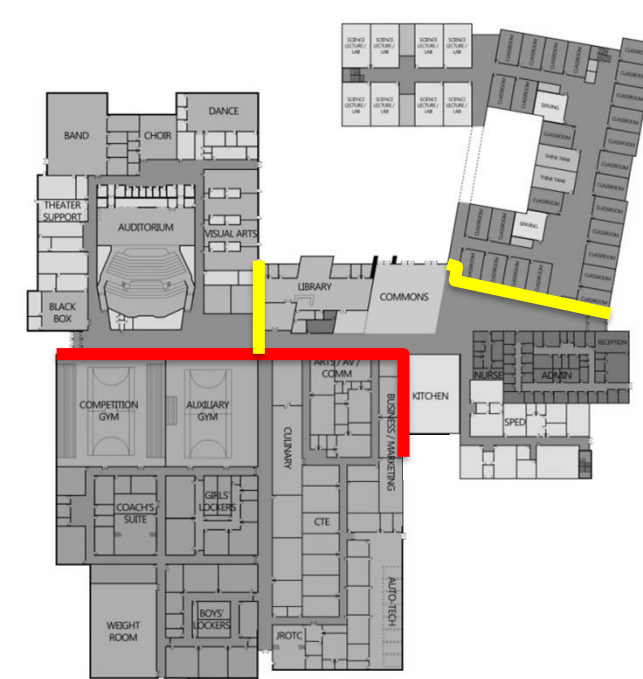

Phasing

Existing Campus

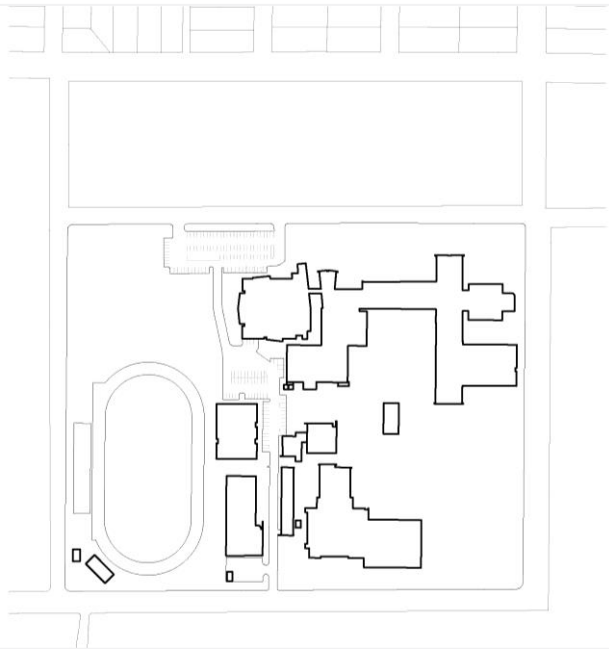

Phases 1 + 2

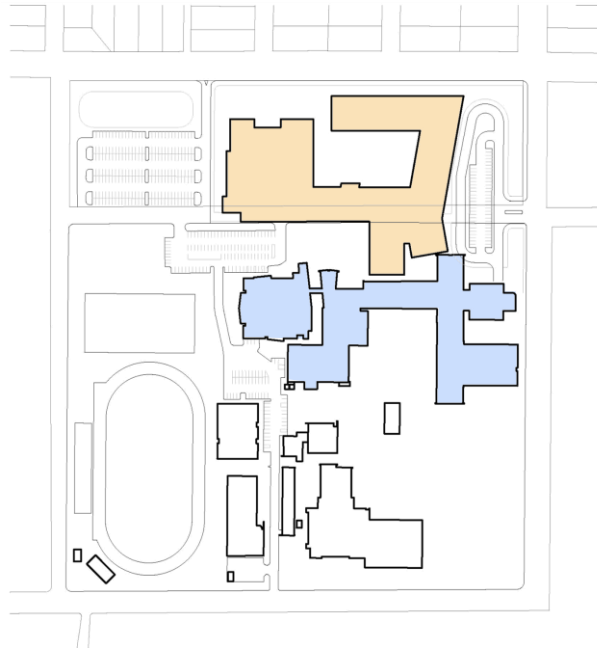

Phase 1

- August 2022 to May 2024 – 22 months
- Construction of +/- 65% of new facility

Phase 2

- June 2024 to December 2024 – 6 months
- Move into completed Phase 1 building
- Demolish existing classroom/aud. building

Phases 3 + 4



Phase 3

- January 2025 to June 2025 – 6 months
- Construction of +/- 35% of new facility

Phase 4

- July 2024 to December 2025 – 18 months
- Move into completed Phase 2 building
- Demolish existing ancillary buildings
- Complete site improvements

Completed Campus

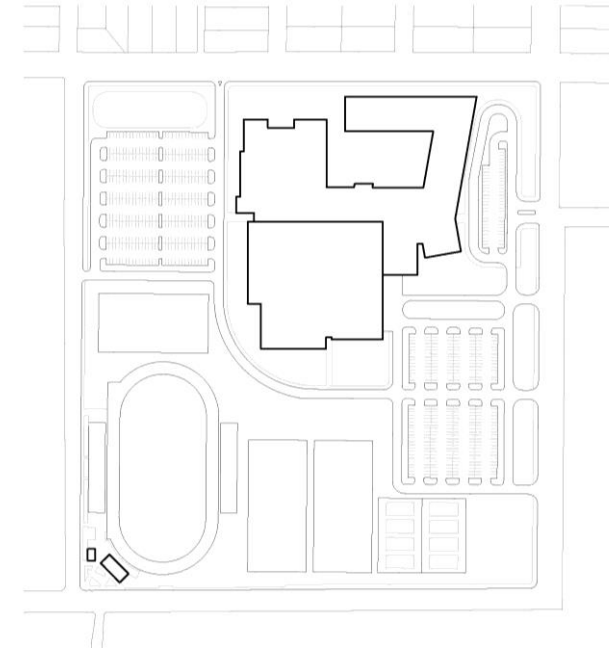

*Estimated dates based on initial concepts and
subject to change pending further development*

Exterior Design



Main Entry



After-Hours / Event Entry



Main Courtyard



Main Courtyard

Next Steps

- Schematic Design Approval
- 3rd Round User Group Meetings
- CMR Engagement + Constructability and Estimate Review
- Design Development (DD) Progress
- Monthly Design Committee Meetings through the DD phase.





Thank you!

**Waco Independent
School District**

Waco High School
Schematic Design Presentation

09.09.2021