

WCS CHROMEBOOK

Start-Up and Support



WCS Chromebook
Tips

WCS Chromebooks will be used for all student work in both online and remote environments. For tips for using your WCS Chromebook, please see the ClassLink Dashboard folder called **WCS Chromebook Tips**.

Connecting to Home WiFi

Before using your WCS Chromebook, you will need to connect to your home Wi-Fi network.

1. Select the **Wi-Fi icon** at the bottom right of the screen.
2. Select **Not Connected**.
3. Choose your desired **Wi-Fi network**.
4. Enter your home WiFi **password** and **Connect**.

ClassLink Dashboard

Students will be automatically directed to the ClassLink Dashboard after logging into the Chromebook with their WCS username and password. The ClassLink Dashboard will provide students access to online resources and support. When prompted to verify username and password, it is important to enter this information and **Submit**. Choosing **Cancel** may result in losing access to some applications.

Restarting

For applications to work properly, it is important to do a full restart at least daily. Closing the lid or choosing **Sign Out** is not the same as a full restart. To restart, open the **Quick Settings Panel** in the bottom right of your screen and select the **Power icon**.

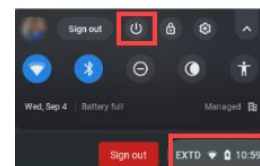

Student Username and Password

Parents and Guardians can access their student's username and password by logging into Skyward Family Access (<https://skyward.wcs.edu>) and going to the **Student Info tab**.

Software and Student Access Support

Students should access the **Help Desk app** on their ClassLink Dashboard.



Cleaning

To avoid damage, it is very important that you clean your Chromebook with recommended products **ONLY**. For detailed cleaning instructions, please refer to the **WCS Chromebook Tips folder** on the ClassLink Dashboard.