

# Lowell Elementary



## Welcome to 2024-2025 School Year

### **Our vision**

Preparing today's students to be the thinkers, leaders, and creators of tomorrow.

### **Our mission**

Uniting as one community, we elevate opportunities for all.

### **Websites**

SJUSD Website: <https://www.sjUSD.org/>

Lowell Website: <https://lowell.sjUSD.org/>

Dear Lowell Families,

I am delighted to welcome you to the 2024-2025 school year! If you are new to Lowell, welcome! If you are returning, welcome back! We have an amazing school where we live by the expectations: **Be Safe, Be Respectful, and Be Productive.**

We are excited to let you know about how we will support your student(s) this year. We know you have many questions, and we want to be sure to give you all the information you need. This digital mailer is just a starting point. We promise to keep you updated.

Please see the following documents included in this digital mailer:

- Lowell Bell Schedule
- Lowell Contact Sheet
- Lowell FAQs
- District Instructional Calendar

The staff and I are excited to begin the new school year on **Thursday, August 8th at 8:55am.** We look forward to supporting all of our students in their academic growth, and building a strong partnership with all of our families.

Sincerely,

Katherine Powell  
Lowell Elementary Principal  
kpowell@sjusd.org



# Lowell Bell Schedule

Monday - Friday

Grade	Starting Bell	Recess	Lunch	Dismissal
TK	8:55	9:50-10:10	11:20-12:00	2:50
K-1	8:55	10:10-10:30	12:00 - 12:40	2:50
2-3			12:25-1:05	
4-5		10:45 - 11:00	12:55-1:30	

ELD : K-3 : 11:15 -12:00

ELD 4-5 11:00-11:45



## Lowell Contact Sheet

Lowell Elementary | 625 S. 7th St., San Jose, CA 95112 | office (408)535-6243 | fax (408)298-3708

Name	Position	Email Address	Ext.
Katherine Powell*	Principal	kpowell@sjusd.org	35110
Destiny Vigil*	Counselor	dvigil@sjusd.org	35110
Veronica Alvarado*	Secretary	valvarado@sjusd.org	35110
Karla Maldonado*	Attendance	kmaldonado@sjusd.org	35111
Leonor Magallon de Tavares*	Parent Liaison	lmagallondetavare@sjusd.org	35116
Antonieta Acosta *	Health Clerk	aacosta@sjusd.org	35112

<b>Student Attendance Line</b>	-	<b>(408)535-6454</b>	<b>35002</b>
--------------------------------	---	----------------------	--------------

\*Bilingual Staff



## Lowell is a Uniform school

**Top:** Polo: Hunter green, navy blue, white or any Lowell sponsored T-Shirt

**Bottom:** Navy pants, short, skirt or dress (with polo under)



# Lowell Frequently Asked Questions



## **What is the uniform? Is it required daily?**

Yes - all students at Lowell are required to wear a uniform. Our uniform is as follows:

Top: Polo: Hunter green, navy blue, white or any Lowell sponsored T-Shirt

Bottom: Navy pants, short or skirt. We do have monthly spirit days where students can dress up according to theme days.

## **Can I volunteer in my child's classroom?**

Please complete the Volunteer Application [here](#). In addition to the Volunteer Application, volunteers must be fingerprinted and submit a completed tuberculosis (TB) clearance.

## **What is the earliest I can drop off my child?**

Earliest drop off is 8:25am. We do not have childcare available until then.

## **Where do I drop off my child(ren)?**

Drop off will be on 6th street and 7th street gates. Reed St. will be closed for now. If you are walking please use 7th street gate, if you are dropping off by car please use 6th street. This will allow traffic for parents dropping off students to flow smoothly. In addition it will keep families walking safe. [PLEASE SEE ATTACHED MAP]

## **How will I find out who my child(ren)'s teacher is?**

Class lists will be posted on campus on Wednesday, August 7th at 4pm. We will not honor any teacher requests or change any student. Our teachers have worked hard to group students.

## **How much is brunch & lunch?**

Brunch and lunch is free to all students, no application needed. Students can eat breakfast starting at 8:25 - 8:45 or during their brunch. If you choose to send your child with food, please send healthy foods. Do not send junk food, candy or soda.



## **Can my child bring a cellphone to school?**

We prefer cellphones to stay at home. If your child needs to get in touch with you, we are more than happy to let them use the office phone. We are not responsible for any damage or stolen cell phones.



## **What school supplies do I need?**

San José Unified provides all of the basic supplies for our students. If you wish to

donate anything you can contact your teacher.

### **When is Back to School Night?**

Back to School Night is Tuesday, August 27, 2024 @ 5:30pm. This is an event for parents to get to know their teachers and ask questions. We will meet in the quad, and then you will be dismissed.



### **How can I stay connected or be involved in my child's education?**



San José Unified believes that family engagement is an essential component in the educational success of students. We are committed to establishing a positive, collaborative relationship with every family. Lowell teachers and staff communicate with families through ParentSquare messages. Please download the app to stay connected. We also host monthly Principal's Coffees to share important information.

In addition all schools have a School Site Council (SSC). SSC is responsible for recommending the proposed Single Plan for Student Achievement (SPSA) to the Board of Education for approval. The SPSA outlines the school's instructional program and how it works to improve student achievement. It also ties the school's funding/expenditures to student needs, please contact Leonor Magallon de Tavares (Parent Liaison) for more information.



# SITE MAP

# LOWELL ELEMENTARY SCHOOL

625 SOUTH 7th STREET,  
SAN JOSE, CA 95112

## South 7th STREET

If you walk to school, for your safety use 7th street entrance/ Si caminas a la escuela, por tu seguridad, usa la entrada de la calle 7

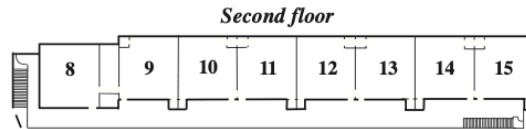

## first floor

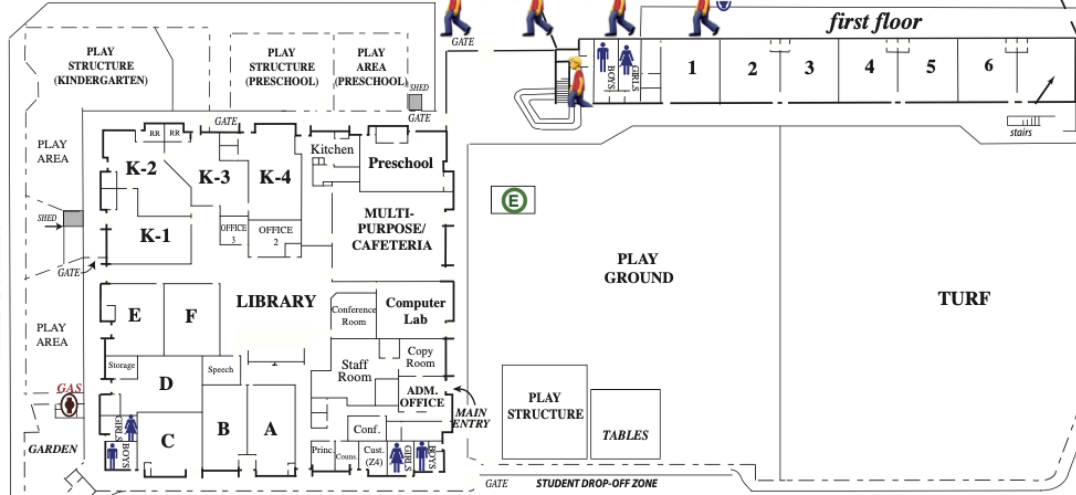

CAR DROP OFF ONLY on 6th Street/ SOLO PARA DEJAR A ESTUDIANTES EN COCHE en la calle 6

If you are walking to school, use 7th street entrance/ Si va caminando a la escuela, use la entrada de la calle 7

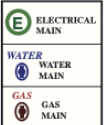

Concept  
EHS Services®

## SOUTH 6th STREET



NOVEMBER  
2010

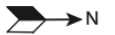



## 2024-2025 Student Calendar

### July 2024

Su	M	Tu	W	Th	F	Sa
	1	2	3	<del>4</del>	5	6
7	8	9	10	11	12	13
14	15	16	17	18	19	20
21	22	23	24	25	26	27
28	29	30	31			

### August 2024

Su	M	Tu	W	Th	F	Sa
				1	2	3
4	5	6	7	8	9	10
11	12	13	14	15	16	17
18	19	20	21	22	23	24
25	26	27	28	29	30	31

### September 2024

Su	M	Tu	W	Th	F	Sa
1	<del>2</del>	3	4	5	6	7
8	9	10	11	12	13	14
15	16	17	18	19	20	21
22	23	24	25	26	27	28
29	30					

### October 2024

Su	M	Tu	W	Th	F	Sa
		1	2	3	4	5
6	7	8	9	10	11	12
13	14	15	16	17	18	19
20	21	22	23	24	25	26
27	28	29	30	31		

### November 2024

Su	M	Tu	W	Th	F	Sa
					1	2
3	4	5	6	7	8	9
10	<del>11</del>	12	13	14	15	16
17	18	19	20	21	22	23
24	25	26	27	28	29	30

### December 2024

Su	M	Tu	W	Th	F	Sa
1	2	3	4	5	6	7
8	9	10	11	12	13	14
15	16	17	18	19	20	21
22	23	24	25	26	27	28
29	30	31				

### January 2025

Su	M	Tu	W	Th	F	Sa
			<del>1</del>	2	3	4
5	6	7	8	9	10	11
12	13	14	15	16	17	18
19	<del>20</del>	21	22	23	24	25
26	27	28	29	30	31	

### February 2025

Su	M	Tu	W	Th	F	Sa
						1
2	3	4	5	6	7	8
9	10	11	12	13	14	15
16	<del>17</del>	<del>18</del>	<del>19</del>	<del>20</del>	<del>21</del>	22
23	24	25	26	27	28	

### March 2025

Su	M	Tu	W	Th	F	Sa
						1
2	3	4	5	6	7	8
9	10	11	12	13	14	15
16	17	18	19	20	21	22
23	24	25	26	27	28	29
30	31					

### April 2025

Su	M	Tu	W	Th	F	Sa
		1	2	3	4	5
6	7	8	9	10	11	12
13	14	15	16	17	18	19
20	21	22	23	24	25	26
27	28	29	30			

### May 2025

Su	M	Tu	W	Th	F	Sa
				1	2	3
4	5	6	7	8	9	10
11	12	13	14	15	16	17
18	19	20	21	22	23	24
25	<del>26</del>	27	28	29	30	31







### June 2025

Su	M	Tu	W	Th	F	Sa
1	2	3	4	5	6	7
8	9	10	11	12	13	14
15	16	17	18	<del>19</del>	20	21
22	23	24	25	26	27	28
29	30					

## Important Dates for Students

8 August	First day of regular school year
30 September to 4 October	Fall recess
12-15 November	Elementary schools out 2 hours early
27-29 November	Thanksgiving recess
17-19 December	Secondary schools out 2 hours early
20 December	All schools out 2 hours early
23 December to 3 January	New Year recess
17-21 February	Winter recess
13-14 March	Elementary schools out 2 hours early
7-11 April	Spring recess
27-29 May	Secondary schools out 2 hours early
28-29 May	High school graduation ceremonies
30 May	All schools out 2 hours early
30 May	Last day of regular school year
2-27 June	Optional extended school year window

## Key to Calendar Notations

	= Regular student day for all schools
	= Shortened student day for elementary schools
	= Shortened student day for secondary schools
	= Shortened student day for all schools
	= Non-student day during regular school year
	= No student activities at all schools due to holiday
	= Optional extended school year for some students

