

# SETUP - WINDOWS BASIC KEYBOARD MODE

## Windows

In this mode the barcode reader functions and communicates similar to a keyboard. Therefore, barcode reader will work with Notes, and any other application that support an active cursor.

1. Turn Bluetooth on for your device. Go to Settings > Bluetooth. A Bluetooth Devices search will begin.
2. Scan barcode below.



#FNB00F40001#

3. Tap Socket S7XX[xxxxxx] in the list of Devices found. After a few seconds the status will change to "Connected" or "Paired" and the barcode reader blue light will stop blinking and turn solid blue.

***Now you are ready to scan barcodes!***

## PAIRING RESET

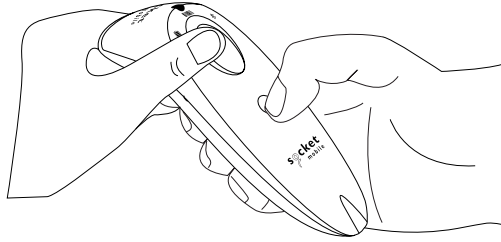

*This procedure will put the barcode reader in discoverable mode.*

**i** If the barcode reader is paired with a device, unpair it before trying to connect to a different device.

Step 1: Remove or forget the barcode reader from the Bluetooth list on the host device.

Step 2: Scan Pairing Reset barcode.

*(Note: For the S730 laser barcode reader. Print the barcode to scan).*



Or, follow the Pairing Reset button sequence:

1. Power on the barcode reader.
2. Press the trigger button then power button and hold both until you hear 3 beeps.

The barcode reader will unpair and automatically power off. The next time you power on the barcode reader, it will be discoverable.

**!** **Important:** Both steps above must be done to complete the unpairing.

# FACTORY RESET

Configures the barcode reader to factory defaults. The barcode reader powers off after scanning this barcode.



**Or, follow the Factory Reset button sequence:**

1. Power ON the barcode reader.



2. Press and hold the scan button.



3. Tap the power button once while continuing to press the scan button.

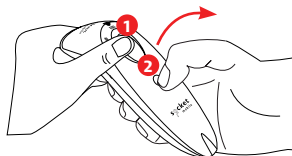

**QUICKLY PRESS AND RELEASE  
THE POWER BUTTON**

4. Keep holding the trigger button until you hear a beep (about 15 seconds).

When you release the scan button you will hear 5 confirmation beeps then the barcode reader will power off.

**Note: If you follow this sequence but release the trigger button too early (before 15 seconds and the beep) the Factory Reset will fail.**