

July 22, 2021

Mr. Eric Hamilton
Edina Public Schools
5701 Normandale Road
Edina, MN 55424



**RE: Edina High School
Lead-in-Water First Draw Testing
IEA Project #202110415**

Dear Mr. Hamilton:

At the request of Edina Public Schools, IEA collected 96 water samples from identified potable water sources on May 26, 2021, for lead analyses from Edina High School.

The purpose of the sampling is to document lead content in the sampled locations and compare to 20 parts per billion (ppb) the level at which the Minnesota Department of Health (MDH) recommends taking the fixture out of service to complete follow-up actions.

INTRODUCTION

Minnesota Statute 121A.335 requires public school buildings serving pre-kindergarten through grade 12 to test for lead in potable water fixtures every five years. The *3Ts for Reducing Lead in Drinking Water Toolkit (2018)* and the Lead Contamination Control Act (LCCA) of 1988 were created by the Environmental Protection Agency (EPA) to identify and reduce lead in drinking water. Lead is a metal that usually enters drinking water through the distribution system, including pipes, solder, faucets, and valves. Lead content in water may increase when the water is allowed to sit undisturbed in the system. Exposure to lead is a health concern.

The EPA recommends taking action when elevated lead levels are noted in water fixtures. The MDH and MDE recommend taking a fixture out of service if levels are 20 ppb or higher. The MDH and MDE also recommend taking action according to their guidelines for fixtures with levels of 2 ppb or higher.

METHODOLOGY

IEA collected 96 first-draw (unless otherwise noted) samples of approximately 250 milliliters (ml) of water. "First draw" means the samples are collected before the fixture is used or flushed during the day. The first-draw sample results reflect a worst-case scenario, i.e., the highest lead level that would be consumed by building occupants. MDH recommends fixtures not be used 6 to 18 hours prior to sampling fixtures.

INSTITUTE FOR ENVIRONMENTAL ASSESSMENT, INC.
www.ieasafety.com

BROOKLYN PARK
9201 West Broadway, #600
Brooklyn Park, MN 55445
763-315-7900 / FAX 763-315-7920
800-233-9513

MANKATO
610 North Riverfront Drive
Mankato, MN 56001
507-345-8818 / FAX 507-345-5301
800-233-9513

ROCHESTER
210 Woodlake Drive SE
Rochester, MN 55904
507-281-6664 / FAX 507-281-6695
800-233-9513

BRAINERD
601 NW 5th Street, Ste. #4
Brainerd, MN 56401
218-454-0703 / FAX 218-454-0703
800-233-9513

MARSHALL
1420 East College Drive
Marshall, MN 56258
507-476-3599 / FAX 507-537-6985
800-233-9513

VIRGINIA
5525 Emerald Avenue
Mountain Iron, MN 55768
218-410-9521
800-233-9513

Water samples were analyzed by Minnesota Valley Testing Laboratories (MVTl) in New Ulm, Minnesota, which uses EPA-approved analytical methods and quality control/assurance procedures. Samples were analyzed using the ICP/MS EPA Method 200.8.

RESULTS & DISCUSSION

The lead-in-water sampling results ranged from below the level of detection (<0.5 ppb) to 148 ppb. There are two (2) sample results greater than the district designated level of 20 ppb. See *Table 1: Water Testing Results Exceeding 20 ppb* and *Table 2: Water Testing Results Approaching 20 ppb*.

Follow up samples were taken after the initial results for three (3) of the four (4) fixtures noted. Due to the COVID-19 pandemic, some of the fixtures were used less frequently. The District flushed the fixtures two days before the sampling to ‘mock’ one weekend without use.

The laboratory report is provided in Appendix A. Laboratory results are reported in micrograms per liter (µg/L) which is equivalent to ppb.

Table 1: Lead-in-Water Testing Results Exceeding 20 ppb and Follow-up

Sample Number	Edina High School Sampling Location	Fixture Type	Lead Results (ppb) May 26, 2021	Lead Results (ppb) July 9, 2021
05262021HS-2	E240 Kitchen – Kitchen Sink 2	Faucet	30.4	Labeled Hand Sink
05262021HS-13	Kitchen – Steam Kettle 1	Faucet	148	5.48

ppb – parts per billion

Table 2: Lead-in-Water Testing Results Approaching 20 ppb and Follow-up

Sample Number	Edina High School Sampling Location	Fixture Type	Lead Results (ppb) May 26, 2021	Lead Results (ppb) July 9, 2021
05262021HS-2	Kitchen Sprayer 2	Sprayer	15.3	2.39
05262021HS-13	By Room S360 Sink H	Faucet	9.57	5.48

ppb – parts per billion

RECOMMENDATIONS

Sampled fixtures showed lead levels below the 20 ppb. Based on the sample results no further action is required at this time.

The EPA and MDH recommend flushing fixtures after extended breaks such as summer break, winter holiday breaks, or extended periods of no use.

The MDH recommends labeling any water fixtures not included in the sampling program, including bathroom taps, hose bibbs, laboratory faucets/sinks, or custodial closet sinks.

It is recommended that a copy of the district's Lead in Water Testing Report be made available to staff and the public through the district's administrative offices. Per Minnesota Statutes, section 121A.335, a school district that has tested its buildings for the presence of lead shall make the results of the testing available to the public for review and must notify parents of the availability of the information.

GENERAL CONDITIONS

The analysis and opinions expressed in this report are based upon data obtained from the district at the indicated locations. This report does not reflect variations in conditions that may occur across the site, property, or facility. Actual conditions may vary and may not become evident without further assessment.

The report is prepared for the exclusive use of our client for specific application to the project discussed and has been prepared in accordance with generally accepted environmental, health and safety practices. Other than as provided in the preceding sentence and in our Proposal #9692 dated May 6, 2021, regarding lead-in-water sampling at district locations, including the General Conditions attached thereto, no warranties are extended or made.

Please contact IEA if you would like assistance with any of the above recommendations or have questions regarding this report.

Sincerely,

IEA, Inc.

Reviewed by:



Mary Ferrian, CSP
EHS Division Manager



Karen Weiblen
EHS Consultant

MF/wb 072121

Enc.

Appendix A

Laboratory Testing Report



MINNESOTA VALLEY TESTING LABORATORIES, INC.

1126 North Front St. ~ New Ulm, MN 56073 ~ 800-782-3557 ~ Fax 507-359-2890
2616 East Broadway Ave. ~ Bismarck, ND 58501 ~ 800-279-6885 ~ Fax 701-258-9724
1201 Lincoln Hwy. ~ Nevada, IA 50201 ~ 800-362-0855 ~ Fax 515-382-3885
www.mvtl.com



Report Date: 14 Jun 2021

HEIDI SOLBERG
IEA/BROOKLYN PARK
9201 W BDWY STE #600
BROOKLYN PARK MN 55445

Work Order #: 12-9988
Account #: 002190
Purchase Order #: 202110415
Date Received: 26 May 2021
Date Sampled: 26 May 2021
Temperature at Receipt: 19.7C

PROJECT NAME: EDINA PUBLIC SCHOOLS
PROJECT NUMBER: 202110415

LAB NUMBER	SAMPLE DESCRIPTION	LEAD RESULTS	MCL	DATE ANALYZED	ANALYST
21-A25330	05262021HS-1 E240 KITCHEN-KITCHEN SINK 1	2.89 ug/L	15.0	1 Jun 21	RMV
21-A25331	05262021HS-2 E240 KITCHEN-KITCHEN SINK 2	30.4 ug/L	15.0	10 Jun 21	RMV
21-A25332	05262021HS-3 E240 KITCHEN-KITCHEN SINK 3 Comments: NO SAMPLE	5.99 ug/L	15.0	1 Jun 21	RMV
21-A25334	05262021HS-8 KITCHEN-KITCHEN SINK 5	< 0.5 ug/L	15.0	1 Jun 21	RMV
21-A25335	05262021HS-9 KITCHEN-KITCHEN SINK 6	1.18 ug/L	15.0	1 Jun 21	RMV
21-A25336	05262021HS-10 KITCHEN-KITCHEN SINK 7	0.79 ug/L	15.0	1 Jun 21	RMV
21-A25337	05262021HS-13 KITCHEN-STEAM KETTLE 1 ~Sample diluted due to result above calibration or linear range.	148 ~ ug/L	15.0	9 Jun 21	RMV
21-A25338	05262021HS-14 KITCHEN-STEAM KETTLE 2	0.65 ug/L	15.0	1 Jun 21	RMV

Approved by:

Dan O'Connell

David Smahel

Chemistry Laboratory Managers New Ulm, MN

Analyses performed under our Minnesota Department of Health Accreditation conform to the current TNI standards.

The reporting limit was elevated for any analyte requiring a dilution as coded below:

@ = Due to sample matrix

= Due to concentration of other analytes

! = Due to sample quantity

+ = Due to internal standard response

CERTIFICATION: MN LAB # 027-015-125 ND WW/DW # R-040

MVTL guarantees the accuracy of the analysis done on the sample submitted for testing. It is not possible for MVTL to guarantee that a test result obtained on a particular sample will be the same on any other sample unless all conditions affecting the sample are the same, including sampling by MVTL. As a mutual protection to clients, the public and ourselves, all reports are submitted as the confidential property of clients, and authorization for publication of statements, conclusions or extracts from or regarding our reports is reserved pending our written approval.



MINNESOTA VALLEY TESTING LABORATORIES, INC.

1126 North Front St. ~ New Ulm, MN 56073 ~ 800-782-3557 ~ Fax 507-359-2890
2616 East Broadway Ave. ~ Bismarck, ND 58501 ~ 800-279-6885 ~ Fax 701-258-9724
1201 Lincoln Hwy. ~ Nevada, IA 50201 ~ 800-362-0855 ~ Fax 515-382-3885
www.mvtl.com



Report Date: 14 Jun 2021

HEIDI SOLBERG
IEA/BROOKLYN PARK
9201 W BDWY STE #600
BROOKLYN PARK MN 55445

Work Order #: 12-9988
Account #: 002190
Purchase Order #: 202110415

Date Received: 26 May 2021
Date Sampled: 26 May 2021
Temperature at Receipt: 19.7C

PROJECT NAME: EDINA PUBLIC SCHOOLS
PROJECT NUMBER: 202110415

LAB NUMBER	SAMPLE DESCRIPTION	LEAD RESULTS	MCL	DATE ANALYZED	ANALYST
21-A25339	05262021HS-15 KITCHEN-STEAM KETTLE 3	1.27 ug/L	15.0	1 Jun 21	RMV
21-A25340	05262021HS-16 KITCHEN HOT WATER DISPENSER	0.72 ug/L	15.0	1 Jun 21	RMV
21-A25341	05262021HS-17 KITCHEN SPRAYER 1	0.92 ug/L	15.0	1 Jun 21	RMV
21-A25342	05262021HS-18 KITCHEN SPRAYER 2	15.3 ug/L	15.0	1 Jun 21	RMV
21-A25343	05262021HS-24 LOUNGE SINK 9	< 0.5 ug/L	15.0	30 May 21	RMV
21-A25344	05262021HS-25 LOUNGE WBF 1	< 0.5 ug/L	15.0	30 May 21	RMV
21-A25345	05262021HS-26 CAFETERIA WBF 2	< 0.5 ug/L	15.0	30 May 21	RMV
21-A25346	05262021HS-27 CAFETERIA WC 1	< 0.5 ug/L	15.0	30 May 21	RMV
21-A25347	05262021HS-28 CAFETERIA WC 2	< 0.5 ug/L	15.0	30 May 21	RMV

Approved by:

Dan O'Connell

David Smahel

Chemistry Laboratory Managers New Ulm, MN

Page: 2

Analyses performed under our Minnesota Department of Health Accreditation conform to the current TNI standards.

The reporting limit was elevated for any analyte requiring a dilution as coded below:

@ = Due to sample matrix

= Due to concentration of other analytes

! = Due to sample quantity

+ = Due to internal standard response

CERTIFICATION: MN LAB # 027-015-125 ND WW/DW # R-040



MINNESOTA VALLEY TESTING LABORATORIES, INC.

1126 North Front St. ~ New Ulm, MN 56073 ~ 800-782-3557 ~ Fax 507-359-2890
2616 East Broadway Ave. ~ Bismarck, ND 58501 ~ 800-279-6885 ~ Fax 701-258-9724
1201 Lincoln Hwy. ~ Nevada, IA 50201 ~ 800-362-0855 ~ Fax 515-382-3885
www.mvtl.com



Report Date: 14 Jun 2021

HEIDI SOLBERG
IEA/BROOKLYN PARK
9201 W BDWY STE #600
BROOKLYN PARK MN 55445

Work Order #: 12-9988
Account #: 002190
Purchase Order #: 202110415

Date Received: 26 May 2021
Date Sampled: 26 May 2021
Temperature at Receipt: 19.7C

PROJECT NAME: EDINA PUBLIC SCHOOLS
PROJECT NUMBER: 202110415

LAB NUMBER	SAMPLE DESCRIPTION	LEAD RESULTS	MCL	DATE ANALYZED	ANALYST
21-A25348	05262021HS-29 HALLWAY OUTSIDE OF CAFETERIA WBF 3	< 0.5 ug/L	15.0	30 May 21	RMV
21-A25349	05262021HS-30 HALLWAY OUTSIDE OF CAFETERIA WC 3	< 0.5 ug/L	15.0	30 May 21	RMV
21-A25350	05262021HS-31 HALLWAY OUTSIDE OF CAFETERIA WC 4	1.15 ug/L	15.0	30 May 21	RMV
21-A25351	05262021HS-32 E238 SINK 10	< 0.5 ug/L	15.0	30 May 21	RMV
21-A25352	05262021HS-33 HALLWAY OUTSIDE OF E230 WBF 4	< 0.5 ug/L	15.0	30 May 21	RMV
21-A25353	05262021HS-34 2ND FLOOR N AREA SINK 11	< 0.5 ug/L	15.0	30 May 21	RMV
21-A25354	05262021HS-35 2ND FLOOR N AREA WBF 5	< 0.5 ug/L	15.0	30 May 21	RMV
21-A25355	05262021HS-36 2ND FLOOR N AREA WC 5	< 0.5 ug/L	15.0	30 May 21	RMV
21-A25356	05262021HS-37 2ND FLOOR N AREA WC 6	< 0.5 ug/L	15.0	30 May 21	RMV

Approved by:

Dan O'Connell

David Smahel

Chemistry Laboratory Managers New Ulm, MN

Page: 3

Analyses performed under our Minnesota Department of Health Accreditation conform to the current TNI standards.

The reporting limit was elevated for any analyte requiring a dilution as coded below:

@ = Due to sample matrix

= Due to concentration of other analytes

! = Due to sample quantity

+ = Due to internal standard response

CERTIFICATION: MN LAB # 027-015-125 ND WW/DW # R-040

MVTL guarantees the accuracy of the analysis done on the sample submitted for testing. It is not possible for MVTL to guarantee that a test result obtained on a particular sample will be the same on any other sample unless all conditions affecting the sample are the same, including sampling by MVTL. As a mutual protection to clients, the public and ourselves, all reports are submitted as the confidential property of clients, and authorization for publication of statements, conclusions or extracts from or regarding our reports is reserved pending our written approval.



MINNESOTA VALLEY TESTING LABORATORIES, INC.

1126 North Front St. ~ New Ulm, MN 56073 ~ 800-782-3557 ~ Fax 507-359-2890
2616 East Broadway Ave. ~ Bismarck, ND 58501 ~ 800-279-6885 ~ Fax 701-258-9724
1201 Lincoln Hwy. ~ Nevada, IA 50201 ~ 800-362-0855 ~ Fax 515-382-3885
www.mvttl.com



Report Date: 14 Jun 2021

HEIDI SOLBERG
IEA/BROOKLYN PARK
9201 W BDWY STE #600
BROOKLYN PARK MN 55445

Work Order #: 12-9988
Account #: 002190
Purchase Order #: 202110415

Date Received: 26 May 2021
Date Sampled: 26 May 2021
Temperature at Receipt: 19.7C

PROJECT NAME: EDINA PUBLIC SCHOOLS
PROJECT NUMBER: 202110415

LAB NUMBER	SAMPLE DESCRIPTION	LEAD RESULTS	MCL	DATE ANALYZED	ANALYST
21-A25357	05262021HS-38 2ND FLOOR W AREA-ROOM W222 SINK 12	0.98 ug/L	15.0	30 May 21	RMV
21-A25358	05262021HS-39 2ND FLOOR W AREA-ROOM W223 SINK 13	1.54 ug/L	15.0	30 May 21	RMV
21-A25359	05262021HS-40 2ND FLOOR W AREA-ROOM W223 WBF 6	< 0.5 ug/L	15.0	30 May 21	RMV
21-A25360	05262021HS-41 2ND FLOOR W AREA-ROOM ACROSS FROM W223 SINK 14	< 0.5 ug/L	15.0	30 May 21	RMV
21-A25361	05262021HS-42 2ND FLOOR W AREA-ROOM ACROSS FROM W223 WBF 7	< 0.5 ug/L	15.0	30 May 21	RMV
21-A25362	05262021HS-43 HALLWAY OUTSIDE OF W223 WBF 8	< 0.5 ug/L	15.0	30 May 21	RMV
21-A25363	05262021HS-44 HALLWAY OUTSIDE OF W223 WC 7	< 0.5 ug/L	15.0	30 May 21	RMV
21-A25364	05262021HS-45	< 0.5 ug/L	15.0	30 May 21	RMV

Approved by:

Dan O'Connell

David Smahel

Chemistry Laboratory Managers New Ulm, MN

Page: 4

Analyses performed under our Minnesota Department of Health Accreditation conform to the current TNI standards.

The reporting limit was elevated for any analyte requiring a dilution as coded below:

@ = Due to sample matrix

= Due to concentration of other analytes

! = Due to sample quantity

+ = Due to internal standard response

CERTIFICATION: MN LAB # 027-015-125 ND WW/DW # R-040

MVTL guarantees the accuracy of the analysis done on the sample submitted for testing. It is not possible for MVTL to guarantee that a test result obtained on a particular sample will be the same on any other sample unless all conditions affecting the sample are the same, including sampling by MVTL. As a mutual protection to clients, the public and ourselves, all reports are submitted as the confidential property of clients, and authorization for publication of statements, conclusions or extracts from or regarding our reports is reserved pending our written approval.



MINNESOTA VALLEY TESTING LABORATORIES, INC.

1126 North Front St. ~ New Ulm, MN 56073 ~ 800-782-3557 ~ Fax 507-359-2890
2616 East Broadway Ave. ~ Bismarck, ND 58501 ~ 800-279-6885 ~ Fax 701-258-9724
1201 Lincoln Hwy. ~ Nevada, IA 50201 ~ 800-362-0855 ~ Fax 515-382-3885
www.mvttl.com



Report Date: 14 Jun 2021

HEIDI SOLBERG
IEA/BROOKLYN PARK
9201 W BDWY STE #600
BROOKLYN PARK MN 55445

Work Order #: 12-9988
Account #: 002190
Purchase Order #: 202110415

Date Received: 26 May 2021
Date Sampled: 26 May 2021
Temperature at Receipt: 19.7C

PROJECT NAME: EDINA PUBLIC SCHOOLS
PROJECT NUMBER: 202110415

LAB NUMBER	SAMPLE DESCRIPTION	LEAD RESULTS	MCL	DATE ANALYZED	ANALYST
	HALLWAY OUTSIDE OF W223 WC 8				
21-A25365	05262021HS-126 KITCHEN-KITCHEN SINK 8	< 0.5 ug/L	15.0	30 May 21	RMV
21-A25366	05262021HS-46 O FLOOR ATHLETICS-OUTSIDE OF RR WBF 9	< 0.5 ug/L	15.0	30 May 21	RMV
21-A25367	05262021HS-47 O FLOOR ATHLETICS-OUTSIDE OF RR WC 9	< 0.5 ug/L	15.0	30 May 21	RMV
21-A25368	05262021HS-48 O FLOOR ATHLETICS-OUTSIDE OF RR WC 10	< 0.5 ug/L	15.0	30 May 21	RMV
21-A25369	05262021HS-49 O FLOOR ATHLETICS-OUTSIDE OF N004 WBF 10	< 0.5 ug/L	15.0	30 May 21	RMV
21-A25370	05262021HS-50 O FLOOR ATHLETICS-OUTSIDE OF N004 WC 11	< 0.5 ug/L	15.0	30 May 21	RMV
21-A25371	05262021HS-51 O FLOOR ATHLETICS-OUTSIDE OF N004 WC 12	< 0.5 ug/L	15.0	30 May 21	RMV

Approved by:

Dan O'Connell

David Smahel

Chemistry Laboratory Managers New Ulm, MN

Page: 5

Analyses performed under our Minnesota Department of Health Accreditation conform to the current TNI standards.

The reporting limit was elevated for any analyte requiring a dilution as coded below:

@ = Due to sample matrix

= Due to concentration of other analytes

! = Due to sample quantity

+ = Due to internal standard response

CERTIFICATION: MN LAB # 027-015-125 ND WW/DW # R-040



MINNESOTA VALLEY TESTING LABORATORIES, INC.

1126 North Front St. ~ New Ulm, MN 56073 ~ 800-782-3557 ~ Fax 507-359-2890
2616 East Broadway Ave. ~ Bismarck, ND 58501 ~ 800-279-6885 ~ Fax 701-258-9724
1201 Lincoln Hwy. ~ Nevada, IA 50201 ~ 800-362-0855 ~ Fax 515-382-3885
www.mvttl.com



Report Date: 14 Jun 2021

HEIDI SOLBERG
IEA/BROOKLYN PARK
9201 W BDWY STE #600
BROOKLYN PARK MN 55445

Work Order #: 12-9988
Account #: 002190
Purchase Order #: 202110415

Date Received: 26 May 2021
Date Sampled: 26 May 2021
Temperature at Receipt: 19.7C

PROJECT NAME: EDINA PUBLIC SCHOOLS
PROJECT NUMBER: 202110415

LAB NUMBER	SAMPLE DESCRIPTION	LEAD RESULTS	MCL	DATE ANALYZED	ANALYST
21-A25372	05262021HS-52 HALLWAY ACROSS FROM E135 WBF 11	< 0.5 ug/L	15.0	30 May 21	RMV
21-A25373	05262021HS-53 HALLWAY ACROSS FROM E135 WC 13	< 0.5 ug/L	15.0	30 May 21	RMV
21-A25374	05262021HS-55 FACS E131-KITCHEN SINK 8	1.17 ug/L	15.0	30 May 21	RMV
21-A25375	05262021HS-56 FACS E131-KITCHEN SINK 9	0.83 ug/L	15.0	30 May 21	RMV
21-A25376	05262021HS-57 FACS E131-KITCHEN SINK 10	1.92 ug/L	15.0	30 May 21	RMV
21-A25377	05262021HS-58 FACS E131-KITCHEN SINK 11	< 0.5 ug/L	15.0	30 May 21	RMV
21-A25378	05262021HS-59 FACS E131-KITCHEN SINK 12	0.70 ug/L	15.0	30 May 21	RMV
21-A25379	05262021HS-60 FACS E131-KITCHEN SINK 13	0.92 ug/L	15.0	30 May 21	RMV
21-A25380	05262021HS-61 FACS E131-KITCHEN SINK 14	< 0.5 ug/L	15.0	30 May 21	RMV
21-A25381	05262021HS-62	< 0.5 ug/L	15.0	30 May 21	RMV

Approved by:

R. Dan O'Connell

David Smahel

Dan O'Connell

David Smahel

Chemistry Laboratory Managers New Ulm, MN

Page: 6

Analyses performed under our Minnesota Department of Health Accreditation conform to the current TNI standards.

The reporting limit was elevated for any analyte requiring a dilution as coded below:

@ = Due to sample matrix

= Due to concentration of other analytes

! = Due to sample quantity

+ = Due to internal standard response

CERTIFICATION: MN LAB # 027-015-125 ND WW/DW # R-040



MINNESOTA VALLEY TESTING LABORATORIES, INC.

1126 North Front St. ~ New Ulm, MN 56073 ~ 800-782-3557 ~ Fax 507-359-2890
2616 East Broadway Ave. ~ Bismarck, ND 58501 ~ 800-279-6885 ~ Fax 701-258-9724
1201 Lincoln Hwy. ~ Nevada, IA 50201 ~ 800-362-0855 ~ Fax 515-382-3885
www.mvtl.com



Report Date: 14 Jun 2021

HEIDI SOLBERG
IEA/BROOKLYN PARK
9201 W BDWY STE #600
BROOKLYN PARK MN 55445

Work Order #: 12-9988
Account #: 002190
Purchase Order #: 202110415

Date Received: 26 May 2021
Date Sampled: 26 May 2021
Temperature at Receipt: 19.7C

PROJECT NAME: EDINA PUBLIC SCHOOLS
PROJECT NUMBER: 202110415

LAB NUMBER	SAMPLE DESCRIPTION	LEAD RESULTS	MCL	DATE ANALYZED	ANALYST
	FACS E131-KITCHEN SINK 15				
21-A25382	05262021HS-63 FACS E131-KITCHEN SINK 16	0.70 ug/L	15.0	30 May 21	RMV
21-A25383	05262021HS-66 LOCKER ROOM N105 WBF 12	< 0.5 ug/L	15.0	30 May 21	RMV
21-A25384	05262021HS-67 LOCKER ROOM N105 WC 15	< 0.5 ug/L	15.0	30 May 21	RMV
21-A25385	05262021HS-68 LOCKER ROOM N103 WBF 13	< 0.5 ug/L	15.0	30 May 21	RMV
21-A25386	05262021HS-69 LOCKER ROOM N103 WC 16	< 0.5 ug/L	15.0	30 May 21	RMV
21-A25387	05262021HS-72 HALLWAY OUTSIDE N101 WBF 14	< 0.5 ug/L	15.0	30 May 21	RMV
21-A25388	05262021HS-73 HALLWAY OUTSIDE N101 WC 17	< 0.5 ug/L	15.0	30 May 21	RMV
21-A25389	05262021HS-74 HALLWAY OUTSIDE N101 WC 18	< 0.5 ug/L	15.0	30 May 21	RMV
21-A25390	05262021HS-75	< 0.5 ug/L	15.0	30 May 21	RMV

Approved by:

Dan O'Connell

David Smahel

Chemistry Laboratory Managers New Ulm, MN

Page: 7

Analyses performed under our Minnesota Department of Health Accreditation conform to the current TNI standards.

The reporting limit was elevated for any analyte requiring a dilution as coded below:

@ = Due to sample matrix
! = Due to sample quantity

= Due to concentration of other analytes
+ = Due to internal standard response

CERTIFICATION: MN LAB # 027-015-125 ND WW/DW # R-040



MINNESOTA VALLEY TESTING LABORATORIES, INC.

1126 North Front St. ~ New Ulm, MN 56073 ~ 800-782-3557 ~ Fax 507-359-2890
2616 East Broadway Ave. ~ Bismarck, ND 58501 ~ 800-279-6885 ~ Fax 701-258-9724
1201 Lincoln Hwy. ~ Nevada, IA 50201 ~ 800-362-0855 ~ Fax 515-382-3885
www.mvttl.com



Report Date: 14 Jun 2021

HEIDI SOLBERG
IEA/BROOKLYN PARK
9201 W BDWY STE #600
BROOKLYN PARK MN 55445

Work Order #: 12-9988
Account #: 002190
Purchase Order #: 202110415

Date Received: 26 May 2021
Date Sampled: 26 May 2021
Temperature at Receipt: 19.7C

PROJECT NAME: EDINA PUBLIC SCHOOLS
PROJECT NUMBER: 202110415

LAB NUMBER	SAMPLE DESCRIPTION	LEAD RESULTS	MCL	DATE ANALYZED	ANALYST
	HALLWAY OUTSIDE OF S396 WBF 15				
21-A25391	05262021HS-76 HALLWAY OUTSIDE OF S396 WC 19	< 0.5 ug/L	15.0	30 May 21	RMV
21-A25392	05262021HS-77 HALLWAY OUTSIDE OF S396 WC 20	< 0.5 ug/L	15.0	30 May 21	RMV
21-A25393	05262021HS-78 ROOM S393 WC 21	< 0.5 ug/L	15.0	30 May 21	RMV
21-A25394	05262021HS-123 BY ROOM S384 SINK J	< 0.5 ug/L	15.0	30 May 21	RMV
21-A25395	05262021HS-79 ROOM S356 WC 22	< 0.5 ug/L	15.0	30 May 21	RMV
21-A25396	05262021HS-114 ROOM S356 SINK A	1.51 ug/L	15.0	30 May 21	RMV
21-A25397	05262021HS-115 ROOM S356 SINK B	< 0.5 ug/L	15.0	30 May 21	RMV
21-A25398	05262021HS-80 ROOM S354 WC 23	< 0.5 ug/L	15.0	30 May 21	RMV
21-A25399	05262021HS-116	0.84 ug/L	15.0	30 May 21	RMV

Approved by:

Dan O'Connell

David Smahel

Chemistry Laboratory Managers New Ulm, MN

Page: 8

Analyses performed under our Minnesota Department of Health Accreditation conform to the current TNI standards.

The reporting limit was elevated for any analyte requiring a dilution as coded below:

@ = Due to sample matrix
! = Due to sample quantity

= Due to concentration of other analytes
+ = Due to internal standard response

CERTIFICATION: MN LAB # 027-015-125 ND WW/DW # R-040



MINNESOTA VALLEY TESTING LABORATORIES, INC.

1126 North Front St. ~ New Ulm, MN 56073 ~ 800-782-3557 ~ Fax 507-359-2890
2616 East Broadway Ave. ~ Bismarck, ND 58501 ~ 800-279-6885 ~ Fax 701-258-9724
1201 Lincoln Hwy. ~ Nevada, IA 50201 ~ 800-362-0855 ~ Fax 515-382-3885
www.mvtl.com



Report Date: 14 Jun 2021

HEIDI SOLBERG
IEA/BROOKLYN PARK
9201 W BDWY STE #600
BROOKLYN PARK MN 55445

Work Order #: 12-9988
Account #: 002190
Purchase Order #: 202110415

Date Received: 26 May 2021
Date Sampled: 26 May 2021
Temperature at Receipt: 19.7C

PROJECT NAME: EDINA PUBLIC SCHOOLS
PROJECT NUMBER: 202110415

LAB NUMBER	SAMPLE DESCRIPTION	LEAD RESULTS	MCL	DATE ANALYZED	ANALYST
	ROOM S354 SINK C				
21-A25400	05262021HS-81 ROOM S350 WC 24	< 0.5 ug/L	15.0	30 May 21	RMV
21-A25401	05262021HS-117 ROOM S350 SINK D	1.79 ug/L	15.0	30 May 21	RMV
21-A25402	05262021HS-82 ROOM NEXT TO S362 WBF 16	< 0.5 ug/L	15.0	30 May 21	RMV
21-A25403	05262021HS-122 ROOM NEXT TO S362 SINK 1	< 0.5 ug/L	15.0	30 May 21	RMV
21-A25404	05262021HS-83 ROOM S360 WBF 17	< 0.5 ug/L	15.0	30 May 21	RMV
21-A25405	05262021HS-118 BY ROOM S360 SINK E	< 0.5 ug/L	15.0	30 May 21	RMV
21-A25406	05262021HS-119 ROOM S360 SINK F	< 0.5 ug/L	15.0	30 May 21	RMV
21-A25407	05262021HS-120 BY ROOM S360 SINK G	1.33 ug/L	15.0	30 May 21	RMV
21-A25408	05262021HS-121 BY ROOM S360 SINK H	9.57 ug/L	15.0	8 Jun 21	KAM
21-A25409	05262021HS-84	< 0.5 ug/L	15.0	30 May 21	RMV

Approved by:

Dan O'Connell

David Smahel

Chemistry Laboratory Managers New Ulm, MN

Page: 9

Analyses performed under our Minnesota Department of Health Accreditation conform to the current TNI standards.

The reporting limit was elevated for any analyte requiring a dilution as coded below:

@ = Due to sample matrix

= Due to concentration of other analytes

! = Due to sample quantity

+ = Due to internal standard response

CERTIFICATION: MN LAB # 027-015-125 ND WW/DW # R-040

MVTL guarantees the accuracy of the analysis done on the sample submitted for testing. It is not possible for MVTL to guarantee that a test result obtained on a particular sample will be the same on any other sample unless all conditions affecting the sample are the same, including sampling by MVTL. As a mutual protection to clients, the public and ourselves, all reports are submitted as the confidential property of clients, and authorization for publication of statements, conclusions or extracts from or regarding our reports is reserved pending our written approval.



MINNESOTA VALLEY TESTING LABORATORIES, INC.

1126 North Front St. ~ New Ulm, MN 56073 ~ 800-782-3557 ~ Fax 507-359-2890
 2616 East Broadway Ave. ~ Bismarck, ND 58501 ~ 800-279-6885 ~ Fax 701-258-9724
 1201 Lincoln Hwy. ~ Nevada, IA 50201 ~ 800-362-0855 ~ Fax 515-382-3885
 www.mvttl.com



Report Date: 14 Jun 2021

HEIDI SOLBERG
 IEA/BROOKLYN PARK
 9201 W BDWY STE #600
 BROOKLYN PARK MN 55445

Work Order #: 12-9988
 Account #: 002190
 Purchase Order #: 202110415
 Date Received: 26 May 2021
 Date Sampled: 26 May 2021
 Temperature at Receipt: 19.7C

PROJECT NAME: EDINA PUBLIC SCHOOLS
 PROJECT NUMBER: 202110415

LAB NUMBER	SAMPLE DESCRIPTION	LEAD RESULTS	MCL	DATE ANALYZED	ANALYST
	HALLWAY OUTSIDE S AREAS WBF 18				
21-A25410	05262021HS-85 HALLWAY OUTSIDE S AREAS WC 25	< 0.5 ug/L	15.0	30 May 21	RMV
21-A25411	05262021HS-86 COMMONS AREA SINK 18	< 0.5 ug/L	15.0	30 May 21	RMV
21-A25412	05262021HS-87 HALLWAY OUTSIDE E345 WBF 19	< 0.5 ug/L	15.0	30 May 21	RMV
21-A25413	05262021HS-88 HALLWAY OUTSIDE E345 WC 26	< 0.5 ug/L	15.0	30 May 21	RMV
21-A25414	05262021HS-95 HALLWAY OUTSIDE E330 WBF 21	< 0.5 ug/L	15.0	30 May 21	RMV
21-A25415	05262021HS-96 HALLWAY OUTSIDE E330 WC 27	2.80 ug/L	15.0	30 May 21	RMV
21-A25416	05262021HS-97 HALLWAY OUTSIDE E330 WC 28	< 0.5 ug/L	15.0	30 May 21	RMV

Approved by:

Dan O'Connell

David Smahel

Chemistry Laboratory Managers New Ulm, MN

Page: 10

Analyses performed under our Minnesota Department of Health Accreditation conform to the current TNI standards.

The reporting limit was elevated for any analyte requiring a dilution as coded below:

@ = Due to sample matrix

= Due to concentration of other analytes

! = Due to sample quantity

+ = Due to internal standard response

CERTIFICATION: MN LAB # 027-015-125 ND WW/DW # R-040

MVTL guarantees the accuracy of the analysis done on the sample submitted for testing. It is not possible for MVTL to guarantee that a test result obtained on a particular sample will be the same on any other sample unless all conditions affecting the sample are the same, including sampling by MVTL. As a mutual protection to clients, the public and ourselves, all reports are submitted as the confidential property of clients, and authorization for publication of statements, conclusions or extracts from or regarding our reports is reserved pending our written approval.



MINNESOTA VALLEY TESTING LABORATORIES, INC.

1126 North Front St. ~ New Ulm, MN 56073 ~ 800-782-3557 ~ Fax 507-359-2890
2616 East Broadway Ave. ~ Bismarck, ND 58501 ~ 800-279-6885 ~ Fax 701-258-9724
1201 Lincoln Hwy. ~ Nevada, IA 50201 ~ 800-362-0855 ~ Fax 515-382-3885
www.mvtl.com



Report Date: 14 Jun 2021

HEIDI SOLBERG
IEA/BROOKLYN PARK
9201 W BDWY STE #600
BROOKLYN PARK MN 55445

Work Order #: 12-9988
Account #: 002190
Purchase Order #: 202110415
Date Received: 26 May 2021
Date Sampled: 26 May 2021
Temperature at Receipt: 19.7C

PROJECT NAME: EDINA PUBLIC SCHOOLS
PROJECT NUMBER: 202110415

LAB NUMBER	SAMPLE DESCRIPTION	LEAD RESULTS	MCL	DATE ANALYZED	ANALYST
21-A25417	05262021HS-98 ROOM N300 WBF 22	< 0.5 ug/L	15.0	30 May 21	RMV
21-A25418	05262021HS-101 HALLWAY OUTSIDE N300 WBF 23	< 0.5 ug/L	15.0	30 May 21	RMV
21-A25419	05262021HS-104 HALLWAY ACROSS FROM N302 WBF 24	< 0.5 ug/L	15.0	30 May 21	RMV
21-A25420	05262021HS-113 HALLWAY ACROSS FROM N302 SINK	< 0.5 ug/L	15.0	30 May 21	RMV
21-A25421	05262021HS-107 HALLWAY OUTSIDE OF W323 WBF 25	< 0.5 ug/L	15.0	30 May 21	RMV
21-A25422	05262021HS-108 HALLWAY OUTSIDE OF W323 WC 35	< 0.5 ug/L	15.0	30 May 21	RMV
21-A25423	05262021HS-109 HALLWAY OUTSIDE OF W323 WC 36	< 0.5 ug/L	15.0	30 May 21	RMV
21-A25424	05262021HS-124 ROOM W324 SINK	0.74 ug/L	15.0	30 May 21	RMV

Approved by:

Dan O'Connell

David Smahel

Chemistry Laboratory Managers New Ulm, MN

Page: 11

Analyses performed under our Minnesota Department of Health Accreditation conform to the current TNI standards.

The reporting limit was elevated for any analyte requiring a dilution as coded below:

@ = Due to sample matrix

= Due to concentration of other analytes

! = Due to sample quantity

+ = Due to internal standard response

CERTIFICATION: MN LAB # 027-015-125 ND WW/DW # R-040

MVTL guarantees the accuracy of the analysis done on the sample submitted for testing. It is not possible for MVTL to guarantee that a test result obtained on a particular sample will be the same on any other sample unless all conditions affecting the sample are the same, including sampling by MVTL. As a mutual protection to clients, the public and ourselves, all reports are submitted as the confidential property of clients, and authorization for publication of statements, conclusions or extracts from or regarding our reports is reserved pending our written approval.



MINNESOTA VALLEY TESTING LABORATORIES, INC.

1126 North Front St. ~ New Ulm, MN 56073 ~ 800-782-3557 ~ Fax 507-359-2890
2616 East Broadway Ave. ~ Bismarck, ND 58501 ~ 800-279-6885 ~ Fax 701-258-9724
1201 Lincoln Hwy. ~ Nevada, IA 50201 ~ 800-362-0855 ~ Fax 515-382-3885
www.mvttl.com



Report Date: 14 Jun 2021

HEIDI SOLBERG
IEA/BROOKLYN PARK
9201 W BDWY STE #600
BROOKLYN PARK MN 55445

Work Order #: 12-9988
Account #: 002190
Purchase Order #: 202110415
Date Received: 26 May 2021
Date Sampled: 26 May 2021
Temperature at Receipt: 19.7C

PROJECT NAME: EDINA PUBLIC SCHOOLS
PROJECT NUMBER: 202110415

LAB NUMBER	SAMPLE DESCRIPTION	LEAD RESULTS	MCL	DATE ANALYZED	ANALYST
21-A25425	05262021HS-125 ROOM W325 SINK	< 0.5 ug/L	15.0	30 May 21	RMV
21-A25429	05262021HS-127 E334 SINK	0.58 ug/L	15.0	30 May 21	RMV

Approved by:

Dan O'Connell

David Smahel

Chemistry Laboratory Managers New Ulm, MN

Page: 12

Analyses performed under our Minnesota Department of Health Accreditation conform to the current TNI standards.

The reporting limit was elevated for any analyte requiring a dilution as coded below:

@ = Due to sample matrix

= Due to concentration of other analytes

! = Due to sample quantity

+ = Due to internal standard response

CERTIFICATION: MN LAB # 027-015-125 ND WW/DW # R-040



MINNESOTA VALLEY TESTING LABORATORIES, INC.

1126 N. Front St. ~ New Ulm, MN 56073 ~ 800-782-3557 ~ Fax 507-359-2890

2616 E. Broadway Ave. ~ Bismarck, ND 58501 ~ 800-279-6885 ~ Fax 701-258-9724

1201 Lincoln Highway ~ Nevada, IA 50201 ~ 800-362-0855 ~ Fax 515-382-3885

www.mvttl.com

MEMBER
ACIL

Report Date: 20 Jul 2021

HEIDI SOLBERG
IEA/BROOKLYN PARK
9201 W BDWY STE #600
BROOKLYN PARK MN 55445

Work Order #: 12-12142
Account #: 002190
Purchase Order #: 202110415

Date Received: 14 Jul 2021
Date Sampled: 9 Jul 2021
Temperature at Receipt: AMBIENT

PROJECT NAME: EDINA HIGH SCHOOL
PROJECT NUMBER: 202110415

LAB NUMBER	SAMPLE DESCRIPTION	LEAD RESULTS	MCL	DATE ANALYZED	ANALYST
21-A33972	07092021HS-1 KITCHEN SPRAYER 2	2.39 ug/L	15.0	19 Jul 21	RMV
21-A33973	07092021HS-2 KITCHEN STEAM KETTLE 1	5.48 ug/L	15.0	19 Jul 21	RMV
21-A33974	07092021HS-3 BY ROOM S360 SINK H	0.73 ug/L	15.0	19 Jul 21	RMV

Approved by:

Dan O'Connell

David Smahel

Chemistry Laboratory Managers New Ulm, MN

Analyses performed under our Minnesota Department of Health Accreditation conform to the current TNI standards. The reporting limit was elevated for any analyte requiring a dilution as coded below:

@ = Due to sample matrix

! = Due to sample quantity

= Due to concentration of other analytes

+ = Due to internal standard response

CERTIFICATION: MN LAB # 027-015-125 ND WW/DW # R-040

LEGEND

- WATER BOTTLE FILLER
- WATER COOLER

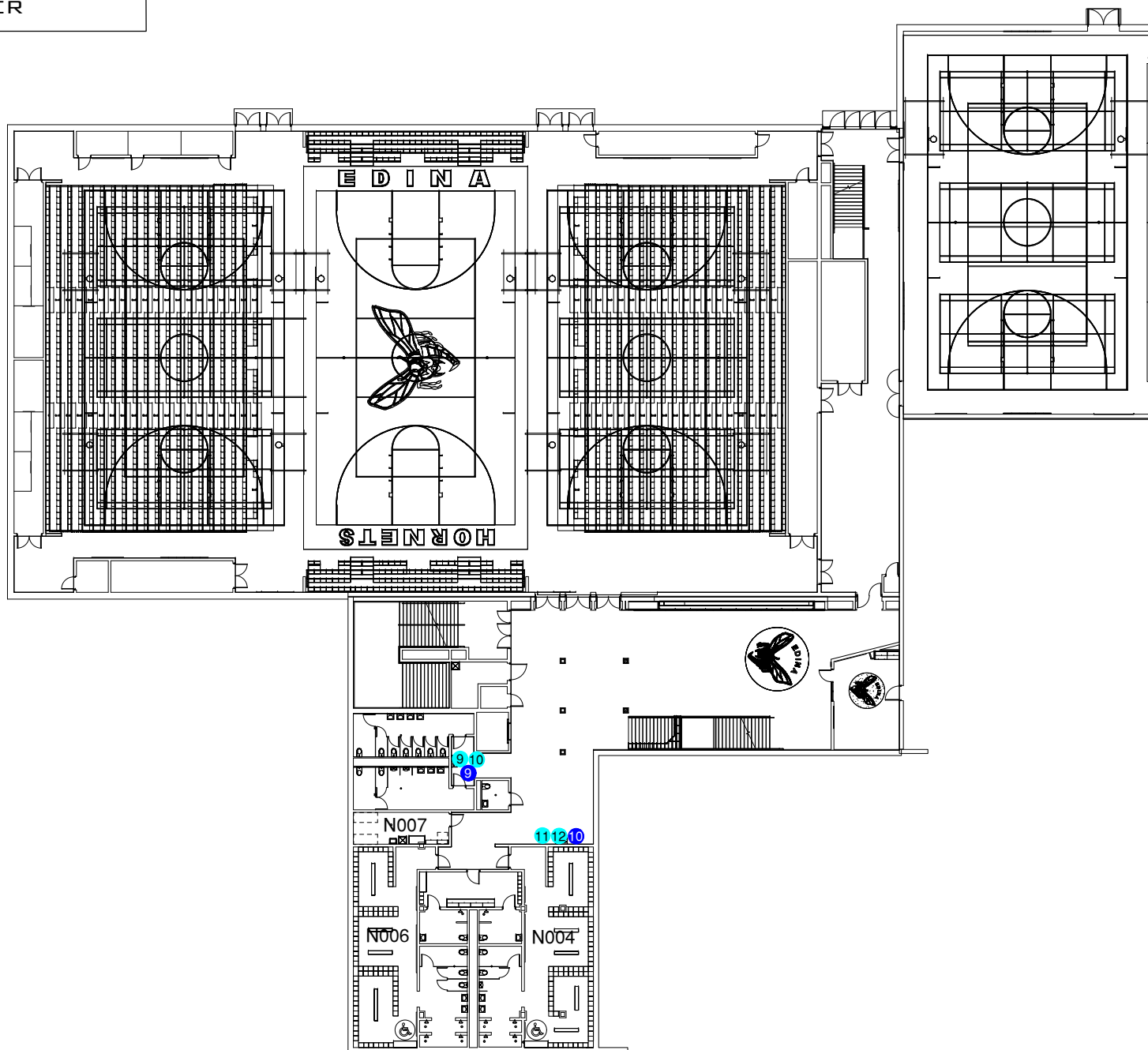

LEGEND

● SINK - NOT TESTING

● KITCHEN SINK

● WATER BOTTLE FILLER

● WATER COOLER

● NON-POTABLE (NOT TESTED)

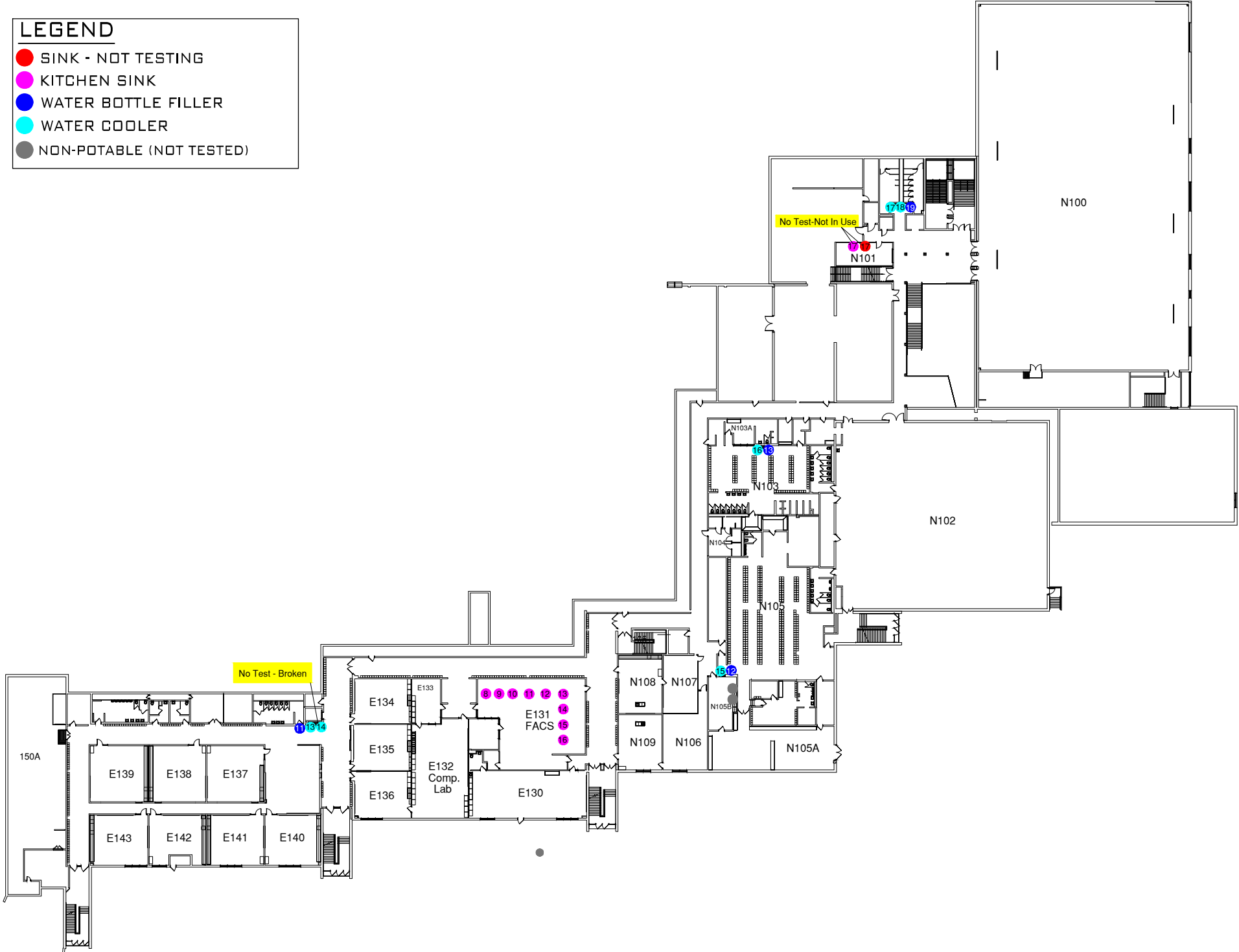

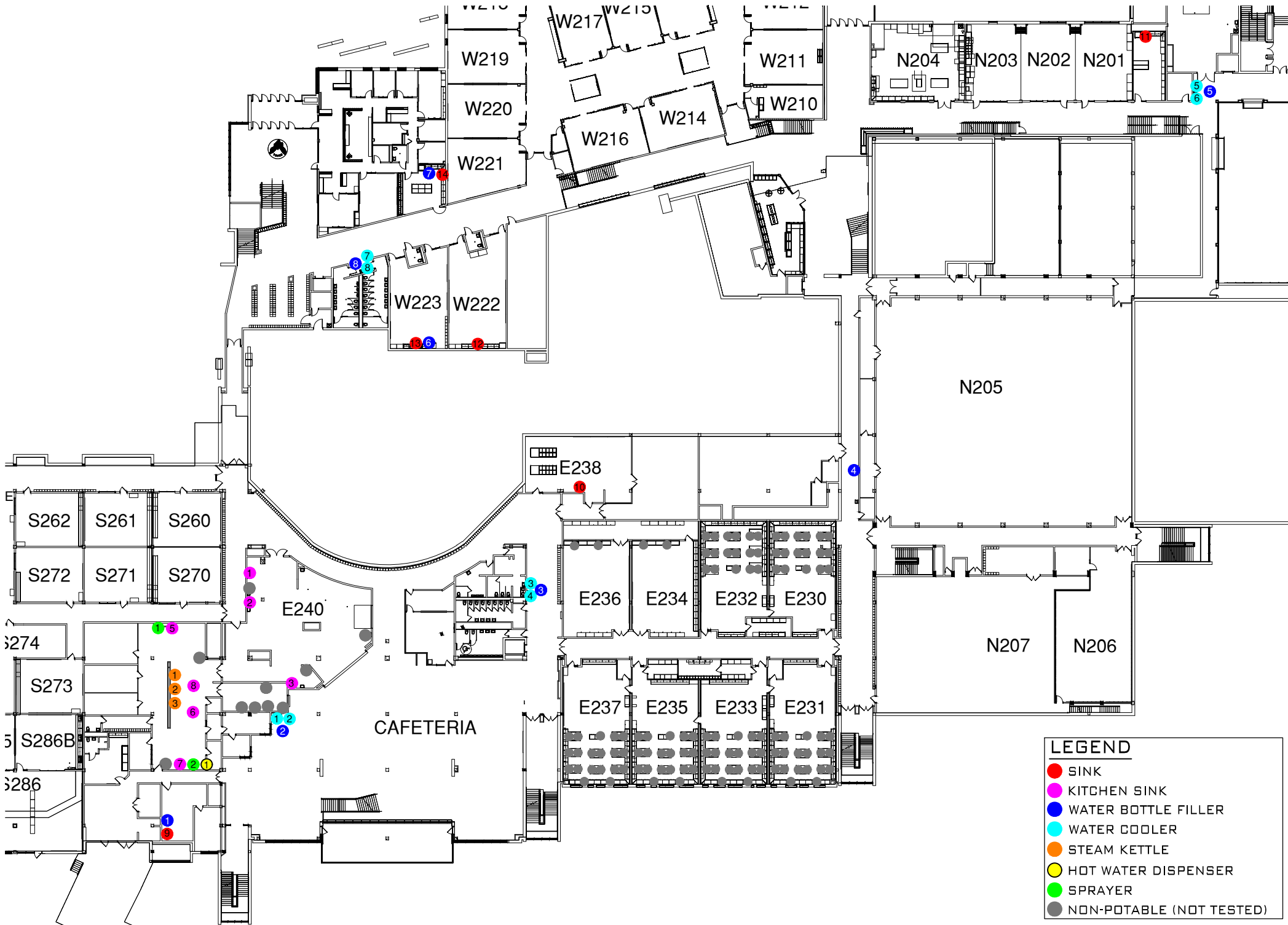

LEGEND

- SINK
- WATER BOTTLE FILLER
- WATER COOLER
- NON-POTABLE (NOT TESTED)

- SINK
- WATER BOTTLE FILLER
- WATER COOLER
- NON-POTABLE (NOT TESTED)

