

RIVER VALLEY LOCAL SCHOOL DISTRICT

2024 PAVEMENT REHABILITATION



SITE DATA:

OWNER:
RIVER VALLEY LOCAL SCHOOL DISTRICT
197 BROCKLESBY ROAD
CALEDONIA, OH 43314
CONTACT: ADAM WICKHAM

SITE ENGINEER:
THE KLEINGERS GROUP
6219 CENTRE PARK DRIVE
WEST CHESTER, OH 45069
513-779-7851
CONTACT: KAYLEIGH HAMMOND

SHEET INDEX	
PAGE	TITLE
C0.0	TITLE SHEET
C1.0	GENERAL NOTES & DETAILS
C2.0	HERITAGE ELEMENTARY
C3.0	MIDDLE AND HIGH SCHOOLS SOUTH LOT
C3.1	MIDDLE AND HIGH SCHOOLS NORTH LOT
C3.2	MIDDLE AND HIGH SCHOOLS EAST LOT
C4.0	LIBERTY ELEMENTARY



VICINITY MAP
N.T.S.

- ① HERITAGE ELEMENTARY
720 COLUMBUS-SANDUSKY ROAD S
MARION OH 43302
- ② RIVER VALLEY MIDDLE AND HIGH SCHOOLS
4280 MARION-MT GILEAD ROAD
CALEDONIA, OH 43314
- ③ LIBERTY ELEMENTARY
1932 WHETSTONE REIVER ROAD N
CALEDONIA, OH 43314

NOTE:
UNDERGROUND UTILITIES ARE PLOTTED FROM A
COMPILATION OF AVAILABLE RECORD INFORMATION AND
SURFACE INDICATIONS OF UNDERGROUND STRUCTURES AND
MAY NOT BE INCLUSIVE. PRECISE LOCATIONS AND THE
EXISTENCE OR NON EXISTENCE OF UNDERGROUND UTILITIES
CANNOT BE VERIFIED. PLEASE NOTIFY THE OHIO UTILITY
PROTECTION SERVICE AT 811 OR 1-800-362-2764 BEFORE ANY
PERIOD OF EXCAVATION OR CONSTRUCTION ACTIVITY.



**RIVER VALLEY LOCAL SCHOOL DISTRICT
2024 PAVEMENT REHABILITATION**

**RIVER VALLEY LOCAL SCHOOLS
197 BROCKLESBY RD
CALEDONIA, OHIO 43314**

SEAL:

NO.	DATE	DESCRIPTION
1	03/12/2024	BID SET
2	03/19/2024	ADDENDUM 1
3	03/27/2024	ADDENDUM 2

RIVER VALLEY LOCAL SCHOOL DISTRICT 2024 PAVEMENT REHABILITATION

PROJECT NO: 220836,002

DATE: MARCH 2024

SCALE:

SHEET NAME:

TITLE SHEET

SHEET NO.

C0.0

GENERAL NOTES

1. THE COUNTY OF MARION, AND THE CURRENT EDITION OF THE STATE OF OHIO DEPARTMENT OF TRANSPORTATION CONSTRUCTION AND MATERIAL SPECIFICATIONS (ODOT CMS), INCLUDING ALL SUPPLEMENTS, SHALL GOVERN ALL MATERIALS AND WORKMANSHIP INVOLVED IN THE IMPROVEMENTS SHOWN ON THIS PLAN. IGNORE REFERENCES TO MEASUREMENT AND PAYMENT IN THE ODOT CMS UNLESS NOTED OTHERWISE. IN THE CASE OF CONFLICTS BETWEEN THE ODOT CMS AND THE COUNTY OF MARION REQUIREMENTS, THE COUNTY OF MARION REQUIREMENTS SHALL PREVAIL.
2. THE CONTRACTOR IS RESPONSIBLE FOR THE INVESTIGATION, LOCATION, SUPPORT, PROTECTION, AND RESTORATION OF ALL EXISTING UTILITIES AND APPURTENANCES WHETHER SHOWN ON THESE PLANS OR NOT. THE CONTRACTOR SHALL EXPOSE ALL UTILITIES OR STRUCTURES PRIOR TO CONSTRUCTION TO VERIFY THE VERTICAL AND HORIZONTAL EFFECT ON THE PROPOSED CONSTRUCTION. THE CONTRACTOR SHALL CALL, TOLL FREE, THE OHIO UTILITIES PROTECTION SERVICE (1-800-362-2764) 48 HOURS PRIOR TO CONSTRUCTION AND SHALL NOTIFY ALL UTILITY COMPANIES WHO ARE NON-MEMBERS OF THE OHIO UTILITIES PROTECTION SERVICE AT LEAST 48 HOURS PRIOR TO WORK IN THE VICINITY OF THEIR UNDERGROUND LINES.
3. CONTRACTOR SHALL OBTAIN A PERMIT FOR ALL CONSTRUCTION ACTIVITIES IN ACCORDANCE WITH LOCAL, STATE, & FEDERAL REGULATIONS.
4. THE CONTRACTOR IS TO PERFORM ALL INSPECTIONS AS REQUIRED BY THE OHIO EPA FOR THE NATIONAL POLLUTANT DISCHARGE ELIMINATION SYSTEM (NPDES) PERMIT AND FURNISH OWNERS REPRESENTATIVE WITH WRITTEN REPORTS.
5. THE CONTRACTOR IS REQUIRED TO VISIT THE SITE AND FULLY INFORM HIMSELF CONCERNING ALL CONDITIONS AFFECTING THE SCOPE OF THE WORK. FAILURE TO VISIT THE SITE SHALL NOT RELIEVE HIM FROM ANY RESPONSIBILITY IN THE PERFORMANCE OF THE CONTRACT.
6. NO ADDITIONAL COMPENSATION SHALL BE ALLOWED FOR EXPENSES INCURRED DUE TO SOIL CONDITIONS, GROUNDWATER, AND/OR ROCK EXCAVATION, ALL OF THESE ITEMS SHALL BE INCLUDED IN THE PRICE BID FOR THE PROJECT.
7. THE COST OF ALL DEWATERING REQUIRED FOR THE CONSTRUCTION OF THIS PROJECT SHALL BE INCLUDED IN THE PRICE BID FOR THE PROJECT.
8. THE DIRECT OR INDIRECT DISCHARGE OR PUMPING OF UNFILTERED SEDIMENT-LADEN WATER INTO THE STORM DRAINAGE SYSTEM OR WATERCOURSE IS ILLEGAL AND PROHIBITED.
9. ANY WELL, WELL POINT, PIT, OR OTHER DEVICE INSTALLED FOR THE PURPOSE OF LOWERING THE GROUND WATER TO FACILITATE CONSTRUCTION OF THIS PROJECT SHALL BE PROPERLY ABANDONED IN ACCORDANCE WITH THE PROVISIONS OF SECTION 3745-9-10 OF THE OHIO ADMINISTRATIVE CODE OR IN ACCORDANCE WITH THIS PLAN AS DIRECTED BY THE DIRECTOR OF PUBLIC UTILITIES OR HIS REPRESENTATIVE.
10. ANY CONTRACTOR INSTALLING ANY WELL, WELL POINT, PIT, OR OTHER DEVICE USED FOR THE PURPOSE OF REMOVING GROUND WATER FROM AN AQUIFER SHALL COMPLETE AND FILE A WELL LOG AND DRILLING REPORT FORM WITH THE OHIO DEPARTMENT OF NATURAL RESOURCES (ODNR), DIVISION OF WATER, WITHIN 30 DAYS OF THE WELL COMPLETION IN ACCORDANCE WITH THE OHIO REVISED CODE SECTION 1521.01 AND 1521.05 IN ADDITION, ANY SUCH FACILITY IS COMPLETED IN ACCORDANCE WITH SECTION 1521.16 OF THE OHIO REVISED CODE. FOR COPIES OF THE NECESSARY WELL LOG, DRILLING REPORT, OR REGISTRATION FORMS, PLEASE CONTACT: DIVISION OF WATER, OHIO DEPARTMENT OF NATURAL RESOURCES, FOUNTAIN SQUARE, COLUMBUS, OHIO 43224, (614)2656717.
11. THE CONTRACTOR SHALL BE SOLELY RESPONSIBLE TO THE ODNR FOR THE REGISTRY, MAINTENANCE AND ABANDONMENT OF ANY WITHDRAWAL DEVICE USED IN CONSTRUCTION OF THIS PROJECT.
12. ALL DIMENSIONS ARE TO THE EDGE OF PAVEMENT AND/OR FACE OF CURB, UNLESS OTHERWISE NOTED.
13. ALL SITE SIGNAGE, STRIPING COLOR AND WIDTH SHALL BE PER THE OHIO MANUAL OF UNIFORM TRAFFIC CONTROL DEVICES.
14. ALL EXISTING PAVEMENTS, WALKS, CURBS, ETC. SHALL BE SAWCUT BEFORE REMOVAL. IF DURING CONSTRUCTION, THE PAVEMENT, WALKWAY, CURB, ETC. IS DAMAGED BEYOND THE ORIGINAL SAWCUT, THE DAMAGED AREA SHALL BE RECUT TO NEAT LINES AS DIRECTED BY THE ENGINEER. PAYMENT FOR SAWCUTTING SHALL BE INCLUDED IN THE PRICE BID FOR THE PROJECT.
15. THE CONTRACTOR SHALL SAWCUT EXISTING PAVEMENT TO PROVIDE A SMOOTH VERTICAL FULL DEPTH BUTT JOINT BETWEEN THE EXISTING PAVEMENT OR CURB AND THE PROPOSED PAVEMENT. CONTRACTOR SHALL LOCATE SOUND PAVEMENT EDGE AND CUT AND TRIM PAVEMENT TO A NEAT LINE. INCLUDE THE COST OF PAVEMENT REMOVAL AND DISPOSAL IN THE PRICE BID FOR THE PROJECT.

GRADING NOTES

1. PROTECTION OF EXISTING TREES AND VEGETATION: PROTECT EXISTING TREES AND OTHER VEGETATION INDICATED TO REMAIN IN PLACE AGAINST UNNECESSARY CUTTING, BREAKING OR SKINNING OF ROOTS, SKINNING OR BRUISING OF BARK, SMOTHERING OF TREES BY STOCKPILING CONSTRUCTION MATERIALS OR EXCAVATED MATERIALS WITHIN DRIP LINE, EXCESS FOOT OR VEHICULAR TRAFFIC, OR PARKING OF VEHICLES WITHIN DRIP LINE. PROVIDE TEMPORARY GUARDS TO PROTECT TREES AND VEGETATION TO BE LEFT STANDING.
2. CONTRACTOR SHALL IMPLEMENT ALL SOIL AND EROSION CONTROL PRACTICES REQUIRED BY COUNTY OF MARION AND THE OHIO EPA.
3. ALL GROUND SURFACE AREAS THAT HAVE BEEN EXPOSED OR LEFT BARE AS A RESULT OF CONSTRUCTION AND ARE TO FINAL GRADE AND ARE TO REMAIN SO, SHALL BE SEEDED AND MULCHED AS SOON AS PRACTICAL IN ACCORDANCE WITH THE PROJECT SPECIFICATIONS. IF NO SPECIFICATIONS ARE SUPPLIED, USE ODOT ITEM 659.

UTILITY NOTES

1. ALL DRAIN TILE AND STORM SEWERS DAMAGED, DISTURBED OR REMOVED AS A RESULT OF THE CONTRACTOR'S OPERATIONS SHALL BE REPLACED WITH THE SAME QUALITY PIPE OR BETTER, MAINTAINING THE SAME GRADIENT AS EXISTING. THE DRAIN TILE AND/OR STORM SEWER SHALL BE CONNECTED TO THE CURB SUBDRAIN, STORM SEWER SYSTEM OR OUTLETTED INTO THE ROADWAY DITCH AS APPLICABLE. REPLACED DRAIN TILE/STORM SEWER SHALL BE LAID ON COMPACTED BEDDING EQUAL IN DENSITY TO SURROUNDING STRATUM. REPLACEMENT SHALL BE DONE AT THE TIME OF THE BACKFILL OPERATION. COST OF THIS WORK TO BE INCLUDED IN THE PRICE BID FOR THE PROJECT.
2. ALL EXISTING UTILITIES KNOWN TO EXIST HAVE BEEN SHOWN ON THESE PLANS IN THEIR APPROXIMATE LOCATION. PRIOR TO THE BEGINNING OF CONSTRUCTION OR EARTH MOVING OPERATIONS, THE CONTRACTOR SHALL VERIFY THE LOCATION AND ELEVATION OF THE UTILITIES SHOWN. THE CONTRACTOR IS ALSO RESPONSIBLE FOR THE PROTECTION AND/OR RELOCATION OF ANY UTILITIES THAT MAY EXIST AND ARE NOT SHOWN.
3. THE CONTRACTOR SHALL BE RESPONSIBLE FOR COORDINATING THE RELOCATION AND/OR PROTECTION OF ANY UTILITIES AS REQUIRED BY THE PLAN WITH THE OWNER OF THE AFFECTED UTILITY.
4. COMPACTED FILLS ARE TO BE MADE TO A MINIMUM OF THREE FEET ABOVE THE CROWN OF ANY PROPOSED SEWER PRIOR TO CUTTING OF TRENCHES FOR PLACEMENT OF SAID SEWERS. ALL FILLS SHALL BE CONTROLLED AND INSPECTED BY AN APPROVED TESTING LABORATORY OR AN INSPECTOR FROM THE APPROPRIATE GOVERNMENTAL AGENCY.
5. CONTRACTOR TO REPLACE ANY PAVEMENT OR UTILITIES DAMAGED WHICH ARE NOT SPECIFIED TO BE REMOVED ON THESE PLANS.
6. ADJUST ALL EXISTING CASTINGS AND CLEANOUTS WITHIN PROJECT AREA TO GRADE AS REQUIRED.
7. ALL CATCH BASINS WITH DEPTH GREATER THAN 4' SHALL BE PROVIDED WITH STEPS. STEPS SHALL MEET THE REQUIREMENTS OF ODOT ITEM 611.
8. ALL STORM SEWER MANHOLES WITH A DEPTH GREATER THAN 4' SHALL BE PROVIDED WITH STEPS. STEPS SHALL MEET THE REQUIREMENTS OF ODOT ITEM 611.

11. ALL PROPOSED STORM SEWERS, SURFACE OR OTHER DRAINAGE FACILITIES ARE TO BE PRIVATE AND MAINTAINED BY THE OWNER. EROSION CONTROL MEASURES MUST PROVIDE PROTECTION UNTIL COMPLETION OF THE PROJECT AND VEGETATIVE STABILIZATION.
12. ALL STORM STRUCTURES ARE ODOT TYPES UNLESS OTHERWISE INDICATED.
13. ALL CATCH BASINS IN THE PAVEMENT ARE TO HAVE 4, 4" PERFORATED UNDERDRAINS EXTENDING 10 LF FROM THE CATCH BASIN IN THE UPHILL DIRECTION AND CAPPED. ALL CATCH BASINS IN THE CURB ARE TO HAVE 2, 4" PERFORATED UNDERDRAINS EXTENDING 10 LF FROM THE CATCH BASIN IN THE UPHILL DIRECTION AND CAPPED.
14. ALL YARD DRAINS SHALL BE ONE OF THE FOLLOWING: NYLOPLAST-ADS DRAIN BASIN, NDS DURACAST FABRICATED PVC CATCH BASIN, AGRI-DRAIN CATCH BASIN, OR APPROVED EQUAL.
15. ALL EXISTING INVERTS ALONG PROPOSED PIPE ALIGNMENTS SHALL BE VERIFIED BY THE CONTRACTOR PRIOR TO CONSTRUCTION OF THE SEWER.
16. ANY FIELD TILE CUT IN EXCAVATION WHICH DRAINS IN AN OFFSITE AREA MUST BE TIED INTO THE STORM DRAINAGE SYSTEM.
17. THE FLOW IN ALL SEWERS, DRAINS, FIELD TILES AND WATERCOURSES ENCOUNTERED SHALL BE MAINTAINED BY THE CONTRACTOR AT HIS OWN EXPENSE. AND WHENEVER SUCH WATERCOURSES AND DRAINS ARE DISTURBED OR DESTROYED DURING THE PROSECUTION OF THE WORK, THEY SHALL BE RESTORED BY THE CONTRACTOR AT HIS OWN EXPENSE TO A CONDITION SATISFACTORY TO THE ENGINEER.

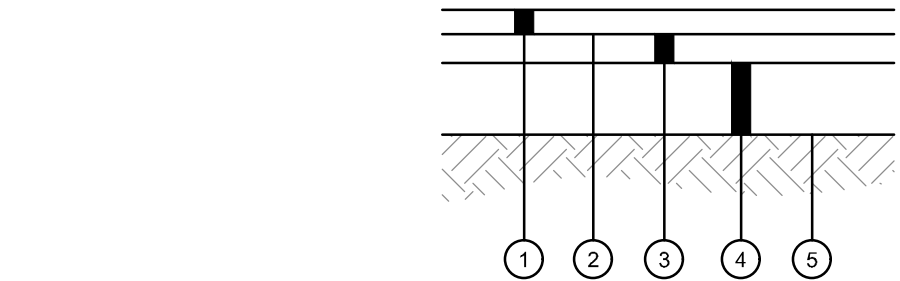

- 1 1 1/2" ODOT ITEM 441 ASPHALT CONCRETE SURFACE COURSE, TYPE 1, PG64-22
- 2 ODOT ITEM 407 TACK COAT, APPLY IF TIME BETWEEN ASPHALT LIFTS EXCEEDS 30 DAYS
- 3 2" ODOT ITEM 441 ASPHALT CONCRETE INTERMEDIATE COURSE, TYPE 2, PG64-22
- 4 8" ODOT ITEM 304 AGGREGATE BASE
- 5 SUBGRADE COMPACTION, REFERENCE ODOT ITEM 204, EARTHWORK SPECIFICATION 312000 AND SOILS REPORT

STANDARD DUTY ASPHALT PAVEMENT DETAIL
N.T.S.

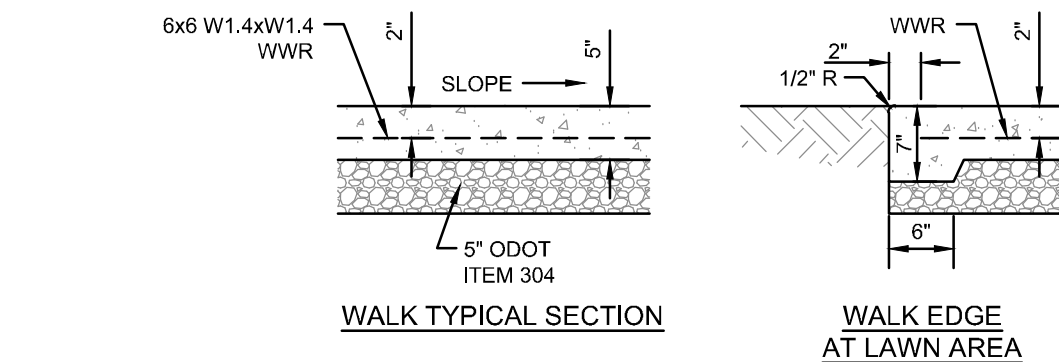
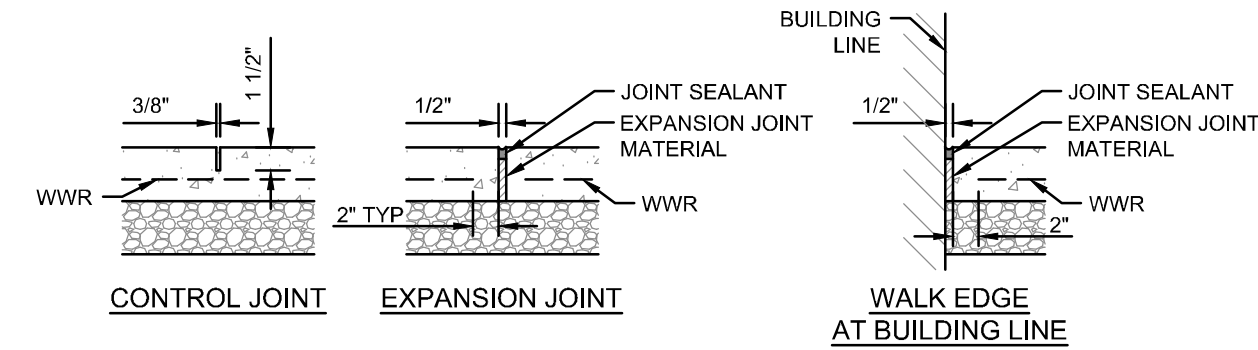

NOTES:

1. INSTALL EXPANSION JOINTS AT 30' OC MAXIMUM AND WHERE SLAB ABUTS STRUCTURES. WHERE NEW WALK ABUTS ADJOINING WALK, SAWCUT EXISTING WALK TO NEAREST JOINT AND INSTALL EXPANSION JOINT. EXPANSION JOINTS SHALL BE 12" WIDE BY DEPTH OF SLAB. SEAL ALL EXPANSION JOINTS.
2. INSTALL CONTROL JOINTS AT 6' OC MAXIMUM. CONTROL JOINTS SHALL BE 3/8" WIDE BY 1 1/2" DEEP AND TOOLED. SAWED JOINTS ARE NOT PERMITTED.
3. WALK SHALL HAVE A MINIMUM CROSS SLOPE OF 1.00%, MAXIMUM CROSS SLOPE OF 2.00%.
4. WATER AND UTILITY BOXES IN THE WALK AREA SHALL BE ADJUSTED FLUSH WITH THE FINAL SURFACE.
5. REFER TO ARCHITECTURAL PLANS FOR ADDITIONAL DETAIL AT ALL BUILDING DOORS.
6. JOINTING PLANS MUST BE SUBMITTED FOR APPROVAL.

EXTERIOR CONCRETE SLAB WALK DETAIL
N.T.S.

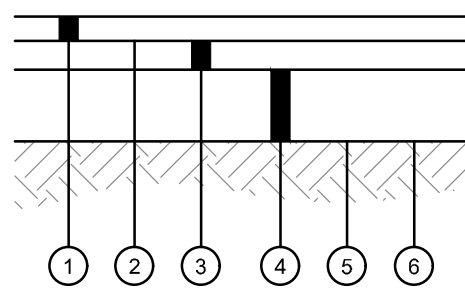

- 1 1 1/2" ODOT ITEM 441 ASPHALT CONCRETE SURFACE COURSE, TYPE 1, PG64-22
- 2 ODOT ITEM 407 TACK COAT, APPLY IF TIME BETWEEN ASPHALT LIFTS EXCEEDS 30 DAYS
- 3 4" ODOT ITEM 441 ASPHALT CONCRETE INTERMEDIATE COURSE, TYPE 2, PG64-22
- 4 8" ODOT ITEM 304 AGGREGATE BASE
- 5 WOVEN GEOTEXTILE FABRIC, ODOT ITEM 712.09 TYPE D
- 6 SUBGRADE COMPACTION, REFERENCE ODOT ITEM 204, EARTHWORK SPECIFICATION 312000 AND SOILS REPORT

HEAVY DUTY ASPHALT PAVEMENT DETAIL
N.T.S.

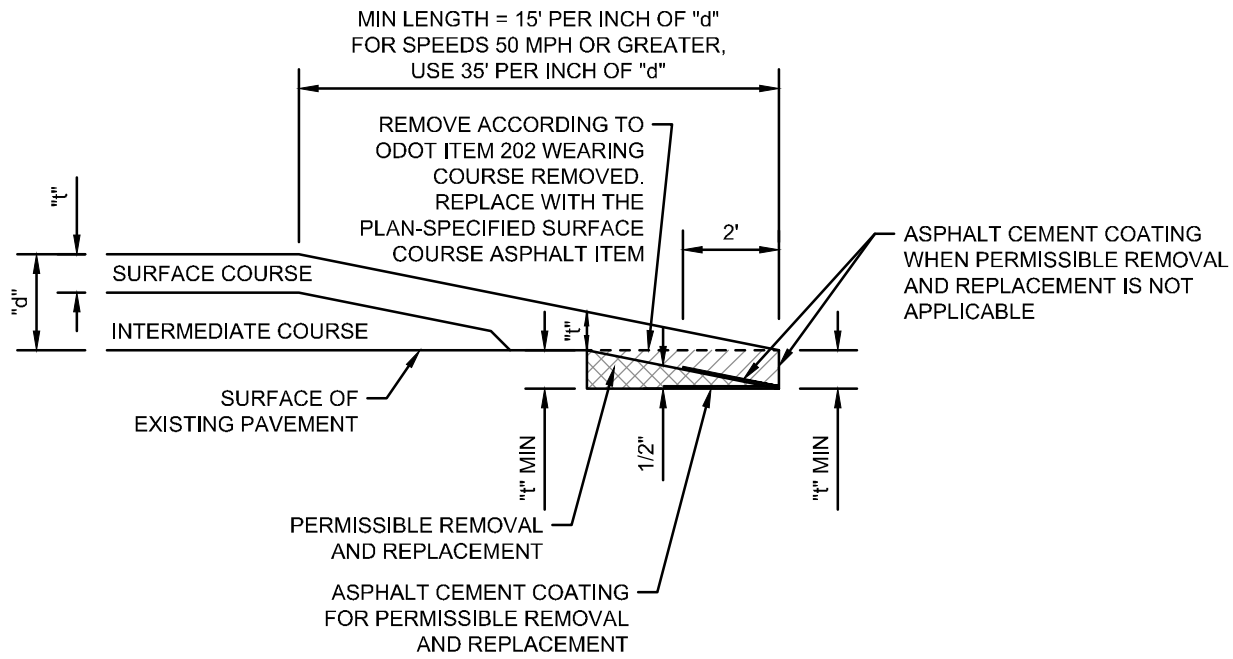

ASPHALT PAVING BUTT JOINT DETAIL
N.T.S.

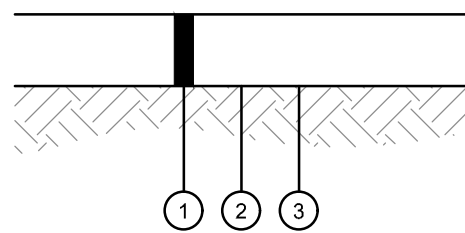

- 1 4" ODOT ITEM 304 AGGREGATE BASE
- 2 WOVEN GEOTEXTILE FABRIC, ODOT ITEM 712.09 TYPE D
- 3 SUBGRADE COMPACTION, REFERENCE ODOT ITEM 204, EARTHWORK SPECIFICATION 312000 AND SOILS REPORT

GRAVEL PAVEMENT DETAIL
N.T.S.

NOTE:
UNDERGROUND UTILITIES ARE PLOTTED FROM A
COMPILATION OF AVAILABLE RECORD INFORMATION AND
SURFACE INDICATIONS OF UNDERGROUND STRUCTURES AND
MAY NOT BE INCLUSIVE. PRECISE LOCATIONS AND THE
EXISTENCE OR NON EXISTENCE OF UNDERGROUND UTILITIES
CANNOT BE VERIFIED. PLEASE NOTIFY THE OHIO UTILITY
PROTECTION SERVICE AT 811 OR 1-800-362-2764 BEFORE ANY
PERIOD OF EXCAVATION OR CONSTRUCTION ACTIVITY.



CIVIL ENGINEERING
SURVEYING
LANDSCAPE
ARCHITECTURE

www.kleingers.com
6219 Centre Park Dr.
West Chester, OH 45069
513.779.7851

RIVER VALLEY LOCAL SCHOOL
DISTRICT
2024 PAVEMENT REHABILITATION

RIVER VALLEY LOCAL SCHOOLS
197 BROCKLESBY RD
CALEDONIA, OHIO 43314

SEAL:

NO.	DATE	DESCRIPTION
1	03/12/2024	BID SET
2	03/19/2024	ADDENDUM 1
3	03/27/2024	ADDENDUM 2

RIVER VALLEY
LOCAL SCHOOL
DISTRICT 2024
PAVEMENT
REHABILITATION

PROJECT NO: 220836.002

DATE: MARCH 2024

SCALE:

SHEET NAME:

GENERAL NOTES
& DETAILS

SHEET NO.

C1.0

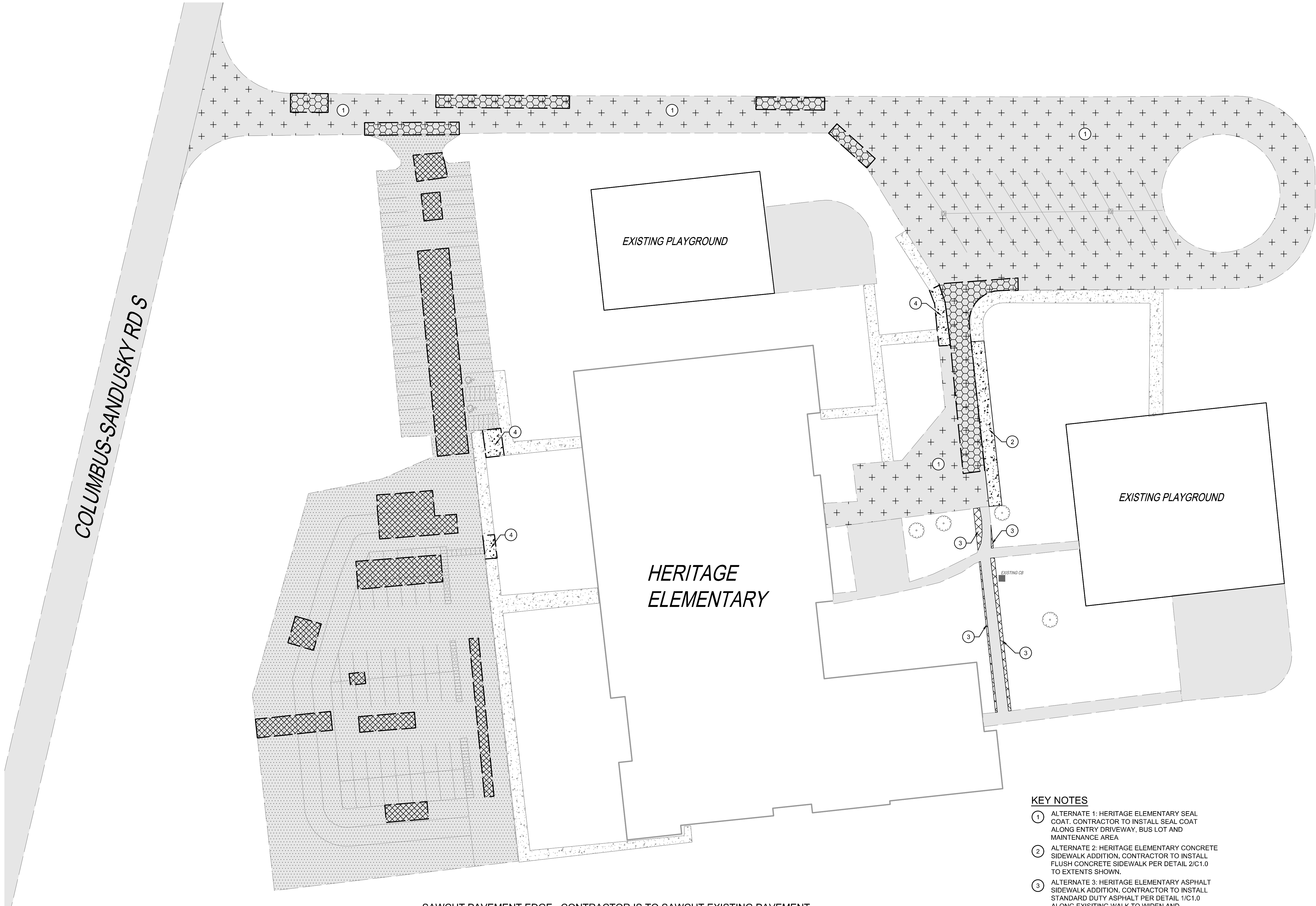

--- SAWCUT PAVEMENT EDGE. CONTRACTOR IS TO SAWCUT EXISTING PAVEMENT IN NEAT, STRAIGHT LINES TO CREATE A CLEAN BUTT JOINT. COAT EDGE OF EXISTING PAVEMENT WITH TACK COAT PRIOR TO PLACING AND COVER JOINT WITH SEALANT.

- EXISTING CONCRETE
- CONCRETE PER DETAIL 2/C1.0
- EXISTING PAVEMENT

- BASE BID ADD: 2" MILL, 0.5" LEVELING COURSE, 1.5" SURFACE COURSE
- ALTERNATE 1: SEAL COAT
- BASE BID: REMOVE EXISTING PAVEMENT FULL DEPTH AND PATCH PER DETAIL 1/C1.0
- BASE BID: REMOVE EXISTING PAVEMENT FULL DEPTH AND PATCH PER DETAIL 3/C1.0

KEY NOTES

- 1 ALTERNATE 1: HERITAGE ELEMENTARY SEAL COAT. CONTRACTOR TO INSTALL SEAL COAT ALONG ENTRY DRIVEWAY, BUS LOT AND MAINTENANCE AREA
- 2 ALTERNATE 2: HERITAGE ELEMENTARY CONCRETE SIDEWALK ADDITION. CONTRACTOR TO INSTALL FLUSH CONCRETE SIDEWALK PER DETAIL 2/C1.0 TO EXTENTS SHOWN.
- 3 ALTERNATE 3: HERITAGE ELEMENTARY ASPHALT SIDEWALK ADDITION. CONTRACTOR TO INSTALL STANDARD DUTY ASPHALT PER DETAIL 1/C1.0 ALONG EXISTING WALK TO WIDEN AND STRAIGHTEN WALK TO EXTENTS SHOWN.
- 4 BASE BID: SAWCUT CONCRETE AT NEAREST JOIN TO REMOVE AND REPLACE

PLAN NOTES:

- 1. SEAL 4,000 LF OF CRACKS THIS SHEET
- 2. RESTRIPE PAVEMENT TO MATCH EXISTING WHEN EXISTING STRIPING IS DISTURBED BY CONSTRUCTION ACTIVITY. STRIPING ON THIS PLAN IS SHOWN FOR REFERENCE ONLY. CONTRACTOR TO FIELD VERIFY STRIPING BEFORE CONSTRUCTION BEGINS.

NOTE: UNDERGROUND UTILITIES ARE PLOTTED FROM A COMPILATION OF AVAILABLE RECORD INFORMATION AND SURFACE INDICATIONS OF UNDERGROUND STRUCTURES AND MAY NOT BE INCLUSIVE. PRECISE LOCATIONS AND THE EXISTENCE OR NON EXISTENCE OF UNDERGROUND UTILITIES CANNOT BE VERIFIED. PLEASE NOTIFY THE OHIO UTILITY PROTECTION SERVICE AT 811 OR 1-800-362-2764 BEFORE ANY PERIOD OF EXCAVATION OR CONSTRUCTION ACTIVITY.



CIVIL ENGINEERING
SURVEYING
LANDSCAPE
ARCHITECTURE

www.kleingers.com
6219 Centre Park Dr.
West Chester, OH 45069
513.779.7851

RIVER VALLEY LOCAL SCHOOL
DISTRICT
2024 PAVEMENT REHABILITATION

RIVER VALLEY LOCAL SCHOOLS
197 BROCKLESBY RD
CALEDONIA, OHIO 43314

SEAL:

NO.	DATE	DESCRIPTION
1	03/12/2024	BID SET
2	03/19/2024	ADDENDUM 1
3	03/27/2024	ADDENDUM 2

RIVER VALLEY
LOCAL SCHOOL
DISTRICT 2024
PAVEMENT
REHABILITATION

PROJECT NO: 220836,002

DATE: MARCH 2024

SCALE:

0 15 30 60

SHEET NAME:

HERITAGE
ELEMENTARY
720 COLUMBUS-SANDUSKY RD S,
MARION, OH 43302

SHEET NO:

C2.0

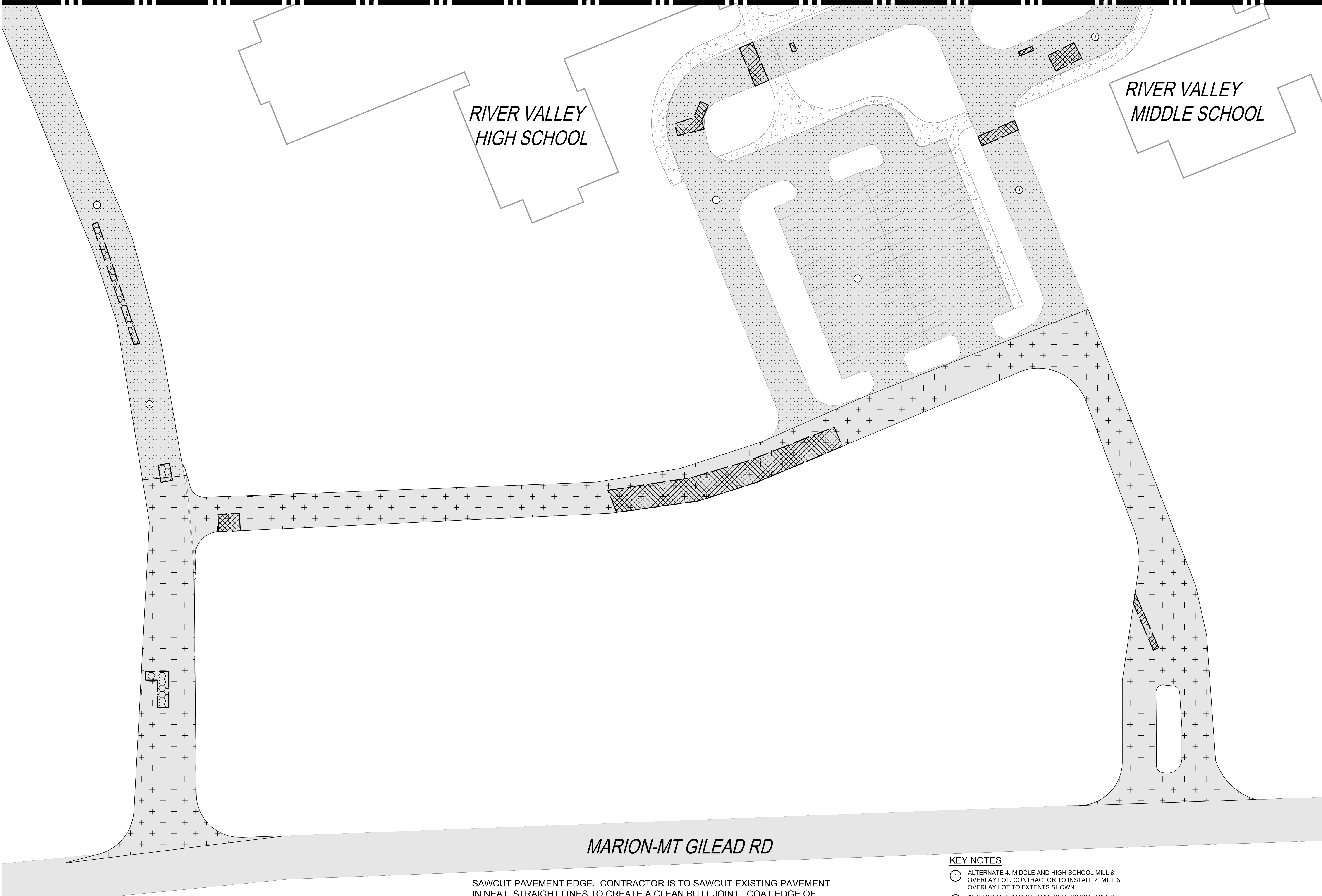

NOTE:
UNDERGROUND UTILITIES ARE PLOTTED FROM A
COMPILATION OF AVAILABLE RECORD INFORMATION AND
SURFACE INDICATIONS OF UNDERGROUND STRUCTURES AND
MAY NOT BE INCLUSIVE. PRECISE LOCATIONS AND THE
EXISTENCE OR NON EXISTENCE OF UNDERGROUND UTILITIES
CANNOT BE VERIFIED. PLEASE NOTIFY THE OHIO UTILITY
PROTECTION SERVICE AT 811 OR 1-800-362-2764 BEFORE ANY
PERIOD OF EXCAVATION OR CONSTRUCTION ACTIVITY.



- | | | | |
|--|---------------------|--|---|
| | EXISTING CONCRETE | | ALTERNATES: 2" MILL, 0.5" LEVELING COURSE, 1.5" SURFACE COURSE |
| | EXISTING PAVEMENT | | BASE BID: REMOVE EXISTING PAVEMENT FULL DEPTH AND PATCH PER DETAIL 3/C1.0 |
| | BASE BID: SEAL COAT | | BASE BID: REMOVE EXISTING PAVEMENT FULL DEPTH AND PATCH PER DETAIL 1/C1.0 |

KEY NOTES

- ① ALTERNATE 4: MIDDLE AND HIGH SCHOOL MILL & OVERLAY LOT. CONTRACTOR TO INSTALL 2" MILL & OVERLAY LOT TO EXTENTS SHOWN
- ② ALTERNATE 5: MIDDLE AND HIGH SCHOOL MILL & OVERLAY NORTH DRIVE. CONTRACTOR TO INSTALL 2" MILL & OVERLAY DRIVE TO EXTENTS SHOWN

PLAN NOTES:

1. SEAL 2,000 LF OF CRACKS THIS SHEET.
2. RESTRIPE PAVEMENT TO MATCH EXISTING WHEN EXISITNG STRIPING IS DISTURBED BY CONSTRUCTION ACTIVITY. STRIPING ON THIS PLAN IS SHOWN OF FOR REFERENCE ONLY. CONTRACTOR TO FIELD VERIFY STRIPING BEFORE CONSTRUCTION BEGINS.

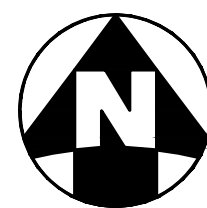

CIVIL ENGINEERING
SURVEYING
LANDSCAPE
ARCHITECTURE

www.kleingers.com
6219 Centre Park Dr.
West Chester, OH 45069
513.779.7851

RIVER VALLEY LOCAL SCHOOL
DISTRICT
2024 PAVEMENT REHABILITATION

RIVER VALLEY LOCAL SCHOOLS
197 BROCKLESBY RD
CALEDONIA, OHIO 43314

SEAL:

NO.	DATE	DESCRIPTION
1	03/12/2024	BID SET
2	03/19/2024	ADDENDUM 1
3	03/27/2024	ADDENDUM 2

RIVER VALLEY
LOCAL SCHOOL
DISTRICT 2024
PAVEMENT
REHABILITATION

PROJECT NO: 220836,002

DATE: MARCH 2024

SCALE:



SHEET NAME:

RIVER VALLEY MIDDLE
AND HIGH SCHOOLS
SOUTH LOT
4280 MARION-MT GILEAD RD,
CALEDONIA, OH 43314

SHEET NO:

C3.0

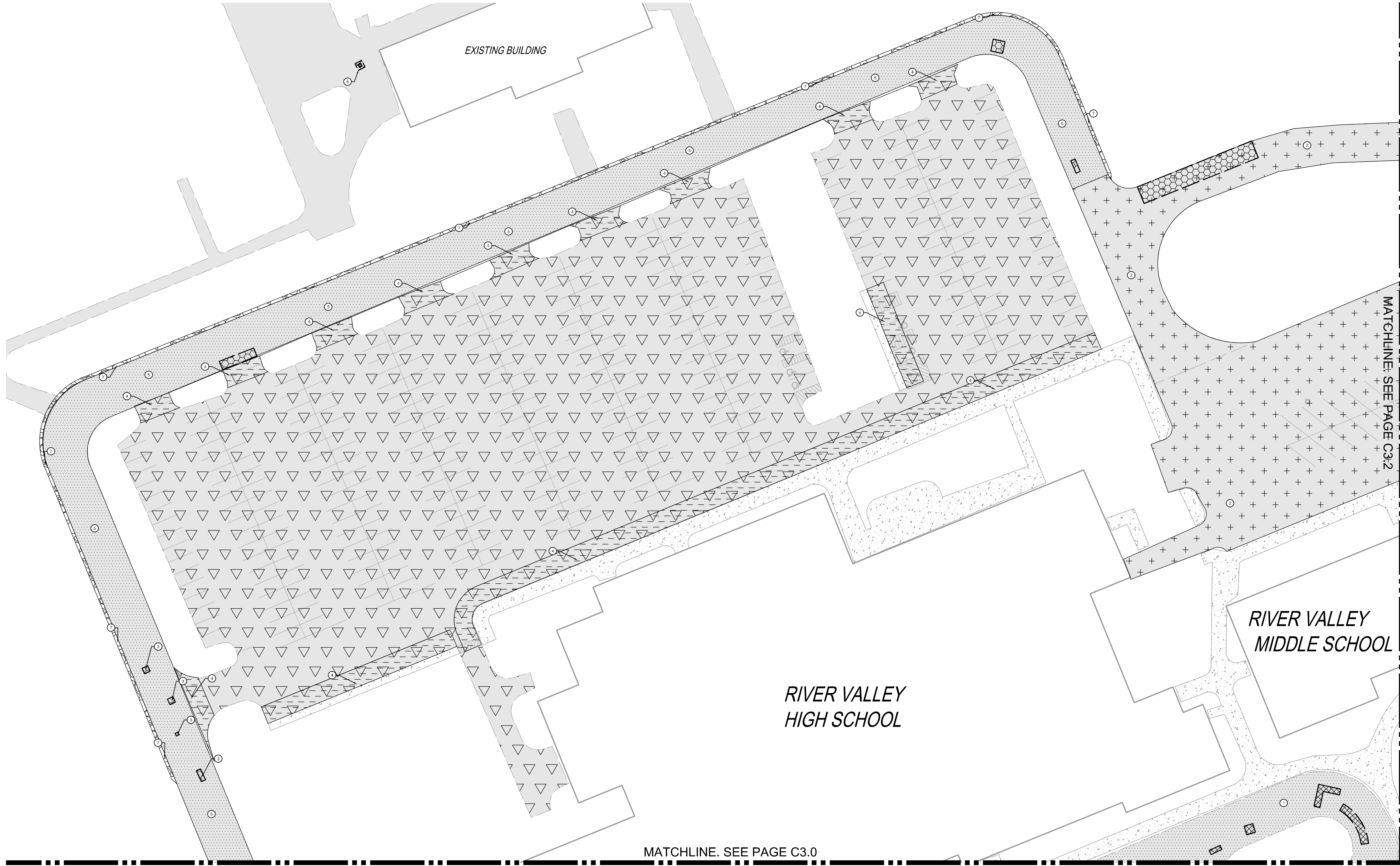

PLAN NOTES:

1. SEAL 4,000 LF OF CRACKS THIS SHEET
2. RESTRIPE PAVEMENT TO MATCH EXISTING WHEN EXISTING STRIPING IS DISTURBED BY CONSTRUCTION ACTIVITY. STRIPING ON THIS PLAN IS SHOWN FOR REFERENCE ONLY. CONTRACTOR TO FIELD VERIFY STRIPING BEFORE CONSTRUCTION BEGINS.

NOTE: UNDERGROUND UTILITIES ARE PLOTTED FROM A COMPILATION OF AVAILABLE RECORD INFORMATION AND SURFACE INDICATIONS OF UNDERGROUND STRUCTURES AND MAY NOT BE INCLUSIVE. PRECISE LOCATIONS AND THE EXISTENCE OR NON-EXISTENCE OF UNDERGROUND UTILITIES CANNOT BE VERIFIED. PLEASE NOTIFY THE OHIO UTILITY PROTECTION SERVICE AT 811 OR 1-800-362-2764 BEFORE ANY PERIOD OF EXCAVATION OR CONSTRUCTION ACTIVITY.



- SAWCUT PAVEMENT EDGE. CONTRACTOR IS TO SAWCUT EXISTING PAVEMENT IN NEAT, STRAIGHT LINES TO CREATE A CLEAN BUTT JOINT. COAT EDGE OF EXISTING PAVEMENT WITH TACK COAT PRIOR TO PLACING AND COVER JOINT WITH SEALANT.
- EXISTING CONCRETE
- SEAL COAT
- EXISTING PAVEMENT
- ALTERNATE 10: 2' GRAVEL SHOULDER PER DETAIL 5/C1.0
- ALTERNATES: 2" MILL, 0.5" LEVELING COURSE, 1.5" SURFACE COURSE
- BASE BID: REMOVE EXISTING PAVEMENT FULL DEPTH AND PATCH PER DETAIL 3/C1.0
- BASE BID: REMOVE EXISTING PAVEMENT FULL DEPTH AND PATCH PER DETAIL 1/C1.0
- BASE BID: 0.5" LEVELING COURSE, 1.5" SURFACE COURSE
- BASE BID: CONTRACTOR TO MILL AREA BEFORE INSTALLING 2" OVERLAY PER DETAIL 4/C1.0

KEY NOTES

1. ALTERNATE 4: MIDDLE AND HIGH SCHOOL MILL & OVERLAY LOT. CONTRACTOR TO INSTALL 2" MILL AND OVERLAY LOT TO EXTENTS SHOWN.
2. ALTERNATE 6: MIDDLE AND HIGH SCHOOL SEAL COAT BUS LOT. CONTRACTOR TO INSTALL SEAL COAT IN BUS LOT TO EXTENTS SHOWN.
3. HEAVY DUTY ASPHALT PATCH FULL DEPTH PER DETAIL 3/C1.0
4. CONTRACTOR TO MILL AREA BEFORE INSTALLING 2" OVERLAY PER DETAIL 4/C1.0
5. ALTERNATE 5: MIDDLE AND HIGH SCHOOL MILL & OVERLAY NORTH DRIVE. CONTRACTOR TO INSTALL 2" MILL & OVERLAY LOT TO EXTENTS SHOWN.
6. BASE BID: 5' x 5' STANDARD DUTY PATCH PER DETAIL 1/C1.0 AROUND EXISTING CATCHBASIN
7. ALTERNATE 10: MIDDLE AND HIGH SCHOOL GRAVEL SHOULDER. CONTRACTOR TO INSTALL GRAVEL SHOULDER ALONG NORTH DRIVE PER DETAIL 5/C1.0



CIVIL ENGINEERING
SURVEYING
LANDSCAPE
ARCHITECTURE

www.kleingers.com
6219 Centre Park Dr.
West Chester, OH 45069
513.779.7851

**RIVER VALLEY LOCAL SCHOOL
DISTRICT
2024 PAVEMENT REHABILITATION**

**RIVER VALLEY LOCAL SCHOOLS
197 BROCKLESBY RD
CALEDONIA, OHIO 43314**

SEAL:

NO.	DATE	DESCRIPTION
1	03/12/2024	BID SET
2	03/19/2024	ADDENDUM 1
3	03/27/2024	ADDENDUM 2

**RIVER VALLEY LOCAL SCHOOL
DISTRICT 2024
PAVEMENT
REHABILITATION**

PROJECT NO: 220836.002

DATE: MARCH 2024

SCALE:

0 15 30 60

SHEET NAME:

**RIVER VALLEY MIDDLE
AND HIGH SCHOOLS
NORTH LOT
4280 MARION-MT GILEAD RD,
CALEDONIA, OH 43314**

SHEET NO.

C3.1

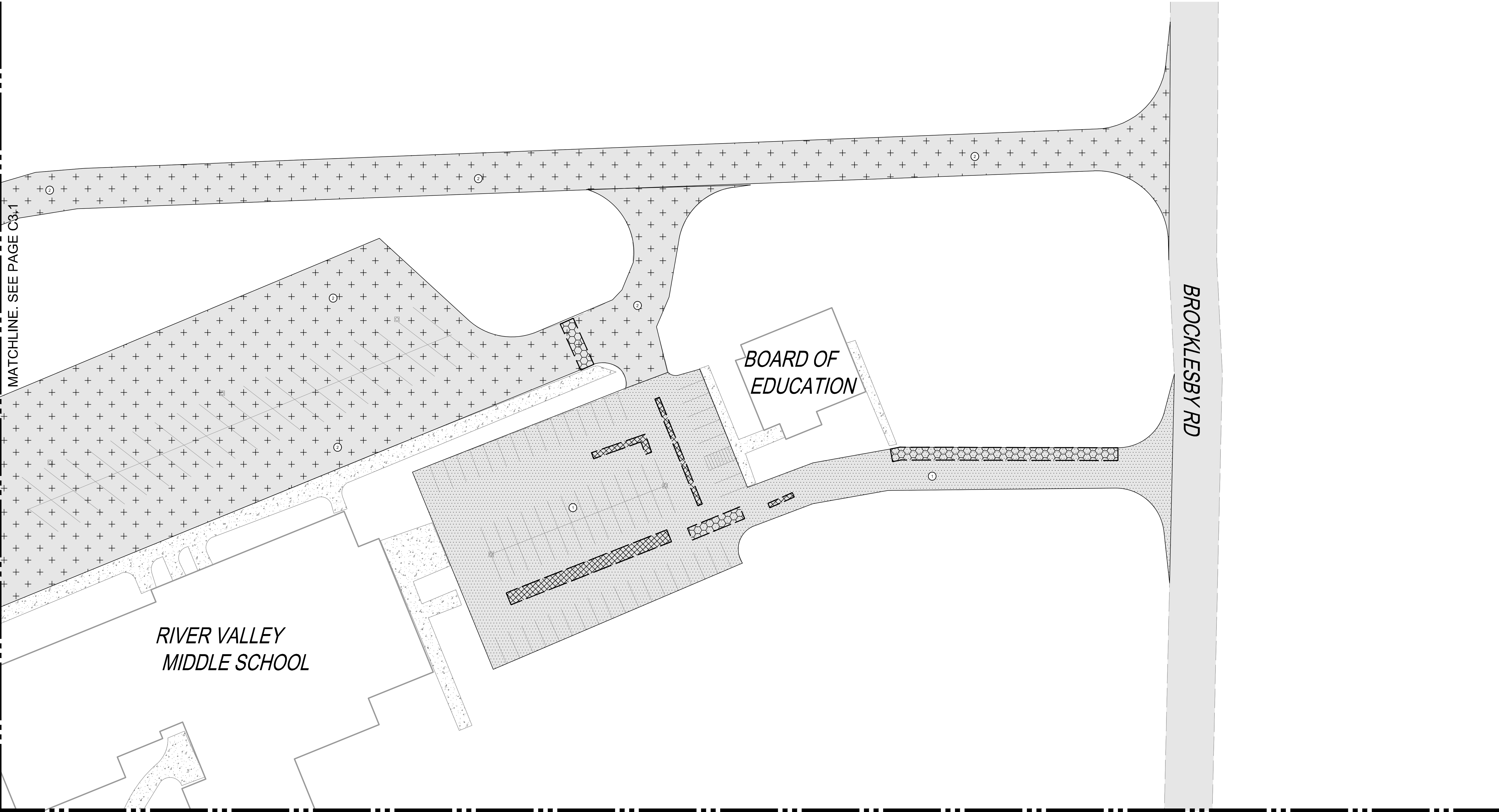

NOTE:
UNDERGROUND UTILITIES ARE PLOTTED FROM A
COMPILATION OF AVAILABLE RECORD INFORMATION AND
SURFACE INDICATIONS OF UNDERGROUND STRUCTURES AND
MAY NOT BE INCLUSIVE. PRECISE LOCATIONS AND THE
EXISTENCE OR NON EXISTENCE OF UNDERGROUND UTILITIES
CANNOT BE VERIFIED. PLEASE NOTIFY THE OHIO UTILITY
PROTECTION SERVICE AT 811 OR 1-800-362-2764 BEFORE ANY
PERIOD OF EXCAVATION OR CONSTRUCTION ACTIVITY.



SAWCUT PAVEMENT EDGE. CONTRACTOR IS TO SAWCUT EXISTING PAVEMENT IN NEAT, STRAIGHT LINES TO CREATE A CLEAN BUTT JOINT. COAT EDGE OF EXISTING PAVEMENT WITH TACK COAT PRIOR TO PLACING AND COVER JOINT WITH SEALANT.

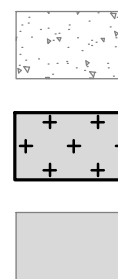

EXISTING CONCRETE
SEAL COAT
EXISTING PAVEMENT

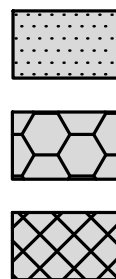

ALTERNATE 7: 2" MILL, 0.5" LEVELING COURSE, 1.5" SURFACE COURSE
BASE BID: REMOVE EXISTING PAVEMENT FULL DEPTH AND PATCH PER DETAIL 3/C1.0
BASE BID: REMOVE EXISTING PAVEMENT FULL DEPTH AND PATCH PER DETAIL 1/C1.0

KEY NOTES

- 1. ALTERNATE 7: BOARD OF EDUCATION MILL AND OVERLAY LOT. CONTRACTOR TO INSTALL 2" MILL & OVERLAY THE BOARD OF EDUCATION LOT TO EXTENTS SHOWN
- 2. ALTERNATE 6: MIDDLE AND HIGH SCHOOL SEAL COAT BUS LOT. CONTRACTOR TO INSTALL SEAL COAT IN BUS LOT TO EXTENTS SHOWN

PLAN NOTES:

- 1. SEAL 2,000 LF OF CRACKS THIS SHEET
- 2. RESTRIPE PAVEMENT TO MATCH EXISTING WHEN EXISITNG STRIPING IS DISTURBED BY CONSTRUCTION ACTIVITY. STRIPING ON THIS PLAN IS SHOWN OF FOR REFERENCE ONLY. CONTRACTOR TO FIELD VERIFY STRIPING BEFORE CONSTRUCTION BEGINS.

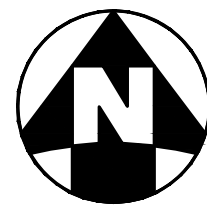

CIVIL ENGINEERING
SURVEYING
LANDSCAPE
ARCHITECTURE

www.kleingers.com
6219 Centre Park Dr.
West Chester, OH 45069
513.779.7851

RIVER VALLEY LOCAL SCHOOL DISTRICT
2024 PAVEMENT REHABILITATION

RIVER VALLEY LOCAL SCHOOLS
197 BROCKLESBY RD
CALEDONIA, OHIO 43314

SEAL:

NO	DATE	DESCRIPTION
1	03/12/2024	BID SET
2	03/19/2024	ADDENDUM 1
3	03/27/2024	ADDENDUM 2

RIVER VALLEY LOCAL SCHOOL DISTRICT 2024 PAVEMENT REHABILITATION

PROJECT NO: 220836.002

DATE: MARCH 2024

SCALE:

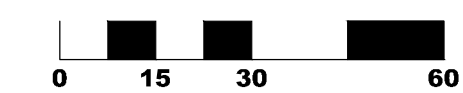

SHEET NAME:

RIVER VALLEY MIDDLE AND HIGH SCHOOLS EAST LOT
4280 MARION-MT GILEAD RD,
CALEDONIA, OH 43314

SHEET NO.

C3.2

NOTE:
UNDERGROUND UTILITIES ARE PLOTTED FROM A
COMPILATION OF AVAILABLE RECORD INFORMATION AND
SURFACE INDICATIONS OF UNDERGROUND STRUCTURES AND
MAY NOT BE INCLUSIVE. PRECISE LOCATIONS AND THE
EXISTENCE OR NON EXISTENCE OF UNDERGROUND UTILITIES
CANNOT BE VERIFIED. PLEASE NOTIFY THE OHIO UTILITY
PROTECTION SERVICE AT 811 OR 1-800-362-2764 BEFORE ANY
PERIOD OF EXCAVATION OR CONSTRUCTION ACTIVITY.

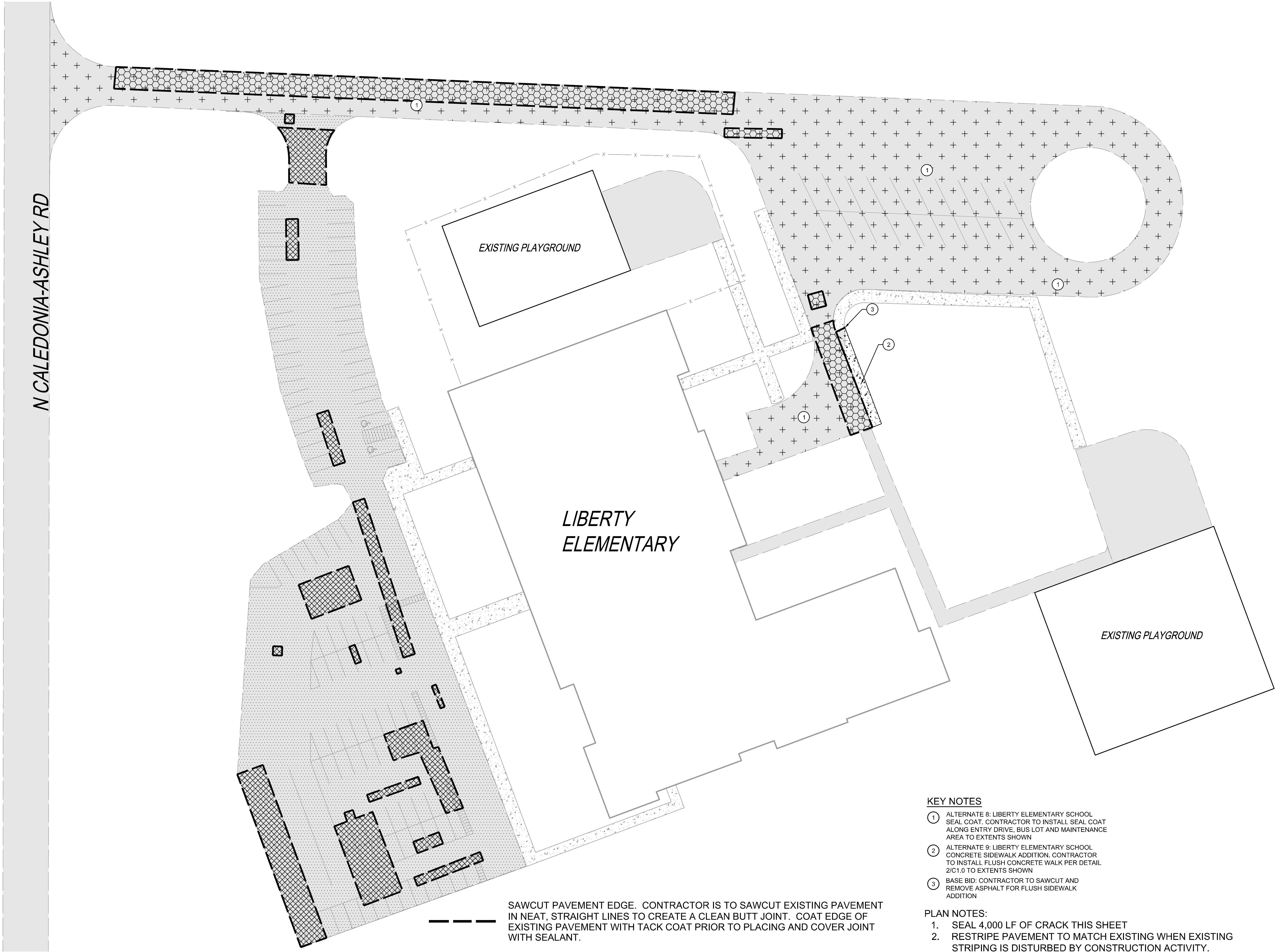

--- SAWCUT PAVEMENT EDGE. CONTRACTOR IS TO SAWCUT EXISTING PAVEMENT IN NEAT, STRAIGHT LINES TO CREATE A CLEAN BUTT JOINT. COAT EDGE OF EXISTING PAVEMENT WITH TACK COAT PRIOR TO PLACING AND COVER JOINT WITH SEALANT.

- EXISTING CONCRETE
- EXISTING PAVEMENT
- CONCRETE PER DETAIL 2/C1.0

- BASE BID: 2" MILL, 0.5" LEVELING COURSE, 1.5" SURFACE COURSE
- ALTERNATE 8: SEAL COAT
- BASE BID: REMOVE EXISTING PAVEMENT FULL DEPTH AND PATCH PER DETAIL 1/C1.0
- BASE BID: REMOVE EXISTING PAVEMENT FULL DEPTH AND PATCH PER DETAIL 3/C1.0

KEY NOTES

- 1 ALTERNATE 8: LIBERTY ELEMENTARY SCHOOL SEAL COAT. CONTRACTOR TO INSTALL SEAL COAT ALONG ENTRY DRIVE, BUS LOT AND MAINTENANCE AREA TO EXTENTS SHOWN
- 2 ALTERNATE 9: LIBERTY ELEMENTARY SCHOOL CONCRETE SIDEWALK ADDITION. CONTRACTOR TO INSTALL FLUSH CONCRETE WALK PER DETAIL 2/C1.0 TO EXTENTS SHOWN
- 3 BASE BID: CONTRACTOR TO SAWCUT AND REMOVE ASPHALT FOR FLUSH SIDEWALK ADDITION

PLAN NOTES:

- 1. SEAL 4,000 LF OF CRACK THIS SHEET
- 2. RESTRIPE PAVEMENT TO MATCH EXISTING WHEN EXISTING STRIPING IS DISTURBED BY CONSTRUCTION ACTIVITY. STRIPING ON THIS PLAN IS SHOWN FOR REFERENCE ONLY. CONTRACTOR TO FIELD VERIFY STRIPING BEFORE CONSTRUCTION BEGINS.



CIVIL ENGINEERING SURVEYING LANDSCAPE ARCHITECTURE
www.kleingers.com
6219 Centre Park Dr. West Chester, OH 45069
513.779.7851

RIVER VALLEY LOCAL SCHOOL DISTRICT
2024 PAVEMENT REHABILITATION

RIVER VALLEY LOCAL SCHOOLS
197 BROCKLESBY RD
CALEDONIA, OHIO 43314

SEAL:

NO.	DATE	DESCRIPTION
1	03/12/2024	BID SET
2	03/19/2024	ADDENDUM 1
3	03/27/2024	ADDENDUM 2

RIVER VALLEY LOCAL SCHOOL DISTRICT 2024 PAVEMENT REHABILITATION

PROJECT NO: 220836.002

DATE: MARCH 2024

SCALE:



SHEET NAME:

LIBERTY ELEMENTARY
1932 WHETSTONE RIVER RD N,
CALEDONIA, OH 43314

SHEET NO.

C4.0