

1 OVERALL SECOND FLOOR PLAN
 1/8" = 1'-0"

- ALTERATION NOTES:**
1. EXISTING CONDITIONS AS INDICATED ON THE ALTERATION DRAWINGS MAY VARY FROM ACTUAL CONDITIONS. BEFORE START OF WORK, VERIFY EXISTING CONDITIONS AS RELATED TO COMPLETION OF NEW PROJECT AND/OR SITE IMPROVEMENTS.
 2. NOTES TO CALL AND NOT DIMENSIONS FOR ADDITIONAL ALTERATION WORK INCLUDING MATERIAL, DIMENSIONS AND/OR COORDINATE OF EXISTING SERVICES SUCH AS MECHANICAL, PLUMBING AND/OR ELECTRICAL, ETC.
 3. BEFORE START OF A TRADE WORK, REVIEW AND PREPARE AN OWNED APPROVAL LIST OF EXISTING TRADES TO REMOVE AS OWNER'S PROPERTY. EQUIPMENT SHALL BE REMOVED AND STORED IN SECURE, CLEAN, DRY ON-SITE LOCATION. TRADES TO BE REMOVED AS REQUIRED UNDER RESPONSIBLE CONSTRUCTION CONDITIONS AND ALL IS RELATED TO COMPLETION OF NEW PROJECT AND/OR SITE IMPROVEMENTS.
 4. REMOVED UNFINISHED CONSTRUCTION MATERIALS OR FINISHED SHALL BE PROPERLY REMOVED OR RECYCLED AS REQUIRED TO MEET THE GOVERNING REGULATIONS AND ALL IS RELATED TO COMPLETION OF NEW PROJECT AND/OR SITE IMPROVEMENTS.
 5. OWNER RESERVES THE RIGHT TO BALANCE AND REMOVE ANY EXISTING TRADE BEFORE START OF ALTERATION WORK.

NOT FOR CONSTRUCTION

KEY PLAN

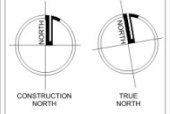
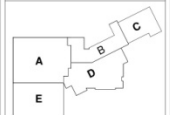

REVISIONS

NO.	DATE	DESCRIPTION OF CHANGE

CRABTREE ROHRBAUGH & ASSOCIATES - ARCHITECTS
 401 EAST WINDING HILL ROAD
 MECHANICSBURG, PA 17055
 717-458-0272 FAX 717-458-0047
www.cra-architects.com

ADDITIONS & RENOVATIONS TO THE
 STATE COLLEGE AREA HIGH SCHOOL - NORTH BUILDING
 STATE COLLEGE AREA SCHOOL DISTRICT
 STATE COLLEGE, PA 16801



OVERALL SECOND FLOOR PLAN
 Plot No.:
 1/8" = 1'-0"
 Title:
 Date: JULY 10, 2018

PROJECT
 2787
4A1.2