

LONG LAKE AND EASTWAYS ROADS TO CLOSE FOR CULVERT REPLACEMENTS

The Road Commission for Oakland County (RCOC), in partnership with the City of Bloomfield Hills, will replace two culverts under Long Lake and Eastways roads in the city. Each culvert is more than 70 years old and is at risk of failing. Each road will be closed temporarily while the culverts are replaced.

PROJECT DETAILS

- The Long Lake Road culvert will be replaced first. It is located between Eastways Road and Kernway Street.
- Once the Long Lake culvert replacement is finished, the Eastways culvert will be replaced. It is located between Long Lake Road and Parkman Drive.
- Both failing culverts are metal and will be replaced with concrete culverts.
- Both Long Lake and Eastways roads will be milled (the old pavement ground off) and resurfaced with asphalt in the vicinity of the culverts.
- Guardrails will be replaced in the vicinity of the culverts.

IMPACT ON TRAFFIC

- Each road will close while the culvert on that road is replaced.
- During the Long Lake culvert work, Long Lake Road will be closed to through traffic between Squirrel and Eastways roads.
- During the Long Lake closure, the **detour route for Long Lake through traffic** will be Squirrel Road to Square Lake Road to Eastways Road and vice versa.
- During the Eastways culvert work, Eastways will be closed to through traffic between Long Lake and Square Lake roads.
- During the Eastways closure, the **detour route for Eastways through traffic** will be Long Lake Road to Squirrel Road to Square Lake Road and vice versa.
- During the Long Lake closure, access to homes and side

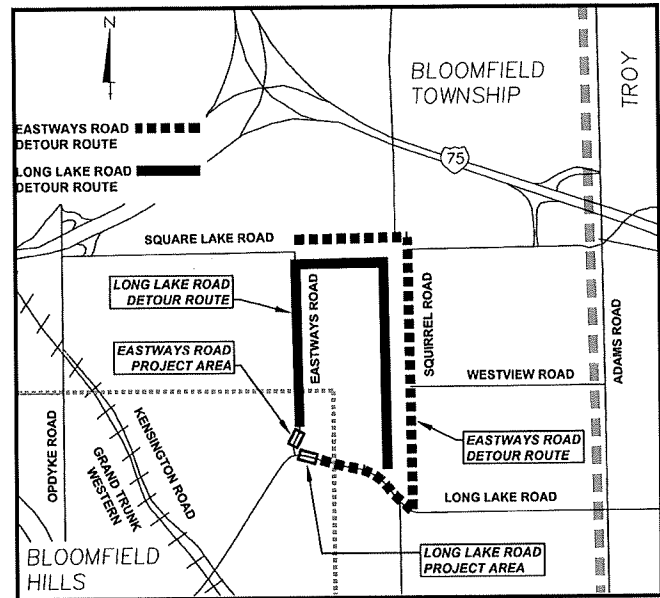

streets along Long Lake will be from either east or west of the full road closure at the culvert.

- During the Eastways closure, access to homes and side streets along Eastways will be via Eastways from either north or south of the full closure at the culvert.

SCHEDULE

- Water and gas main relocation work will take place in June. During that time, both Long Lake and Eastways will remain open to traffic but there will be single-lane closures with traffic directed by flaggers.
- Long Lake will close after July 4 and re-open by Aug. 16, prior to the Dream Cruise.
- Eastways will close after the Aug. 17 Dream Cruise and re-open in September.

PROJECT COST AND FUNDING

The project will cost \$900,000 and will be paid for by RCOC and Bloomfield Hills. The work will be performed by DePonio Contracting of Shelby Twp.

For more information:

Visit the RCOC Website, www.rcocweb.org: Click on the "Road Projects" icon and select "Baldwin/Clarkston Roundabout" from the list of projects.

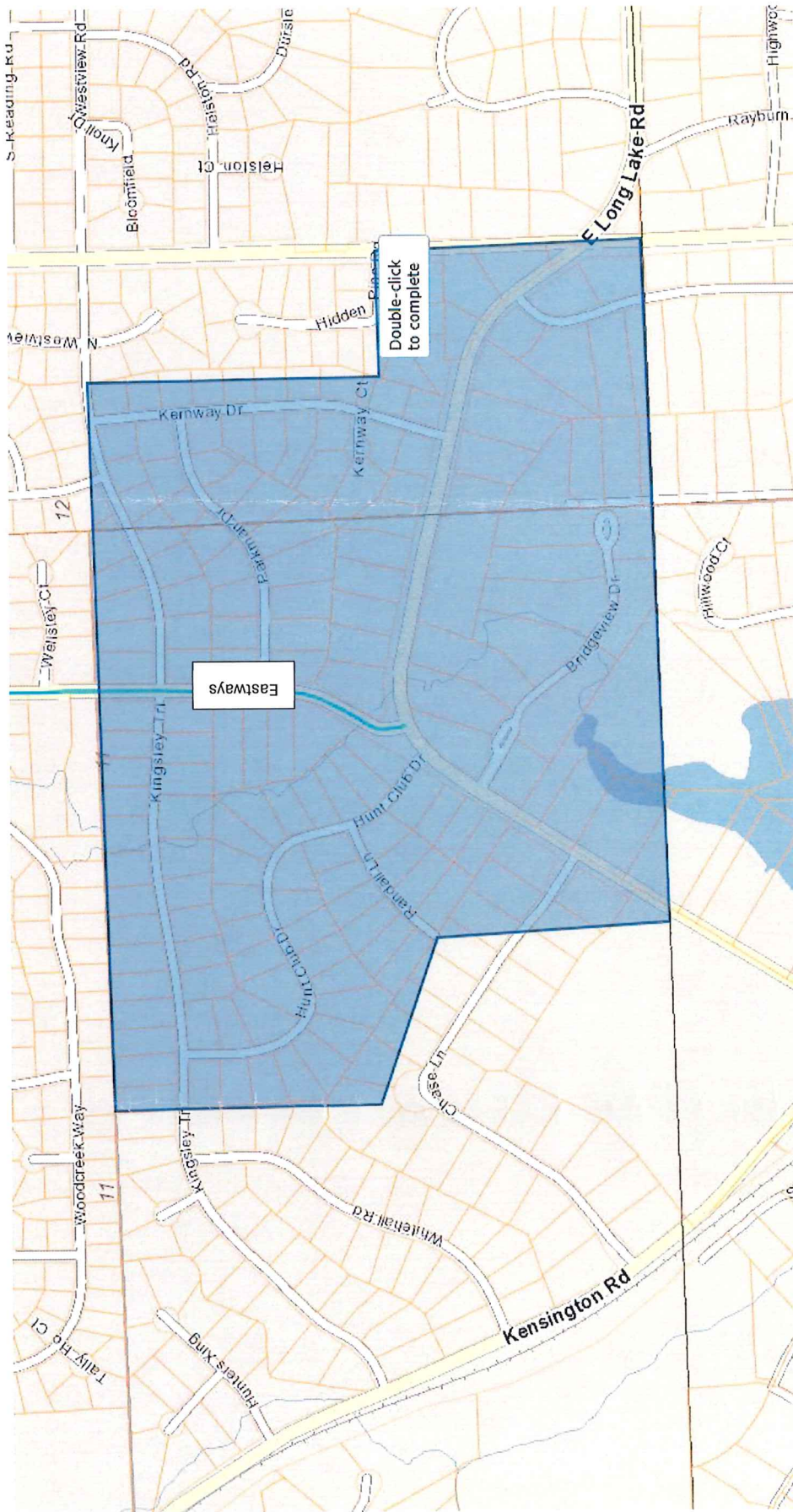

Eastways

Double-click to complete