

Early College High School New Support Building at Wilmot J. Fraser Campus

Community Brief

9 Dec 2021

Purpose

To gain community support and feedback as we design, construction, and equip the future Early College High School Support building located on the Wilmot J. Fraser Campus.



****Hampstead Park is not included or associated with this project.****

Agenda

- ECHS History
- Live-in Attendance
- Sales Tax Referendum Summary
- Priority Factors
- Project Scope
- ECHS New Support Building
- Next Steps

Early College High School History

- Originally opened as Eastside High School in 1962, was later renamed C.A. Brown
- ECHS opened in August 2017
- ECHS has a dedication to honor the legacy of C.A. Brown and the Eastside Community

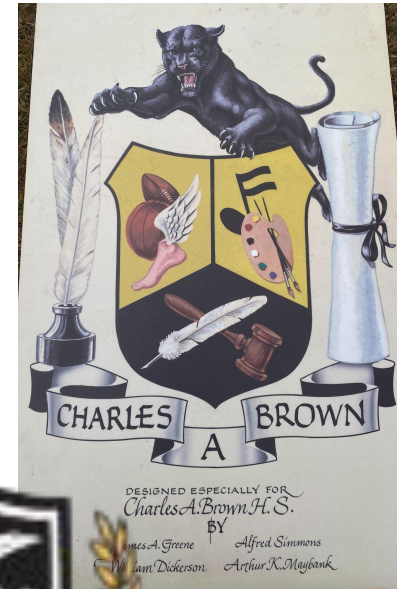

Early College High School

Who Do We Serve?

Demographic Breakdown by Year

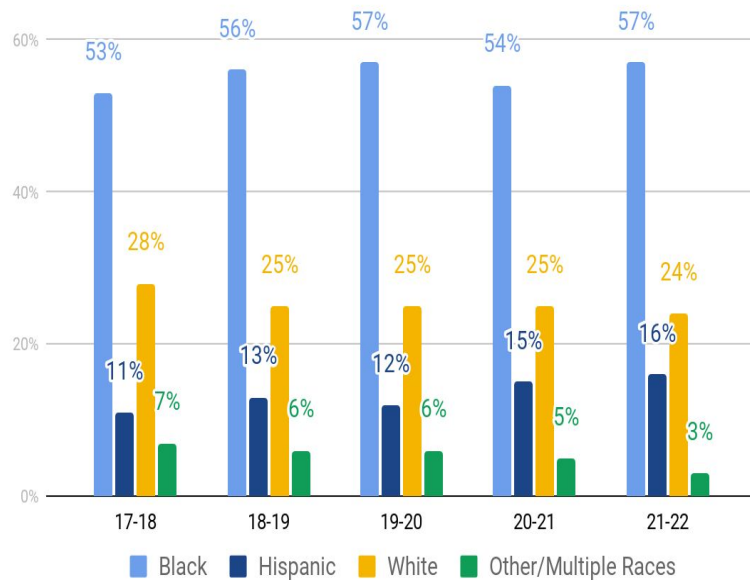

Year	Poverty Rate	Graduation Rate
17-18	67%	N/A
18-19	41%	N/A
19-20	77%	N/A
20-21	76%	100%
21-22	74%	TBD

73% of ECHS students report being first-generation college goers

Live-In Attendance

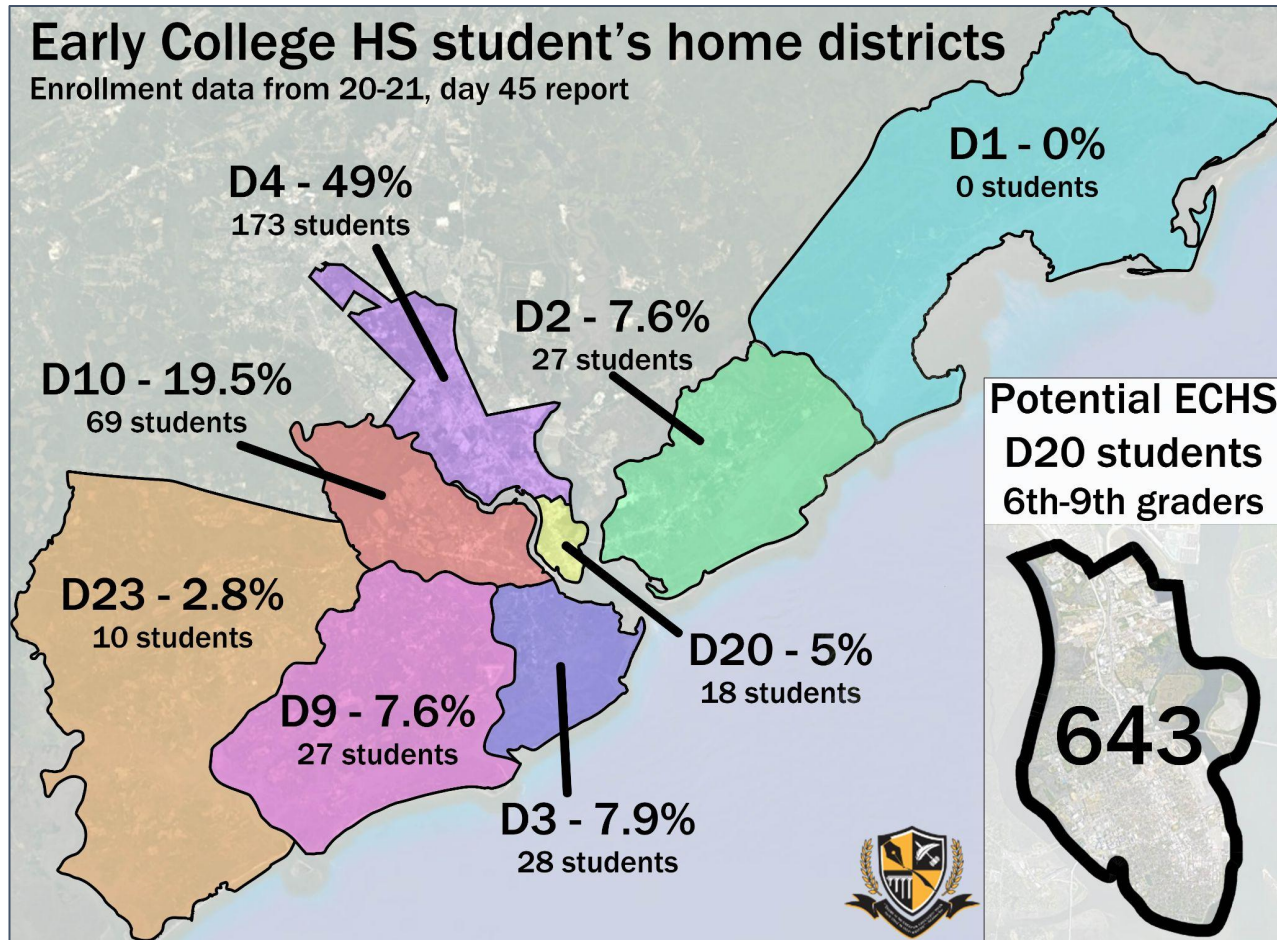

Sales Tax Referendum Summary



Board of Trustees

The Board of Trustees approved funded and unfunded projects

Charleston Voters

Voters passed the 2nd extension of the Capital Improvements Educational Sales and Use tax (2023-28)

Board of Trustees

Project waves were set by the Board

Early College Support building is in Wave 1 (2021 - 2024)

Design, construct, and equip support facilities for Early College High School on the Fraser Campus

CAPITAL PROJECTS DRAFT WAVES

Board approved on 22 Mar 2021

DRAFT LIST			PRIORITY FACTORS			
WAVE	PROJECT	PROPOSED SCOPE	MISSION CRITICAL	LIFE SAFETY/ GROWTH	FACILITY CONDITION	PROGRAM
1 (21-24)	Hursey	New 600 student; Demo existing		X	X	X
1 (21-24)	Ladson	New 900 student (1200 core) ES	X	X	X	
1 (21-24)	D9 Elementary School	New 600 student (900 core)	X	X	X	
1 (21-24)	Early College	New support building, Demo existing		X		X
1 (21-24)	Building Improvements	5 Tasks		X	X	
1 (21-24)	Athletic Improvements	5 Tasks			X	X
1 (21-24)	Paving Improvements	8 Tasks		X	X	
2 (22-25)	Lambs and Early Ed Center	New 1200 student and 300 student early ed center, Demo existing	X		X	X
2 (22-25)	Middle School Facilities West Ashley	To be determined	X		X	
2 (22-25)	Early Ed at JIMS campus	New 300 student early education and parent engagement center	X	X		X
2 (22-25)	St. John's Stadium	New pressbox, renovate stands and concession areas			X	X
3 (23-27)	D23 Additional Elementary School Capacity	To be determined			X	X
3 (23-27)	James B. Edwards	New 900 student, Demo of existing building		X		
3 (23-27)	Stall Expansion	300 student expansion, Demo or relocate 8 trailers		X	X	
3 (23-27)	Cario Expansion	300 student expansion, Demo or relocate 6 trailers		X	X	
3 (23-27)	Jl Charter Stadium	New pressbox, renovate stands and concession areas			X	X

Priority Factors - Capacity

ECHS Existing Cafeteria - small room, students mostly eat in the halls



vs.

Burke Cafeteria



Priority Factors - Capacity

ECHS Existing Gym - small room,
low ceilings

vs.

Burke Gym



10

Priority Factors - Capacity

ECHS Existing Gathering Space -
current facility has no space larger
than 50 people for gathering
without requiring costly rental

vs.

Burke Gathering Space



11

Priority Factors - Program

ECHS Existing Classroom - small rooms, low ceilings, little daylight

vs.

Burke Classroom

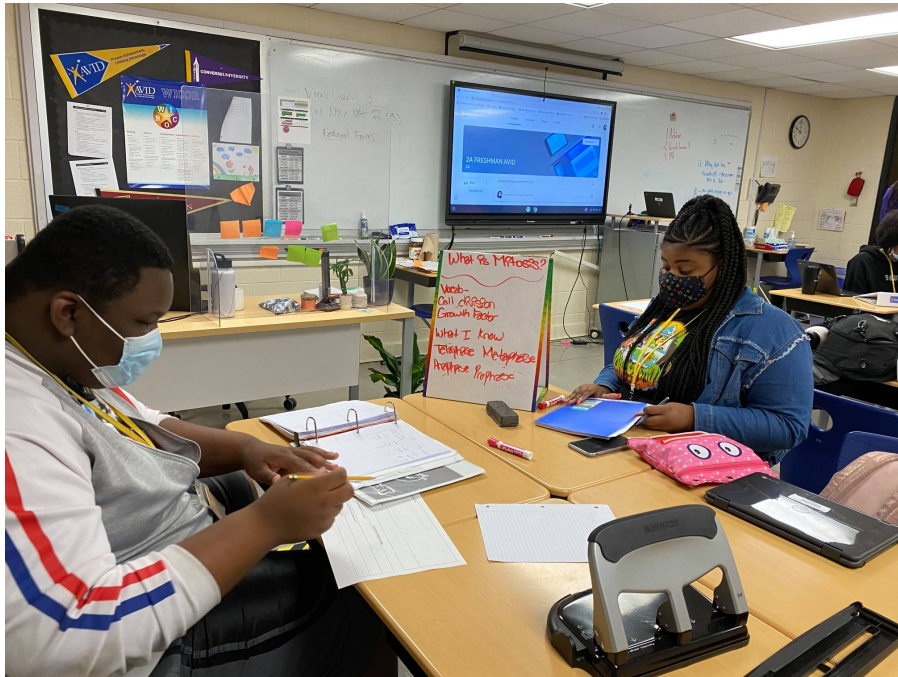

Project Scope

Construction Management:

BROWNSTONE

Design Firm:

liollo
architecture

Wilmot J. Fraser Campus



Total Budget: \$29.4M

Total Acres: 2.41

Design Start: Nov. 2021

Project Completed: Aug. 2024

13

New ECHS Support Building

- Cafeteria
 - Gym/Multipurpose Room
 - Nurse Suite
 - Administrative Suite
 - Locker Rooms
 - Guidance Suite
 - Senior AVID
 - 9th-11th Grade AVID
 - Large Gathering Space Areas
 - Project Labs
 - Science Labs
 - Library Space
- **Support facilities areas are subject to change based on school needs.****

Preserve the legacy of Wilmot J. Fraser and school

14

Conceptual Site Layout

~65,000 sq. ft. (building only)

****Hampstead Park is not included or associated with this project.****

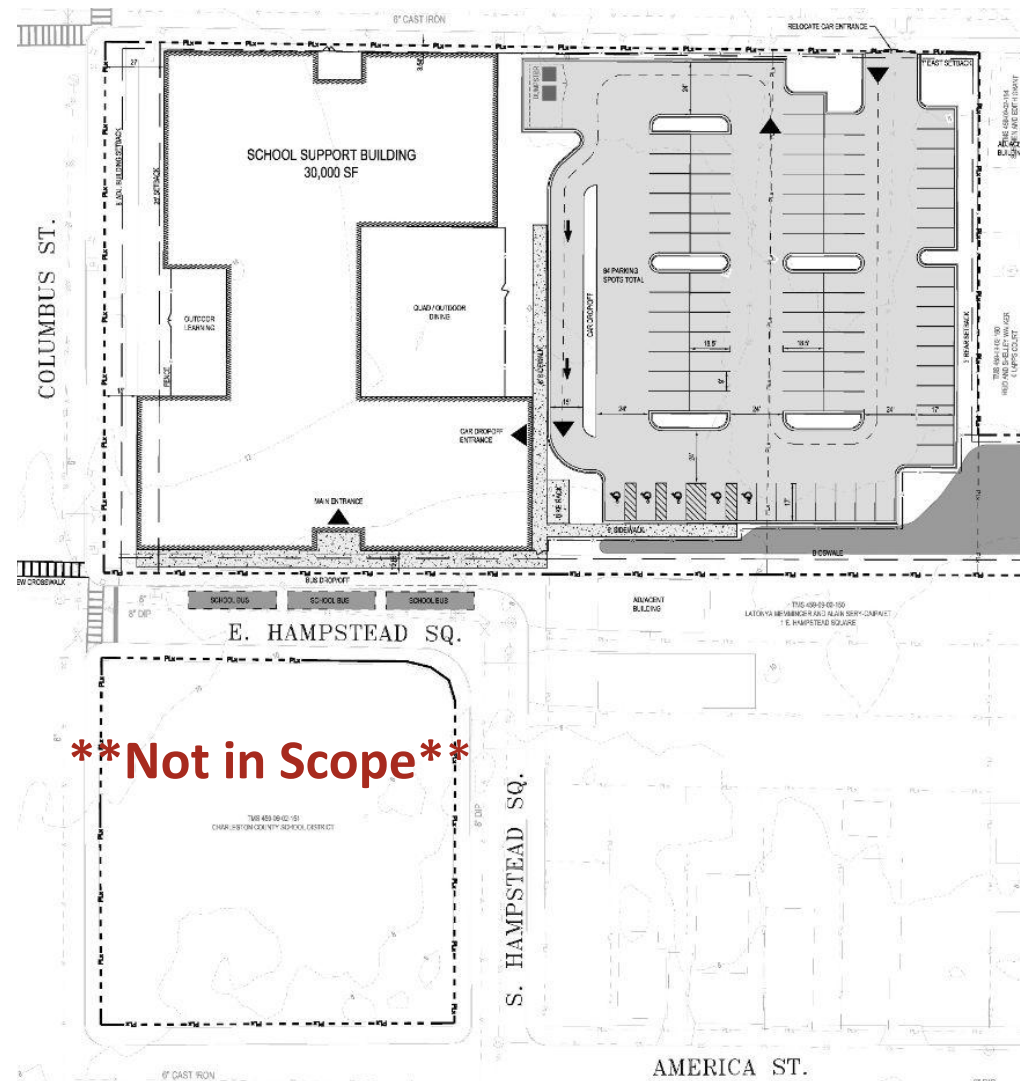

Community Updates

Word cloud containing the following terms:

- Traffic Patterns
- Soil/Foundation
- Schedule
- Concerns
- History
- Fraser Campus
- Laydown Area
- Building
- Foundation
- Stormwater
- ECHS
- Support Building
- Name
- Parking
- Safety
- Construction
- Equipment
- Noise
- Crosswalk
- Work Hours

Next Steps

Project Timeline & Construction Site

Design: **Nov 21' - Nov 22'**

- Technical Review Committee
- Board of Architectural Review
- Drawings Schematic/Devlp./Const.
- Permitting

Bid: **November 2022**

Construction: **December 2022**
Begins

Construction: **July 2024**
Ends

School Opens: **August 2024**

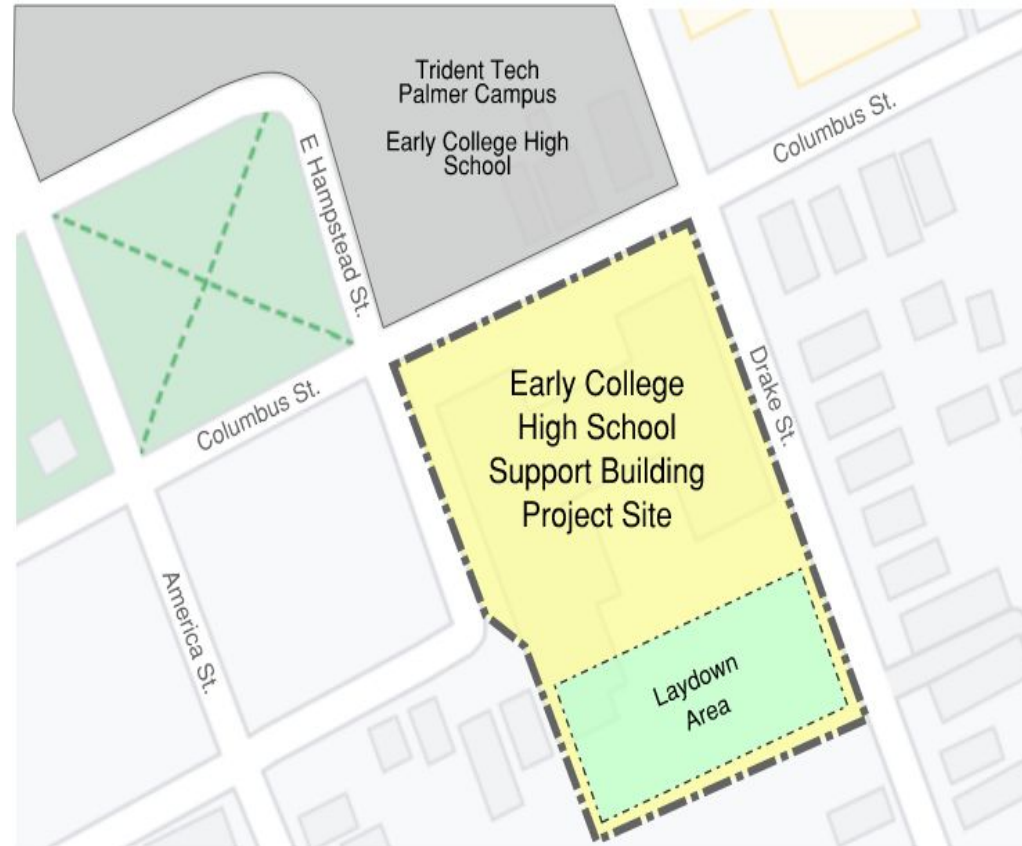

Next Steps

Design Development

- Liollo will design and develop blueprints and a detailed layout of the Early College High New Support Building

Community Engagement (Tour)

- Registration (must register in advance)
 - December 10, 2021 @ 3pm
 - Tour Early College HS campus & Fraser campus
 - Meeting Location: Fraser Campus front door

Registration Link:

<https://forms.gle/P2xjU7XRQNfzyQCs6>

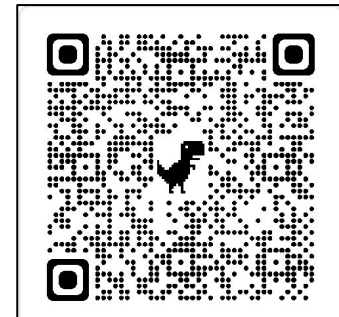

Community Feedback

Your input is essential

Fill out one of our comment cards
or

Email comments to
capital@charleston.k12.sc.us