

MOVEMENT DIAGRAM																																								
NTOR	PHASE 1				PHASE 2				PHASE 3				PHASE 4 PRE-EMPT 2				PHASE 5				PHASE 6 PRE-EMPT 1				PHASE 7				PHASE 8											
	FLASH	GRN	CL	CL	GRN	CL	CL	CL	GRN	CL	CL	CL	GRN	CL	CL	CL	GRN	CL	CL	CL	GRN	CL	CL	CL	GRN	CL	CL	CL	GRN	CL	CL	CL	GRN	CL	CL	CL	GRN	CL	CL	CL
1	Y	←R	←Y	R	R	R	R	R	R	R	R	R	R	R	R	R	R	R	R	R	R	R	R	R	R	R	R	R	R	R	R	R	R	R	R	R	R	R	R	R
2	Y	R	R	R	R	R	R	R	R	R	R	R	R	R	R	R	R	R	R	R	R	R	R	R	R	R	R	R	R	R	R	R	R	R	R	R	R	R	R	R
3	R	R	R	R	R	R	R	R	R	R	R	R	R	R	R	R	R	R	R	R	R	R	R	R	R	R	R	R	R	R	R	R	R	R	R	R	R	R	R	R
4	R	R	R	R	R	R	R	R	R	R	R	R	R	R	R	R	R	R	R	R	R	R	R	R	R	R	R	R	R	R	R	R	R	R	R	R	R	R	R	R
5	Y	R	R	R	R	R	R	R	R	R	R	R	R	R	R	R	R	R	R	R	R	R	R	R	R	R	R	R	R	R	R	R	R	R	R	R	R	R	R	R
6	Y	R	R	R	R	R	R	R	R	R	R	R	R	R	R	R	R	R	R	R	R	R	R	R	R	R	R	R	R	R	R	R	R	R	R	R	R	R	R	R
P	OFF	←	←	DW	R	R	R	R	R	R	R	R	R	R	R	R	R	R	R	R	R	R	R	R	R	R	R	R	R	R	R	R	R	R	R	R	R	R	R	R

TECHNICAL NOTES		
STANDARD OVERLAP SKIP FEATURES APPLY		
PHASE 2 ON TO OMIT PHASE 5.		
PHASE 6 ON TO OMIT PHASE 1.		
PRE-EMPTION TO BE INOPERATIVE DURING FLASHING OPERATION.		
① PERCUSSIVE TONE ONLY DURING WALK INTERVAL.		
② COUNTDOWN ONLY DURING FLASHING PEDESTRIAN CHANGE INTERVAL.		

OFFICE RECORD		
REV # 9	TIR # N/A	SM # 100685
REV # 10	TIR # N/A	SM # N/A
REV # 11	TIR # N/A	SM # N/A
REV # 12	TIR # N/A	SM # N/A

INTERVALS												
MIN GRN	5											
WALK												
PED CLR												
VEH EXT	1.5											
MAX 1	10											
MAX 2	10											
YELLOW		3.0										
RED			1.0									
ADD INIT				4.1								
MAX INIT					1.6							
TBR												
TTR												
MIN GAP												
MODE	NON-LOCK			MIN RECALL			OFF			NON-LOCK		
INT START	THIS PHASE			THIS PHASE			THIS PHASE			THIS PHASE		

DETECTORS											
IDENT	SIZE (WXL) *	TYPE	MODE	SYSTEM LOC	COORDINATION TYPE: NONE	FUNCTION	PROGRAM TIME	DAYS	CYCLE	OFFSET	
D1	8' X 50'	VIDEO 360	PRESENCE			FLASH	FUTURE				
D2	10' X 16'	VIDEO 360	PRESENCE			MAX 1	ALL OTHER TIMES				
D2A	10' X 20'	VIDEO 360	PRESENCE			MAX 2	FUTURE				
D4	20' X 64'	VIDEO 360	PRESENCE								
D4A	20' X 67'	VIDEO 360	PRESENCE								
D5	8' X 48'	VIDEO 360	PRESENCE								
D6	9' X 18'	VIDEO 360	PRESENCE								
D6A	8' X 16'	VIDEO 360	PRESENCE								
SD1	10' X 30'	VIDEO 360	PRESENCE								
SD2	10' X 25'	VIDEO 360	PRESENCE								

SIGN LEGEND	
(A)	31-0183 (SPAN MOUNTED) ONLY
(B)	31-0823 (SPAN MTD.) N.TOR
(C)	51-6616 (83)
(D)	31-0630 (D) NO PARKING ANY TIME
(E)	51-6616 (83)
(F)	31-0282Z (INSTALL NEW TYPE 16 RAMPS)
(G)	31-0183 (SPAN MOUNTED) ONLY
(N)	VIDEO DETECTION BY USE OF VIDEO-360 CAMERA
(O)	CAT-5E CABLE RUN DIRECTLY FROM CAMERA TO CONTROLLER

SPAN POLE INFORMATION			
ID #	POLE LENGTH	CAMERA BRACKET LENGTH	YEAR INSTALLED
047-204-A	33'	22"	2005
047-204-B	32'	22"	2005
047-204-C	28'	20"	2005

NO.	DATE	REVISION DESCRIPTION

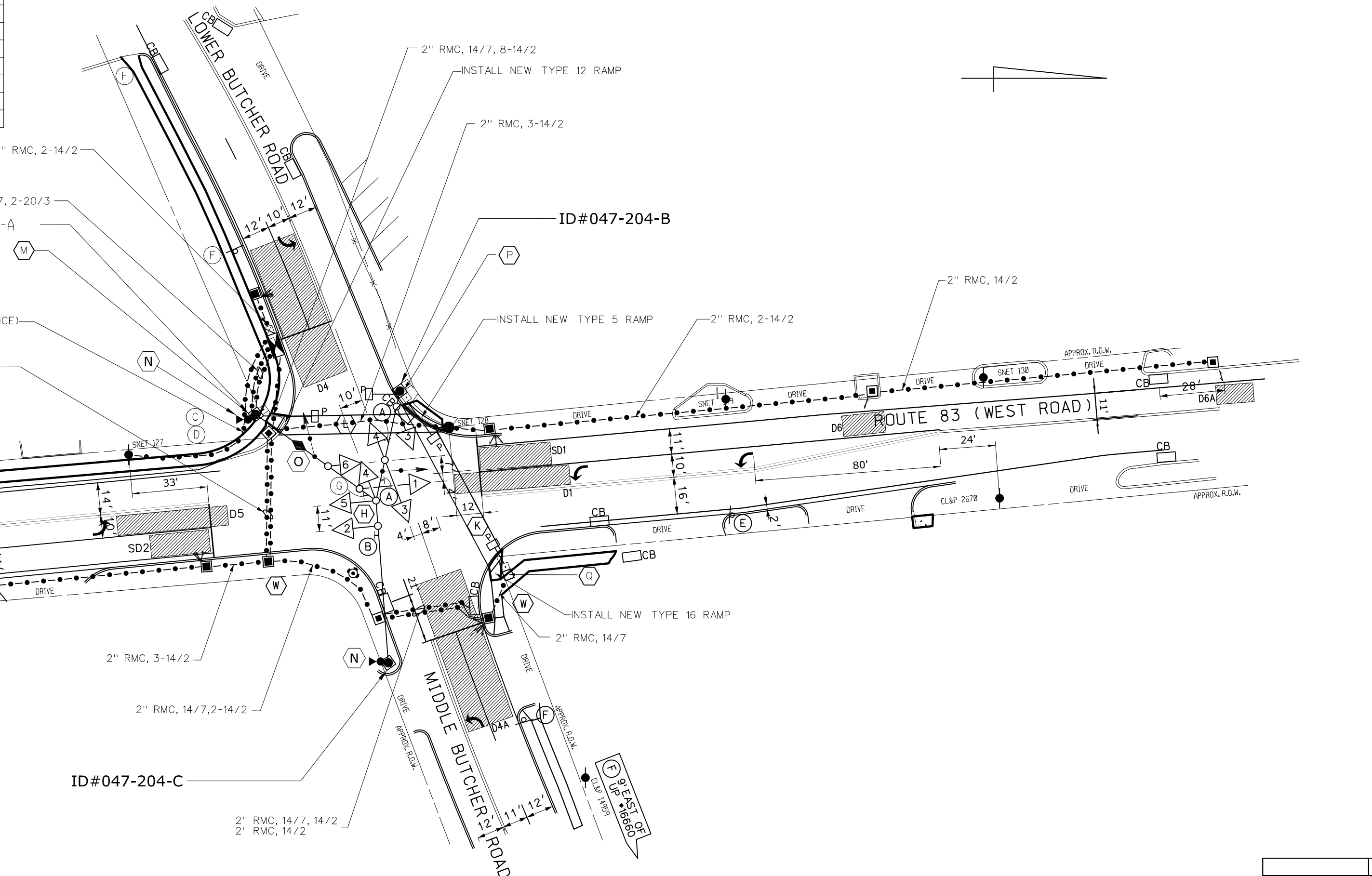

SIGNAL FACES		
1, 5	12"	12"
2, 3, 4, 6	12"	12"
P	9"	9"

PRE-EMPTION SETTINGS		
PRIORITY	NO	NO
DET. LOCK	YES	YES
DELAY	0	0
ALT. MIN. GRN	5	5
ALT. YELLOW	PARENT	PARENT
ALT. RED	PARENT	PARENT
ALT. PED. CLR.	NO	NO
HOLD GREEN	15	15
HOLD YELLOW	4.1	4.1
HOLD RED	1.6	3.8
HOLD PHASE	6	4
EXIT PHASE	2.6	1.5
EXIT CALL	NONE	NONE

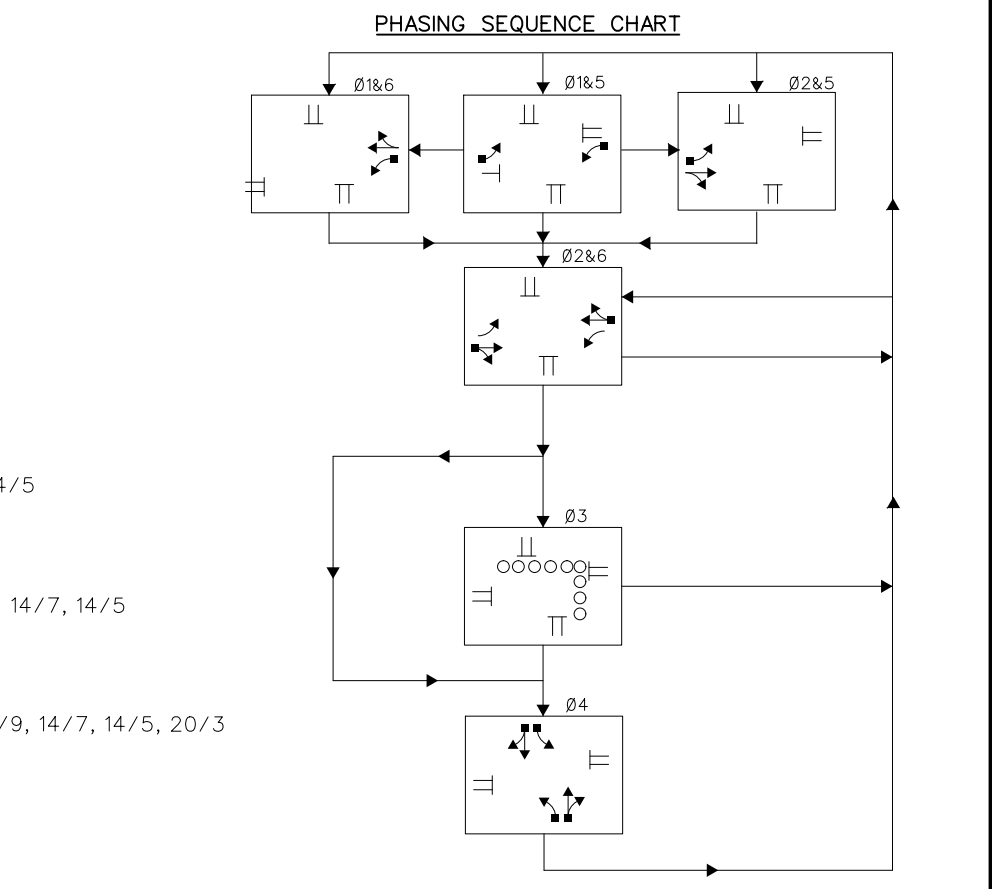
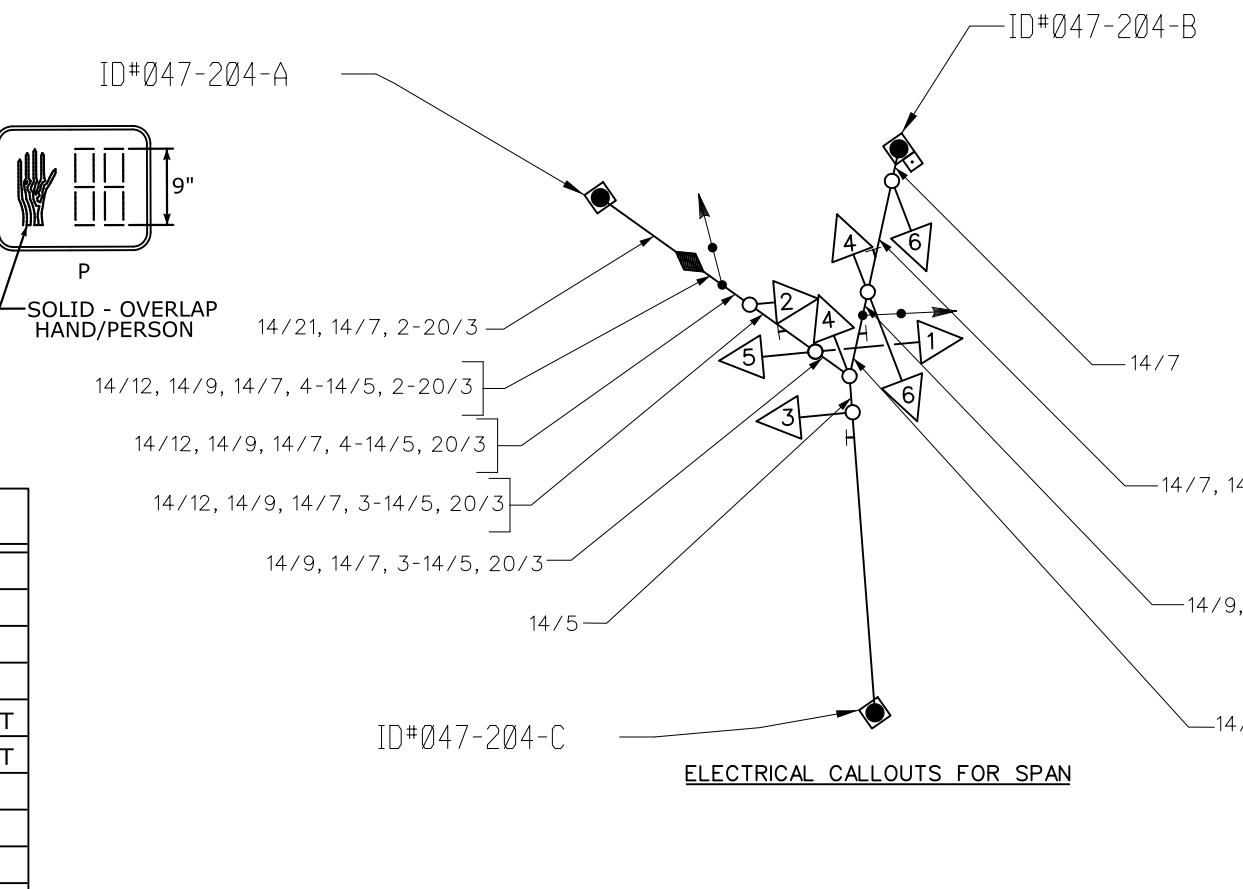

	ENGINEER	TRAFFIC	DATE	ELECTRICAL	DATE	REV #12	INTERSECTION #047-204	
	DRAWN BY					ENERGY BY - TOWN		ADDRESS #
	CHECKED BY					MAINT LEVEL 5		SERVICE POLE - SNET 127
	APPROVED BY					UNMETERED SERVICE		
	ROUTE 83 (WEST RD) AT LOWER & MIDDLE BUTCHER RD					TOWN:	PROJECT NO. 171-398	
						DRAWING TITLE:	DRAWING NO.	
							SHEET NO.	

Tighe & Bond
www.tighebond.com
213 Court Street
Suite 900
Middletown, CT 06457
(860) 704-4760

FAH
F. A. Heeketh & Associates, Inc.
3 Creamery Brook, East Granby, CT 06026
Civil & Traffic Engineers - Surveyors
Planners - Landscape Architects
Phone (860) 655-8000
Fax (860) 844-8600
e-mail ma@faheeketh.com

CLEARANCE INTERVALS DESIGNED BY: TIGHE & BOND
ENGINEER'S SEAL & SIGNATURE APPLY TO CLEARANCE INTERVALS ONLY.

REVISION #12 ONLY

SCALE 1" = 40'

DATE PLOTTED : 12/21/2021 10:20:21 21159 - Ellington Sidewalks V011_TR_ASSET_047-204.dgn

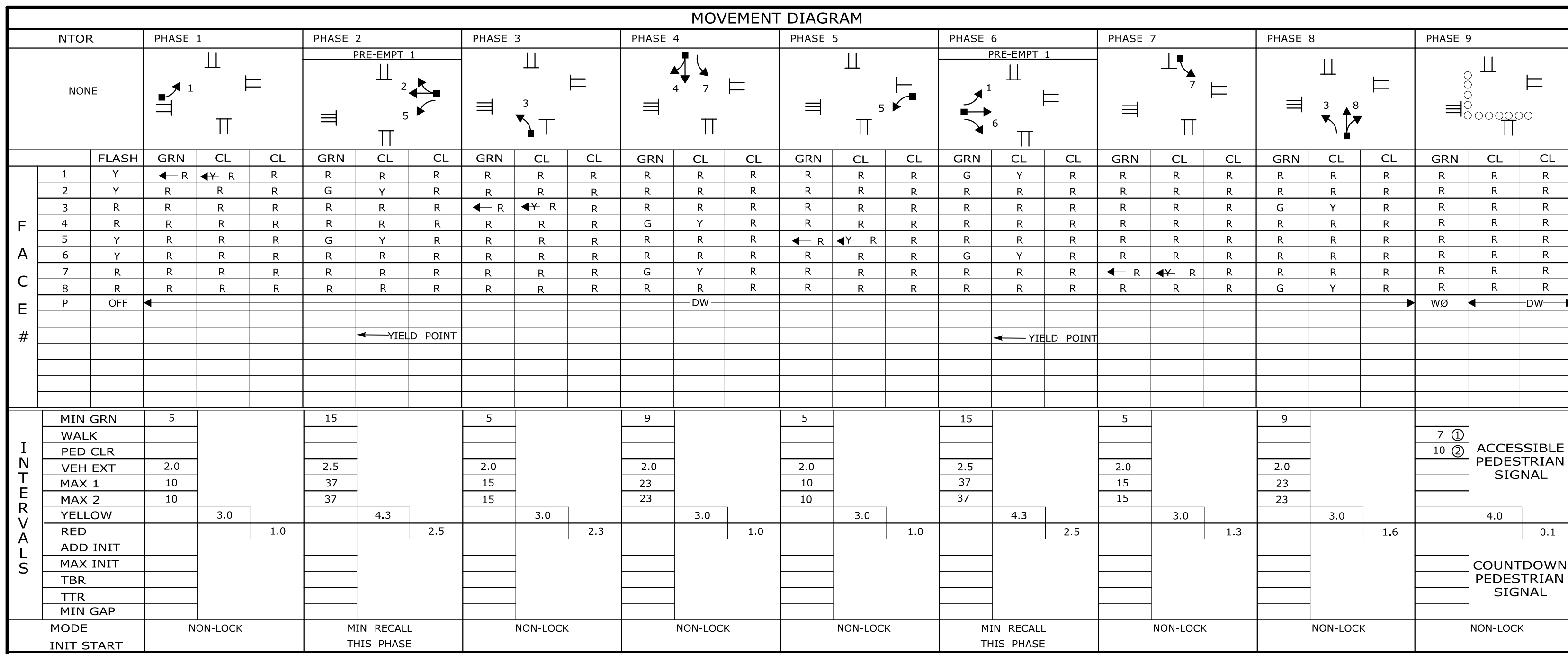

TECHNICAL NOTES
 STANDARD OVERLAP SKIP FEATURES APPLY

① PERCUSSIVE TONE ONLY DURING WALK INTERVAL.
 ② COUNTDOWN ONLY DURING FLASHING PEDESTRIAN CHANGE INTERVAL.
 MANUAL AND INTERVAL ADVANCE TO BE DISCONNECTED DURING PHASE 9 PEDESTRIAN CHANGE INTERVAL.
 PRE-EMPTION TO BE INOPERATIVE DURING FLASHING OPERATION.

OFFICE RECORD		SIGNAL REVISED:	
REV #	TIR # OSTA #047-1901-02 SM # N/A	REV #	TIR # N/A
	SIGNAL REPLACED UNDER PERMIT FOR 135 WEST ROAD.		INSTALLATION OF CONCRETE SIDEWALK

IDENT	SIZE (WXL)	TYPE	MODE	SYSTEM LOC	MASTER	COORDINATION TYPE: NONE			CYCLE	OFFSET
						FUNCTION	PROGRAM	DAYS		
D1	6' X 30'	VIDEO 360	PRESENCE			FLASH	NONE	DAILY		
D2, D2A	6' X 6'	VIDEO IP	PRESENCE			MAX 1	ALL OTHER TIMES			
D3	6' X 30'	VIDEO 360	PRESENCE			MAX 2	FUTURE			
D4	SEE PLAN	VIDEO 360	PRESENCE							
D5	6' X 30'	VIDEO 360	PRESENCE							
D6, D6A	6' X 6'	VIDEO IP	PRESENCE							
D7	6' X 30'	VIDEO 360	PRESENCE							
D8	6' X 30'	VIDEO 360	PRESENCE							

CONSTRUCTION NOTES

ALL MATERIAL AND CONSTRUCTION METHODS SHALL CONFORM TO THE FOLLOWING CURRENT D.O.T. DOCUMENTS WHICH CAN BE ACCESSED ON THE D.O.T. WEBSITE:

- * STANDARD SPECIFICATIONS FOR ROADS, BRIDGES AND INCIDENTAL CONSTRUCTION
- * SUPPLEMENTAL SPECIFICATIONS TO THE STANDARD SPECIFICATIONS,
- * SPECIAL PROVISIONS TO THE STANDARD SPECIFICATIONS,
- * STANDARD INSTALLATION AND GUIDE SHEETS

STAKE ALL R.O.W. PRIOR TO EXCAVATION.
 HAND HOLES, AND CONDUITS ARE EXISTING TO REMAIN AS SHOWN.

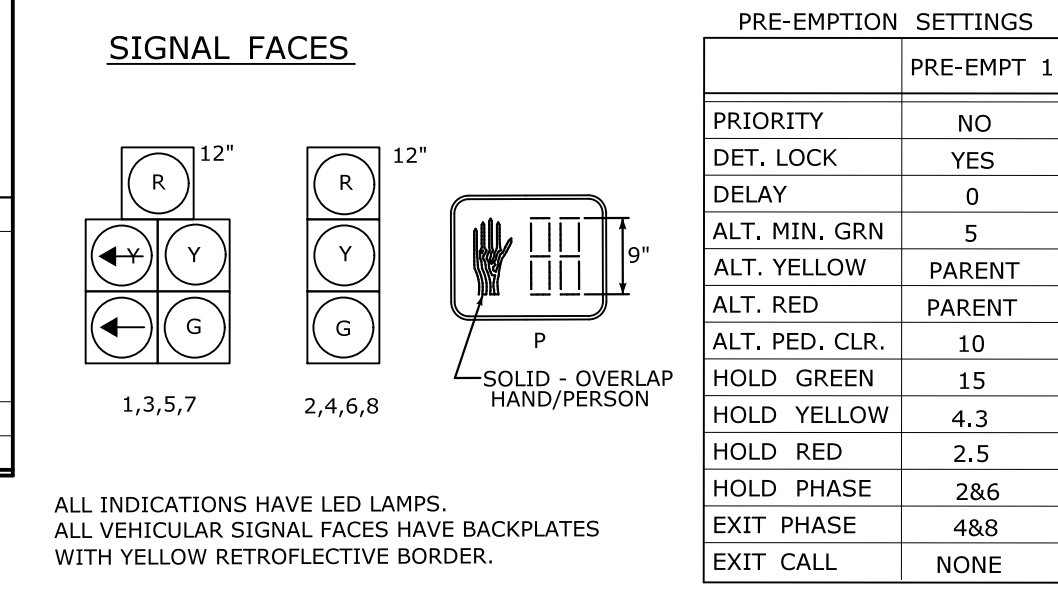

ANY PROPOSED REVISIONS TO THE LOCATION OF THE APPURTENANCES SHOWN ON THE PLAN MUST BE SUBMITTED FOR REVIEW AND APPROVAL BY THE DIVISION OF TRAFFIC ENGINEERING PRIOR TO INSTALLATION.

① CONSTRUCT TYPE 16 SIDEWALK RAMP PER GUIDE SHEETS.

ALL TRAFFIC SIGNAL EQUIPMENT IS EXISTING.

- SIGN LEGEND**
- Ⓐ INSTALL 31-0282 (↖↗)
 - Ⓑ INSTALL 31-0302 (↖↗)
 - Ⓒ INSTALL 31-1526 "KEEP RIGHT"
 - Ⓓ SPAN MOUNT 31-0135 (↖)
 - Ⓔ INSTALL 31-1603 "NO LEFT TURN"
 - Ⓕ INSTALL 31-0282Z (↖↗)
- STATE TO MAINTAIN ALL PAVEMENT MARKINGS AND SIGNAGE ON ROUTE 83 AND ALL STOP BARS.
- PROPERTY OWNERS TO MAINTAIN ALL OTHER PAVEMENT MARKINGS AND SIGNAGE ON THE PROPERTY OWNER'S DRIVEWAYS.
- Ⓖ BAR TYPE CROSS WALK, STATE MAINTAINED.
- NOTES:**
- PRE-EMPTION TO BE OWNED AND MAINTAINED BY THE TOWN OF ELLINGTON.
 - Ⓖ 30"x30" HANDHOLE, ALL OTHERS ARE TYPE II.
 - Ⓖ VIDEO DETECTION BY USE OF VIDEO IP CAMERA MOUNTED ON SPAN POLE ID #047-215-C.
 - Ⓖ VIDEO DETECTION BY USE OF VIDEO IP CAMERA CO-MOUNTED WITH VIDEO 360 DEGREE CAMERA ON SPAN POLE ID #047-215-D.

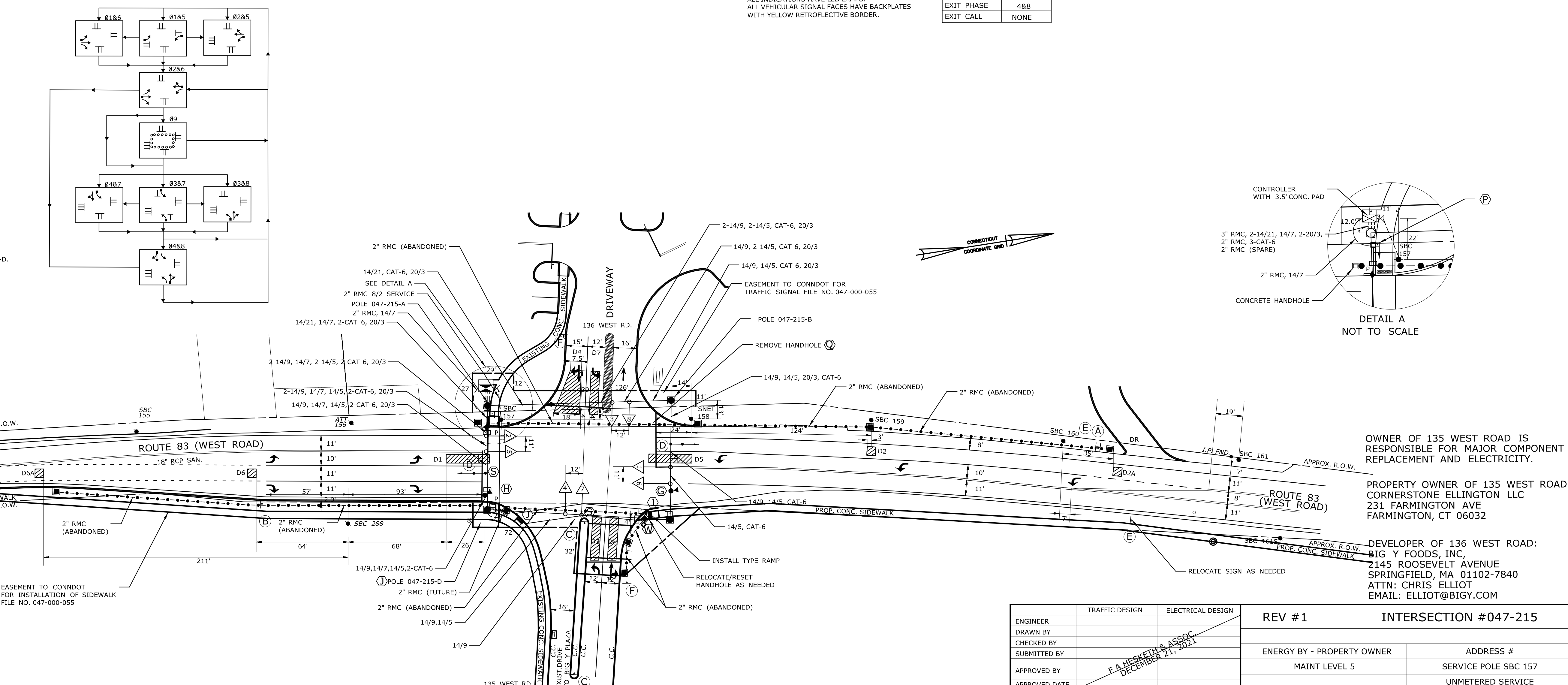

SPAN POLE INFORMATION

POLE ID#	POLE LENGTH	BOLT CIRCLE	CAMERA BRACKET LENGTH	YEAR INSTALLED
047-215 A	32'	24"	-	XXXX
047-215 B	32'	24"	-	XXXX
047-215 C	32'	24"	20' HORIZ.	XXXX
047-215 D	32'	24"	20' HORIZ.	XXXX

- LEGEND:**
- PROPOSED WOOD SPAN POLE
 - Ⓡ EXISTING WOOD SPAN POLE
 - Ⓢ PROPOSED STEEL SPAN POLE
 - Ⓣ EXISTING STEEL SPAN POLE
 - Ⓤ PROPOSED UTILITY POLE
 - ⓖ EXISTING UTILITY POLE
 - ⓗ PEDESTAL MOUNTING
 - ⓓ PEDESTRIAN PUSH BUTTON & SIGN
 - ⓔ DIRECTIONAL ARW. FOR PUSH BUTTON
 - Ⓥ TRAFFIC SIGNAL FACE
 - Ⓦ PEDESTRIAN SIGNAL FACE
 - Ⓧ DET. LEADS IN SAW CUT
 - Ⓨ PROPOSED RMC (RIGID METAL CONDUIT)
 - Ⓩ EXISTING RMC (RIGID METAL CONDUIT)
 - ⓐ AUXILIARY TERMINATION CABINET
 - ⓑ AUXILIARY EQUIPMENT CABINET
 - ⓓ VIDEO DETECTION ZONE
 - ⓔ PROPOSED CONTROLLER
 - Ⓠ EXISTING CONTROLLER
 - Ⓡ LOOP DETECTOR
 - Ⓢ VIDEO CAMERA CABLE
 - Ⓣ CABLE CLOSURE
 - Ⓤ WIRELESS SENSOR
 - ⓖ WIRELESS RECEIVER
 - ⓗ WIRELESS TRANSCIVER
 - ⓓ GUY WIRE
 - ⓔ PROPOSED HANDHOLE
 - Ⓠ EXISTING HANDHOLE

STATE OF CONNECTICUT DEPARTMENT OF TRANSPORTATION

ROUTE 83 (WEST RD) AT DRIVEWAYS TO 135 & 136 WEST ROAD

SCALE 1" = 40'

ENGINEER	TRAFFIC DESIGN	ELECTRICAL DESIGN	REV #1	INTERSECTION #047-215
DRAWN BY			ENERGY BY - PROPERTY OWNER	ADDRESS #
CHECKED BY			MAINT LEVEL 5	SERVICE POLE SBC 157
SUBMITTED BY			UNMETERED SERVICE	
APPROVED BY			TOWN:	ELLINGTON
APPROVED DATE			PROJECT NO.	FAH-18108
			DRAWING NO.	TCS-01
			SHEET NO.	

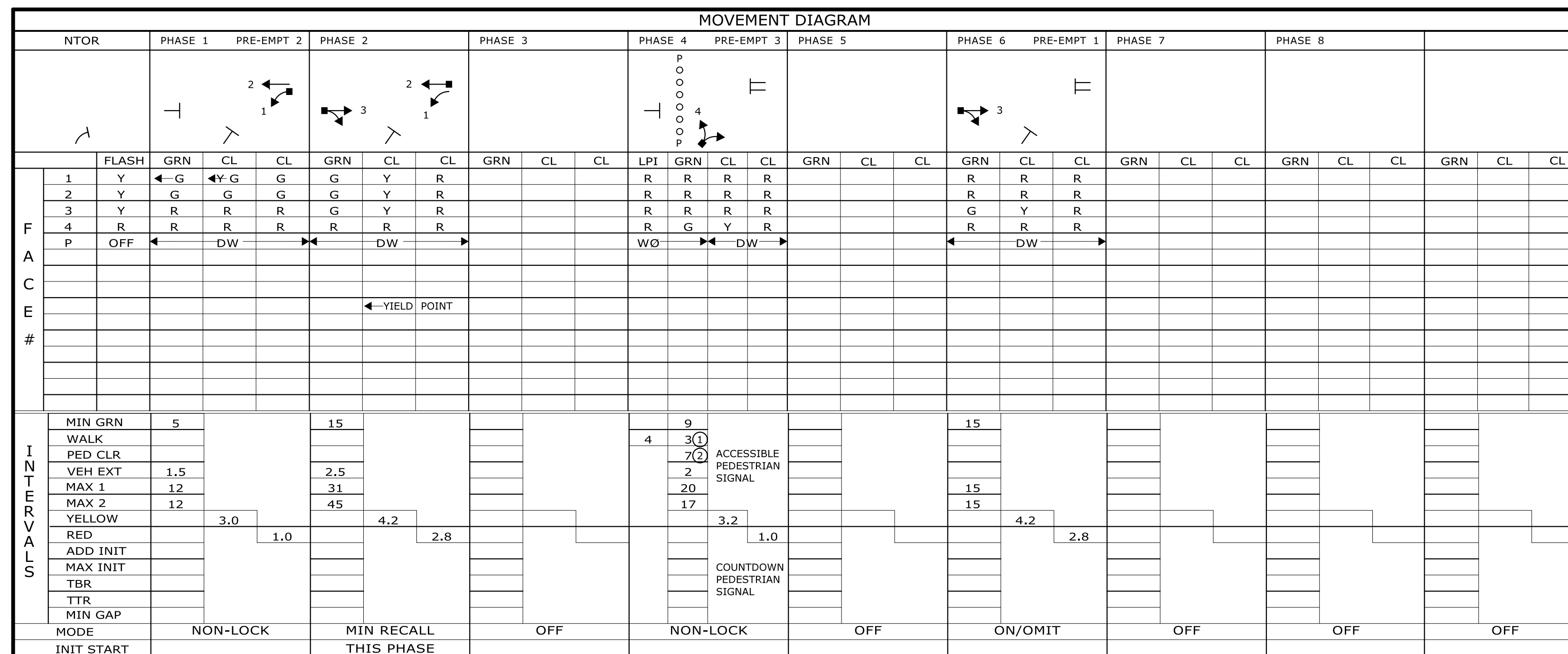

TECHNICAL NOTES

STANDARD OVERLAP SKIP FEATURES APPLY
 PHASE 2 ON TO OMIT PHASE 1.
 ② COUNTDOWN ONLY DURING FLASHING PEDESTRIAN CHANGE INTERVAL.
 ① PERCUSSIVE TONE ONLY DURING LPI AND PEDESTRIAN WALK INTERVAL.
 ③ LPI AND CONCURRENT PED PHASE ONLY COMES IN WHEN ACTUATED BY PUSHBUTTON.
 ARTERY DETECTION TO BE NON-ACTUATING DURING COORDINATION.

OFFICE RECORD

REV # 0171-0441
 TR # N/A
 SM # N/A
 SIGNAL REVISED: 0171-0441

INTERVALS

MIN GRN	5	15	9	15
WALK			4	
PED CLR			30	
VEH EXT	1.5	2.5	7	
MAX 1	12	31	20	
MAX 2	12	45	17	
YELLOW	3.0	4.2	3.2	4.2
RED	1.0	2.8	1.0	2.8
ADD INIT				
MAX INIT				
TBR				
TTR				
MIN GAP				
MODE	NON-LOCK	MIN RECALL	OFF	ON/OMIT
INIT START		THIS PHASE		

DETECTORS

IDNT	SIZE (WXL)	TYPE	MODE	SYSTEM LOC	COORDINATION TYPE: TBC/GPS	FUNCTION	PROGRAM TIME	DAYS	CYCLE	OFFSET
									SEC	%
D1	6' X 40'	VIDEO-360	PRESENCE	047-213	FLASH	NONE				
D2	6' X 155'	RADAR	PRESENCE		MAX 1	ALL OTHER TIMES				
D2A	6' X 155'	RADAR	PRESENCE		MAX 2	0600-0800 1600-1800	M-F	80"	4	5
D4	6' X 55'	VIDEO-360	PRESENCE		PATTERN 1	FREE	ALL OTHER TIMES			
SD2	6' X 40'	VIDEO-360	PRESENCE							
SD2A	6' X 40'	VIDEO-360	PRESENCE							

CONSTRUCTION NOTES:

ALL TRAFFIC SIGNAL EQUIPMENT IS NEW EXCEPT AS NOTED.
 STATE FORCES TO STAKE ALL R.O.W. PRIOR TO EXCAVATION UNLESS OTHERWISE DIRECTED BY ENGINEER.
 ANY PROPOSED REVISIONS TO THE LOCATION OF THE APPURTENANCES SHOWN ON THE PLAN MUST BE SUBMITTED FOR REVIEW AND APPROVAL BY THE DIVISION OF TRAFFIC ENGINEERING PRIOR TO INSTALLATION.
 THE LOCATION OF THE TRAFFIC SIGNAL FOUNDATIONS WHEN IN OR ADJACENT TO SIDEWALKS SHALL BE VERIFIED PRIOR TO INSTALLATION TO PROVIDE A FREE PATH OF NOT LESS THAN 4 FEET. IF A MINIMUM OF 4 FOOT FREE PATH IS UNAVAILABLE, NOTIFY THE ENGINEER AND CONTACT THE DIVISION OF TRAFFIC ENGINEERING.
 REMOVE ALL ABANDONED TRAFFIC SIGNAL EQUIPMENT PER SPECIAL PROVISION.
 INSTALL PEDESTAL FOUNDATIONS ADJACENT TO LANDING AREAS.
 INSTALL RISER ON SNET # 188 UTILITY POLE.
 (E) INSTALL MAST ARM FOUNDATION ADJACENT TO AND WITHIN R.O.W.
 (G) CONSTRUCT TYPE 13 SIDEWALK RAMP PER GUIDE SHEETS.
CONTRACTOR TO ERADICATE AND INSTALL PAVEMENT MARKINGS AS INDICATED BELOW
 -REFRESH STOP BARS ON ROUTE 83
 -INSTALL 4" DYCL ISLAND MARKINGS ON ROUTE 83 SOUTH LEG AS SHOWN ON THE PLAN
 -ERADICATE STOP BAR AND 18' OF DOUBLE YELLOW CENTERLINE ON MOUNTAIN ROAD
 -AND INSTALL NEW STOP BAR AS SHOWN ON THE PLAN
 -INSTALL CROSSWALK ON ROUTE 83 SOUTH LEG. ERADICATE EDGE LINE WITHIN 4' OF CROSSWALK
 TEMPORARILY RELOCATE EXISTING CONTROLLER TO FACILITATE INSTALLATION
 OF NEW CONTROLLER CABINET AND FOUNDATION UNTIL NEW CONTROLLER IS IN OPERATION.
 COORDINATE WITH UTILITY COMPANY REPRESENTATIVES LISTED IN THE SPECIAL PROVISION, 1.07 - LEGAL RELATIONS AND RESPONSIBILITIES.
 DETECTION LOCATIONS ARE FOR ILLUSTRATION ONLY.
 EXACT LOCATIONS SHALL BE DETERMINED BY THE MANUFACTURER OR HIS DESIGNATED REPRESENTATIVE.
 DETECTOR CABLES ARE TO BE INSTALLED CONTINUOUS BETWEEN EACH DETECTOR AND THE CONTROLLER CABINET.
 CONTRACTOR TO REMOVE THE EXISTING 14/9 INTERCONNECT BETWEEN THE SIGNALS.
 (J) DETECTION BY THE USE OF RADAR DETECTOR ON MAST ARM ID # 047-213-A & MAST ARM ID # 047-213-B
 (K) VIDEO DETECTION BY USE OF VIDEO 360 CAMERA ON MAST ARM ID # 047-213-B
 (W) INSTALL 30" X 30" HANDHOLE. ALL OTHERS TYPE II.

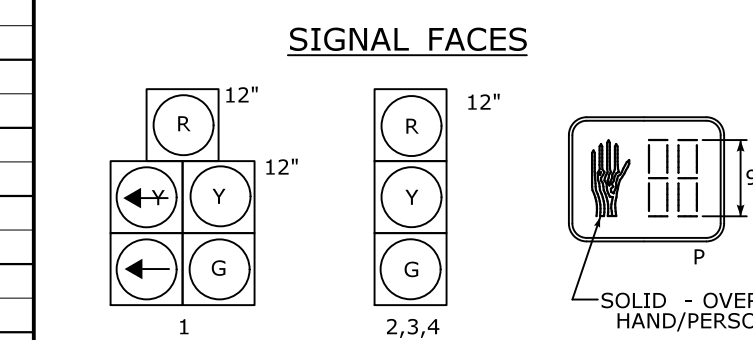

PRE-EMPTION SETTINGS

	PRE-EMPT 1	PRE-EMPT 2	PRE-EMPT 3
PRIORITY	NO	NO	NO
DET. LOCK	YES	YES	YES
DELAY	0	0	0
ALT. MIN. GRN	5	5	5
ALT. YELLOW	PARENT	PARENT	PARENT
ALT. RED	PARENT	PARENT	PARENT
ALT. PED. CLR.	NO	NO	PARENT
HOLD GREEN	15	15	15
HOLD YELLOW	4.2	4.2	3.2
HOLD RED	2.8	2.8	1.0
HOLD PHASE	6	1	4
EXIT PHASE	4	4	2
EXIT CALL	NONE	NONE	NONE

CONSTRUCTION NOTES:

ALL TRAFFIC SIGNAL EQUIPMENT IS NEW EXCEPT AS NOTED.
 STATE FORCES TO STAKE ALL R.O.W. PRIOR TO EXCAVATION UNLESS OTHERWISE DIRECTED BY ENGINEER.
 ANY PROPOSED REVISIONS TO THE LOCATION OF THE APPURTENANCES SHOWN ON THE PLAN MUST BE SUBMITTED FOR REVIEW AND APPROVAL BY THE DIVISION OF TRAFFIC ENGINEERING PRIOR TO INSTALLATION.
 THE LOCATION OF THE TRAFFIC SIGNAL FOUNDATIONS WHEN IN OR ADJACENT TO SIDEWALKS SHALL BE VERIFIED PRIOR TO INSTALLATION TO PROVIDE A FREE PATH OF NOT LESS THAN 4 FEET. IF A MINIMUM OF 4 FOOT FREE PATH IS UNAVAILABLE, NOTIFY THE ENGINEER AND CONTACT THE DIVISION OF TRAFFIC ENGINEERING.
 REMOVE ALL ABANDONED TRAFFIC SIGNAL EQUIPMENT PER SPECIAL PROVISION.
 INSTALL PEDESTAL FOUNDATIONS ADJACENT TO LANDING AREAS.
 INSTALL RISER ON SNET # 188 UTILITY POLE.
 (E) INSTALL MAST ARM FOUNDATION ADJACENT TO AND WITHIN R.O.W.
 (G) CONSTRUCT TYPE 13 SIDEWALK RAMP PER GUIDE SHEETS.
CONTRACTOR TO ERADICATE AND INSTALL PAVEMENT MARKINGS AS INDICATED BELOW
 -REFRESH STOP BARS ON ROUTE 83
 -INSTALL 4" DYCL ISLAND MARKINGS ON ROUTE 83 SOUTH LEG AS SHOWN ON THE PLAN
 -ERADICATE STOP BAR AND 18' OF DOUBLE YELLOW CENTERLINE ON MOUNTAIN ROAD
 -AND INSTALL NEW STOP BAR AS SHOWN ON THE PLAN
 -INSTALL CROSSWALK ON ROUTE 83 SOUTH LEG. ERADICATE EDGE LINE WITHIN 4' OF CROSSWALK
 TEMPORARILY RELOCATE EXISTING CONTROLLER TO FACILITATE INSTALLATION
 OF NEW CONTROLLER CABINET AND FOUNDATION UNTIL NEW CONTROLLER IS IN OPERATION.
 COORDINATE WITH UTILITY COMPANY REPRESENTATIVES LISTED IN THE SPECIAL PROVISION, 1.07 - LEGAL RELATIONS AND RESPONSIBILITIES.
 DETECTION LOCATIONS ARE FOR ILLUSTRATION ONLY.
 EXACT LOCATIONS SHALL BE DETERMINED BY THE MANUFACTURER OR HIS DESIGNATED REPRESENTATIVE.
 DETECTOR CABLES ARE TO BE INSTALLED CONTINUOUS BETWEEN EACH DETECTOR AND THE CONTROLLER CABINET.
 CONTRACTOR TO REMOVE THE EXISTING 14/9 INTERCONNECT BETWEEN THE SIGNALS.
 (J) DETECTION BY THE USE OF RADAR DETECTOR ON MAST ARM ID # 047-213-A & MAST ARM ID # 047-213-B
 (K) VIDEO DETECTION BY USE OF VIDEO 360 CAMERA ON MAST ARM ID # 047-213-B
 (W) INSTALL 30" X 30" HANDHOLE. ALL OTHERS TYPE II.

SIGN LEGEND:

(A) REPLACE 31-0222 ONLY

(B) REPLACE EXISTING (N.T.O.R.) WITH 31-1626 (LEFT TURNING VEHICLES YIELD TO PEDESTRIANS)

(C) INSTALL MAST ARM MOUNTED 31-0816 (N.T.O.R.)

(D) INSTALL 31-1626 (LEFT TURNING VEHICLES YIELD TO PEDESTRIANS)

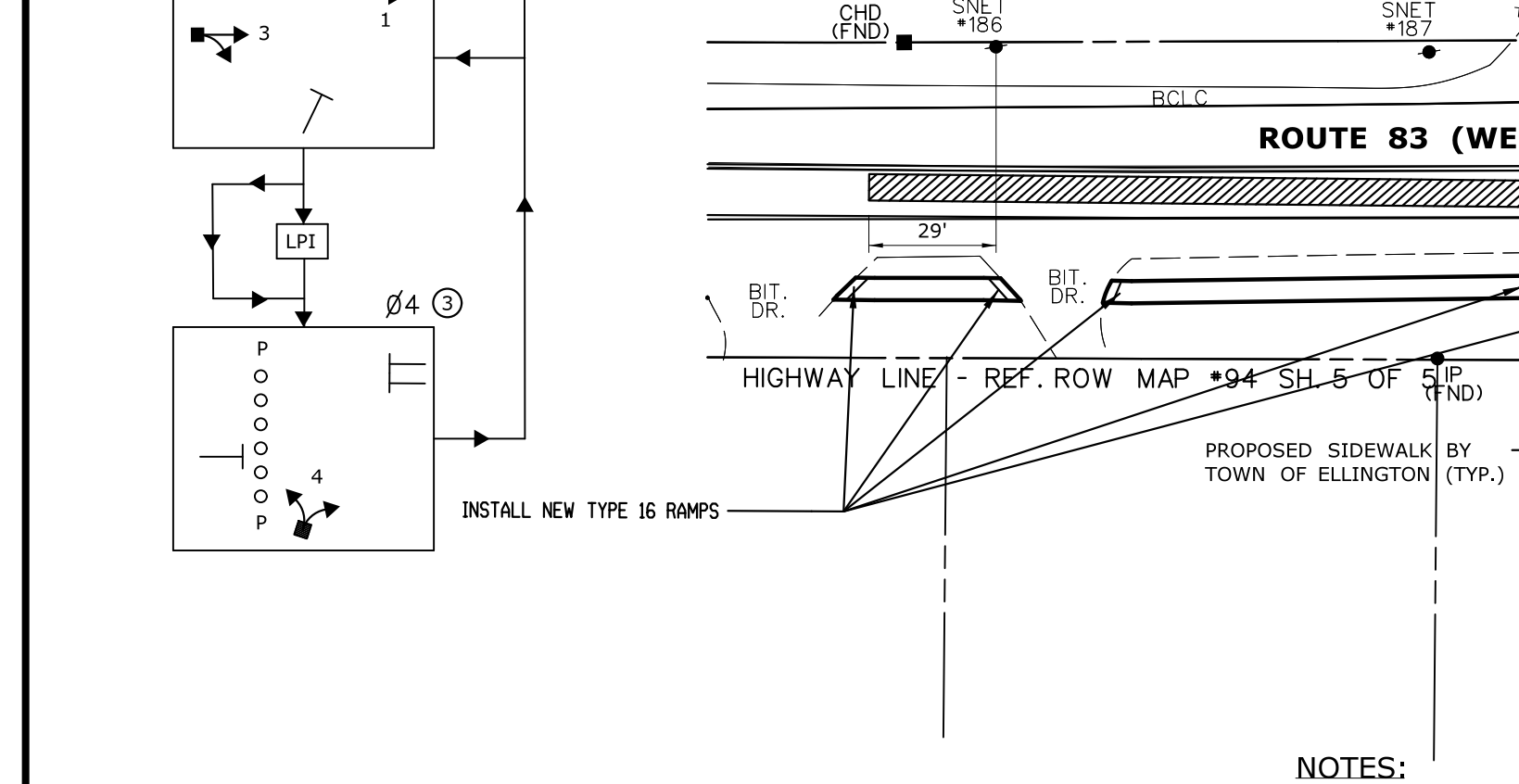

MAST ARM INFORMATION

ID #	APPROX. ARM ATTACHMENT HEIGHT	ARM LENGTH	RADAR DETECTOR VERTICAL MOUNT	VERTICAL RISER FOR 360 CAMERA	YEAR INSTALLED	GPS COORDINATES
						NORTHING EASTING
047-213-A	25'	3'	N/A			888405.27 1078985.19
047-213-B	45'	3'	10'			888467.17 1079057.10

* TO BE CALCULATED BY CONTRACTOR BASED ON FIELD CONDITIONS

NOTES:

-STATE TO MAINTAIN ALL SIGNS AND PAVEMENT MARKINGS ON ROUTE 83 AND ALL STOP BARS.
 -TOWN TO MAINTAIN ALL OTHER PAVEMENT MARKINGS ON MOUNTAIN ROAD.
 (S) BAR TYPE CROSSWALK - STATE MAINTAINED.
 -THE TOWN OF ELLINGTON OWNS AND MAINTAINS THE EMERGENCY VEHICLE PRE-EMPTION EQUIPMENT.

LEGEND:

R, Y, G	RED, YEL, GRN	EXISTING WOOD SPAN POLE	TRAFFIC SIGNAL FACE	PROPOSED CONTROLLER	VC VIDEO CAMERA CABLE
RED ARROW	RED ARROW	EXISTING STEEL SPAN POLE	PEDESTRIAN SIGNAL FACE	EXISTING CONTROLLER	CABLE CLOSURE
YELLOW ARROW	YELLOW ARROW	EXISTING WOOD SPAN POLE	DET. LEADS IN SAW CUT	LOOP DETECTOR	WIRELESS SENSOR
GREEN ARROW	GREEN ARROW	EXISTING STEEL SPAN POLE	PROPOSED RMC (RIGID METAL CONDUIT)	SD SYSTEM DETECTOR	WIRELESS RECEIVER
WALK/ PED. CLR	WALK/ PED. CLR	PROPOSED UTILITY POLE	EXISTING RMC (RIGID METAL CONDUIT)	MAGNETIC DETECTOR	WIRELESS TRANSCIEVER
D.W. DON'T WALK	D.W. DON'T WALK	EXISTING UTILITY POLE	AUXILIARY TERMINATION CABINET	OPTICAL DETECTOR	GUY WIRE
FL. FLASHING	FL. FLASHING	PEDESTAL MOUNTING	AUXILIARY EQUIPMENT CABINET	VIDEO DETECTOR	EXISTING HANDHOLE
		PEDESTRIAN PUSH BUTTON & SIGN	VIDEO DETECTION ZONE	AUDIO DETECTOR	
		DIRECTIONAL ARW. FOR PUSH BUTTON			

DATE PLOTTED : 12/21/2021 Q:\2021\21159 - Ellington Sidewalks\TR_TCS_MSH_047-213_XXXpending(for sharing NO CHANGES).dgn

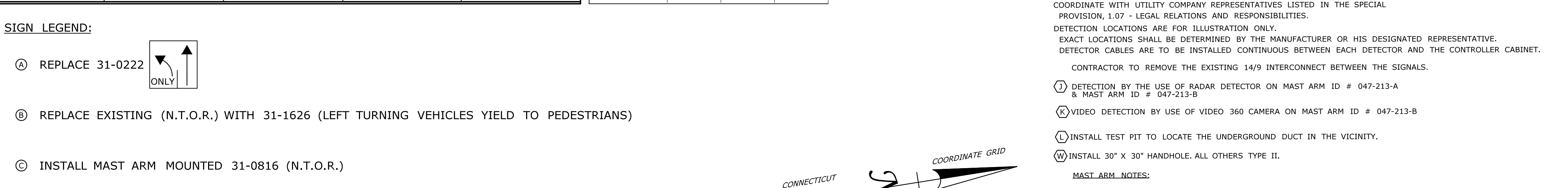

2020 TRAFFIC COUNTS

APPROACH	A.M. PEAK HOUR	P.M. PEAK HOUR
436(684)	6(39)	613(615)
613(615)	89(98)	
107(87)		23(31)

SYSTEM LOC

MASTER	COORDINATION TYPE: TBC/GPS	FUNCTION	PROGRAM TIME	DAYS	CYCLE	OFFSET
					SEC	%
047-213	FLASH	NONE				
	MAX 1	ALL OTHER TIMES				
	MAX 2	0600-0800 1600-1800	M-F	80"	1	1
	PATTERN 1	FREE	ALL OTHER TIMES			
	FREE	ALL OTHER TIMES				

ENGINEER

ENGINEER	TRAFFIC DESIGN	ELECTRICAL DESIGN
C. LOCKHART	T. JAMES	T. JAMES
CHECKED BY	D. VERONESI	M. JULIANO
APPROVED BY	MARK F. MAKUCH	MARK F. MAKUCH
APPROVED DATE	6/8/21	6/8/21

REV # INTERSECTION # 047-213

ENERGY BY TOWN	-
MAINT LEVEL 1	SERVICE POLE SNET #188
UNMETERED	

STATE OF CONNECTICUT DEPARTMENT OF TRANSPORTATION

ROUTE 83 (WEST RD) AT MOUNTAIN ROAD

TRAFFIC CONTROL SIGNAL PLAN

TOWN: ELLINGTON

PROJECT NO. 0171-0441

DRAWING NO. TCS-09

SHEET NO.

SCALE 1" = 40'

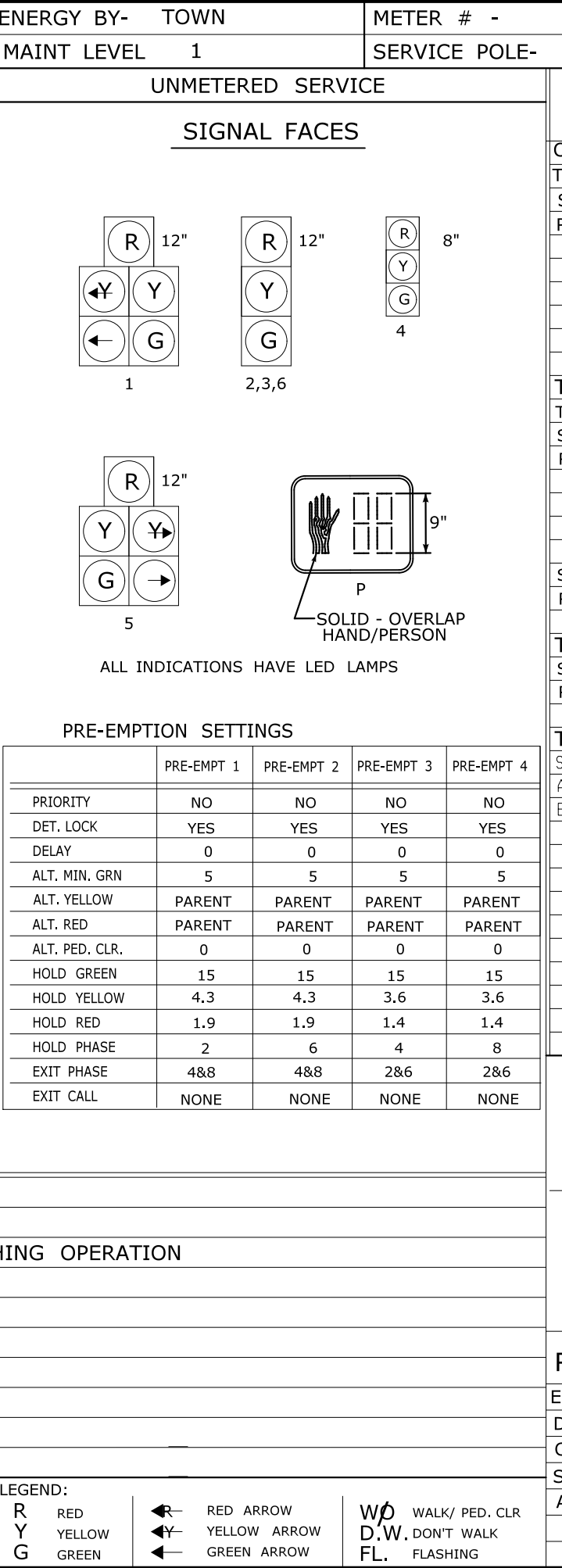
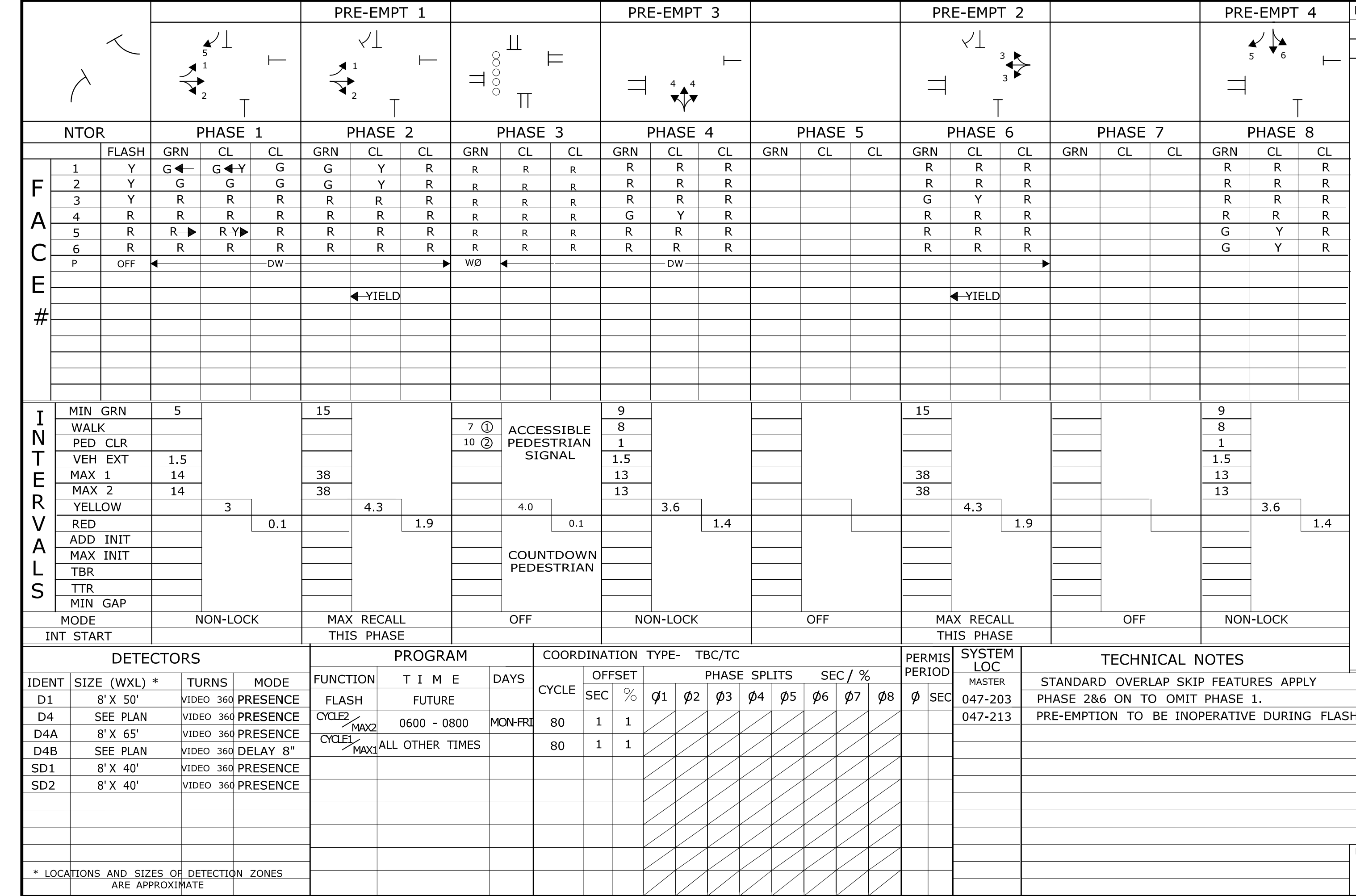

REVISION #	SM #	DESCRIPTION
10A		TRAFFIC & ELECT DES : DIST 1 ELECT
11		REMOVED TIME CLOCK NOTE.
12		ADDED EMERGENCY PRE-EMPTION
13		REMOVED RAISED MEDIAN ISLAND AND "KEEP RIGHT" SIGNS ON ROUTE 286. INSTALLED DOTTED DOUBLE YELLOW CENTER LINE MARKINGS.
14		REMOVED PAVED MARKINGS UNDER 2018 VIP.
15		REPLACED LOOPS WITH VIDEO DETECTION BY SIGNAL LAB.

STATE OF CONNECTICUT	DEPARTMENT OF TRANSPORTATION
BUR. OF ENGINEERING & HWY OPERATIONS	
DIVISION OF TRAFFIC ENGINEERING	
TRAFFIC CONTROL SIGNAL	

REVISION #	DATE	DESCRIPTION
10A	12/29/2008	TRAFFIC CONTROL SIGNAL

CONSTRUCTION NOTES

ALL MATERIAL AND CONSTRUCTION METHODS SHALL CONFORM TO THE FOLLOWING CURRENT D.O.T. DOCUMENTS WHICH CAN BE ACCESSED ON THE D.O.T. WEBSITE:
 • STANDARD SPECIFICATIONS FOR ROADS, BRIDGES AND INCIDENTAL CONSTRUCTION
 • SUPPLEMENTAL SPECIFICATIONS TO THE STANDARD SPECIFICATIONS,
 • SPECIAL PROVISIONS TO THE STANDARD SPECIFICATIONS,
 • STANDARD INSTALLATION AND GUIDE SHEETS

ALL TRAFFIC SIGNAL EQUIPMENT IS NEW EXCEPT AS NOTED.

STAKE ALL R.O.W. PRIOR TO EXCAVATION.

ANY PROPOSED REVISIONS TO THE LOCATION OF THE APPURTENANCES SHOWN ON THE PLAN MUST BE SUBMITTED FOR REVIEW AND APPROVAL BY THE DIVISION OF TRAFFIC ENGINEERING PRIOR TO INSTALLATION.

THE LOCATION OF TRAFFIC SIGNAL FOUNDATIONS WHEN IN OR ADJACENT TO SIDEWALKS SHALL BE VERIFIED PRIOR TO INSTALLATION TO PROVIDE A FREE PATH OF NOT LESS THAN 4 FEET. IF A MINIMUM 4 FOOT FREE PATH IS UNAVAILABLE NOTIFY THE ENGINEER AND CONTACT THE DIVISION OF TRAFFIC ENGINEERING.

REMOVE ALL ABANDONED TRAFFIC SIGNAL EQUIPMENT PER SPECIAL PROVISION.

INSTALL PEDESTAL FOUNDATIONS ADJACENT TO LANDING AREAS.

MODIFY EXISTING CONTROLLER TO ACCOMMODATE CHANGES. SUPPLY 5 COPIES OF REVISED CABINET WIRING DIAGRAMS.

COUNTDOWN ONLY DURING FLASHING PEDESTRIAN CHANGE INTERVAL.

PERCUSSIVE TONE ONLY DURING PEDESTRIAN WALK INTERVAL.

INSTALL NEW 8' PEDESTAL, PEDESTRIAN COUNTDOWN SIGNAL AND ACCESSIBLE PUSHBUTTON ON RELOCATED PEDESTAL. EXTEND EXISTING 14/2 RMC INTO NEW FOUNDATION. REMOVE EXISTING 14/5 CABLE AND REPLACE WITH NEW 14/7 CABLE TO CONTROLLER.

INSTALL NEW 8' PEDESTAL, PEDESTRIAN COUNTDOWN SIGNAL AND ACCESSIBLE PUSHBUTTON ON RELOCATED PEDESTAL. EXTEND EXISTING 14/2 RMC INTO NEW FOUNDATION. REMOVE EXISTING 14/5 CABLE AND REPLACE WITH NEW 14/7 CABLE TO CONTROLLER.

INSTALL NEW BAR TYPE CROSSWALK (16' X 16' X 8' MIN) - MAINTAINED BY STATE

MIN GRN	5	15		9		15		9	
WALK									
PED CLR									
VEH EXT	1.5								
MAX 1	14								
MAX 2	14								
YELLOW	3								
RED		0.1			0.1				0.1
ADD INIT									
MAX INIT									
TBR									
TTR									
MIN GAP									

IDENT	SIZE (WXL) *	TURNS	MODE	FUNCTION	TIME	DAYS	CYCLE	OFFSET	PHASE SPLITS	SEC / %	PERMIS PERIOD	SYSTEM LOC	TECHNICAL NOTES
D1	8' X 50'	VIDEO 360	PRESENCE	FLASH	FUTURE							047-203	STANDARD OVERLAP SKIP FEATURES APPLY
D4	SEE PLAN	VIDEO 360	PRESENCE	CYCLE	0600 - 0800	MON-FRI	80	1 1				047-213	PHASE 2&6 ON TO OMIT PHASE 1.
D4A	8' X 65'	VIDEO 360	PRESENCE	CYCLE	ALL OTHER TIMES		80	1 1					PRE-EMPTION TO BE INOPERATIVE DURING FLASHING OPERATION
D4B	SEE PLAN	VIDEO 360	DELAY 8"										
SD1	8' X 40'	VIDEO 360	PRESENCE										
SD2	8' X 40'	VIDEO 360	PRESENCE										



NOTES:

STATE TO MAINTAIN ALL SIGNS AND PAVEMENT MARKINGS ON ROUTE 83 AND ROUTE 286 AND STOP BAR AND "NO TURN ON RED" SIGN ON SNIPLSIC LAKE ROAD.

TOWN OF ELLINGTON TO MAINTAIN ALL OTHER SIGNS AND MARKINGS ON SNIPLSIC LAKE ROAD.

PRE-EMPTION EQUIPMENT TO BE OWNED AND MAINTAINED BY THE TOWN OF ELLINGTON.

BAR-TYPE CROSSWALK (16' X 16' X 8' MIN.) - MAINTAINED BY STATE

VIDEO DETECTION BY USE OF VIDEO-360 CAMERA MOUNTED ON SPAN POLE ID #047-203-A CAT 5e CABLE RUNS DIRECTLY FROM CAMERA TO CABINET.

SPAN POLE INFORMATION:
ID # 047-203-A HEIGHT 30', B.C. 20', LOAD AT YIELD 7800lbs.

LEGEND:	TRAFFIC SIGNAL FACS	MAGNETIC DETECTOR	EXISTING CONTROLLER	EXISTING R.M.C. (RIGID METAL CONDUIT)	MICROWAVE DETECTOR
PROPOSED WOOD SPAN POLE	PROPOSED UTILITY POLE	SD	EXISTING CONTROLLER	EXISTING R.M.C. (RIGID METAL CONDUIT)	STRAIN INSULATOR
EXISTING WOOD SPAN POLE	EXISTING UTILITY POLE		PROPOSED HANDHOLE	CABLE CLOSURE	AUXILIARY TERMINATION CABINET
PROPOSED STEEL SPAN POLE	PEDESTRIAN SIGNAL HEAD		EXISTING HANDHOLE	DET. LEADS IN SAW CUT	AUXILIARY EQUIPMENT CABINET
EXISTING STEEL SPAN POLE	AUDIBLE PEDESTRIAN SIGNAL		PROPOSED R.M.C. (RIGID METAL CONDUIT)	EXISTING PEDESTAL	
	PEDESTRIAN PUSH BUTTON & SIGN				

REV #14 INTERSECTION # 047-203

TOWN OF ELLINGTON
ROUTE 83 (WEST ROAD) AT
RTE 286 (MAIN ST) & SNIPLSIC LAKE RD

TRAFFIC CONTROL SIGNAL LAYOUT	SCALE - 1"=40'
ALL DIMENSIONS IN FEET UNLESS OTHERWISE NOTED.	
DATE PLOTTED: 12/20/2021	

NO.	DATE	INIT.	DESCRIPTION

CONNECTICUT DEPARTMENT OF TRANSPORTATION	
TOWN: ELLINGTON	PROJECT NO.:
DRAWING TITLE: TRAFFIC SIGNAL PLAN SHEET	DRAWING NO.:
SHEET NO.: 2	

REV #13 INTERSECTION # 047-203

